



5900 Schooner Street – Belleville, MI 48111 – USA

TEL (800) 422-2558 – FAX (734) 665-9099

[www.Eberbachlabtools.com](http://www.Eberbachlabtools.com)

**E8575.00 MICRO CONTAINER**

## **USE AND CARE FOR CATALOG NUMBER: - E8575.00 MICRO CONTAINER**

### USE:

The Micro Container is a precision assembly designed for aseptic use, if desired. Samples in the container are in contact with stainless steel and Teflon. It can be used on Waring one and two speed blender power units. Working capacity is between 3 ml minimum and 20 ml maximum. The cast aluminum base acts as a heat sink capable of absorbing heat produced during the blending operation. The entire assembly can be pre-chilled to provide additional heat absorbing capacity. Thorough cleaning or sterilizing should be accomplished by disassembling the container proper from the aluminum base. The base and bearings should not be subjected to sterilizing temperatures. Care should be exercised when operating unit; since the load is light, operating speeds are higher than normal. It is suggested that the power switch be turned on and off several times to allow alignment of the drive coupling and dispersion of the load. Unbalance will cause vibration and loosening of the container from the base. Minor vibration can usually be dampened by placing your hand on the aluminum base for two or three seconds.

To disassemble container from the base for cleaning and sterilizing, remove cover. With wrench (part no. 046) on cap nut (part no. 070) and wrench (part no. 048) in shaft (part no. 508A), loosen and remove cap nut (part no. 070). This enables the rotating cutter sub-assembly (part no. 516A) and the shaft with drive coupling sub-assembly (part no. 508A) to be removed. Do not lose bearing washer (part no. 050) and bushing (part no. 512A), they may be lodged inside 516A assembly. Loosen and remove standpipe with 512A sub-assembly (part no. 514A) from threaded bushing in base, thus allowing disassembly of container assembly (part no. 504A) from base.

To assemble follow above directions in reverse. **Part no. 054 is not re-usable and will need to be replaced** (replacement part E8575.A.001 - Replacement PTFE container seal washer pkg of 6). Care should be taken to tighten standpipe sub-assembly (part no. 514A) carefully. Torque the blending assembly with 85inlbs (9.6Nm) to prevent leaking. After running once, check to see that it is tight.

### CARE:

Lubrication: Place several drops of light machine oil on the shafts occasionally or each time the unit is assembled after cleaning. The shaft assembly can be sterilized and if desired, sterile oil can be used.

To disassemble the bearing housing with bearings (part no. 506A) from base, loosen the two setscrews (part no. 062) in the base with Allen Wrench (part no. 042).

Cleaning Procedure: It is recommended that the container be thoroughly cleaned before initial use and after regular use in accordance with the following suggestions.

\*\*\*Note: Do not use cleaners that contain Chlorine\*\*\*

Regular cleaning with ordinary cleansers, such as mild soaps or detergents in water, is usually sufficient to quickly and easily remove dirt, grease, and other surface contaminants. For areas on which particles adhere, a number of non-gritty abrasives are available. These include whiting, powdered pumice and many stainless steel cleansing powders sold under trade names. These are generally best used in the form of a creamy water paste and should be thoroughly flushed from the surface immediately following the cleaning operation. *A final flushing with methanol is recommended to remove all traces of water.*

Areas, large or small, which have been allowed to become encrusted with tenacious surface contaminants, may require rubbing with steel wool in conjunction with one of the above materials. Stainless steel wool is recommended for this, since its residue particles will not rust as do ordinary steel wool.

Should this product become discolored by iron rust, no matter what the source, either of the following easy methods may be used to remove all traces and restore stainless surfaces.

1. Prepare a 15% to 20% (by volume) solution of nitric acid. Properly protect hands and person. Use only in a well ventilated room. Swab acid over surface, allowing it to remain until all rust is loosened (usually one to two minutes). Immediately flush surface with clean water until all acid is removed. Dry it thoroughly.
2. If preferred, a 2% to 5% (by volume) solution of warm oxalic acid may be used. The procedure is the same as above.

Note: When rubbing, polishing or buffing any polished stainless steel finish, either wet or dry, always use a motion parallel to the lines of the finish. This prevents marring of the surface.

## **E8575.00 MICRO CONTAINER**

### **REPLACEMENT PARTS LIST**

| <u>PartNo</u> | <u>DESCRIPTION</u>                                | <u>QTY.</u> |
|---------------|---|-------------|
| 5631          | WRENCH FOR #10 SET SCRE                           | 1           |
| 5664          | STUBBY SPINITE WRENCH SIZE 5/16                   | 1           |
| 5665          | Plastic Handle Driver, Jawco #H4, 1/4" Drive      | 1           |
| 7213.3        | 1/2 OD SOFT VITON O-RING, WHITE                   | 1           |
| 7215.1        | 1-1/2 OD BUNA-N O-RING                            | 1           |
| 8321.5        | #10-32 X 1/4" SET SCREW                           | 2           |
| 9200          | Acorn Cap Nut, Type 303 Stainless Steel, 6-32     | 1           |
| EP8575.004    | BASE  | 1           |
| EP8575.023    | BUSHING (ROTATING CUTTER TUBE)                    | 1           |
| EP8575.026    | SAMPLING PLUG                                     | 1           |
| EP8575.037    | COVER   | 1           |
| EP8575.050    | TEFLON BEARING WASHER                             | 1           |
| EP8575.054    | BOTTOM SEALING GASKET TEFLON                      | 1           |
| EP8575.504A   | CONTAINER   | 1           |
| EP8575.506A   | BEARING HOUSING WITH BEARING SUB ASSEMBLY         | 1           |
| EP8575.508A   | SHAFT WITH DRIVE COUPLING ASSEMBLY                | 1           |
| EP8575.512A   | WRENCH SUBASSEMBLY FOR STAND PIPE                 | 1           |
| EP8575.514A   | STAND PIPE ASSEMBLY                               | 1           |
| EP8575.516A   | ROTATING CUTTER SUB ASSEMBLY                      | 1           |
| E8575.A.001   | - REPLACEMENT PTFE CONTAINER SEAL WASHER PKG OF 6 |             |

NOTE: BE SURE TO SEND A COMPLETE SET OF WRENCHES WITH EACH UNIT PART 042, 046, 048 & 512A.

AFTER WATER TEST, RINSE WITH ALCOHOL AND DRY SPRAY INSIDE OF CUP AND CAP WITH NOX-AGE

DO NOT WATER TEST OVERNIGHT

CHECK THREADS

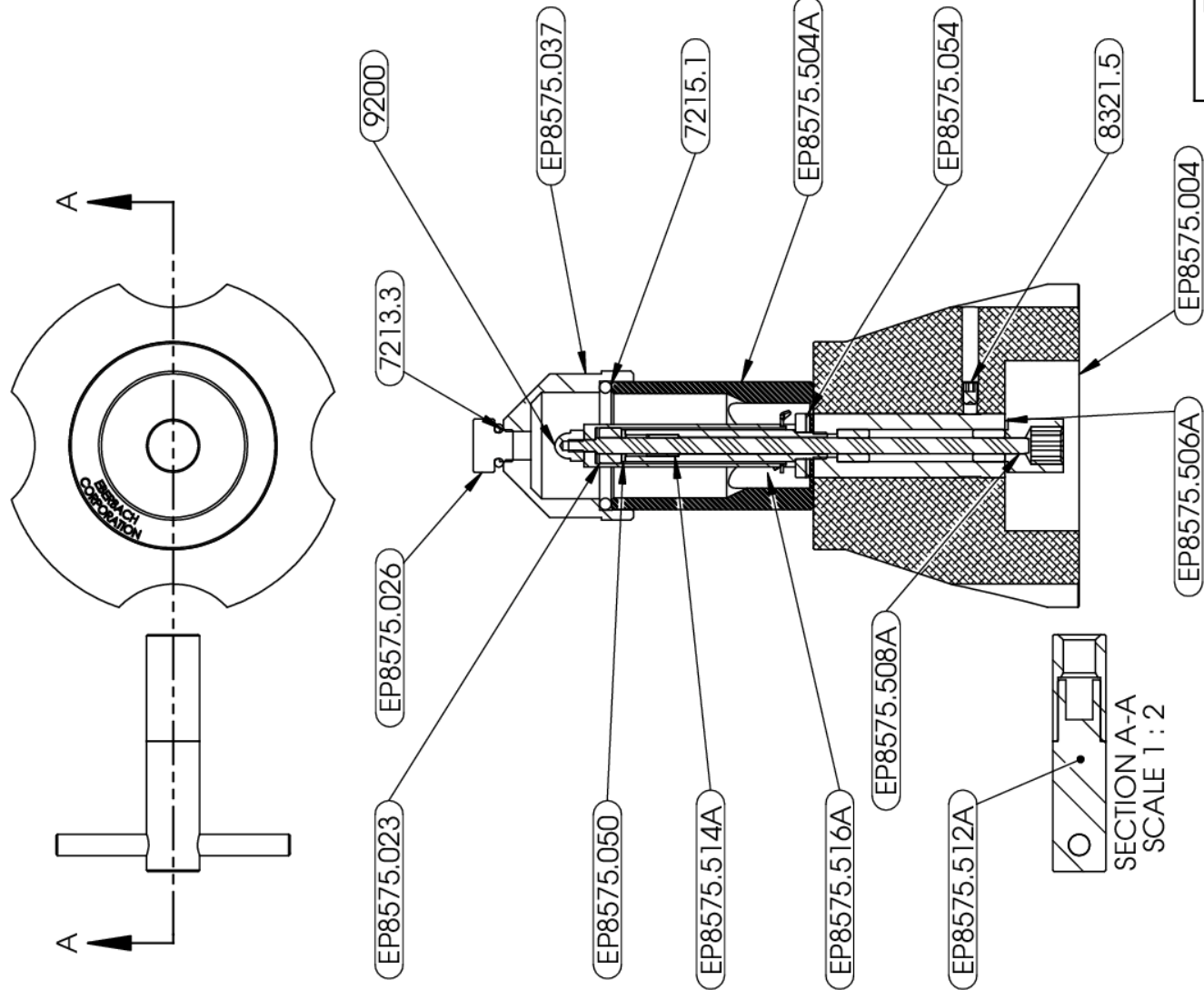

| Part No     | DESCRIPTION                                   | QTY. |
|-------------|---|------|
| 5631        | WRENCH FOR # 10 SET SCRE                      | 1    |
| 5664        | STUBBY SPINITE WRENCH SIZE 5/16               | 1    |
| 5666        | Plastic Handle Driver, Jawco #H4, 1/4" Drive  | 1    |
| 7213.3      | 1/2 OD SOFT VITON O-RING, WHITE               | 1    |
| 7215.1      | 1-1/2 OD BUNA-N O-RING                        | 1    |
| 8321.5      | # 10-32 X 1/4" SET SCREW                      | 2    |
| 9200        | Acorn Cap Nut, Type 303 Stainless Steel, 6-32 | 1    |
| EP8575.004  | BASE  | 1    |
| EP8575.023  | BUSHING (ROTATING CUTTER TUBE)                | 1    |
| EP8575.026  | SAMPLING PLUG                                 | 1    |
| EP8575.037  | COVER   | 1    |
| EP8575.050  | TEFLON BEARING WASHER                         | 1    |
| EP8575.054  | BOTTOM SEALING GASKET TEFLON                  | 1    |
| EP8575.504A | CONTAINER                                     | 1    |
| EP8575.506A | BEARING HOUSING WITH BEARING SUB ASSEMBLY     | 1    |
| EP8575.508A | SHAFT WITH DRIVE COUPLING ASSEMBLY            | 1    |
| EP8575.512A | WRENCH SUBASSEMBLY FOR STAND PIPE             | 1    |
| EP8575.514A | STAND PIPE ASSEMBLY                           | 1    |
| EP8575.516A | ROTATING CUTTER SUB ASSEMBLY                  | 1    |

EBERBACH CORPORATION U.S.A.

|   |           |                    |                |
|---|-----------|--------------------|----------------|
| DIMENSIONS ARE IN INCHES UNLESS OTHERWISE SPECIFIED |           | DRAWING SCALE: 1:2 |                |
| FRACTION  | DECIMAL   | ASSEMBLY           | DATE           |
| 1/16  | .0625     | 1:2                | 8/20/2013      |
| ANGLE   | XX # 01   | APPR               | DRW.           |
| + .5°   | XXX # 005 | S.B.               | DRW.           |
| 3RD ANGLE PROJ.                                     |           | WEIGHT             | 3.6lb          |
| MATERIAL  |           | PART NAME          | FINAL ASSEMBLY |
| STOCKING  |           | PART NO.           | E8575.00       |
|   |           | REV                | ERROR!         |

TORQUE TO 85 LBIN

Rev