



5900 Schooner Street – Belleville, MI 48111 – USA

TEL (800) 422-2558 – FAX (734) 665-9099

[www.Eberbachlabtools.com](http://www.Eberbachlabtools.com)

**E6155.00 Orbital Shaker**

Variable Speed with Timer and Tachometer

30-300 rpm, 115 V, 50/60 Hz

## **USE AND CARE FOR CATALOG NUMBER:**

- E6155.00 Orbital Shaker Power Unit  
Variable Speed 30-300 rpm with Timer and Tachometer  
115V 50/60Hz

## **GENERAL INFORMATION**

- Handle this unit with care. Unpack and check that the contents coincide with the packing-list. If any part is damaged or missing, please advise the distributor immediately.
- Do not install or use this equipment without first reading this manual.
- This manual should always be attached to the equipment and made available to all users.
- Immediately after reading this manual power on the machine to verify that it is working properly.
- If you have any doubts or inquiries, please contact your supplier or ***Eberbach Corporation*** technical service.

## OPERATION

The **Eberbach** orbital shaker catalog # **E6155.00** features:

- An Oriental 400W BLDC Motor Drive for long life and low maintenance.
- A digital tachometer and timer for simple and accurate use.
- Base designed to be moved with a narrow fork (21") forklift or pallet jack.
  
- A continuously variable speed range, adjustable between 30 and 300 rpm/min with stock orbit set to 2" (50.8mm). Also available in 1" (25.4mm) or 3" (76.2mm) orbits.
  
- See Load Graph on following page for recommended working load speeds.

**NOTE:** Due to the large inertia of the E6155 the machine may take as much as 45 seconds to completely accelerate or decelerate to its target speed.

**NOTE:** Do not overuse the EMERGENCY STOP button! Do not use the EMERGENCY STOP to stop the machine in normal conditions. Always turn off the power on the machine after the EMERGENCY STOP is pressed to reset motor and driver.

**WARNING:** Do not turn the POWER SWITCH off until machine has come to a complete stop! Doing so can damage the Motor and Gear Box.

See Graph Below For Maximum Load/Speed Recommendations Based on Orbit Diameter

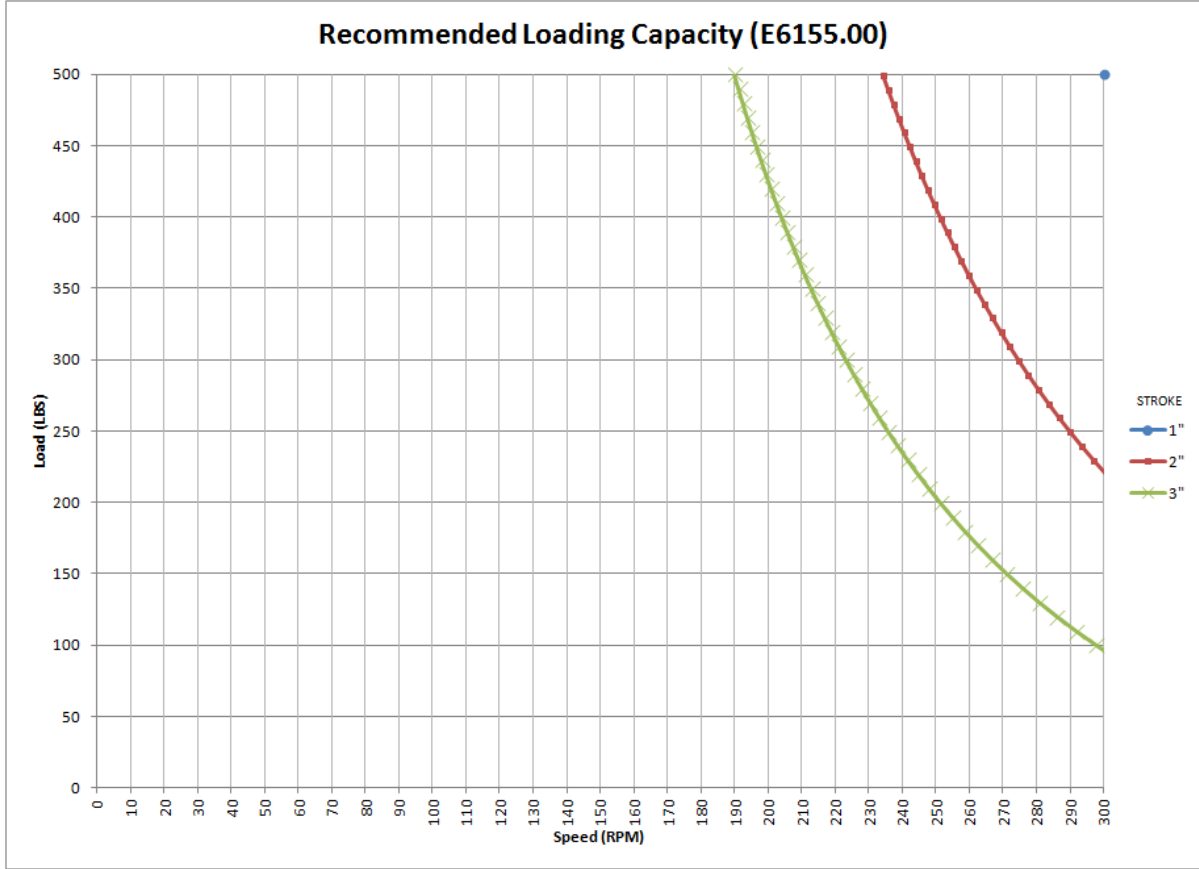

Contact **Eberbach Corporation Technical Support** for other stroke setting weight limits.

## FRONT PANEL DISPLAY

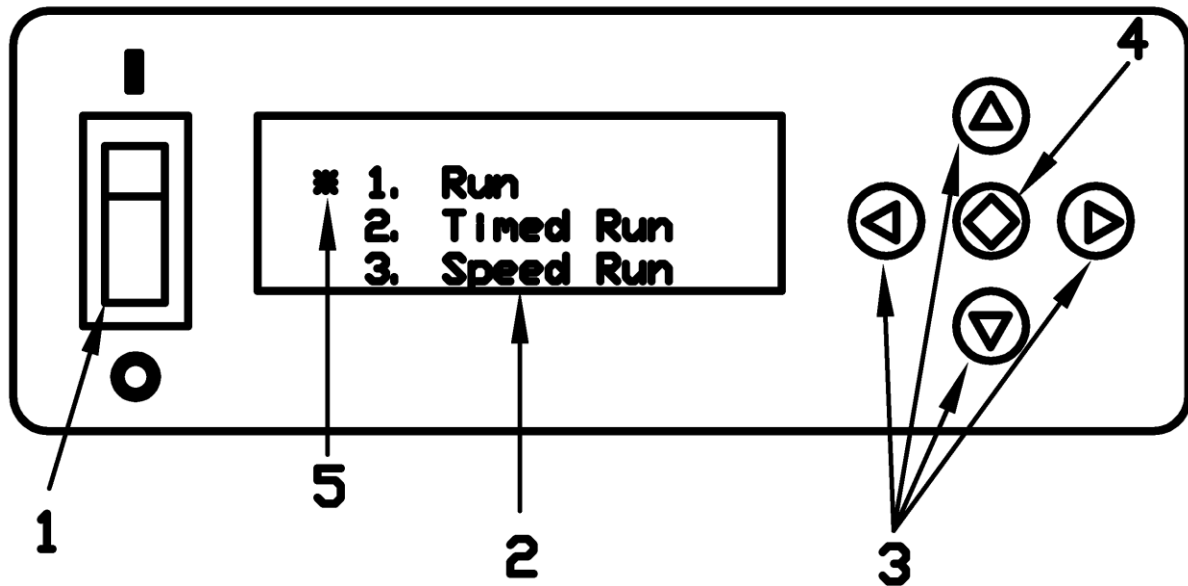

- 1) Power Switch
- 2) Liquid Crystal Display (LCD)
- 3) Directional Pad (D-Pad)
- 4) Enter Button
- 5) Cursor

**Operation:** Press the **Power Switch** down into the ON position. The **LCD** should light up and show the main menu. There are three different run modes to choose from. Select a run mode by moving the **Cursor** (using the **D-PAD**) and press the **Enter Button**.

**Run Mode:** The shaker will begin the run mode at its lowest speed. The speed shown in parenthesis (xxxx) is the set speed controlled by the user. The speed listed to the right is the tachometer read out or the actual speed of the shaker in real time. The speed can be increased/decreased by pressing and holding the up/down arrows on the **D-PAD**. The longer the button is held down the faster the speed will increase/decrease. Once engaged the timer will begin counting all the way up to 999 hours before the timer overflows back to zero. To pause the shaker move the **Cursor** to the PAUSE item by pressing the left arrow on the **D-PAD** and press the **Enter Button**. The clock will pause at its current time and the shaker will gradually come to a complete stop. The clock and shaker can be resumed at its current time and speed by selecting RESUME and pressing the Enter Button. To go back to the main menu move the **Cursor** to the EXIT item by pressing the right arrow on the **D-PAD** and then press the **Enter Button**.

RUN TIME	00: 00: 00
RPM	( 100) 100
* PAUSE	EXIT

RUN MENU

**Timed Run Mode:** The timed run mode features a count down timer that automatically shuts the shaker off when the time runs out. When selected the user will be taken to the Timed Run Setup Menu and will need to input the run time in hours, minutes, seconds and select the speed for the run. The left/right arrows on the **D-PAD** can be used to move the cursor between hours, minutes or seconds and the up and down arrows can be used to set the time. The longest run time allowed is 999:59:59. Once the time is set move the **Cursor** down by pressing the right arrow on the **D-PAD** until the **Cursor** is next to the RPM line item. The speed can be set using the up and down arrows on the **D-PAD**. Now that the data is set navigate the **Cursor** to the START line item using the left/right arrows on the **D-PAD** and press the **Enter Button**.

TIMED RUN SETUP		
RUN TIME HR: MN: SC		
* RPM		100
START		EXIT

TIMED RUN SETUP MENU

After selecting START the shaker will begin at the selected speed and the timer will begin counting down. The speed can be adjusted in real time using the up/down arrows on the **D-PAD**. The speed shown in parenthesis is the target speed controlled by the user and the speed listed to the right is the actual speed as read by the tachometer. The shaker and countdown timer can be paused and resumed. Move the **Cursor** to the line item PAUSE by pressing the left arrow on the **D-PAD** and then press the **Enter Button**. Exiting the Timed Run Menu will bring the user back to the Timed Run Setup Menu.

RUN TIME	999: 59: 59
RPM	( 100) 100
* PAUSE	EXIT

TIMED RUN MENU



**Speed Run Mode:** The speed run allows the user to program in a set run speed. Once engaged the timer will begin counting all the way up to 999 hours before the timer overflows back to zero. Select the speed run mode from the main menu and press the **Enter Button**. The user will be prompted with the speed run setup menu. Set the desired speed using the up/down arrows on the **D-PAD**. The left/right arrows can be used to move the **Cursor** between START and EXIT. EXIT will take the user back to the main menu. Keep the **Cursor** next to the START line item and press the **Enter Button**.

```
SPEED RUN SETUP

RPM                               100
* START                           EXIT
```

SPEED RUN SETUP MENU

The user will now be taken to the speed run menu. The shaker will begin at the speed selected in the setup menu. The speed run menu behaves in the same way as the run menu with one exception. Pressing EXIT will not take the user back to the main menu instead pressing EXIT will take the user back to the speed run setup menu.

```
RUN TIME 00: 00: 00
RPM      (< 100)    100
*PAUSE                               EXIT
```

SPEED RUN MENU

## **Error: No Tachometer**

If the Tachometer should fail your machine will shut down for safety reasons. This can also be caused by a stalled motor or unplugged Tachometer cable. The No Tachometer Error message will be flashed across the top line. It is possible to run the machine without a Tachometer although the accuracy of the speed may vary. To do this follow the prompt and select yes to run in open loop mode.

**Note:** All run menus will have two speeds listed. The leftmost speed will be displayed inside parenthesis. This is the target speed controlled by the user. The shaker will attempt to match this speed and should do so within ten seconds after making an adjustment. The rightmost speed is the tachometer reading, which shows the user what the shaker is actually running at. The tachometer reading will not necessarily match the target speed at all times, but is guaranteed to be within +/- 1% RPM.

**Note:** Reciprocating shakers will display OSC (oscillations) instead of RPM (revolutions per minute).

**Note:** Use slowest speed necessary to produce required shaking action.

***If you have any doubts or inquiries concerning operation contact your supplier or Eberbach Corporation technical service.***

**LOADING:**

It is impossible to outline the exact limitations for loading a shaker, as resulting shaking action is dependent upon several factors. Principal among these is the size and shape of the containers, speed, orbit radius, and the amount and type of material being shaken.

Basic considerations should be:

- Use lowest speed consistent with the required shaking action.
- At higher speed use less weight on platform.
- When using a tiered platform (one platform above the other), place equal load on each or, if possible, place heavier mass on lower platform and lighter on the top. If shaking action imparts a “whip” to the upper platform, then either the speed is too high or the load is too heavy on that platform.
- If shaker has tendency to “walk” on floor, then rubber feet should be secured to the floor using rubber or contact cement.

Good judgment in the selection of the factors will contribute to proper use of the shaker.

#### BELT INSPECTION:

Remove top plate and inspect belt annually and replace if actually broken or if the cords are exposed and frayed. In the case of a high duty cycle inspect every 6 months. Small outer fabric breaks are not harmful.

#### BELT REPLACEMENT AND ADJUSTMENT:

To replace belt, loosen motor mount screws and drop belt below both pulleys. Install new belt (Stock #4220) and tighten the motor screws but do not tighten belt to the point where the bearings will be overloaded. When belt is tight, the operator should be able to press lightly on the middle of the belt and cause it to bow in an amount equal to the width of the belt.

## REPLACEMENT PARTS LIST FOR E6155.00

PartNo	DESCRIPTION	QTY.
4220	BELT-A32	1
4400.6	1/4" X 1.0" KEY	1
4482.6	AK64X1" KEYED	1
6010.7	POWER SUPPLY, 5V 30W	1
6063	CABLE TIE, LOW PROFILE MOUNT	9
6063.2	ZIP TIE	13
6102	OVERLAY	1
6129	FUSE, 5AMP TIME DELAY	1
6131.1	FUSE HOLDER	1
6220	CABLE TIE HOLDER WITH ADHESIVE BACKED	3
6272	AC POWER INLET	1
6507.1	ROCKER SWITCH	1
6544.1	EMERGENCY STOP BUTTON	1
6544.5	EMERGENCY STOP SWITCH COVER	1
6558	TRANSFORMER	1
6649	CORD AND PLUG	1
6730	7 TERMINAL GROUNDING BLOCK	1
6851	DISPLAY BOARD	1
6855	USB BOARD	1
6999.2	MOTOR DRIVER	1
6999.4	MOTOR AND DRIVE CONNECTION CABLES	1
6999.5	REGENERATION UNIT	1
7397	#2-56 X 1/4" S/S PAN HD. MACHINE SCREW	1
7398	#2-56 X 5/16" S/S PAN HD. MACHINE SCREW	1
7568	#4-40 X 1/4" S/S PAN HD. MACHINE SCREW	4
7617	#6-32 X 1/2" S/S ROUND HD. MACHINE SCREW	2
8005	#8-32 X 1/2" FLAT HD. MACHINE SCREW	9
8050	#4-40 x 3/8" S/S PAN HD. MACHINE SCREW	4
8277.1	#8-32 X 1/2" S/S TRUST HD. SCREW	2
8285	#8-32 X 1/4" S/S TRUST HD. SCREW	55
8285.5	#8-32 X 3/8" 316 S/S TRUST HD. SCREW	4
8333	5/16"-18 X 1/4" SET SCREW	12
8507	1/4"-20 X 1/2" HEX HEAD SCREW	1

8509	1/4"-20 X 5/8" HEX HEAD SCREW	4
8533.6	1/4-20" X 2-3/4" HEX HEAD SCREW	1
8576	#4-40 X 3/8" S/S SOCKET HD. SCREW	2
8641	1/2"-13 X 2-1/4" SOCKET HD. SCREW	7
9206	#6-32 S/S NYLON LOCK NUT	2
9235	#8-32 S/S MACHINE SCREW NUT	2
9437	1/4 WASHER ZINC PLATED	1
9487	1/4" OVERSIZE WASHER	4
9531	1/4" SPLIT LOCK WASHER	2
CP6155.003.030	TOP PANEL SEAL	8
EP2500.026	SPACER FOR ROTATING TOP PLATE	2
EP6155.101	ECCENTRIC BLOCK	3
EP6155.201	ROUND SUPPORT	7
EP6155.220	TOP COVER	1
EP6155.221	RIGHT SIDE PANEL	1
EP6155.222	LEFT SIDE PANEL	1
EP6155.226	FRONT & BACK MOUNTING BRACKET	2
EP6155.227	SIDE MOUNTING BRACKET	2
EP6155.508A	FRONT PANEL ASSEMBLY	1
EP6155.509A	BACK PANEL ASSEMBLY	1
EP6155.530A	MOTOR ASSEMBLY	1
EP6155.541A	LOWER BEARING LADDER ASSEMBLY	1
EP6155.542A	UPPER BEARING LADDER ASSEMBLY	1
EP6155.545A	TACH WHEEL ASSEMBLY	1
EP6155.550A	BASE ASSEMBLY	1
EP6155.555A	MOUNTING FOOT ASSEMBLY	8
EP6155.652A	WIRING HARNESS	1
EP6155.SS.011	MOTOR DRIVER SPLASH GUARD	1
EP6155.SS.309	TACH BRACKET	1

Part No	DESCRIPTION	QTY.	JOB
4420	BELT-A32	1	EA
4400.6	1/4" X 1.0" KEY	1	EA
4482.6	AKG6X1" KEVED	1	EA
6010.7	POWER SUPPLY, 5Y-30H	1	EA
6063	CABLE TIE, LON PROFILE MOUNT	9	EA
6063.2	ZIP TIE	13	EA
6102	OVERLAY	1	EA
6129	FUSE, 5AMP TIME DELAY	1	EA
6131.1	FUSE HOLDER	3	EA
6272	CABLE TIE HOLDER WITH ADHESIVE BACKED	1	EA
6372	AC POWER INLET	1	EA
6507.1	ROCKER SWITCH	1	EA
6541.1	EMERGENCY STOP BUTTON	1	EA
6544.5	EMERGENCY STOP SWITCH COVER	1	EA
6558	TRANSFORMER	1	EA
6649	CORD AND PLUG	1	EA
6730	7 TERMINAL GROUNDING BLOCK	1	EA
6851	DISPLAY BOARD	1	EA
6855	USB BOARD	1	EA
6999.2	MOTOR DRIVER	1	EA
6999.4	MOTOR AND DRIVE CONNECTION CABLES	1	EA
6999.5	REGENERATION UNIT	1	EA
7397	#2-56 X 1/4" 5/5 PAIR HD. MACHINE SCREW	1	EA
7398	#2-56 X 5/16" 5/5 PAIR HD. MACHINE SCREW	1	EA
7568	#4-40 X 1/4" 5/5 PAIR HD. MACHINE SCREW	4	EA
7617	#6-32 X 1/2" 5/5 ROUND HD. MACHINE SCREW	2	EA
8005	#8-32 X 1/2" 5/5 FLAT HD. MACHINE SCREW	9	EA
8050	#4-40 X 3/8" 5/5 PAIR HD. MACHINE SCREW	4	EA
8277.1	#8-32 X 1/2" 5/5 TRUSS HD. SCREW	2	EA
8285	#8-32 X 3/8" 316 5/5 TRUSS HD. SCREW	55	EA
8333	5/16" -18 X 1/4" SET SCREW	12	EA
8507	1/4" -20 X 1/2" HEX HEAD SCREW	1	EA
8509	1/4" -20 X 5/8" HEX HEAD SCREW	4	EA
8576	1/4" -20" X 2-3/4" HEX HEAD SCREW	1	EA
8641	#4-40 X 3/8" 5/5 SOCKET HD. SCREW	2	EA
9206	#6-32 5/5 NYLON LOCK NUT	2	EA
9235	#8-32 5/5 MACHINE SCREW NUT	2	EA
9437	1/4 WASHER ZINC PLATED	1	EA
9487	1/4" OVERSIZE WASHER	4	EA
9531	1/4" SPLIT LOCK WASHER	4	EA
CP6155.003.030	TOP PANEL SEAL	8	EA
EP2500.026	SPACER FOR ROTATING TOP PLATE	2	EA
EP6155.101	ECCENTRIC BLOCK	3	EA
EP6155.201	ROUND SUPPORT	7	EA
EP6155.220	TOP COVER	1	EA
EP6155.221	RIGHT SIDE PANEL	1	EA
EP6155.222	LEFT SIDE PANEL	1	EA
EP6155.226	FRONT & BACK MOUNTING BRACKET	2	EA
EP6155.227	SIDE MOUNTING BRACKET	2	EA
EP6155.508A	FRONT PANEL ASSEMBLY	1	EA
EP6155.509A	BACK PANEL ASSEMBLY	1	EA
EP6155.530A	MOTOR ASSEMBLY	1	EA
EP6155.541A	LOWER BEARING LADDER ASSEMBLY	1	EA
EP6155.542A	UPPER BEARING LADDER ASSEMBLY	1	EA
EP6155.545A	TACH WHEEL ASSEMBLY	1	EA
EP6155.550A	BASE ASSEMBLY	1	EA
EP6155.555A	MOUNTING FOOT ASSEMBLY	8	EA
EP6155.657A	WIRING HARNESS	1	EA
EP6155.SS.011	MOTOR DRIVER SPLASH GUARD	1	EA
EP6155.SS.309	TACH BRACKET	1	EA

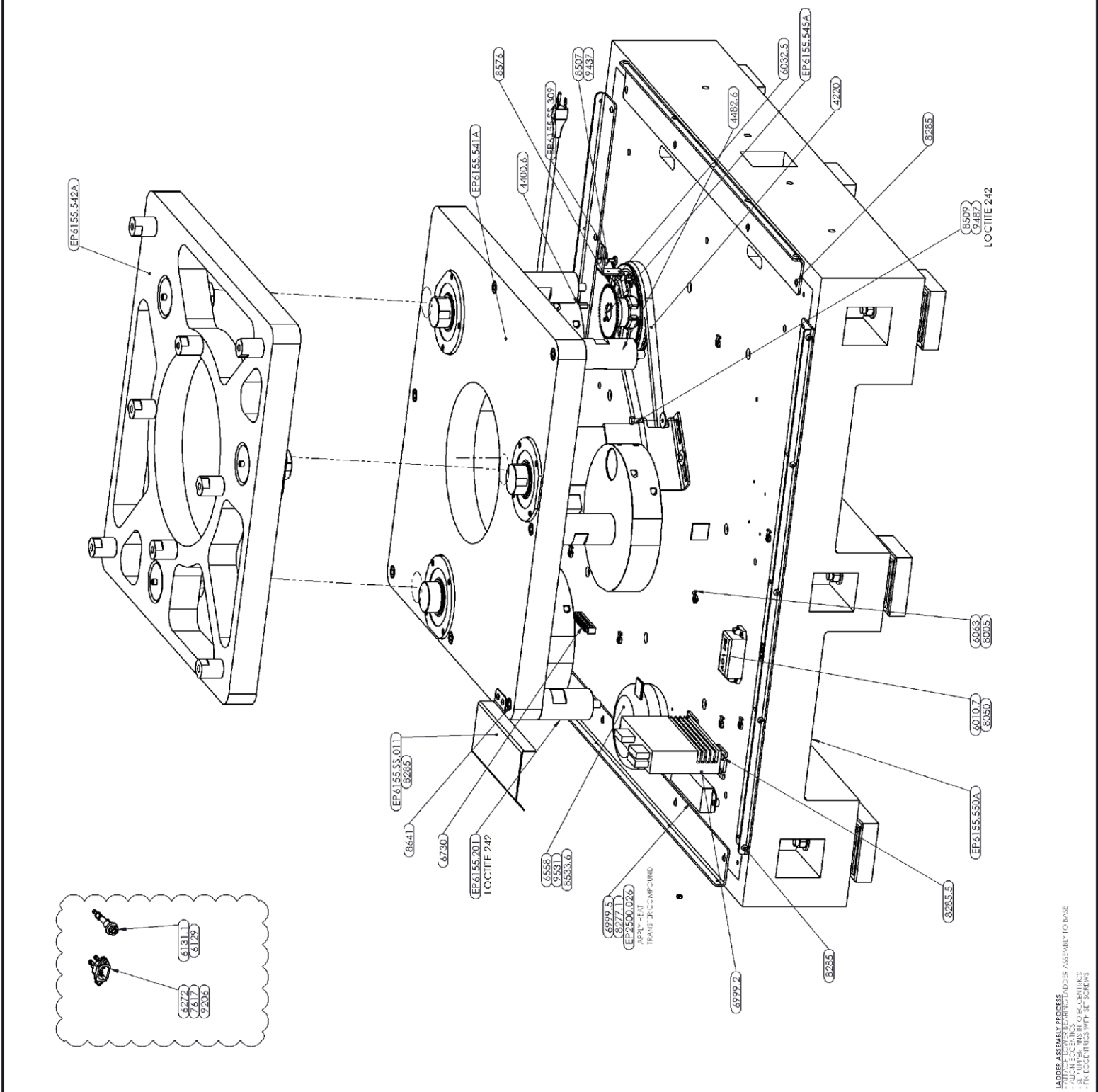

<b>ASSEMBLY PROCESS</b> 1. MOUNT LOWER BEARING LADDER ASSEMBLY TO BASE 2. MOUNT UPPER BEARING LADDER ASSEMBLY TO LOWER BEARING LADDER ASSEMBLY 3. MOUNT MOTOR DRIVER SPLASH GUARD TO MOTOR DRIVER ASSEMBLY 4. MOUNT TACH BRACKET TO TACH WHEEL ASSEMBLY 5. MOUNT MOTOR DRIVER ASSEMBLY TO MOTOR DRIVER SPLASH GUARD 6. MOUNT FRONT PANEL ASSEMBLY TO MOTOR DRIVER ASSEMBLY 7. MOUNT BACK PANEL ASSEMBLY TO MOTOR DRIVER ASSEMBLY 8. MOUNT TOP COVER TO MOTOR DRIVER ASSEMBLY 9. MOUNT SIDE PANELS TO MOTOR DRIVER ASSEMBLY 10. MOUNT FRONT & BACK MOUNTING BRACKET TO MOTOR DRIVER ASSEMBLY 11. MOUNT MOUNTING FEET ASSEMBLY TO MOTOR DRIVER ASSEMBLY 12. MOUNT BASE ASSEMBLY TO MOTOR DRIVER ASSEMBLY 13. MOUNT TACH WHEEL ASSEMBLY TO MOTOR DRIVER ASSEMBLY 14. MOUNT UPPER BEARING LADDER ASSEMBLY TO MOTOR DRIVER ASSEMBLY 15. MOUNT LOWER BEARING LADDER ASSEMBLY TO MOTOR DRIVER ASSEMBLY 16. MOUNT MOTOR ASSEMBLY TO MOTOR DRIVER ASSEMBLY 17. MOUNT MOTOR DRIVER SPLASH GUARD TO MOTOR DRIVER ASSEMBLY 18. MOUNT FRONT PANEL ASSEMBLY TO MOTOR DRIVER ASSEMBLY 19. MOUNT BACK PANEL ASSEMBLY TO MOTOR DRIVER ASSEMBLY 20. MOUNT TOP COVER TO MOTOR DRIVER ASSEMBLY 21. MOUNT SIDE PANELS TO MOTOR DRIVER ASSEMBLY 22. MOUNT FRONT & BACK MOUNTING BRACKET TO MOTOR DRIVER ASSEMBLY 23. MOUNT MOUNTING FEET ASSEMBLY TO MOTOR DRIVER ASSEMBLY 24. MOUNT BASE ASSEMBLY TO MOTOR DRIVER ASSEMBLY 25. MOUNT TACH WHEEL ASSEMBLY TO MOTOR DRIVER ASSEMBLY 26. MOUNT UPPER BEARING LADDER ASSEMBLY TO MOTOR DRIVER ASSEMBLY 27. MOUNT LOWER BEARING LADDER ASSEMBLY TO MOTOR DRIVER ASSEMBLY 28. MOUNT MOTOR ASSEMBLY TO MOTOR DRIVER ASSEMBLY 29. MOUNT MOTOR DRIVER SPLASH GUARD TO MOTOR DRIVER ASSEMBLY 30. MOUNT FRONT PANEL ASSEMBLY TO MOTOR DRIVER ASSEMBLY 31. MOUNT BACK PANEL ASSEMBLY TO MOTOR DRIVER ASSEMBLY 32. MOUNT TOP COVER TO MOTOR DRIVER ASSEMBLY 33. MOUNT SIDE PANELS TO MOTOR DRIVER ASSEMBLY 34. MOUNT FRONT & BACK MOUNTING BRACKET TO MOTOR DRIVER ASSEMBLY 35. MOUNT MOUNTING FEET ASSEMBLY TO MOTOR DRIVER ASSEMBLY 36. MOUNT BASE ASSEMBLY TO MOTOR DRIVER ASSEMBLY 37. MOUNT TACH WHEEL ASSEMBLY TO MOTOR DRIVER ASSEMBLY 38. MOUNT UPPER BEARING LADDER ASSEMBLY TO MOTOR DRIVER ASSEMBLY 39. MOUNT LOWER BEARING LADDER ASSEMBLY TO MOTOR DRIVER ASSEMBLY 40. MOUNT MOTOR ASSEMBLY TO MOTOR DRIVER ASSEMBLY 41. MOUNT MOTOR DRIVER SPLASH GUARD TO MOTOR DRIVER ASSEMBLY 42. MOUNT FRONT PANEL ASSEMBLY TO MOTOR DRIVER ASSEMBLY 43. MOUNT BACK PANEL ASSEMBLY TO MOTOR DRIVER ASSEMBLY 44. MOUNT TOP COVER TO MOTOR DRIVER ASSEMBLY 45. MOUNT SIDE PANELS TO MOTOR DRIVER ASSEMBLY 46. MOUNT FRONT & BACK MOUNTING BRACKET TO MOTOR DRIVER ASSEMBLY 47. MOUNT MOUNTING FEET ASSEMBLY TO MOTOR DRIVER ASSEMBLY 48. MOUNT BASE ASSEMBLY TO MOTOR DRIVER ASSEMBLY 49. MOUNT TACH WHEEL ASSEMBLY TO MOTOR DRIVER ASSEMBLY 50. MOUNT UPPER BEARING LADDER ASSEMBLY TO MOTOR DRIVER ASSEMBLY 51. MOUNT LOWER BEARING LADDER ASSEMBLY TO MOTOR DRIVER ASSEMBLY 52. MOUNT MOTOR ASSEMBLY TO MOTOR DRIVER ASSEMBLY 53. MOUNT MOTOR DRIVER SPLASH GUARD TO MOTOR DRIVER ASSEMBLY 54. MOUNT FRONT PANEL ASSEMBLY TO MOTOR DRIVER ASSEMBLY 55. MOUNT BACK PANEL ASSEMBLY TO MOTOR DRIVER ASSEMBLY 56. MOUNT TOP COVER TO MOTOR DRIVER ASSEMBLY 57. MOUNT SIDE PANELS TO MOTOR DRIVER ASSEMBLY 58. MOUNT FRONT & BACK MOUNTING BRACKET TO MOTOR DRIVER ASSEMBLY 59. MOUNT MOUNTING FEET ASSEMBLY TO MOTOR DRIVER ASSEMBLY 60. MOUNT BASE ASSEMBLY TO MOTOR DRIVER ASSEMBLY 61. MOUNT TACH WHEEL ASSEMBLY TO MOTOR DRIVER ASSEMBLY 62. MOUNT UPPER BEARING LADDER ASSEMBLY TO MOTOR DRIVER ASSEMBLY 63. MOUNT LOWER BEARING LADDER ASSEMBLY TO MOTOR DRIVER ASSEMBLY 64. MOUNT MOTOR ASSEMBLY TO MOTOR DRIVER ASSEMBLY 65. MOUNT MOTOR DRIVER SPLASH GUARD TO MOTOR DRIVER ASSEMBLY 66. MOUNT FRONT PANEL ASSEMBLY TO MOTOR DRIVER ASSEMBLY 67. MOUNT BACK PANEL ASSEMBLY TO MOTOR DRIVER ASSEMBLY 68. MOUNT TOP COVER TO MOTOR DRIVER ASSEMBLY 69. MOUNT SIDE PANELS TO MOTOR DRIVER ASSEMBLY 70. MOUNT FRONT & BACK MOUNTING BRACKET TO MOTOR DRIVER ASSEMBLY 71. MOUNT MOUNTING FEET ASSEMBLY TO MOTOR DRIVER ASSEMBLY 72. MOUNT BASE ASSEMBLY TO MOTOR DRIVER ASSEMBLY 73. MOUNT TACH WHEEL ASSEMBLY TO MOTOR DRIVER ASSEMBLY 74. MOUNT UPPER BEARING LADDER ASSEMBLY TO MOTOR DRIVER ASSEMBLY 75. MOUNT LOWER BEARING LADDER ASSEMBLY TO MOTOR DRIVER ASSEMBLY 76. MOUNT MOTOR ASSEMBLY TO MOTOR DRIVER ASSEMBLY 77. MOUNT MOTOR DRIVER SPLASH GUARD TO MOTOR DRIVER ASSEMBLY 78. MOUNT FRONT PANEL ASSEMBLY TO MOTOR DRIVER ASSEMBLY 79. MOUNT BACK PANEL ASSEMBLY TO MOTOR DRIVER ASSEMBLY 80. MOUNT TOP COVER TO MOTOR DRIVER ASSEMBLY 81. MOUNT SIDE PANELS TO MOTOR DRIVER ASSEMBLY 82. MOUNT FRONT & BACK MOUNTING BRACKET TO MOTOR DRIVER ASSEMBLY 83. MOUNT MOUNTING FEET ASSEMBLY TO MOTOR DRIVER ASSEMBLY 84. MOUNT BASE ASSEMBLY TO MOTOR DRIVER ASSEMBLY 85. MOUNT TACH WHEEL ASSEMBLY TO MOTOR DRIVER ASSEMBLY 86. MOUNT UPPER BEARING LADDER ASSEMBLY TO MOTOR DRIVER ASSEMBLY 87. MOUNT LOWER BEARING LADDER ASSEMBLY TO MOTOR DRIVER ASSEMBLY 88. MOUNT MOTOR ASSEMBLY TO MOTOR DRIVER ASSEMBLY 89. MOUNT MOTOR DRIVER SPLASH GUARD TO MOTOR DRIVER ASSEMBLY 90. MOUNT FRONT PANEL ASSEMBLY TO MOTOR DRIVER ASSEMBLY 91. MOUNT BACK PANEL ASSEMBLY TO MOTOR DRIVER ASSEMBLY 92. MOUNT TOP COVER TO MOTOR DRIVER ASSEMBLY 93. MOUNT SIDE PANELS TO MOTOR DRIVER ASSEMBLY 94. MOUNT FRONT & BACK MOUNTING BRACKET TO MOTOR DRIVER ASSEMBLY 95. MOUNT MOUNTING FEET ASSEMBLY TO MOTOR DRIVER ASSEMBLY 96. MOUNT BASE ASSEMBLY TO MOTOR DRIVER ASSEMBLY 97. MOUNT TACH WHEEL ASSEMBLY TO MOTOR DRIVER ASSEMBLY 98. MOUNT UPPER BEARING LADDER ASSEMBLY TO MOTOR DRIVER ASSEMBLY 99. MOUNT LOWER BEARING LADDER ASSEMBLY TO MOTOR DRIVER ASSEMBLY 100. MOUNT MOTOR ASSEMBLY TO MOTOR DRIVER ASSEMBLY 101. MOUNT MOTOR DRIVER SPLASH GUARD TO MOTOR DRIVER ASSEMBLY 102. MOUNT FRONT PANEL ASSEMBLY TO MOTOR DRIVER ASSEMBLY 103. MOUNT BACK PANEL ASSEMBLY TO MOTOR DRIVER ASSEMBLY 104. MOUNT TOP COVER TO MOTOR DRIVER ASSEMBLY 105. MOUNT SIDE PANELS TO MOTOR DRIVER ASSEMBLY 106. MOUNT FRONT & BACK MOUNTING BRACKET TO MOTOR DRIVER ASSEMBLY 107. MOUNT MOUNTING FEET ASSEMBLY TO MOTOR DRIVER ASSEMBLY 108. MOUNT BASE ASSEMBLY TO MOTOR DRIVER ASSEMBLY 109. MOUNT TACH WHEEL ASSEMBLY TO MOTOR DRIVER ASSEMBLY 110. MOUNT UPPER BEARING LADDER ASSEMBLY TO MOTOR DRIVER ASSEMBLY 111. MOUNT LOWER BEARING LADDER ASSEMBLY TO MOTOR DRIVER ASSEMBLY 112. MOUNT MOTOR ASSEMBLY TO MOTOR DRIVER ASSEMBLY 113. MOUNT MOTOR DRIVER SPLASH GUARD TO MOTOR DRIVER ASSEMBLY 114. MOUNT FRONT PANEL ASSEMBLY TO MOTOR DRIVER ASSEMBLY 115. MOUNT BACK PANEL ASSEMBLY TO MOTOR DRIVER ASSEMBLY 116. MOUNT TOP COVER TO MOTOR DRIVER ASSEMBLY 117. MOUNT SIDE PANELS TO MOTOR DRIVER ASSEMBLY 118. MOUNT FRONT & BACK MOUNTING BRACKET TO MOTOR DRIVER ASSEMBLY 119. MOUNT MOUNTING FEET ASSEMBLY TO MOTOR DRIVER ASSEMBLY 120. MOUNT BASE ASSEMBLY TO MOTOR DRIVER ASSEMBLY 121. MOUNT TACH WHEEL ASSEMBLY TO MOTOR DRIVER ASSEMBLY 122. MOUNT UPPER BEARING LADDER ASSEMBLY TO MOTOR DRIVER ASSEMBLY 123. MOUNT LOWER BEARING LADDER ASSEMBLY TO MOTOR DRIVER ASSEMBLY 124. MOUNT MOTOR ASSEMBLY TO MOTOR DRIVER ASSEMBLY 125. MOUNT MOTOR DRIVER SPLASH GUARD TO MOTOR DRIVER ASSEMBLY 126. MOUNT FRONT PANEL ASSEMBLY TO MOTOR DRIVER ASSEMBLY 127. MOUNT BACK PANEL ASSEMBLY TO MOTOR DRIVER ASSEMBLY 128. MOUNT TOP COVER TO MOTOR DRIVER ASSEMBLY 129. MOUNT SIDE PANELS TO MOTOR DRIVER ASSEMBLY 130. MOUNT FRONT & BACK MOUNTING BRACKET TO MOTOR DRIVER ASSEMBLY 131. MOUNT MOUNTING FEET ASSEMBLY TO MOTOR DRIVER ASSEMBLY 132. MOUNT BASE ASSEMBLY TO MOTOR DRIVER ASSEMBLY 133. MOUNT TACH WHEEL ASSEMBLY TO MOTOR DRIVER ASSEMBLY 134. MOUNT UPPER BEARING LADDER ASSEMBLY TO MOTOR DRIVER ASSEMBLY 135. MOUNT LOWER BEARING LADDER ASSEMBLY TO MOTOR DRIVER ASSEMBLY 136. MOUNT MOTOR ASSEMBLY TO MOTOR DRIVER ASSEMBLY 137. MOUNT MOTOR DRIVER SPLASH GUARD TO MOTOR DRIVER ASSEMBLY 138. MOUNT FRONT PANEL ASSEMBLY TO MOTOR DRIVER ASSEMBLY 139. MOUNT BACK PANEL ASSEMBLY TO MOTOR DRIVER ASSEMBLY 140. MOUNT TOP COVER TO MOTOR DRIVER ASSEMBLY 141. MOUNT SIDE PANELS TO MOTOR DRIVER ASSEMBLY 142. MOUNT FRONT & BACK MOUNTING BRACKET TO MOTOR DRIVER ASSEMBLY 143. MOUNT MOUNTING FEET ASSEMBLY TO MOTOR DRIVER ASSEMBLY 144. MOUNT BASE ASSEMBLY TO MOTOR DRIVER ASSEMBLY 145. MOUNT TACH WHEEL ASSEMBLY TO MOTOR DRIVER ASSEMBLY 146. MOUNT UPPER BEARING LADDER ASSEMBLY TO MOTOR DRIVER ASSEMBLY 147. MOUNT LOWER BEARING LADDER ASSEMBLY TO MOTOR DRIVER ASSEMBLY 148. MOUNT MOTOR ASSEMBLY TO MOTOR DRIVER ASSEMBLY 149. MOUNT MOTOR DRIVER SPLASH GUARD TO MOTOR DRIVER ASSEMBLY 150. MOUNT FRONT PANEL ASSEMBLY TO MOTOR DRIVER ASSEMBLY 151. MOUNT BACK PANEL ASSEMBLY TO MOTOR DRIVER ASSEMBLY 152. MOUNT TOP COVER TO MOTOR DRIVER ASSEMBLY 153. MOUNT SIDE PANELS TO MOTOR DRIVER ASSEMBLY 154. MOUNT FRONT & BACK MOUNTING BRACKET TO MOTOR DRIVER ASSEMBLY 155. MOUNT MOUNTING FEET ASSEMBLY TO MOTOR DRIVER ASSEMBLY 156. MOUNT BASE ASSEMBLY TO MOTOR DRIVER ASSEMBLY 157. MOUNT TACH WHEEL ASSEMBLY TO MOTOR DRIVER ASSEMBLY 158. MOUNT UPPER BEARING LADDER ASSEMBLY TO MOTOR DRIVER ASSEMBLY 159. MOUNT LOWER BEARING LADDER ASSEMBLY TO MOTOR DRIVER ASSEMBLY 160. MOUNT MOTOR ASSEMBLY TO MOTOR DRIVER ASSEMBLY 161. MOUNT MOTOR DRIVER SPLASH GUARD TO MOTOR DRIVER ASSEMBLY 162. MOUNT FRONT PANEL ASSEMBLY TO MOTOR DRIVER ASSEMBLY 163. MOUNT BACK PANEL ASSEMBLY TO MOTOR DRIVER ASSEMBLY 164. MOUNT TOP COVER TO MOTOR DRIVER ASSEMBLY 165. MOUNT SIDE PANELS TO MOTOR DRIVER ASSEMBLY 166. MOUNT FRONT & BACK MOUNTING BRACKET TO MOTOR DRIVER ASSEMBLY 167. MOUNT MOUNTING FEET ASSEMBLY TO MOTOR DRIVER ASSEMBLY 168. MOUNT BASE ASSEMBLY TO MOTOR DRIVER ASSEMBLY 169. MOUNT TACH WHEEL ASSEMBLY TO MOTOR DRIVER ASSEMBLY 170. MOUNT UPPER BEARING LADDER ASSEMBLY TO MOTOR DRIVER ASSEMBLY 171. MOUNT LOWER BEARING LADDER ASSEMBLY TO MOTOR DRIVER ASSEMBLY 172. MOUNT MOTOR ASSEMBLY TO MOTOR DRIVER ASSEMBLY 173. MOUNT MOTOR DRIVER SPLASH GUARD TO MOTOR DRIVER ASSEMBLY 174. MOUNT FRONT PANEL ASSEMBLY TO MOTOR DRIVER ASSEMBLY 175. MOUNT BACK PANEL ASSEMBLY TO MOTOR DRIVER ASSEMBLY 176. MOUNT TOP COVER TO MOTOR DRIVER ASSEMBLY 177. MOUNT SIDE PANELS TO MOTOR DRIVER ASSEMBLY 178. MOUNT FRONT & BACK MOUNTING BRACKET TO MOTOR DRIVER ASSEMBLY 179. MOUNT MOUNTING FEET ASSEMBLY TO MOTOR DRIVER ASSEMBLY 180. MOUNT BASE ASSEMBLY TO MOTOR DRIVER ASSEMBLY 181. MOUNT TACH WHEEL ASSEMBLY TO MOTOR DRIVER ASSEMBLY 182. MOUNT UPPER BEARING LADDER ASSEMBLY TO MOTOR DRIVER ASSEMBLY 183. MOUNT LOWER BEARING LADDER ASSEMBLY TO MOTOR DRIVER ASSEMBLY 184. MOUNT MOTOR ASSEMBLY TO MOTOR DRIVER ASSEMBLY 185. MOUNT MOTOR DRIVER SPLASH GUARD TO MOTOR DRIVER ASSEMBLY 186. MOUNT FRONT PANEL ASSEMBLY TO MOTOR DRIVER ASSEMBLY 187. MOUNT BACK PANEL ASSEMBLY TO MOTOR DRIVER ASSEMBLY 188. MOUNT TOP COVER TO MOTOR DRIVER ASSEMBLY 189. MOUNT SIDE PANELS TO MOTOR DRIVER ASSEMBLY 190. MOUNT FRONT & BACK MOUNTING BRACKET TO MOTOR DRIVER ASSEMBLY 191. MOUNT MOUNTING FEET ASSEMBLY TO MOTOR DRIVER ASSEMBLY 192. MOUNT BASE ASSEMBLY TO MOTOR DRIVER ASSEMBLY 193. MOUNT TACH WHEEL ASSEMBLY TO MOTOR DRIVER ASSEMBLY 194. MOUNT UPPER BEARING LADDER ASSEMBLY TO MOTOR DRIVER ASSEMBLY 195. MOUNT LOWER BEARING LADDER ASSEMBLY TO MOTOR DRIVER ASSEMBLY 196. MOUNT MOTOR ASSEMBLY TO MOTOR DRIVER ASSEMBLY 197. MOUNT MOTOR DRIVER SPLASH GUARD TO MOTOR DRIVER ASSEMBLY 198. MOUNT FRONT PANEL ASSEMBLY TO MOTOR DRIVER ASSEMBLY 199. MOUNT BACK PANEL ASSEMBLY TO MOTOR DRIVER ASSEMBLY 200. MOUNT TOP COVER TO MOTOR DRIVER ASSEMBLY 201. MOUNT SIDE PANELS TO MOTOR DRIVER ASSEMBLY 202. MOUNT FRONT & BACK MOUNTING BRACKET TO MOTOR DRIVER ASSEMBLY 203. MOUNT MOUNTING FEET ASSEMBLY TO MOTOR DRIVER ASSEMBLY 204. MOUNT BASE ASSEMBLY TO MOTOR DRIVER ASSEMBLY 205. MOUNT TACH WHEEL ASSEMBLY TO MOTOR DRIVER ASSEMBLY 206. MOUNT UPPER BEARING LADDER ASSEMBLY TO MOTOR DRIVER ASSEMBLY 207. MOUNT LOWER BEARING LADDER ASSEMBLY TO MOTOR DRIVER ASSEMBLY 208. MOUNT MOTOR ASSEMBLY TO MOTOR DRIVER ASSEMBLY 209. MOUNT MOTOR DRIVER SPLASH GUARD TO MOTOR DRIVER ASSEMBLY 210. MOUNT FRONT PANEL ASSEMBLY TO MOTOR DRIVER ASSEMBLY 211. MOUNT BACK PANEL ASSEMBLY TO MOTOR DRIVER ASSEMBLY 212. MOUNT TOP COVER TO MOTOR DRIVER ASSEMBLY 213. MOUNT SIDE PANELS TO MOTOR DRIVER ASSEMBLY 214. MOUNT FRONT & BACK MOUNTING BRACKET TO MOTOR DRIVER ASSEMBLY 215. MOUNT MOUNTING FEET ASSEMBLY TO MOTOR DRIVER ASSEMBLY 216. MOUNT BASE ASSEMBLY TO MOTOR DRIVER ASSEMBLY 217. MOUNT TACH WHEEL ASSEMBLY TO MOTOR DRIVER ASSEMBLY 218. MOUNT UPPER BEARING LADDER ASSEMBLY TO MOTOR DRIVER ASSEMBLY 219. MOUNT LOWER BEARING LADDER ASSEMBLY TO MOTOR DRIVER ASSEMBLY 220. MOUNT MOTOR ASSEMBLY TO MOTOR DRIVER ASSEMBLY 221. MOUNT MOTOR DRIVER SPLASH GUARD TO MOTOR DRIVER ASSEMBLY 222. MOUNT FRONT PANEL ASSEMBLY TO MOTOR DRIVER ASSEMBLY 223. MOUNT BACK PANEL ASSEMBLY TO MOTOR DRIVER ASSEMBLY 224. MOUNT TOP COVER TO MOTOR DRIVER ASSEMBLY 225. MOUNT SIDE PANELS TO MOTOR DRIVER ASSEMBLY 226. MOUNT FRONT & BACK MOUNTING BRACKET TO MOTOR DRIVER ASSEMBLY 227. MOUNT MOUNTING FEET ASSEMBLY TO MOTOR DRIVER ASSEMBLY 228. MOUNT BASE ASSEMBLY TO MOTOR DRIVER ASSEMBLY 229. MOUNT TACH WHEEL ASSEMBLY TO MOTOR DRIVER ASSEMBLY 230. MOUNT UPPER BEARING LADDER ASSEMBLY TO MOTOR DRIVER ASSEMBLY 231. MOUNT LOWER BEARING LADDER ASSEMBLY TO MOTOR DRIVER ASSEMBLY 232. MOUNT MOTOR ASSEMBLY TO MOTOR DRIVER ASSEMBLY 233. MOUNT MOTOR DRIVER SPLASH GUARD TO MOTOR DRIVER ASSEMBLY 234. MOUNT FRONT PANEL ASSEMBLY TO MOTOR DRIVER ASSEMBLY 235. MOUNT BACK PANEL ASSEMBLY TO MOTOR DRIVER ASSEMBLY 236. MOUNT TOP COVER TO MOTOR DRIVER ASSEMBLY 237. MOUNT SIDE PANELS TO MOTOR DRIVER ASSEMBLY 238. MOUNT FRONT & BACK MOUNTING BRACKET TO MOTOR DRIVER ASSEMBLY 239. MOUNT MOUNTING FEET ASSEMBLY TO MOTOR DRIVER ASSEMBLY 240. MOUNT BASE ASSEMBLY TO MOTOR DRIVER ASSEMBLY 241. MOUNT TACH WHEEL ASSEMBLY TO MOTOR DRIVER ASSEMBLY 242. MOUNT UPPER BEARING LADDER ASSEMBLY TO MOTOR DRIVER ASSEMBLY 243. MOUNT LOWER BEARING LADDER ASSEMBLY TO MOTOR DRIVER ASSEMBLY 244. MOUNT MOTOR ASSEMBLY TO MOTOR DRIVER ASSEMBLY 245. MOUNT MOTOR DRIVER SPLASH GUARD TO MOTOR DRIVER ASSEMBLY 246. MOUNT FRONT PANEL ASSEMBLY TO MOTOR DRIVER ASSEMBLY 247. MOUNT BACK PANEL ASSEMBLY TO MOTOR DRIVER ASSEMBLY 248. MOUNT TOP COVER TO MOTOR DRIVER ASSEMBLY 249. MOUNT SIDE PANELS TO MOTOR DRIVER ASSEMBLY 250. MOUNT FRONT & BACK MOUNTING BRACKET TO MOTOR DRIVER ASSEMBLY 251. MOUNT MOUNTING FEET ASSEMBLY TO MOTOR DRIVER ASSEMBLY 252. MOUNT BASE ASSEMBLY TO MOTOR DRIVER ASSEMBLY 253. MOUNT TACH WHEEL ASSEMBLY TO MOTOR DRIVER ASSEMBLY 254. MOUNT UPPER BEARING LADDER ASSEMBLY TO MOTOR DRIVER ASSEMBLY 255. MOUNT LOWER BEARING LADDER ASSEMBLY TO MOTOR DRIVER ASSEMBLY 256. MOUNT MOTOR ASSEMBLY TO MOTOR DRIVER ASSEMBLY 257. MOUNT MOTOR DRIVER SPLASH GUARD TO MOTOR DRIVER ASSEMBLY 258. MOUNT FRONT PANEL ASSEMBLY TO MOTOR DRIVER ASSEMBLY 259. MOUNT BACK PANEL ASSEMBLY TO MOTOR DRIVER ASSEMBLY 260. MOUNT TOP COVER TO MOTOR DRIVER ASSEMBLY 261. MOUNT SIDE PANELS TO MOTOR DRIVER ASSEMBLY 262. MOUNT FRONT & BACK MOUNTING BRACKET TO MOTOR DRIVER ASSEMBLY 263. MOUNT MOUNTING FEET ASSEMBLY TO MOTOR DRIVER ASSEMBLY 264. MOUNT BASE ASSEMBLY TO MOTOR DRIVER ASSEMBLY 265. MOUNT TACH WHEEL ASSEMBLY TO MOTOR DRIVER ASSEMBLY 266. MOUNT UPPER BEARING LADDER ASSEMBLY TO MOTOR DRIVER ASSEMBLY 267. MOUNT LOWER BEARING LADDER ASSEMBLY TO MOTOR DRIVER ASSEMBLY 268. MOUNT MOTOR ASSEMBLY TO MOTOR DRIVER ASSEMBLY 269. MOUNT MOTOR DRIVER SPLASH GUARD TO MOTOR DRIVER ASSEMBLY 270. MOUNT FRONT PANEL ASSEMBLY TO MOTOR DRIVER ASSEMBLY 271. MOUNT BACK PANEL ASSEMBLY TO MOTOR DRIVER ASSEMBLY 272. MOUNT TOP COVER TO MOTOR DRIVER ASSEMBLY 273. MOUNT SIDE PANELS TO MOTOR DRIVER ASSEMBLY 274. MOUNT FRONT & BACK MOUNTING BRACKET TO MOTOR DRIVER ASSEMBLY 275. MOUNT MOUNTING FEET ASSEMBLY TO MOTOR DRIVER ASSEMBLY 276. MOUNT BASE ASSEMBLY TO MOTOR DRIVER ASSEMBLY 277. MOUNT TACH WHEEL ASSEMBLY TO MOTOR DRIVER ASSEMBLY 278. MOUNT UPPER BEARING LADDER ASSEMBLY TO MOTOR DRIVER ASSEMBLY 279. MOUNT LOWER BEARING LADDER ASSEMBLY TO MOTOR DRIVER ASSEMBLY 280. MOUNT MOTOR ASSEMBLY TO MOTOR DRIVER ASSEMBLY 281. MOUNT MOTOR DRIVER SPLASH GUARD TO MOTOR DRIVER ASSEMBLY 282. MOUNT FRONT PANEL ASSEMBLY TO MOTOR DRIVER ASSEMBLY 283. MOUNT BACK PANEL ASSEMBLY TO MOTOR DRIVER ASSEMBLY 284. MOUNT TOP COVER TO MOTOR DRIVER ASSEMBLY 285. MOUNT SIDE PANELS TO MOTOR DRIVER ASSEMBLY 286. MOUNT FRONT & BACK MOUNTING BRACKET TO MOTOR DRIVER ASSEMBLY 287. MOUNT MOUNTING FEET ASSEMBLY TO MOTOR DRIVER ASSEMBLY 288. MOUNT BASE ASSEMBLY TO MOTOR DRIVER ASSEMBLY 289. MOUNT TACH WHEEL ASSEMBLY TO MOTOR DRIVER ASSEMBLY 290. MOUNT UPPER BEARING LADDER ASSEMBLY TO MOTOR DRIVER ASSEMBLY 291. MOUNT LOWER BEARING LADDER ASSEMBLY TO MOTOR DRIVER ASSEMBLY 292. MOUNT MOTOR ASSEMBLY TO MOTOR DRIVER ASSEMBLY 293. MOUNT MOTOR DRIVER SPLASH GUARD TO MOTOR DRIVER ASSEMBLY 294. MOUNT FRONT PANEL ASSEMBLY TO MOTOR DRIVER ASSEMBLY 295. MOUNT BACK PANEL ASSEMBLY TO MOTOR DRIVER ASSEMBLY 296. MOUNT TOP COVER TO MOTOR DRIVER ASSEMBLY 297. MOUNT SIDE PANELS TO MOTOR DRIVER ASSEMBLY 298. MOUNT FRONT & BACK MOUNTING BRACKET TO MOTOR DRIVER ASSEMBLY 299. MOUNT MOUNTING FEET ASSEMBLY TO MOTOR DRIVER ASSEMBLY 300. MOUNT BASE ASSEMBLY TO MOTOR DRIVER ASSEMBLY 301. MOUNT TACH WHEEL ASSEMBLY TO MOTOR DRIVER ASSEMBLY 302. MOUNT UPPER BEARING LADDER ASSEMBLY TO MOTOR DRIVER ASSEMBLY 303. MOUNT LOWER BEARING LADDER ASSEMBLY TO MOTOR DRIVER ASSEMBLY 304. MOUNT MOTOR ASSEMBLY TO MOTOR DRIVER ASSEMBLY 305. MOUNT MOTOR DRIVER SPLASH GUARD TO MOTOR DRIVER ASSEMBLY 306. MOUNT FRONT PANEL ASSEMBLY TO MOTOR DRIVER ASSEMBLY 307. MOUNT BACK PANEL ASSEMBLY TO MOTOR DRIVER ASSEMBLY 308. MOUNT TOP COVER TO MOTOR DRIVER ASSEMBLY 309. MOUNT SIDE PANELS TO MOTOR DRIVER ASSEMBLY 310. MOUNT FRONT & BACK MOUNTING BRACKET TO MOTOR DRIVER ASSEMBLY 311. MOUNT MOUNTING FEET ASSEMBLY TO MOTOR DRIVER ASSEMBLY 312. MOUNT BASE ASSEMBLY TO MOTOR DRIVER ASSEMBLY 313. MOUNT TACH WHEEL ASSEMBLY TO MOTOR DRIVER ASSEMBLY 314. MOUNT UPPER BEARING LADDER ASSEMBLY TO MOTOR DRIVER ASSEMBLY 315. MOUNT LOWER BEARING LADDER ASSEMBLY TO MOTOR DRIVER ASSEMBLY 316. MOUNT MOTOR ASSEMBLY TO MOTOR DRIVER ASSEMBLY 317. MOUNT MOTOR DRIVER SPLASH GUARD TO MOTOR DRIVER ASSEMBLY 318. MOUNT FRONT PANEL ASSEMBLY TO MOTOR DRIVER ASSEMBLY 319. MOUNT BACK PANEL ASSEMBLY TO MOTOR DRIVER ASSEMBLY 320. MOUNT TOP COVER TO MOTOR DRIVER ASSEMBLY 321. MOUNT SIDE PANELS TO MOTOR DRIVER ASSEMBLY 322. MOUNT FRONT & BACK MOUNTING BRACKET TO MOTOR DRIVER ASSEMBLY 323. MOUNT MOUNTING FEET ASSEMBLY TO MOTOR DRIVER ASSEMBLY 324. MOUNT BASE ASSEMBLY TO MOTOR DRIVER ASSEMBLY 325. MOUNT TACH WHEEL ASSEMBLY TO MOTOR DRIVER ASSEMBLY 326. MOUNT UPPER BEARING LADDER ASSEMBLY TO MOTOR DRIVER ASSEMBLY 327. MOUNT LOWER BEARING LADDER ASSEMBLY TO MOTOR DRIVER ASSEMBLY 328. MOUNT MOTOR ASSEMBLY TO MOTOR DRIVER ASSEMBLY 329. MOUNT MOTOR DRIVER SPLASH GUARD TO MOTOR DRIVER ASSEMBLY 330. MOUNT FRONT PANEL ASSEMBLY TO MOTOR DRIVER ASSEMBLY 331. MOUNT BACK PANEL ASSEMBLY TO MOTOR DRIVER ASSEMBLY 332. MOUNT TOP COVER TO MOTOR DRIVER ASSEMBLY 333. MOUNT SIDE PANELS TO MOTOR DRIVER ASSEMBLY 334. MOUNT FRONT & BACK MOUNTING BRACKET TO MOTOR DRIVER ASSEMBLY 335. MOUNT MOUNTING FEET ASSEMBLY TO MOTOR DRIVER ASSEMBLY 336. MOUNT BASE ASSEMBLY TO MOTOR DRIVER ASSEMBLY 337. MOUNT TACH WHEEL ASSEMBLY TO MOTOR DRIVER ASSEMBLY 338. MOUNT UPPER BEARING LADDER ASSEMBLY TO MOTOR DRIVER ASSEMBLY 339. MOUNT LOWER BEARING LADDER ASSEMBLY TO MOTOR DRIVER ASSEMBLY 340. MOUNT MOTOR ASSEMBLY TO MOTOR DRIVER ASSEMBLY 341. MOUNT MOTOR DRIVER SPLASH GUARD TO MOTOR DRIVER ASSEMBLY 342. MOUNT FRONT PANEL ASSEMBLY TO MOTOR DRIVER ASSEMBLY 343. MOUNT BACK PANEL ASSEMBLY TO MOTOR DRIVER ASSEMBLY 344. MOUNT TOP COVER TO MOTOR DRIVER ASSEMBLY 345. MOUNT SIDE PANELS TO MOTOR DRIVER ASSEMBLY 346. MOUNT FRONT & BACK MOUNTING BRACKET TO MOTOR DRIVER ASSEMBLY 347. MOUNT MOUNTING FEET ASSEMBLY TO MOTOR DRIVER ASSEMBLY 348. MOUNT BASE ASSEMBLY TO MOTOR DRIVER ASSEMBLY 349. MOUNT TACH WHEEL ASSEMBLY TO MOTOR DRIVER ASSEMBLY 350. MOUNT UPPER BEARING LADDER ASSEMBLY TO MOTOR DRIVER ASSEMBLY 351. MOUNT LOWER BEARING LADDER ASSEMBLY TO MOTOR DRIVER ASSEMBLY 352. MOUNT MOTOR ASSEMBLY TO MOTOR DRIVER ASSEMBLY 353. MOUNT MOTOR DRIVER SPLASH GUARD TO MOTOR DRIVER ASSEMBLY 354. MOUNT FRONT PANEL ASSEMBLY TO MOTOR DRIVER ASSEMBLY 355. MOUNT BACK PANEL ASSEMBLY TO MOTOR DRIVER ASSEMBLY 356. MOUNT TOP COVER TO MOTOR DRIVER ASSEMBLY 357. MOUNT SIDE PANELS TO MOTOR DRIVER ASSEMBLY 358. MOUNT FRONT & BACK MOUNTING BRACKET TO MOTOR DRIVER ASSEMBLY 359. MOUNT MOUNTING FEET ASSEMBLY TO MOTOR DRIVER ASSEMBLY 360. MOUNT BASE ASSEMBLY TO MOTOR DRIVER ASSEMBLY 361. MOUNT TACH WHEEL ASSEMBLY TO MOTOR DRIVER ASSEMBLY 362. MOUNT UPPER BEARING LADDER ASSEMBLY TO MOTOR DRIVER ASSEMBLY 363. MOUNT LOWER BEARING LADDER ASSEMB	
--	--

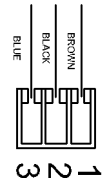

(6266.3)

\*PINK WIRE NOT USED

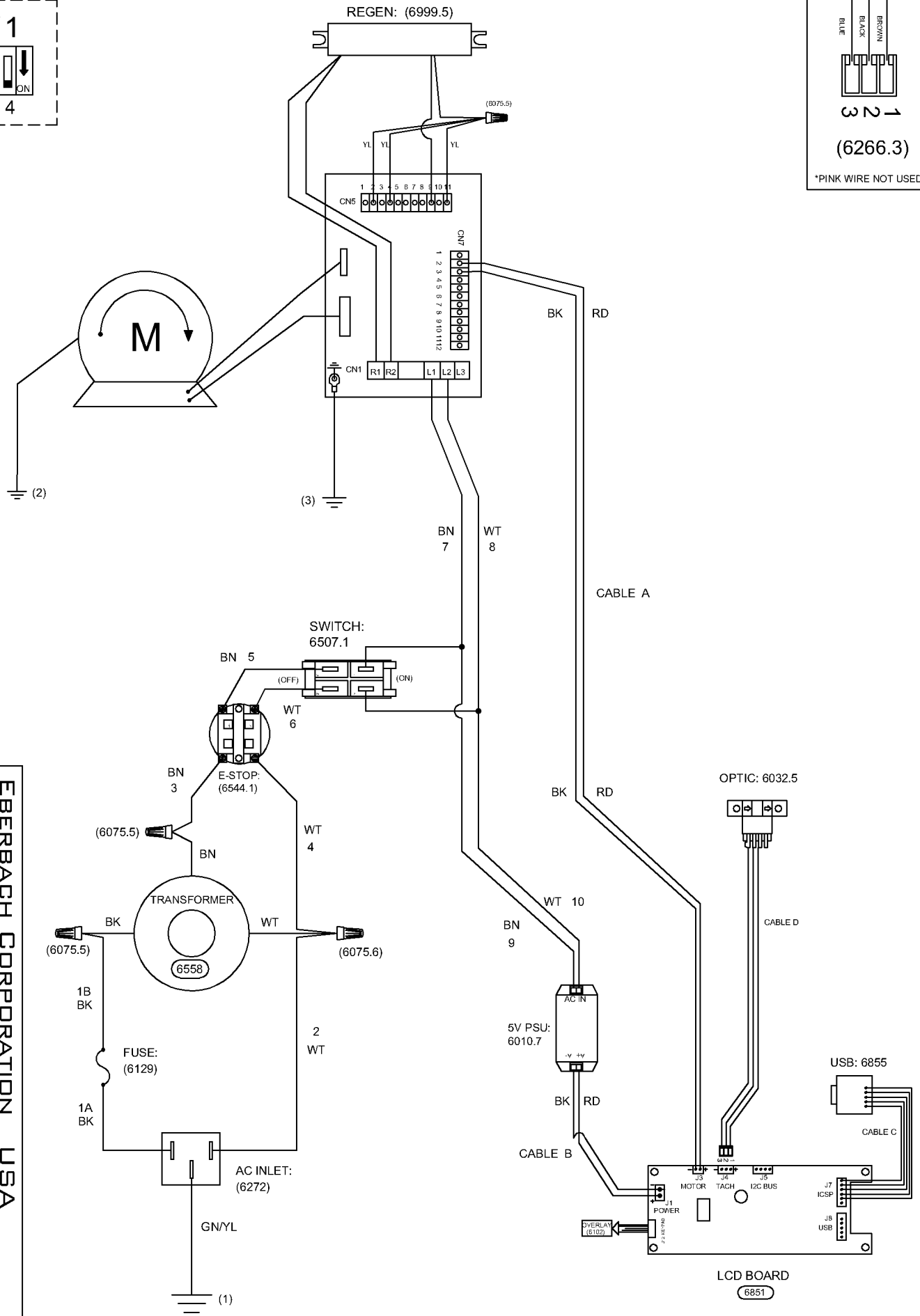
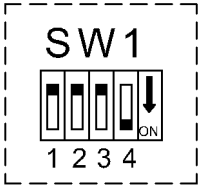

<b>EBERBACH CORPORATION USA</b>		<b>ELECTRONIC ASSEMBLY</b>	
ASSEMBLY	-	PART NAME	-
MATERIAL	-	SCALE	N/A
FINISH	-	REV'D	1
REVISED		J.B. REV 8	9/16/2019
		J.B. REV 9	9/16/2019
		J.B. REV 10	9/16/2019
		J.B. REV 11	9/16/2019
		J.B. REV 12	9/16/2019
		J.B. REV 13	9/16/2019
		J.B. REV 14	9/16/2019
		J.B. REV 15	9/16/2019
		J.B. REV 16	9/16/2019
		J.B. REV 17	9/16/2019
		J.B. REV 18	9/16/2019
		J.B. REV 19	9/16/2019
		J.B. REV 20	9/16/2019
		J.B. REV 21	9/16/2019
		J.B. REV 22	9/16/2019
		J.B. REV 23	9/16/2019
		J.B. REV 24	9/16/2019
		J.B. REV 25	9/16/2019
		J.B. REV 26	9/16/2019
		J.B. REV 27	9/16/2019
		J.B. REV 28	9/16/2019
		J.B. REV 29	9/16/2019
		J.B. REV 30	9/16/2019
		J.B. REV 31	9/16/2019
		J.B. REV 32	9/16/2019
		J.B. REV 33	9/16/2019
		J.B. REV 34	9/16/2019
		J.B. REV 35	9/16/2019
		J.B. REV 36	9/16/2019
		J.B. REV 37	9/16/2019
		J.B. REV 38	9/16/2019
		J.B. REV 39	9/16/2019
		J.B. REV 40	9/16/2019
		J.B. REV 41	9/16/2019
		J.B. REV 42	9/16/2019
		J.B. REV 43	9/16/2019
		J.B. REV 44	9/16/2019
		J.B. REV 45	9/16/2019
		J.B. REV 46	9/16/2019
		J.B. REV 47	9/16/2019
		J.B. REV 48	9/16/2019
		J.B. REV 49	9/16/2019
		J.B. REV 50	9/16/2019
		J.B. REV 51	9/16/2019
		J.B. REV 52	9/16/2019
		J.B. REV 53	9/16/2019
		J.B. REV 54	9/16/2019
		J.B. REV 55	9/16/2019
		J.B. REV 56	9/16/2019
		J.B. REV 57	9/16/2019
		J.B. REV 58	9/16/2019
		J.B. REV 59	9/16/2019
		J.B. REV 60	9/16/2019
		J.B. REV 61	9/16/2019
		J.B. REV 62	9/16/2019
		J.B. REV 63	9/16/2019
		J.B. REV 64	9/16/2019
		J.B. REV 65	9/16/2019
		J.B. REV 66	9/16/2019
		J.B. REV 67	9/16/2019
		J.B. REV 68	9/16/2019
		J.B. REV 69	9/16/2019
		J.B. REV 70	9/16/2019
		J.B. REV 71	9/16/2019
		J.B. REV 72	9/16/2019
		J.B. REV 73	9/16/2019
		J.B. REV 74	9/16/2019
		J.B. REV 75	9/16/2019
		J.B. REV 76	9/16/2019
		J.B. REV 77	9/16/2019
		J.B. REV 78	9/16/2019
		J.B. REV 79	9/16/2019
		J.B. REV 80	9/16/2019
		J.B. REV 81	9/16/2019
		J.B. REV 82	9/16/2019
		J.B. REV 83	9/16/2019
		J.B. REV 84	9/16/2019
		J.B. REV 85	9/16/2019
		J.B. REV 86	9/16/2019
		J.B. REV 87	9/16/2019
		J.B. REV 88	9/16/2019
		J.B. REV 89	9/16/2019
		J.B. REV 90	9/16/2019
		J.B. REV 91	9/16/2019
		J.B. REV 92	9/16/2019
		J.B. REV 93	9/16/2019
		J.B. REV 94	9/16/2019
		J.B. REV 95	9/16/2019
		J.B. REV 96	9/16/2019
		J.B. REV 97	9/16/2019
		J.B. REV 98	9/16/2019
		J.B. REV 99	9/16/2019
		J.B. REV 100	9/16/2019