



5900 Schooner Street – Belleville, MI 48111 – USA

TEL (800) 422-2558 – FAX (734) 665-9099

www.Eberbachlabtools.com

E6010.00 Shaker Power Unit

Two Speed 180/280 osc/min, 115 V, 60 Hz

USE AND CARE FOR CATALOG NUMBER:

- E6010.00 Two Speed Power Unit, 180 & 280 osc/min.

- **NOTE**

THE SHAKER SHOULD BE OPERATED INDOORS ONLY AND LESS THAN 2000 METERS ELEVATION.

- **NOTE**

POSITION THE SHAKER SO THE POWER SWITCH CAN BE EASILY ACCESSED IN CASE OF EMERGENCY SHUT DOWN.

- **NOTE**

THE SHAKER SHOULD BE POWERED UP AS SOON AS POSSIBLE TO ENSURE NO DAMAGE HAS OCCURRED DURING SHIPPING.

- **CAUTION**

REPLACEMENT POWER CORD MUST BE AT LEAST 18AWG AND 300VAC RATED.

- **CAUTION**

LIFT UNIT WITH BOTH HANDS UNDER THE BOTTOM. DO NOT LIFT UNIT BY TOP PLATFORM.

- **CAUTION**

ONLY USE THE SHAKER IN A MANNER AS DESCRIBED IN THIS MANUAL. FAILURE TO DO SO MAY COMPROMISE THE SAFETY FEATURES INCORPORATED IN THE UNIT.

- **CAUTION**

SERVICE SHOULD BE PERFORMED ONLY BY QUALIFIED/TRAINED PERSONNEL. PLEASE DIRECT ANY QUESTIONS TO Eberbach Corporation technical service @ 1-800-422-2558.

- **CLEANING**

When cleaning the shaker always turn the power off and disconnect the power cord from the power source!

The unit may be cleaned using a damp cloth or any standard household or laboratory cleaner to wipe down its outer surface. Do not use abrasive or corrosive compounds to clean the shaker, as they may damage the unit.

If you have any doubts or inquiries concerning operation contact your supplier or Eberbach Corporation technical service @ 1-800-422-2558.

TRANSPORT / LIFTING

The shaker should be lifted by the bottom of the power unit, never lift or transport the shaker via the utility box or top plate.

INITIAL PREPARATION:

This shaker power unit is furnished without carriers. Prior to installation of any carrier the unit should be run.

With the switch in the off position (center – off for E6010.00), plug the line cord into a 115 Volt, 60 Hz source. Turn shaker on by moving switch to the “Low” position.

OPERATION:

Because an oscillating mechanism such as a shaker tends to “walk”, caution must be exercised when installing it for use.

This shaking apparatus must be placed on a rigid bench or table, or directly on the floor. Suction type rubber feet are provided; therefore, the surface must be free of cracks or voids and must be clean, especially free of dust, oil or wax.

If the shaker starts “walking”, it may need to be cemented to the mounting surface. At no time should the load exceed 40lbs.

If it is necessary to cement the shaker to a mounting surface, we suggest the use of a rubber bonding cement. When applying rubber a bonding cement, follow manufacturer’s directions.

To move the shaker after it has been cemented to a surface, it is necessary to free the feet with a sharp knife or razor blade to keep from damaging the feet.

For optimum operation of this shaking apparatus and for long trouble-free life, it is recommended that a minimum load be placed in the shaker when used.

OILING AND ALL MAINTENANCE CAN BE PERFORMED BY REMOVING EITHER THE FRONT OR REAR HOUSING PANEL.

BELT INSPECTION:

Inspect the belt at each oiling period and replace if broken or if cords are exposed and frayed. Small outer fabric breaks are not harmful.

BELT REPLACEMENT AND ADJUSTMENT:

To replace the belt, loosen the motor screws and remove the belt, then install a new belt. Tighten the motor screws, but do not tighten the belt to the point where the bearings will be overloaded. Once the belt is tight, the operator should be able to press lightly on the middle of the belt and cause it to bow in an amount equal to the width of the belt.

LUBRICATION:

See exploded view of shaker power unit for points of lubrication. Use a good grade of SAE #30 oil.

Lubrication when shaker is used in continuous duty applications of 100 hours or more:

- A. Oil the crank bearing through the hole in the center of the bearing bracket every 3 months.
- B. Oil the 8 bearings located at the top and bottom of each of the 4 rocker arms every 3 months. Place oil on the shaft next to the bearing.
- C. Oil the connecting rod bearings every 3 months. Place oil on the shaft next to the bearing at the upper end and at the crank end of the connecting rod.

Lubrication when shaker is used for intermittent duty:

- A. Oil the crank bearing through the hole in the center of the bearing bracket every 6 months.
- B. Oil the 8 bearings located at the top and bottom of each of the 4 rocker arms every 6 months. Place oil on the shaft next to the bearing.
- C. Oil the connecting rod bearings every 6 months. Place oil on the shaft next to the bearing at the upper end and at the crank end of the connecting rod.

REPLACEMENT PARTS LIST FOR E6010.00

<u>PART NO.</u>	<u>DESCRIPTION</u>	<u>QTY.</u>
4283.2	3L290R V-BELT GATES #1290	1
4351	COLLAR	2
4487	8" PULLEY X 1/2" BORE, 7.66" PITCH	1
5528	3.75" SUCTION CUP W/ 5/16-18 THREADED POST	4
6063.1	CABLE TIE MOUNT, HOLE DIA (.025 - .125")	4
6063.2	CABLE TIE	3
6129	FUSE, 5AMP TIME DELAY	1
6131.1	FUSE HOLDER	1
6272	AC POWER INLET	1
6518	SWITCH	1
6649	115V POWER CORD, TYPE B PLUG	1
6800.5	LOGO PLATE	1
7051.1	MOTOR 1/6 HP, 1725/1140 RPM	1
7568	#4-40 X 1/4" S/S PAN HD. MACHINE SCREW	2
7617	#6-32 X 1/2" S/S ROUND HD. MACHINE SCREW	2
8279	#10-32 X 3/8" SELF LOCKING BOTTEN HD. SOCKET SCREW	8
8285	#8-32 X 1/4" S/S TRUST HD. SCREW	16
8323	1/4"-20 X 3/16" SET SCREW	1
8518	1/4"-28 X 3/4" HEX HEAD SCREW	4
8528.4	5/16"-24 X 1/2" HEX HEAD SCREW	4
9175	#4-40X.25" PAN HD. SHEET METAL SCREW	2
9206	#6-32 NYLON LOCK NUT	2
9217	#4-40 S.S NYLON LOCK NUT	2
9235	#8-32 S/S MACHINE SCREW NUT	2
9271	1/4"-28 GRADE 5 HEX NUT	4
9437	1/4" OVERSIZE WASHER	8
9438	5/16" SAE WASHER	4
9609	FIBER WASHER, 0.391 X 0.625 X 0.032	10
9627.5	DELTRIN WASHER, 0.515 X 0.885 X 0.067	1
EP6000.037	SWITCH ESCUTCHEON	1
EP6000.565A	ROCKER ARM AND SPACER ROD ASSEMBLY	2
EP6010.036	OK-12 PULLEY	1
EP6010.500A	FRONT PANEL ASSEMBLY	1
EP6010.501A	BACK PANEL ASSEMBLY	1
EP6010.505A	BASE ASSEMBLY	1
EP6010.525A	BEARING BLOCK AND CRANK ASSEMBLY	1
EP6010.655A	WIRING HARNESS ASSEMBLY	1

EP6015.512A	TOP PLATE ASSEMBLY	1
EP6015.529A	CONNECTING ROD ASSEMBLY	1

CARRIERS AND ACCESSORIES

E6040.00	Utility Box Carrier
E6042.00	Crosswise Bar Clamp
E6044.00	Lengthwise Bar Clamp
E6047.00	Box Carrier with Plexiglass Cover
E6061.00	Shaker Platform
E6090.01	10 ML ERLENMEYER FLASK HOLDER
E6090.02	25 ML ERLENMEYER FLASK HOLDER
E6090.05	50 ML ERLENMEYER FLASK HOLDER
E6090.12	125 ML ERLENMEYER FLASK HOLDER
E6090.25	250 ML ERLENMEYER FLASK HOLDER
E6090.50	500 ML ERLENMEYER FLASK HOLDER
E6090.60	1000 ML ERLENMEYER FLASK HOLDER
E6090.65	1500 ML ERLENMEYER FLASK HOLDER
E6090.70	2000 ML ERLENMEYER FLASK HOLDER
E6090.75	2500 ML LOW FORM FLASK HOLDER
E6090.78	2800 ML FERNBACH FLASK HOLDER
E6090.90	4000 ML ERLENMEYER FLASK HOLDER
E6090.92	6000 ML ERLENMEYER FLASK HOLDER
E6095.25	250 ML SEPARATORY FUNNEL HOLDER
E6095.50	500 ML SEPARATORY FUNNEL HOLDER
E6095.60	1000 ML SEPARATORY FUNNEL HOLDER
E6095.70	2000 ML SEPARATORY FUNNEL HOLDER

Visit us at www.Eberbachlabtools.com for a complete list of shakers and accessories.

PartNo	DESCRIPTION	QTY.	UoM
4351	COLLAR	2	EA
4487	8" PULLEY X 1/2" BORE, 7.66" PITCH	1	EA
5528	3.75" SUCTION CUP W/ 5/16- 18 THREADED POST	4	EA
6063.1	CABLE TIE MOUNT	4	EA
6063.2	ZIP TIE	3	EA
6129	FUSE, 5AMP TIME DELAY	1	EA
6131.1	FUSE HOLDER	1	EA
6272	AC POWER INLET	1	EA
6518	SWITCH	1	EA
6649	CORD AND PLUG	1	EA
6800.5	LOGO PLATE	1	EA
7051.1	MOTOR 1/6HP 1725/1140RPM	1	EA
7568	#4-40 X 1/4" S/5 PAN HD. MACHINE SCREW	2	EA
7617	#6-32 X 1/2" S/5 ROUND HD. MACHINE SCREW	2	EA
8279	#10-32 X 3/8" SELF LOCKING BOTTEN HD. SOCKET SCREW	8	EA
8285	#8-32 X 1/4" S/5 TRUST HD. SCREW	16	EA
8323	1/4"-20 X 3/16" SET SCREW	1	EA
8518	1/4"-28 X 3/4" HEX HEAD SCREW	4	EA
8528.4	5/16"-24 X 1/2" HEX HEAD SCREW	4	EA
9175	#4-40X.25" PAN HD. SHEET METAL SCREW	2	EA
9206	#6-32 S/5 NYLON LOCK NUT	2	EA
9217	#4-40 S/5 NYLOCK NUT	2	EA
9235	#8-32 S/5 MACHINE SCREW NUT	2	EA
9271	1/4"-28 GRADE 5 HEX NUT	4	EA
9437	1/4 WASHER ZINC PLATED	8	EA
9438	5/16" SAE WASHER	4	EA
9609	FIBER WASHER, 0.391 X 0.625 X 0.032	10	EA
9627.5	DELIRIN WASHER, 0.515 X 0.885 X 0.067	1	EA
EP6000.037	SWITCH ESCUTCHEON ASSEMBLY	1	EA
EP6000.565A	ROCKER ARM AND SPACER ROD ASSEMBLY	2	EA
EP6010.036	OK-12 PULLEY	1	EA
EP6010.500A	FRONT PANEL ASSEMBLY	1	EA
EP6010.501A	BACK PANEL ASSEMBLY	1	EA
EP6010.505A	BASE ASSEMBLY	1	EA
EP6010.525A	BEARING BLOCK AND CRANK ASSEMBLY	1	EA
EP6010.655A	WIRING HARNESS	1	EA
EP6015.512A	TOP PLATE ASSEMBLY	1	EA
EP6015.529A	CONNECTING ROD ASSEMBLY	1	EA

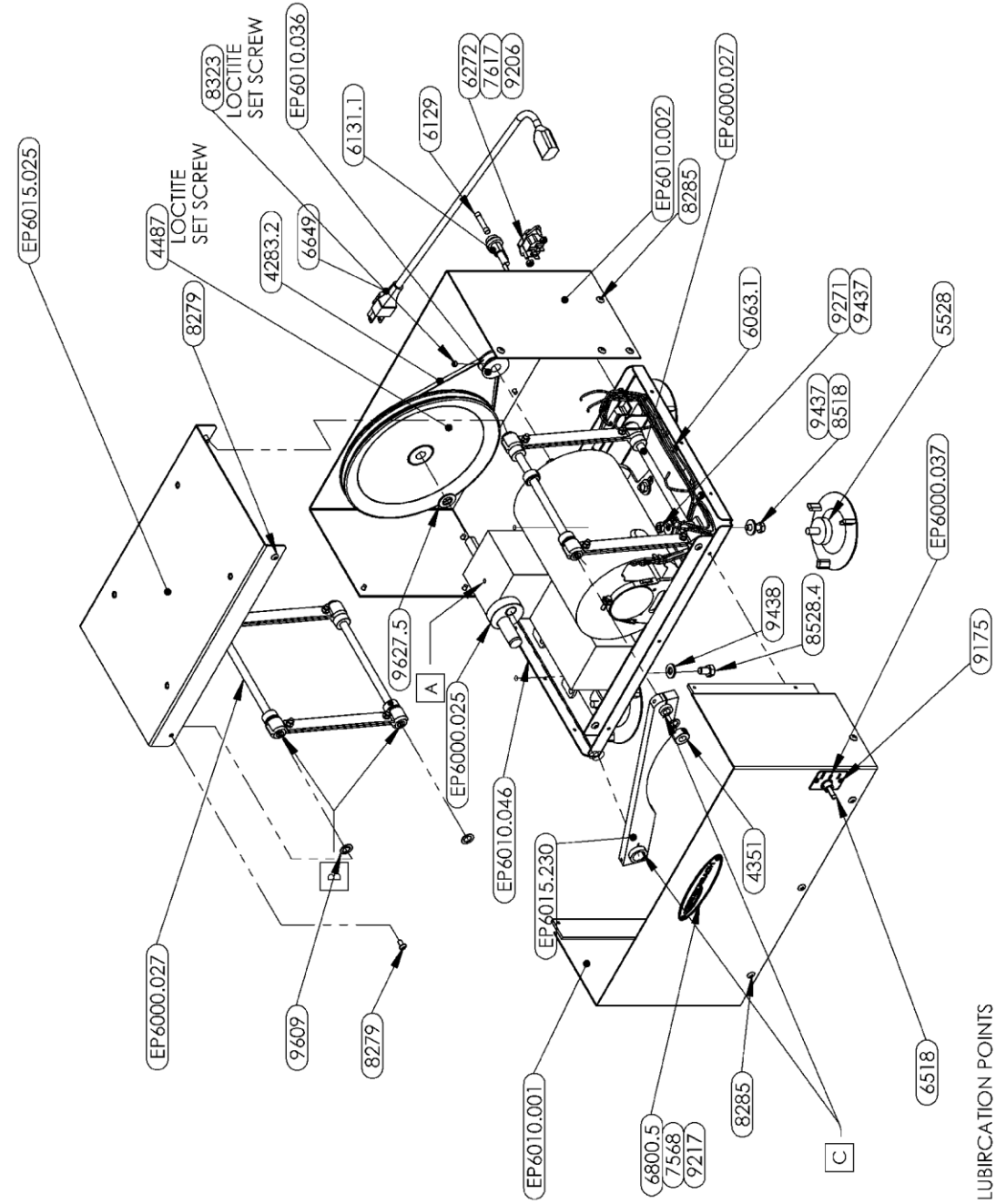

LUBRICATION POINTS
USE SAE# 30 OIL

- A CRANK BEARING BLOCK
- B ROCKER ARM BEARINGS, 8 PLACES
- C CONNECTING ROD BEARING

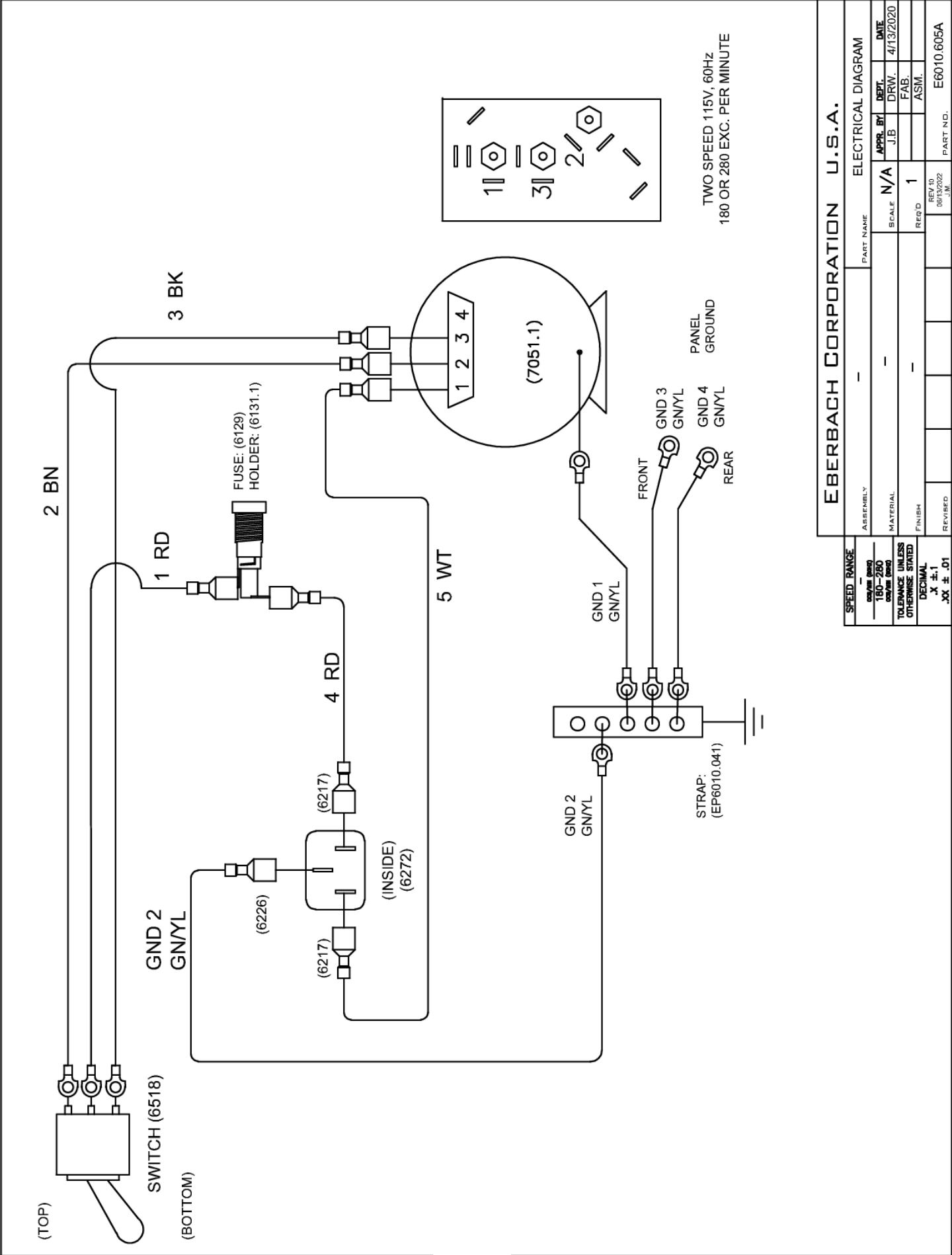

EBERBACH CORPORATION U.S.A.

SPEED RANGE	ASSEMBLY	PART NAME	ELECTRICAL DIAGRAM	
10-250 RPM			SCALE	N/A
TOLERANCE UNLESS OTHERWISE STATED			REV'D	1
DECIMAL .X ±.1 .XX ±.01			REV'D	06/13/2022
			REV'D	J.M.
			PART NO.	E6010.605A