

Base Box		Base Hardware		Q35x Console Box	
<ul style="list-style-type: none"> Base Access Panel Mast Boot Top Shroud 	<ul style="list-style-type: none"> Console Mast Moving Handlebars (L and R) Handlebar Covers (2) 	<ul style="list-style-type: none"> B-1 (4) B-2 (8) B-3 (1) B-4 (4) B-5 (4) B-6 (4) 	<ul style="list-style-type: none"> Console and Keypad Information Packet 	<ul style="list-style-type: none"> Power Supply Console Hardware C-1 (4) 	

A Moving Handlebars

- Attach handlebar at hub with B-6 (Qty 2), and B-2 (Qty 4) between bolt and both sides of bracket; secure with B-5 (Qty 2); tighten (20 ft-lb).

B Mast, Keypad & Console

- Slide mast over screws on base; tighten.
- Connect cable connectors (mast to base); secure loose cables to frame with B-3.
- Connect heart rate cable to heart rate board on console back. Match keypad and main cable connectors to sockets on console back; connect (2).
- Attach console/keypad to mast with C-1 (Qty 4).

C Access Panel & Handlebar Covers

- Secure back of panel with B-1 (Qty 2).
- Secure sides of panel with B-1 (Qty 2).
- Place handlebar covers.

D Top Shroud & Mast Boot

- Holding bottom edge in place, hinge top shroud down.
- Attach top shroud with B-4 (Qty 4).
- Wrap mast boot around mast; tuck into access panel.

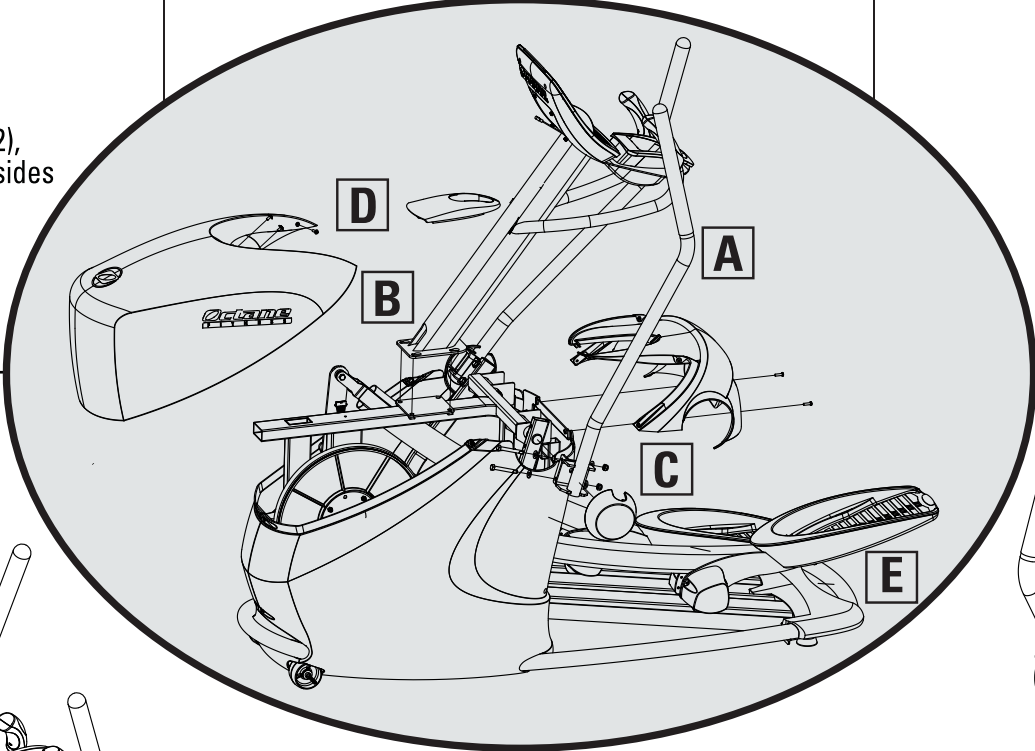

E Level & User Set-up

- Adjust and lock levelers; **make sure nut is tight.**
- Connect power supply to unit and to power outlet.
- Complete User Set-up (press & hold Level (▲/▼) — Instructions in Operations Manual).
- Before 1st use and as needed, clean tracks with a cloth and mild soap and water.