



240-SWTS-LICPLT

Universal Street Legal
License Plate Frame with LED

SSV WORKS, 201 N. Rice Ave Unit A, Oxnard, CA 93030

www.SSVworks.com | Phone: 818-991-1778 | Fax: 866-293-6751

WARRANTY INFORMATION:

All SWITCH Works Electronics are covered by a limited 1 year warranty against defects in material or workmanship. Contact SSV Works for further warranty information.



Please read and understand these instructions completely before installation to avoid possible injury, or damage to the accessory or vehicle.

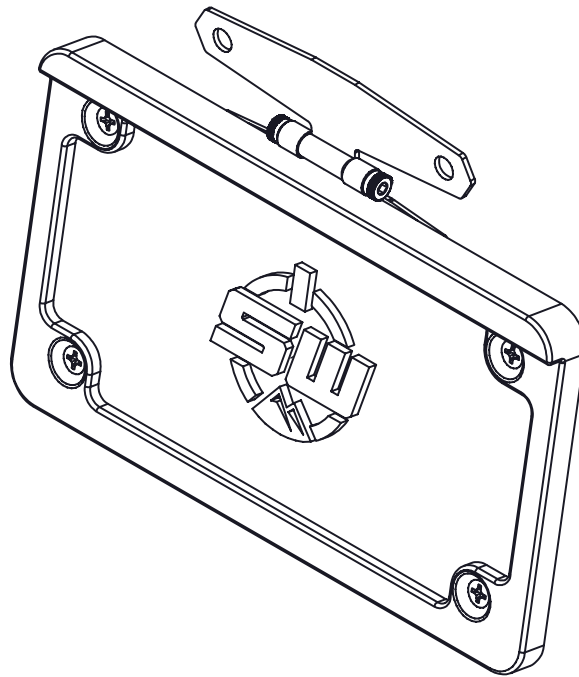

SWITCH Works License Plate Parts List



SWITCH Works License Plate Frame with LED Light



License Plate Frame Bracket [B-MBP3422]



License Plate Frame Hardware Pack [B-HP3425]

SWITCH Works License Plate Frame Installation

TOOLS NEEDED FOR INSTALLATION

- Phillips Screw Driver
- 4mm Allen Wrench

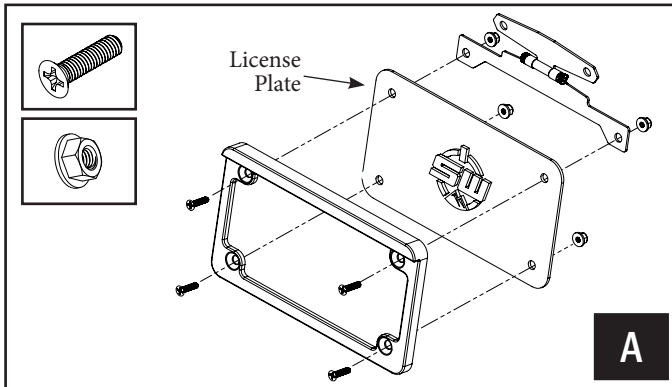

A. Use (4) M4 Phillips flat head screws and flanged locknuts, included in the kit, to assemble the license plate between the license plate frame and bracket as shown above.

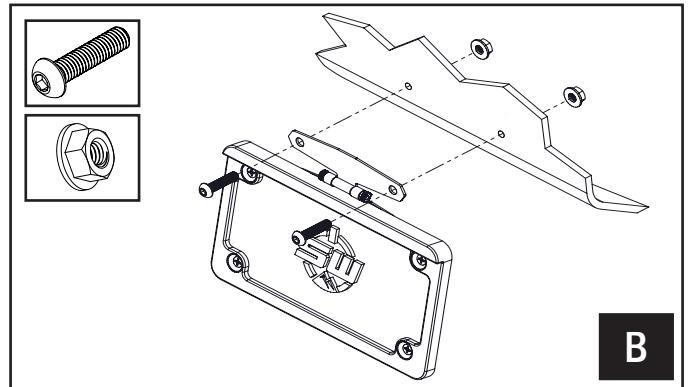

B. Use the button head Allen screws and flanged locknuts, included in the kit, to secure the license plate frame bracket to the vehicle.

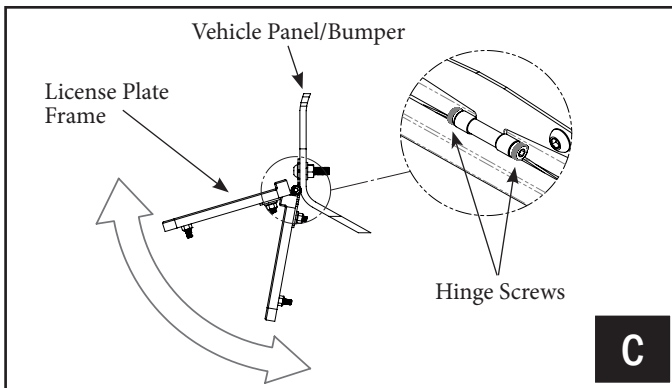

C. The license plate frame bracket has a 240° up and down adjustability for various mounting options such as above bumper, vertical body mounting or under bumper mounting. Tighten the 3mm bracket hinge screws to lock the angle (see inset above).

D. Plug in the license plate frame LED cable connector to the SWITCH Works Turn Signal kit (sold separately).

Alternative mounting option without using the Adjustable Bracket

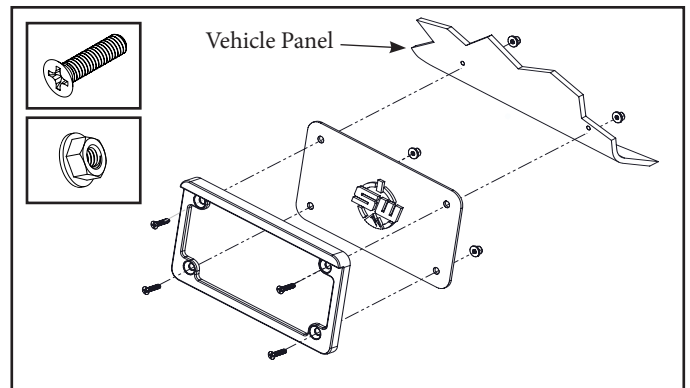

The license plate frame can also be mounted directly to the vehicle panel without using the provided adjustable bracket. Use the (4) M4 Phillips flat head screws and flanged locknuts, included in the kit, to secure the license plate frame to the vehicle.