

# Assembly & Care Guide

## *Kizu Table Lamp*

The Kizu Table Lamp is carefully made and therefore every item is unique. It may occur different expression in the material and surface, with smaller marks and minor deviations.

### SAFETY INSTRUCTIONS

Please read the instructions carefully and retain it for future reference. New Works Aps is not responsible for any faults or damages caused by not following the instructions correctly.

The lamp is only intended for indoor use, consult a professionally qualified electrician if any doubt. Follow the guidance:

Kizu Table Lamp, Small - 220-240V~ 50/60Hz - E14 LED Max 7W (Bulb not included).

Kizu Table Lamp, Large - 220-240V~ 50/60Hz - E27 LED Max 11W (Bulb not included).

The light bulb and lamp exterior may get hot after prolonged use.

Turn off the power (unplug from wall outlet) before replacing the bulb. Make sure the bulb has sufficient time to cool down. Do not subject the lamp to any shock as this may cause the lamp to brake.

Keep the product out of children's reach. Dispose the packaging and do not allow children to play with it. Do not modify the product in any way.

### CLEANING

Turn off the electricity before cleaning the lamp. Wipe the lamp exterior with a soft dry or moist cloth. Do not use any abrasive cleaning tools, and never use strong cleaning agents such as household glass cleaner, white spirit, or turpentine.

### MORE INFORMATION

For more information such as product overview, material description and disclaimers - please visit our website at [www.newworks.dk](http://www.newworks.dk) for further information. If you have any questions or comments, please do not hesitate to contact us at [info@newworks.dk](mailto:info@newworks.dk).

## **NEW WORKS.**

# Assembly & Care Guide

## *Kizu Table Lamp*

Read the instruction carefully and turn off electricity at main circuit breaker panel before beginning the installation. Warning all wires are connected - when unpacking the box, be careful not to pull wires, as this may result in a bad connection. Do not connect the electricity until the lamp is fully assembled.

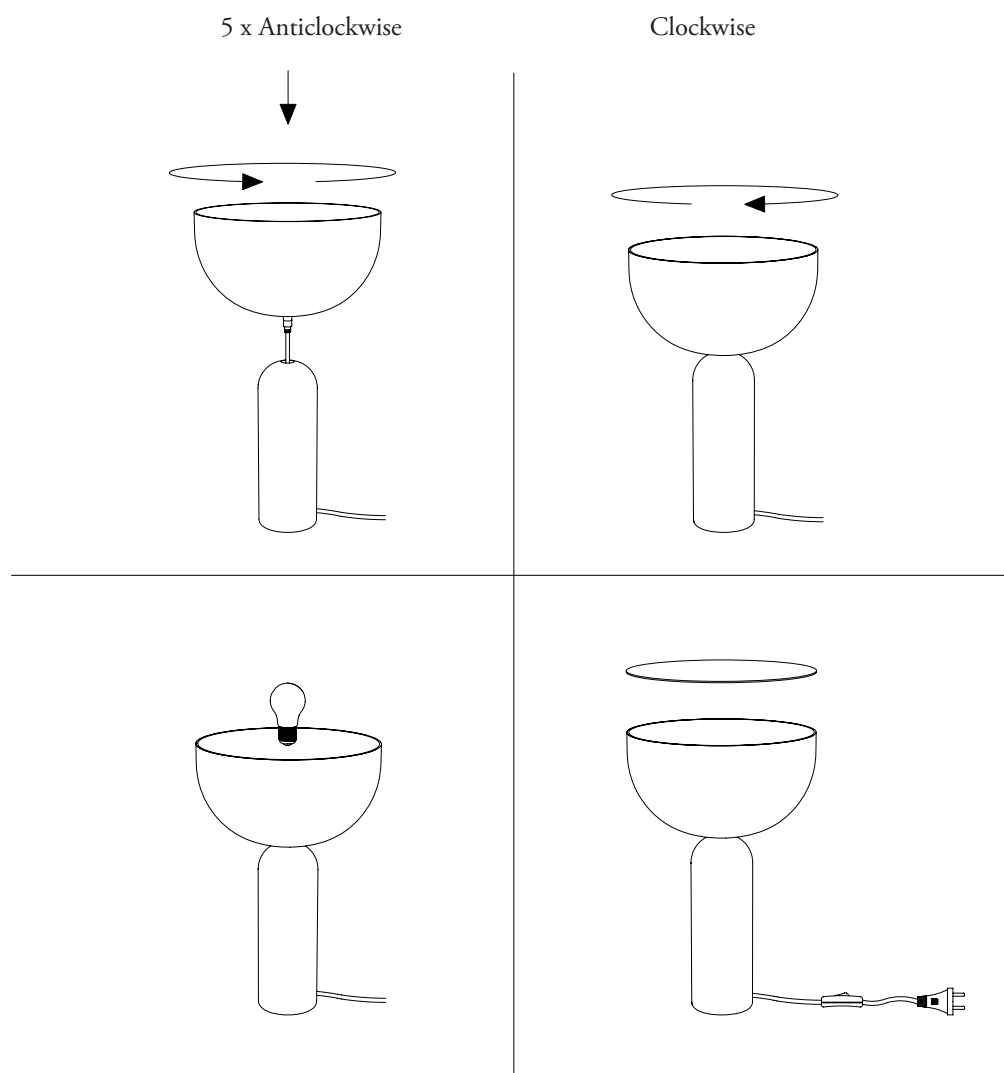

### ASSEMBLY INSTRUCTIONS

1. Place the lamp on a levelled and stable surface - Make sure only to lift the lamp by its base.  
Insert the shade into the top of the base, then turn it five times to the right (anticlockwise).
2. Then, turn the shade the opposite direction (clockwise) until it is mounted correctly. Make sure not to turn it too hard, as this could break the lampshade.
3. Install the light bulb - Make sure only to use one of the approved bulb types - E27 Light Bulb, LED Max 11W / E14 LED max 7W (Bulb not included).
4. Place the Acrylic lid on top and connect to electricity.

**NEW WORKS.**