



HydraFacial

User Guide



Contents

3	Before You Start
3	Safety Information
10	Getting Started
10	Package Contents
11	Device Components
12	Installation
12	• Tool Holder
12	• Waste Container
12	• HydraFacial® Handpiece
13	• HydroPeel® Tip
13	• Specialty Vial
15	• Skin Solutions
15	• Optional Components
17	Operating Instructions
17	• On/Off, Standby, and Sleep Modes
18	• Touchscreen
18	• Adjust Fluid Flow
18	• Adjust Vacuum Strength
19	• Activate LED Lights (optional)
19	• Skin Imaging Camera (optional)
20	System Cleaning & Preventive Maintenance
20	• After Each Service
20	• Weekly Cleaning
21	• HydraFacial® Handpiece
23	• Waste Container
23	• Touchscreen
23	• Removable Front Door
24	• Wet Diamond Aggressive Abrasion (Medical Use Only)
25	• Mechanical Lymphatic Drainage Therapy Handpieces (optional)
25	• LED Light Therapy Handpieces (optional)
25	• Skin Imaging Camera (optional)
26	Troubleshooting











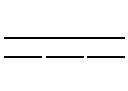

BEFORE YOU START

HYDRAFACIAL MD® ELITE™

User Guide

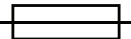
SAFETY INFORMATION

PRODUCT MARKING SYMBOLS





<i>Symbol</i>	<i>Description</i>
	Attention: Refer to accompanying documentation. Aufmerksamkeit: Beziehen Sie sich begleitend auf Dokumentation. Attention : Consultez la documentation d'accompagnement.
	Separate collection for electronic. Trennen Sie Sammlung für elektronisch. Collecte sélective pour l'électronique.
	Type BF Applied Part. Defibrillation proof. Type BF. Defibrillation Beweis. BF Pièce appliquée de type. Défibrillation preuve.
	Direct Current Gleichstrom Courant continu
	Alternating Current Wechselstrom Courant alternatif
	ON (Power) EIN (Stromversorgung) ALLUME (Alimentation)
	OFF (Power) AUS (Stromversorgung) ETEINT (Alimentation)
	STANDBY (Power) STANDBY (Stromversorgung) PAUSE (Alimentation)
	Operating Instructions Bedienungsanleitung Mode d'emploi
	Fuse Sicherung Fusible
	Pushing Prohibited Drücken ist untersagt Interdiction de pousser
	Certified by CSA Group Zertifiziert von der CSA-Gruppe Certifié par CSA Group
	Connect to supply mains with protective earth (ground) Zum Versorgungsnetz durch eine Schutzerdung anschließen Connectez au secteur, avec protection mise à la terre

BEFORE YOU START

HYDRAFACIAL MD® ELITE™

User Guide

CAUTION AND MARKING SYMBOLS

<i>Symbol</i>	<i>Description</i>
	<p>Calls attention to a procedure, practice, or condition that could possibly cause bodily injury or death.</p> <p>Ruft Aufmerksamkeit zu einem Verfahren, Praxis, oder Bedingung, die vielleicht körperliche Verletzung oder Tod verursachen könnte.</p> <p>Une attention particulière doit être portée à une procédure, pratique ou condition qui pourrait causer des blessures corporelles ou la mort.</p>
	<p>Calls attention to a procedure, practice, or condition that could possibly cause damage to equipment or permanent loss of data.</p> <p>Ruft Aufmerksamkeit zu einem Verfahren, Praxis, oder Bedingung, die vielleicht Schaden an Ausrüstungen oder permanentem Verlust der Daten verursachen könnte.</p> <p>Une attention particulière doit être portée à une procédure, pratique ou condition qui pourrait causer des dommages à l'appareil ou la perte permanente de données.</p>
	<p>Do Not Re-use Nicht wieder verwenden Ne pas réutiliser</p>
	<p>Manufactured by Hergestellt von Fabriqué par</p>
	<p>Keep dry Bleib trocken Garder au sec</p>

BEFORE YOU START

HYDRAFACIAL MD® ELITE™

User Guide

SAFETY GUIDELINES

1. Ensure that all operators of the HydraFacial® System are trained and licensed as required by the state or country. Do not operate the unit before being trained.
2. Be sure to read the User Guide thoroughly before setting up the system.
3. Always use a clean tip for each procedure. The HydroPeel® tips are for single use only. Use for more than one procedure may result in infection.
4. Reusing contaminated skin solution can cause harm to the client and will void all warranties.
5. Skin solutions should not exceed the “Use By” date on the bottle.
6. In the event that a client experiences irritation, discontinue the use of the skin solution immediately.
7. Always do a client consultation to determine if the client is a candidate for the procedure. Follow contraindication list as pre-determination for procedure.
8. Always begin procedure conservatively. Follow recommended protocols and contraindications for skin type. Each client’s skin conditions and sensitivity are different and suggested settings will vary for each client. Do a sensitivity test on the neck by the earlobe and increase or decrease the vacuum level as required. Skin conditions requiring more aggressive vacuum settings are at operator’s discretion.
9. Do not work on sensitive areas such as the eyelids. Eyelids should be closed at all times during the procedure and covered with protective eyewear or damp cotton pads. Sterile eye rinse solution should be available at all times to rinse the eyes.
10. Removing contact lenses prior to procedure is recommended.

BEFORE YOU START

HYDRAFACIAL MD® ELITE™

User Guide

11. The client should have a minimum sunscreen SPF 30 applied after the procedure and should use sunscreen on an ongoing basis.
12. Empty the waste container after each service according to your waste handling protocol. Follow the system cleaning instructions in this guide to clean your machine and handpiece after each procedure.
13. Only Edge Systems skin solutions should be suctioned through the HydraFacial® handpiece. Use of other, non-approved skin solutions will void the warranty and clog the machine. Always use solution when performing abrasion.
14. Keep the device in accordance to recommended environmental conditions. Liquid should only be suctioned through the HydraFacial® handpiece.
15. Not recommended for severe acne scarring.

WARNING

Equipment not suitable for use in the presence of a flammable anesthetic mixture with air or with oxygen or Nitrous Oxide.

Ausrüstungen die nicht sind passend für Gebrauch in der Anwesenheit von einer brennbaren Narkosenmischung mit Luft oder mit Sauerstoff oder Stickstoffoxyd.

L'appareil n'est pas destiné à être utilisé en présence d'un mélange anesthésique inflammable avec de l'air, de l'oxygène ou de l'oxyde nitreux.

WARNING

Equipment is not intended to be used in an oxygen-rich environment.

Die Geräte sind nicht zum Einsatz in einer sauerstoffreichen Umgebung bestimmt.

L'équipement ne doit pas être utilisé dans un environnement riche en oxygène.

BEFORE YOU START

HYDRAFACIAL MD® ELITE™

User Guide

CAUTION

DO NOT suction liquids through the dry port for crystal-free procedure located on the side of the unit. This will damage the unit and will void the warranty.

MACHT Saugwirkungsflüssigkeiten durch den trockenen Hafen für Kristall frei Behandlung NICHT, die auf der Seite von der Einheit befunden wird. Dies wird die Einheit beschädigen und wird von der Garantie nicht bedeckt.

N'ASPIREZ PAS de liquides par le port de séchage pour le traitement sans cristal situé sur le côté de l'appareil. Ceci entraînera des dommages à l'appareil qui ne sont pas couverts par la garantie.

CAUTION

This equipment has been designed and determined to be compliant with regulatory agency limits for EMI. However, there is no guarantee that interference will not occur in a particular installation. If this equipment does cause interference, which can be determined by turning the equipment off and on, the interference can be possibly corrected by one or more of the following measures:

- Relocate the equipment with respect to the receiver.
- Move the equipment away from the receiver.
- Plug the equipment into a different electrical outlet so that the equipment and receiver are on different branch circuits.

BEFORE YOU START

HYDRAFACIAL MD® ELITE™

User Guide

Diese Ausrüstungen sind entworfen worden und sind bestimmt worden, entgegenkommend mit gesetzlichen Agenturengrenzen für EMI zu sein. Jedoch, es gibt keine Garantie, die jene Störung in einer besonderen Installation nicht stattfinden wird. Wenn diese Ausrüstungen Störung verursachen, die von Drehen den Ausrüstungen ab und auf bestimmt werden kann, kann die Störung vielleicht von ein oder mehr von den Folgenden Maßnahme korrigiert werden:

- Repositionieren Sie die Ausrüstungen in Bezug auf den Empfänger.
- Bewegen Sie die Ausrüstungen weg vom Empfänger.
- Stöpseln Sie die Ausrüstungen in eine verschiedene Steckdose zu, damit die Ausrüstungen und der Empfänger auf verschiedenen Zweigenkreisläufen sind.

Cet appareil a été conçu conformément aux limites de l'organisme de réglementation en matière d'interférence électromagnétique. Toutefois, rien ne garantit l'absence d'interférences dans une installation particulière. Si cet appareil provoque des interférences, détectables en allumant et en éteignant l'appareil, celles-ci pourront possiblement être corrigées en accomplissant une ou plusieurs des actions suivantes :

- Déplacer l'appareil par rapport au récepteur;
- Éloigner l'appareil du récepteur;
- Brancher l'appareil sur une autre prise de courant pour que l'appareil et le récepteur soient branchés sur différents circuits.

CAUTION

To prevent electric shock, do not remove the instrument cover. There are no user serviceable parts inside. Routine maintenance or cleaning of internal parts is not necessary. Avoid the use of cleaning agents or chemicals on the instrument. Some chemicals may damage plastic parts or lettering. Any external cleaning should be done with a clean, dry or slightly damp cloth.

Elektroschock zu verhindern, nimmt die Instrumentdecke nicht heraus. Es gibt keine vom Benutzer haltbaren Teile hinein. Routinewartung oder reinigend von inneren Teilen ist nicht notwendig. Vermeiden Sie den Gebrauch, um Agenten oder Chemikalien auf dem Instrument zu reinigen. Einige Chemikalien dürfen Kunststoffteile oder Beschriftung beschädigen. Irgendein äußerlicher Reinigen sollte mit einem sauberen gemacht werden, trocken oder dämpft etwas Tuch.

BEFORE YOU START

HYDRAFACIAL MD® ELITE™

User Guide

Pour prévenir les chocs électriques, n'enlevez pas le couvercle de l'instrument. Ce dernier ne contient aucune pièce pouvant être réparée par l'utilisateur. L'entretien ou le nettoyage périodique des pièces internes n'est pas nécessaire. Évitez l'utilisation de produits nettoyants ou chimiques sur l'instrument. Certains produits chimiques peuvent endommager les pièces de plastique ou le lettrage. Tout nettoyage externe doit être fait avec un chiffon propre, sec ou légèrement humide.

GETTING STARTED

HYDRAFACIAL MD® ELITE™ User Guide

Package Contents

 A photograph of the HydraFacial MD Elite machine. It is a tall, grey and black unit on wheels. At the top is a monitor displaying a woman's face and the HydraFacial logo. Below the monitor is a control panel with several buttons. The main body of the machine is grey with a blue-tinted section in the middle. The base is black with two large wheels.	<p>Console Unit Wet (HydraFacial®) Handpiece Assembly Tool Holder HydroPeel® Tips Skin Solutions Puncture Tool Waste Container Assembly Cleaning Cap</p> <p>Options: Mechanical Lymphatic Drainage Glass Handpiece Cups</p> <p>Cordless Red LED Light Therapy Handpiece Cordless Blue LED Light Therapy Handpiece LED Light Therapy Handpiece Holder LED Light Therapy Marketing Kit</p> <p>Camera Handpiece Camera Holder</p> <p>Wet Diamond Aggressive Abrasion Pads Smooth Tip Cleaning Kit</p>
--	---

Device Components

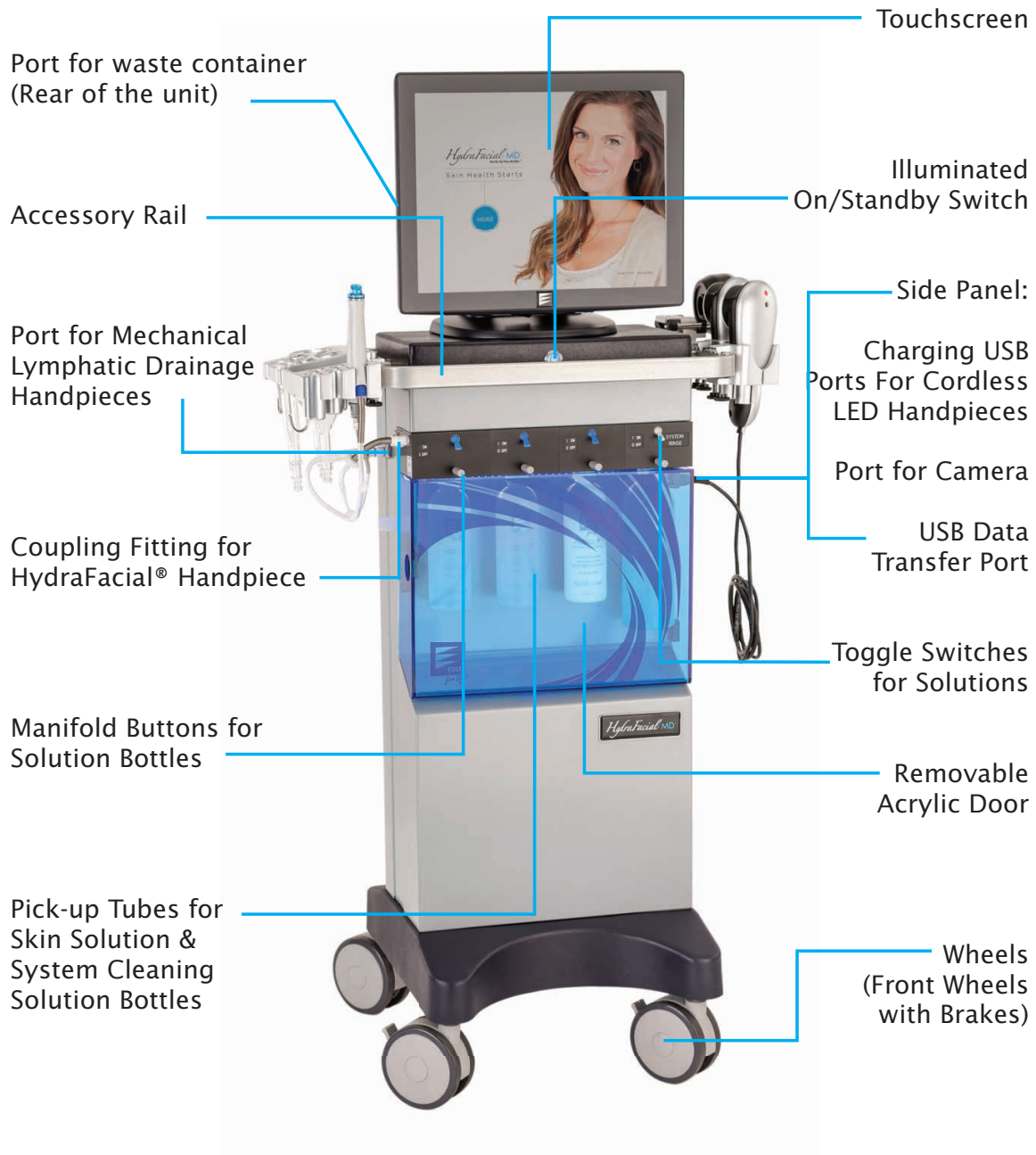

GETTING STARTED

HYDRAFACIAL MD® ELITE™

User Guide

INSTALLATION

TOOL HOLDER

1. Loosen thumbscrews first.
2. Attach the tool holder, top first onto the accessory rail.
3. Tighten the thumbscrews to lock the handpiece holder in place.

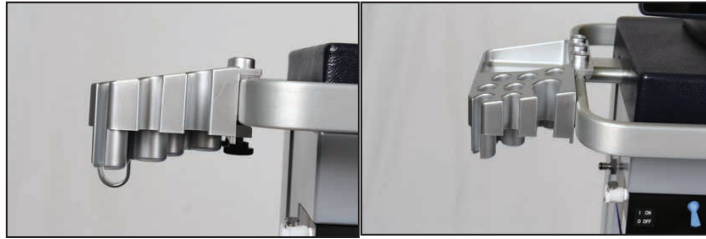

WASTE CONTAINER

1. Attach the waste container lid and secure the clamps.
2. Insert the tube on the lid into the waste container port on the back of the unit.
3. Make sure the waste container sits securely on the ledge. Use a Phillips screwdriver to install the ledge.

Note: Always remove the waste container before transporting the unit.



HydraFacial® HANDPIECE

1. Plug the small tube attached to the HydraFacial® handpiece into coupling fitting.
2. Connect the large tube attached to the handpiece into the waste container.
3. Locate the small tubing with the blue end and connect it to the appropriate end on the handpiece. The blue end corresponds with the blue dot. Twist the knob gently clockwise to secure the tubing.



GETTING STARTED

HYDRAFACIAL MD® ELITE™

User Guide

5. Insert the gray cartridge into the handpiece. Align the arrow on the cartridge with the unlock symbol on the handpiece. Push firmly until it snaps into place, then twist the cartridge up until the arrow aligns with the lock symbol.

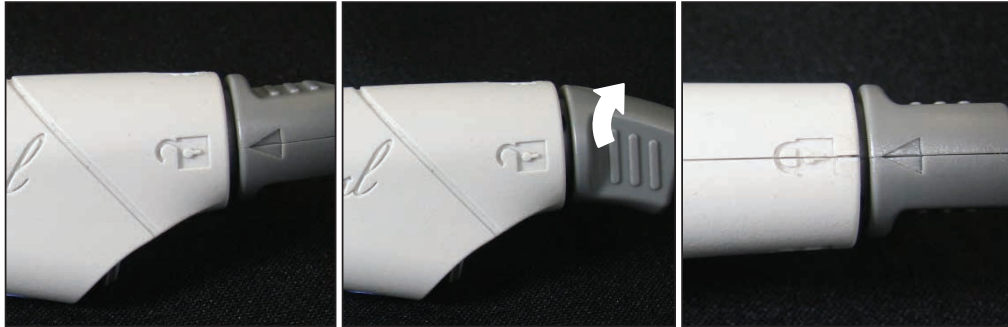

Note: If the gray cartridge is difficult to insert, drizzle a small amount of water into the cartridge to lubricate it, and try again.

HYDROPEEL® TIP

1. Align the HydroPeel® tip and attach it to the handpiece.



2

Single use only

SPECIALTY VIAL:

1. To access specialty vials, remove the gray cartridge from the handpiece by twisting until the arrow aligns with the unlock symbol, then pull the cartridge straight out.



2. Insert the vial into the handpiece. Push firmly until it snaps into place.
Note: Keep all the toggle switches off (see below) while using specialty vials.

GETTING STARTED

HYDRAFACIAL MD® ELITE™

User Guide



3. To re-access the skin solution bottles, remove the specialty vial and insert the gray cartridge into the handpiece. Push firmly until it snaps into place, then twist the cartridge up into the locked position.

SKIN SOLUTION BOTTLES

1. Open the front door. Remove the cap of the skin solution bottle and use the puncture tool to pierce the seal inside the bottle.
2. Press and hold each manifold button as you insert each bottle into the manifold, and then release the button.

Note: The Rinseaway™ System Cleaning Solution should be installed in the manifold with the gray toggle switch labeled “SYSTEM RINSE”.

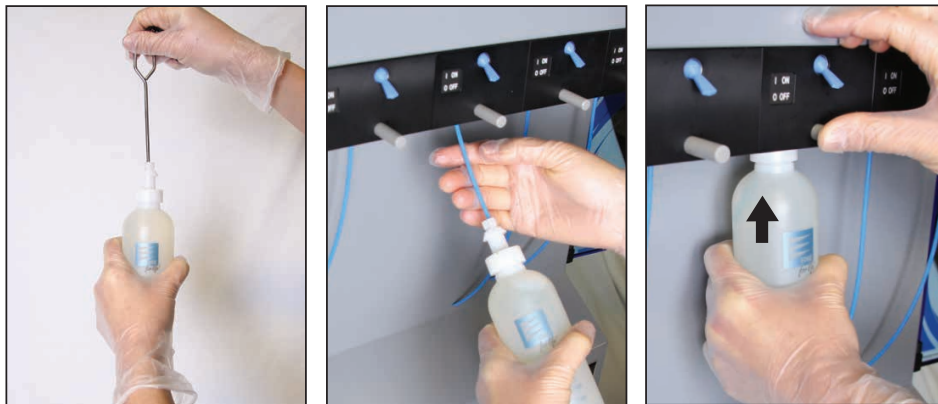

3. The toggle switches control which skin solution bottle is being used. When a switch is in the ON position, fluid will be drawn from that bottle. When switched to the OFF position, no fluid will be drawn from the corresponding bottle.

Note: Always keep the “SYSTEM RINSE” toggle switch (gray) off while performing procedures.

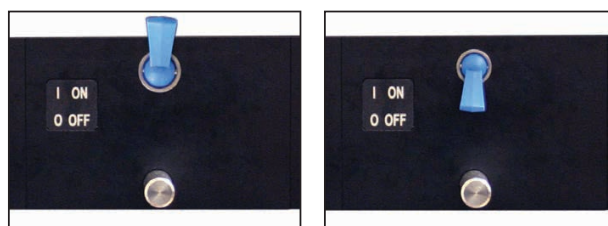

OPTIONAL

If you have purchased the optional kits, please see below.

WET DIAMOND AGGRESSIVE ABRASION (Medical Use Only)

1. Place the diamond pad inside the tip and push it in.
2. Place the tip on the HydraFacial® handpiece and press-in until it is fully seated.

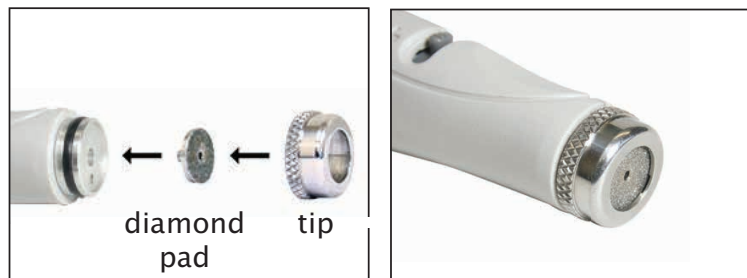

LYMPHATIC DRAINAGE THERAPY HANDPIECES

Mechanical Lymphatic Drainage mode (Optional): This accessory uses vacuum and hollow glass or plastic cups to assist in massage.

1. Plug the metal tube coupling attached to the Dry Handpiece Tubing into the port on the side of the machine.
2. Connect the plastic coupling on the other end of the tubing into the Lymphatic Drainage Therapy handpiece. To connect the tubing, simply press the two halves together until you hear them click into place. To disconnect the coupling halves, press the thumb latch button and gently pull the two halves apart.
3. Place the handpiece(s) in the handpiece holder.
4. Place the tips and accessories on the holder when they are not in use.



WARNING

Never place suction cup over eyes or other body orifice.

GETTING STARTED

HYDRAFACIAL MD® ELITE™

User Guide

UNIVERSAL TOOL HOLDER

1. Loosen thumbscrews first.
2. Attach the tool holder, top first onto the accessory rail.
3. Tighten the thumbscrews to lock the handpiece holder in place.



CORDLESS LED LIGHT THERAPY HANDPIECES (Optional)

1. Refer to LED Light Therapy Handpiece User Guide part number 19692 for details on installation and operation.
2. USB ports for cordless LED Handpieces are located within each of the LED Light holders. Plug the LED handpieces into the appropriate holders in order to recharge.

SKIN IMAGING CAMERA

1. Attach the tool holder, top first, onto the accessory rail. Tighten the thumbscrews to lock the tool holder in place.
2. Insert the cable end connector from the camera into the port located on the right side of the unit. Push in and twist until it is completely locked.
3. Place the camera on the tool holder when not in use.

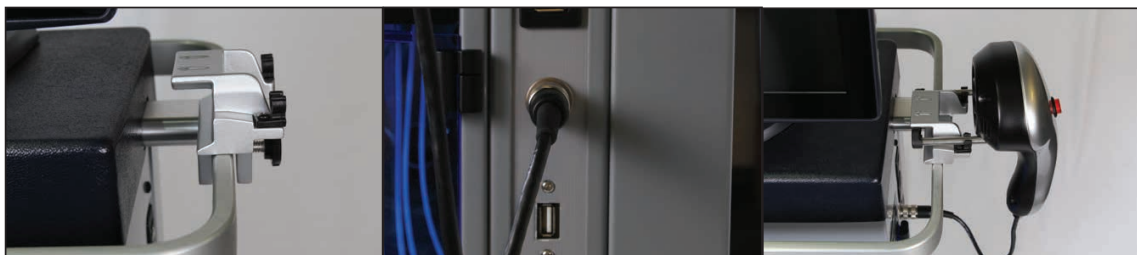

OPERATING INSTRUCTIONS

HYDRAFACIAL MD® ELITE™

User Guide

OPERATION

TURN ON THE SYSTEM

1. Verify the switch on the power entry module located on the back of the unit is in the OFF (o) position. Connect the power cord to the power entry module and connect the plug into a grounded wall outlet. Switch the power entry module switch to the ON (I) position.
2. The Illuminated Power Switch will light up blue. Press the blue Illuminated Power Switch. The machine should begin its boot up cycle at this point. When the HydraFacial® page appears on the screen, select “Here” to go to the main page.

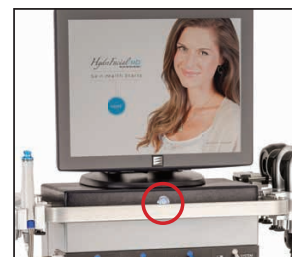

STANDBY / SLEEP MODE

1. Press the Illuminated Power Switch and a “System Cleaning Reminder” will appear on the screen.
2. If you have not cleaned the skin solution stations, press NO and the System Cleaning Protocol screen will appear.
Note: You must clean the skin solution stations before you can turn the system off or switch to the standby mode. Always turn to the standby/sleep mode at the end of each day.
3. If you have cleaned the skin solution stations, press YES and the system will go into standby mode.

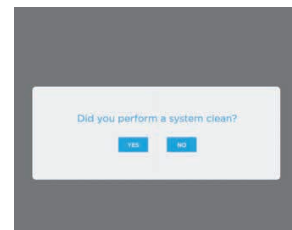

TURN OFF THE SYSTEM

1. Follow the above steps to switch the machine into Stand by/Sleep Mode. Then switch the power entry module switch on the back of the unit to the OFF position, and the machine is completely shut off.

OPERATING INSTRUCTIONS

HYDRAFACIAL MD® ELITE™

User Guide

TOUCHSCREEN OPERATION

1. Lightly tap the buttons displayed on the screen with your **finger tip** (not fingernail). This will cause the unit to perform a variety of functions. If the button does not seem to work, verify that you have actually pressed on the button and did not miss it.
2. There may be a 0.5 second delay when you press the buttons on the touchscreen, so do not press the same button repeatedly if it does not respond immediately.
3. Activate the modality you will be using on the touchscreen by pressing the button.

Note: The touchscreen has been preset for optimal performance with the HydraFacial® program. Thus, you cannot and will not need to adjust the monitor.

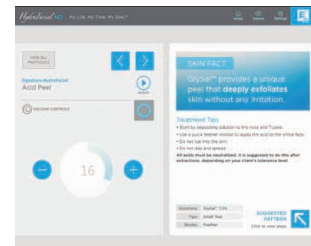
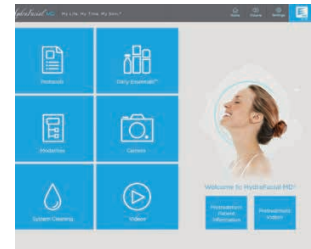

ADJUST FLUID FLOW

1. Turn the flow control valve towards the + sign to increase fluid flow. Turn towards the - sign to decrease fluid flow.

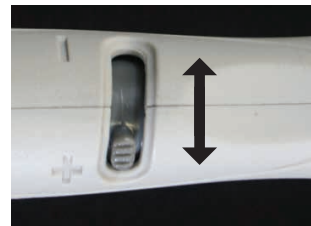

ADJUST VACUUM STRENGTH

1. To adjust vacuum settings, simply press the + button to increase the vacuum or - button to decrease the vacuum strength.
2. On the screen, select 'O' to turn vacuum on or off



OPERATING INSTRUCTIONS

HYDRAFACIAL MD® ELITE™

User Guide

ACTIVATE THE LED LIGHTS (OPTIONAL)

Refer to LED Light Therapy Handpiece User Guide part number 19692 for details on installation and operation.

1. To operate the LED Lights, go to the Home screen and select “Modalities.” Then select “LED Light Therapy”.
2. Choose either Red, Blue, or Red & Blue LED Lights.
3. Select 1 Light or 2 Lights, then press Start.
4. An area of the face will light up, guiding you to continue treatment.
5. Follow the instructions on the screen.

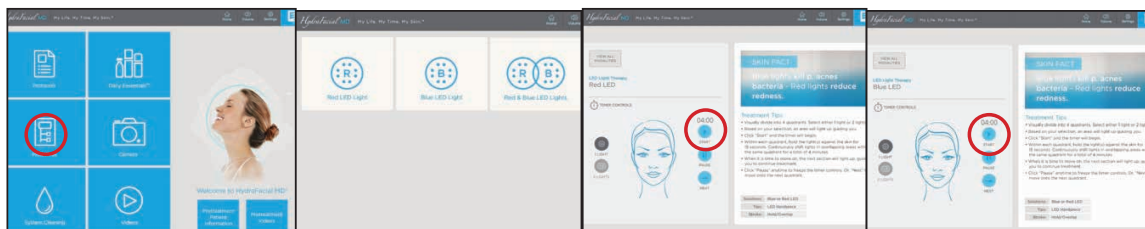

ACTIVATE SKIN IMAGING CAMERA

1. To operate the camera, go to the Home screen and select “Camera”.
2. A prompt will appear requesting you to create a new profile or select a profile already in the system.
3. In the member screen, either create a new profile or search for a member by name, date of birth or telephone number.
4. After creating a new profile or selecting the member's profile from the system, the “Photo Capture” button should turn from gray to blue.
5. To capture a photo, place the chin rest against the chin. There are three options for capturing a photo:
 - In the member profile screen, select the “Photo Capture” button or
 - On the camera, press the red button or
 - Use the foot switch to capture a photo. To install the foot switch, plug the USB cable into one of the USB ports located on the right side of the unit.

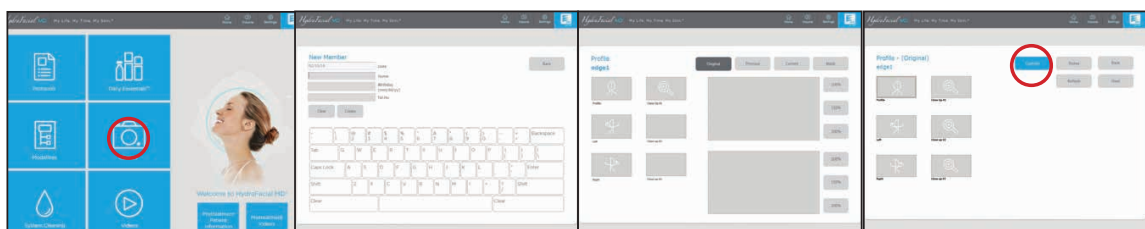

SYSTEM CLEANING AND PREVENTIVE MAINTENANCE

The HydraFacial MD® Elite™ system needs to be cleaned after each procedure. Cleaning is especially important after the usage of vials.

Skin Solution Stations And Tubing

AFTER EACH SERVICE

1. Wearing gloves is recommended.
2. After each procedure, run the “system cleaning process”. Start by switching all the blue toggle switches down to the “OFF” position, and switch only the gray toggle switch “SYSTEM RINSE” up to the “ON” position.



3. Make sure that the Rinseaway™ system cleaning solution is properly installed. **Only use the Edge System Rinseaway™ Solution**; it is specifically developed to flush through the tubing line to remove and prevent any product or impurity build-up. Partially used skin solution bottles must be capped and stored in a cool place.
4. Turn the unit on and **set vacuum setting to 26**.
5. Use the cleaning cap (as shown) to occlude the handpiece. Turn the flow control valve all the way towards the + sign, and let the cleaning process run for **20-30 seconds**. Extend to **1 minute** after each service day. The cleaning cap can also be used as a protective cap.
6. When completed, be sure to switch the toggle switch to the “OFF” position.
7. Empty the waste on the back of the unit at the end of each service day. **Do not let the waste container fill above 450ml.**
8. Wash, dry, and wipe/spray germicide over waste canister and lid. Leave open overnight to air-dry.



WEEKLY CLEANING

1. Wearing gloves is recommended.
2. Use the Rinseaway™ solution on each individual skin solution station to prevent/remove any clogging. Follow the above instructions to clean/flush your system.
3. When completed, be sure to switch all the toggle switches to OFF position.

HydraFacial® Handpiece

The HydraFacial® handpiece tubing chambers must be cleaned and disinfected using the cleaning brush **every week** to prevent any bacterial contamination.

The HydraFacial® Handpiece



1. Ensure all the blue toggles switches are in the OFF position. Turn gray toggle switch "SYSTEM RINSE" up to the ON position and vacuum setting on "26". Attach cleaning cap and flush through the handpiece and tubing for 1 minute
2. Detach the handpiece from all tubing. Gently twist the knobs counter-clockwise to detach each tube from the handpiece.
3. Insert the cleaning brush into the vacuum (smaller opening) on the face of the handpiece. Push it in gently all the way, while rotating in either direction. Repeat with the opening on the back with the blue dot. A few drops of disinfectant may be dropped onto the "face" of the hand piece (held in an upright position) allowing the disinfectant to run into the handpiece opening before inserting the cleaning brush.

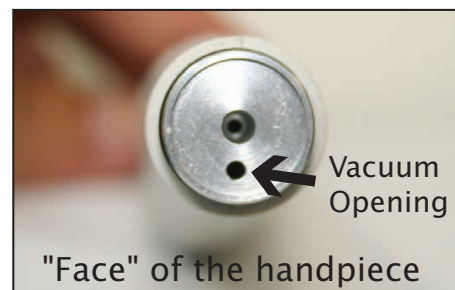
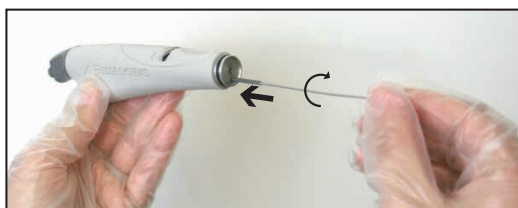
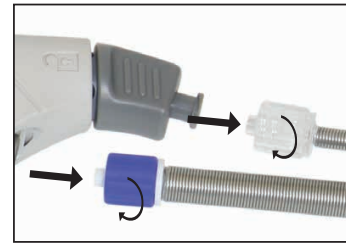

4. Wash the brush bristles in soapy water between each handpiece opening insertion to clean off debris.

SYSTEM CLEANING

HYDRAFACIAL MD® ELITE™

User Guide

5. When the brush and air cleaning are completed, make sure all the blue toggle switches are in the OFF position. Turn the gray toggle switch "SYSTEM RINSE" up to the ON position and the **vacuum setting on "26"**. Press on the cleaning cap and flush through the handpiece and tubing for **1 minute**.

DURING TREATMENT, USING SPECIALTY VIALS

1. Fill a small bowl with Rinseaway™ Solution and place next to treatment station.
2. Make sure to remove GlySal™ cartridge and replace with gray cartridge with no toggles on.
3. **Set vacuum to 12** and dip the handpiece with tip attached into the bowl of Rinseaway™ for 5 seconds.
4. Throw away bowl after each cleaning.

Other

WASTE CONTAINER

1. Wash, dry, and wipe/spray germicide over waste canister and lid. Leave open overnight to air-dry.

Note: Always remove the waste container before transporting the unit.

TOUCHSCREEN

WARNING

To avoid risk of electric shock, do not disassemble the unit cabinet. The unit is not user serviceable. **Remember to shut down system and unplug it from power outlet before cleaning.**

Note: Do not use alcohol (methyl, ethyl or isopropyl) or any strong dissolvent. Do not use thinner or benzene, abrasive cleaners, or compressed air.

1. To clean the touchscreen, use window or glass cleaner. Put the cleaner on a microfiber cloth and wipe the touch screen.
Never apply the cleaner directly on the touchscreen.
Note: Avoid getting liquids inside your touchscreen. Do not wipe the screen with a cloth or sponge that could scratch the surface.

REMOVABLE FRONT DOOR

1. To clean door use a plastic cleaner available at your nearest hardware store (for example: Novus plastic clean and shine). **Never, under any circumstances use any type of alcohol to clean front door.**

Options

WET DIAMOND AGGRESSIVE ABRASION (MEDICAL USE ONLY)

1. It is always recommended to use gloves for this process.
2. After each use, remove abrasive pads and tip. Drop in hot water and let them soak for about 10 minutes, softening any debris surrounding both pads and tip.



3. Place abrasive pad under running water and brush away all the debris with the included brush. Rinse away any debris very thoroughly.

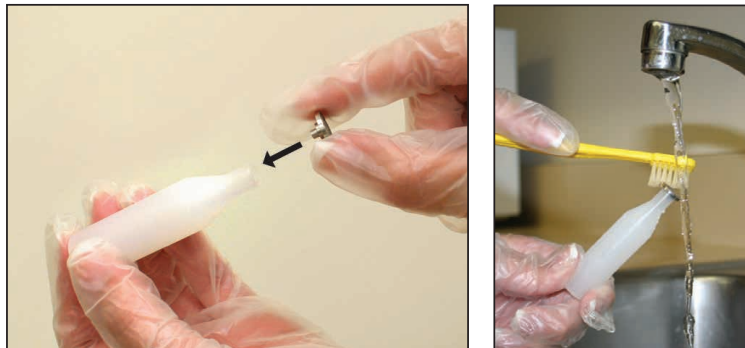

4. It is recommended to use an ultrasonic cleaner with a disinfectant solution to thoroughly clean the abrasive pads and tip of any debris that may have been embedded between the diamond grits during use. Please follow the suggested dilution ratio from the manufacturer.
5. For maximum sterility, abrasive pads, tip, and pad holder are autoclavable following manufacturer's instructions.



MECHANICAL LYMPHATIC DRAINAGE HANDPIECES

1. Wipe off excess treatment lotion after each procedure.
2. Clean the handpiece appropriately using cold sterilization or autoclave following manufacturer's instructions.

LED LIGHT THERAPY HANDPIECES (Optional)

Refer to LED Light Therapy Handpiece User Guide part number 19692 for details on installation and operation.

SKIN IMAGING CAMERA

Clean the chin rest with an alcohol wipe after each use.

TROUBLESHOOTING

HYDRAFACIAL MD® ELITE™

User Guide



TROUBLESHOOTING

Problem	Possible Cause	Solution
No Power	Power cord	Make sure power cord is properly connected to back of the unit and to a working wall outlet.
	Fuses	Unplug unit from main wall outlet prior to this. Use a small flat head screwdriver to remove the fuse holder box located in between the ON/OFF switch and power cord, and check that fuses are in good working conditions (not blown).
Touchscreen	Blank screen / No video signal	If the main power is “ON” and the touchscreen is blank, press the power button located on the right hand side of touchscreen. Check video cable connection in the rear.
	No image, or inverted image on the screen	Call your local representative or Edge Systems for assistance.
	Screen does not respond to touch	
Low or No Fluid Flow	Toggle switch	Make sure the switch is on.
	Empty bottle	Make sure your skin solution bottle is not empty.
	Improper connection	Make sure that your HydraFacial® handpiece is properly connected to the side of the skin solution station block, and to the waste container. Also, make sure that the lid is firmly attached to the waste container.
	Tip is improperly installed	Make sure the tip is firmly installed onto the handpiece. Angled tips should face downwards in order to facilitate flow.
	Flow control valve is closed	Make sure the flow control valve on the handpiece is open. To increase fluid flow, turn the flow control valve towards the + sign. 

TROUBLESHOOTING

HYDRAFACIAL MD® ELITE™

User Guide

Problem	Possible Cause	Solution
Low or No Fluid Flow	Leak in the line	Check lines for any kinks or leaks. Repuncture bottle if needed.
	Too many solution stations are on	Make sure you only have a maximum of two skin solution stations on the "ON" position.
	Faulty station	If using only one station at a time, turn current station off and try another station, if this corrects the problem please check on the previous station that internal bottle seal is completely broken and pick up assembly (metal portion) is fully submerged.
	Operator technique	Make sure that you are holding the handpiece correctly and not working against gravity or blocking the tubing.
	Waste container is full	Do not let the waste container fill above 450ml. If the container becomes overfull, a built-in float will occlude the vacuum opening and skin solution flow through the handpiece will cease. Empty the waste container after each service.
	Clogging	Flush all stations thoroughly. Make sure the machine is cleaned after each service.
	Gray cartridge is loose	Make sure that the gray cartridge is properly inserted into the handpiece. The arrow on the cartridge should line up with the lock symbol. 
Too Much Fluid Flow	Make sure the flow control valve on the handpiece is not open too far. The default setting for the flow control valve is 50% open. To decrease fluid flow, turn the flow control valve towards the - sign. 	

TROUBLESHOOTING

HYDRAFACIAL MD® ELITE™

User Guide

OPTIONS

Problem	Possible Cause	Solution
Low or No Vacuum Flow for Lymphatic Drainage Handpieces	Kinks or leaks	Check lines for kinks or leaks.
	Improper connections	Make sure the dry handpiece tubing assembly and corresponding attachments are properly connected.
	Occluded filter	If you conduct an excessive number of massage procedures, you may occlude filter, which in turn will reduce vacuum performance. Please call your local representative or call Edge Systems to order a replacement part.
LED Light Handpiece Not Working	Improper connection	Make sure the light handpiece is connected to the proper color-coded receptacle.
	Unit is not activated	Make sure that you pressed the button for red light or blue light on the touchscreen to activate the light handpiece. Also make sure you press the button on the back of the handpiece.
LED Light Handpiece Not Working	Refer to LED Light Therapy Handpiece User Guide part number 19692 for troubleshooting solutions.	
Camera Not Working	Unit is not on	Check that the cable end connector is securely inserted into the port.
Camera Not Taking Photos	Connection issue	Disconnect the camera, and then reconnect the camera to the unit. Reboot the system.
Unable to Create New Member Profile or Store Photos	Out of storage memory	Back up photos on a regular basis with the 32GB USB flash drive provided with the Camera kit option. Go to Settings and select "Photo Backup/Restore."
Currently Stored Photos Are Erased After Restoring Photos	Restoring photos overrides current photos stored in the system.	Ensure current photos in the system are backed up before restoring previous photos to the system.

Note: Circuit diagrams & component part lists are available upon request for service technicians.