

CANVAS^{TM/MC}

VALENCIA COLLECTION

Day Bed and Swing

MODEL NO. 088-1682-2

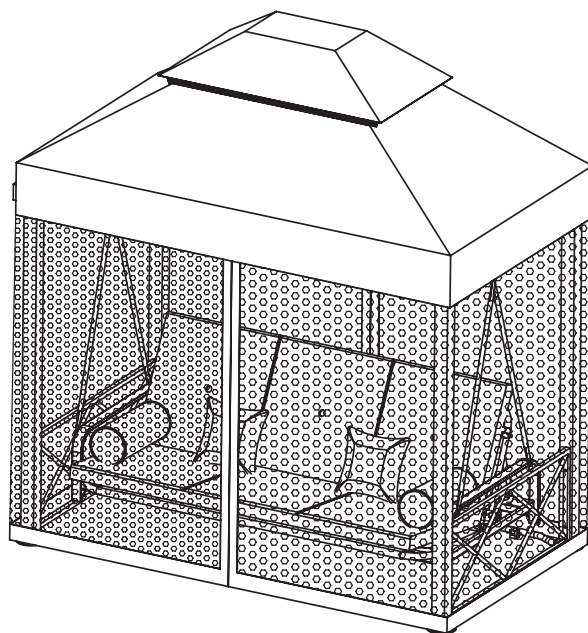

ASSEMBLY INSTRUCTIONS

Toll-free: 1-888-670-6684

IMPORTANT: Please read this manual carefully before beginning assembly of this product.
Keep this manual for future reference.

TABLE OF CONTENTS	2
Important Safety Instructions	2
Parts List	3
Assembly	5
Cleaning and Maintenance	14
Technical Specifications	14
Warranty	14

• **SET UP YOUR FURNITURE PROPERLY**

Ensure that all parts are assembled properly and fully tightened as per the instructions. When placing in the desired location, ensure that all legs are resting on the same surface. You may adjust the legs levellers as required to ensure that the item stands in a rigid position.

• **EXAMINE YOUR FURNITURE**

Examine occasionally to ensure that there are no loose parts. If loose parts are found, they must be retightened fully before additional use.

- Do not completely tighten bolts and nuts until indicated in assembly step.

IMPORTANT: Retain for future reference, and read carefully.

1
Leg post - 2 

2
Leg post - 2 

3
Side panel - 2 

4
Long top crossbar - 2 

5
Short top crossbar - 2 

6
Rear leg crossbar - 1 

7
Right arm - 1 

8
Left arm - 1 

9
Front seat support bar - 1 

10
Rear seat support bar - 1 

11
Seat and back - 1 

12
Hanging bar - 4 

13
Large canopy frame - 1 

14
Canopy frame bar - 4 

15
Small canopy frame - 2 

16
Small canopy frame bar - 1 

17
Cushion - 1 

18
Pillow - 2 

19
Large canopy - 1 

20
Small canopy - 1 

21
Net - 1 

22
Throw pillow - 2 

A
M6*12 bolt - 4 

B
M6*25 bolt - 2 

C
M6*30 bolt - 4 

D
M6*36 bolt - 2 

E
M8*15 bolt - 4 

F
M8*35 bolt - 8 + 1 spare 

G
M8*60 bolt - 4



H
M8*80 bolt - 2



I
M6 nut - 4



J
M8 nut - 6



K
M6 metal washer - 4



L
M8 metal washer - 22



M
Plastic washer - 2



N
S-hook - 2



O
U-bracket - 4



P
Open wrench - 1



Q
Hex wrench - 1



R
M8 wrench - 1

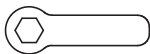



Let us help you!

**DO NOT RETURN YOUR PRODUCT TO THE STORE. CALL US FIRST!
1-888-670-6684**

If you have questions regarding your product, require warranty assistance, or have damaged or missing parts, please call our customer service toll-free helpline. Contact us for assistance; we're here to help.

IMPORTANT: Please read and understand this manual before any assembly. Before beginning assembly of product, make sure all parts are present. Compare parts with packaging contents list. If any part is missing, or if you have any questions, contact the service centre at 1-888-670-6684 (toll-free).

Place all parts from the box in a cleared area and position them on the floor in front of you. Remove all packing materials and place them back into the box. Do not dispose of the packing materials until assembly is complete. Read each step carefully before beginning any assembly and make sure you understand each step. If you are missing a part, please call our toll-free number for assistance: 1-888-670-6684 between 9:00 am to 5:00 pm Eastern standard time Monday through Friday.

Needed for assembly:



2 people

Step 1

Requires 1, 2, A, O.

Insert a bolt A through the U-shaped bracket O, and secure into the leg top 1 or 2. Do not tighten. Repeat for the remaining 3 legs.



Not actual size.

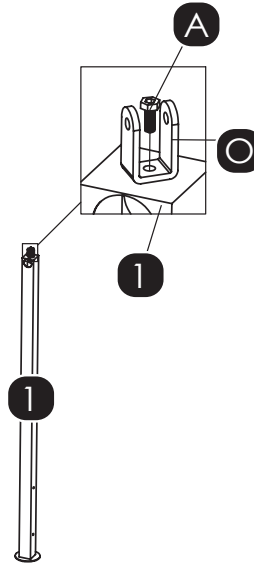

Step 2

Requires 1, 2, 3, F, L.

Attach the side panel 3 to 2 legs 1 and 2 by inserting a bolt F through a metal washer L, through the hole of the side panel 3, and secure into the leg 2. Make sure the arrow "↑ ↑" is pointing up. Repeat procedure for the other leg 1. Do not tighten completely. Repeat procedure for the other side panel.



Not actual size.

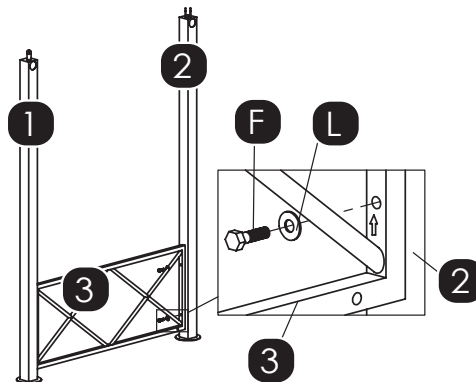

Step 3**Requires 1, 2, 4, E, L.**

Insert two long top crossbars **4** into the holes at the top of each leg. Line up the holes. For each hole insert a bolt **E** through a metal washer **L**, through the leg, and secure into the long top crossbar **4**. Do not tighten completely. Repeat procedure for the other long top crossbar.

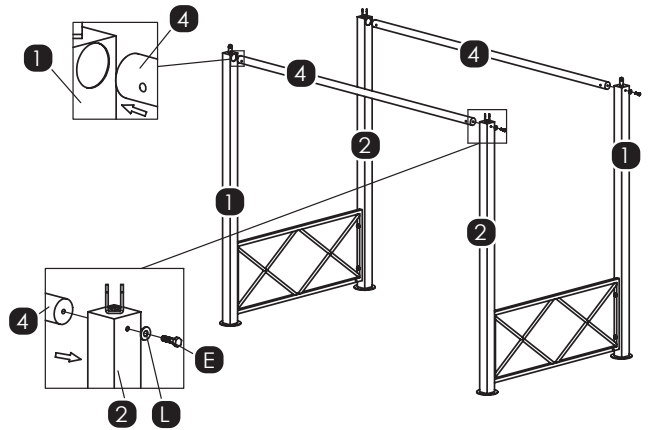

Not actual size.

**Step 4****Requires 4, 5, G, J, L.**

Attach a short top crossbar **5** onto the long top crossbars **4**. Make sure the U-shaped brackets of the short top crossbar **5** are facing down. Line up the holes. For each hole, insert a bolt **G** through a metal washer **L**, then through the outer side of the bracket on the short top crossbar **5**, the long top crossbar **4**, the inner side of the bracket on the short top crossbar **5**, another metal washer **L**, and secure with a nut **J**. Do not tighten completely. Repeat procedure for the other side.



Not actual size.

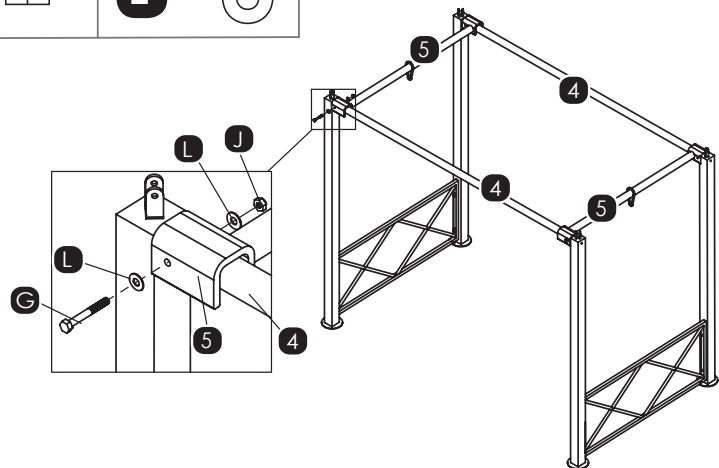

Step 5

Requires **3, 6, D, K, P, Q, R.**

Place the rear leg crossbar **6** between the side panels **3**. Line up the holes. Insert a bolt **D** through a metal washer **K**, through the side panel **3**, and secure into the rear leg crossbar **6**. Do not tighten completely. Repeat procedure for the other side. Tighten all bolts and nuts from step 1 to step 5 by using the wrenches provided (except bolt **A**).

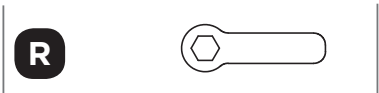

Not actual size.

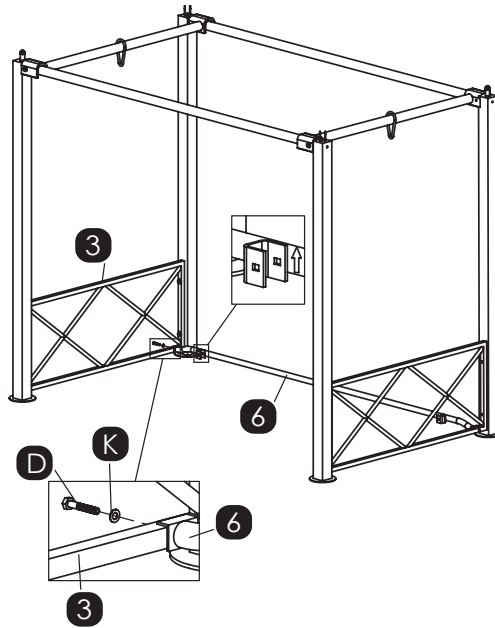

Step 6

Requires **7, 8, 9, 10.**

Lay out the right arm **7**, left arm **8**, front seat support bar **9** and rear seat support bar **10**. Make sure that the labels marked "FRONT" on the arms and seat support bars are all facing the front edge of the seat. Attach the seat support bars to the arms by pressing the tabs on the ends of the seat support bars down into the brackets on the arms. Make sure they are securely seated.

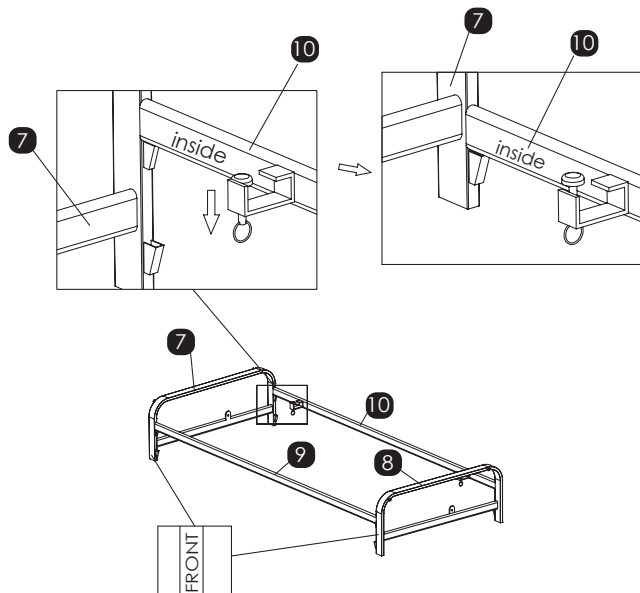

Step 7**Requires 7, 8, 11, H, J, L, M, P, R.**

Unfold the seat and back 11 and lay it on top of the frame. Line up the holes in the arms 7 and 8 with the holes in the side tubes of the seat and back 11. Insert a bolt H (from outside to inside) through the bracket of the arm, through a plastic washer M, through the side bar on the seat and back, through a metal washer L and secure with a nut J. Do not tighten completely. Repeat procedure for the other side. Then securely tighten the bolts and nuts.

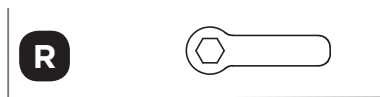
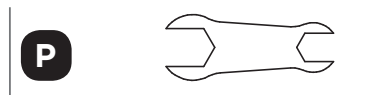
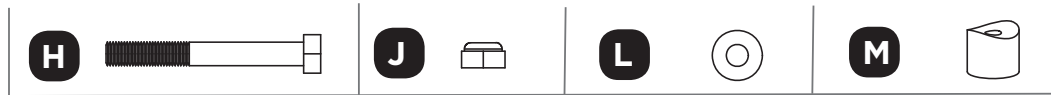

Not actual size.

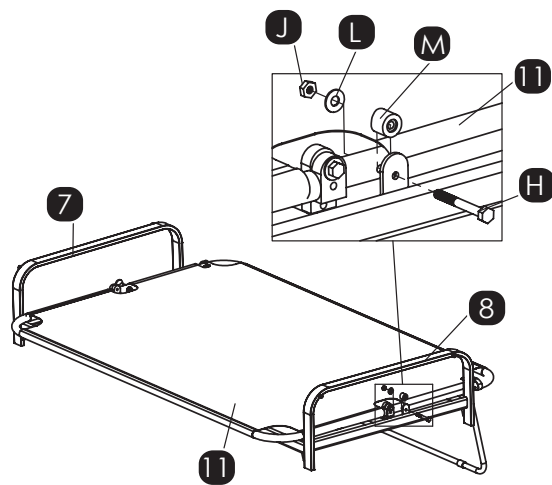
**Step 8****Requires 10, 11.**

Raise the back side of the seat and back 11 and fasten the U-shaped bracket of the back support tube to the rear seat support bar 10 as per the drawing.

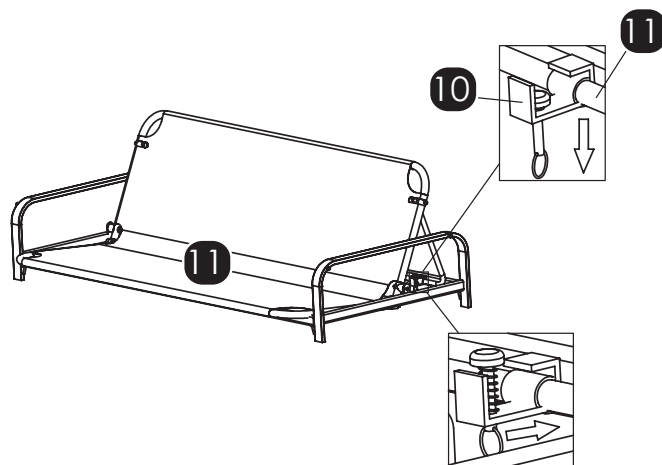

Step 9

Requires 5, 7, 8, 12, N.

Attach the hanging bars 12 to the arms by sliding the bottom hole in the bars over the pins on the outside of the arms 7 and 8. Position the bars so that the end labelled "TOP" is up and facing toward the swing seat. At each end of the seat assembly, bring together the holes in the top ends of the hanging bars and thread them on to a "S" hook N. Hang the "S" hooks from the loops on the short top crossbar 5.

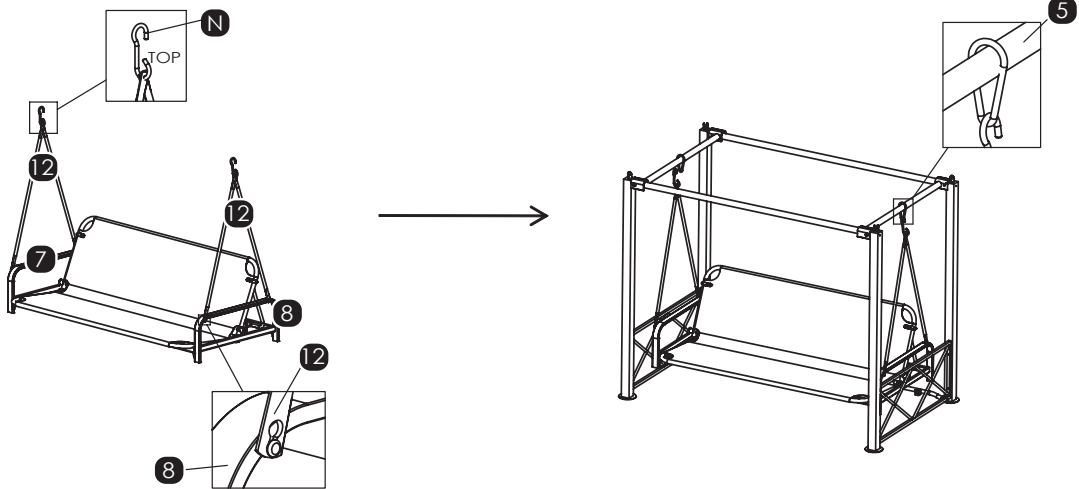

Step 10

Requires 13, 14, 19.

Insert large canopy frame bars 14 into the large canopy frame 13 as per drawing. Place the large canopy 19 over the assembled canopy frame 13 and 14 as shown.

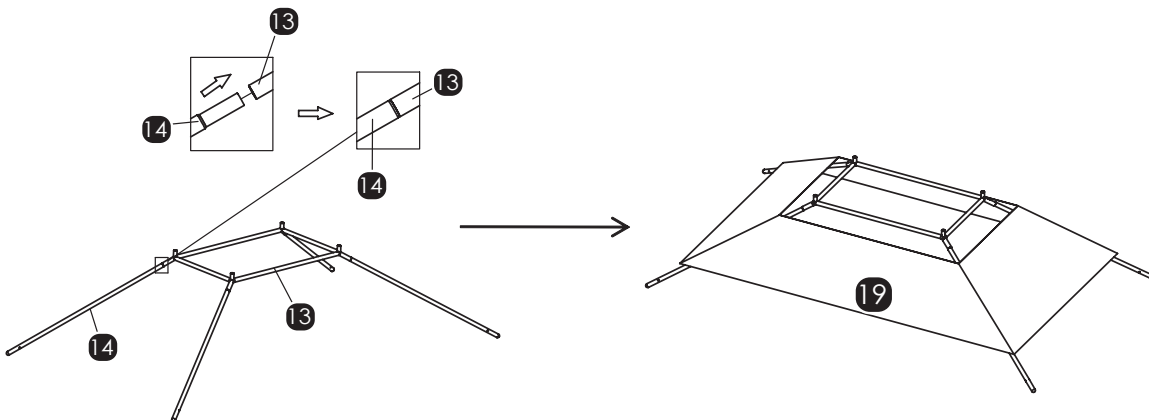

Step 11**Requires 13, 15.**

Insert the small canopy frame 15 into the large canopy frame 13 as per drawing.

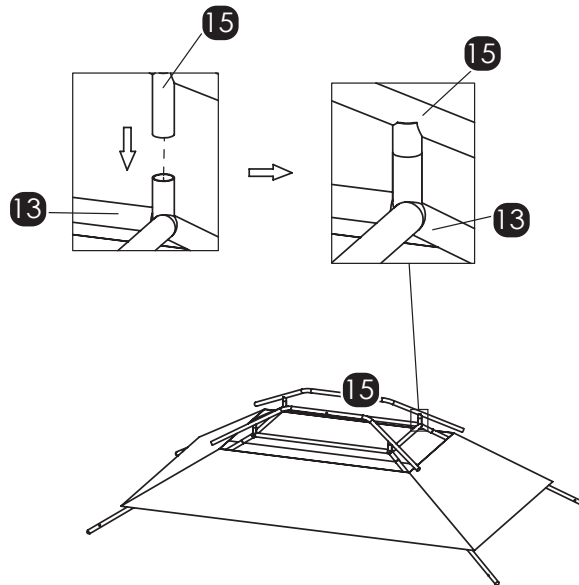
**Step 12****Requires 15, 16, 20, B, K.**Insert a bolt **B** through the metal washer **K**, through the small canopy frame 15, and into the small canopy frame bar 16. Repeat procedure on the other side. Do not tighten completely. Then insert the small canopy frame 15 into the small canopy 20.

Not actual size.

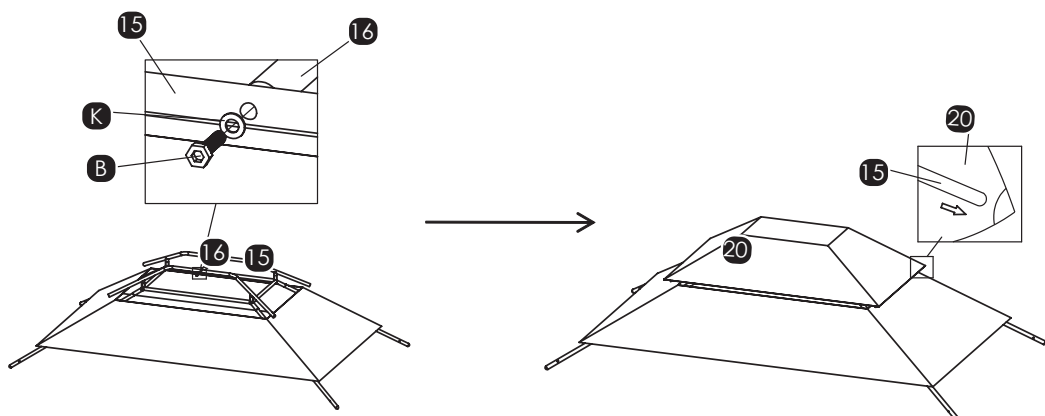

Step 13

Requires 14, 19, 20, C, I, O, P, Q, R.

Place the assembled canopy top frame on the assembled swing frame. Insert a bolt C through one side of the U shaped bracket O at the top of the leg, through the canopy frame bar 14, through the other side of the U shaped bracket, and secure with a nut I. Do not completely tighten. Repeat procedure for the remaining 3 canopy frame bars 14. Tighten all bolts and nuts from step 1 to step 13 using the wrenches.

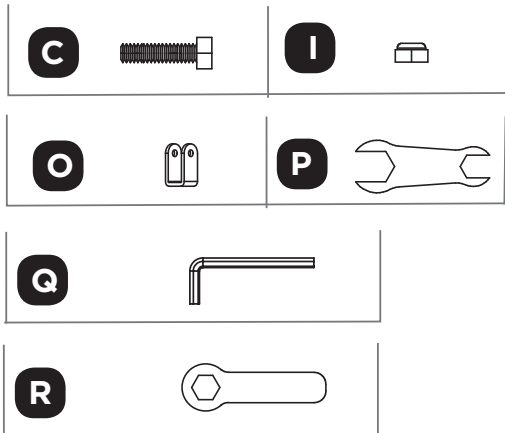

Not actual size.

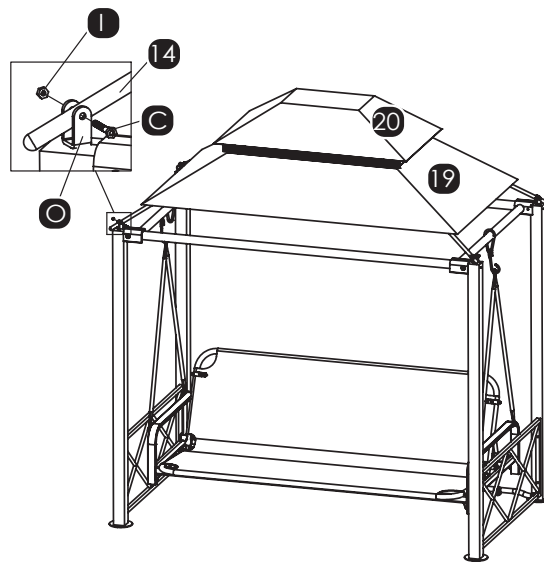

Step 14

Requires 14, 17, 18, 19, 20, 22.

Insert the large canopy frame 14 into the large canopy 19 and 20. Put cushion 17, pillow 18 and throw pillow 22 on.

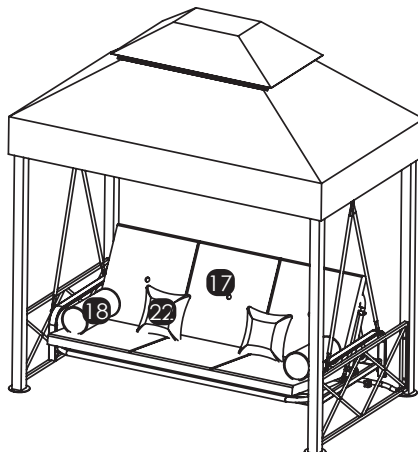
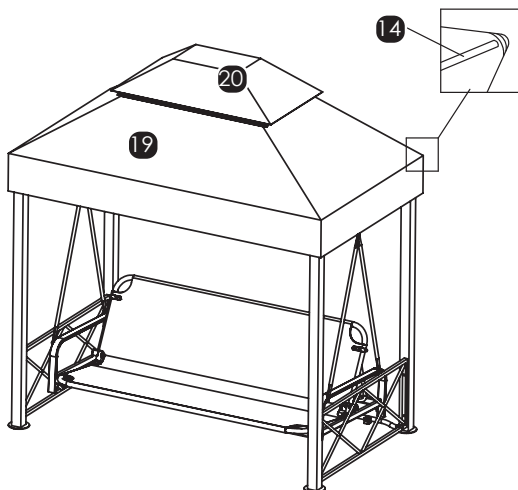

Step 15**Requires 6, 10, 11**

To convert the swing into a hanging bed, push down the spring ring-pull on rear seat support bar **10** first. Then release the back support tube from the rear seat support bar **10** and fasten it to the U-shaped bracket on the rear leg crossbar **6**. When used as a bed, the seat assembly should be secured by these holders and not allowed to swing.

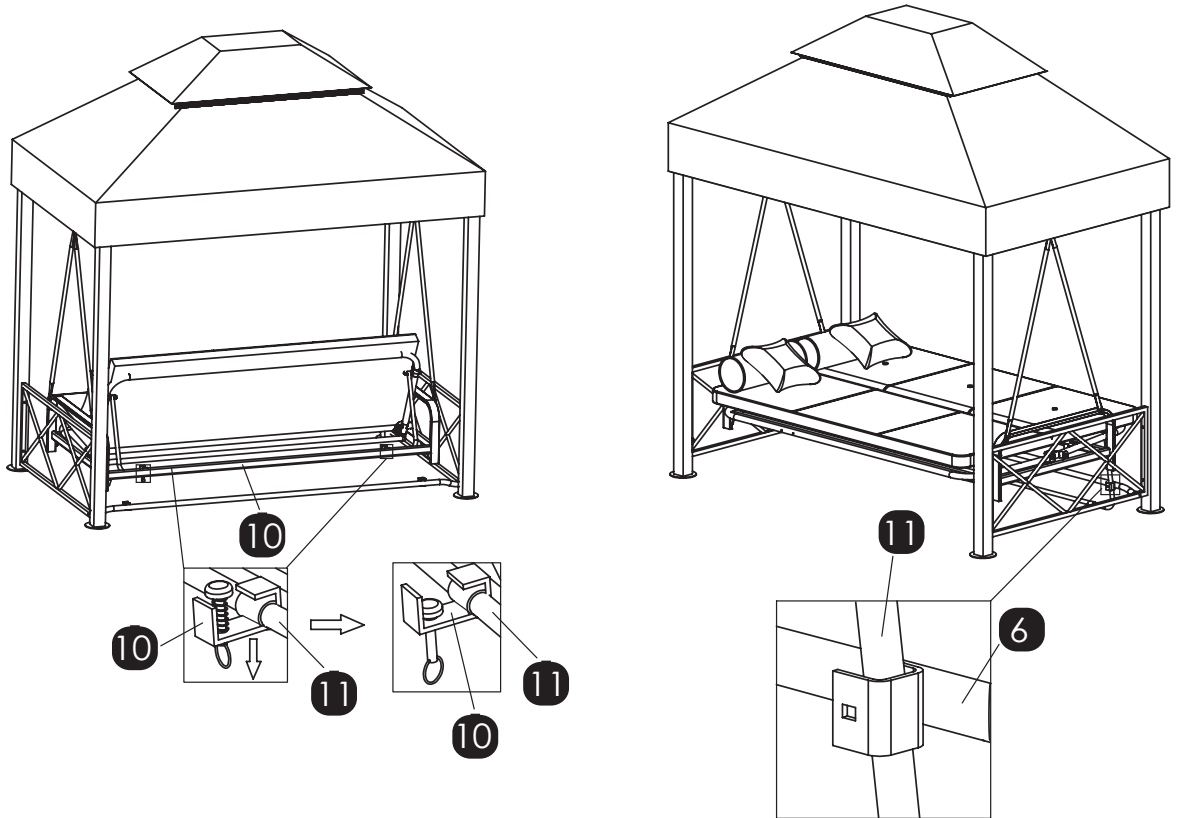
**Step 16****Requires 19, 21.**

Attach the net **21** to the large canopy **19** by hook-and-loop strip.

The net zipper goes in the centre of the top crossbar.

Your swing is ready for use!

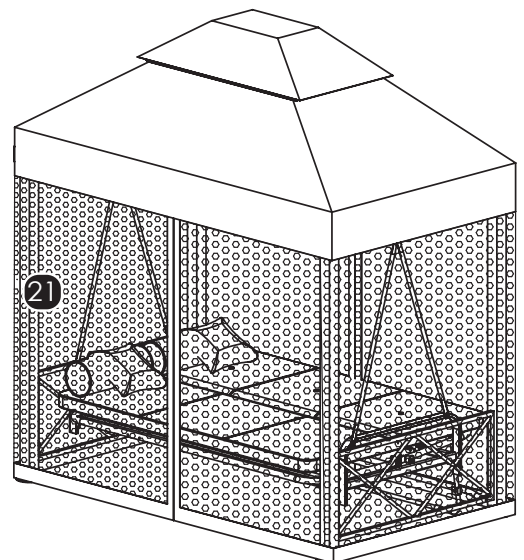

14 MODEL NO. 088-1682-2

- Though its powder-coated finish is rust-resistant, steel is prone to rust over time with exposure to the elements. In case of rust or scratches, lightly sand the affected area and apply touch-up paint. To maintain the finish, periodically apply wax with a soft cloth.
- Wash frames with a mild solution of soap and water; rinse thoroughly. Do not use bleach or solvents.
- **CARING FOR OUTDOOR FURNITURE WITH CUSHIONS:**
Wash frames and cushions with a mild solution of soap and water; rinse thoroughly. Dry frame completely and allow cushions to drip-dry. Do not use bleach or solvents.

Dimensions (L x W x H)	208 x 131 x 229 cm
	82 x 51 1/2 x 90"
Product weight	70 kg
	154 lb
Weight capacity	275 kg
	600 lb

WARRANTY

This CANVAS product carries a one (1) year warranty against defects in workmanship and materials. Trileaf Distribution agrees to replace the defective product free of charge within the stated warranty period, when returned by the original purchaser with proof of purchase. This product is not guaranteed against rust, wear or breakage due to misuse and/or abuse.

Made in China

Imported by
Trileaf Distribution Trifeuil Toronto, Canada M4S 2B8