

## Effimero Medium Hanging Pendant Clear Glass Shade

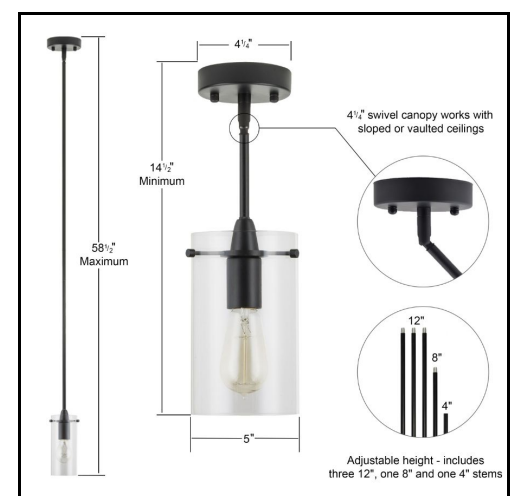

### Product Overview

Ideal for kitchen island lighting, as a kitchen table light, a dining room hanging light, hallway light or bedroom light

- Quality metal construction with a clear glass cylinder shade
- Measures 5 inches wide by 14.5 inches high; shade measures 5 inches in diameter by 8 inches high
- No visible wiring.. Adjustable stem mounted: 14.5 inches minimum hanging height and 58.5 inches maximum hanging height; includes 5 hard stems in assorted lengths to allow for a variety of hanging heights three 12 inches long, one 8 inches long and one 4 inches long
- 4.25 inch round swivel canopy works with sloped or vaulted ceilings
- Uses one E26-base bulb, 60W max (not included) compatible with smart bulbs
- Dimmable when used with a dimmable bulb and compatible dimmer switch
- UL listed
- Must be hardwired
- 1 year manufacturer warranty with US based customer service
- Available in brushed nickel, chrome, satin brass and black finishes

## Effimero Medium Hanging Pendant, Clear Glass Shade

### Technical Specifications

#### Dimensions

<b>Item Weight</b>	2.89 pounds
<b>Product Dimensions</b>	5 x 5 x 61.5 inches
<b>Assembled Height</b>	14.5 inches
<b>Assembled Length</b>	14.5 inches minimum hanging height and 58.5 inches maximum hanging height
<b>Assembled Width</b>	5 inches
<b>Shade Dimensions</b>	5 inches in diameter by 8 inches high

#### Bulb

<b>Bulb Included</b>	No
<b>Bulb Base</b>	E26
<b>Compatibility</b>	Works with most medium base bulbs up to 60W, compatible with smart bulbs
<b>Dimmable</b>	Dimmable when used with a dimmable bulb and compatible dimmer switch

#### Construction

<b>Material</b>	Metal
<b>Shade</b>	Glass
<b>Style</b>	Contemporary

#### Electrical Specifications

<b>Voltage</b>	120 Volts
<b>Wattage</b>	60W max
<b>Damp Rated</b>	Yes
<b>Installation</b>	Must be hardwired, does not have a switch
<b>Certifications</b>	UL/CUL

#### Mounting

<b>Canopy</b>	4.25 inch round swivel canopy works with sloped or vaulted ceilings
<b>Compatibility</b>	Compatible with most junction boxes

#### Additional

<b>Color</b>	Varies
<b>Shade Color</b>	Clear Glass
<b>Light Direction</b>	Downlight
<b>Options</b>	Available in small, medium and large sizes; black, brushed nickel, chrome and satin brass finishes; clear, frosted and smoked glass shades. Also available in multi-light cluster pendant lighting. Single wall sconces and two, three and four light vanity lights also available.
<b>Waranty</b>	1 year limited warranty