

LINEA ■ LIGHTING

Plug-In Table Lamp LL-TL814

ASSEMBLY INSTRUCTIONS

REMOVE ALL PARTS FROM PACKAGE, BE CAREFUL NOT
TO DAMAGE ANY COMPONENTS.

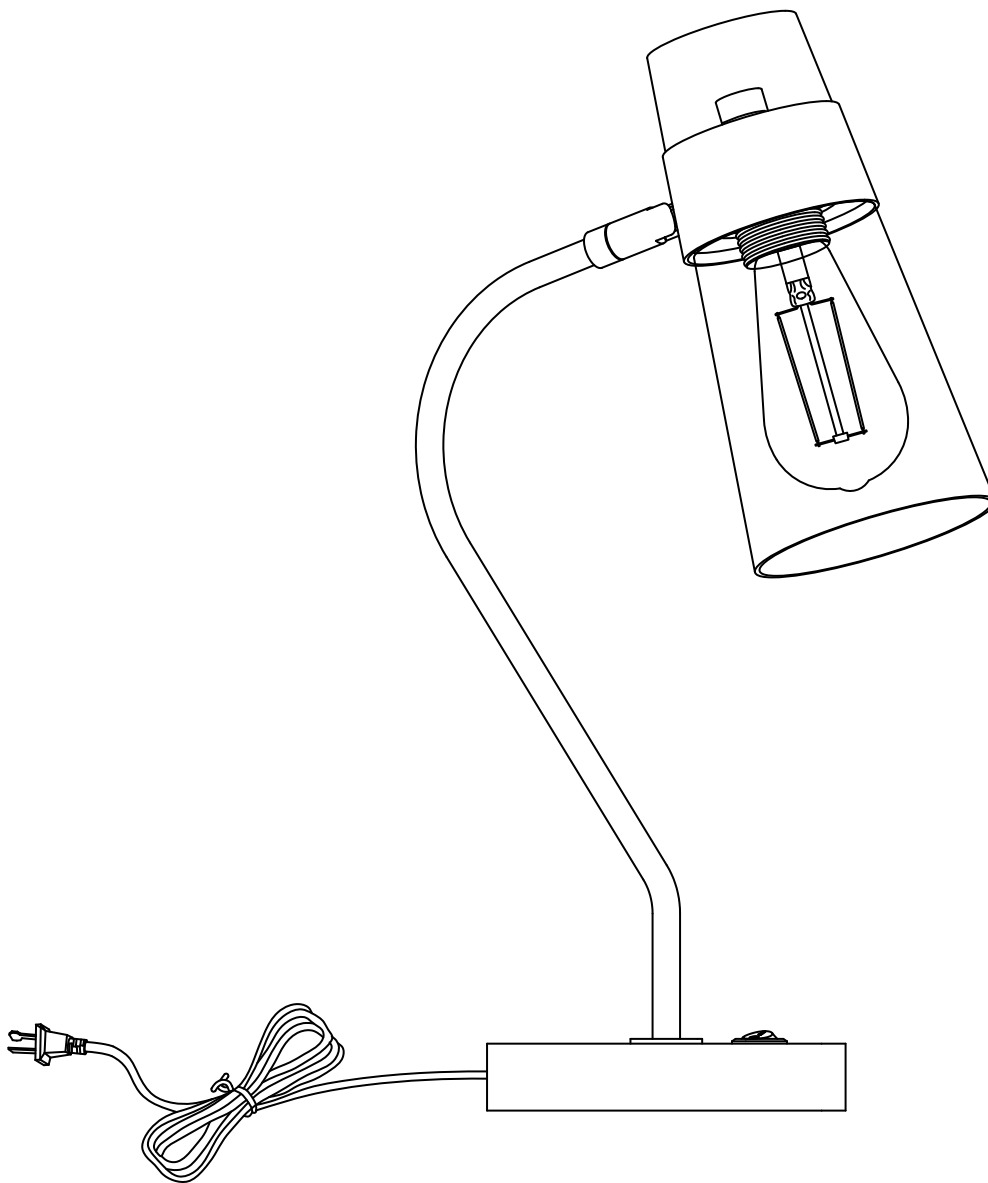

PROFESSIONAL INSTALLATION RECOMMENDED

LINEA ■ LIGHTING

Plug-In Table Lamp

LL-TL814

REMOVE ALL PARTS FROM PACKAGE, BE CAREFUL NOT TO DAMAGE ANY COMPONENTS.

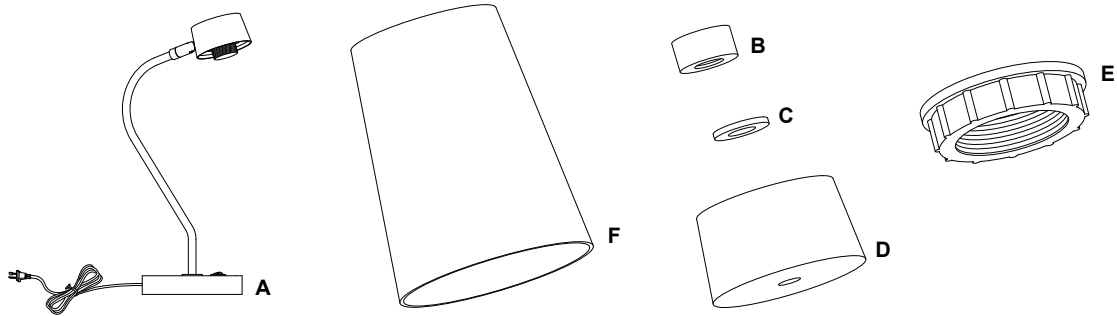

1. Remove decorative nut [B] and washer [C] from top of lamp body [A]. Place shade cap [D] on top of lamp body [A] and align the holes. Secure with washer [C] and decorative nut [B].
2. Remove socket ring [E] from lamp body [A]. Place shade [F] over socket and secure with socket ring [E].
3. Install bulb 60W max.
4. Plug in fixture. Use toggle switch to turn fixture on and off.

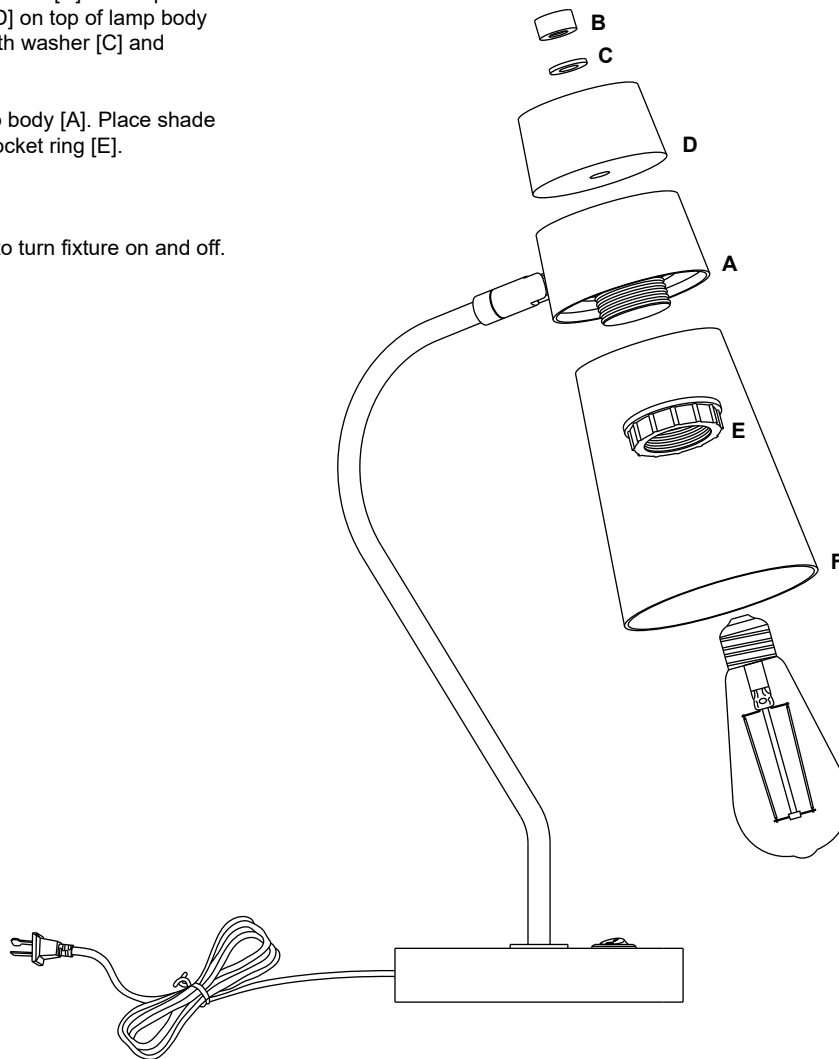

Note: Turn off switch before replacing the bulb. Make sure the bulb has sufficient time to cool down. Do not subject the lamp to any shock while lit as shattering of glass shade may result.