

# LINEA ■ LIGHTING

---

## ANDANTE INDUSTRIAL PENDANT LAMP LL-P407 / LL-P407-LED

### ASSEMBLY INSTRUCTIONS

REMOVE ALL PARTS FROM PACKAGE, BE CAREFUL NOT  
TO DAMAGE ANY COMPONENTS.

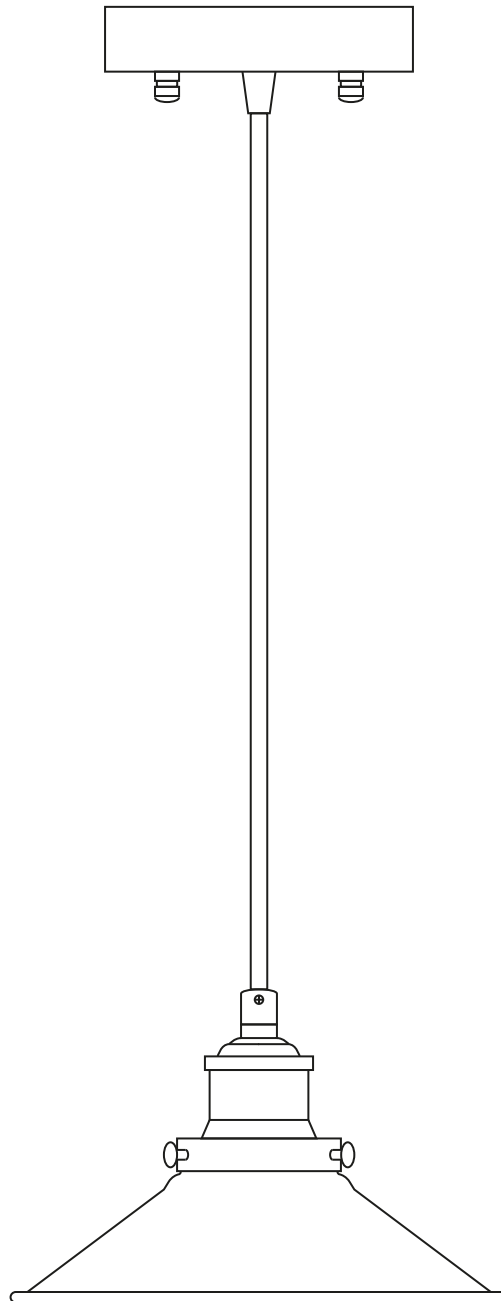

---

PROFESSIONAL INSTALLATION RECOMMENDED

# LINEA ■ LIGHTING

## ANDANTE INDUSTRIAL PENDANT LAMP

LL-P407 / LL-P407-LED

REMOVE ALL PARTS FROM PACKAGE, BE CAREFUL NOT TO DAMAGE ANY COMPONENTS.

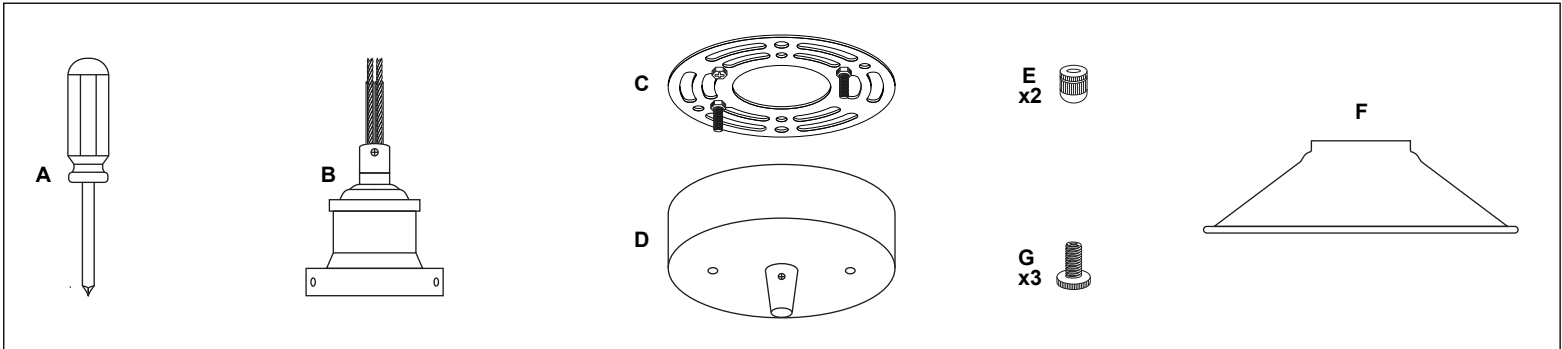

1. Measure area and determine desired hanging height.

2. Adjust the length of the cord by loosening the screw on the stem of the canopy with the provided screwdriver [A].  
Re-tighten screw after desired cord length is achieved.

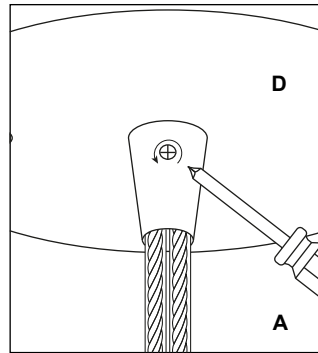

3. Detach mounting plate [C] from canopy [D].

4. Mounting plate [C] will attach to ceiling junction box.

5. Install light to ceiling. Linea Lighting recommends installation by a qualified electrical professional. Canopy nuts [E] are used to tighten light to ceiling.

6. Install the metal shade [F] onto socket part [B] and tighten by using screws [G]. Install bulb 60W max (included with LL-P407-LED).

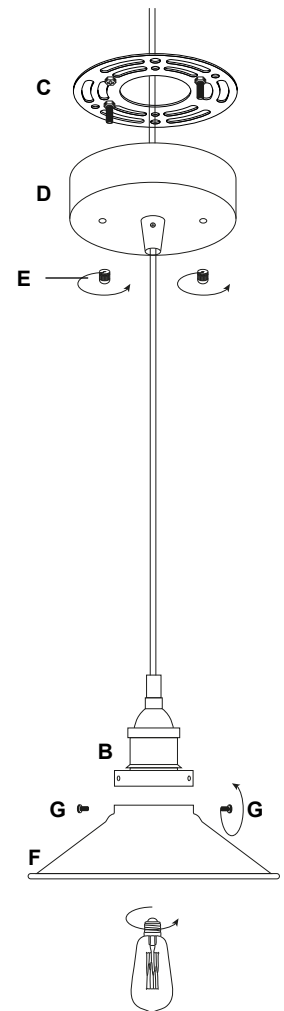

Note: Turn off switch before replacing the bulb. Make sure the bulb has sufficient time to cool down.  
Do not subject the lamp to any shock while lit as shattering of glass shade may result.