

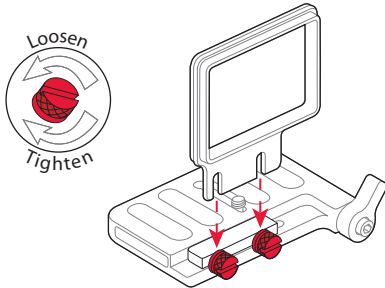

Installing your Z-Finder 3.2" Mounting Frame

- 1** Attach your 3.2" frame to gorilla plate with red thumb screws



- 3** Loosen slide and red thumb screws to center of screen then tighten screws

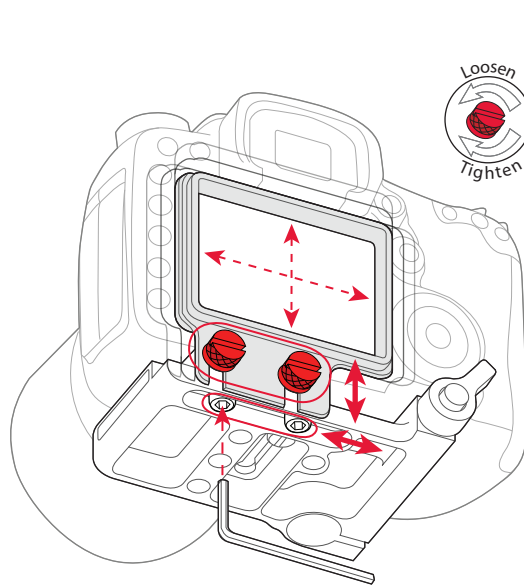

- 2** Press and hold frame against LCD and attach to camera with 1/4"-20 screw

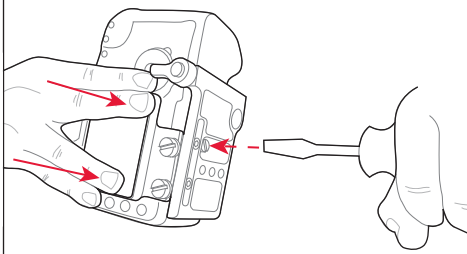

Included parts:

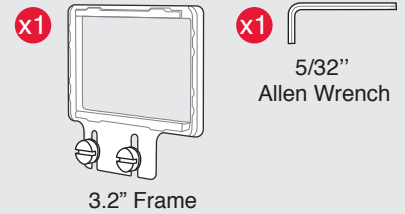

Required Tools:

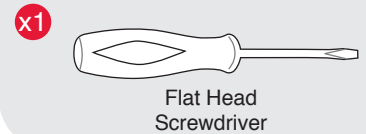

Installing your Z-Finder 3.2" Mounting Frame

- 1** Attach your 3.2" frame to gorilla plate with red thumb screws

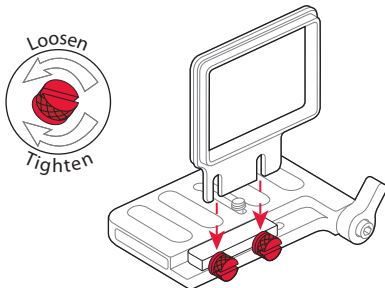

- 3** Loosen slide and red thumb screws to center of screen then tighten screws

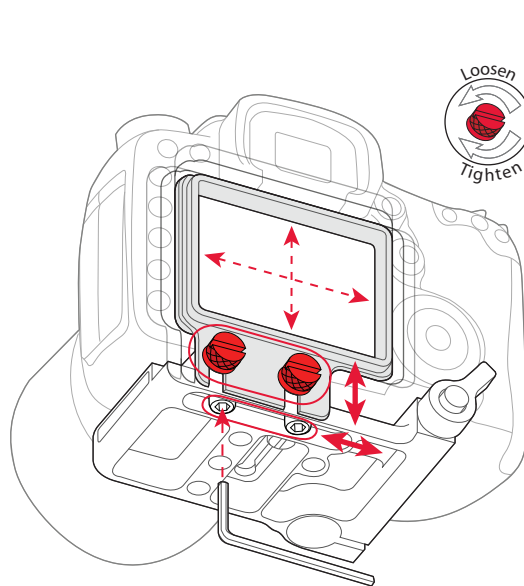

- 2** Press and hold frame against LCD and attach to camera with 1/4"-20 screw

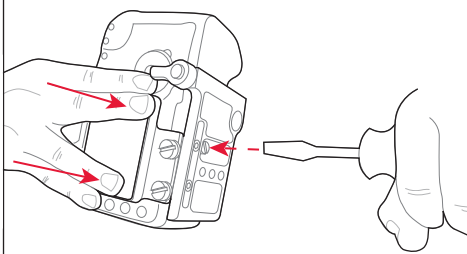

Included parts:

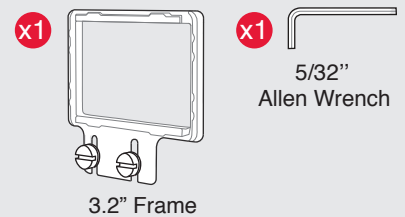

Required Tools:

