

27 Dinah (Or alternate block, Dorothy)

As seen in *The Farmer's Wife 1930s Sampler Quilt* book by Laurie Aaron Hird

FMM 55

Since we chose not to make Dinah, Dorothy is our substitute. For personal use in conjunction with the Farmer's Wife 1930s Sew Along and these **From MARTI MICHELL** Tools: Perfect Patchwork Template Sets A #8251. Optional: Set C, #8253.

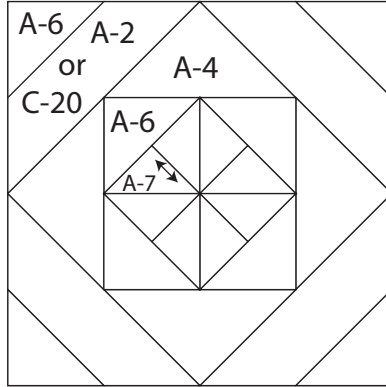
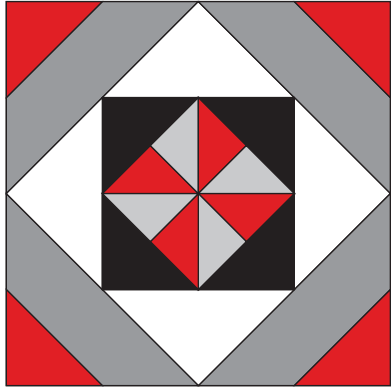

Cutting the Pieces From the Center Pinwheel Out

Refer to previous PDFs for the Marti Way to measure and cut strips for A-7 pinwheel fabrics. Observe grainline overrides with A-7  on both fabrics for center Pinwheel.

A-7—Cut 4 each of 2 Pinwheel fabrics.



With fabrics right sides together, cut 2 strips 6" x width of template. Cut in half and stack.

A-6—Cut 4 from a 2" x 6" strip.



A-4—Cut 4 from 2: 2" x 6" strips.



C-20—Cut 4 from 2 strips cut 9" by width of template.

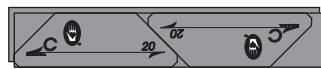

OR A-2—Cut 4 from 2: 3½" x 9" strips.

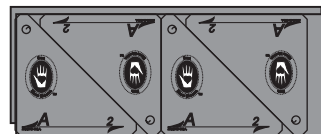

A-6—Cut 4 from 1: 2" x 6" strip for corners of block.



Making the Dorothy block

1. Chain-piece A-7 triangle pair. Press toward the dark.
2. Join pairs as shown and press to the light fabric.



Then join to complete the pinwheel. Swirl press the center.

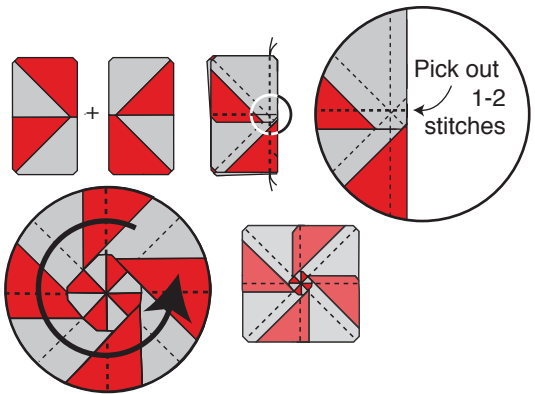

3. Add 4 A-6 triangles to the pinwheel. Add opposite sides first and press toward A-6 pieces. Add final two A-6 triangles.

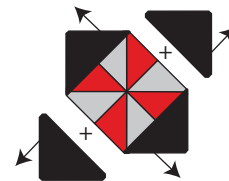

4. In the same manner add 4 A-4 triangles to center unit.
5. Make corner units by joining C-20 pieces and A-6 corner triangles. Press toward A-6. **OR** position A-6 and A-2 triangles right sides together as shown below so that all three nubbed corners of A-6 are aligned with the edges of the A-2 triangle. Stitch as shown. Flip A-6 triangle to cover seam. Confirm that the outside corners of the two pieces align and then cut away the excess A-2 fabric. Press toward A-6.

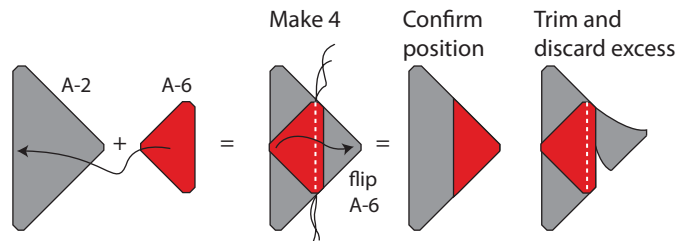

6. Join corner units to center unit to complete the block. Press toward corners.