

# FLEX 68PN

## PENINSULA FIREPLACE



**Clean Burning**

Fueled by clean burning e-NRG bioethanol

**Toughened Safety Screen**

Your Flex Fireplace features toughened glass to stabilise the flame in windy conditions and provide an additional layer of safety and comfort. The Integrated windscreen sits flush behind the frame.

**Room Divider Application**

Peninsula fireplaces feature three open sides - view the flame from the front, back and open side.

**Global Compliance**

These models comply with existing standards in the USA, Europe, UK and Australia. UL Listed, EN 16647 BSI Certified, ACCC Safety Mandate compliant.

**Decorative Side Box**

When a decorative box is added, the panel between the standard fire and the decorative box is glass.

**Colours**

Available in a timeless black finish, Flex Fireplaces come with Stainless Steel or Black burners.



**Built to Last a Lifetime**

Zinc sealed steel construction powder coated with super hi-temp black paint prevents rusting so all fireplaces can be used both indoors or outdoors.

**Zero Clearance**

Self-contained, zero clearance construction allows your Flex fireplace to be framed into wood or metal studs, providing installation freedom and flexibility for builders, architects, interior designers, landscapers and homeowners.

**Included Accessories**

**Optional Accessory**



Jerry Can, Safety Spout & e-NRG bottle adaptor



Lighting Rod + Lighter



Operations Manual



Baffles (N/A Flex 18)



Black Glass Charcoal



Glass Fire Screen/s



Decorative Steel Logs

Disclaimer. All product specifications and data are subject to change without notice and believed to be correct at the time of publication. MAD Design Group (MDG), its affiliates, agents, and employees, and all persons acting on its or their behalf (collectively, "MAD Design Group"), disclaim any and all liability for any errors, inaccuracies or incompleteness contained herein or in any other disclosure relating to any product. MDG disclaims any and all liability arising out of the use or application of any product described herein or of any information provided herein to the maximum extent permitted by law. The product specifications do not expand or otherwise modify MDG's terms and conditions of purchase, including but not limited to the warranty expressed therein, which apply to these products. No license, express or implied, by estoppel or otherwise, to any intellectual property rights is granted by this document or by any conduct of MDG. Customers using or selling MDG products not expressly indicated for use in such applications do so entirely at their own risk and agree to fully indemnify MDG for any damages arising or resulting from such use or sale. Please contact authorised personnel from MDG to obtain written terms and conditions regarding products designed for such applications. Images are indicative only.

## Peninsula Fireplaces

<b>Award</b>	2020 BIMsmith Best Award (USA)
<b>Application</b>	Indoor & Outdoor
<b>Materials</b>	Mild Steel (Zinc Sealed), Toughened Glass, Grade 304 Stainless Steel
<b>Colours</b>	Black Firebox, Stainless Steel or Black Burner/s
<b>Fuel Type</b>	e-NRG Bioethanol

### Flex 68

#### ESF.2.FX.68PN

<b>Weight</b>	102.8kg [226.2lbs] (Incl. burner/s, glass charcoal, glass)
<b>Burner</b>	XL1200 x 1
<b>Volume Capacity</b>	10 Litres [2.6 Gallons] x 1
<b>Heats on Average</b>	Over 65 square metres [700 square feet]
<b>Burn Time</b>	9 - 14 hours (approx)
<b>Minimum Room Size</b>	115 cubic metres [4061 cubic feet] per fireplace
<b>Minimum Wall Length</b>	1,935mm [76in]

#### ESF.1.FX.68PN.BX2

<b>Weight</b>	96.1kg [211.4lbs] (Incl. burner/s, glass charcoal, glass)
<b>Burner</b>	XL500 x 1
<b>Volume Capacity</b>	5 Litres [1.3 Gallons]
<b>Heats on Average</b>	Over 40 square metres [430.6 square feet]
<b>Burn Time</b>	10 - 13 hours (approx)
<b>Minimum Room Size</b>	80 cubic metres [2825 cubic feet] per fireplace.
<b>Minimum Wall Length</b>	1,935mm [76in]

#### ESF.1.FX.68PN.BXL ESF.1.FX.68PN.BXR

<b>Weight</b>	83.9kg [184.6lbs] (Incl. burner/s, glass charcoal, glass)
<b>Burner</b>	XL900 x 1
<b>Volume Capacity</b>	9 Litres [2.4 Gallons]
<b>Heats on Average</b>	Over 60 square metres [645 square feet]
<b>Burn Time</b>	8 - 13 hours (approx)
<b>Minimum Room Size</b>	110 cubic metres [3884 cubic feet] per fireplace.
<b>Minimum Wall Length</b>	1,935mm [76in]

Physical model dimensions should be verified against cut out dimensions BEFORE installation begins to confirm tolerances align.

These values are indicative only and may vary depending on the model purchased, installation, and the seasonal resource used to manufacture e-NRG.

All models can be rotated

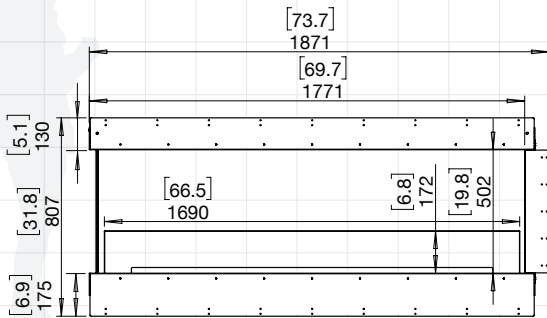

68PN (FLAME ONLY)

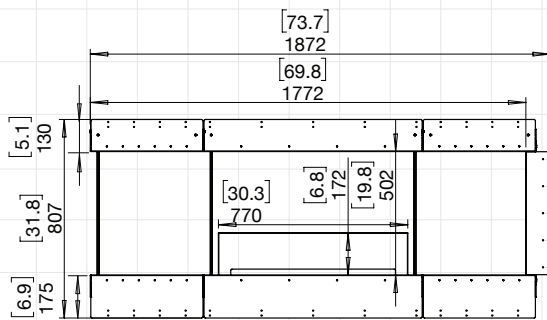

68PN.BX2 (LEFT & RIGHT DECORATIVE BOXES)

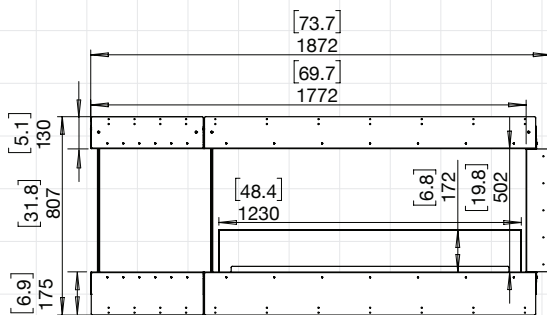

68PN.BXL (LEFT DECORATIVE BOX AS ILLUSTRATED)  
68PN.BXR (RIGHT DECORATIVE BOX)

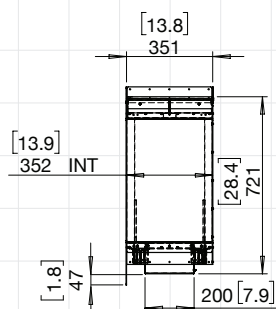

SIDE VIEW

FOR MORE INFORMATION PLEASE REFERENCE THE CLEARANCE & INSTALLATION MANUAL

Disclaimer: All product specifications and data are subject to change without notice and believed to be correct at the time of publication. MAD Design Group (MDG), its affiliates, agents, and employees, and all persons acting on its or their behalf (collectively, "MAD Design Group"), disclaim any and all liability for any errors, inaccuracies or incompleteness contained herein or in any other disclosure relating to any product. MDG disclaims any and all liability arising out of the use or application of any product described herein or of any information provided herein to the maximum extent permitted by law. The product specifications do not expand or otherwise modify MDG's terms and conditions of purchase, including but not limited to the warranty expressed therein, which apply to these products. No license, express or implied, by estoppel or otherwise, to any intellectual property rights is granted by this document or by any conduct of MDG. Customers using or selling MDG products not expressly indicated for use in such applications do so entirely at their own risk and agree to fully indemnify MDG for any damages arising or resulting from such use or sale. Please contact authorised personnel from MDG to obtain written terms and conditions regarding products designed for such applications. Images are indicative only.

## Peninsula Installations



Flex 18PN



Flex 68PN.BXL



Flex 140PN.BX2