

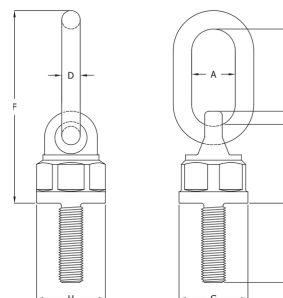

METRIC ULTRA LIFTING RINGS

**READ SAFETY PRECAUTION PRIOR TO USE
(SAFETY INFORMATION PAGE 151)**

- 200% Proof-Load Tested with Serial Number for Traceability
- Swivels 360° - Pivots 180°
- Material: Alloy Steel
- Safety Factor: 4:1
- Magnetic Particle Inspected
- Certified Heat Treatment
- Rated at 100% from 0°-90°
- Meets or Exceeds the Requirements of EN1677-4



METRIC										
PART NO.	RATED LOAD (KGS)	A	B	C	D	E	F	H	THREAD SIZE	WEIGHT (LBS)
44302	400	1-1/8	1-1/2	1-1/4	5/16	12	3.45	1.42	M8x1.25	0.6
44304	500	1-1/8	1-1/2	1-1/4	5/16	19	3.45	1.42	M10x1.50	0.6
44310	1,050	1-3/8	2-1/2	2-1/4	1/2	20	5.83	2.36	M12x1.75	2.6
44312	1,150	1-3/8	2-1/2	2-1/4	1/2	31	5.83	2.36	M14x2.00	2.6
44314	1,900	1-3/8	2-1/2	2-1/4	1/2	31	5.83	2.36	M16x2.00	2.6
44320	2,150	1-1/2	3	2-3/4	3/4	38	7.05	2.76	M20x2.50	5.0
44322	2,250	1-1/2	3	2-3/4	3/4	38	7.05	2.76	M22x2.50	5.0
44324	4,200	1-1/2	3	2-3/4	3/4	38	7.05	2.76	M24x3.00	5.0
44346	5,000	2	3-1/2	3-1/2	7/8	50	8.90	2.90	M30x3.50	9.0
44348	7,000	2	3-1/2	3-1/2	7/8	50	8.90	2.90	M33x3.50	9.0
44350	8,000	2	3-1/2	3-1/2	7/8	54	8.90	2.90	M36x4.00	9.0
44355	8,000	2	3-1/2	3-1/2	7/8	58	8.90	2.90	M39x4.00	9.0
44360	10,000	2-1/2	4	4-1/2	1	63	9.45	3.67	M42x4.50	13.0
44362	10,000	2-1/2	4	4-1/2	1	152	9.45	3.67	M42x4.50	15.0
44363	10,000	2-1/2	4	4-1/2	1	304	9.45	3.67	M42x4.50	19.0
44367	10,000	2-1/2	4	4-1/2	1	68	9.45	3.67	M45x4.50	14.0
44365	10,000	2-1/2	4	4-1/2	1	68	9.45	3.67	M48x5.00	14.0
44366	10,000	2-1/2	4	4-1/2	1	152	9.45	3.67	M48x5.00	17.0
44364	10,000	2-1/2	4	4-1/2	1	304	9.45	3.67	M48x5.00	21.0
44370	15,000	2-3/4	5-3/16	5	1-1/4	84	11.18	4.13	M56x5.50	22.0
44376	15,000	2-3/4	5-3/16	5	1-1/4	203	11.18	4.13	M56x5.50	27.0
44384	15,000	2-3/4	5-3/16	5	1-1/4	304	11.18	4.13	M56x5.50	31.0
44372	15,000	2-3/4	5-3/16	5	1-1/4	90	11.18	4.13	M60x5.50	23.0
44378	15,000	2-3/4	5-3/16	5	1-1/4	203	11.18	4.13	M60x5.50	28.0
44386	15,000	2-3/4	5-3/16	5	1-1/4	304	11.18	4.13	M60x5.50	33.0
44375	15,000	2-3/4	5-3/16	5	1-1/4	95	11.18	4.13	M64x6.00	24.0
44380	15,000	2-3/4	5-3/16	5	1-1/4	203	11.18	4.13	M64x6.00	30.0
44388	15,000	2-3/4	5-3/16	5	1-1/4	304	11.18	4.13	M64x6.00	35.0

*ADDITIONAL SIZES AVAILABLE UPON REQUEST