

juice **SUPER MAX**

Instruction Manual



655Wh

What's in the Box?

- Juice® SuperMax 655Wh
- Power cable & adapter
- Car charging cable
- User manual



Let's Get Techy

Model No.	JUI-PBANK-SUPERMAX-642W
Output Waveform	Pure sine wave
Output Voltage	230V / 50Hz
Power Output	600W
Battery Capacity	655.2Wh
Battery Model	3.6V 2600mAh (7S10P)
Battery Type	18650 Lithium-ion cells (ternary lithium)
DC Outputs	1x Cigarette lighter 24V/10A 1x Cigarette lighter 12V/10A
DC Outputs	1x Cigarette lighter + 2x DC5525 (Sharing 12V/10A)
USB Outputs	USB 2.0 5V 2.4A / USB Q3.0 / PD100W (independence)
Charging Time	7 ~ 8H
Charging V&C	29.4V d.c.3.0A (Support 29.4-50V) / Solar Panel 36V 100-400W
LED Lighting	3W (Solid, SOS, Flashing)
Ambient Temp	0°C ~ 40°C
Storage Temp	-10°C ~ 65°C
Product Dims	L348mm x W182mm x H243mm
Net Weight	6.1kg
Protection Funct.	Input/output under-voltage, input/output over-voltage, over-temperature, overload, short-circuit

Overview

- 1 Car Port 24V 10A (max)
- 2 Car Port 12V 10A (max)
- 3 DC Switch
- 4 Solar 36V 100-400W
- 5 DC 29.4-50V (max)
- 6 DC 12V 10A (max)
- 7 DC 12V 10A (max)
- 8 PD100W (max)
- 9 USB 3.0 18W (max)
- 10 USB 5V 2.4A
- 11 Display LCD
- 12 Power Button
- 13 AC Switch
- 14 AC Output 600W (max)

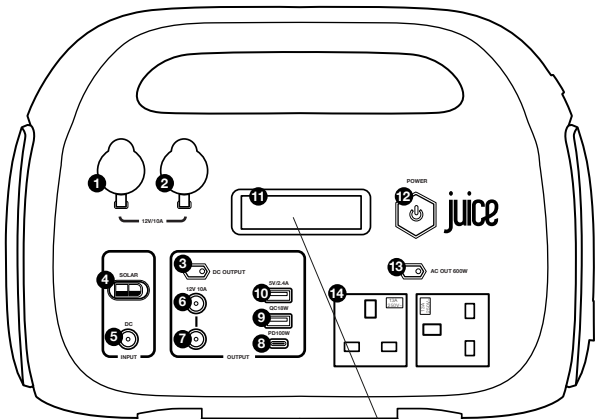

- 15 LED Flashlight Button

- 16 LED Flashlight

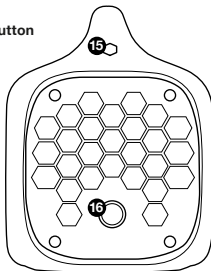

Power output display

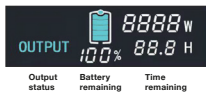

Power input display

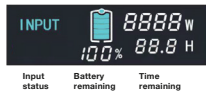

Functions

Steps for using AC power



Press the power button **12** for 3s to turn on the Super Max



Press the AC OUT **13** button

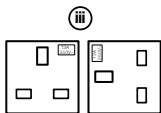

Plug in your device to use AC power **14**

Steps for using DC power



Press the power button **12** for 3s to turn on the Super Max

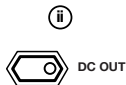

Press the DC OUT **3** button



Plug in your device to use DC power **6 7**

Steps for using LED Flashlight



Press the power button **12** for 3s to turn on the Super Max



Press & hold the LED Flashlight button **15** for 3 seconds to turn on the LED Flashlight

LED Flashlight Functions **15**

Press once for standard Light

Press twice for SOS mode

Press three times for strobe mode



Press & hold the LED Flashlight button **15** at any time for 3 seconds to turn off the LED Flashlight

Notes:

If the DC or AC power is live, the LED on the button will be alight. If you aren't using the output ports, ensure the buttons are switched off to retain power.

Features & Uses



CAMPING
TRIPS



OUTDOOR
ADVENTURES



HOME
ESSENTIALS



SOLAR
POWER

CAMPING TRIPS

x50

Phone Charges

8hrs

100W Solar Panel

x12

Laptop Charges

12hrs

Portable Fridge

OUTDOOR ADVENTURES

Enough charge for any weekend long adventure!

HOME ESSENTIALS

An **invaluable** emergency source of power in the home in an unexpected power outage

SOLAR POWER

A potential **inifinte source** of power using external solar panels to charge your Super Max!

How to Charge

The Juice Super Max 655Wh can be charged in three modes, **charging from the wall**, **charging from solar** and **charging from the car**, with voltages ranging from 29.4V to 50V. The current cannot exceed 6Amps. **It is strongly recommended** to use the charging adapters provided to avoid potentially damaging the Super Max.

1. Charging from the wall:

Plug the supplied 3-pin adapter into the wall socket and connect the power box, plugging the DC cable into the DC INPUT **5** port. The Super Max will begin to charge.

2. Charging from solar panels (sold separately):

Plug a 36V 100-400W solar panel into the Solar input connector **4** or DC INPUT **5** to charge the Super Max. Power input levels and charging speeds may vary depending on sun strength and cloud coverage.

3. Charging in the car:

Insert the supplied 29.4V car charger cable into the car cigarette lighter and plug the DC cable into the DC INPUT **5** port. Ensure the plug is fully inserted into the cigarette lighter to achieve a stable and consistent charge. **It is strongly recommended** to run the engine when charging the Super Max from your car, as the car battery could rapidly drain, leaving the car unable to start. **Do not** charge the Super Max in the car while driving on uneven and bumpy terrain, as a destabilised connection to the cigarette lighter could pose a fire risk.

When the product is charging, the LCD screen **11** will show the power level percentage and remaining charging time in real time. When fully charged, the charger will automatically stop charging.

Energy Efficiency Info:	
Product Code	JUI-PBANK-SUPERMAX-642Wh
Output Power (W)	88.2W
Average active efficiency %	115V (89%) 230V(90.3%)
Efficiency at low load (10%)%	86.10%
No load power consumption (W)	0.2049W

Troubleshooting & Safety

1. Please read all instructions carefully before using your Juice® Super Max 655Wh.
2. Close supervision is required when using this product around children to reduce risk.
3. Only use the Juice Super Max with devices that you know are safe and purchased from reputable sources.
4. When the product is not in use, please remove your device's power adapter from the socket.
5. Do not dismantle the product or try to repair it yourself, as this may lead to unpredictable risks such as fire, explosion or electric shock.
6. Avoid using frayed or damaged charging cables with the Super Max to reduce risk of electric shock.
7. Charge the product in a well ventilated area and do not restrict ventilation in any way.
8. Take care to use the Juice® Super Max in a well ventilated and dry area, away from rain and direct, intense sunlight.
9. The Juice® Super Max does not support pass-through charging, so ensure you have sufficient required charge before use.
10. Do not use extension cords or charge multiple devices simultaneously from one AC socket.
11. To maintain optimum performance, charge the Super Max every 3 months when not in active use.
12. It is recommended to preserve the health and performance of the battery cells by leaving the Super Max powered down for around 2 hours before recharging after fully discharging the battery.

ISSUE	REASON	SOLUTION
Buttons, screen & output unresponsive	Lower power or overload protection	Ensure the Super Max has charge
LCD screen displays as normal, AC output is unresponsive despite AC button being pressed	Overheating	Turn the Super Max off and recover it to normal temp
	Overload	Remove connected devices to reduce load and recover
	Low voltage or low capacity	Recharge the Super Max
USB ports have no output	The DC button is not pressed	Press the DC button
LCD screen appears incorrect	The screen is broken, or the internal line is reversed	Contact customerservices@juice.co.uk
Energy output is less than expected	AC ports and DC ports are active simultaneously, or maximum rated power exceeded	Reduce the no. of devices on charge
Can't recharge with solar panels	Insufficient sunlight or the solar panel being used may be less powerful than recommended	Use more powerful solar panels with an output higher than the Super Max's required input
Can't recharge from wall output	Charger may be broken or management system broken	Contact customerservices@juice.co.uk

Legal Liability

The Juice@Super Max can be used only with compatible products. Please read your equipment's compatibility instructions to determine whether this Juice@Super Max matches your equipment. The manufacturer will not be liable for any damage to your electronic equipment during the use of this product. Juice will not be held responsible for any equipment or accessories not suitable for use with the Juice@Super Max. The manufacturer will not be held liable for damage caused by misuse or damage incurred by the buyer or the third party arising from any intentional or unintentional use of the Juice@Super Max.

All Juice@Super Max's have been tested comprehensively to ensure quality. If you encounter any unusual heat, discolouration or product distortion during charging or storage, please stop using it immediately and contact the dealer. These issues may cause leakage, heat, smoke or ignition of the Juice@Super Max. The Juice@Super Max is not intended for use by persons (including children) with reduced physical, sensory or mental capabilities (or lack of experience and knowledge) unless they have been given supervision or instructions concerning the use of the Juice@Super Max by a person responsible for their safety. Children should be supervised to ensure that they do not play with the Juice@Super Max, this is not a toy.

WASTE ELECTRICAL PRODUCTS SHOULD NOT BE DISPOSED OF WITH HOUSEHOLD WASTE. ALL ELECTRONIC PRODUCTS WITH THE WEEE LOGO MUST BE COLLECTED AND SENT TO APPROVED OPERATORS FOR SAFE DISPOSAL OR RECYCLING. PLEASE RECYCLE WHERE FACILITIES EXIST. MANY ELECTRICAL/ELECTRONIC EQUIPMENT RETAILERS FACILITATE "DISTRIBUTOR TAKE-BACK SCHEME" OF HOUSEHOLD WEEE. CHECK WITH YOUR LOCAL AUTHORITY OR RETAILERS FOR DESIGNATED COLLECTION FACILITIES (DCF) WHERE CONSUMERS MAY DISPOSE OF THEIR WEEE FREE OF CHARGE."

**SCAN ME FOR
WARRANTY**

Caution: If the batch code is removed from the product, the warranty will be void.



UK
CA



Made from 100% recycled plastics

The entire outer casing and side panels of this product are made from recycled post consumer waste plastic

Designed in the UK. Product made in China. Please retain packaging for future reference. Design & specification may be subject to change without prior notice. Juice@SuperMax is part of the ©Juice® brand.

customerservices@juice.co.uk. Juice®, 10 Haslemere Way, OX16 5RW, UK

Box 133, 3 Lombard Street East, Dublin 2, D02 HC78, Ireland

Helpline number: +35315256712