

BEAST

PS9000/8000 SERIES SMART SCALE FOR FORKLIFT

Installation Manual

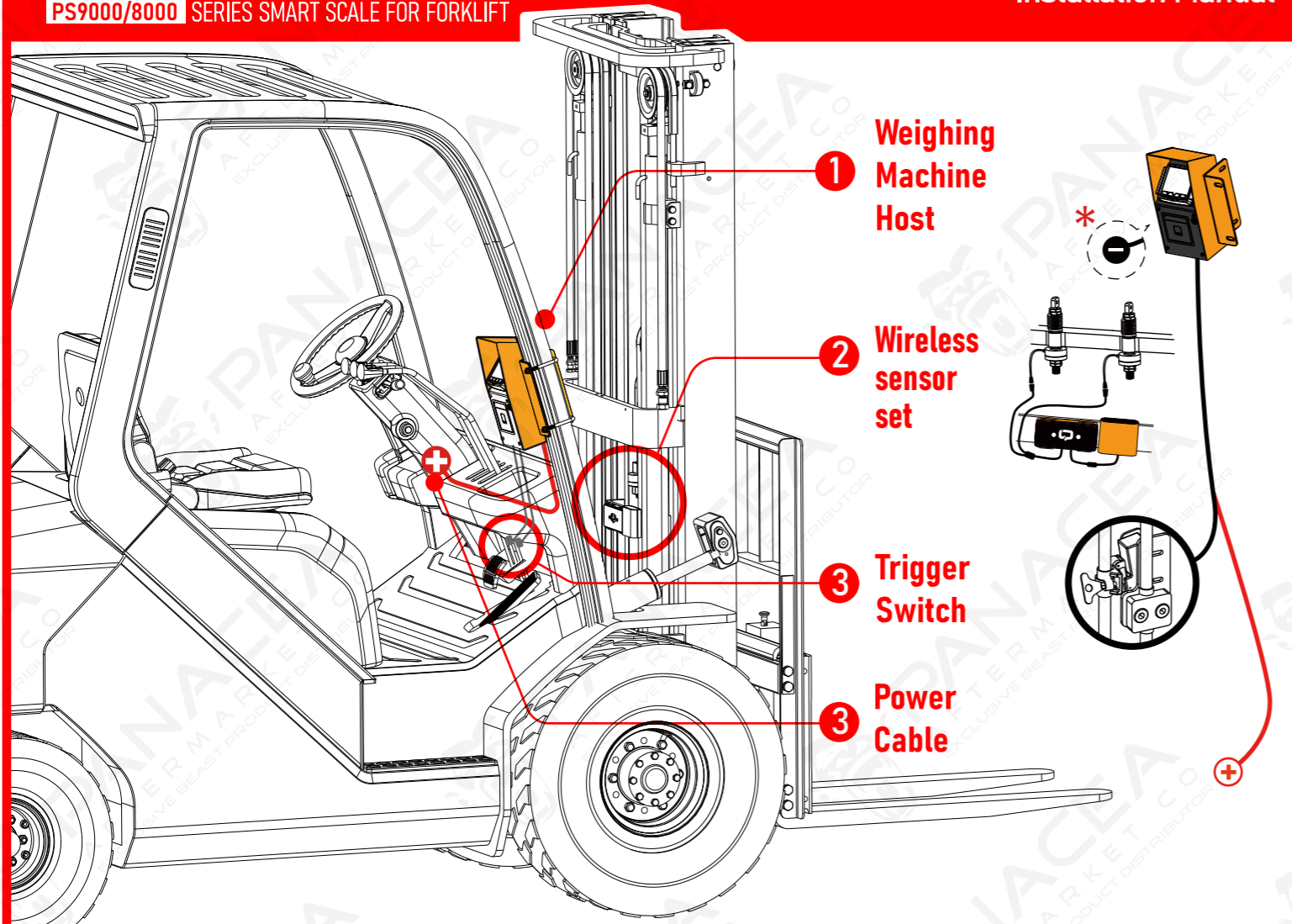

*** Assembly notes:**

The negative pole of the system is placed in the shell and connected to the frame through the shell

LOAD CELL Installation Instruction

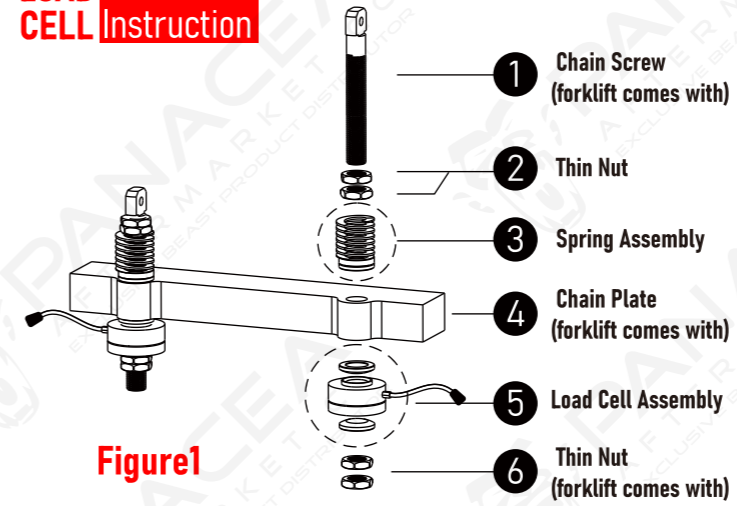

Installation Notes:

As shown in Figure 1, the parts (2) (3) are assembled to the parts (1), then pass through the parts (4), and then assemble the parts (5)(6)(7) in sequence. The parts (3) and (5) pay attention to the assembly direction. After completion, as shown on the left side of Figure (1).

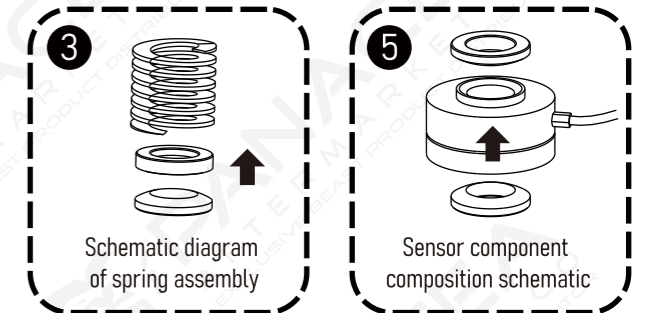

Assembly notes:

1. Spring components include M18, M22 (yellow, where M22 spring components are larger than M18) and M20 (blue), which are respectively equipped with chain screws of corresponding specifications;
2. When the chain is loose, the spring assembly is pre-compressed, and the gap between the springs is roughly the thickness of 3mm;
3. Adjust the parts (6) so that the fork can land, and the tension of the two chains is the same when the fork is raised;
4. After the assembly is completed, the two nuts of parts (2) and (6) are tightened to each other.

Installation Instructions For The Weighing Host

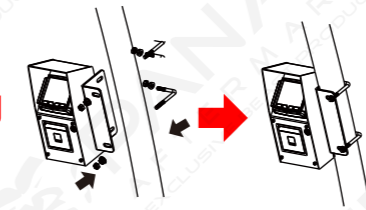

Installation Notes:

Use the screw kit to fix the host on the overhead guard pillar and adjust it to a suitable position.

WIRELESS DATA BOX Installation introduction

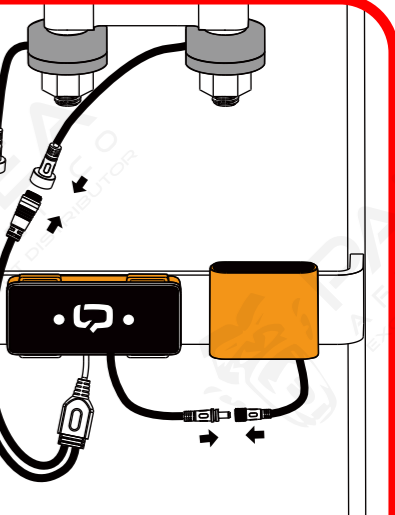

SPARE PARTS LIST

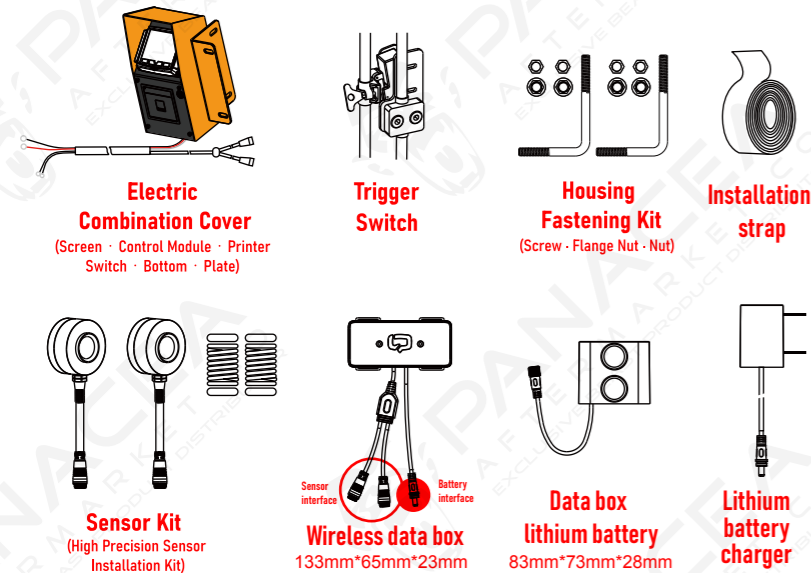

TRIGGER SWITCH Installation Instruction

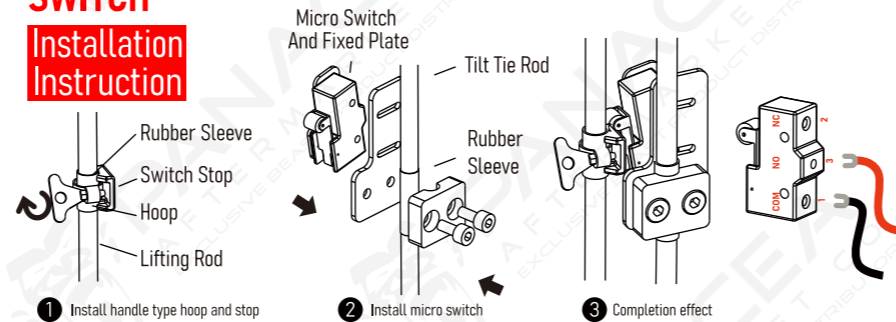

Description :

Assemble the handle hoop assembly and the trigger switch to the lifting rod and the tilt tie rod in turn, The contact gap between the small roller of the switch and the switch block is 0-1mm

Assembly notes:

1. When pulling the joystick, the trigger switch assembly must not interfere with the frame
2. Pull the tilt tie rod to the end, the trigger switch harness must remain slack

POWER CABLE Installation Instruction

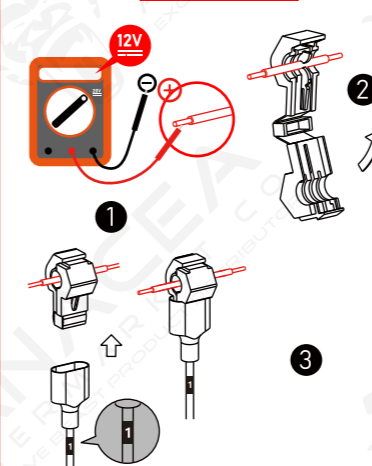

Clamp the positive wire of the forklift power supply with the clamping terminal (12-24V)

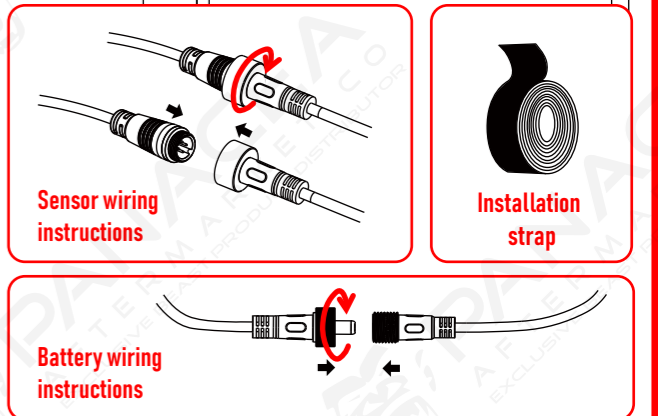

Assembly notes:
Use self-adhesive tape to bind the data box and battery to the proper position of the mast;
Ensure that there is no relative displacement between the mast and the sensor when the mast is raised.

OPERATION INSTRUCTION

Power on/off

Press the power button to turn on/off
* After turning on, the power button will light up

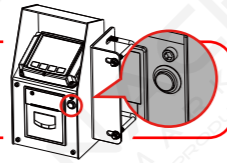

Wireless data box

When the system is turned on, the green indicator light will light up, and the indicator light will turn off when the system is shutdown;
When the battery is low, the indicator light will show red.
If the data box does not light up after booting, please check the power battery level;
When the battery is low, remove the battery and charge it with a dedicated charger.



Interface Instruction



Valuation function

When the forklift lifts the goods
The valuation area will show the valuation
Valuation is for weight reference only
The smallest unit is 100kg
* The valuation error is relatively large, so it is not recommended to use it in pricing



Zero function

Lift the empty fork and observe the zero weighing result. If it is not the green "0", click the "Zero" button, the green value will automatically become 0.
Complete the zero-setting operation
* zero-setting operation can improve weighing accuracy



Precise weighing function

When accurate weighing is required, pull the forklift lever to lift the goods, the interface prompts "weighing calculation", keep the action for about three seconds, the interface will prompt "calculation function", the green words appear, this is accurate weighing, the error is ±1%

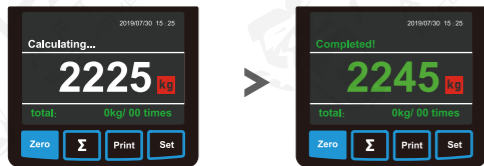

Accumulation function

After completing a weighing, click the "accumulation" button. The accumulated weight and accumulated times will be reflected in the accumulated interface;
Long press the accumulation button to clear the accumulation content
* The accumulation function is equipped with a mechanism to prevent mis-operation. When the accumulation button is pressed, a red dot prompt appears. Pressing the accumulation key again before the red dot disappears is an invalid operation to prevent a single weight from accumulating multiple times.
* By flipping through the weighing records, you can check the accumulated weight each time.



Print function

Press print key, it will print out weight value of the present cargos.
If there is accumulation information, it will print accumulation information too.
* It shall make sure enough printing paper before printing.



Setting interface

Press key setting, can go into setting interface to make system setting.



* Change password and calibration initial password, please contact with customer service to get.

After sales service

go into setting interface, press key "about" to get more after sales information.



CALIBRATION INSTRUCTION

1 Check zero :
Lift the empty fork several times at a constant speed
Check whether the zero display value is stable or not.
If the deviation is large, you need to check whether the installation or operation method is accurate or not.



2 Zero setting :
After get the stable weighing data, press zero key.



3 Adjust the filter coefficient as 0.0% :
Go into setting → weighing setting (need a password) → Calibrate → Filter coefficient → Confirm filter coefficient as 0.0%



4 Lifting cargo:
Lift cargo of known weight at a constant speed (1-2t recommended)
Make record that cargo real weight value is a (example:1202kg)
Indicator display weight value b (example:524kg)



5 Calibration :
go into setting → weighing setting → Calibration → hand adjustment
input step 4 real weight value a and display weight value b, press confirm.



6 Filter coefficient :
Quit setting, check no error,
go into setting → weighing setting → Calibration → Filter coefficient, setting as 1.0%

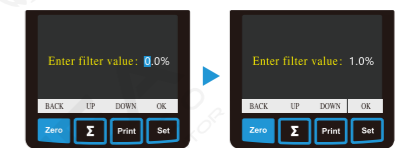

NORMAL PROBLEM WILL HAPPEN WHEN FORKLIFT SCALE USING AND HOW TO HANDLE

Forklift scale not working

- 1 Can not turn on no action when press turn/on key
Check the power cable and forklift battery (power cable not connected or the battery low power.)
- 2 When lifting the forklift scale, the interface of the indicator do not change, do not do data calculation.
Check power switch (power switch wiring not good)
- 3 Check trigger switch. (When lifting the forklift scale, trigger switch if not work, adjust trigger switch and the place where the switch is installed.)



Forklift scale is not accurate

- 1 Zero empty fork: if the result of lifting empty fork is not 0, press zero
- 2 Check the load cell: check load cell wiring is right or not, the installation place is loose or not.
- 3 Check the status of the mast: the status of the forklift mast will affect the accuracy of the forklift (If the structure is deformed, the gap is too large, the chain is rusted, etc., you need to maintain the mast before debugging the forklift scale)



Common misoperation

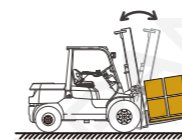

The mast is severely inclined
try to keep the mast vertical when weighing



Try to keep the mast vertical when weighing
try to lift the goods from the ground when weighing

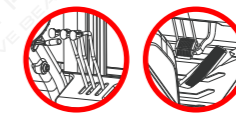

Uneven speed when lifting and weighing
Control the lifting rod and accelerator pedal to ensure a uniform and stable lifting speed



Premature interruption leads to weighing cancellation
Please keep the lifting action when weighing until the result is calculated

The printing is not clear, and some areas are not printed



Error reason:
The overall print head is dirty, Affect printing
Partially severely soiled can't print at all

Cleaning method:
Wipe the print head repeatedly with alcohol swabs or cotton pads
Make sure that it is clean and free of dirt, then it can return to normal.
If there is no alcohol swab or cotton pad, use wet wipes, damp clean cloth, etc., but remember not to be too wet to avoid water damage to the print head.

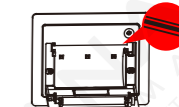

Open the printer panel
The print head is in the paper compartment
Internal upper end

