

---

# Electric Height Adjustable Standing Desk

## Installation Manual

---

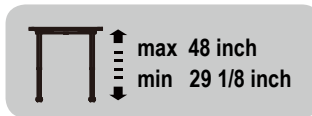
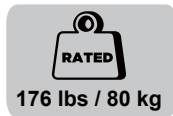
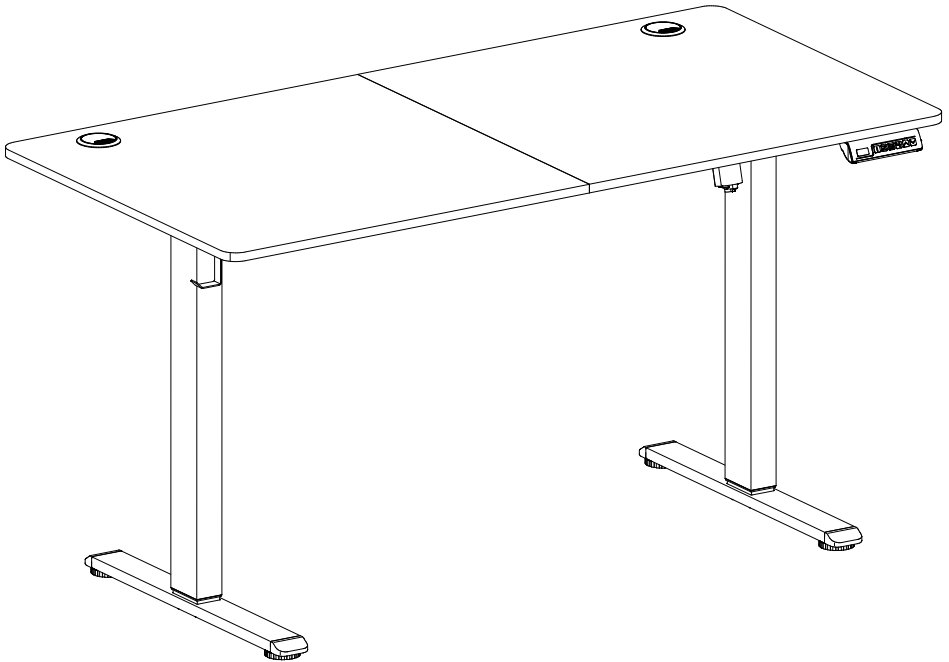

V2.0



**Technical Support: 626-425-4350, Mon-Fri, 10am-6pm (PST)**



**Other Info: [help@jollyholding.com](mailto:help@jollyholding.com)**



**Website: <https://mountup.com>**

If you have any issues, please feel free to contact our customer support before returning.  
At MOUNTUP strive to provide you with the best quality products and services in the industry.

# SAFETY INSTRUCTIONS

## BEFORE ASSEMBLY

- ◆ Place the product on the flat floor with a mat to avoid scratches.
- ◆ Layout all components and hardware. Check all parts are included and undamaged.
- ◆ Should anybody intends to install or use this electric height adjustable desk, please read and understand this manual carefully.

## WARNING

- ◆ Do not open or modify any components, including the legs, system control box or adjustment controller. This might cause electric shock or permanent damage to the product.
- ◆ This product contains small items that could be a choking hazard if swallowed.  
KEEP AWAY FROM CHILDREN UNDER 3 YEARS OLD. ADULT SUPERVISION IS REQUIRED.
- ◆ Neither adults nor children can sit or stand on the desk. Do not play within the area under the desk. This might cause to severe bodily injury.
- ◆ If you do not understand these instructions or have any doubt about the safety instructions, assembly or use of this product, please contact our customer service.
- ◆ At least two adults are required to assemble this desk.

## USE & LIABILITY

- ◆ Do not use this product for any purpose that is not explicitly specified in this manual.
- ◆ Do not exceed weight capacity of 176LBS / 80KG.
- ◆ Indoor use only.
- ◆ We cannot be liable for damage or injury caused by incorrect assembly or inappropriate use.

## ELECTRICAL SAFETY

This product is powered by electricity. In order to avoid burns, fire and electric shock, please read the following instructions carefully.

- ◆ The product must be connected to AC 100-240 Voltage power supply.
- ◆ To avoid electric failure, please keep this desk and parts dry from water or humid environment.

## WARNING

### PINCH POINT

DO NOT place hands on or near any parts underneath the desk. Moving parts can crush and cut. Pinch points are created during lifting and lowering the worksurface. Failure to follow these instructions may result in serious personal injury.



## CAUTION



Do not exceed desk weight limit.

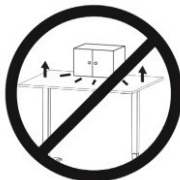

Keep the knee space clear obstacles.



Keep weight on desk balanced for correct operation and longer life of components.



Leave enough slack in cables to allow for full range of vertical motion.

Failure to follow these instructions may result in property damage and / or personal injury.

# PACKAGE CONTENTS

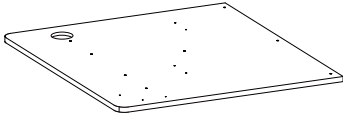

**A-1 (x1)**  
Right Tabletop

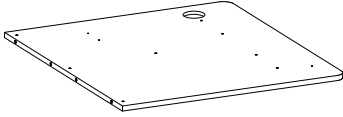

**A-2 (x1)**  
Left Tabletop

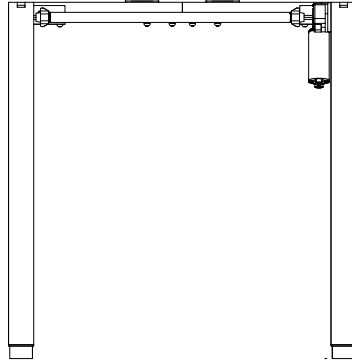

**B (x1)**  
Frame



**C (x2)**  
Side Bracket

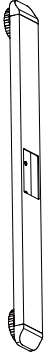

**D (x2)**  
Base



**E (x2)**  
Hook

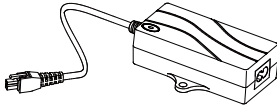

**F (x1)**  
Power Adapter

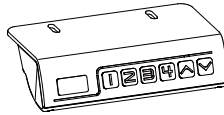

**G (x1)**  
Controller

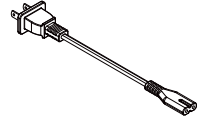

**H (x1)**  
Power Wire



**I (x2)**  
Grommet



**J (x3)**  
Fixture



**K (x4)**  
Wooden Pin

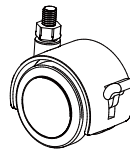

**L (x4)**  
Caster with Lock

# SCREW & BOLT KITS



**M-A (x16)**  
M6x14 Bolt

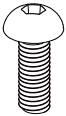

**M-B (x8)**  
M6x20 Bolt



**M-C (x4)**  
M6x12 Bolt



**M-D (x6)**  
ST4.8x12 Screw

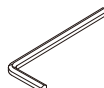

**M-E (x1)**  
4mm Allen Key



**M-F (x1)**  
Wrench

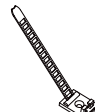

**M-G (x4)**  
Cable Clip



**M-H (x1)**  
Screwdriver

# ASSEMBLY STEPS

## Installation Tips

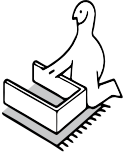

Lay a mat or old blanket underneath desk so the floor and the furniture will not get scratched or damaged during assembly.



## STEP 1

1. Insert Wooden Pin (K) into the holes of Tabletop (A-1 or A-2) and assemble them together.

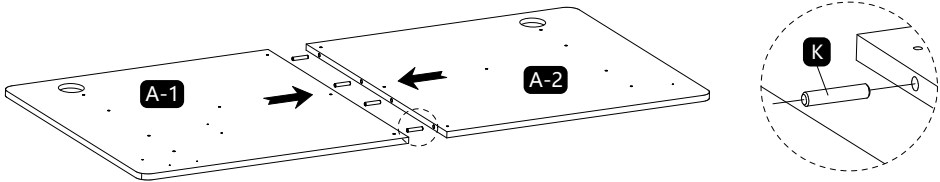

2. Align and attach Fixture (J) to the assembled tabletops. Tighten them with M6x14 Bolt (M-A) and Allen Key (M-E)

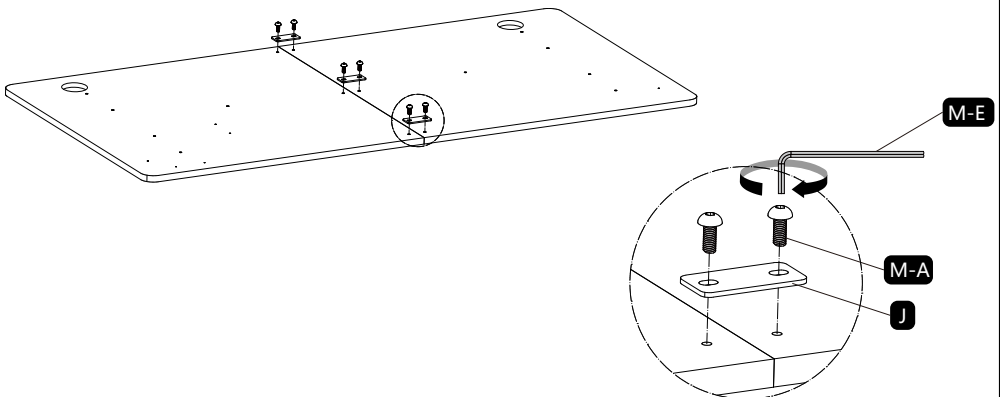

## STEP 2

Attach Side Bracket (C) to Frame (B) with 4 pcs of M6x12 Bolt (M-C).  
Tighten them with Allen Key (M-E).

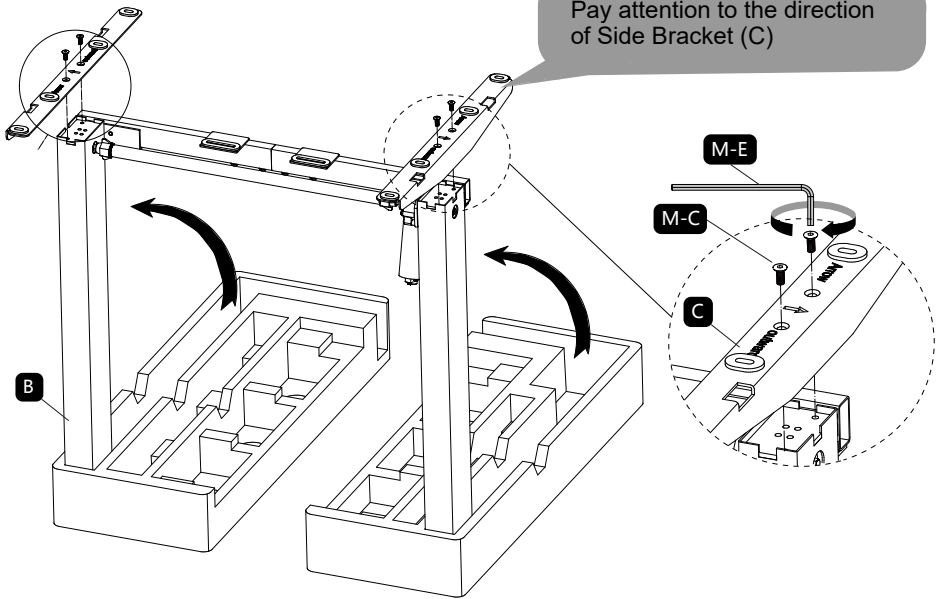

## STEP 3

Attach Base (D) on Frame (B). Use 8 pcs of M6x20 Bolt (M-B) and  
Allen Key (M-E) to tighten them.

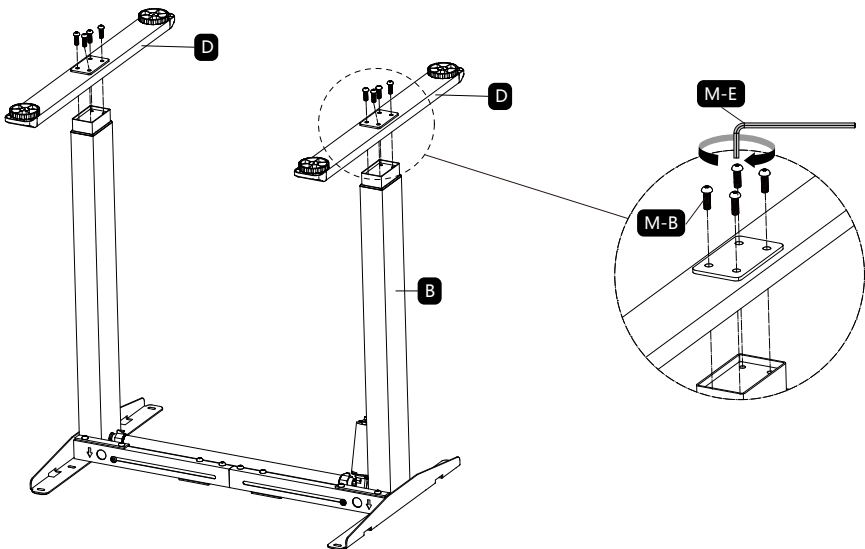

## Caters Installation (Optional)

**Note:** As you prefer, you can replace the leveling studs with four casters. Remove the pre-assembled leveling studs and save them for future use. Insert Caster with Lock (L) and use Wrench (M-F) to tighten them.

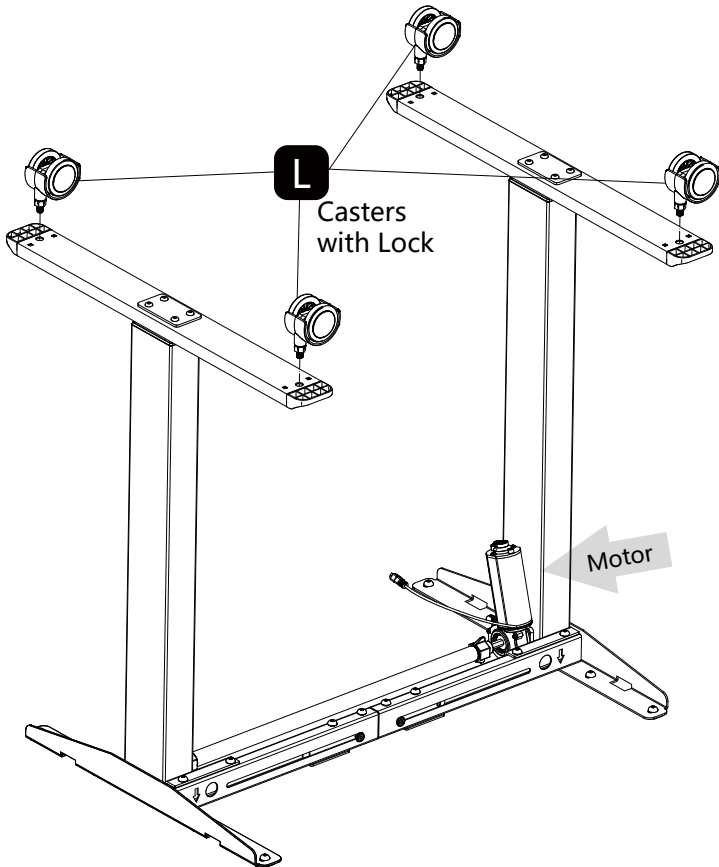
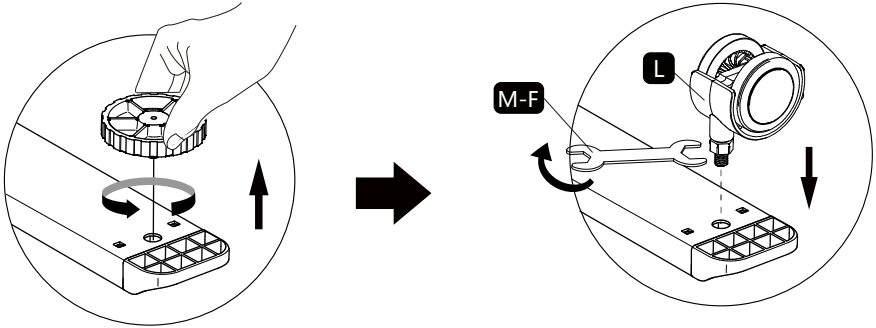

## STEP 4

Use Allen Key (M-E) to loose the pre-assembled crossbar screws and loose the plastic sleeves on hexagon rod.

Then adjust the length of Frame (B) to the limit position.

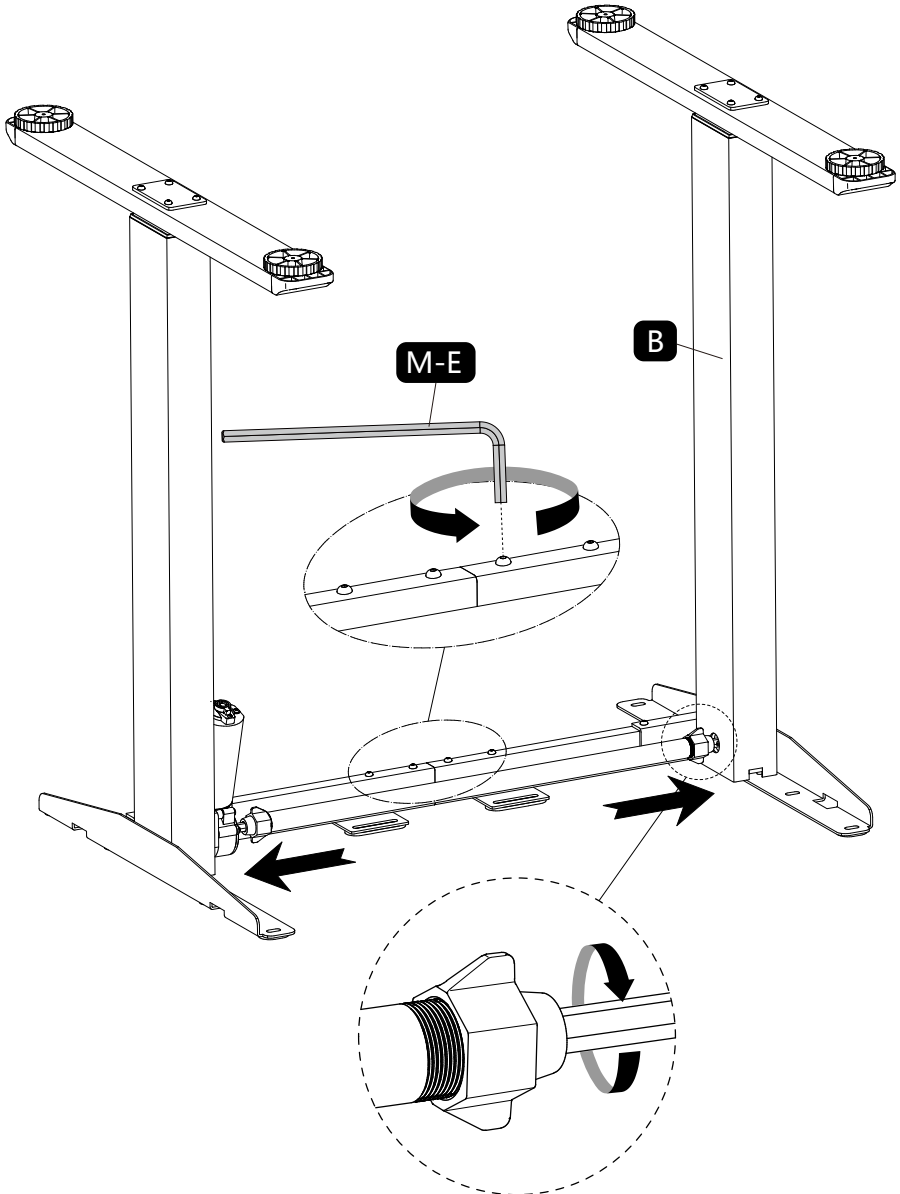

## STEP 5

**Note:** It's highly suggested not to tighten the bolts one by one, instead, align them firstly and then tighten when they are all aligned well.

1. Place and align Frame (B) to the assembled tabletop (A) with 12 pcs of M6x14 bolt (M-A). Use Allen Key (M-E) to tighten them.

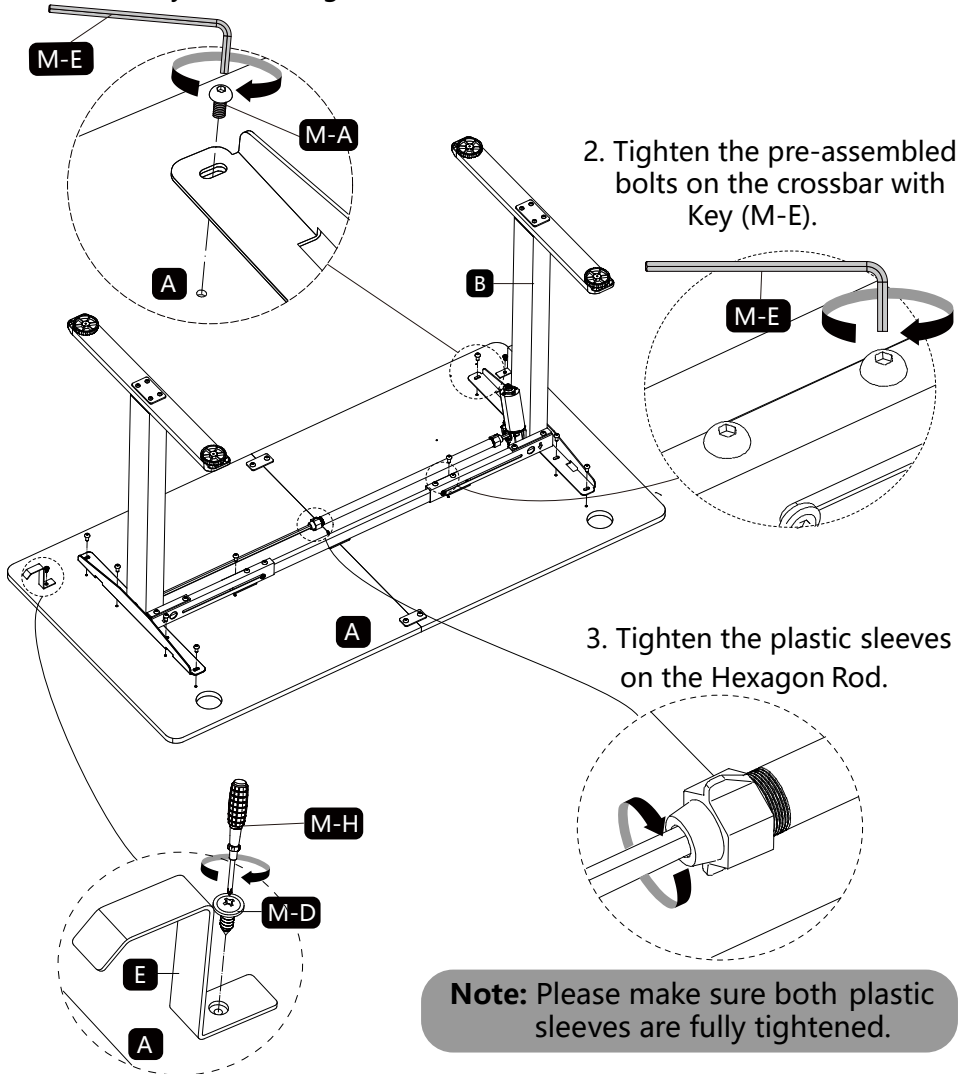

4. Attach Hook (E) to the tabletop (A). Use Screw (M-D) and Screwdriver (M-H) to tighten them.



## STEP 6

**Note: The Controller should be installed close to the motor.**

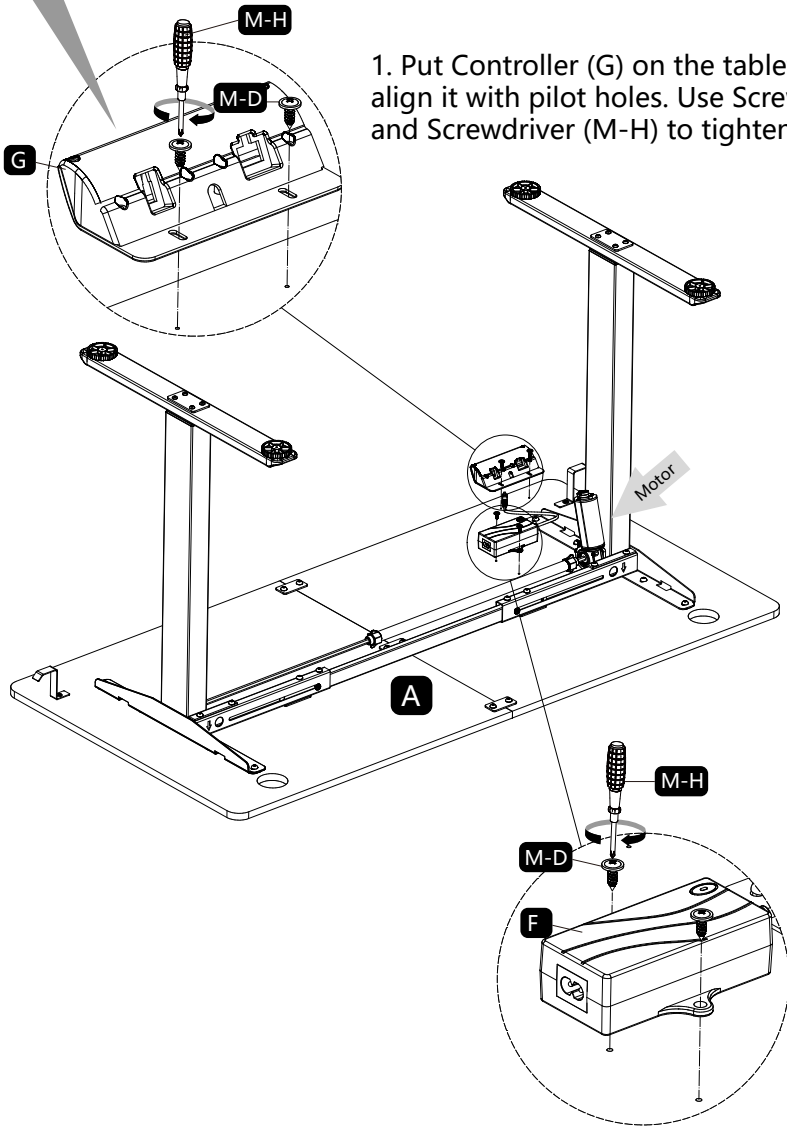

1. Put Controller (G) on the tabletop and align it with pilot holes. Use Screw (M-D) and Screwdriver (M-H) to tighten them.

2. Align Power Adapter (F) with the pilot holes, and then tighten it with Screw (M-D) & Screwdriver (M-H).

## STEP 7

1. Connect the motor wire to Controller (G).
2. Connect the wire of Power Adapter (F) to Controller (G).
3. Connect Power Wire (H) to Power Adapter (F).

Motor to Controller

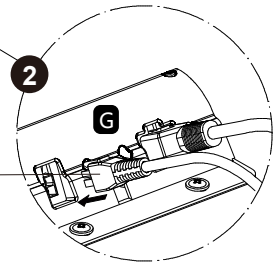
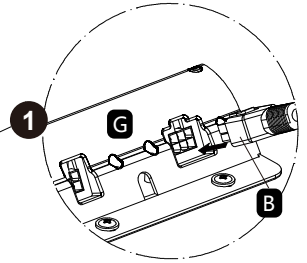

Power Adapter to Controller

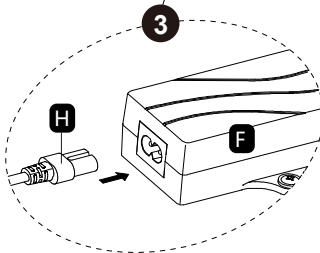

Power Wire to Power Adapter

## STEP 8

Attach Cable Clip (M-G) to the backside of the assembled tabletop for cable management.

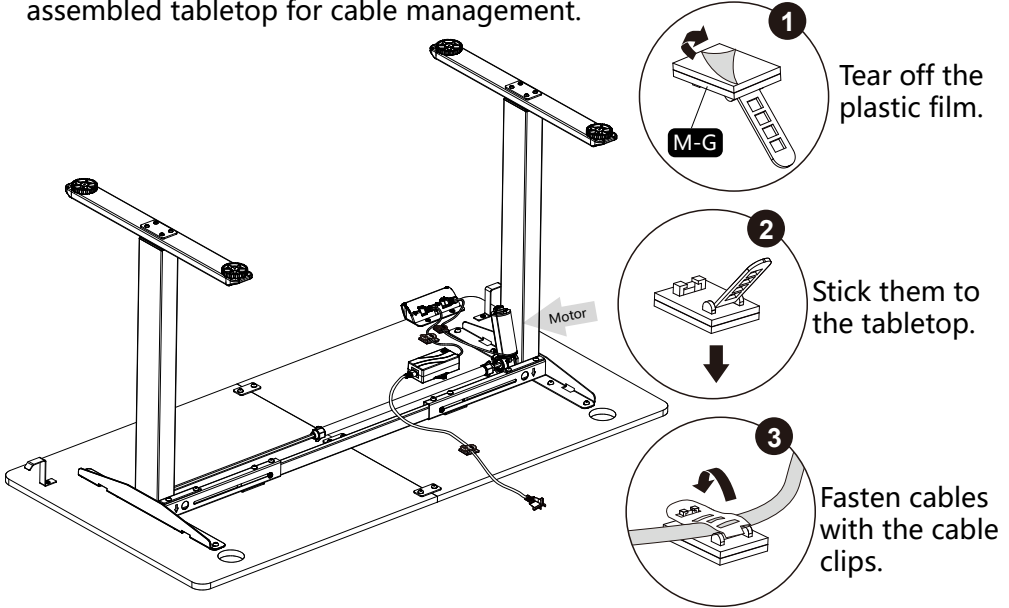

## STEP 9

1. Turn over the desk to stay upwards and insert Grommet (I).
2. Make sure the legs are level and all bolts are well tightened to avoid the desk making noise or wobbling.
3. Plug in the power supply and let the desk power on.

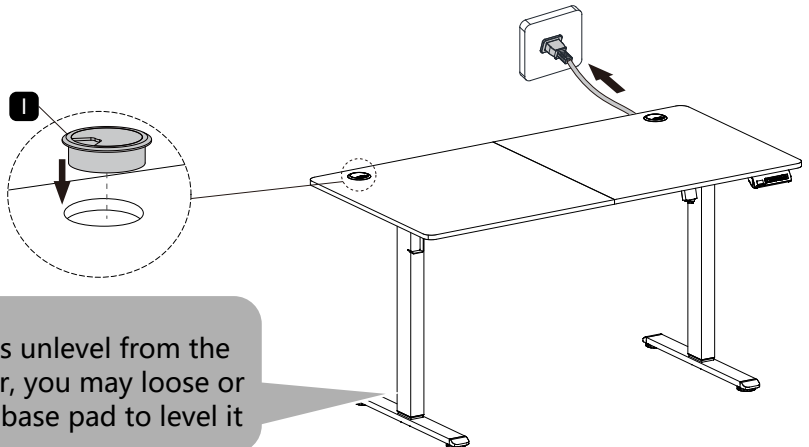

**Note:**

If the desk is unlevel from the bumpy floor, you may loose or tighten the base pad to level it

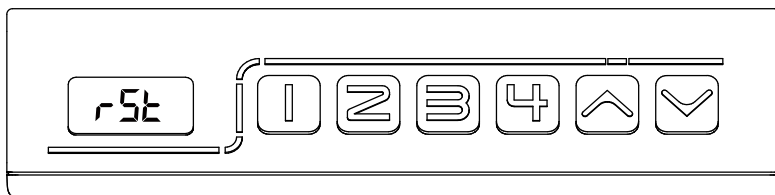

<p><b>Program Reset</b></p>	<p>To reset the program, press and hold the " ∨ " button until the desk move to the lowest height and the screen shows " 29.1 ", then release.</p>
<p><b>Height Adjustment</b></p>	<p>Press and hold " ^ " to raise the desk, press and hold " ∨ " to lower the desk. The height will be showed on the screen.</p>
<p><b>Preset Memory Height</b></p>	<p>When desk moves to desired height, press and hold " 1 " button for 3 seconds, the current height is saved as " S-1 ". Continue the same step to preset your " S-2 ", " S-3 ", " S-4 " memory height.</p>
<p><b>Adjust to Preset Height</b></p>	<p>Press " 1 " button, desk will run to the preset " S-1 " height. Same operation for " 2 ", " 3 " and " 4 ".</p>
<p><b>Set Child Lock</b></p>	<p>Press and hold both buttons " ^ " &amp; " ∨ " for 5 seconds, the desk will be locked when " Loc " is displayed on the screen. You can press and hold both button " ^ " &amp; " ∨ " for 5 seconds to unlock it.</p>
<p><b>Anti-collision Protection</b></p>	<p>Desk will retract if encounters obstacle during its vertical movement. Please make sure no obstacle under or above desk's moving scope.</p>

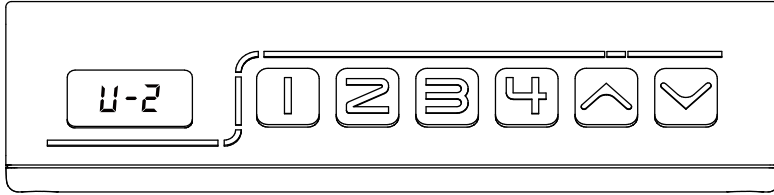

### Set Anti-collision Sensitivity

The anti-collision sensitivity of the desk defaults to 2.

If you need to set the sensitivity, please do the following steps.

-Press and hold "1" and "2" for more than 20 seconds, until the controller screen flashes, the system can start setting.

-Press button "1" and "2" simultaneously, you can select the menu: U-0 and d-0.

U-□ means upward anti-collision sensitivity.

d-□ means downward anti-collision sensitivity.

-Press "^" or "v" can adjust the number from 0-9 (0 means no sensitivity, 9 means the highest sensitivity).`

-Press and hold "1" and "2" for 5 seconds, when the screen shows **888** , the modified content is saved.

## Product Dimensions

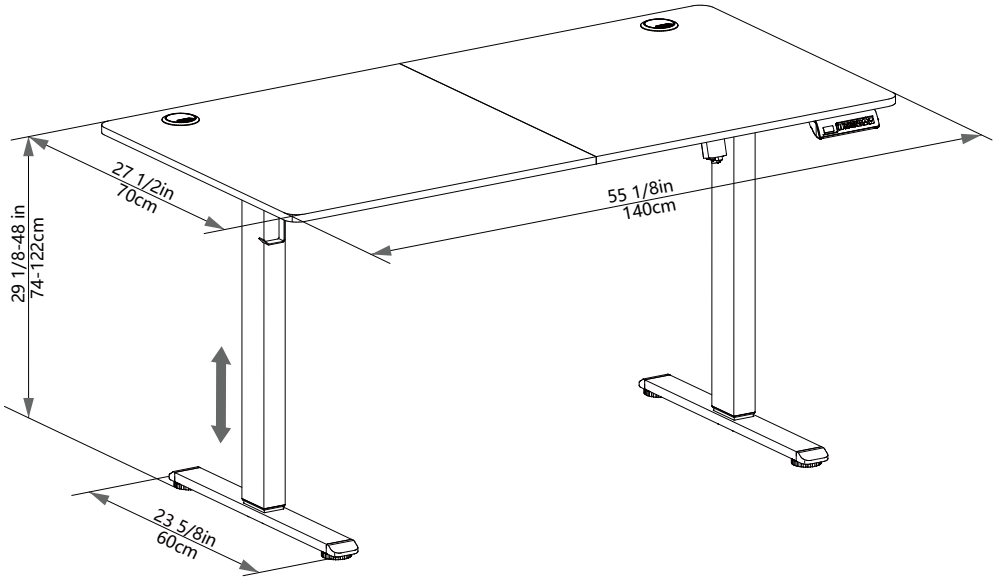

## Technical Specifications

Lowest Height	29 1/8in (74cm)
Highest Height	48in (122cm)
Weight Capacity	176 lbs (80Kg)
Tabletop Size	55 1/8in × 27 1/2in × 5/8in 140cm × 70cm × 1.5cm
Input Voltage	AC 100-240V
Travel Speed	25mm/s
Applicable Temperature	0~40°C
Noise	≤50 dB