

Single Monitor Desk Mount

Instruction Manual

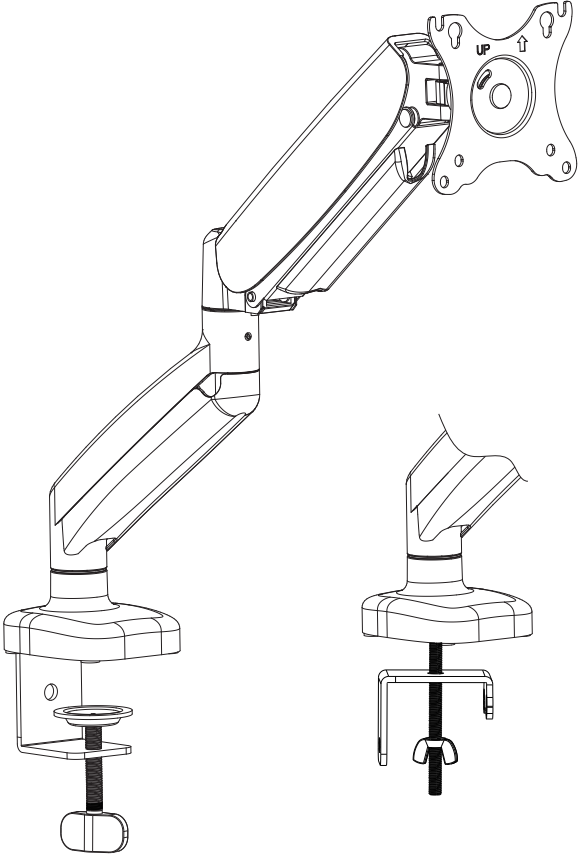

⚠ WARNING!

If you have any confusions or are not quite sure about the installation, please do not hesitate to ask for our help.

Before assembly, please check and make sure all necessary accessories are included and undamaged. Improper installation, such as use the product for monitors over its load capacity or for any purpose not explicitly specified, may cause damage or serious injury. We would not be liable for any damage or injury caused by improper mounting or inappropriate use.

The kit contains small items that could be choking hazards if swallowed. Please keep them OUT OF REACH OF CHILDREN UNDER 3 YEARS OLD. ADULT SUPERVISION IS REQUIRED.

PACKAGE CONTENTS

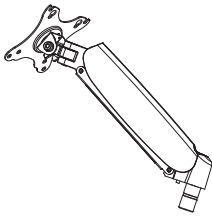

A (x1)
Upper Arm



A1 (x1)
Cable Cover

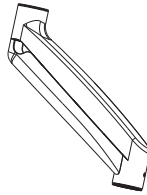

B (x1)
Lower Arm

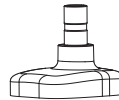

C (x1)
Base

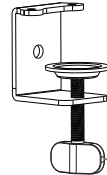

D (x1)
Clamp



E (x4)
Pad



F (x1)
Carriage Bolt



G (x1)
Wingnut

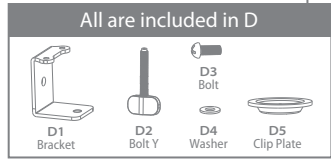

H (x1)
Grommet Base



I (x3)
M6x10



J (x1)
3mm Allen Key



K (x1)
4mm Allen Key



L (x1)
6mm Allen Key



M-A (x4)
M4x12

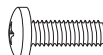

M-B (x4)
M6x12



M-C (x4)
D6 Washer



M-D (x4)
spacer

NOTE: Not all hardware included will be used.



DO NOT EXCEED WEIGHT CAPACITY.

ASSEMBLY STEPS

STEP 1: Apply Pads to the Base Bottom

Apply pads (E) to the base bottom to avoid desk scratches.

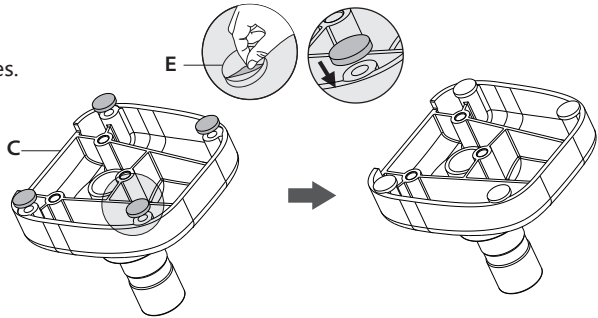

STEP 2: Clamp Installation or Grommet Base Installation

OPTION A: Clamp Installation

Mount Clamp (D) to the bottom of Base (C) by tightening screws (I) with 4mm Allen Key (K).

Adjust the Clamp width to fit your desk. Secure stand to the desktop by tightening Bolt Y (D2).

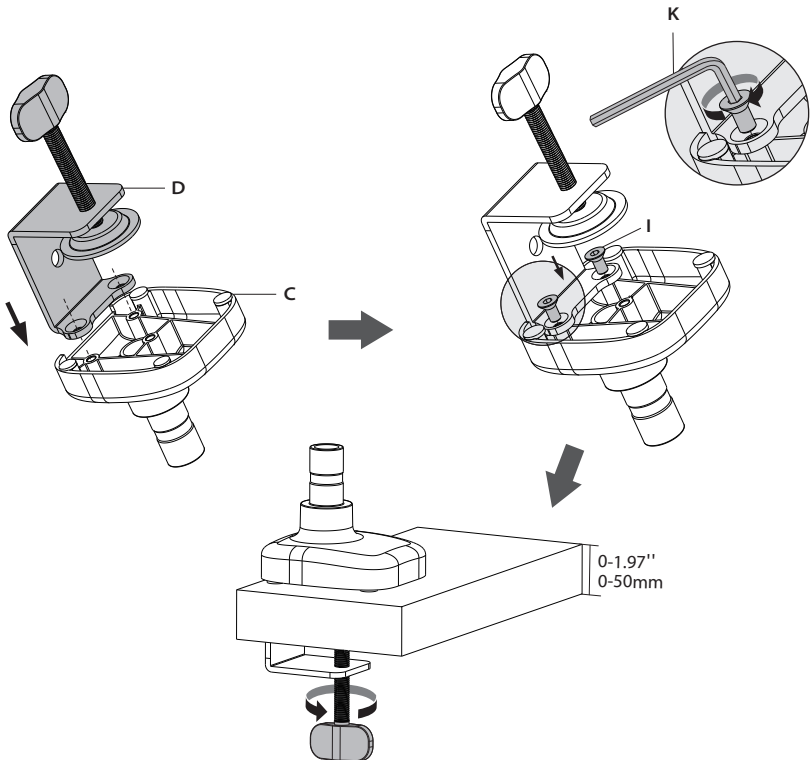

STEP 2: (Continued)

OPTION B: Grommet Base Installation

Firstly detach Bracket(D1) from Clamp (D).

Then run Carriage Bolt(F) through Grommet Base(H) and fix them to Base(C) by tightening screws(I) with 4mm Allen Key(K).

Next get the Carriage Bolt(F) through your desk hole.

Finally, by making Bracket(D1) through Carriage Bolt(F) and stacked above Wingnut(G), and then tightening Wingnut(G), Base(C) would be fixed to your desk securely.

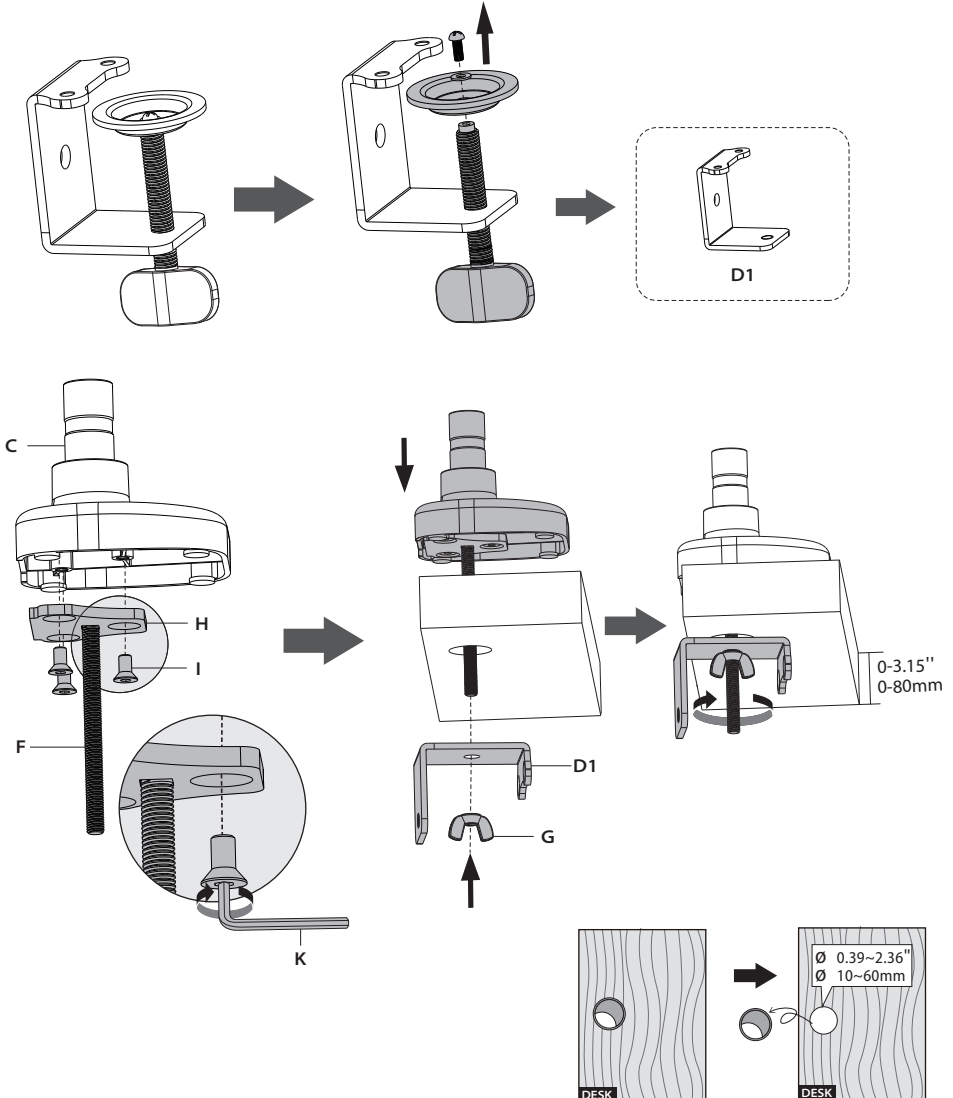

STEP 3: Arm Installation

Install the lower arm (B) and the upper arm (A) to the base (C). Secure the arm by tightening the inside screw using 3mm Allen key (J).

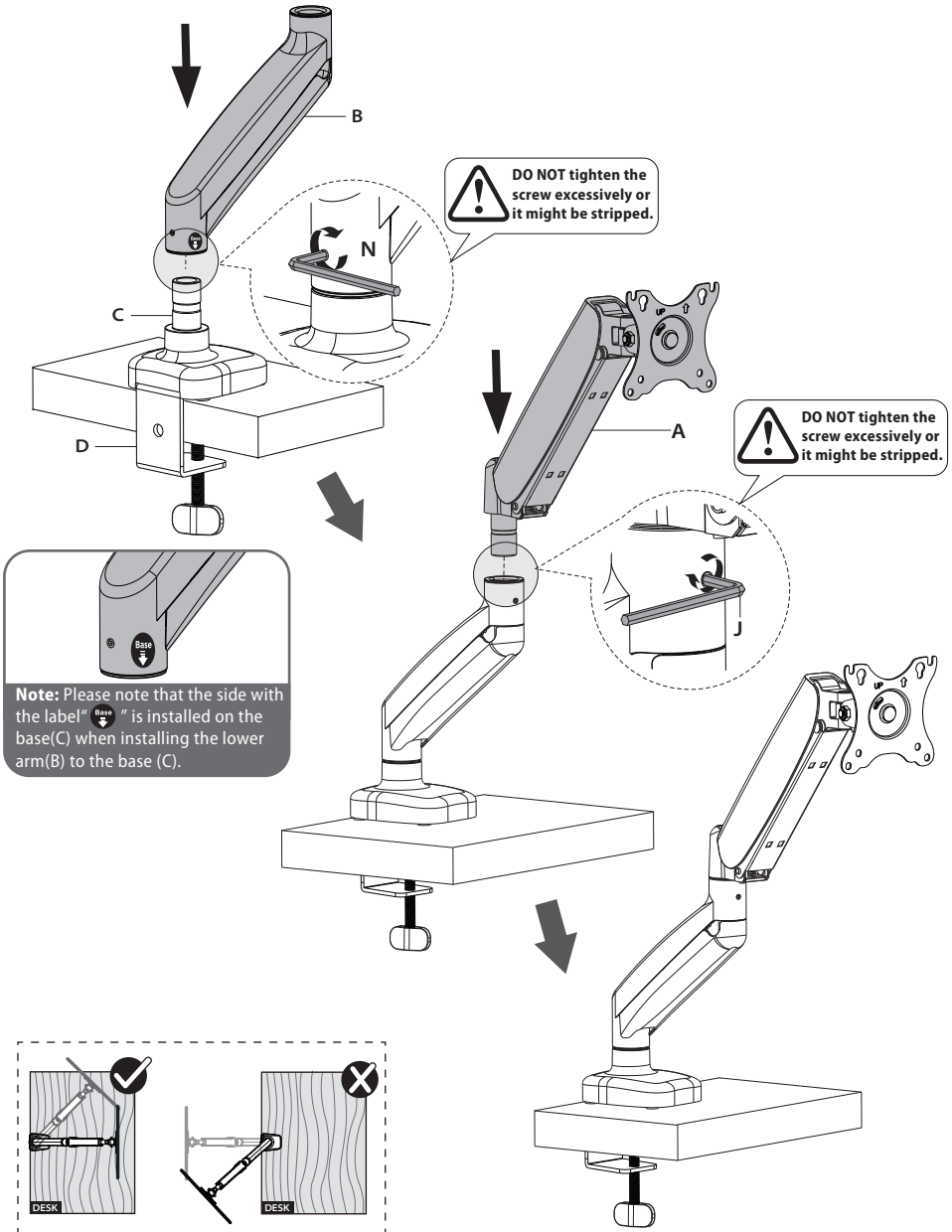

STEP 4: Attach Monitor

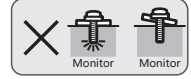
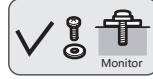
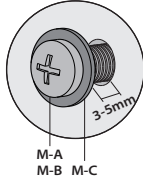
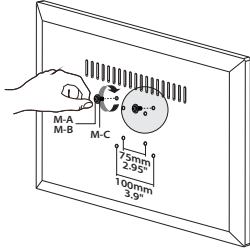

OPTION A: Flat Back Monitor

Firstly choose suitable screws(M-A or M-B) according to the hole size of your monitor back; then assemble two of them with 3-5mm space left. Next hang your monitor onto VESA plate of Upper Arm(A). Finally finish the attachment by using a 6mm Allen Key(L) to tighten all chosen screws(M-A or M-B) along with D6 Washers(M-C). Please pay attention to not tighten the screws much excessively which may cause your monitor damage.

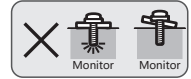
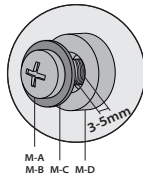
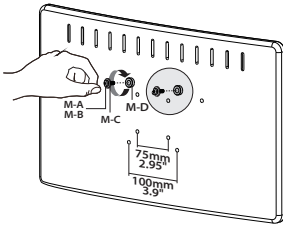
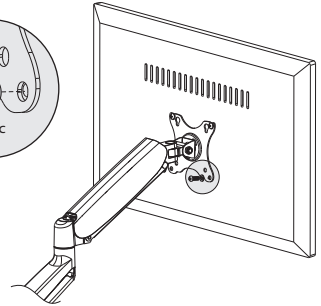
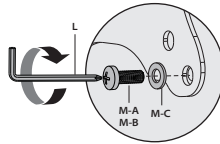
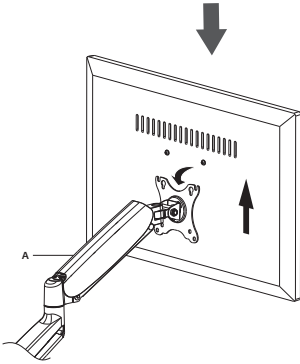

OPTION B: Curved Back Monitor

Firstly choose suitable screws(M-A or M-B) according to the hole size of your monitor back; then assemble two of them with 3-5mm space left. Next hang your monitor onto VESA plate of Upper Arm(A). Finally finish the attachment by using a 6mm Allen Key(L) to tighten all chosen screws(M-A or M-B) along with D6 Washers(M-C) and Spacers(M-D). Please pay attention to not tighten the screws much excessively which may cause your monitor damage.

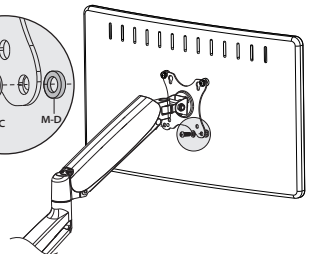
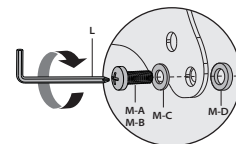
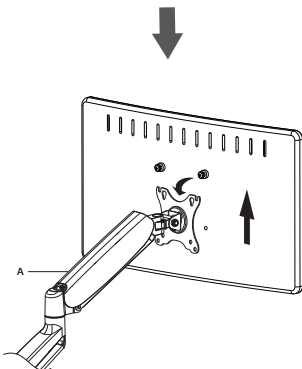

STEP 5: Tilt Adjustment

Problem:
Monitor tilts down.

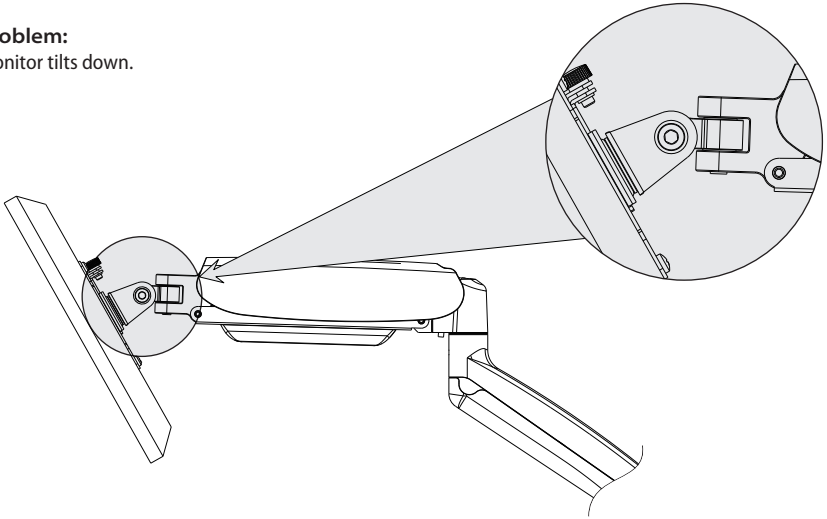

Solution:

1. Loosen the tilting bolt.
2. Hold the bottom of monitor with one hand and adjust to determine your desired tilt angle.
3. Retighten the tilting bolt to fix the intended angle.

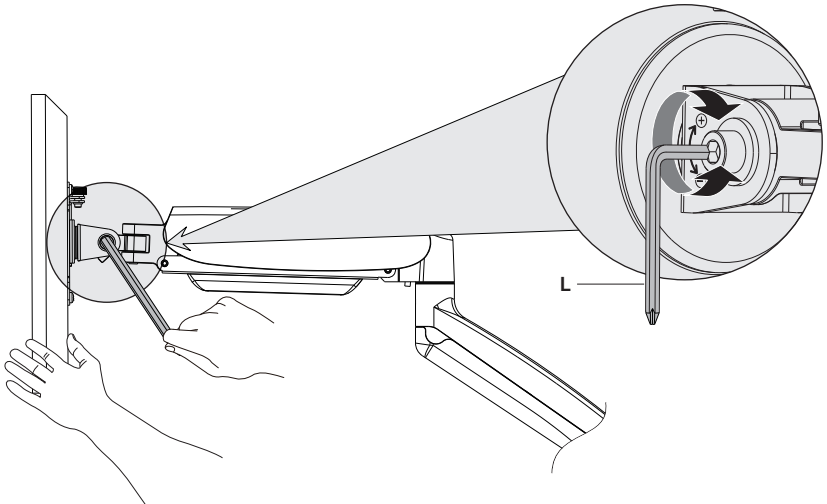

STEP 6: Adjust Tension

For intended functioning of the mount, you may need to adjust the tension of Upper Arm (A) in accordance with your monitor weight by 6 mm Allen Key (L).

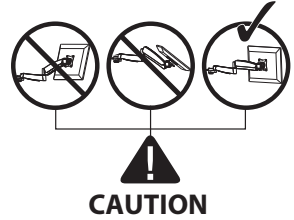
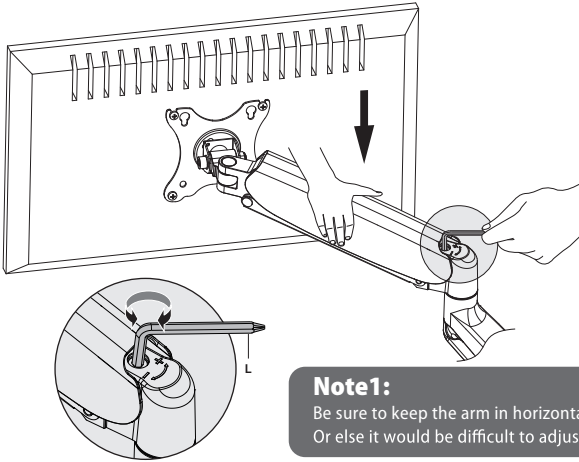

Note1:

Be sure to keep the arm in horizontal position during adjustment. Or else it would be difficult to adjust the mount or damage the mount.

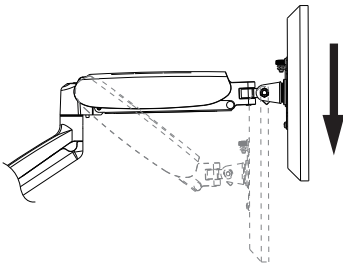

Situation 1: Arm falls down

Upper Arm with monitor falls down and fails to stay where intended.

Solution:

Turn the inside screw counterclockwise(“+”direction) to increase gas spring tension until the arm can stay as intended.

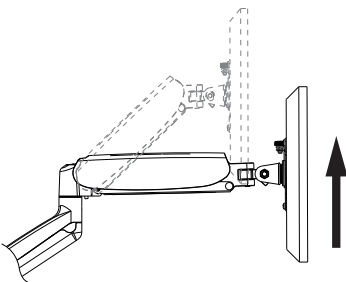

Situation 2: Arm rises up

Upper Arm with monitor rises up and fails to stay where intended.

Solution:

Turn the inside screw clockwise(“-”direction) to decrease gas spring tension until the arm can stay as intended.

Note2:

For how many circles the screw should be turned, please refer to the table below.

Monitor Weight	2kg	3kg	4kg	5kg	6kg	7kg	8kg
Circles (AT LEAST)	min	1	4	8	11	14	17

STEP 7: Cable Management

7-1 Remove Cable Cover

- For lower arm: Remove the bottom plastic cover from lower arm as shown in the diagram below.

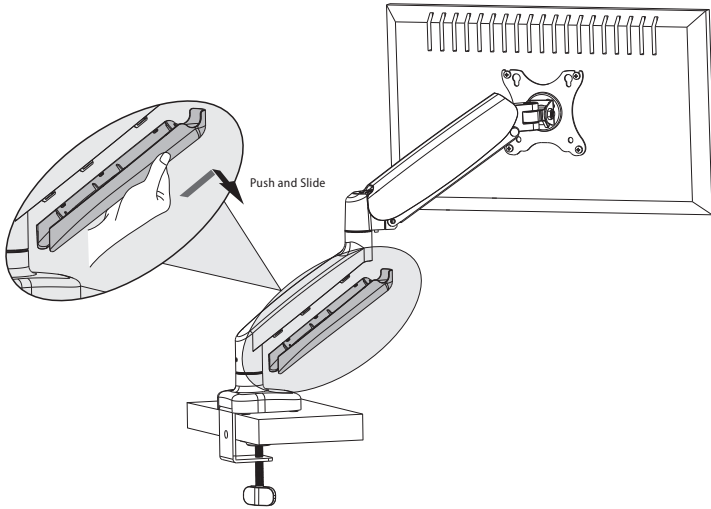

7-2 Attach Cable Cover

- For lower arm: Run cables through the cable cover, then insert and slide the cover down for reattachment;
- For upper arm: Run cables through the cable cover, then with both hands slightly press inwards the tabs inside the cover and insert it to upper arm.

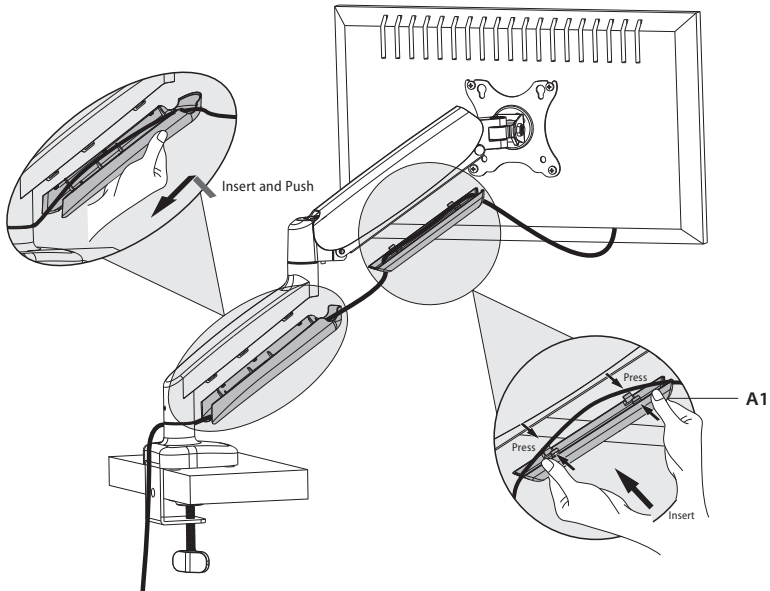

Adjust as Desired

Adjust monitor position and rotation.

- Tilt
- Swivel
- Rotation
- Height

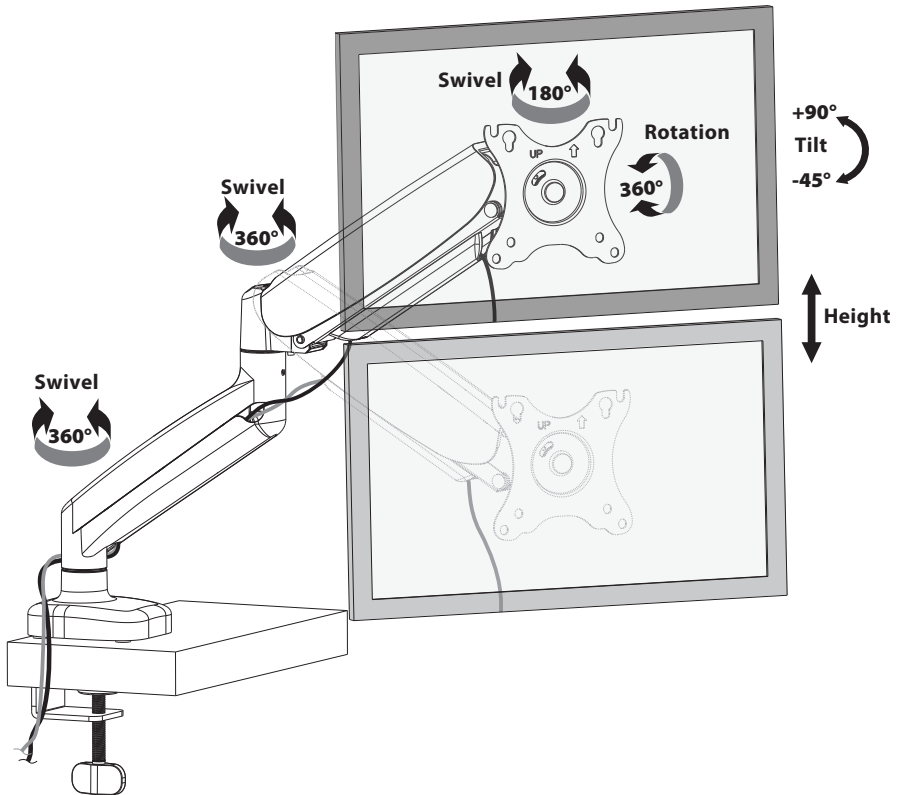

Note: To ensure stability, the tightness of the rotating axis has been preset, so it would be kind of difficult to rotate the VESA plate.
Suggestion: Please attach the monitor first, then hold the two sides of it with both hands, and rotate vigorously.
If that doesn't work out, please do not hesitate to ask for our help.

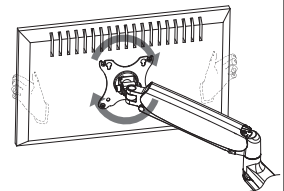

Product Dimensions

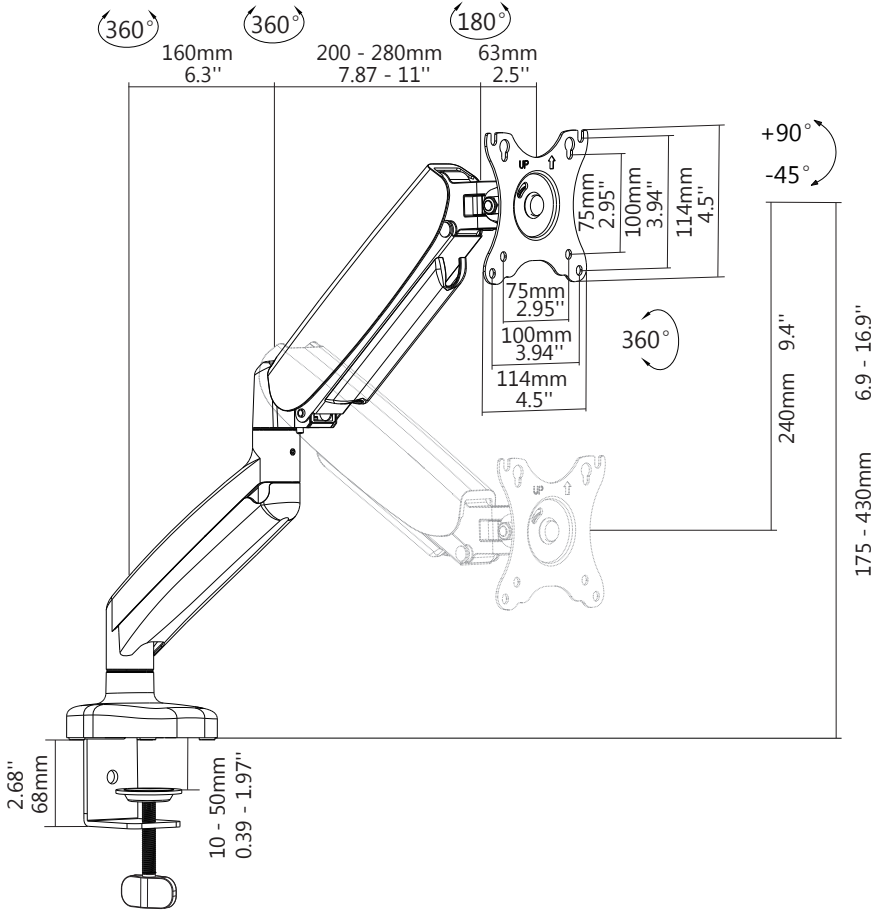



CAUTION AND MAINTENANCE:

- Never allow children to climb, stand, hang, or play on any part of monitor or stand.
- This product is intended for indoor use only. Using this product outdoors could lead to product failure and personal injury.
- Check that the bracket is secure and safe to use at regular intervals (at least every three months).