

# INSTALLATION INSTRUCTION

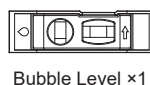
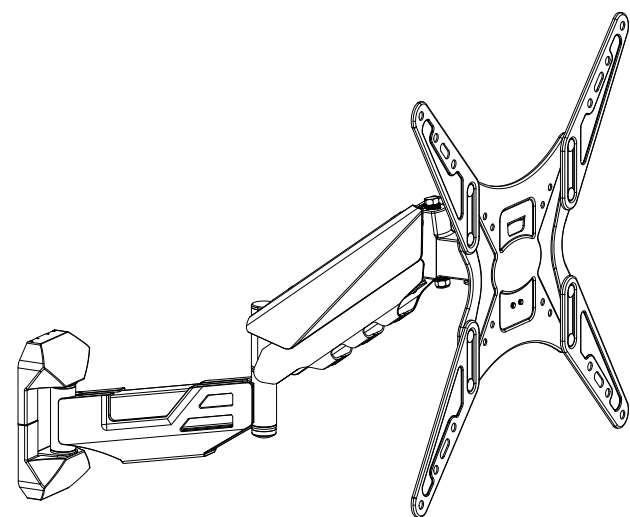

Min: 100x100mm /4x4"  
Max: 400x400mm/16x16"

WMA-44MU-DY

If you have any questions, please feel free to contact us via Amazon.

### Warm Tips

You could also refer to the Video Guide about installation on our product page.

## Safety Caution

Please read this instruction carefully before installation. If you do not understand these instructions or have doubts about the safety of the installation, assembly or use of this product, please contact us.

- This product is designed for use in wood stud or solid concrete wall.
- **DO NOT install into drywall alone.**
- The wall must be capable of supporting five times the weight of the TV and mount combined.
- Incorrect installation may result in product damage or body injury.

**WARNING:** This product contains small items that could be a choking hazard if swallowed. Before starting assembly, verify all parts are included and undamaged. For parts shortage or damage, please contact us.

## Must Check Before Getting Started

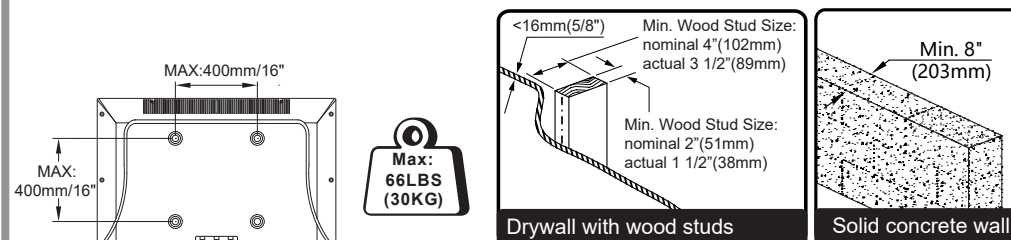

**CAUTION:** DO NOT install into drywall alone.

## Installation Tools (Not Included)

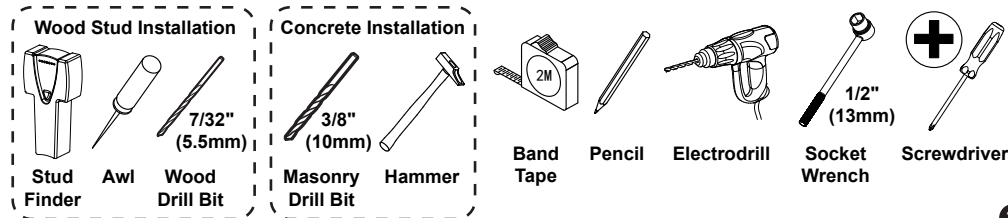

## Hardware Included

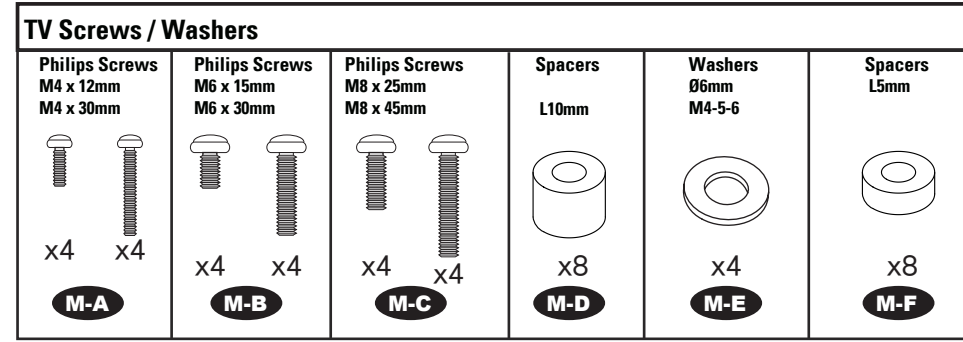
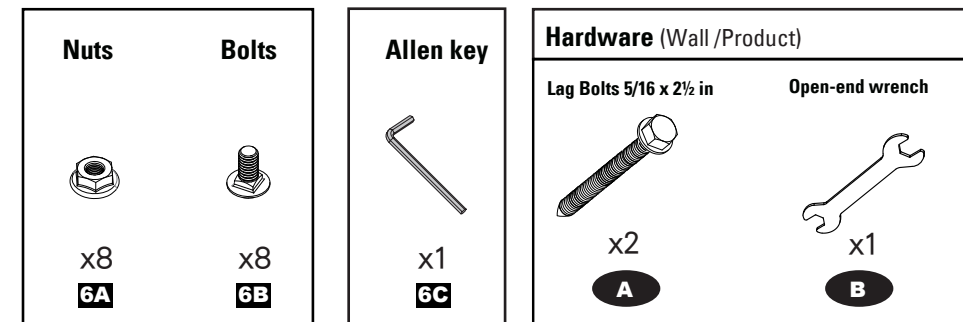
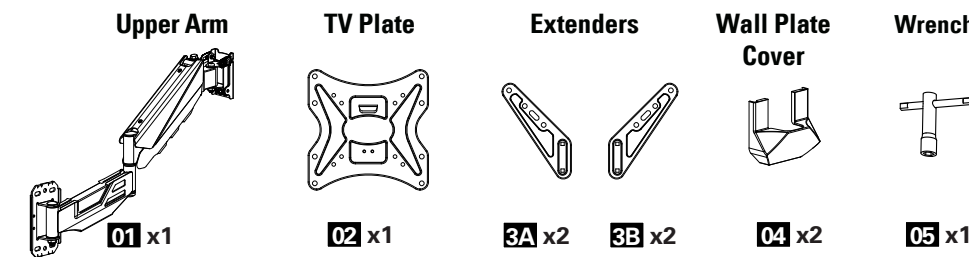

## Step 1-1 Select TV screw diameter

Thread screws by hand into the threaded holes on the back of your TV to select which screw diameter fits your TV.

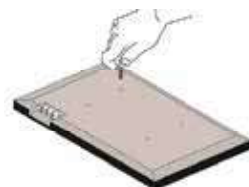

## Step 1-2 Select TV screw length

**Warning:** When attaching brackets to the flat screen, be careful not to over tighten screws and be sure that screws do not bottom out in the mounting holes.



## Step 2 Measure your TV Pattern

Measure and note the width and the height of the square or rectangle formed from the VESA holes pattern.

- 100mm ≈ 4in.
- 130mm ≈ 5 1/8in.
- 200mm ≈ 8in.
- 300mm ≈ 11 3/4in.
- 340mm ≈ 13 3/4in.
- 400mm ≈ 16in.

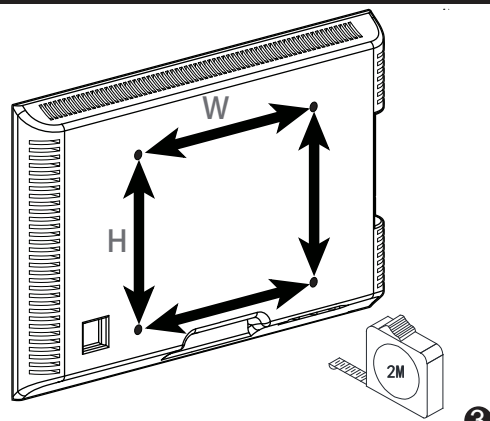

## Step 3-1 Select TV Plate Configuration

Select the configuration A, B, C, D, or E to use based on the measurement from Step 2.

VESA (WxH)	Configuration	VESA (WxH)	Configuration
100mm x 100mm	A	300mm x 200mm	C
130mm x 130mm	A	300mm x 300mm	E
200mm x 100mm	A	400mm x 200mm	C
200mm x 200mm	A	400mm x 300mm	D
200mm x 300mm	B	400mm x 400mm	E
200mm x 400mm	B		

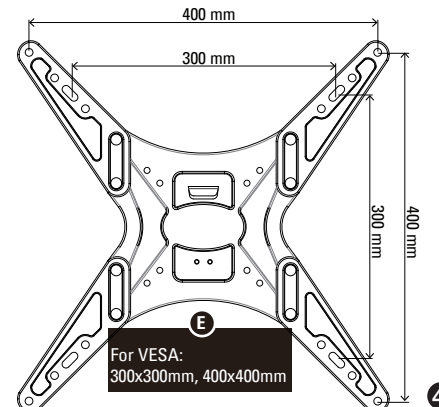
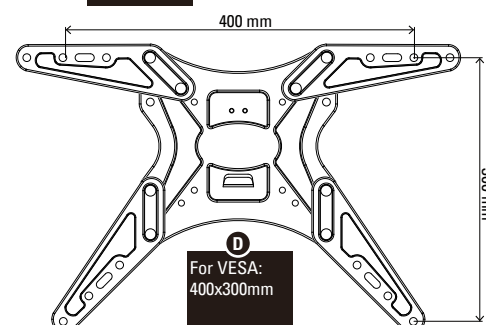
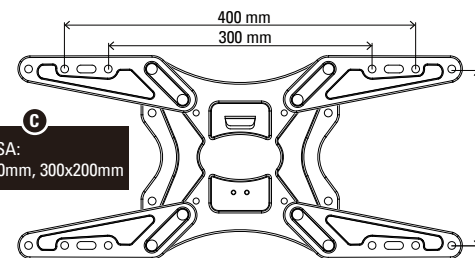
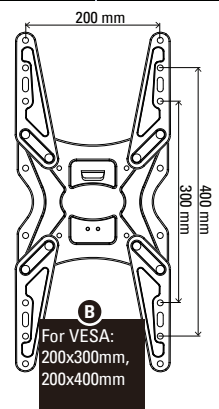
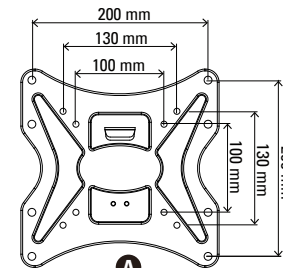

## Step 3-2 Assemble TV Plate and Extenders

If your TV hole pattern is greater than 200x200mm, attach extenders 3A and 3B to TV plate 02 using Nut 6A and Bolt 6B.

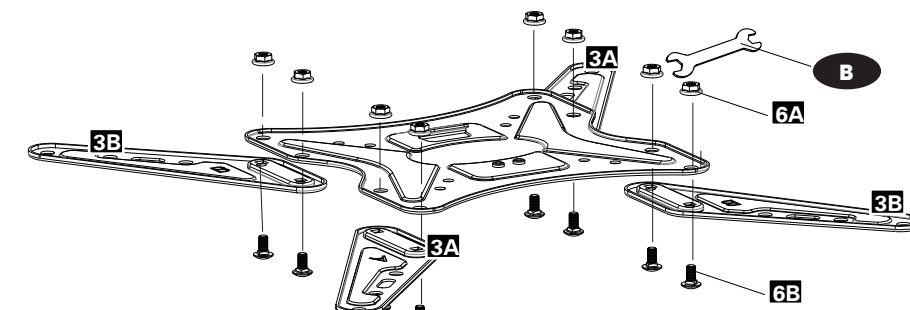

## Step 3-3 Attach the TV Plate

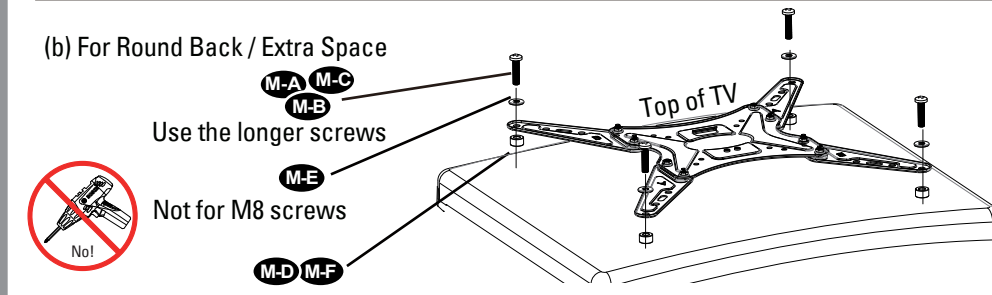
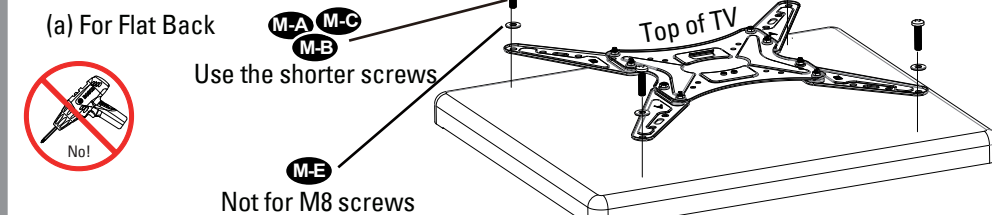

## Step 4A Wall plate installation (Wood Stud)

**A-1**

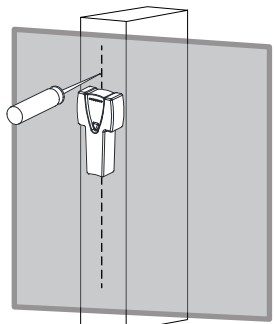

Locate your studs. Verify and mark the center of the stud by finding the stud edges using an awl, a thin nail, or an edge-to-edge stud finder.

**A-2**

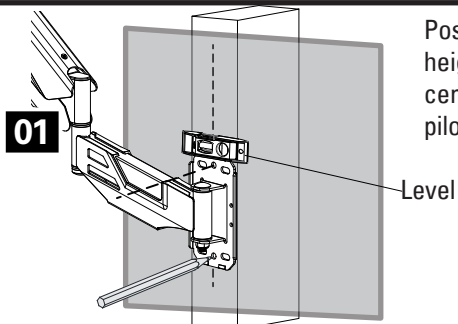

Position the upper arm **01** at your desired height and line up the holes with your stud center line. Level the wall plate and mark the pilot hole locations x2.

**A-3**

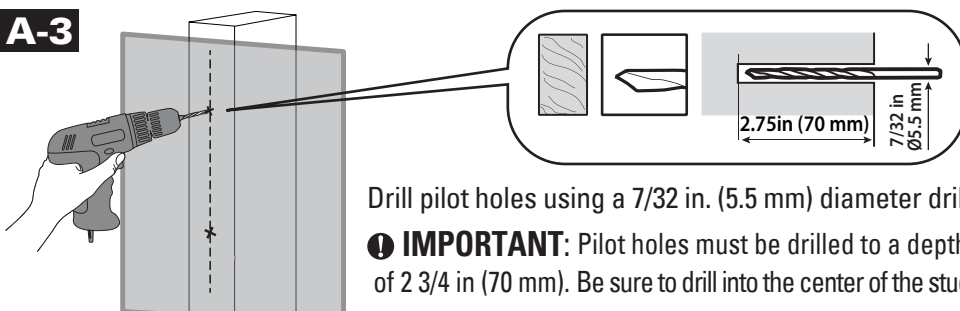

Drill pilot holes using a 7/32 in. (5.5 mm) diameter drill bit.  
**IMPORTANT:** Pilot holes must be drilled to a depth of 2 3/4 in (70 mm). Be sure to drill into the center of the stud.

**A-4**

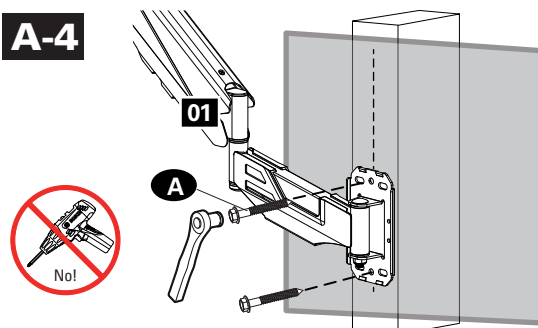

Install wall plate **01** using lag bolts **A** with **Socket Wrench, NO Electrodrill**. Tighten the lag bolts **A** until they are pulled firmly against the wall plate **01**.

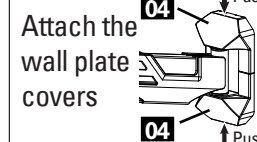

## Step 4B Wall plate installation (concrete or brick)

**B-1**

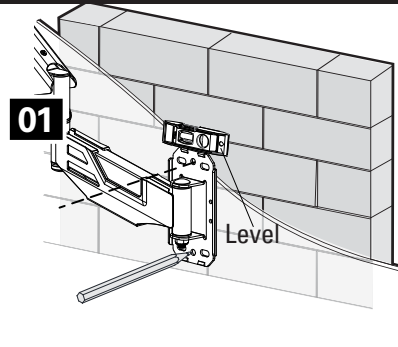

Position the wall plate **01** at your desired height, level the wall plate and mark the pilot hole locations x2.

**B-2**

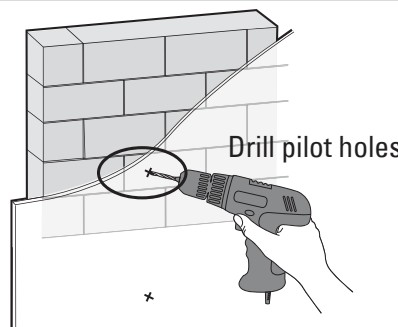

Drill pilot holes

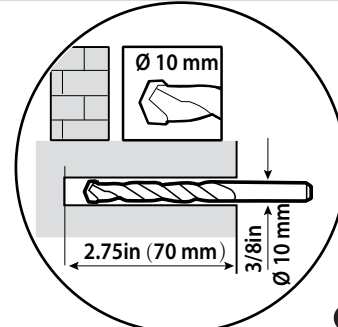

**B-3**

Install wall plate **01** using lag bolts **A** and anchors (not included) with **Socket Wrench, NO Electrodrill**. Tighten the lag bolts **A** until they are pulled firmly against the wall plate **01**. Tighten the lag bolts **A** until they are pulled firmly against the wall plate **01**.

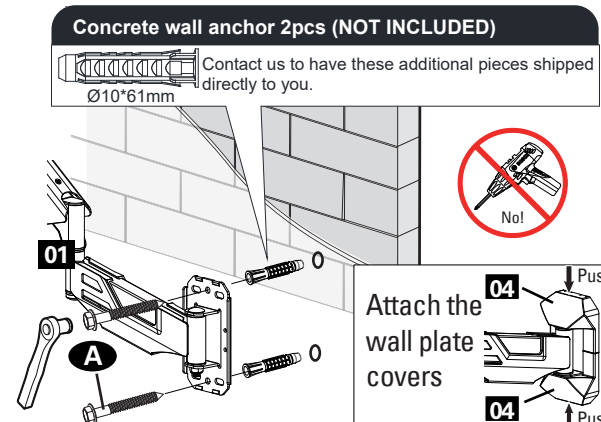

## Step 5 Lift and Hang TV with Brackets onto Wall Bracket

**5-1** Remove 2 preassembled screws and washers before hang TV on to the wall bracket, and save them for using to next step.

**5-2** Lift and hang TV assembly onto arm and wall plate.

**IMPORTANT NOTICE:** The gas spring is pre-set to minimum tension. Once TV is hung on, hold TV with both hands and DO NOT let go suddenly or immediately. Instead, leave TV in a slow & gentle way while observing whether the arms will fall down wildly.

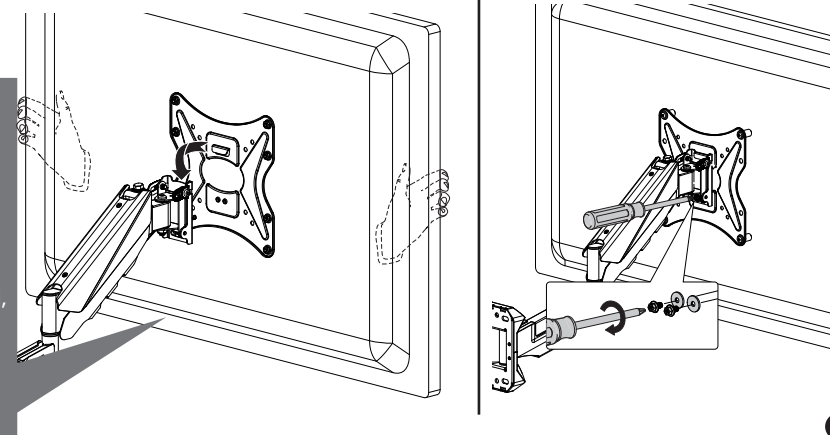

## STEP 6 Adjust Gas Spring Tension

For proper functioning of this mount, You might need to adjust tension in upper arm depending on different weight of TV.

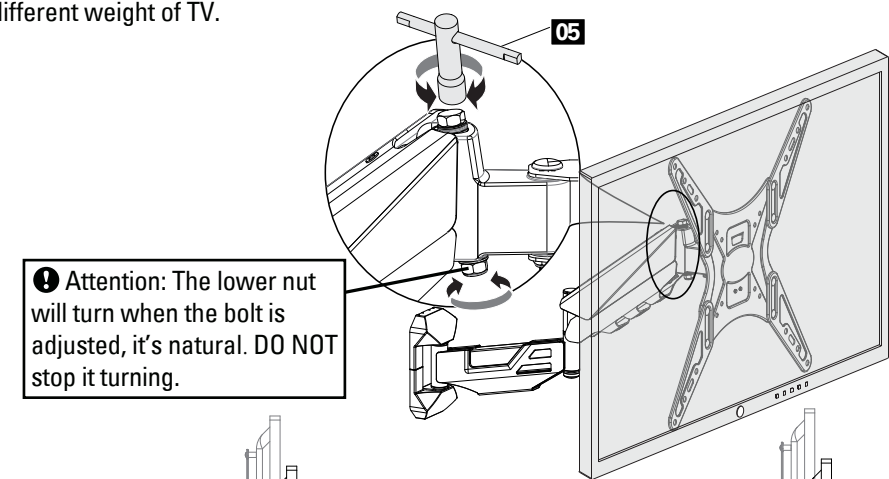

**Attention:** The lower nut will turn when the bolt is adjusted, it's natural. DO NOT stop it turning.

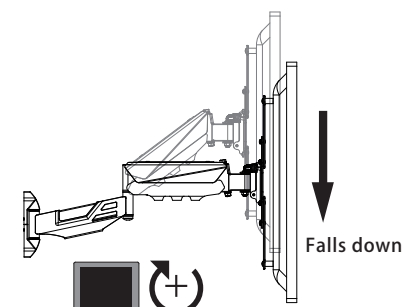

**Situation 1:** Arm falls down  
Upper Arm with TV falls down and fails to stay where intended.  
**Solution:** Turn the inside screw clockwise ("+" direction) to increase gas spring tension till the arm can stay as intended.

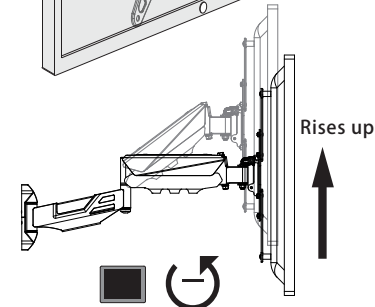

**Situation 2:** Arm rises up  
Upper Arm with TV rises up and fails to stay where intended.  
**Solution:** Turn the inside screw counterclockwise ("- " direction) to decrease gas spring tension till the arm can stay as intended.

As for how many circles the screw should be turned, refer to below diagram.

TV Weight	5kg	10kg	15kg	20kg	25kg	30kg
Circles (AT LEAST)	6	12	16	20	24	30

## Adjustments

### (Tilting Adjustment)

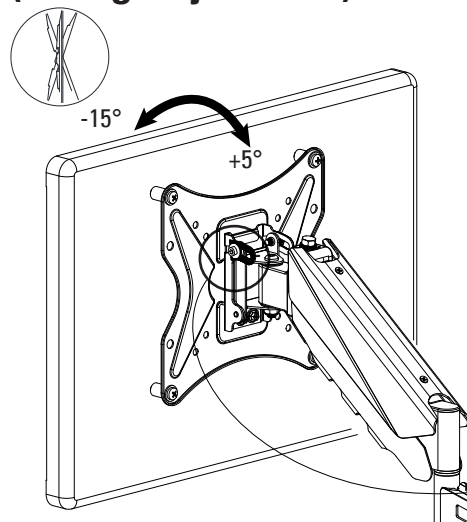

### (Tilting)

Tilting Angle Adjustment (+5° / -15°)  
Loosen 2 tilting bolts, pull TV to your desired angle, then fasten tilting nuts with open-end wrench.

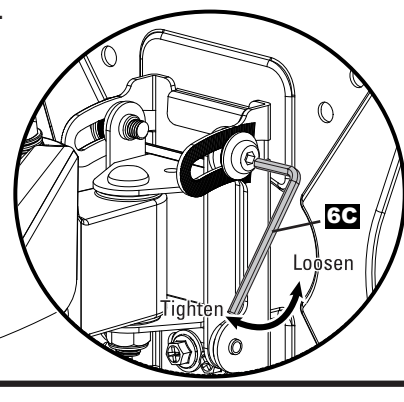

### (Leveling) Leveling adjustment (-3°/+3°)

If needed, TV can be leveled ±3 degrees via adjusting the 2 screws with the open end wrench.

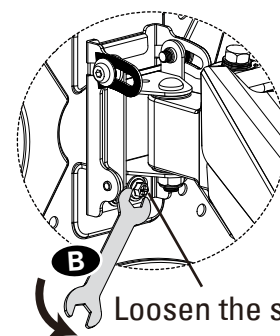

Loosen the screws

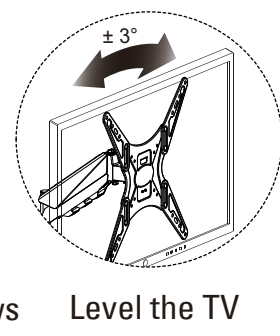

Level the TV

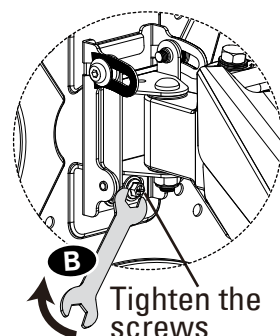

Tighten the screws

## Cable Management

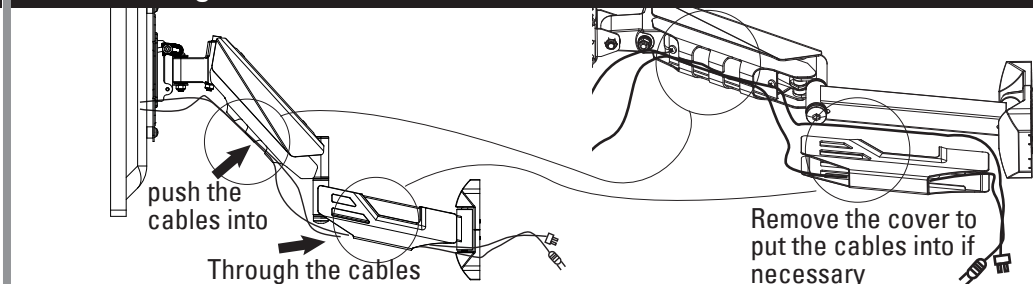

## Product Dimensions:

