

Helpful Information

Tools:

Gather the necessary tools as shown below to complete the installation of this Glass rinser



Adjustable Wrench



Flash Light



Basin Wrench



Safety Glasses



Thread Sealant

Read all instructions before installation.

Turn off hot and cold water supplies at angle stops before installing glass rinser.

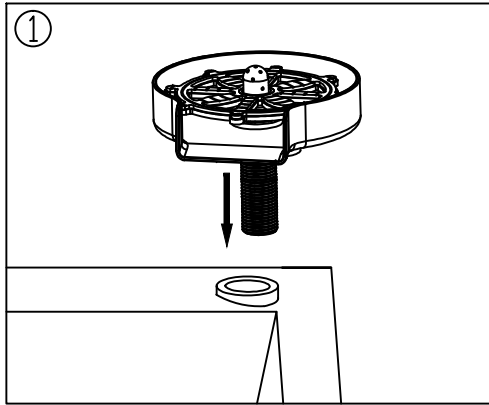

Put the base on the sink hole.

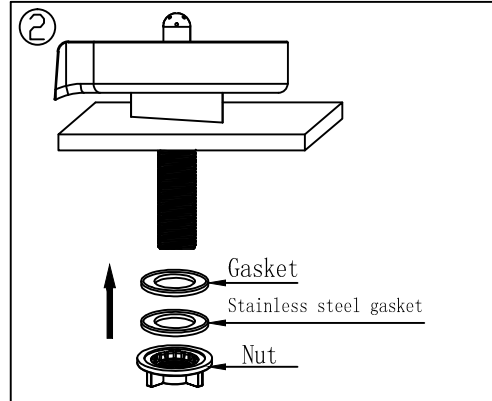

Put the gasket and Stainless steel gasket and nut onto the shank

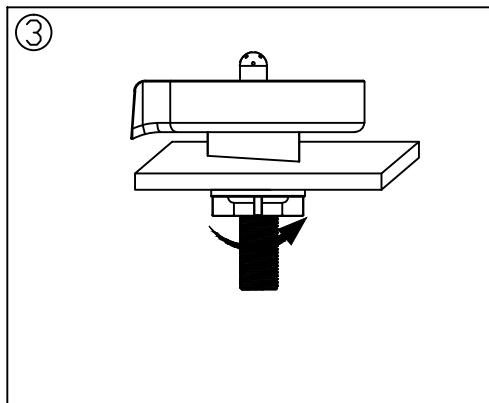

Screw the round nut onto the shank, and tighten.

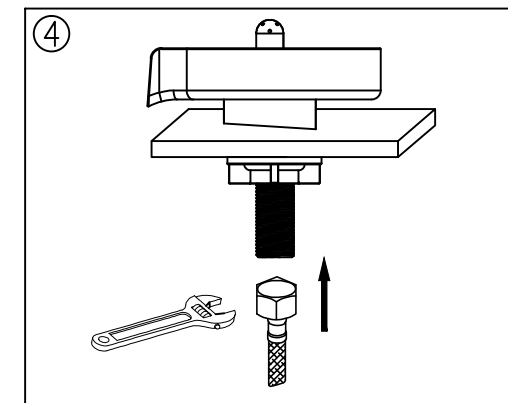

Screw the 1/2" end of provided supply pipe to mounting shank with wrench.

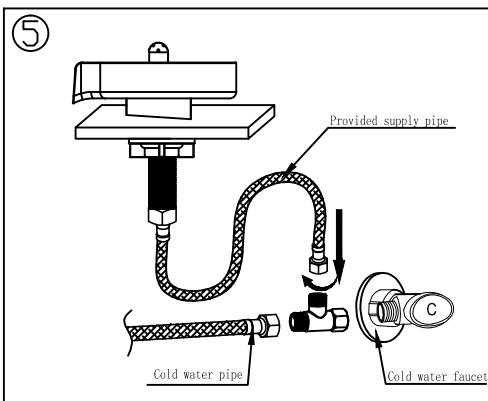

Untie the existing cold water faucet supply pipe from angle stop.
Screw provided tee onto angle stop with wrench.

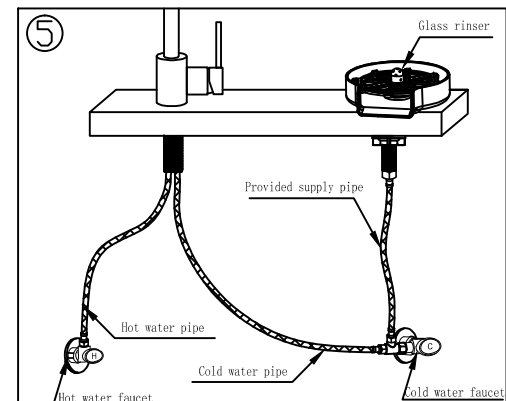

Screw both the faucet supply pipe and the 3/8" end of provided supply line to tee. When pipes are installed, check alignment, retighten mounting nut.