

# Two Handle Centerset Lavatory Faucet

Applicable faucets (including but not limited)



## INSTALLATION

**Prior to installation:** Shut off water supply. Remove old faucet.  
Clean sink/countertop surface in preparation for new faucet

<p><b>01</b></p> <p>Apply some plumbers putty or other suitable sealant to the bottom edge of undercover.</p>	<p><b>02</b></p> <p>Align and press into place</p>	<p><b>05</b></p> <p>Tighten fitting nuts with adjustable wrench. Do not over tighten!</p>	<p><b>06</b></p> <p>Remove excessive putty, adjust slightly the position of faucet</p>
<p><b>03</b></p> <p>Insert the faucet through sink</p>	<p><b>04</b></p> <p>Screw the nut onto shrank, leaving approximately 0.12" (3mm) between the ring and the sink.</p>	<p><b>07</b></p> <p>Connect and tighten the supply hoses.</p>	

## TOOLS YOU WILL NEED



Adjustable wrench



Phillips screwdriver



Hex Wrench



Two Male Supply



pipe tape



Silicone sealant/Putty

Right of product modification such as dimension without notice is reserved.

## Two Handle Centerset Lavatory Faucet

08

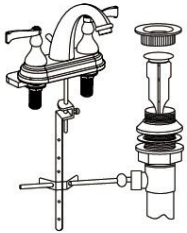

If included, install the drain and lift rod.

09

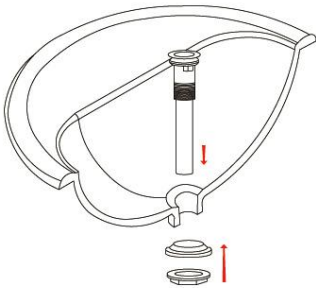

Disassemble the drain, apply plumbers putty to the underside of the flange. Install the flange. Tighten the nut. Wipe away excessive plumbers putty.

10

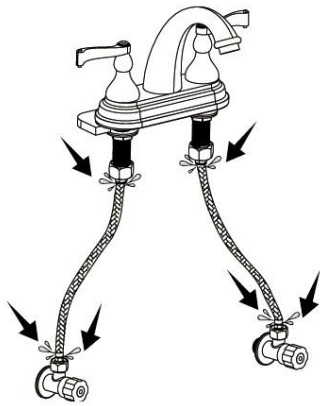

Check for leaks

11

### Care and Cleaning

For best results, keep the following in mind when caring for your VAPSINT product:

- Use a mild detergent such as liquid dishwashing soap and warm water for cleaning. Do not use abrasive cleaners that may scratch or dull the surface.
- Carefully read the cleaner product label to ensure the cleaner is safe for use on the material.
- Always test your cleaning solution on an inconspicuous area before applying to the entire surface.
- Do not allow cleaners to sit or soak on the surface.
- Wipe surfaces clean and rinse completely with water immediately after cleaner application. Rinse and dry any overspray that lands on nearby surfaces.

