

EVEREST

2-IN-1 BIKE TRAILER AND STROLLER

Jeep®

INSTRUCTION MANUAL

ADULT ASSEMBLY REQUIRED
STYLES AND COLORS MAY VARY

A1952-001 Jeep® Parent Organizer sold separately on www.DeltaChildren.com

85000



**▲ WARNING:
CHOKING HAZARD**

Adult assembly required because of small parts. Keep assembly parts out of reach of children under 3 years.

Read all instructions BEFORE assembly and USE of product
KEEP INSTRUCTIONS FOR FUTURE USE.

PASSENGERS MUST WEAR APPROPRIATE HELMET AND SAFETY EQUIPMENT AT ALL TIMES

Customer Experience Center
email: gcs@DeltaChildren.com

DELTA♥CHILDREN

DCP-IM-07152021-V6

WARNING

Keep these instructions for future reference.

- Please follow all of these instructions to ensure the safety of your child.
- Failure to follow these instructions could result in serious injury or death.
- Avoid serious injury from falling or sliding out. **ALWAYS** insure that the child is properly positioned by using the safety harness according to these instructions.
- **ONLY** children who have developed enough upper body control to sit without leaning forward can use the front seat in the upright position.
- **NEVER** leave children unattended.
- Purses, shopping bags, parcels, diaper bags or accessory items may change the balance of the bike trailer/stroller and cause hazardous unstable conditions.
- Make sure all body parts are clear of the bike trailer/stroller when folding and unfolding.
- **ALWAYS** lock brakes when adding and removing children from bike trailer/stroller, or when parked.
- **DO NOT** place hot liquids in the cup holder. Hot liquids can burn your child.
- The maximum weight that can be carried in the rear storage compartment is 13 lbs (1.36 kg). Excessive weight may cause a hazardous unstable condition to exist.
- Before allowing the children near the bike trailer/stroller, be certain the stroller is fully erect and latched in the open locked position.
- Use of the bike trailer/stroller with children weighing more than 50 pounds (22.62 kg) or over 42 inches (106.7 cm) tall, may cause a hazardous unstable condition to the stroller.
- Total weight must not exceed 113 lbs. (2 children under 50 lbs. each and the rear cargo compartment)
- Before attaching the bike trailer to to bicycle, have a professional bike mechanic perform a safety inspection.
- **NEVER** use the bike trailer/stroller on stairways or escalators.
- **NEVER** allow your bike trailer/stroller to be used as a toy.
- **NEVER** use the bike trailer/stroller in conjunction with bicycles, skateboards, roller skates, or in-line skates. Please discuss using the trailer/stroller with your health care provider prior to use.
We recommend that the child occupant needs to be 9 months of age, at the minimum, before use of the stroller and 12 months for the use of the bike trailer.
- **DO NOT** install a car seat or any other seating device in side the bike trailer/stroller.
- **DO NOT** make any modifications to the bike trailer/stroller.
- **DO NOT** allow any of the child's body, clothing, shoe laces or toys to come in contact with moving parts.
- Red reflectors must always be visible on the rear of the bike trailer/stroller.
- Before each ride, ensure the attached bike trailer does not interfere with braking, pedaling or steering of the bicycle.
- Never ride a bicycle at night without adequate lighting. Obey all local legal requirements for lighting.
- Always wear a helmet while operating a bicycle.
- If using the bike trailer/stroller for extended periods of time, ensure passengers have adequate ventilation, proper hydration and are protected from wind and wind chill.
- **DO NOT** use the bike trailer/stroller in incimate weather conditions such as snow or hard rain.
- **DO NOT** use the bike trailer/stroller on hazardous road conditions.
- The maximum speed while using the bike trailer is **15MPH** on flat/smooth roads and **5 MPH** on bumpy/winding roads.

Product features and decorations may vary from the photo.



Max. 2 passengers

Minimum age:

9m in stroller mode

12m in Bike Trailer mode



Max. 42 inches



**Max.
50 lbs.**



**Max.
50 lbs.**



**Max.
13 lbs.**



**Max.
113 lbs.**



**Total loaded weight
including trailer
154 lbs.**



Before returning this product to the store! Let's see if we can assist you!

- **Not sure how to assemble our product?**

Visit our site for easy to follow instructions along with some Tricks and Tips assembly video's
<https://www.deltachildren.com/pages/instructions>

- **If you are missing a piece or have a damaged part**

Please contact our Consumer Experience Center for assistance at gcs@DeltaChildren.com.
To better assist you please have your Style #, Lot # and Manufacturer Date information available along with the part number that you need assistance with.

- **In the event we do not have a replacement part available**

You may need to return your product to the retailer for an exchange or refund.

- **Warranty**

In order to protect your investment, don't forget to register your product.

You may also wish to consider purchasing our extended warranty.

Visit <https://www.deltachildren.com/pages/extended-warranty> for more details.

- **Please note:**

"All Final", "As Is" or Third Party/Liquidator sales are not covered under our Limited Manufacturer Warranty..

DELTA CHILDREN

LIMITED MANUFACTURER WARRANTY

This Delta product is warranted to be free from defects for a period of 90 days from the date of purchase under normal use. This warranty extends only to the original retail purchaser and is valid only when supplied with proof of purchase, or if received as a gift, when the registration is on file with Delta. This limited manufacturer warranty does not cover the following:

- Products purchased as floor models or samples.
- Items purchased on an “as-is” basis, as a second hand product, or as a resale product.
- Items purchased at a Final sale, a “Going out of Business” sale, or a Liquidation sale.

TO REGISTER YOUR PRODUCT for important safety alerts and updates to your product please visit www.deltachildren.com

TO REPORT A PROBLEM, please log on to www.deltachildren.com and click the Consumer Care Tab, or contact us by email at gcs@DeltaChildren.com.

Date of Purchase: _____ (you should also keep your receipt)

EXTENDED WARRANTY

DON'T MISS YOUR CHANCE TO BE COVERED FOR ALL OF LIFES MISHAPS!

With Delta's Extended Warranty, you're covered for mechanical failure from normal use or if your item stops working due to normal wear and tear, plus all those unexpected surprises.

2 YEARS OF PROTECTION

For Additional Information:

Simply visit our Website, register your product, and add the Extended Warranty

<https://www.deltachildren.com/pages/product-registration>

Extended Warranty only available in the following States: Arkansas, Colorado, Delaware, District of Columbia, Georgia, Idaho, Illinois, Indiana, Iowa, Kansas, Kentucky, Louisiana, Maryland, Michigan, Mississippi, Missouri, Nebraska, Nevada, New Hampshire, New York, North Carolina, North Dakota, Pennsylvania, Rhode Island, South Dakota, Tennessee, Utah, West Virginia

PARTS

IMPORTANT! Please remove all parts from the package and identify them before assembly.

IMPORTANT! Before assembly and each use, inspect this product for damaged hardware, loose joints, missing parts, or sharp edges. **NEVER** use if any parts are missing or broken. Contact manufacturer for replacement parts and instructions if needed. Never substitute parts. **IMPORTANT!** Adult assembly is required.



Frame



Wheel Protectors (x2)



Front Wheel



Rear Wheels (x2)



Drawbar



Pennant



Drawbar sleeve

ASSEMBLY



1

UNFOLDING

- Lift the upper frame [A] upward until you see the crossbar with folding handle [B] inside.



Pull back firmly on crossbar to make sure the indicator changes from red to green, so that all locks are correctly engaged.

LEFT INDICATOR



WRONG!

To be fully locked and secured, the indicators on each side of crossbar must fully show GREEN (No Visible RED).

RIGHT INDICATOR



LEFT INDICATOR



CORRECT – FULLY LOCKED!

When the indicator on each side of crossbar shows completely GREEN, the bike trailer frame is securely locked

RIGHT INDICATOR



2

CLICKING INTO PLACE

- Grab the crossbar with your second hand.
- Keep holding the top frame. Pull the crossbar [B] firmly towards you until the frame engages with an audible “click” sound.

NOTE: Make sure the indicator changes from red to green, so that all locks are correctly engaged.

ASSEMBLY



3

ASSEMBLY OF WHEELS

- Hold down the central button [C] and push the wheel to the axle.

NOTE: To check if the wheel is correctly installed, pull it away from the body – it must not detach itself from the axle.

NOTE: Make sure that rear tires are properly inflated to at least 36 Psi, but do not exceed 50 Psi.

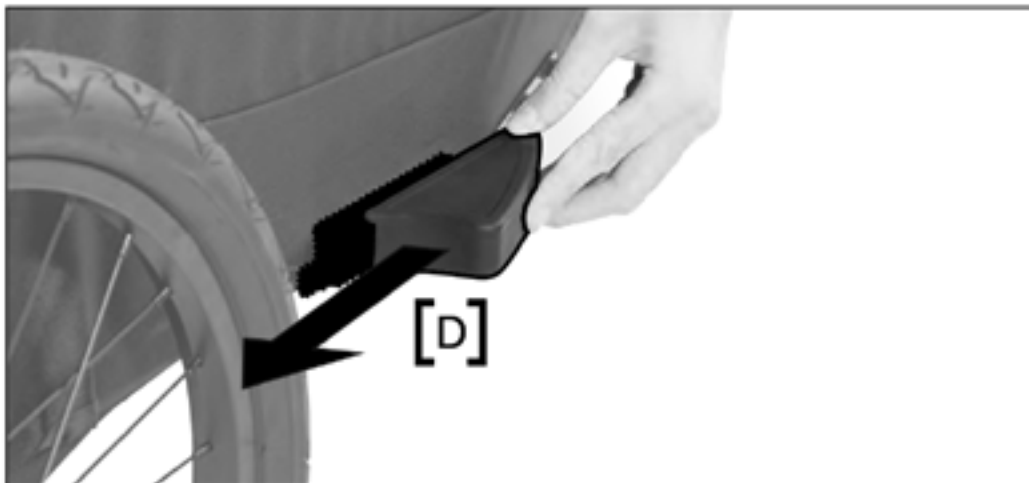

4

ASSEMBLY OF WHEEL PROTECTION

- Slide the wheel protector [D] from the front to the intended position. Repeat on other side.

Note: To check if the wheel protector is correctly installed pull it away from the wheel. It must not detach itself from the frame.

ASSEMBLY

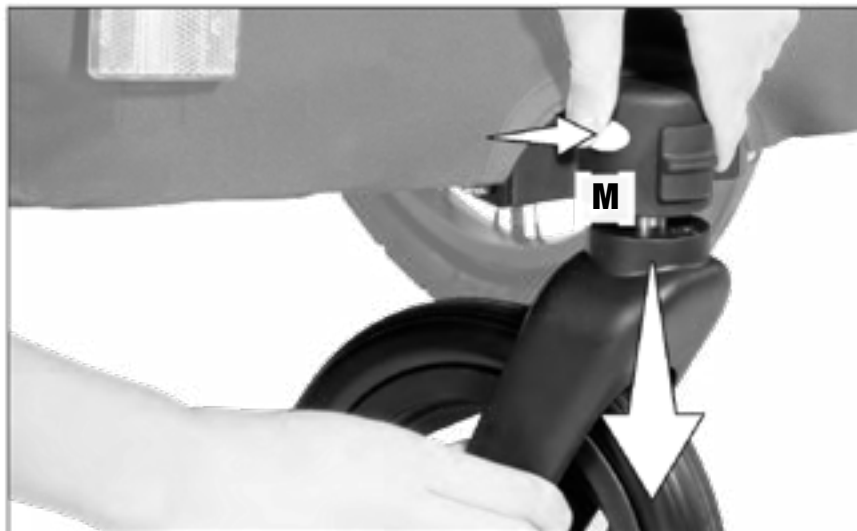

5

REMOVE THE FRONT WHEEL

- Press the unlock button [M] to remove the front wheel. Then follow the instructions from step 1 on page 12 to mount the drawbar.

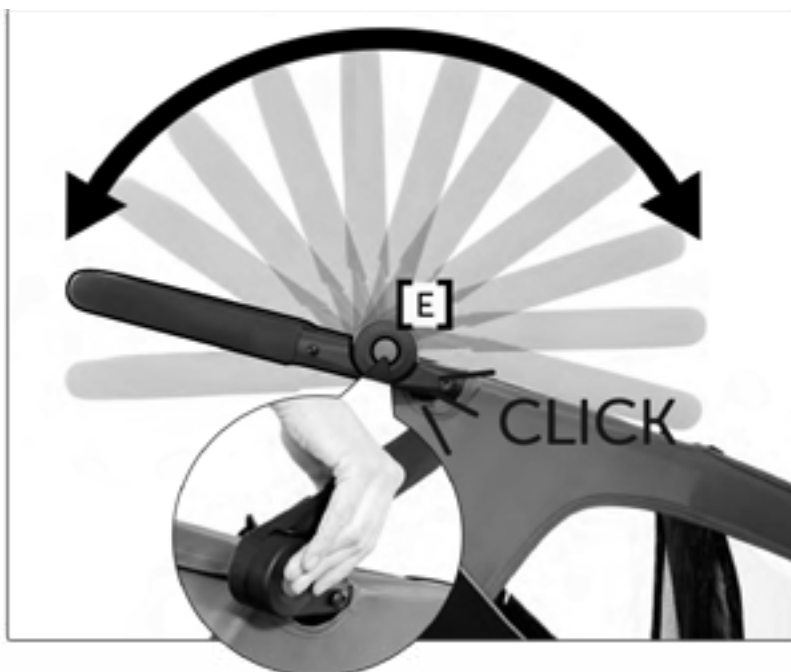

6

ADJUSTING HANDLEBARS

- To adjust handle: Press BOTH buttons (located on either side of handle bar) [E].
- With both buttons pressed, rotate the handle up or down to desired position.

- The buttons will “CLICK” on both sides once it is in a fully locked position.

Note: Confirm both buttons are depressed and handlebars are in a locked position before use



7

ASSEMBLY OF THE PENNANT

- Pin the two pennant pieces together and slide the finished pennant into the fabric tab provided on the left side of the bike trailer.

TO CONVERT TO BIKE TRAILER GO TO PAGE 11

TO CONVERT TO STROLLER GO TO PAGE 17

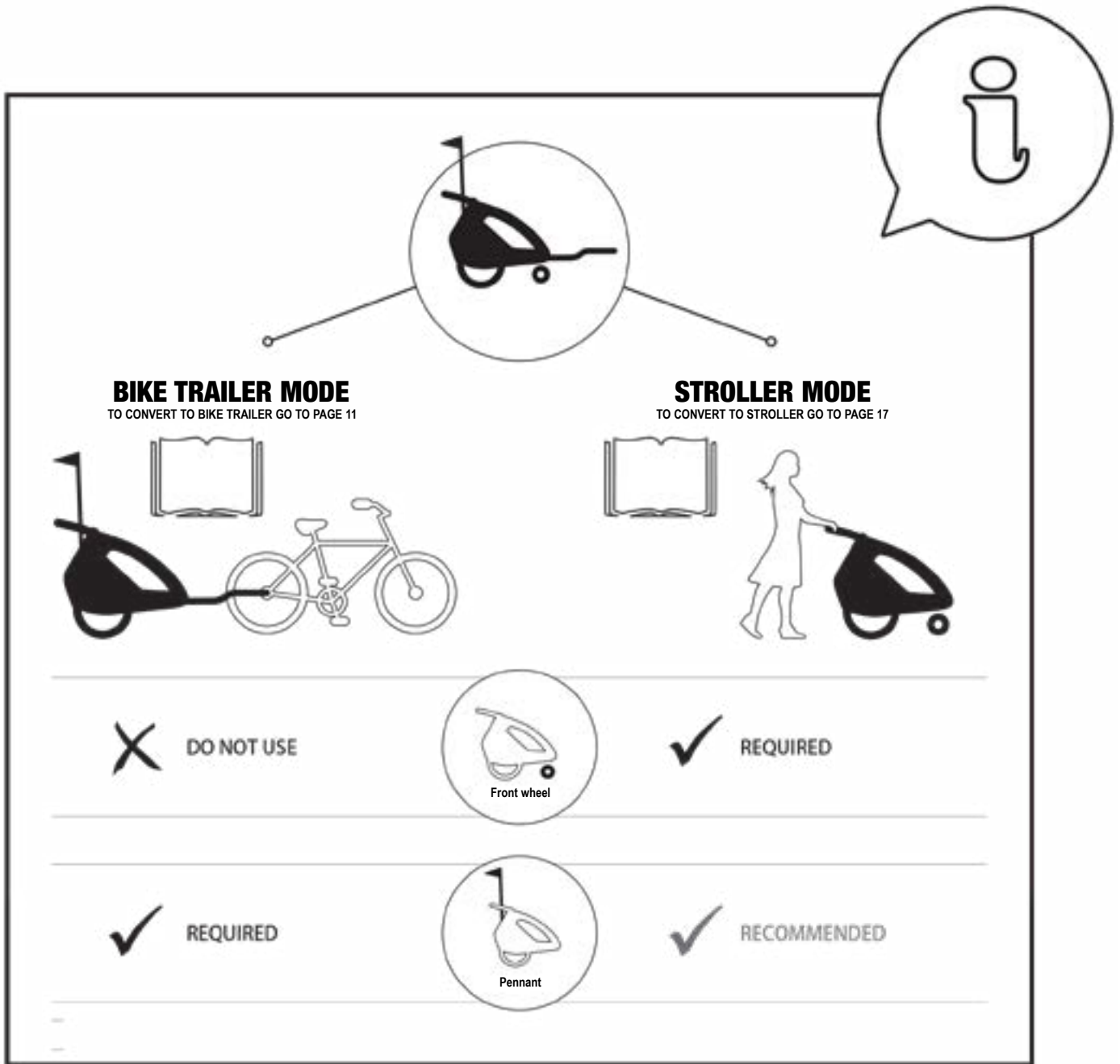

CONVERSION FROM STROLLER TO TRAILER

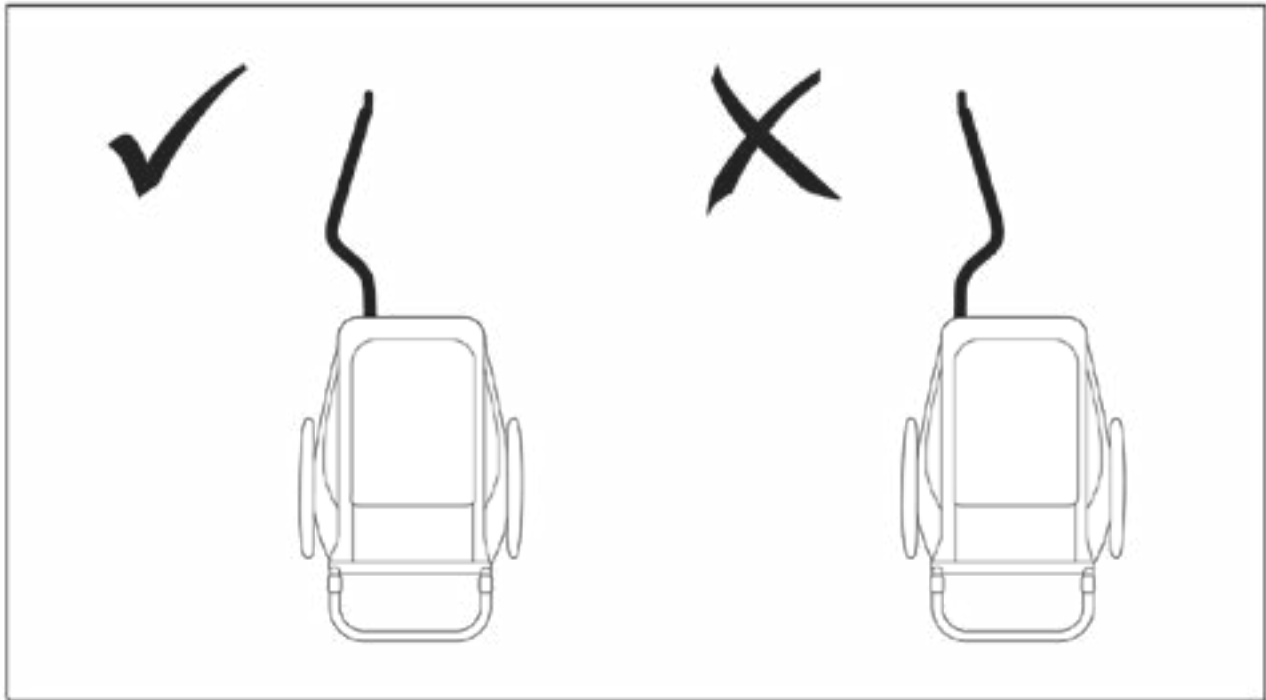

Note: Before installing the drawbar, make sure the longer side is facing the outside of the bike trailer.

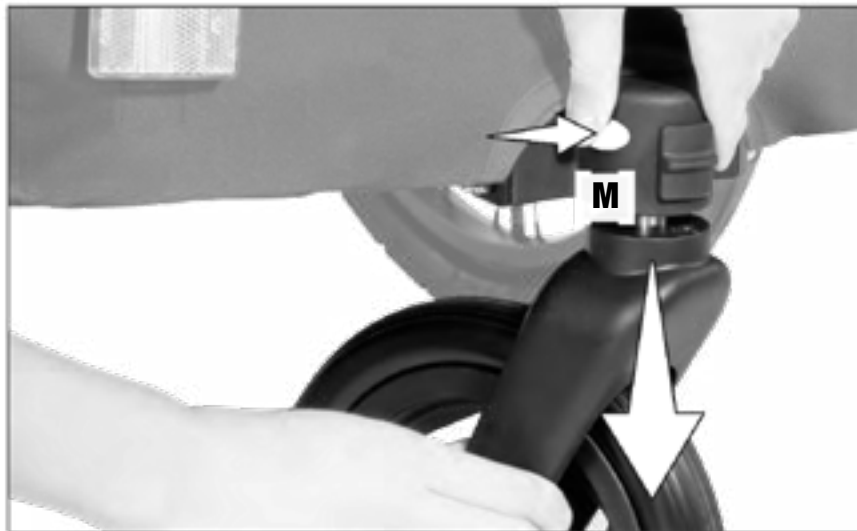

1

REMOVE THE FRONT WHEEL

- Press the unlock button [M] to remove the front wheel.

CONVERSION FROM STROLLER TO TRAILER

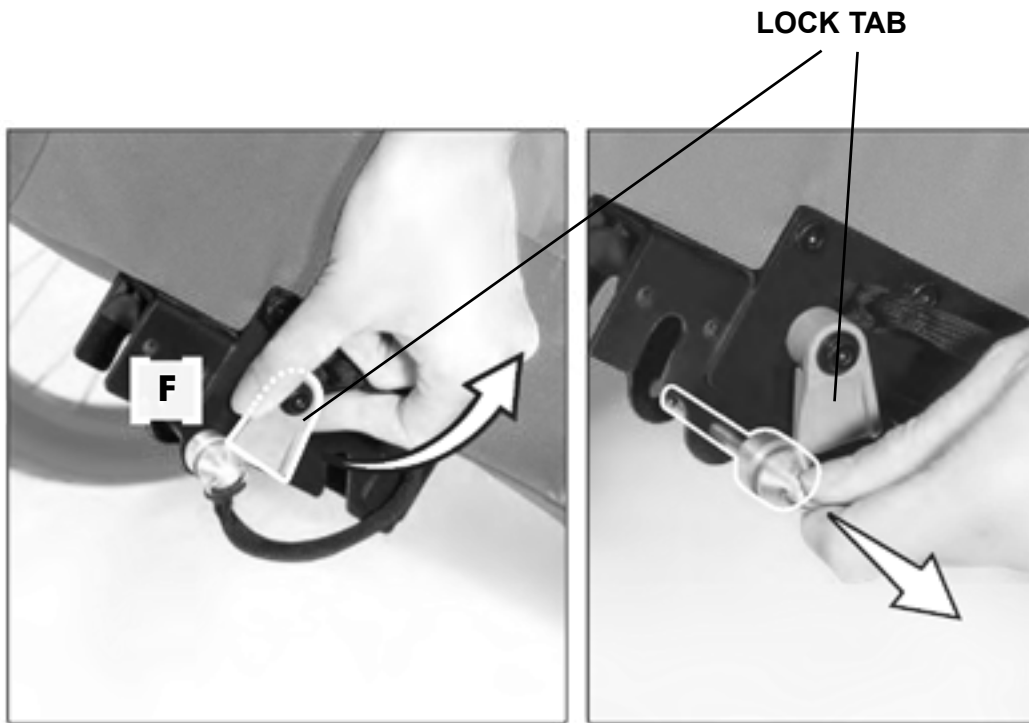

2

REMOVING THE SAFETY PIN

- Tilt the trailer backwards to make handling easier. Rotate the lock tab [F] to release safety pin from mounting plate.

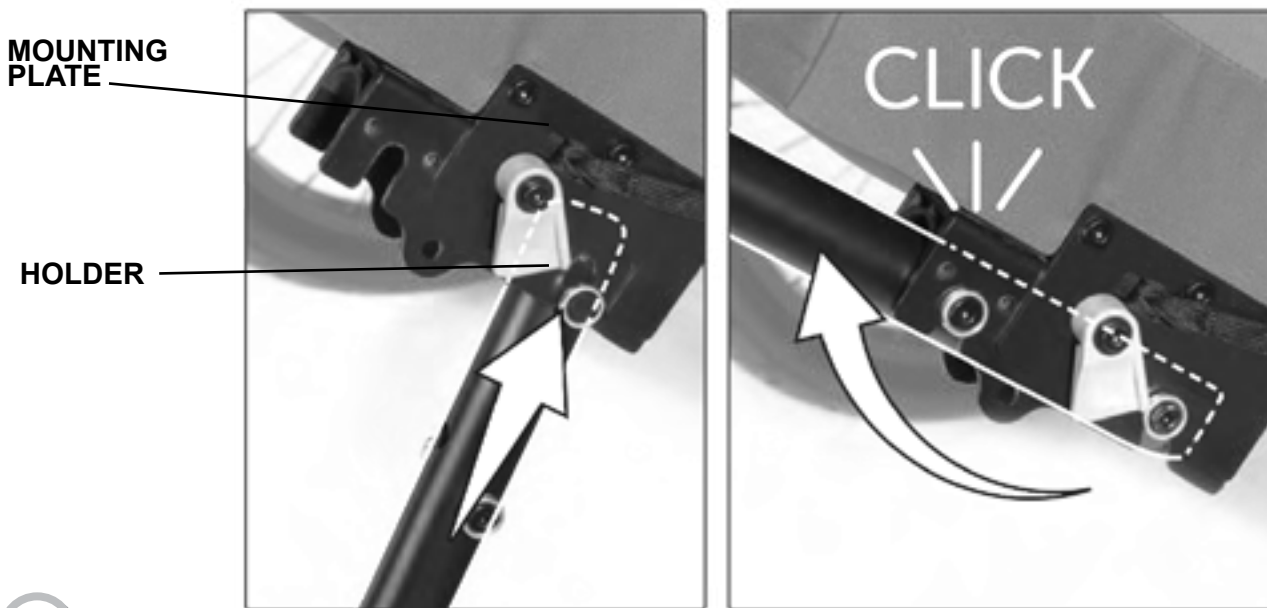

3

ASSEMBLING THE DRAWBAR

- Slide the end of the of the drawbar into the holder on the mounting plate. Once the drawbar is securely fastened to the mounting plate, tilt the drawbar forward until it is properly engaged.

CONVERSION FROM STROLLER TO TRAILER

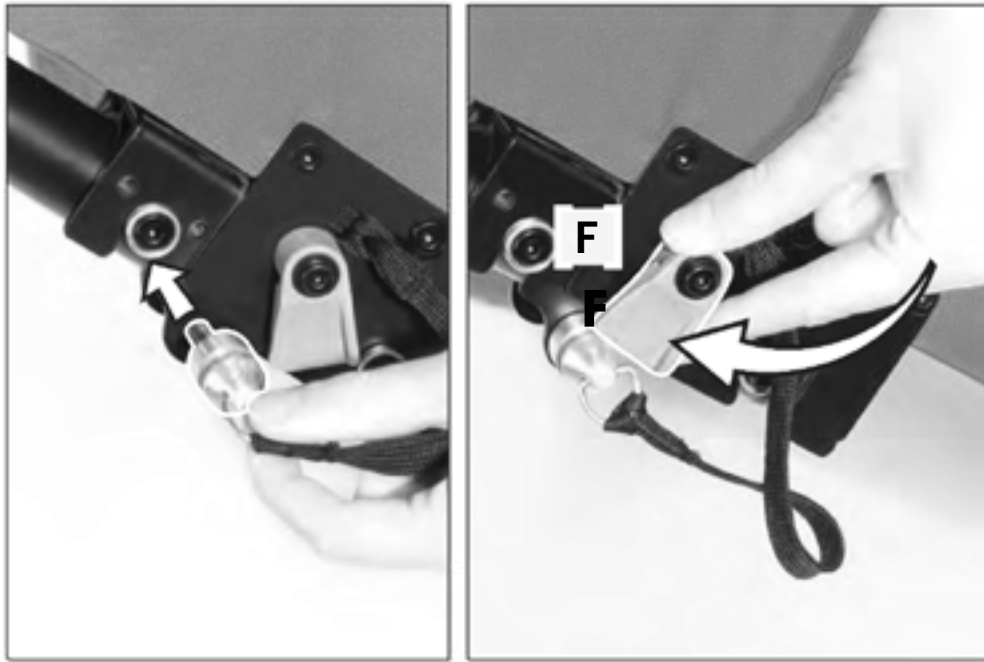

4

SECURING SAFETY PIN TO THE DRAWBAR

- Put the safety pin through both holes in the mounting plate. Rotate the lock tab [F] in front of the safety pin to prevent the drawbar from slipping out.

Note: push down on drawbar to ensure it is securely attached.

SAFETY BRACKET

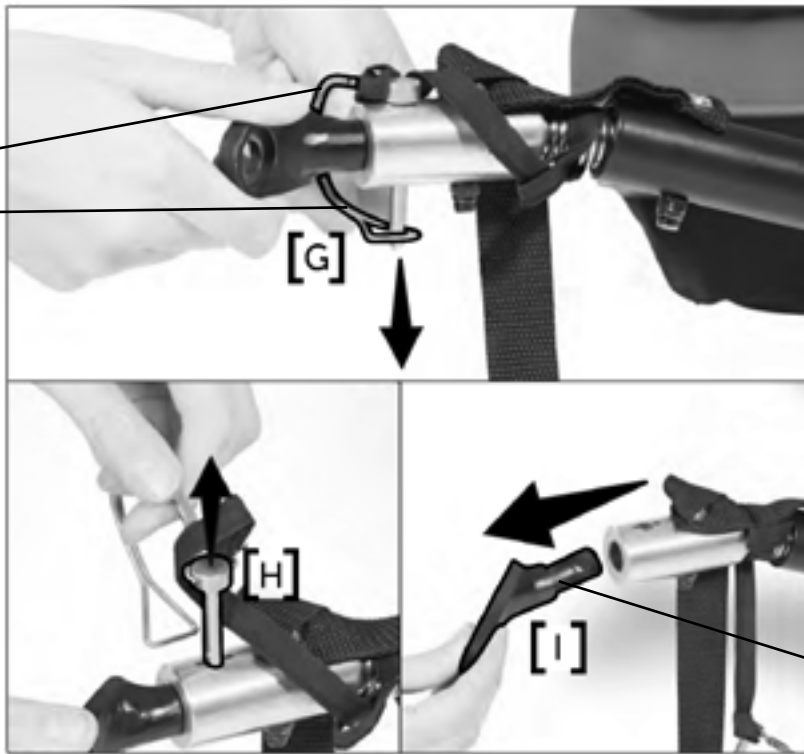

CLUTCH HEAD

5

REMOVE CLUTCH HEAD

- Press down the safety bracket [G] at the front end of the drawbar.
- After rotating the safety bracket away from the end of the pin, remove the pin from the head of the drawbar [H].
- Then release the clutch head [I] from the drawbar

CONVERSION FROM STROLLER TO TRAILER

Use this step only for quick release wheels



5A

ATTACHING CLUTCH HEAD TO REAR BIKE AXLE (FOR QUICK RELEASE REAR WHEELS).

- Undo the rear axle of your bicycle and pull it out. Refer to your bike's user manual.
- Then slide the clutch head [!] on the axle.

Use this step only for fixed axle wheels

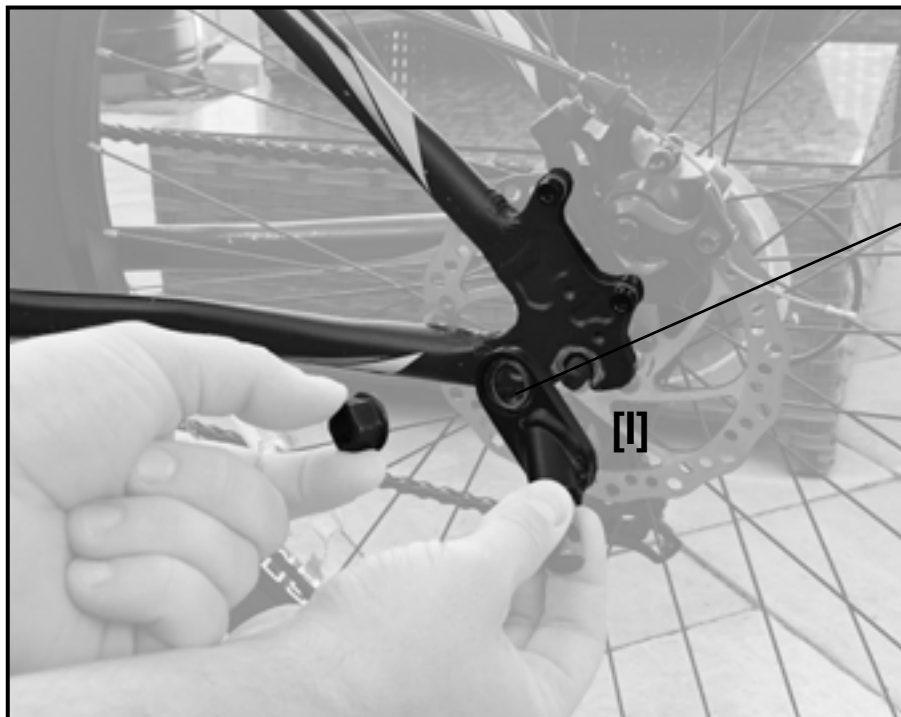

CLUTCH HEAD

5B

ATTACHING CLUTCH HEAD TO REAR BIKE AXLE (FOR FIXED AXLE WHEELS).

- Unscrew the nut on the rear axle of your bicycle. Refer to your bike's user manual.
- Then slide the clutch head [!] on the axle and screw the nut back on.

CONVERSION FROM STROLLER TO TRAILER

Use this step only for quick release wheels



CLUTCH HEAD

6A

ASSEMBLING CLUTCH HEAD (FOR QUICK RELEASE WHEELS)

- Tighten the rear axle again. Make sure that the system is completely closed and that the axle cannot come loose.
- If you use the bike trailer frequently, you can leave the clutch head attached to the axle. This makes it easier to attach and detach the trailer.

Use this step only for fixed axle wheels



CLUTCH HEAD

6B

ASSEMBLING CLUTCH HEAD (FOR FIXED AXLE WHEELS)

- Replace the nut on the rear axle. Make sure that the system is completely closed and that the axle cannot come loose.
- If you use the bike trailer frequently, you can leave the clutch head attached to the axle. This makes it easier to attach and detach the trailer.

CONVERSION FROM STROLLER TO TRAILER

HITCHING TO THE BIKE



7

HITCHING OF THE DRAWBAR

- Slide the drawback onto the clutch head and secure it with the safety pin [H].

Note: Make sure the safety pin is well secured in place by pulling outward on the drawbar.



8

FIXATION OF THE SAFETY STRAP

- Put the safety strap [J] around the bicycle frame and hook it into the loop provided on the drawbar.

Note: Ensure that the safety strap is securely fixed to the bike frame and cannot be caught in the rear bike wheel.

UNHITCHING FROM THE BIKE



1

REMOVE THE CLUTCH

- Open the safety strap and remove the safety bracket. Pull out the safety pin [H]

UNHITCHING FROM THE BIKE

- Pull the drawbar off the clutch head. If you are not going to use the Everest Bike Trailer with your bike for a longer period of time, we recommend that you also remove the clutch head to avoid corrosion.

⚠ SUPPORT LOAD

The minimum support load is 11 lbs. and the maximum is 28 lbs. The minimum or the maximum drawbar load is determined by placing the end of the drawbar on a scale in a horizontal position and weighing the trailer at minimum (empty) or maximum load (with passengers and cargo)

11 LBS. MIN.
28 LBS. MAX.

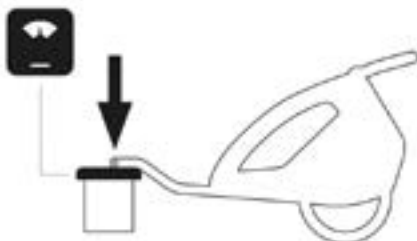

⚠ DRIVING BEHAVIOUR

Note that the braking distance and turning radius are changed by pulling the trailer.

Avoid fast change of direction and evasive maneuvers, drive in a controlled manner on steep roads and around bends



CONVERSION FROM TRAILER TO STROLLER

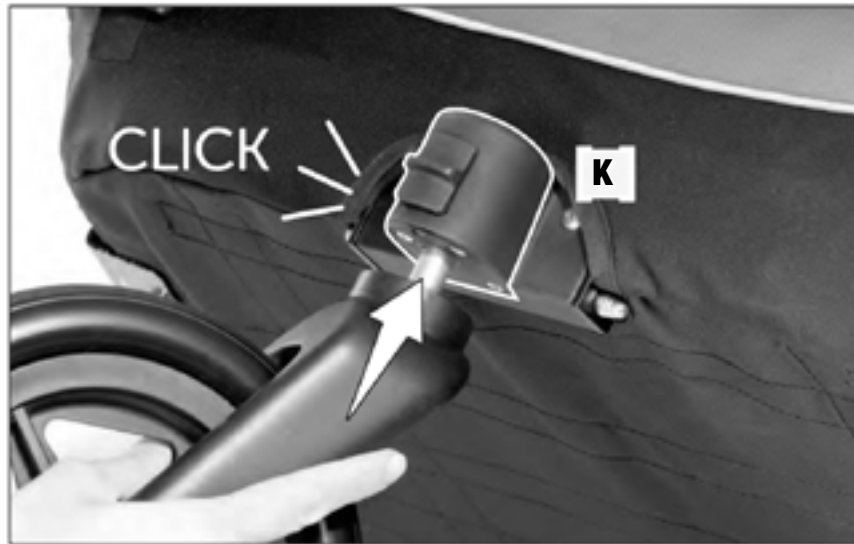

1

INSTALLATION OF THE FRONT WHEEL

- Tilt the trailer backwards to make handling easier. Insert the front wheel into the front hub [K] of the trailer until it clicks into place.

Note: Pull downward on wheel to ensure that the wheel is securely locked.

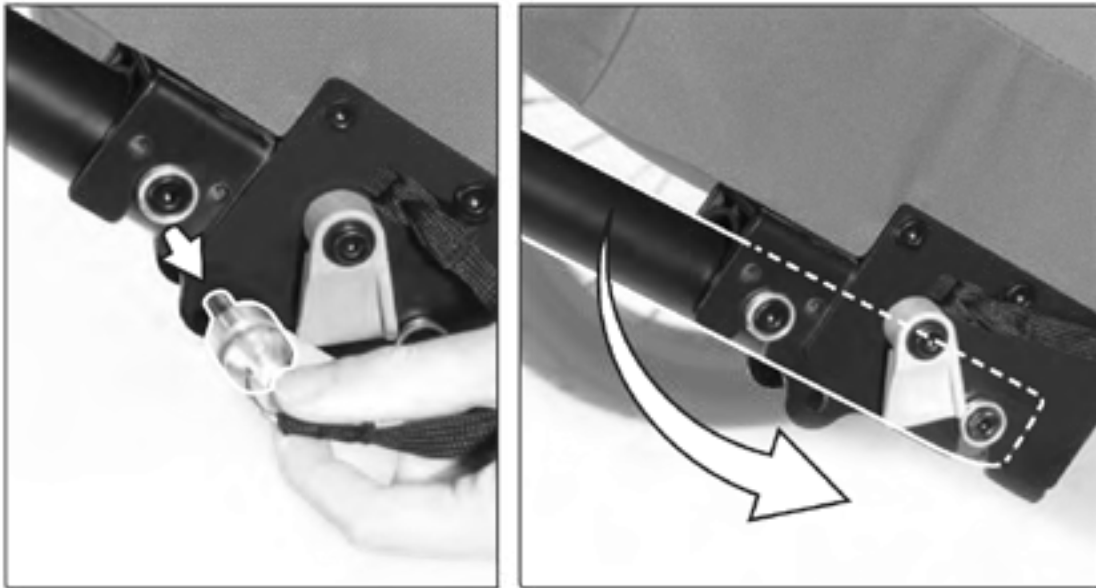

2

REMOVE THE DRAWBAR

- Rotate the lock tab to the side so that you can pull out the safety pin.
- Then rotate the drawbar backwards and release it from the mounting plate.

CONVERSION FROM TRAILER TO STROLLER



3

INSERTING DRAWBAR INTO SLEEVE

- In order to transport the drawbar in stroller mode, insert drawbar into sleeve until it is fully contained. Locate the two straps on sleeve and attach to bike trailer handlebar

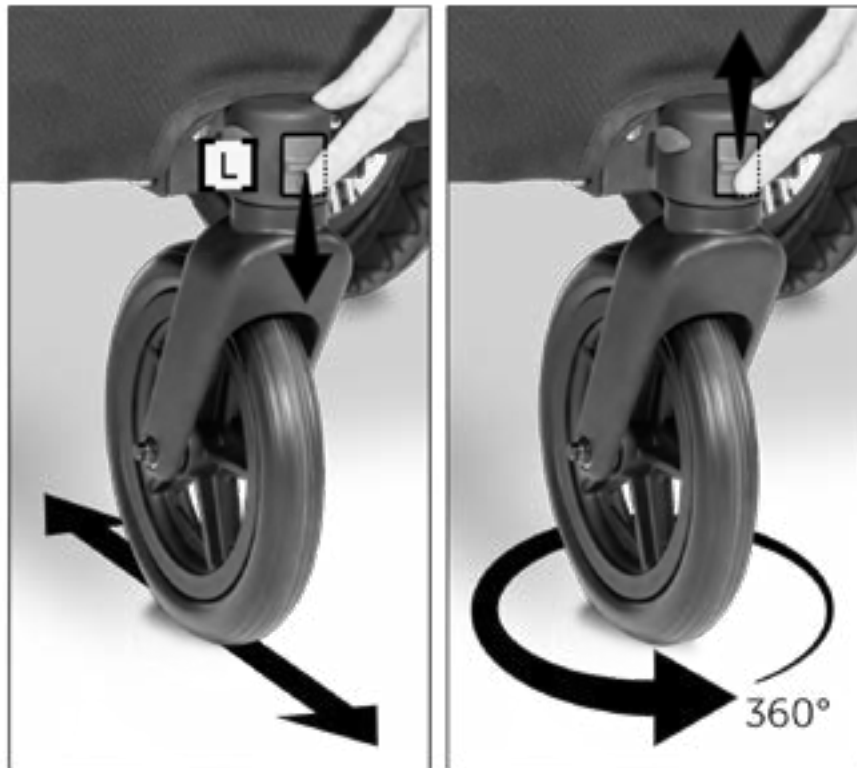

4

LOCKING OF THE FRONT WHEEL

- To stabilize the front wheel on uneven ground, push the locking lever [L] down.
- When you want the wheel to swivel freely, push the lever up.

CONVERSION FROM TRAILER TO STROLLER

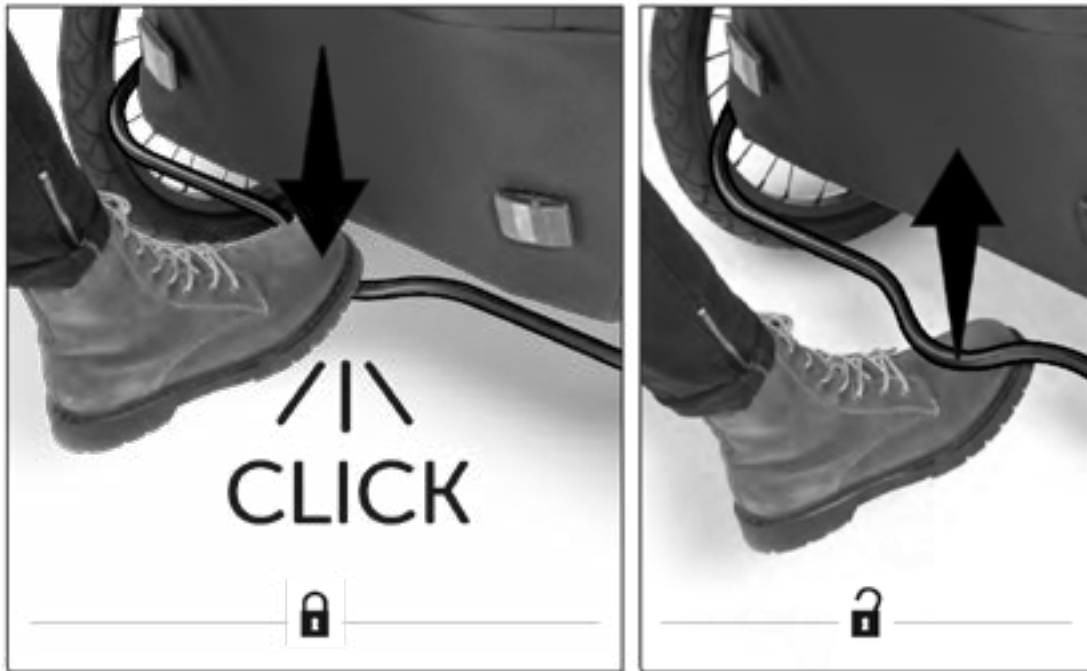

5

USAGE OF THE BRAKE

- By pressing the brake lever, the brake locks in with a clear “click” sound. To release the brake, push the brake lever up again.

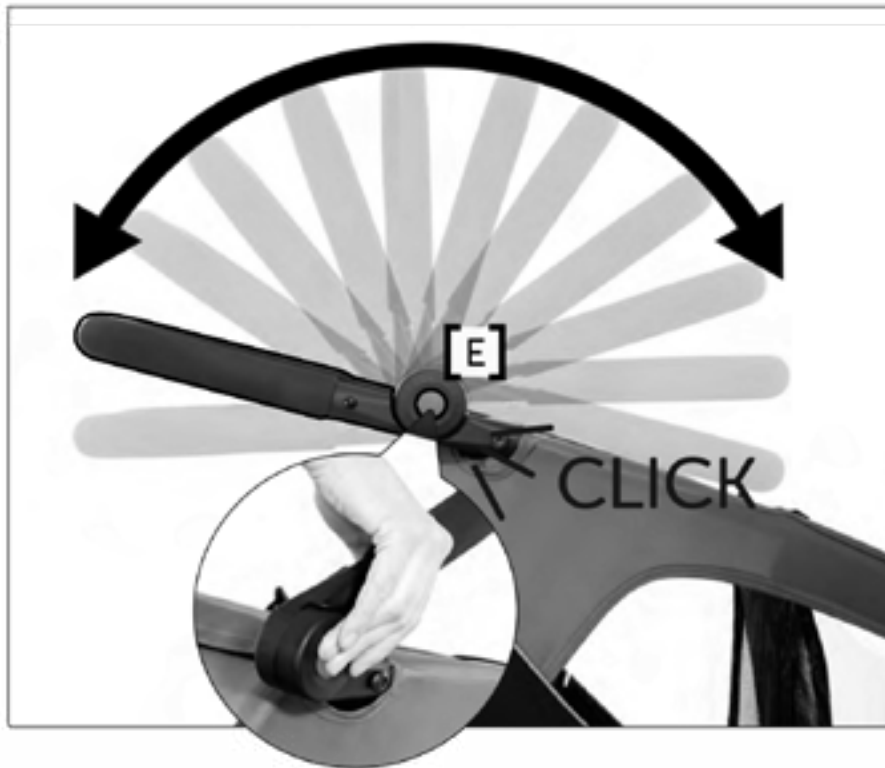

6

ADJUSTMENT OF THE HANDLEBAR

- Press and hold the push buttons [E] on the left and right of the handle. Move the handle to the desired position and make sure it locks in with an audible “click” sound.

Note: Handle can move to 11 different positions

CONVERSION FROM TRAILER TO STROLLER



7

STORAGE OF FRONT WHEEL

- While the front wheel is not in use, it can be stored in the bag in the rear storage compartment.



8

UNLOCKING THE BRAKE

- When in bike trailer mode, make sure the rear brake is unlocked to allow the wheels to rotate.

FABRIC COVER ASSEMBLY

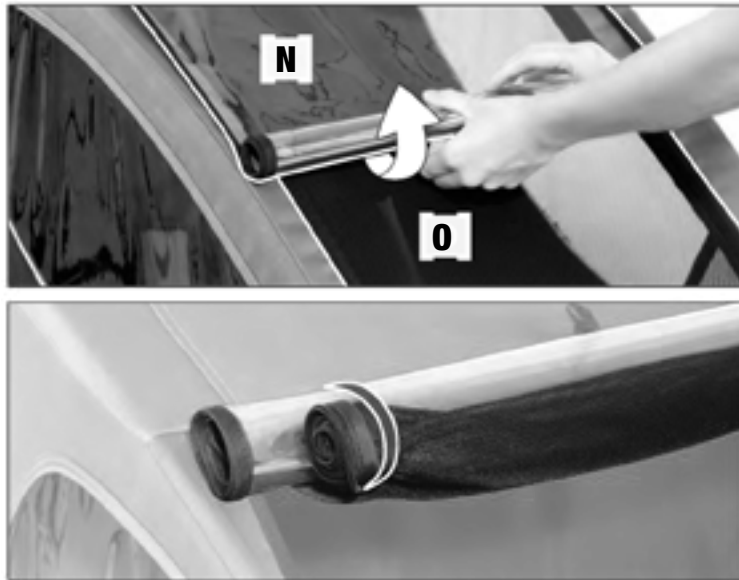

1

2-in-1 CANOPY

- The canopy consists of all-weather protection [N] and mosquito net [O].
- To open the canopy, loosen the Velcro and roll it upwards and fasten with toggle and loops on both sides.



2

PANORAMA WINDOW

- The cover of the window can be rolled upwards and be fastened with the middle toggle and loop.



3

STORAGE COMPARTMENT

- A load of 13lbs is permitted in the rear storage space of the trailer.

SECURING CHILD

Before Placing your Child in Stroller:

Close Canopy. Press brake down until it “clicks” into the locked position.

Make sure the brake pedal is pressed down completely.

Always set the brake pedal when parking the trailer/stroller.

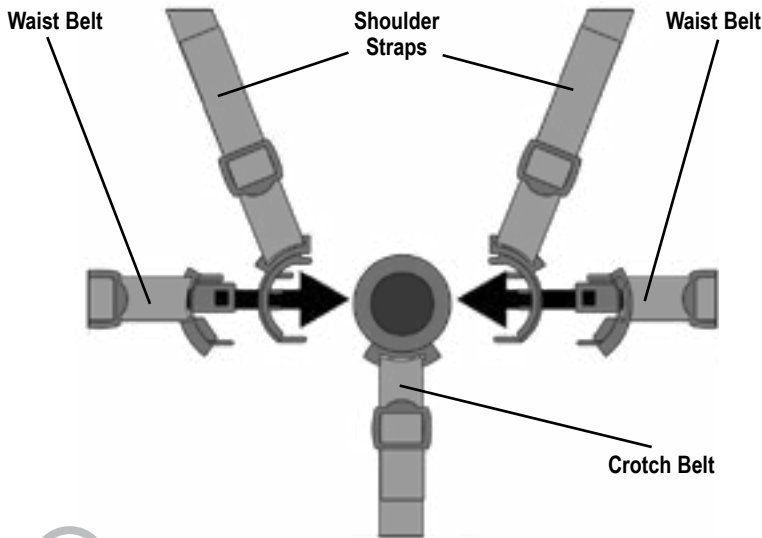

1

Securing Child

- Place your child in the stroller. Position the crotch belt between your child’s legs.
- Pull shoulder straps over child’s arm and shoulder and fasten both strap ends to the restraint system.
- Fasten both waist belts to the buckle on each side of the crotch belt. Make sure you hear a “click” on both sides.
- Check to be sure the restraint system is securely attached by pulling it away from your child. The restraint system should remain attached.

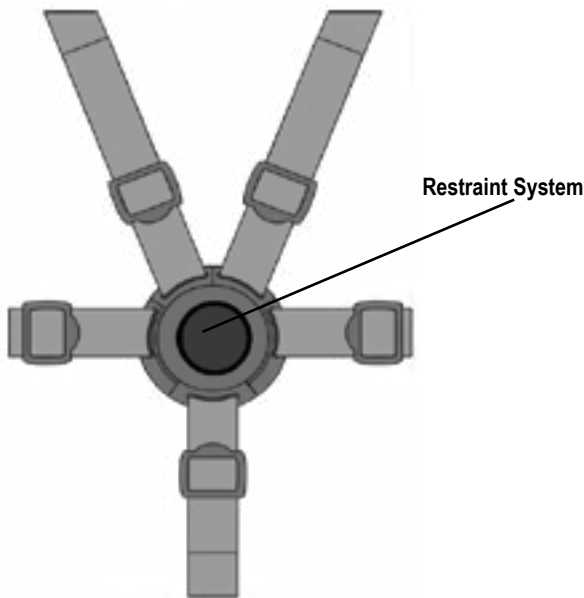

2

- Tighten each waist belt and shoulder strap so that the restraint system is snug against your child. Please refer to the next section for instructions to tighten the waist belts.

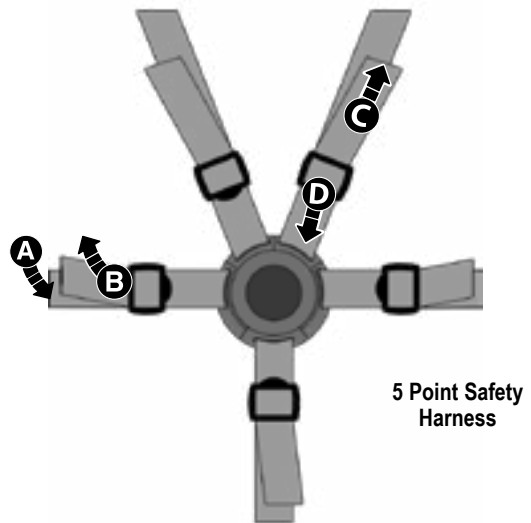

5 Point Safety Harness

TIGHTEN

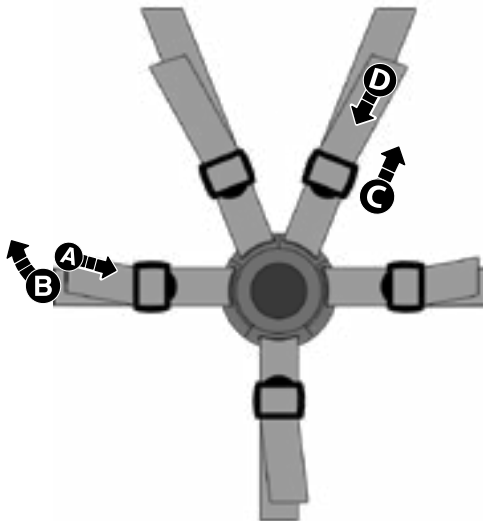

LOOSEN

3

To tighten the waist belts and shoulder straps:

- Feed the anchored end of a waist belt up through the buckle to form a loop **A**. Pull the free end of the waist belt **B**.
- Repeat this procedure to tighten the other waist belt.
- Feed the top end of the shoulder strap through the plastic stay to form a loop **C**. Pull the bottom end down to tighten the strap **D**.
- Repeat this procedure to tighten the other shoulder strap.

To loosen the waist belts and shoulder straps:

- Feed the free end of the waist belt up through the buckle to form a loop **A**. Enlarge the loop by pulling on the end of the loop toward the buckle. Pull the anchored end of the waist belt to shorten the free end of the waist belt **B**.
- Repeat this procedure to loosen the other waist belt.
- Feed the bottom end of the shoulder strap through the plastic stay to form a loop **C**. Pull the top end up to loosen the strap **D**.
- Repeat this procedure to loosen the other shoulder strap.

Please Note: After adjusting the restraint system to fit your child, make sure you pull on it to be sure it is securely fastened.

USAGE OF THE 5-POINT HARNESS

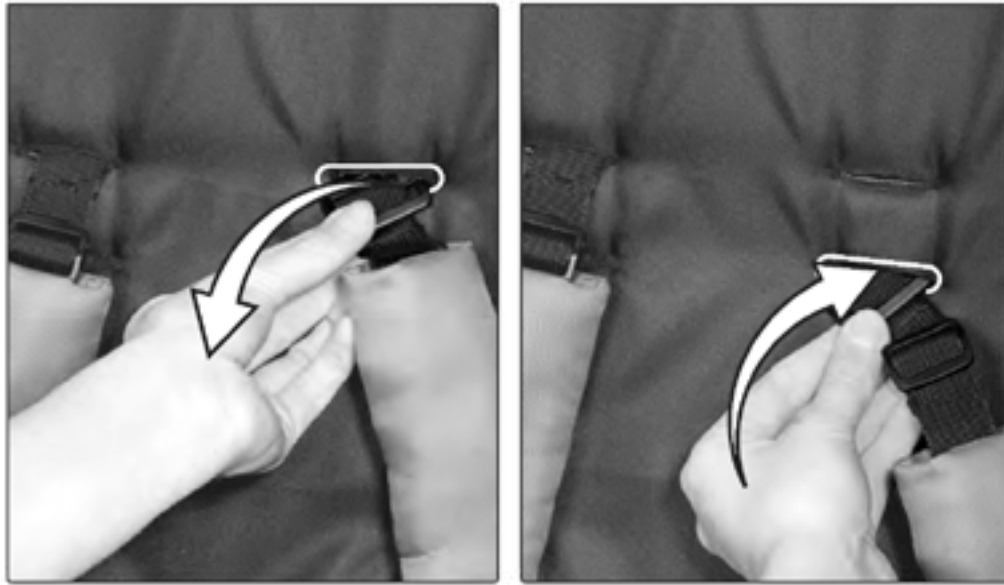

1

HEIGHT-ADJUSTMENT OF THE HARNESS

- To adjust the harness height for smaller children, pull the harness ends through the backrest.

TRANSPORTATION OF CHILDREN

Be sure to observe all safety information on page 3!

IMPORTANT

- If you carry only one child, it should sit on the right side in the direction of travel.
- The brake should always be engaged during the loading and unloading of children.
- The 5-point harness must be used at all times.
- Children must always wear a suitable safety helmet
- The cover of the bike trailer must remain closed at all times to protect children during the ride.



FOLDING BIKE TRAILER/STROLLER

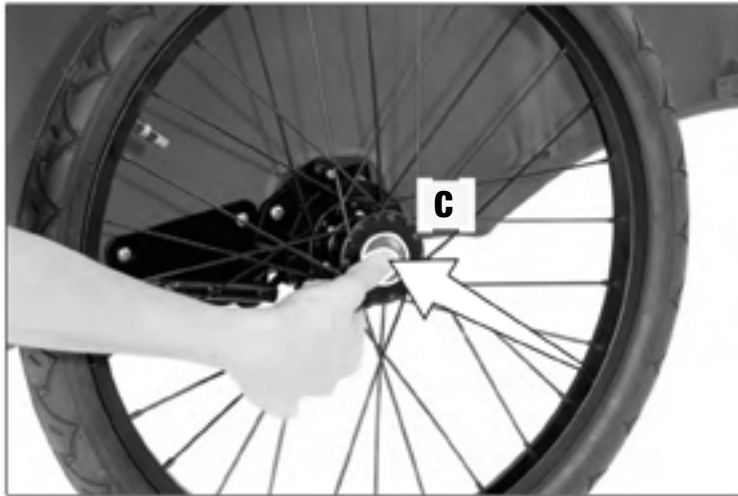

1

REMOVING FRONT AND REAR WHEELS

- Remove the rear wheel by pressing the center release button [C].

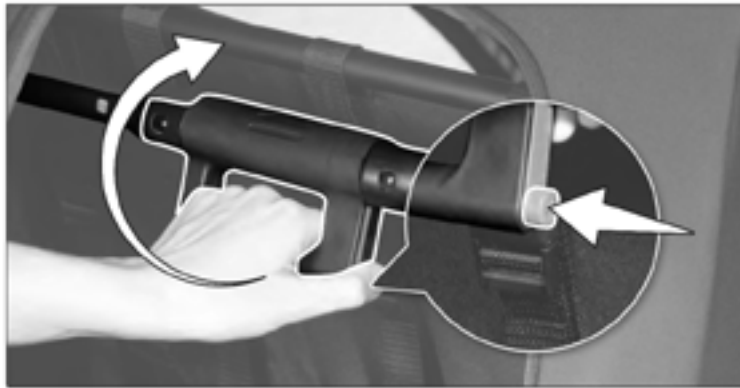

2

FOLDING THE BIKE TRAILER/STROLLER FRAME

- Press the button on the folding handle and turn the folding handle upwards.
- Slide the folding handle forward until the trailer is fully folded.

USING THE RAIN SHIELD



TOGGLE AND LOOP

1

WHEN NOT IN USE

- Roll up rain guard and fasten rolled up guard to toggle and loop [P].



VELCRO STRIP
UNDER RAIN GUARD



VELCRO STRIP
UNDER OPENING

2

WHEN USING THE RAIN GUARD

- Roll the rain guard all the way down.
- Fasten the velcro strip on the underside of the rain guard to the strip at the bottom of the opening.

CARE AND MAINTENANCE

- To clean the trailer/stroller use a mild household soap with warm water on a sponge or clean cloth. Do not use any aggressive cleaning agents.
- Carry out regular internal and external cleaning of the cabin.
- Check your trailer/stroller for loose screws, worn parts, torn material or stitching on a regular basis. Replace or repair parts as needed.
- Care for all moving parts with silicone spray.
- Dry the frame and entire cover after each use.
- Check the bike trailer for road worthiness including tire pressure of the rear wheels before each journey. Make sure that each tire are properly inflated to at least 36 Psi, but do not exceed 50 Psi.
- Regularly inspect locks and belts for signs of wear.
- Inspect all fasteners on a regular basis. Tighten as needed.
- When not in use, store the bike trailer in a dry, protected place away from direct sunlight.
- Discontinue use of wagon if it should become damaged or malfunctions. Please contact our customer service email at gcs@DeltaChildren.com to arrange for repair or obtain replacement parts.
- If you experience any difficulty with assembly, missing parts or use, please DO NOT return this item to the store. Retail stores are unable to properly assist you. Contact our Customer Service Department directly for assistance gcs@DeltaChildren.com

DELTA♥CHILDREN

Delta Children's Products Corp.
114 West 26th Street
New York, NY 10001
gcs@DeltaChildren.com
www.DeltaChildren.com

follow us



@deltachildren