

CRUZER DOUBLE STROLLER

DELTA♥CHILDREN

INSTRUCTION MANUAL

ADULT ASSEMBLY REQUIRED
STYLES AND COLORS MAY VARY

11511

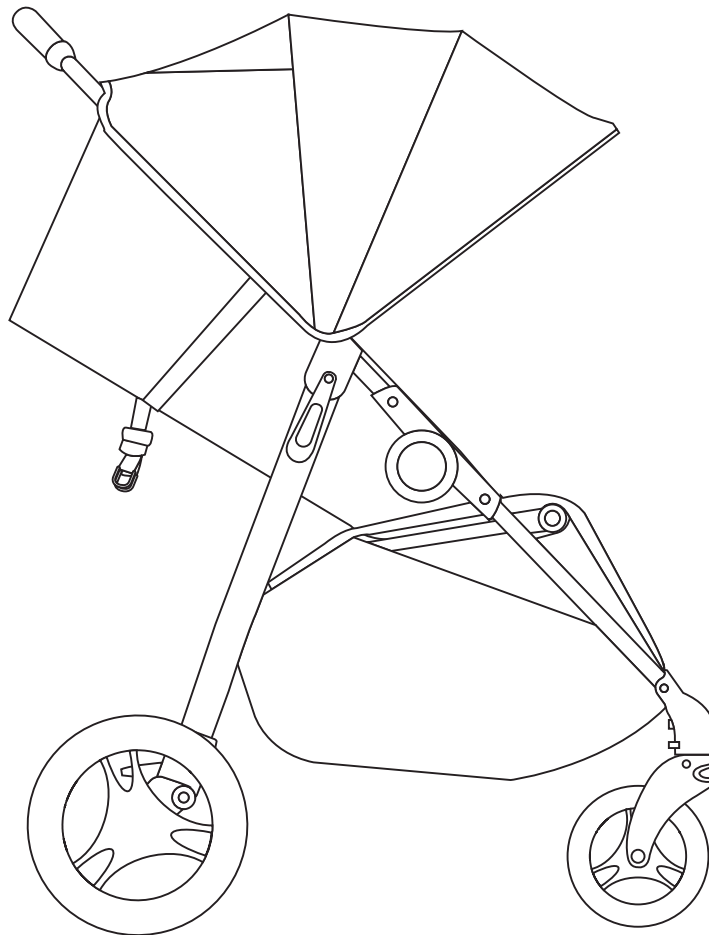

**▲ WARNING:
CHOKING HAZARD**

Adult assembly required because of small parts. Keep assembly parts out of reach of children under 3 years.

Read all instructions BEFORE assembly and USE of product
KEEP INSTRUCTIONS FOR FUTURE USE.

Customer Experience Center
email: gcs@DeltaChildren.com

DELTA♥CHILDREN

www.DeltaChildren.com

DCP-IM-022421-F2

WARNING

WARNING: Please follow all of these instructions to ensure the safety of your child.

Keep these instructions for future reference.

WARNING: Failure to follow these instructions could result in serious injury or death.

- Avoid serious injury from falling or sliding out. **ALWAYS** insure that the child is properly positioned by using the safety harness according to these instructions. **ONLY** children who have developed enough upper body control to sit without leaning forward can use the front seat in the upright position.
- **NEVER** leave children unattended.

WARNING: CHOKING HAZARD Adult assembly required because of small parts.

Keep (assembly parts) out of reach of children under 3 years.

CAUTION: Purses, shopping bags, parcels, diaper bags or accessory items may change the balance of the stroller and cause hazardous unstable conditions.

TO PREVENT INJURY

- Make sure all body parts are clear of the stroller when folding and unfolding.
- The maximum weight that can be carried in the lower basket, and child tray, each is 3 lbs (1.36 kg). Excessive weight may cause a hazardous unstable condition to exist.
- Before allowing the children near the stroller, be certain the stroller is fully erect and latched in the open locked position.
- Use of the stroller with children weighing more than 50 pounds (22.62 kg) per seat or over 42 inches (106.7 cm) tall, may cause a hazardous unstable condition to the stroller.
- **NEVER** use the stroller on stairways or escalators.
- **NEVER** allow your stroller to be used as a toy.
- **NEVER** use the stroller in conjunction with bicycles, skateboards, roller skates, or in-line skates. Please discuss using the jogging stroller with your health care provider prior to jogging use. We recommend that the child occupant needs to be 6 months of age, at the minimum, before use of the stroller.

Product features and decorations may vary from the photo.

CARE AND MAINTENANCE

- To clean the plastic parts on stroller use a mild cleaning solution with warm water on a sponge or damp cloth. Hand wash fabric with damp cloth and air dry. Do not use bleach.
- To keep your stroller wheels from squeaking, use silicone or graphite based lubricant.
- Check your stroller for loose screws, worn parts, torn material or stitching on a regular basis. Replace or repair parts as needed, discontinue use of stroller if it should become damaged or malfunctions.

DELTA CHILDREN

LIMITED MANUFACTURER WARRANTY

This Delta product is warranted to be free from defects for a period of 90 days from the date of purchase under normal use. This warranty extends only to the original retail purchaser and is valid only when supplied with proof of purchase, or if received as a gift, when the registration is on file with Delta. This limited manufacturer warranty does not cover the following:

- Products purchased as floor models or samples.
- Items purchased on an “as-is” basis, as a second hand product, or as a resale product.
- Items purchased at a Final sale, a “Going out of Business” sale, or a Liquidation sale.

TO REGISTER YOUR PRODUCT for important safety alerts and updates to your product please visit www.deltachildren.com

TO REPORT A PROBLEM, please log on to www.deltachildren.com and click the Consumer Care Tab, or contact us by email at gcs@DeltaChildren.com

Date of Purchase: _____ (you should also keep your receipt)

EXTENDED WARRANTY

DON'T MISS YOUR CHANCE TO BE COVERED FOR ALL OF LIFES MISHAPS!

With Delta's Extended Warranty, you're covered for mechanical failure from normal use or if your item stops working due to normal wear and tear, plus all those unexpected surprises.

2 YEARS OF PROTECTION

For Additional Information:

Simply visit our Website, register your product, and add the Extended Warranty

<https://www.deltachildren.com/pages/product-registration>

Extended Warranty only available in the following States: Arkansas, Colorado, Delaware, District of Columbia, Georgia, Idaho, Illinois, Indiana, Iowa, Kansas, Kentucky, Louisiana, Maryland, Michigan, Mississippi, Missouri, Nebraska, Nevada, New Hampshire, New York, North Carolina, North Dakota, Pennsylvania, Rhode Island, South Dakota, Tennessee, Utah, West Virginia

PARTS

IMPORTANT! Please remove all parts from the package and identify them before assembly.

IMPORTANT! Before assembly and each use, inspect this product for damaged hardware, loose joints, missing parts, or sharp edges. **NEVER** use if any parts are missing or broken. Contact manufacturer for replacement parts and instructions if needed. **Never substitute parts. IMPORTANT! Adult assembly is required.**



Front Wheel (X2)

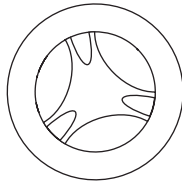

Rear Wheel (X2)

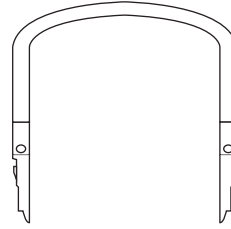

Child Bar

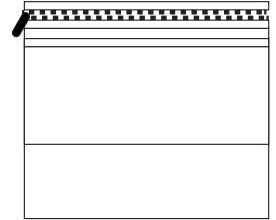

Pouch (X2)

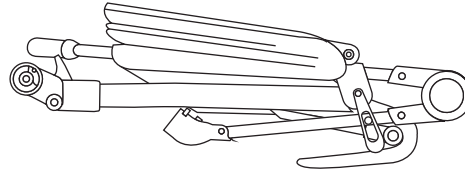

Stroller Frame

ASSEMBLY

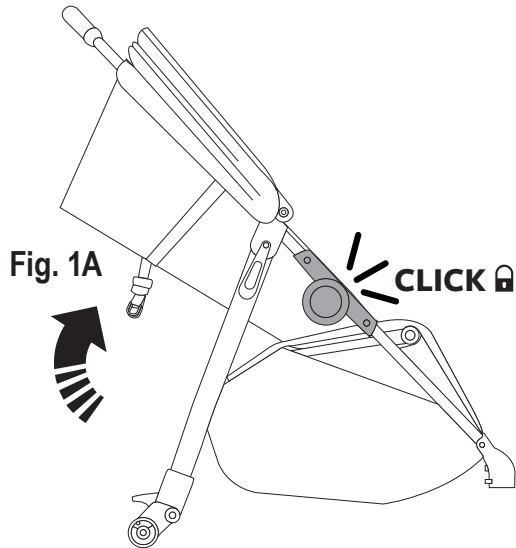
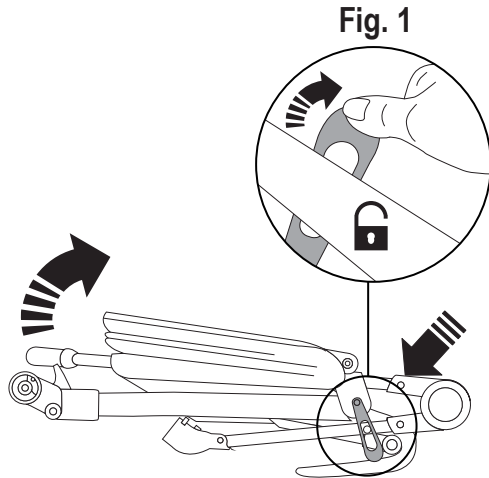

1

WARNING: Care must be taken when folding and unfolding the stroller to prevent finger entrapment.

OPENING STROLLER FRAME

- First, release the locking latch clip which is located on the right side of the stroller frame. (Fig. 1)
- Second, lift up on the stroller handle with both hands until the stroller frame is in a fully opened and locked position. (Fig. 1A)
- The stroller is in a fully locked position when both side handle latches are in a fully locked position and “CLICK”

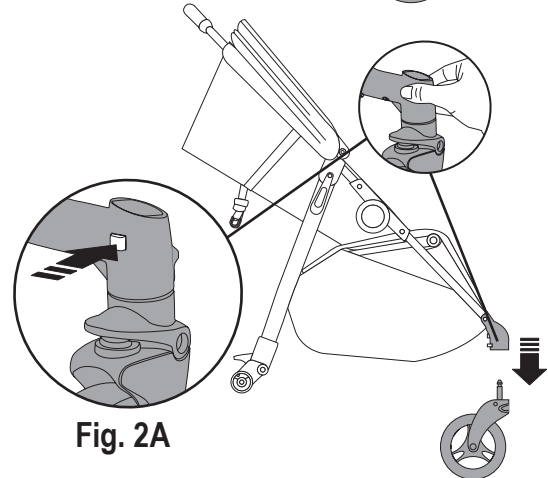
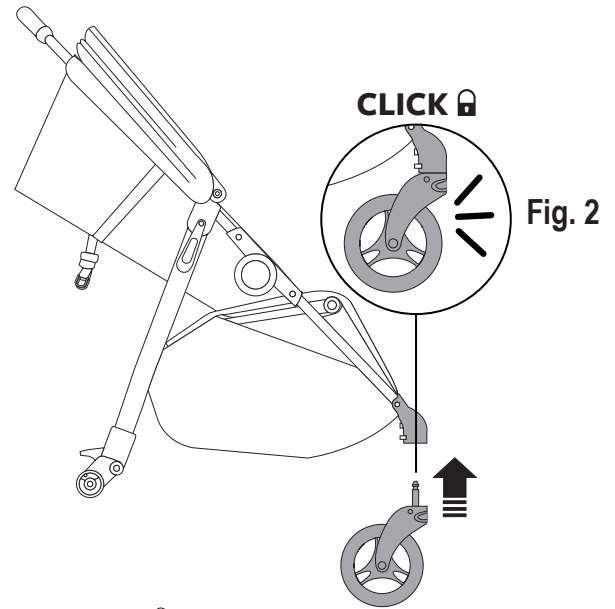

Fig. 2A

2

NOTE: Before attaching front wheel, make sure the stroller is in a fully open position.

ATTACHING FRONT WHEELS

- Push front wheel post into the front wheel housing until it “CLICKS” into a fully locked position. (Fig. 2)
- Repeat on opposite side.

NOTE: Pull downward on each wheel to ensure that each wheel is securely locked.

REMOVING FRONT WHEELS

NOTE: Make sure the back brakes are fully engaged.

- Press the metal button located on the back of the wheel housing and push inward to release. (Fig. 2A)
- Repeat on opposite side.

ASSEMBLY

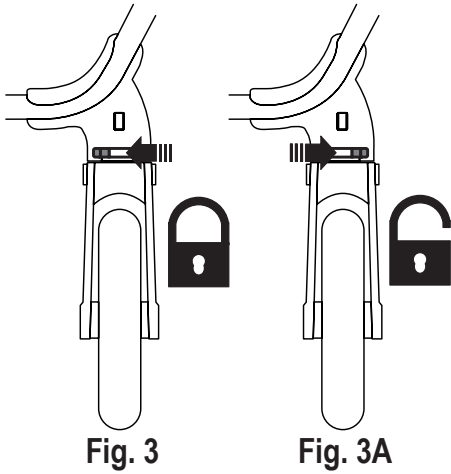

3

Fig. 3

Fig. 3A

TO LOCK FRONT SWIVEL WHEELS

- Press downward on the lever located on the top of the front wheel housing. Rotate wheel until it “CLICKS” into a fully locked position. (Fig. 3)

TO UNLOCK FRONT SWIVEL WHEELS

- Press upward on the lever located on the top of the front wheel housing until it “CLICKS” into a fully unlocked position. (Fig. 3A)

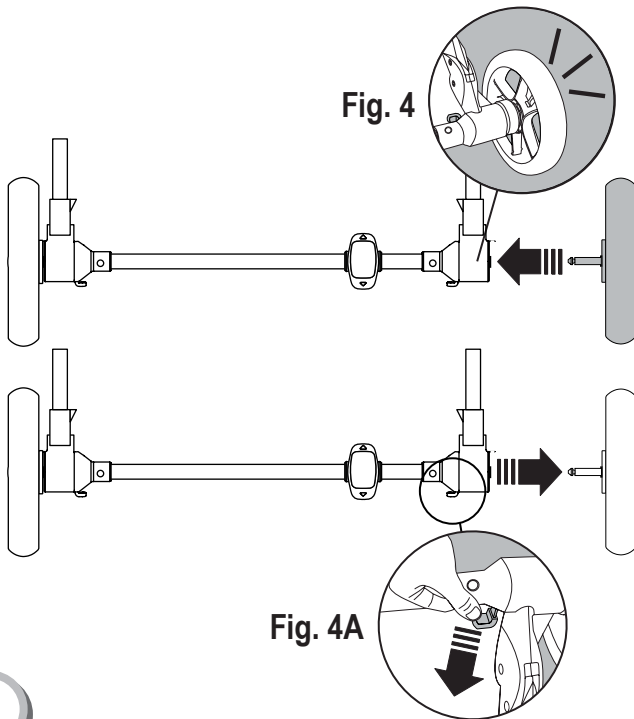

Fig. 4

Fig. 4A

4

ATTACHING REAR WHEELS

- Push rear wheel post into the rear wheel housing until it “CLICKS” into a fully locked position. (Fig. 4)
- Repeat on opposite side.

NOTE: Pull outward on each wheel to ensure that each wheel is securely locked.

REMOVING REAR WHEELS

- Press button located on the back of the wheel housing and pull wheel outward until wheel is released. (Fig. 4A)
- Repeat on opposite side.

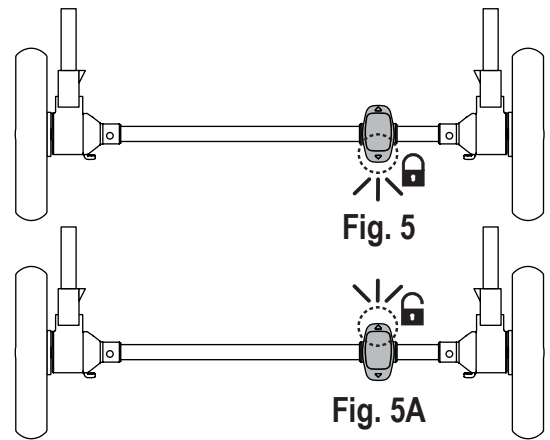

Fig. 5

Fig. 5A

5

WARNING: Always lock brakes when the stroller is not being pushed so that the stroller will not roll away. Never leave stroller unattended on a hill or incline as the stroller may slide down the hill.

WARNING: NEVER leave child unattended in stroller.

Rear Wheel Brake – One Touch Brake System

TO ENGAGE BRAKES

- Apply light downward pressure on bottom section of the linked brake lever located in the middle of the rear wheel axle. (Fig. 5)
- Check to make sure the brakes are in a fully locked position, stroller will not move when pushed.

TO RELEASE BRAKES

- Apply light downward pressure on top section of the linked brake lever located in the middle of the rear wheel axle. (Fig. 5A)

ASSEMBLY

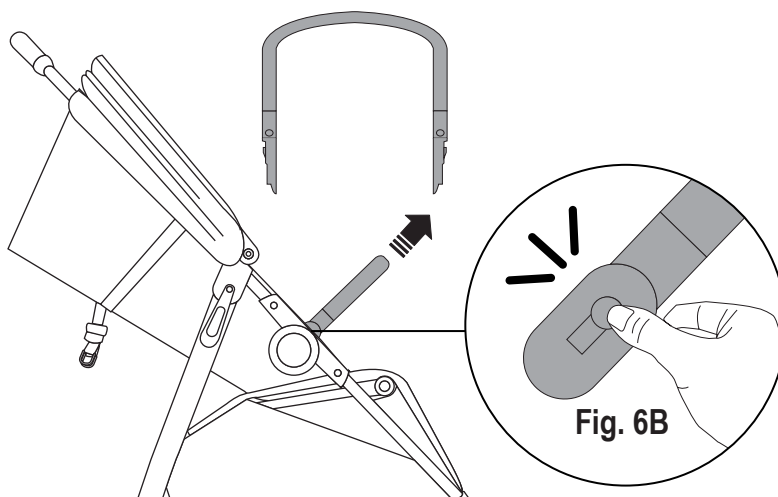
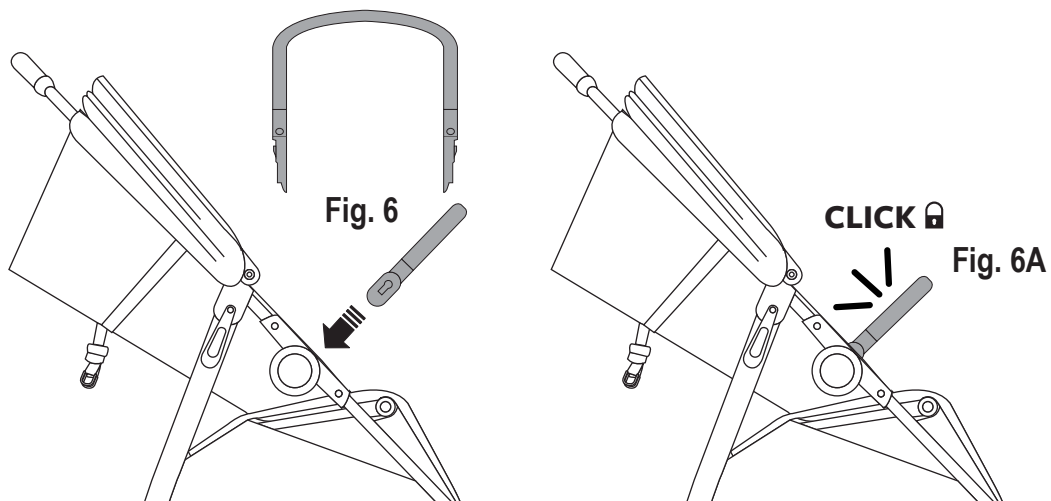

6

ATTACHING CHILD BAR

- Insert left / right sides of the child bar into the child bar housing located on the left / right side of the stroller frame. (Fig. 6)
- The child bar “CLICKS” on both sides once it is in a fully locked position. (Fig. 6A)
- NOTE: Pull upward on the child bar to ensure it is securely locked onto the stroller frame.

REMOVING CHILD BAR

- Press both child bar buttons located on both sides of the stroller frame and pull upward to release. (Fig. 6B)

ASSEMBLY

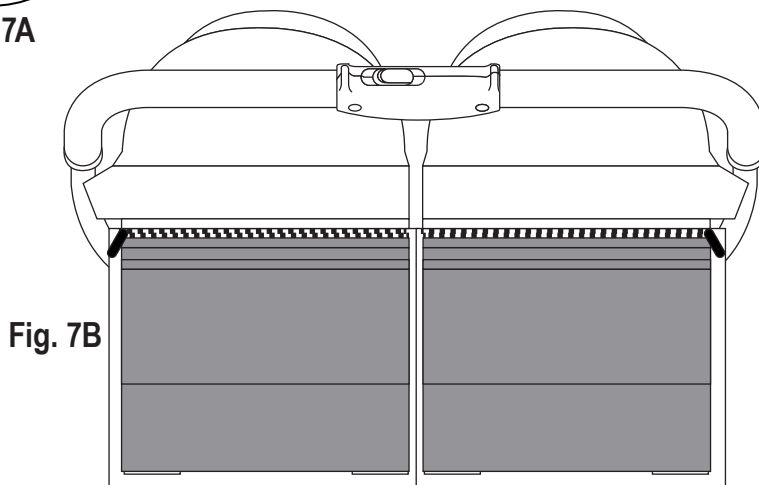
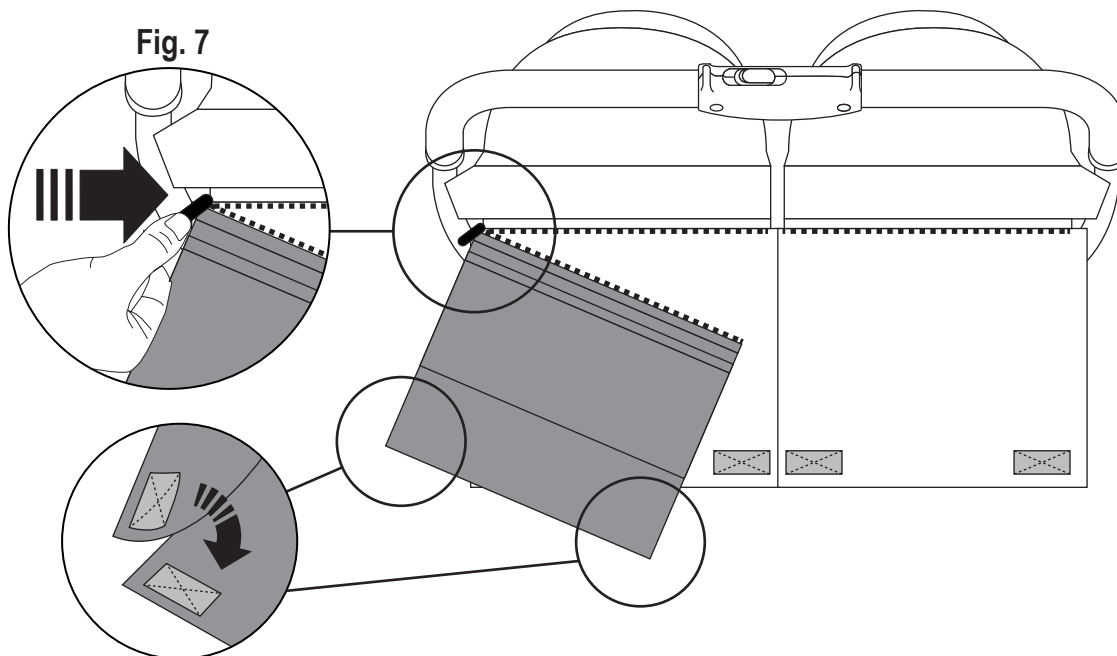

7

ATTACHING POUCHES

- Locate two (X2) pouches and zipper it on the back of the stroller and velcro the bottom. (Fig. 7)
- Repeat on opposite side.
- Fully assembled pouches on rear of stroller. (Fig. 7B)

SETUP AND USE

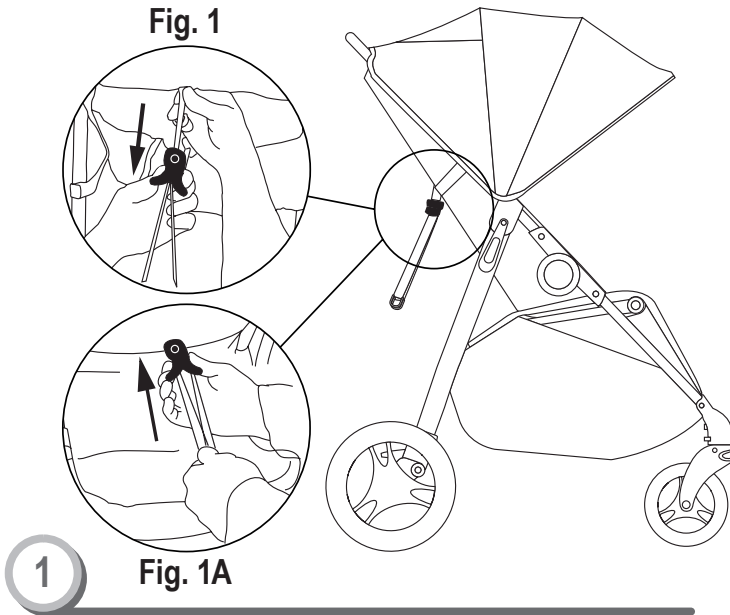

SEAT BACK ADJUSTMENT

- Recline Position: To return to a recline position, squeeze the cord housing and pull downward away from the seat. (Fig. 1).
- Upright Position: To return to an upright position, squeeze the cord housing and pull toward the back of the seat. (Fig. 1A)

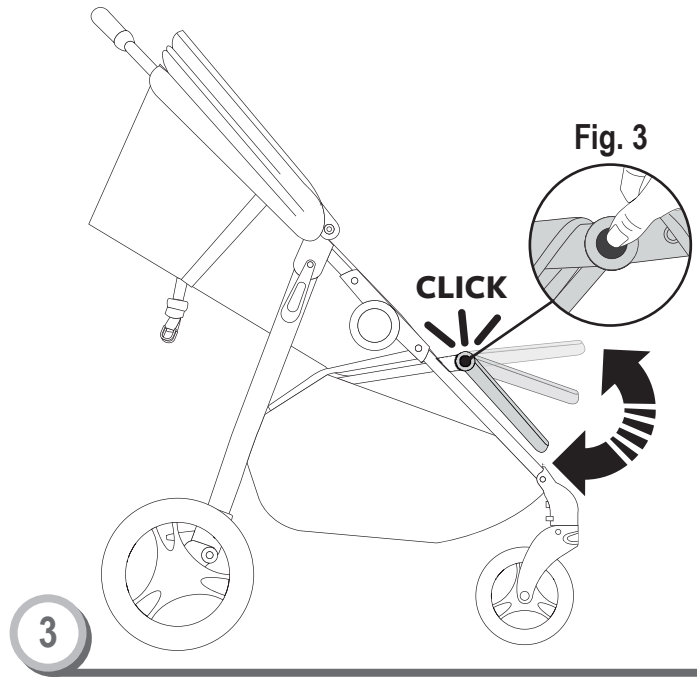

FOOTREST ADJUSTMENT

- Press both left / right recline buttons located on left/right side of foot rest. While pressing both recline buttons, rotate foot rest upward or downward to its desired position.
- The footrest "CLICKS" on both sides once it is in a fully locked position. (Fig. 3)

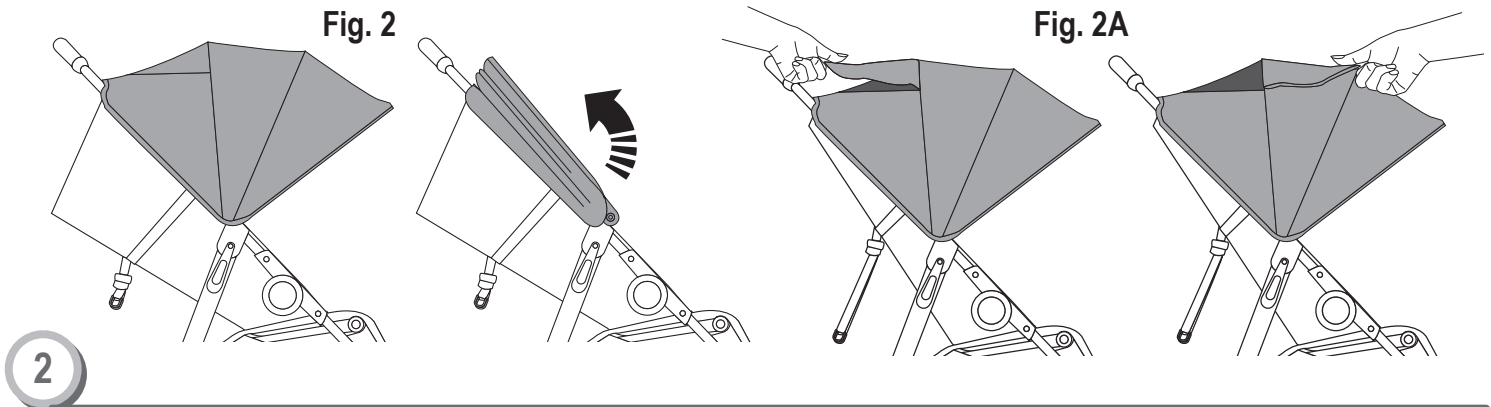

TO CLOSE EXTENDABLE CANOPY

- Push backward on the front edge of canopy until it is all the way collapsed (Fig. 2)

TO OPEN PEEK A BOO WINDOW

- Pull upward on window flap until it is in a fully opened position. (Fig. 2A)

SETUP AND USE

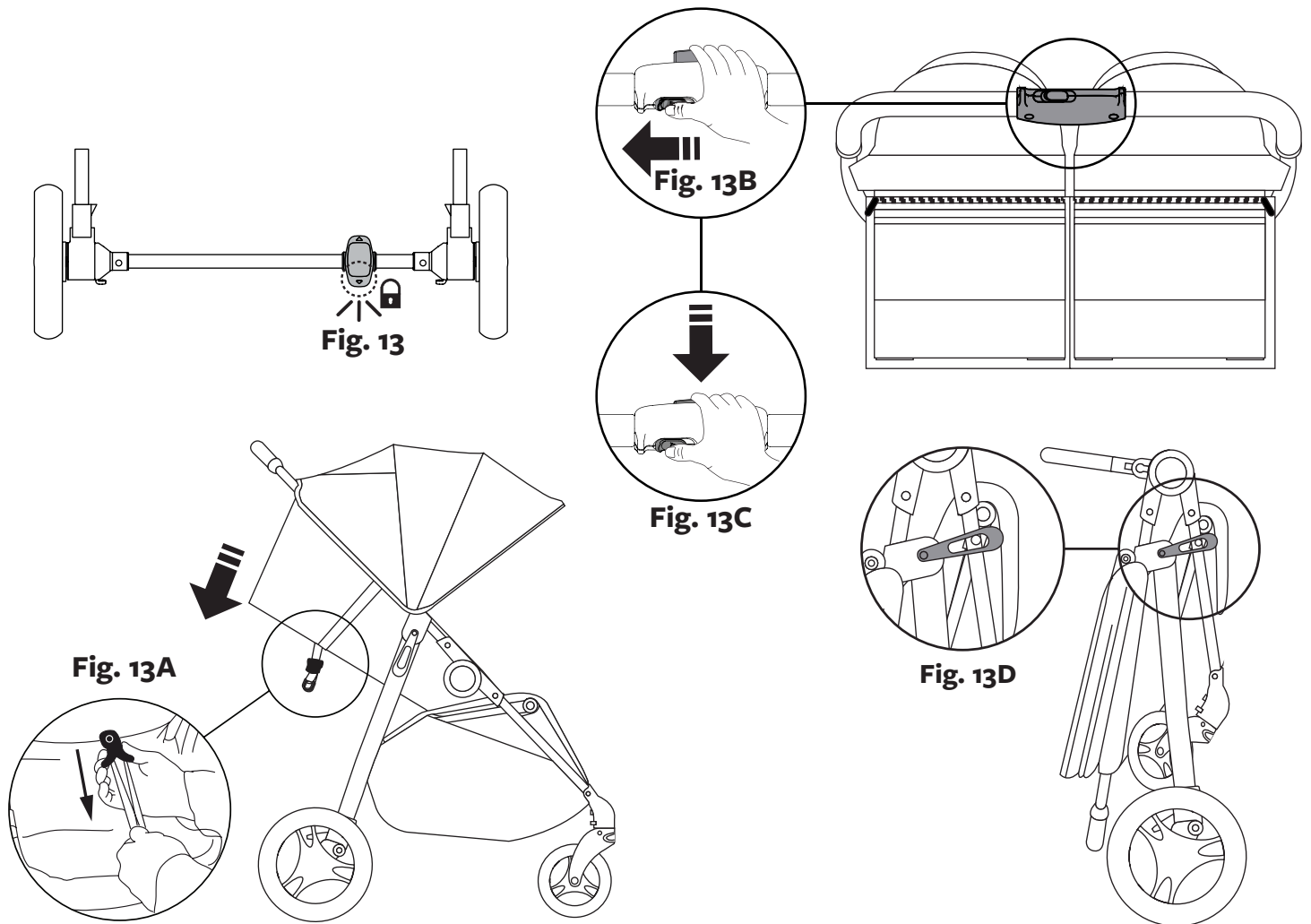

13

FOLDING STROLLER

NOTE: Make sure the brake pedal is pressed down completely. Always set the brake pedal when parking the stroller. Always recline seat to its lowest position before folding the stroller.

- Close the extendable canopy.
- Position footrest to its lowest position.
- Position the stroller seat to a fully reclined position.
- Press the brake pedal down until it “CLICKS” into the locked position. (Fig. 13)
- To return to a recline position, squeeze the cord housing and pull downward away from the seat. (Fig. 13A)
- Slide the unlock tab to the left with your thumb and hold. (Fig. 13B)
- While holding the unlock tab, squeeze the release button inward and push downward on the handle (Fig. 13C) until the auto-latch is in a fully locked position. (Fig. 13D)

SECURING CHILD

Before Placing your Child in Stroller:

Close Canopy. Press both brake pedals down until they “click” into the lock position.

Make sure the brake pedals are pressed down completely.

Always set both brake pedals when parking the stroller.

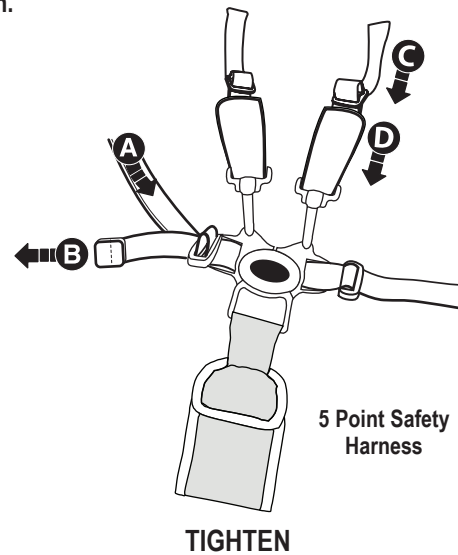
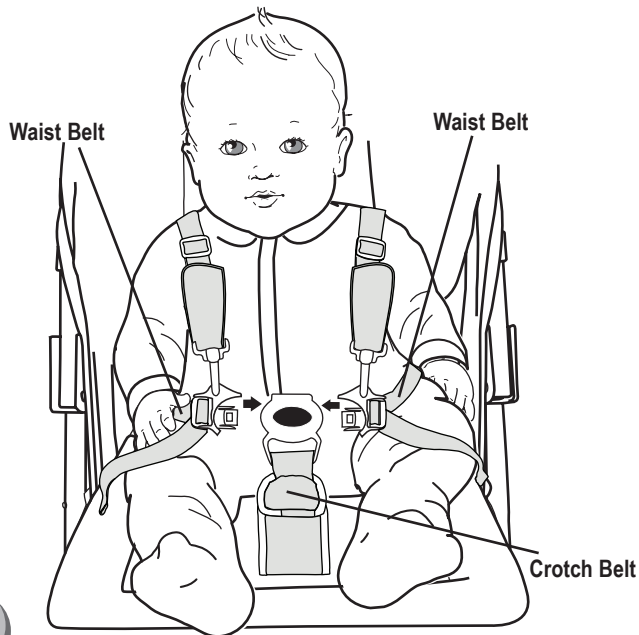

Securing Child

- Place your child in the stroller. Position the crotch belt between your child’s legs.
- Pull shoulder straps over child’s arm and shoulder and fasten both strap ends to the restraint system.
- Fasten both waist belts to the buckle on each side of the crotch belt. Make sure you hear a “click” on both sides.
- Check to be sure the restraint system is securely attached by pulling it away from your child. The restraint system should remain attached.

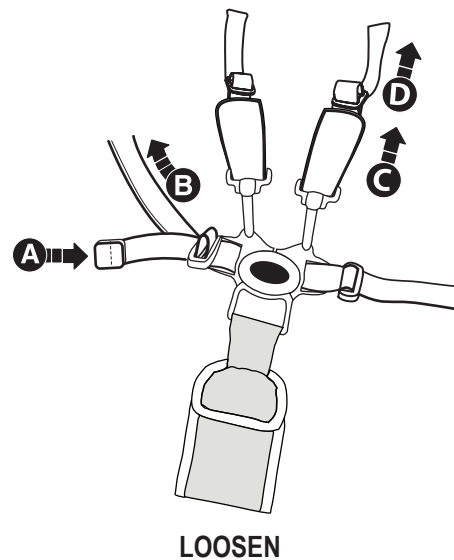

3

To tighten the waist belts and shoulder straps:

- Feed the anchored end of a waist belt up through the buckle to form a loop **A**. Pull the free end of the waist belt **B**.
- Repeat this procedure to tighten the other waist belt.
- Feed the top end of the shoulder strap through the plastic stay to form a loop **C**. Pull the bottom end down to tighten the strap **D**.
- Repeat this procedure to tighten the other shoulder strap.

To loosen the waist belts and shoulder straps:

- Feed the free end of the waist belt up through the buckle to form a loop **A**. Enlarge the loop by pulling on the end of the loop toward the buckle. Pull the anchored end of the waist belt to shorten the free end of the waist belt **B**.
- Repeat this procedure to loosen the other waist belt.
- Feed the bottom end of the shoulder strap through the plastic stay to form a loop **C**. Pull the top end up to loosen the strap **D**.
- Repeat this procedure to loosen the other shoulder strap.

Please Note: After adjusting the restraint system to fit your child, make sure you pull on it to be sure it is securely fastened.

- Tighten each waist belt and shoulder strap so that the restraint system is snug against your child.
Please refer to the next section for instructions to tighten the waist belts.

DELTA♥CHILDREN

Delta Children's Products Corp.
114 West 26th Street
New York, NY 10001
gcs@DeltaChildren.com
www.DeltaChildren.com