

Installation Manual

- ※ Do not use heavy duty tools and excessive power when tightening the connections.
- ※ Do not use Teflon tape when connecting the hose to the water supply valve and the bidet unit.
- ※ This product is water tested for quality check.

1 Accessories (This may differ from the product specification.)

1 A type Installation Accessories

Water Hose (Thin)

Remote control
Each product may use a different remote controller.

Wax Ring Conversion Nut

Wall Mount

AA Batteries (x3) Screws (x2) Anchors (x2)

2 B type Installation Accessories

Water Hose (Thick)

Remote control
Each product may use a different remote controller.

Wax Ring Water Pipe Ring Plate Water Shutoff Valve

Wall Mount

AA Batteries (x3) Screws (x2) Anchors (x2) Strainer Filter

2 Remove Existing Toilet

- Close the water shutoff valve and flush the toilet.

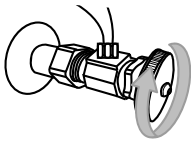

- Remove the toilet and wax ring, leaving the exposed trap (pictured below).

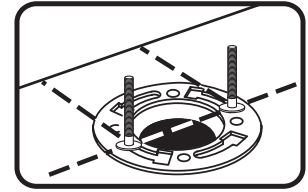
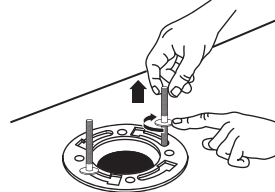
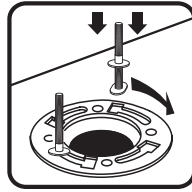

* If you will not install the toilet immediately, cover the exposed trap to eliminate any fumes

3 Install the toilet base

1 A type Installation Accessories

- Attach the provided water hose to your water shutoff valve.

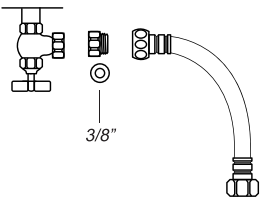

*You may need to use the included conversion nut to fit your water shutoff valve. Simply screw the conversion nut into the 1/2" side of the hose before connecting it to your water shutoff valve.

2 B type Installation Accessories

1. Close the water gauge.
2. Remove dust and sand in the water inlet when installing the shutoff valve.
3. Wind Teflon tape around the water pipe
4. Connect the pipe with the shutoff valve.
5. Connect the Strainer Filter.

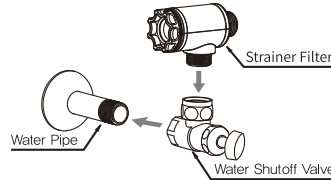

- Apply the new wax ring to the exposed trap.

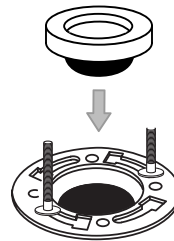

- Line up the toilet base over the closet bolts screws. Place the toilet base and re-secure the closet bolts.

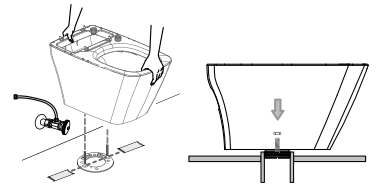

*A team of two people is recommended to correctly place the toilet base.

4 Attach Bidet Seat

- Feed the water hose through the back of the toilet base and attach it to the underside of the bidet seat.

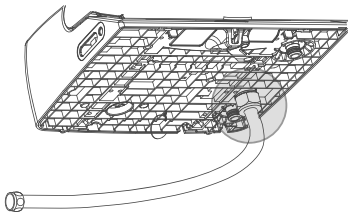

REMOVING THE BIDET SEAT

The bidet seat can be removed by pulling the tabs beneath the unit forward and lifting up.

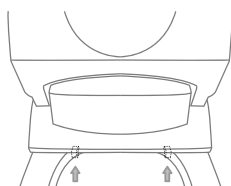

- Attach the bidet seat to the toilet base by lining up the mounting hooks and pressing down until you hear a "click".

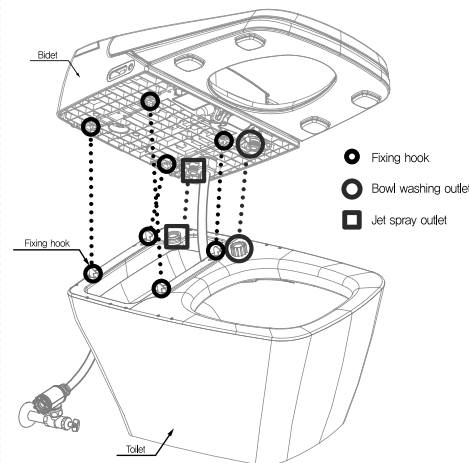

*Do not use excessive force when attaching the bidet seat to the toilet base.

Open the water valve first and then plug-in the power.

- Open the water shutoff valve.

No.1

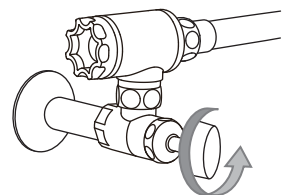

- Plug in the power cord.

No.2

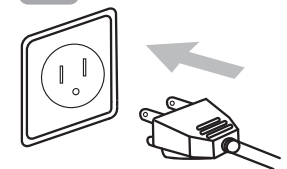

Thank you for purchasing VOVO product.

We are here to help and improve your satisfaction.

Please allow us the opportunity to assist you to maximize your satisfaction.

If you have any questions, please contact us through live chat at www.vovo-us.com or send us an email at support@vovousa.com

How to use Remote Control

< TOP >

– TCB 090SA / RTB 090WA



– TCB 090S / RTB 090W / TCB 8100B / TCB 8100W

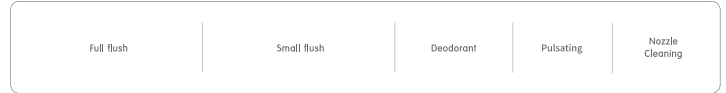

Flush (full, small) button

- Press the flush button to activate the full or small flushing

Cover and seat opening

- When you press the cover or toilet seat buttons, both the toilet seat cover and the toilet seat are automatically open and closed.

Pulsating

- Press the pulsating button to repeat the intensity of the water pressure from strong to weak.

Seat cover opening/closing

- Press the seat cover button to automatically open and close the toilet seat cover

Auto Deodorant ON / OFF

- Press the deodorant button to remove the odor inside the bowl.

Nozzle cleaning

- Press the nozzle cleaning button to clean the nozzle in a moving forward position.

Cover and seat closing

- Press the close button to close both the toilet seat cover and toilet seat.

Power Save On / OFF

- In power save mode, water temperature, and seat temperature will be adjusted efficiently when not used for more than one hour.
- When the product is used again, the temperature returns back to the original setting.

< Front >

– TCB 090SA / RTB 090WA

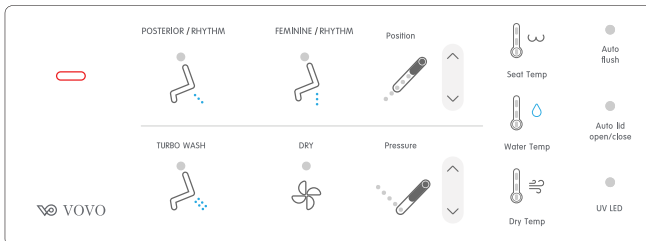

– TCB 090S / RTB 090W

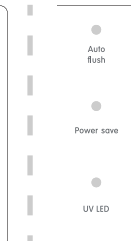

– TCB 8100B / TCB 8100W

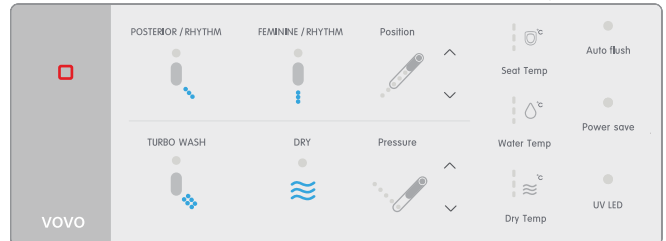

Stop

- To stop the function being used, press the STOP button.

Position

- The nozzle position can be adjusted in five levels.

Turbo Wash

- Press the Turbo wash button to activate washing water spray from the nozzle.

Water Temp

- It is possible to adjust the water temperature of Posterior wash, Feminine wash, and Turbo wash in three levels.

Dry Temp

- The temperature of the drying function can be adjusted in three levels.

Posterior/Rhythm

- Performs Posterior wash (Back area of the body) by pushing the button once.
- Performs Rhythm function when pushed the button again while the posterior function is on the process.
- During Rhythm function, the nozzle will move to wash wide area and provide pulsating massage effect with changing water pressure.

Seat Temp

- The toilet seat temperature button can adjust the temperature of the toilet seat in three levels.

Dry

- Dry off the water after using the posterior wash, Feminine wash, and Turbo wash function.

Auto lid open / close

- When you stand in front of the toilet, the lid automatically opens, and when you move away from the toilet, the lid automatically closes.

Feminine/Rhythm

- Performs Feminine wash (Frontal area of the body) by pushing the button once.
- Performs Rhythm function when pushed the button again while the feminine function is on the process.
- During Rhythm function, the nozzle will move to wash wide area and provide pulsating massage effect with changing water pressure.

Auto flush ON/OFF

- Distinguishes between small flush and full flush based on the time the user is seated on the seat.

Pressure

- It is possible to adjust the water pressure of Posterior wash, Feminine wash, and Turbo wash in five levels.

UV LED Light ON / OFF (Option)

- UV LED eliminates germs and bacteria as well as sterilizing the bowl.
When UV LED function is activated, UV LED will turn on and it will automatically turn off while seated.