

MAINTENANCE INSTRUCTIONS

For 710 Series Diaphragm Valve Sizes 3/8" & 1/2"

Maintenance (all sizes)

Refer to **ASSEMBLY DRAWING APR-236A** And proceed as follows:

1. Loosen and remove body bolts (12).
2. Remove body (1), diaphragm (3) and compressor (3).
3. Remove thrust ring (4), circle clip (13) and quad ring (7).
4. Loosen and remove bolt inserts (22). The complete internals will come out of the housing (15).
5. Remove the locknut (18) and washer (19) from the spindle (23). Remove the piston (8) and springs (9/1, 9/2).
6. Remove the guide (6) from the spindle (23).
7. Remove the thrust ring (4), circle clip (13) and quad ring (7) from the spindle (23).
8. Inspect diaphragm (2) and all parts for wear or abrasion.
9. Replace parts as necessary.
10. Before re-assembling valve lubricate spindle (23), Dow Corning Silicone III or equivalent recommended.
11. To re-assemble valve follow steps 1 through 8 in reverse order, tightening to the bolt torques recommended in the chart below.



JJ DOWNS INDUSTRIAL PLASTICS INC.

416.236.1884

Toronto, ON

JJDOWNS.COM

Maintenance Instructions 710 diaphragm Valve cont.

IMPORTANT When re-assembling valve ensure that holes in lower part (6) of valve, piston (8) and housing (15) are in line. When tightening diaphragm, if it stops turning before its tab lines up with that on the actuator, unscrew diaphragm totally until it backs off one screw thread, then retighten. The tab should now line up with that on the actuator. Also if attaching to actuator ensure all screw holes line up. Above application is for normally closed actuator. Piston (8) can be reversed for normally open application by placing springs (9/1,9/2) must then be between piston (8) and guide (6).

Maintenance (all sizes)

VALVE SIZE	DIAPHRAGM MATERIAL BOLT TORQUE (IN-LB)		
	EPDM	Viton	Teflon
3/8	13	13	18
1/2	13	13	18

		
JJ DOWNS INDUSTRIAL PLASTICS INC.		
416.236.1884	Toronto, ON	JJDOWNS.COM

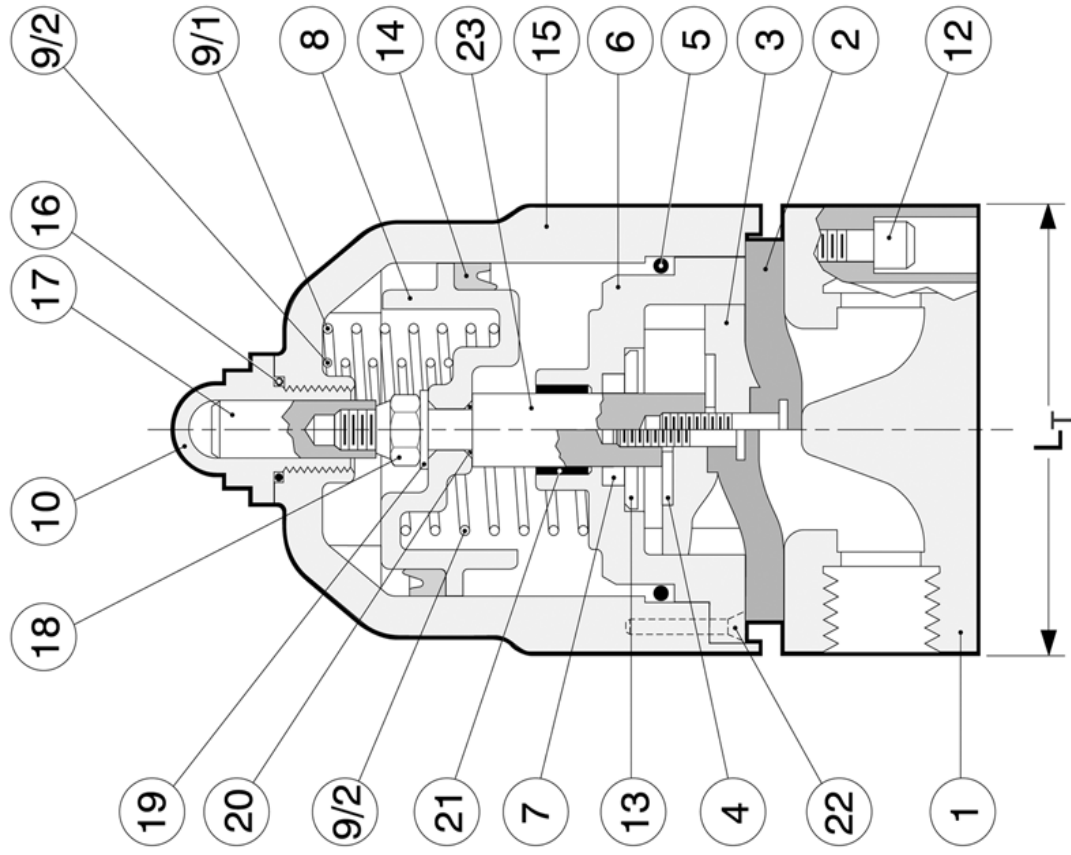

PARTS

No.	Part	Pcs.	Materials
1	Valve Body	1	PVC, CPVC, PP, PVDF
2	Process Diaphragm	1	EPDM, Viton, Teflon
3	Compressor	1	PBTPT
4	Thrust Ring	1	Cad. Plated Steel
5	O-Ring	1	Nitrile
6	Guide	1	Ixef*
7	Quad Ring	1	Nitrile
8	Piston	1	Ixef*
9x	Spring	1	Epoxy Coated Spring Steel
10	Indicator Cover	1	Polycarbonate
12	Socket Head Bolt	4	304 SS
13	Circle Clip	1	Brass
14	Lip Ring	1	Nitrile
15	Actuator Housing	1	Ixef*
16	O-Ring	1	Nitrile
17	Position Indicator	1	Polypropylene
18	Lock Nut	1	Cad. Plated Steel
19	Washer	1	Cad. Plated Steel
20	O-Ring	1	Nitrile
21	Shaft Bearing	1	Teflon/Aluminum
22	Bolt Inserts	2	Steel
23	Spindle	1	Stainless Steel

* Ixef = Polyamide
 † PBTB = Polybutylene Terephthalate

JJD
 JJ DOWNS INDUSTRIAL PLASTICS INC.
 JJDOWNS.COM

TITLE **Approval Drawing - Type 710**
Diaphragm Valve

SCALE	NTS	DATE	CHEMLINE
DR. BY	PJ	03/04	PLASTICS
CHKD. BY			DWG. NO
APP. BY			APR-236A
			REV.

REFERENCE