



Pipe & Hangers Product
**CLIC® TOP & CLIC® Pipe Clamp Hangers,
 Spacers & Accessories**

CLIC® TOP Premium Pipe Hangers

Part Number	Size	Std Pk	Mstr Ctn	Prod Code
-------------	------	--------	----------	-----------

Premium Hangers for IPS Pipe

1/8" IPS Diameter Through 4"



For Internal or External Use

CLIC-001	1/8	100	0	893
CLIC-002	1/4	100	0	893
CLIC-003	3/8	100	0	893
CLIC-005	1/2	100	0	893
CLIC-007	3/4	50	0	893
CLIC-012CTS/010	1 IPS & 1-1/4CTS	50	0	893
CLIC-015CTS/012	1-1/4IPS&1-1/2CTS	25	0	893
CLIC-015	1-1/2	25	0	893
CLIC-020	2	20	0	893
CLIC-025	2-1/2	40	0	893
CLIC-030	3	40	0	893
CLIC-035	3-1/2	25	0	893
CLIC-040	4	25	0	893

Premium Hangers for CTS Pipe

1/2" CTS Diameter Through 2"



For Internal or External Use

CLIC-005CTS	1/2	100	0	893
CLIC-007CTS	3/4	100	0	893
CLIC-010CTS	1	50	0	893
CLIC-012CTS/010	1 IPS & 1-1/4CTS	50	0	893
CLIC-015CTS/012	1-1/4IPS&1-1/2CTS	25	0	893
CLIC-020CTS	2	25	0	893

Premium Hangers for Tubing or Cable

1-1/2", 2-1/2" Tubing & 8mm Cable



For internal or External Use

CLIC-8M	8mm	100	0	893
CLIC-015-TUBING	1-1/2	50	0	893
CLIC-025-TUBING	2-1/2	25	0	893

CLIC® Economical Pipe Hangers

Part Number	Size	Std Pk	Mstr Ctn	Prod Code
-------------	------	--------	----------	-----------

Hangers for IPS Pipe

1/8" IPS Diameter Through 4"



Recommended for Internal Use Only

CLIC2-001	1/8	100	0	893
CLIC2-002	1/4	100	0	893
CLIC2-003	3/8	100	0	893
CLIC2-005	1/2	100	0	893
CLIC2-007	3/4	50	0	893
CLIC2-012CTS010	1 IPS & 1-1/4 CTS	50	0	893
CLIC2-015CTS012	1-1/4 IPS & 1-1/2 CTS	25	0	893
CLIC2-015	1-1/2	25	0	893
CLIC2-020	2	20	0	893
CLIC2-025	2-1/2	40	0	893
CLIC2-030	3	40	0	893
CLIC2-040	4	25	0	893

Hangers for CTS Pipe

1/2" Diameter Through 2"



Recommended for Internal Use Only

CLIC2-005CTS	1/2	100	0	893
CLIC2-007CTS	3/4	100	0	893
CLIC2-010CTS	1	50	0	893
CLIC2-012CTS010	1 IPS & 1-1/4 CTS	50	0	893
CLIC2-015CTS012	1-1/4 IPS & 1-1/2 CTS	25	0	893
CLIC2-020CTS	2	25	0	893

Hangers for Tubing or Cable

1-1/2", 2-1/2" Tubing & 8mm Cable



Recommended for Internal Use Only

CLIC2-8M	8mm	100	0	893
CLIC2-015-TUBE	1-1/2	50	0	893
CLIC2-025-TUBE	2-1/2	25	0	893

Suitable for Oil-Free air handling to 25 psi, not for distribution of compressed air or gas

JJ DOWNS INDUSTRIAL PLASTICS INC.

416.236.1884
Toronto, ON
JJDOWNS.COM



Pipe & Hangers Product
**CLIC® TOP & CLIC® Pipe Clamp Hangers,
 Spacers & Accessories**

CLIC® TOP & CLIC® Spacers

Part Number	Size	Std Pk	Mstr Ctn	Prod Code
-------------	------	--------	----------	-----------

CLIC® Stand-Off Spacers



Fits All CLIC® TOP & CLIC® Hangers

Approximate distance from mounting surface to surface of pipe.
 For Internal or External Use

CLIC-SP2	3/32	100	0	893
CLIC-SP5	3/16	100	0	893
CLIC-SP15	9/16	100	0	893
CLIC-SP25	1	100	0	893
CLIC-SP35	1-3/8	100	0	893
CLIC-SP45	1-3/4	100	0	893
CLIC-SP65	2-9/16	50	0	893
CLIC-SP85	3-5/16	50	0	893

CLIC® TOP & CLIC® Mounting Accessories

Strut Hangers



With Mounting Screw - Fits All CLIC® TOP & CLIC® Hangers or Spacers

Provides Easy Mount to Standard 1-5/8" width Strut Channel

SH-109CLIC	for 3/8" - 2" Pipe Clamps	25	100	892
Designed for Single (1) Installation on 3/8" - 2" Hangers; includes 1-1/4" #10 screw, Use Double (2) Strut Hangers with 2-1/2" #10 screws (2) on Each 2-1/2" through 4" Size CLIC® TOP or CLIC® Pipe Hangers.				

Mounting Flange Nut - Stainless Steel

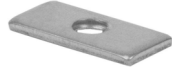

Fits All CLIC® TOP & CLIC® Hangers

Fits Hanger Base to provide 1/4"-20 threaded rod, stud or bolt connection

FN-101CLIC	1/4-20	25	1500	892
------------	--------	----	------	-----

Flange Nut Mounting Adapter - Stainless Steel



1/4"-20 Male to 3/8"-16 Female Adapter

Adapts CLIC Flange Nut to 3/8"-16 threaded rod, stud or bolt connection

FA-102CLIC	1/4-20X3/8-16	10	250	892
------------	---------------	----	-----	-----

Part Number	Size	Std Pk	Mstr Ctn	Prod Code
-------------	------	--------	----------	-----------



Double Thread Stud - Stainless Steel

1/4"-20 Stud 1/2" Long

For connection of 2-CLIC Flange Nuts for Back-to-Back Hanger Mounting

98-63-074	1/4-20X1/2	100	0	299
-----------	------------	-----	---	-----

Mounting Base Plates for 2 & 3 Pipe Lines



Fits CLIC® TOP & CLIC® Hangers up to 3/4" IPS & 1" CTS Pipe Sizes (CLIC# 8-28)

For 2-pc or 3-pc Hanger Mounting - Hangers Snap-fit onto Base Plate

MBP-2	2-pc Plate	50	0	893
MBP-3	3-pc Plate	25	0	893

Suitable for Oil-Free air handling to 25 psi, not for distribution of compressed air or gas

JJ DOWNS INDUSTRIAL PLASTICS INC.

416.236.1884
Toronto, ON
JJDOWNS.COM