

MAINTENANCE INSTRUCTIONS

For Ball Check Valves and Ball Foot Valves Sizes 1/2” to 4”

Maintenance

Refer to dwg.APR-050 or ASSEMBLY DRAWING BC-003 rev.0 and proceed as follows:

1. Loosen union nut (5) and remove valve from line.
(Note: make sure there is no pressure in line prior to removing valve.)
2. **Important** Hold seat/seal (3) in place while removing valve, as the seat, stop ring (6) and ball (2) may fall out.
3. Remove seat (3), stop ring (6) and ball (2). Inspect for excessive wear. The ball should not show signs of wear or deformation.
4. When re-installing ball (2), stop ring (6) and seat (3), check inside body for any foreign debris that may have become lodged in the valve.
5. Replace union nut (5) and tighten.
6. For Foot Valves with strainer baskets, remove basket (7) and clean thoroughly.



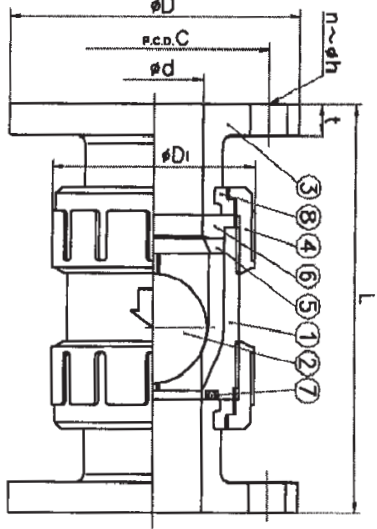

FLANGE END

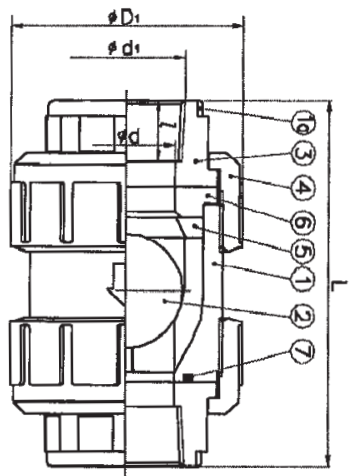

THREAD CONNECTION

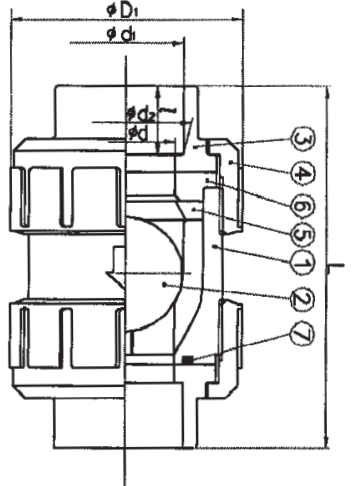

SOCKET CONNECTION

DIMENSIONS TABLE

NOMINAL SIZE	FLANGE						THREAD					
	D	C	n	h	L	t	d ₁	L	L	d	D ₁	
1/2" 15	3.50	2.38	4	0.63	5.12	0.47	1/2"	14 NPT	0.59	3.39	0.59	1.89
3/4" 20	3.86	2.76	4	0.63	6.10	0.55	3/4"	14 NPT	0.67	4.06	0.79	2.36
1	4.25	3.13	4	0.63	6.50	0.55	1"	11 1/2 NPT	0.79	4.45	0.98	2.76
1 1/4 30	—	—	—	—	—	—	1 1/4"	11 1/2 NPT	0.87	5.00	1.22	3.78
1 1/2 40	5.00	3.88	4	0.63	7.56	0.53	1 1/2"	11 1/2 NPT	0.98	5.94	1.57	3.78
2	5.98	4.74	4	0.75	8.43	0.63	2"	11 1/2 NPT	1.10	6.97	2.01	4.17

UNIT : inch

NOMINAL SIZE	PVC - C-PVC						SOCKET						
	d ₁	d ₂	L	d ₁	d ₂	L	d ₁	d ₂	L	d ₁	d ₂	L	
1/2" 15	0.84	0.83	0.68	3.43	0.84	0.83	0.87	3.80	0.82	—	0.89	3.83	0.83
3/4" 20	1.05	1.04	0.71	3.86	1.05	1.04	1.00	4.41	1.03	—	1.05	4.49	1.04
1	1.32	1.31	0.87	4.37	1.32	1.31	1.25	4.88	1.30	—	1.40	4.98	1.30
1 1/4 30	1.67	1.65	0.93	4.92	1.67	1.65	1.25	5.55	1.50	—	1.26	5.58	—
1 1/2 40	1.91	1.89	1.09	5.94	1.91	1.89	1.37	6.50	1.89	—	1.39	6.57	1.89
2	2.30	2.28	1.56	6.77	2.30	2.28	1.50	7.44	2.30	—	1.51	7.57	2.34

NOTE: The shape and appearance of assembly differ a little with nominal size compared to this drawing.

Customer
Customer PO#
Chemline PS#

Part No. _____
Body Material _____
Elastomer Material _____
End Connection _____

1a RING	2	STAINLESS STEEL (304/316)	1/2" - 1"
8 STOP RING (B)	2	PVDF	1/2" - 1"
7 O-RING	1	EPDM / FPM	used for flange end
6 SEAT RING	1	Others	Y
5 STOP RING (A)	1	PVC	
4 UNION NUT	2	C-PVC	
3 END CONNECTOR	2	PP	
2 BALL	2	PP	
1 BODY	1	PVDF	

TRUE UNION BALL CHECK VALVE ASSTLY
FLANGE END, SOCKET CONNECTION, THREAD CONNECTION
ANSI : 1/2" - 2"

DRAWN LC DATE 09/28/99 SCALE
CHECKED DRAWING No.
APPROVED APR-050

CHEMLINE PLASTICS LTD.





JJ DOWNS INDUSTRIAL PLASTICS INC.

416.236.1884 Toronto, ON JJDOWNS.COM