

REVOLVER

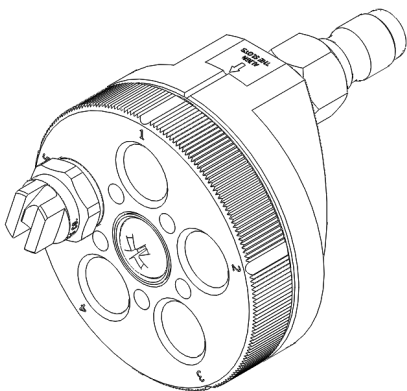

QUICK START GUIDE

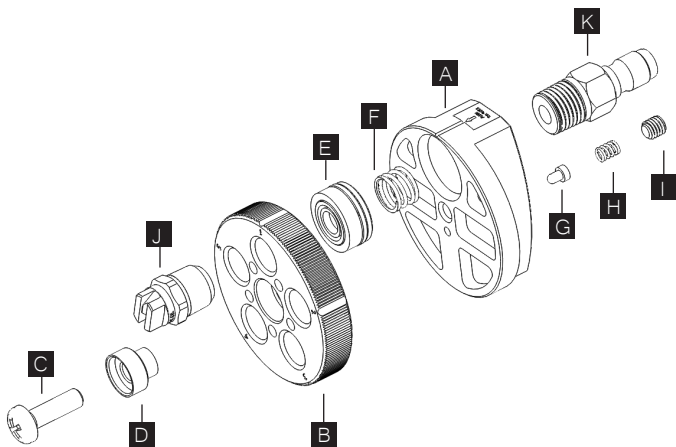

COMPONENTS

A - REVOLVER BODY
B - ROTATING CAP
C - CENTER ASSEMBLY SCREW
D - BRASS BUSHING
E - PRESSURE SEAL
F - SEAL SPRING
G - DETENT PIN

H - DETENT SPRING
I - DETENT SET SCREW
J - SPRAY TIP
K - INLET COUPLING

ASSEMBLY AND TESTING

1. Attach the included Inlet Coupling and Spray Tips to the Revolver
 - a. Teflon tape **MUST** be used to create a seal on all threads
 - b. It can be helpful to have a friend, or soft-grip vice, to hold the Revolver while you install the spray tips
2. Insert the assembled Revolver into your gun or wand's female quick connect and ensure it fits properly
 - a. Make sure the female quick connect 'locks'
3. Test the unit with low pressure water
4. Test the unit with high pressure water
5. Rotate through the spray tip range, verifying it 'clicks' into position and the alignment line on the Revolver body and Rotating Cap straight with each other
6. Get to work!

! CHLORINE AND OTHER CHEMICALS !

We designed the Revolver to endure day after day of industrial work - however, high potency chemicals corrode and destroy ANY metal they make contact with. The oxidative properties of the process of corrosion imply that a majority of the damage occurs once the chemical is dispensed and allowed to sit on the surface for extended periods.

In order to prolong the life of the Revolver's serviceable internals, it is **IMPERATIVE** to rinse and flush the unit after each use with any corrosive chemicals.

Flushing can be completed by rotating through the nozzles while running water (at high or low pressure). Dunking into a neutralizer is an alternative to flushing with water.

DO NOT FORGET TO FLUSH YOUR UNIT!

MAINTENANCE

1. Occasionally spray the center assembly screw area with WD-40 to keep the unit spinning smoothly
2. Frequently check that the center assembly screw has NOT loosened from vibration of the pressure washer. If loose, add threadlock and tighten down.
 - a. A loose assembly screw can cause the unit to separate and the seals to fail during use.
3. Occasionally turn the Detent Set Screw on the back of the body to ensure it hasn't locked up
4. Occasionally rebuild the Detent Pin Hole by unscrewing the Set Screw, and removing the spring and pin. Fill the hole with some grease, and reassemble
 - a. A Revolver that feels 'rough' when turning likely just needs to have its detent pin cleaned

TROUBLESHOOTING

PROBLEM: Difficulty turning rotating cap

- This problem is a symptom an issue with either the detent pin, or friction from the center assembly screw / brass bushing

SOLUTION:

- a. Rebuild the Detent Pin Hole by unscrewing the Set Screw, and removing the spring and pin. Fill the hole with some grease, and reassemble

PROBLEM: Water leaking from gap between revolver body and rotating cap

- The Pressure seal not engaging with the back face of the rotating cap
- Solution**

- a. Ensure alignment of the line on the Body and the Rotating cap not aligned
- b. Check that the unit 'clicks' into location when rotating cap
- c. Test if the center assembly screw is tight

PROBLEM: Difficult inserting and removing quick release inlet coupling

SOLUTION:

- a. Replace coupling from mushrooming