

# SST019

# Welding Bottle

# Organizer

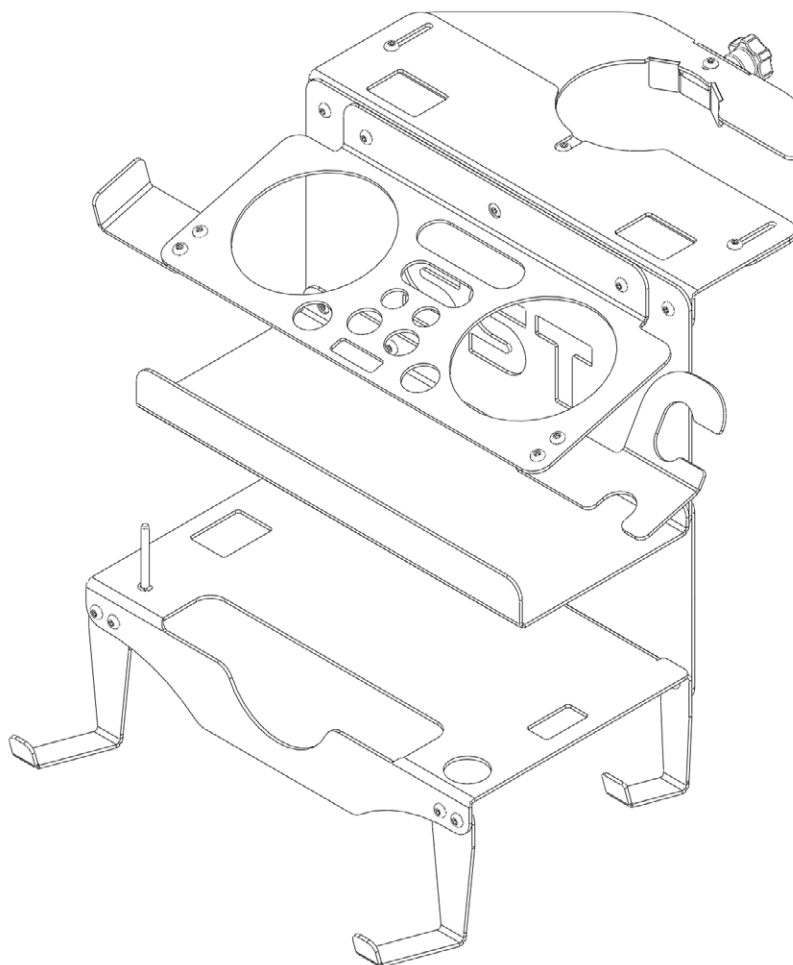

|    |                          |
|----|--------------------------|
| 01 | What's in the Box        |
| 02 | Assembly                 |
|    | a. Standard Shelf        |
|    | b. Angle Grinder Shelf   |
| 03 | Technical Specifications |
| 04 | Safety                   |
| 05 | Liability                |
| 06 | Warranty Policy          |

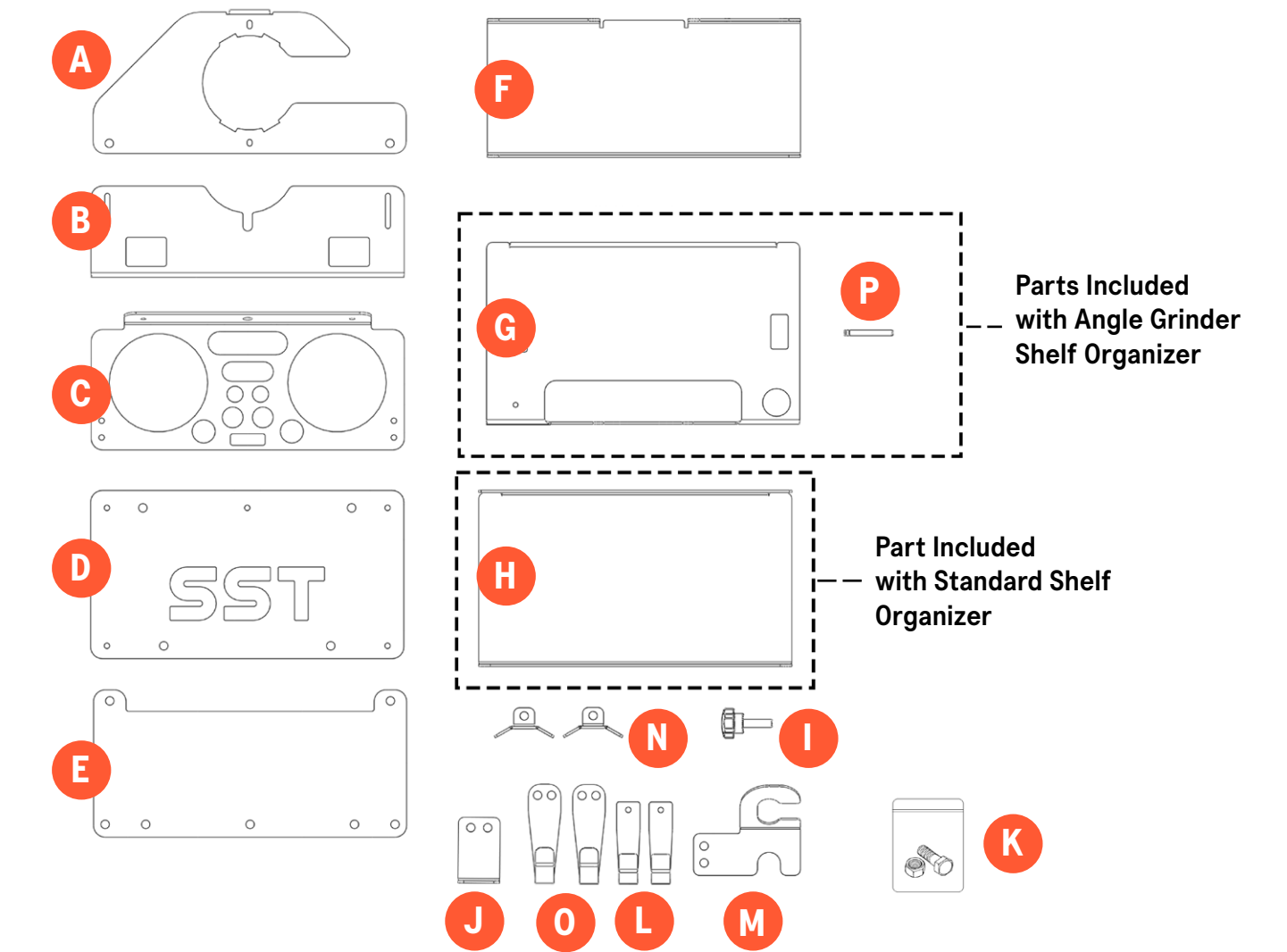

| No | Part Name                  | Quantity |
|----|----------------------------|----------|
| A  | Bottle Collar              | 1        |
| B  | Sliding Assembly Connector | 1        |
| C  | Accessories Shelf          | 1        |
| D  | Back Plate                 | 1        |
| E  | Back Plate Extension       | 1        |
| F  | Middle Shelf               | 1        |
| G  | Angle Grinder Shelf        | 1        |
| H  | Bottom Shelf               | 1        |
| I  | Tightening Knob            | 1        |
| J  | Large Hook                 | 1        |
| K  | Hardware Baggie            | 1        |
| L  | Small Hook                 | 2        |
| M  | Torch Holder               | 1        |
| N  | Bottle Collar Pad          | 2        |
| O  | Medium Hook                | 2        |
| P  | Disc Holder Pin            | 1        |

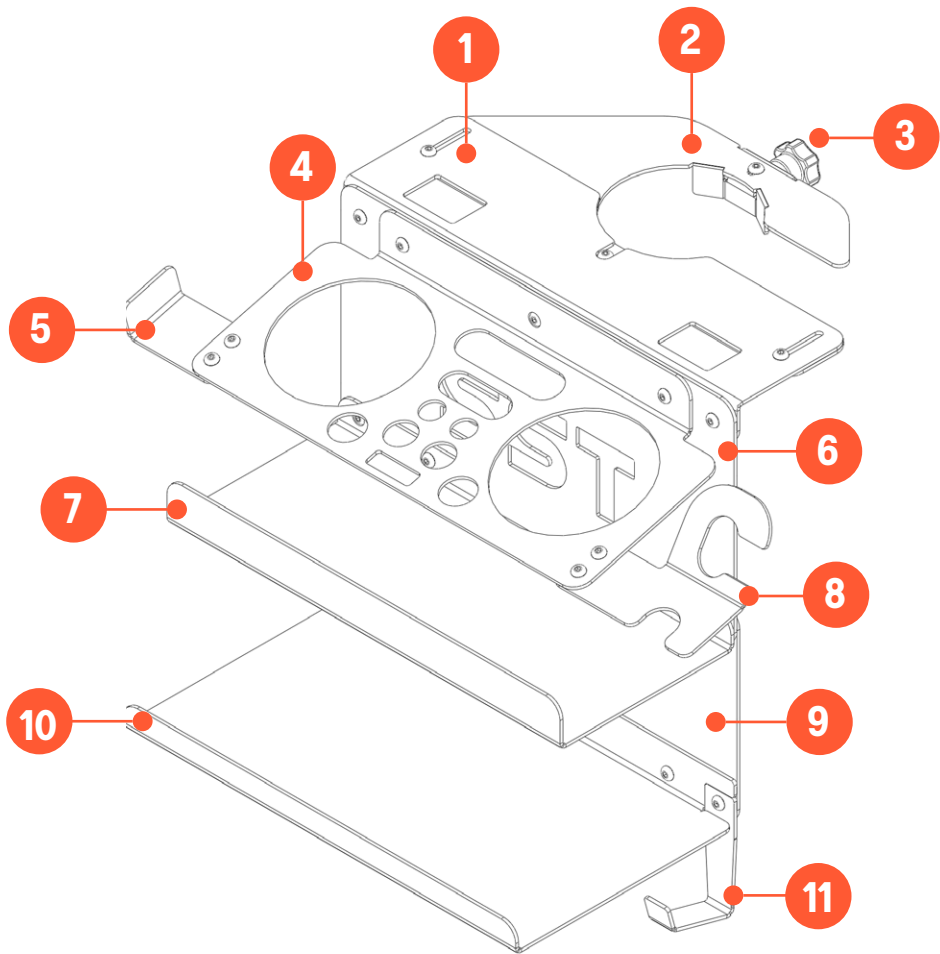

| No | Part Name                  |
|----|----------------------------|
| 1  | Sliding Assembly Connector |
| 2  | Bottle Collar              |
| 3  | Tightening Knob            |
| 4  | Accessories Shelf          |
| 5  | Large Hook                 |
| 6  | Back Plate                 |
| 7  | Middle Shelf               |
| 8  | Torch Holder               |
| 9  | Back Plate Extension       |
| 10 | Bottom Shelf               |
| 11 | Small Hook                 |

## Component Map - Angle Grinder Shelf

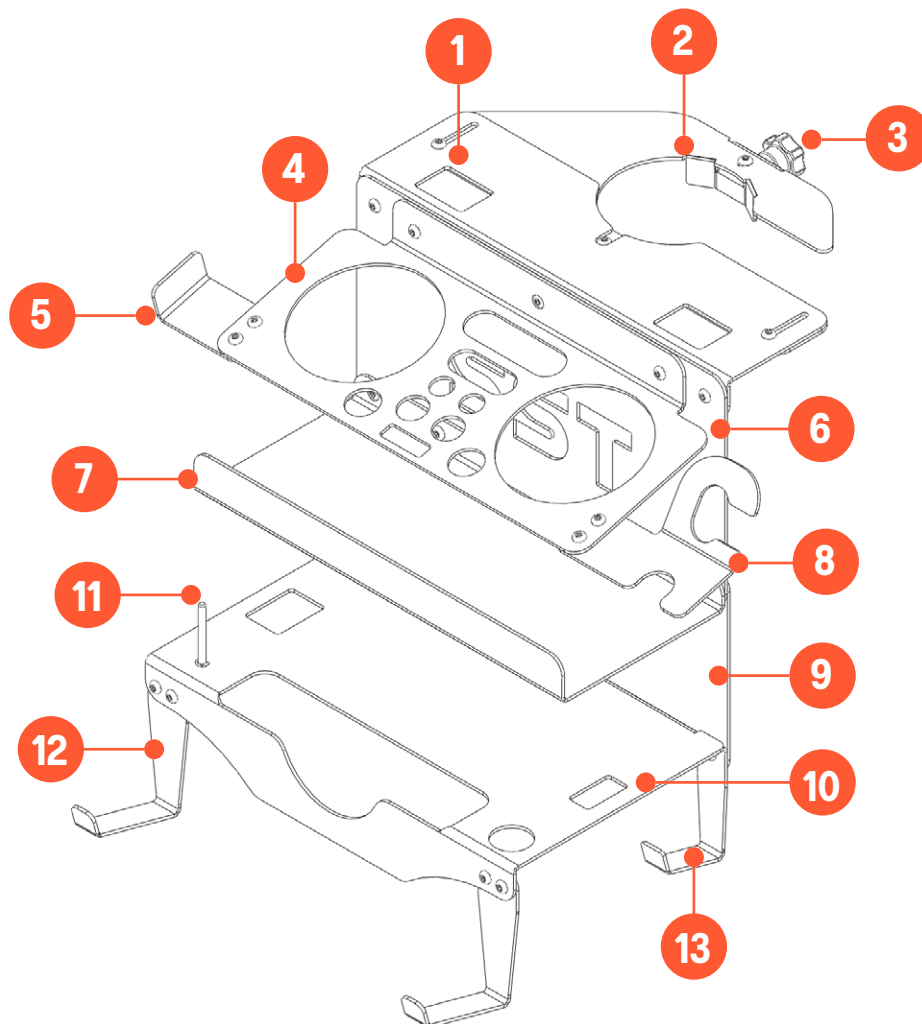

| No | Part Name                  |
|----|----------------------------|
| 1  | Sliding Assembly Connector |
| 2  | Bottle Collar              |
| 3  | Tightening Knob            |
| 4  | Accessories Shelf          |
| 5  | Large Hook                 |
| 6  | Back Plate                 |
| 7  | Middle Shelf               |
| 8  | Torch Holder               |
| 9  | Back Plate Extension       |
| 10 | Angle Grinder Shelf        |
| 11 | Disc Holder Pin            |
| 12 | Medium Hook                |
| 13 | Small Hook                 |

## Access Our Assembly Walkthrough Video

Prefer to see how its done? Click on the button below, scan the QR code, or copy and paste the link into your browser to watch our assembly video!

Option 1

**Click Here!**

---

**Scan Here!**

Option 2



Option 3

**Link Here!**

<https://www.youtube.com/watch?v=wI0qh6YPkPs>

## Welding Bottle Organizer Assembly: Standard Shelf

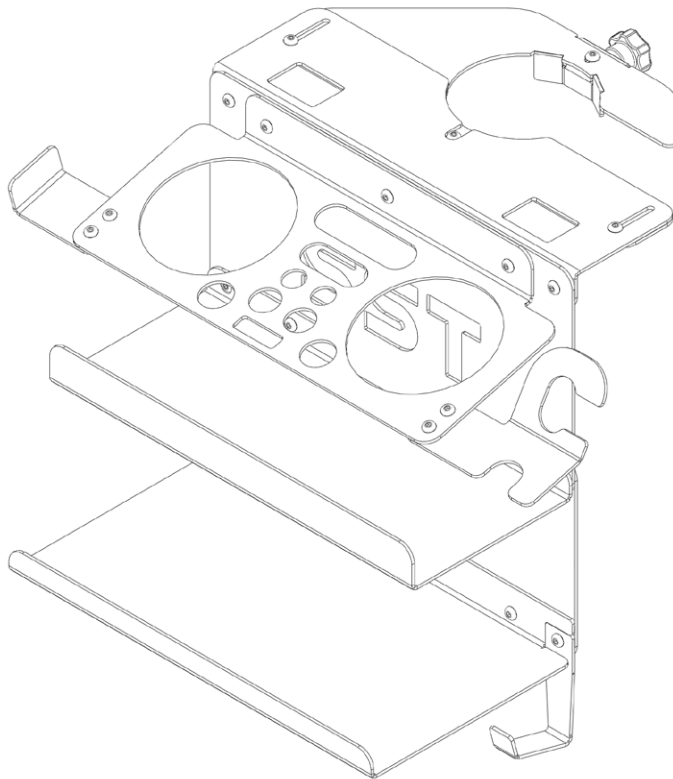

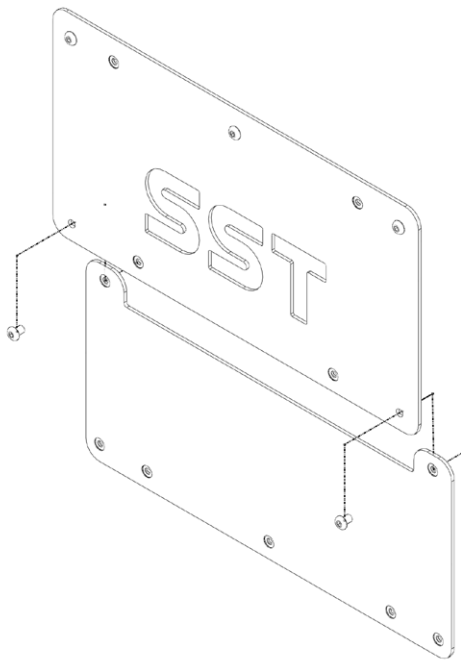

### 1. Attach the Back Plate to the Back Plate Extension

---

a. Use 2pcs M4 x 5 Button Head Bolts

---

b. ONLY the two outer holes should receive bolts

---

NOTE : The only hardware included is M4 x 5 Button Head Bolts - so no need to measure or check sizing

---

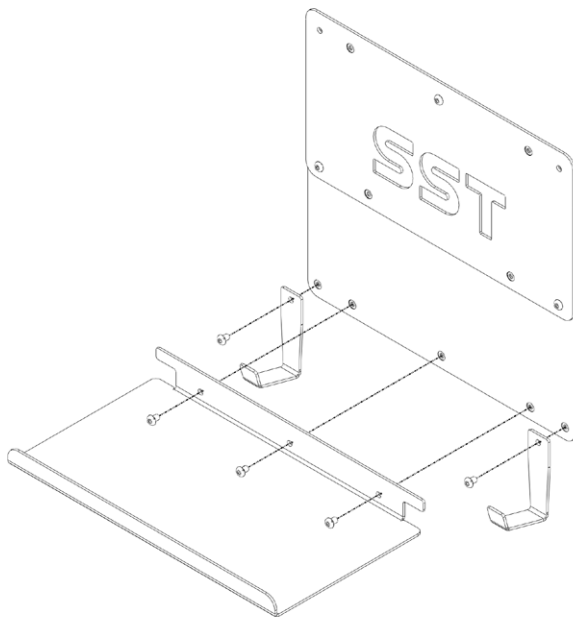

### 2. Attach the Bottom Shelf & Small Hooks to the Back Plate Extension

---

a. Use 3pcs M4 Bolts for the Bottom Shelf

---

b. The Small Hooks take 1pcs M4 bolt each

---



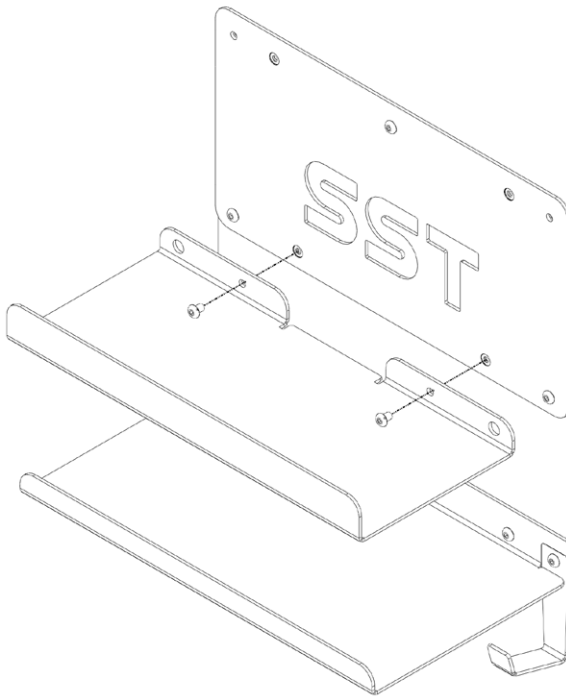

### 3. Attach the Middle Shelf to the Back Plate

---

a. Use 2pcs M4 bolts

---

b. The bolts are used only on the two center-most holes

---

c. The outer-most holes are intentionally oversized, so they clear the heads of the bolts used to secure the Back Plates

---

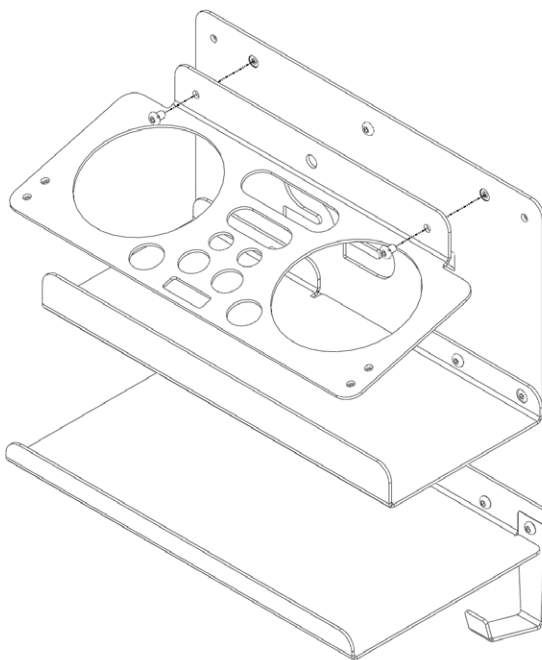

### 4. Attach the Accessories Shelf to the Back Plate

---

a. Use 2pcs M4 bolts

---

b. Only the two outer-most holes receive bolts,

---

c. The center hole is used to attach the Bottle Collar Sub-assembly in the next steps

---

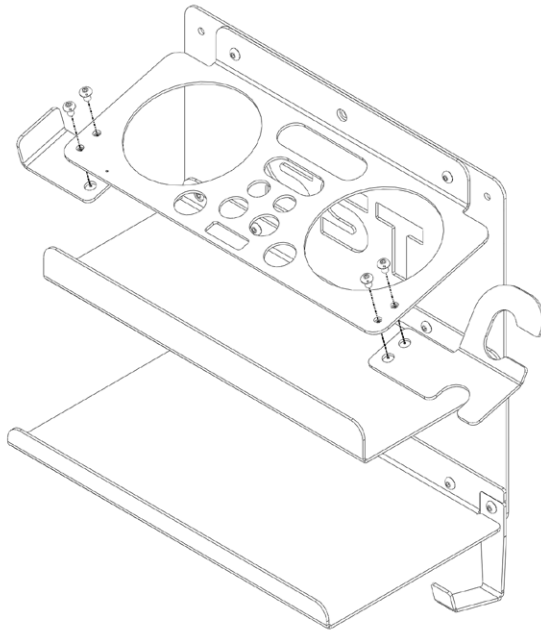

### 5. Attach the Large Hook and Torch Holder to the Accessories Shelf

---

a. Each uses 2pcs M4 bolts

---

b. Take care to align properly before tightening - they should be straight and square with the accessories shelf

---

### 6. Set Organizer aside as we move on to assembling the bottle collar.

---

## Assembly

### Bottle Collar Sub-assembly

---

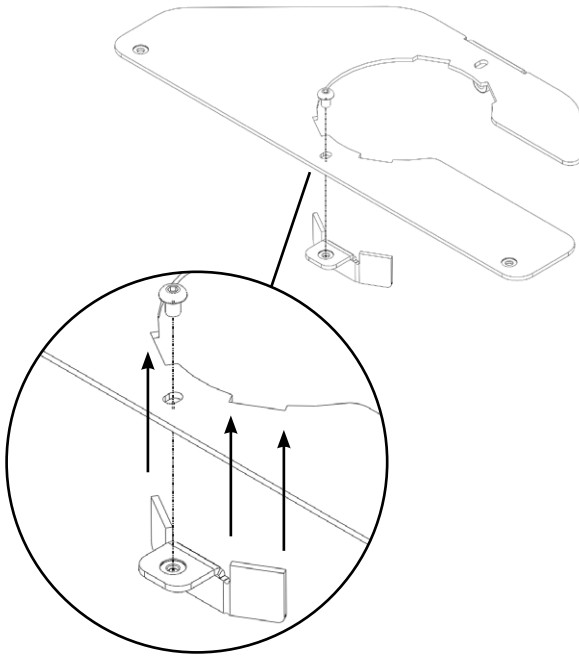

#### 7. Connect the Stationary Clamp Pad to the Bottle Collar

---

- a. Use 1pcs M4 bolt
  - b. CHECK that the Clamp Pad aligns with the cut-outs on the Bottle Collar
- 

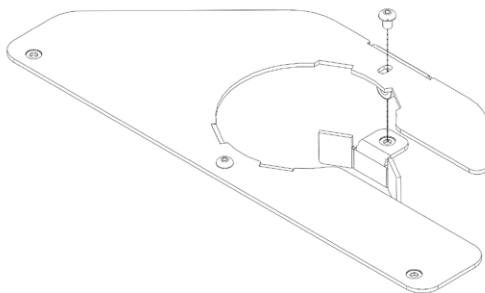

#### 8. Connect the Sliding Clamp Pad to the Bottle Collar

---

- a. Use 1pcs M4 bolt
  - b. CHECK that the Clamp Pad aligns with the cut-outs on the Bottle Collar
  - c. Lightly tighten, but allow some slack so the pad can slide under the Tightening Knob
-

## Assembly

### Bottle Collar Sub-assembly

---

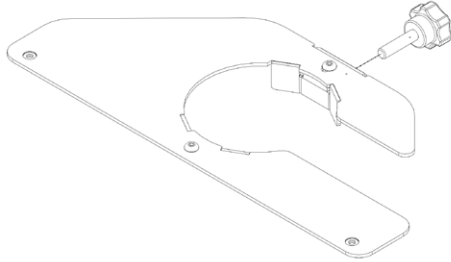

#### 9. Thread the Tightening Knob onto the Bottle Collar

---

- Test to see that the Sliding Collar Pad moves along with the Tightening Knob
- 

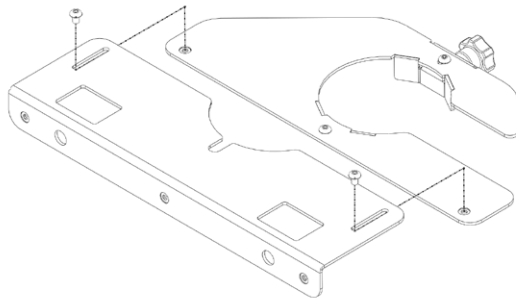
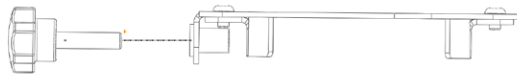

#### 10. Secure the Bottle Collar to the Sliding Assembly Connector

---

- Use 1pcs M4 bolt
  - Lightly tighten, but allow some slack so connector can slide
- 

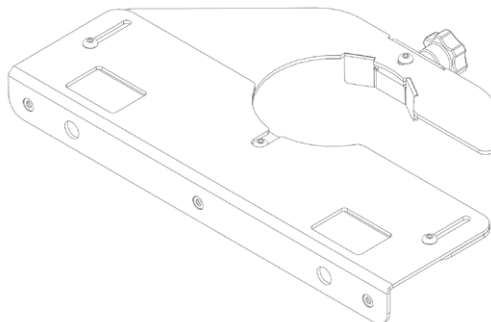

## Assembly

### Bottle Collar Sub-assembly

---

Extended (for larger tanks)

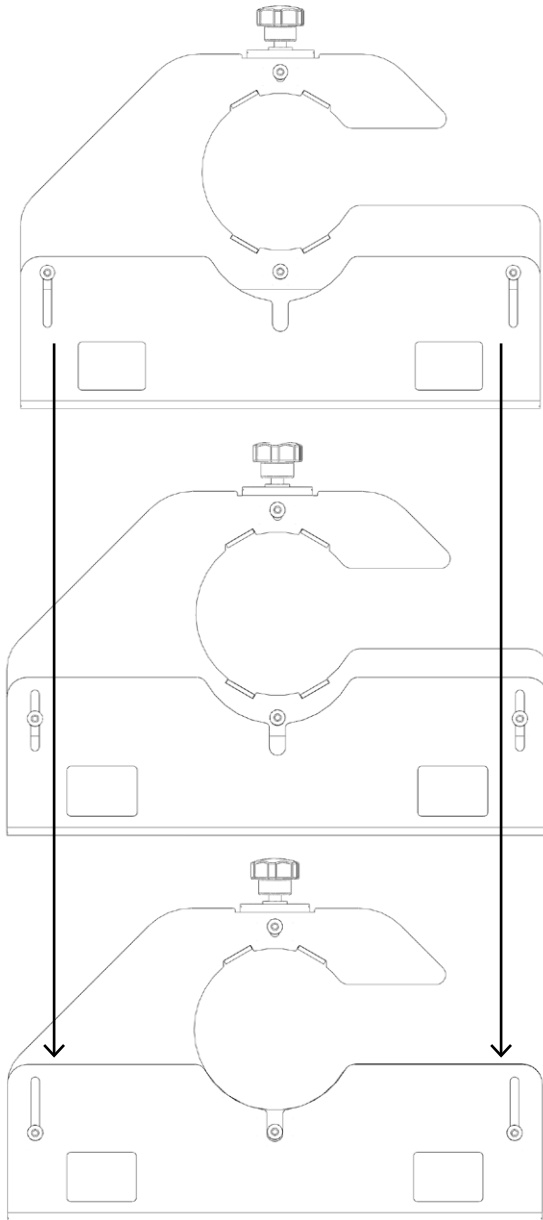

Compressed (for smaller tanks)

#### 11. Check and admire the Bottle Mount Sub-Assembly'sv ability to slide

---

- a. Once you mount the unit to your bottle, and are able to properly extend the assembly to the right length, you can secure the two M4 bolts
-

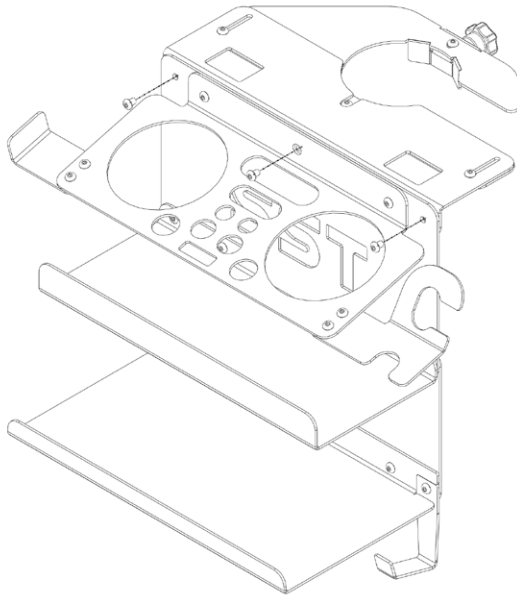

## 12. Secure the Bottle Collar Sub-assembly to the Back Plate

---

a. Use 3pcs M4 bolts

---

b. The bolts are used on the 2x outer-most holes, as well as the center hole

---

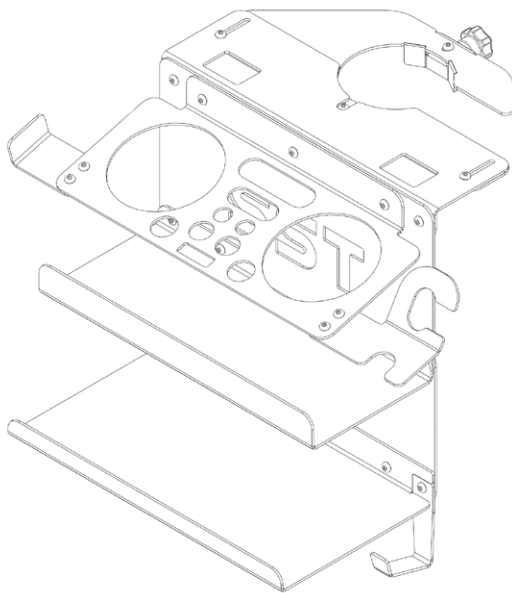

## 13. Admire your new Bottle Mount and Get to Organizing!

---

## Welding Bottle Organizer Assembly: Angle Grinder Shelf

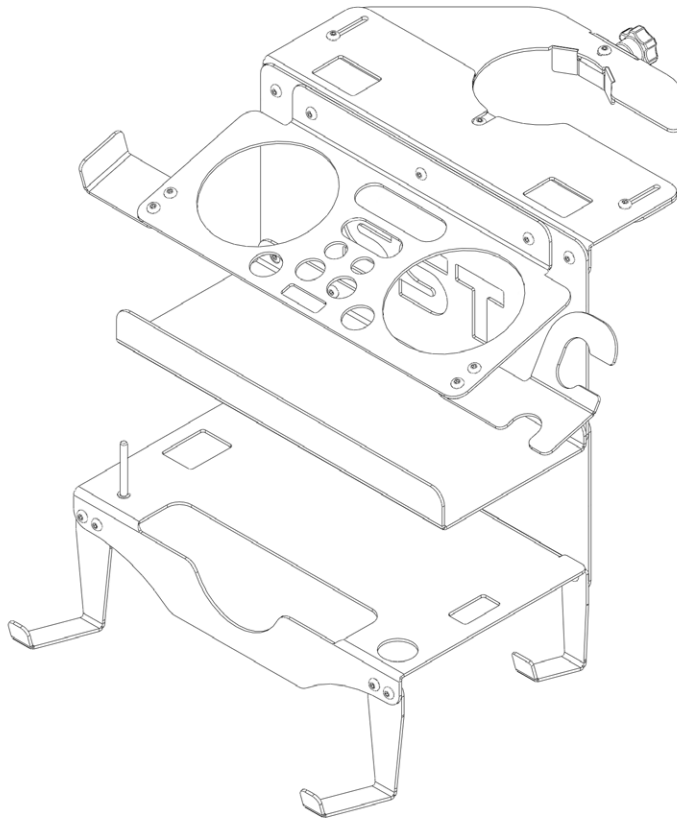

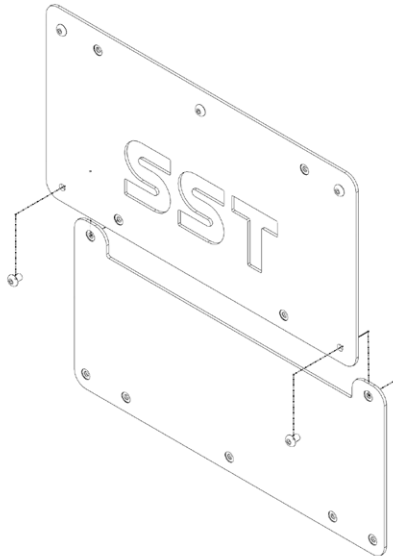

### 1. Attach the Back Plate to the Back Plate Extension

---

a. Use 2pcs M4 x 5 Button Head Bolts

---

b. ONLY the two outer holes should receive bolts

---

NOTE : The only hardware included is M4 x 5 Button Head Bolts - so no need to measure or check sizing

---

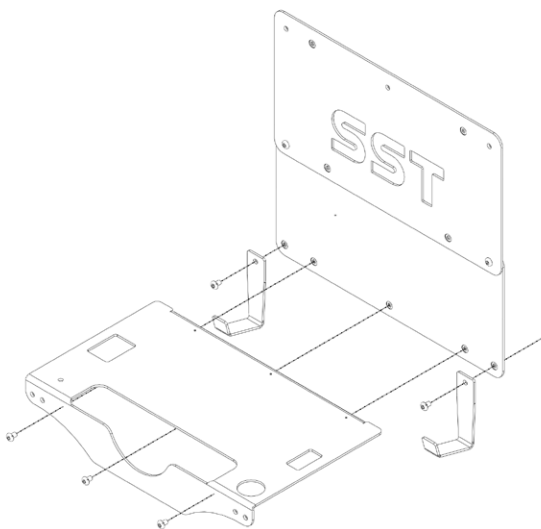

### 2. Attach the Angle Grinder Shelf & Small Hooks to the Back Plate Extension

---

a. Use 3pcs M4 Bolts for the Angle Grinder Shelf

---

b. The Small Hooks take 1pcs M4 bolt each

---



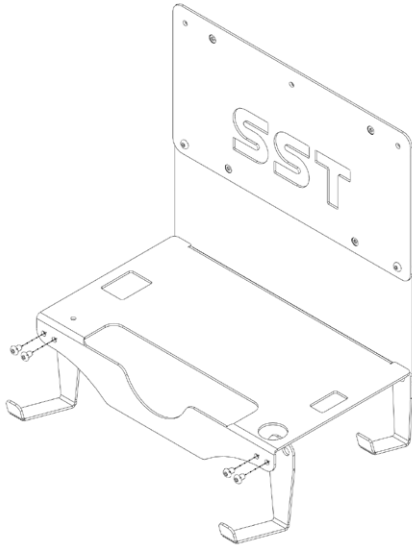

### 3. Secure the Medium Hooks to the Angle Grinder Bracket

---

- a. Each hook uses 2pcs M4 Bolt
- 

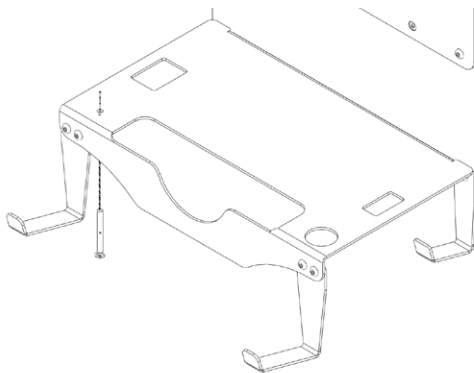

### 4. Secure the Grinder Disc Pin onto the Angle Grinder Shelf

---

- a. The pin locks onto the shelf using two retaining clips
- 

- b. I recommend FIRST attaching the retaining clip to the bottom groove, then inserting into the Shelf and attaching the second retaining clip
- 

- c. Use a screwdriver or pliers to help with this assembly process
- 

- d. BE CAREFUL TO NOT LOSE THE CLIP! They're small and can easily fly away if you're not careful
- 

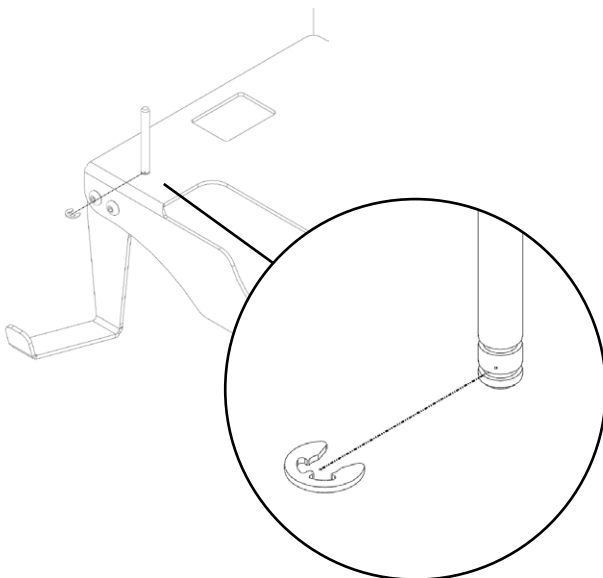

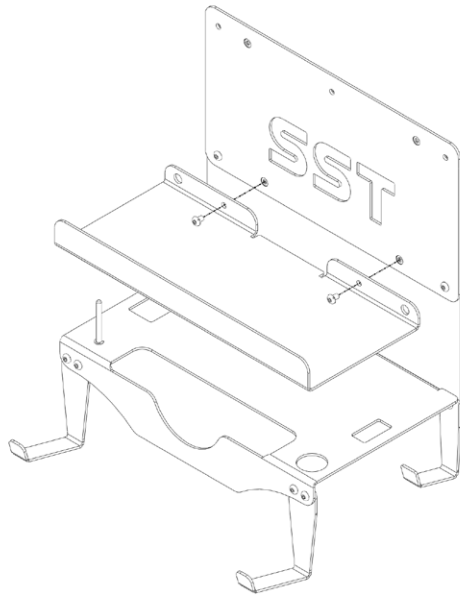

### 5. Attach the Middle Shelf to the Back Plate

---

a. Use 2pcs M4 bolts

---

b. The bolts are used on the two center-most holes

---

c. The outer-most holes are intentionally oversized, so they clear the heads of the bolts used to secure the Back Plates

---

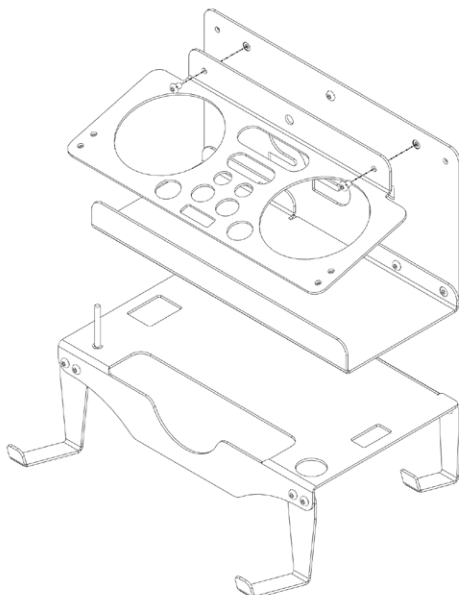

### 6. Attach the Accessories Shelf to the Back Plate

---

a. Use 2pcs M4 bolts

---

b. Only the two outer-most holes receive bolts

---

c. The center hole is used to attach the Bottle Collar Sub-assembly in the next steps

---

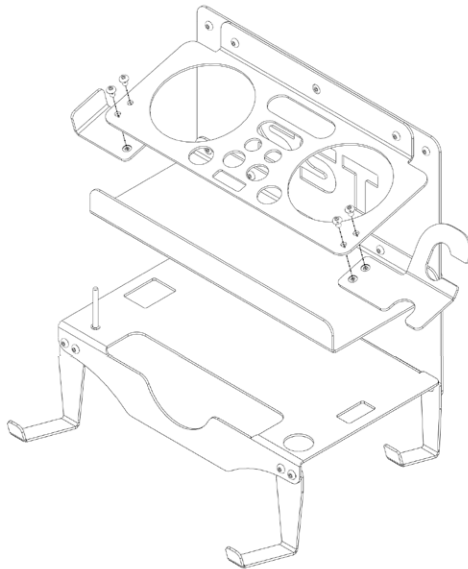

### 7. Attach the Large Hook and Torch Holder to the Accessories Shelf

---

a. Each uses 2pcs M4 bolts

---

b. Take care to align them properly before tightening - they should be straight and square with the accessories shelf

---

### 8. Set Organizer aside as we move on to assembling the bottle collar.

---

## Assembly

### Bottle Collar Sub-assembly

---

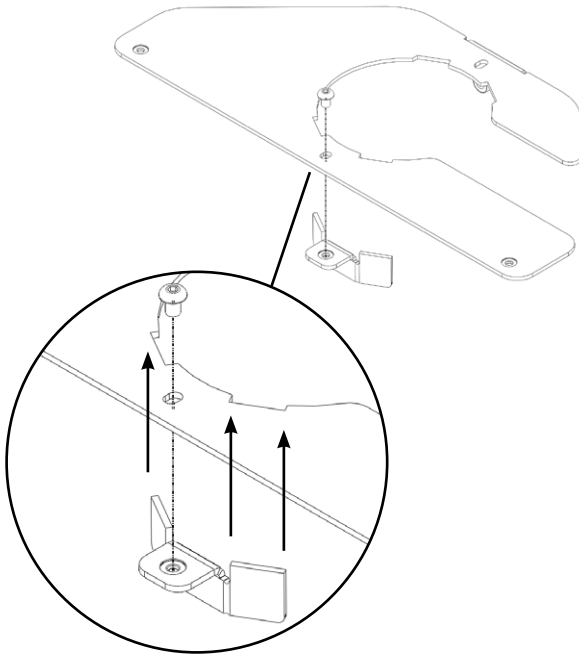

#### 9. Connect the Stationary Clamp Pad to the Bottle Collar

---

- a. Use 1pcs M4 bolt
  - b. CHECK that the Clamp Pad aligns with the cut-outs on the Bottle Collar
- 

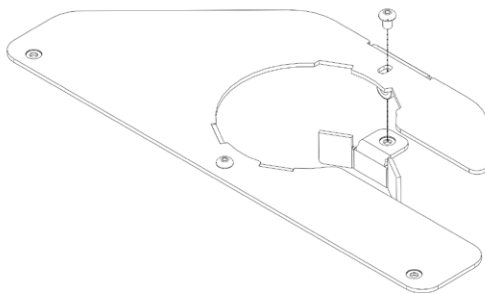

#### 10. Connect the Sliding Clamp Pad to the Bottle Collar

---

- a. Use 1pcs M4 bolt
  - b. CHECK that the Clamp Pad aligns with the cut-outs on the Bottle Collar
  - c. Lightly tighten, but allow some slack so the pad can slide under the Tightening Knob
-

## Assembly

### Bottle Collar Sub-assembly

---

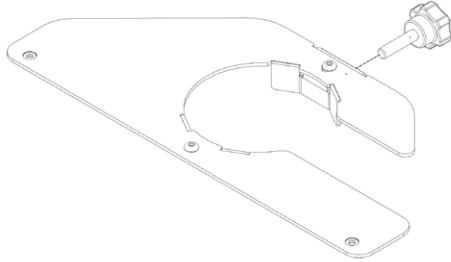

#### 11. Thread the Tightening Knob onto the Bottle Collar

---

- Test to see that the Sliding Collar Pad moves along with the Tightening Knob
- 

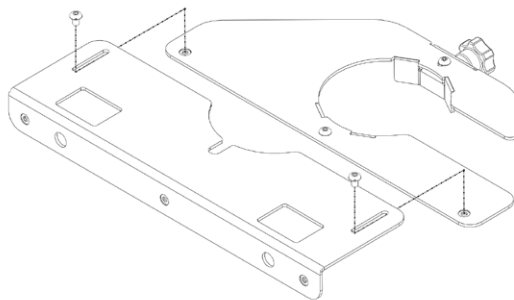
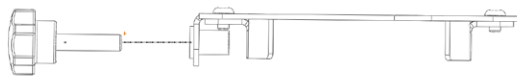

#### 12. Secure the Bottle Collar to the Sliding Assembly Connector

---

- Use 1pcs M4 bolt
  - Lightly tighten, but allow some slack so connector can slide
- 

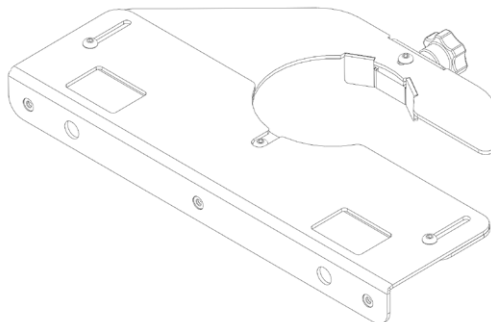

## Assembly

### Bottle Collar Sub-assembly

---

Extended (for larger tanks)

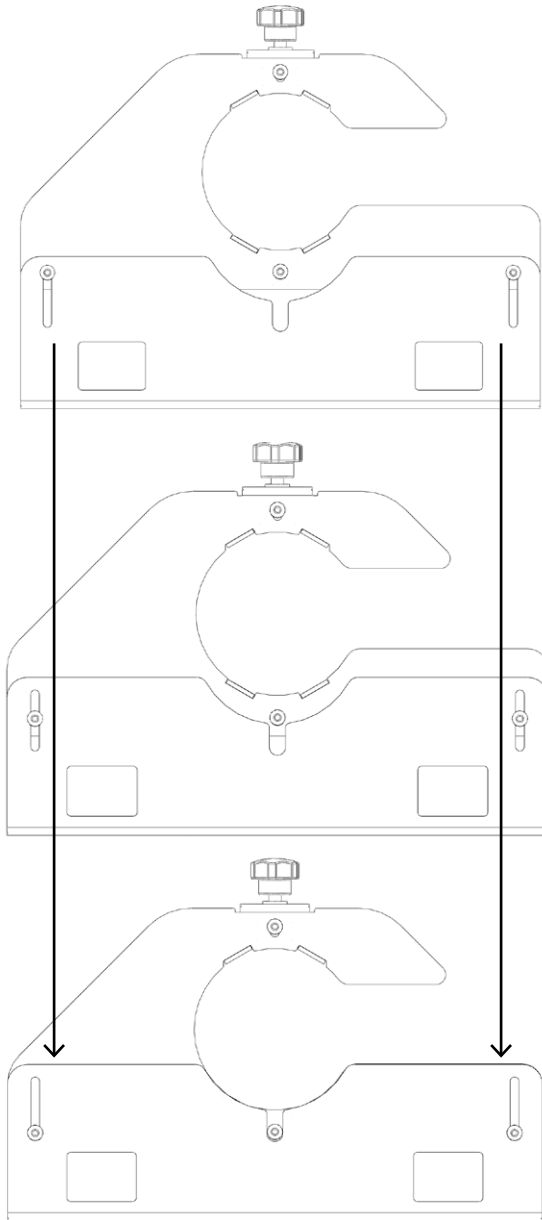

Compressed (for smaller tanks)

#### 13. Check and admire the Bottle Mount Sub-Assembly's ability to slide

---

- a. Once you mount the unit to your bottle, and are able to properly extend the assembly to the right length, you can secure the two M4 bolts
-

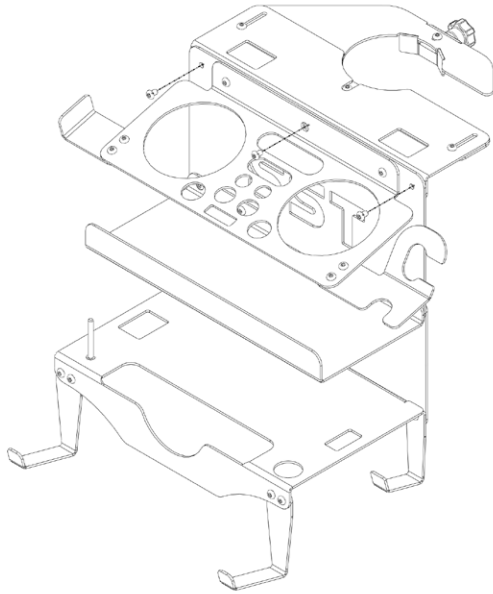

#### 14. Secure the Bottle Collar Sub-assembly to the Back Plate

---

- a. Use 3pcs M4 bolts
  - b. The bolts are used on the 2x outer-most holes, as well as the center hole
- 

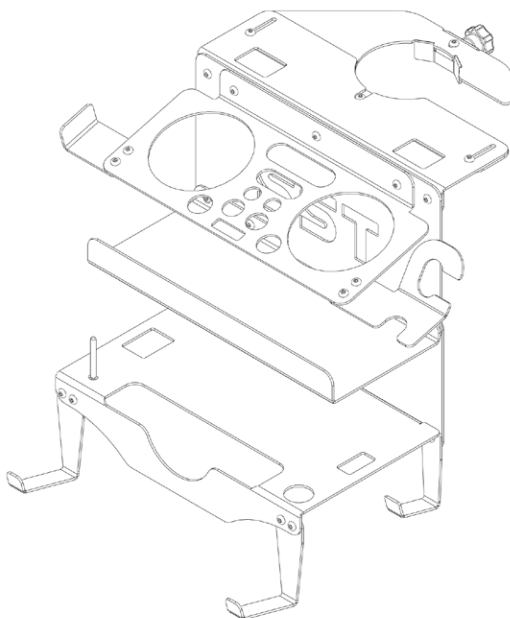

#### 15. Admire your new Bottle Mount and Get to Organizing!

---

**Technical Specifications**  
SST019 Welding Bottle Organizer Details

---

**Standard / Angle Grinder Shelf**

|                                       |                    |
|---------------------------------------|--------------------|
| Unit Weight                           | 3.8 kg             |
| Unit Dimensions                       | 300 x 270 x 155mm  |
| Frame Material                        | Cold Rolled Steel  |
| Frame Coating                         | Red Wrinkle Powder |
| Welding Bottle Neck Size              | 3.00-3.25"         |
| Welding Bottle Diameter Compatibility | 6.75-9.25"         |



**WARNING**

Read all safety warnings and all instructions. Failure to follow the warnings and instructions may result in mechanical failure, damage to your bins, and/or serious injury.

**SAVE ALL WARNINGS AND INSTRUCTIONS FOR FUTURE REFERENCE**

## 1. Work Area Safety

- a. Keep the work area clean, well-organized, and properly lit. A cluttered or poorly lit environment increases the risk of accidents.
- b. Ensure the assembly area is free from tripping hazards and other obstructions that could interfere with safe assembly or tool use.
- c. Maintain a safe distance between children, pets, and bystanders during assembly or use. Distractions can cause loss of control, leading to injury or damage.
- d. Welding bottles should ALWAYS be secured to avoid tip over; which may be likely to occur during installation and removal of the welding bottle organizer
- e. Ensure the wall surface where the welding bottle organizer is installed is structurally sound and free of obstructions. Inadequate wall support can lead to product detachment and potential injury.
- f. When using screws, verify they are properly anchored into studs or concrete walls for maximum strength. Avoid mounting on drywall alone.
- g. Make sure the mounting surface is dry and free of grease or dust before installation.

## 2. Personal Safety

- a. Stay alert, watch what you are doing, and use common sense when using any tools. Do not use power tools or the organizer while you are tired or under the influence of drugs, alcohol, or medication. A moment of inattention while operating power tools may result in serious personal injury.
- b. Always use appropriate personal protective equipment (PPE) such as gloves, safety glasses, and closed-toe shoes while assembling the organizer or using tools to minimize the risk of injury.
- c. Ensure all screws are properly tightened during assembly and periodically checked. Loose fasteners may lead to organizer instability or failure.

## 3. Use & Care

- d. Install the power tool organizer in a secure location, out of reach of children and pets. Avoid placing the organizer in high-traffic areas where it could be bumped or knocked over. Ensure that only individuals familiar with the organizer and its usage instructions handle or adjust it.
- e. Only mount welding tools and accessories to the organizer after verifying its stability and load capacity. Overloading any shelf or hook may cause failure.
- f. Periodically inspect the welding bottle organizer for any signs of wear, damage, or instability. Tighten any loose fasteners and ensure that the caster wheels (if installed) remain securely locked when the organizer is stationary.
- g. The organizer should only be mounted or moved when it is completely unloaded. No power tools or accessories should be installed during mounting or relocation. If using the magnet kit, ensure the magnets are firmly seated and periodically check for slippage or weakening.
- h. Periodically check for signs of corrosion or damage to the metal components, especially if the organizer is used in a high-humidity environment.

## Assumption of Liability

The STUPID SIMPLE TOOLS® Welding Bottle Organizer Organizer is designed for safe use when assembled according to the provided instructions and safety guidelines. Constructed from laser cut steel plate and capable of supporting power tools and accessories, it is intended for use in industrial environments. Users must ensure that tools and accessories are securely placed in the organizer and that the organizer is correctly installed on a stable surface. Improper assembly / mounting, use on uneven surfaces, or failure to properly secure the tools can lead to tipping, falling, or accidental dislodging of the organizer or its contents, which may cause damage to property or harm to individuals, pets, or small children.

By assembling and/or using the Welding Bottle Organizer, you acknowledge and accept responsibility for all associated risks, including but not limited to potential tipping, falling, or accidental dislodging, and agree that STUPID SIMPLE TOOLS® is not liable for any damage, injury, or other consequences arising from misuse or improper assembly of the product.

## **Limited Warranty, Limitations of Warranty and Disclaimer of Liability**

### **LIMITED PRODUCT WARRANTY**

STUPID SIMPLE TOOLS™ warrants that the Welding Bottle Organizer (the “Product”) will, at the time of purchase by the first retail purchaser (“End User”), comply with the product specifications (the “Specifications”) published by Stupid Simple Designs, LLC (“SST” or the “Company”). This warranty is made only to the End User and is not assignable.

### **PRODUCT WARRANTY DISCLAIMER. LIMITATION OF DAMAGES.**

TO THE EXTENT PERMITTED BY LAW AND EXCEPT FOR THE EXPRESS LIMITED PRODUCT WARRANTY SET FORTH IN THIS AGREEMENT, SST MAKES NO (AND EXPRESSLY DISCLAIMS ALL) WARRANTIES, EXPRESS, IMPLIED OR STATUTORY, WITH RESPECT TO THE PRODUCTS SUPPLIED UNDER THIS AGREEMENT, INCLUDING WITHOUT LIMITATION ANY IMPLIED WARRANTY OF MERCHANTABILITY, FITNESS FOR A PARTICULAR PURPOSE, NONINFRINGEMENT, OR ARISING FROM COURSE OF PERFORMANCE, DEALING, USAGE OR TRADE. WITHOUT LIMITING THE GENERALITY OF THE FOREGOING, SST MAKES NO CLAIM, REPRESENTATION, OR WARRANTY OF ANY KIND AS TO THE UTILITY OF THE PRODUCTS FOR THE END USER'S INTENDED USES.

### **REMEDY FOR BREACH OF WARRANTY AND LIMITATION OF DAMAGES.**

If notified in writing of a valid warranty claim within three months of the date of purchase by the End User, SST will, at its option, (i) correct the non-conforming Product so that it materially complies with the Specifications; (ii) provide a replacement Product; or (iii) terminate the Agreement and refund the purchase price paid for the Product. SST shall not be obligated to correct, cure, or otherwise remedy any nonconformity or defect in the Product if the End User has made any changes whatsoever to the Product, if the Product has been misused or damaged in any respect, or if the End User has not reported to SST the existence and nature of such nonconformity or defect promptly upon discovery thereof. IN NO EVENT SHALL SST BE LIABLE FOR ANY PUNITIVE, RELIANCE, INDIRECT, SPECIAL, INCIDENTAL OR CONSEQUENTIAL DAMAGES (INCLUDING LOST REVENUE, LOST PROFITS, OR LOST SAVINGS) IN EXCESS OF THE PURCHASE PRICE OF THE PRODUCT, HOWEVER CAUSED AND UNDER ANY THEORY, EVEN IF IT HAS NOTICE OF THE POSSIBILITY OF SUCH DAMAGES. This section states SST's entire liability and the End User's sole and exclusive remedy for breach of warranty.

# SST

## Thank you for your purchase!

If you have any issues, please contact us at  
our email below.

CONTACT

**SUPPORT @ STUPID SIMPLE . TOOLS**

CHECK OUT OUR OTHER TOOLS!

**WWW . STUPID SIMPLE . TOOLS**

