

# ISMOD

## NANO

### User Guide

English

#### 1. SAFETY WARNING & INSTRUCTIONS

- When shipping this device, make sure that it is always powered down
- This device is not suitable for: people under the age of 18 years; This tobacco product damages your health and is addictive.
- Keep this device and its components out of reach of children and pets.
- Keep this device in room temperature. Do not expose the device to excessive heat or humidity.
- Do not immerse any part or component of the device in water.
- Do not use this device where flammable substances, liquids, gases, or oxygen are present.
- Do not use this device during charging.
- Do not use a charging device that does not meet the requirements for charging.
- Before cleaning, opening, or making direct contact with the internal heating components, you must ensure that the device main body has cooled down.
- Please use and keep the device at an ambient temperature of 5 ~ 40 °C. A lower or higher temperature environment may temporarily reduce battery life or cause damage to the device.
- If you notice any abnormal situation such as odor or smoke, please stop charging and using immediately, and contact your service provider.
- If the battery leaks from the product, please avoid contact with the skin and eyes. If you accidentally touch it, wash affected areas with clean water immediately and consult a doctor immediately.
- The precautions contained in the user guide cannot cover all possible situations.

Please read and understand this manual carefully before using this product.



English 01

#### 2. OVERVIEW

ISMOD NANO Tobacco heating device with Large capacity Lithium battery, smart & modular design, easy to carry and use.

#### 3. STRUCTURE

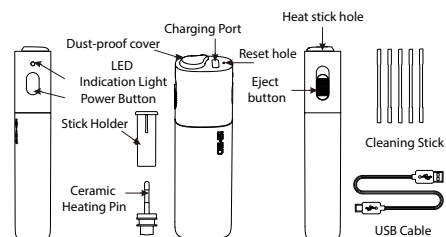

#### 4. SPECIFICATIONS

Model	ISMOD NANO
Battery Capacity	1500mAh, 3.7V
Charger Time	Approx. 1.5 Hours
Charger Method	USB Charger Port: Type C; Charger Setting: 5V/1A
Pre-heat Duration	15 Seconds
Working Duration	15 puff or 300 seconds
Working Environment Temperature	5 ~ 40 °C
Product Size	27mm (L) X 17mm(W) X 90mm(H)
Product Weight	51 grams
Capacity at full charge	≈ 20 heat sticks

English 02

#### 5. OPERATIONAL INSTRUCTIONS

##### 1. PREPARE

Rotate the dust-proof cover

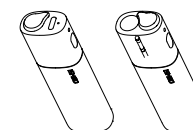

##### 2. INSERTING TOBACCO STICK

Insert the tobacco stick into the chamber upright, leaving the filter out.

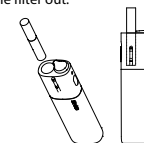

##### 3. HEAT

Press and hold the button for 1.5 seconds until the LED light blinks blue and the device will vibrate.



The Led Light will indicate the heating mode as shown below

The device starts pre-heating for 15 seconds until the LED light turns solid blue color and 2nd vibration happens, you can now start to enjoy smoking for 4 minutes 45 seconds. When the smoking time comes to the last 30 seconds or reaches 13th puff, the device will vibrate warning you of the remaining time or puffs, while LED light starts blinks which indicates that the device will switch off. When the whole smoking time is finished or after 15th puff, then the device will vibrate and the device will switch off.

##### 4. REMOVING THE TOBACCO STICK

- Slide the eject button up to push out the stick
- Remove the tobacco stick and rotate the dust-proof cover.

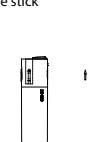

English 03

#### Temperature Adjustment (TA) Mode:

LED light color Indication as following:

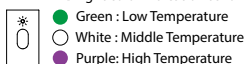

To start the TA mode, click the button once and then 5 times quickly. The LED light will blink green, white and purple alternatively. When the LED light stops blinking, click the button to change the temperature heating mode.

Press and hold the power button to confirm the heating mode or wait for 10 seconds to quit the TA mode.

#### 5. CLEANING THE HEATING CHAMBER

Make sure the device is switched off and cooled down before attempting to clean it.

- Separate the top cover from the main body.
- Pull out the heating pin from the main body.

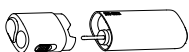

- Eject the stick holder through the slide button and pull it out.

- Take out the parts (stick holder & heating pin), then use a cleaning stick to clean all parts carefully.

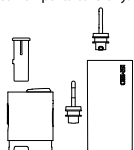

English 04

#### 6. CHARGING YOUR DEVICE

Connect the USB cable with the adaptor for charging. The LED light will blink different colors to indicate the battery power. LED light will show a solid blue light when the device is fully charged.

- Blue : 100%-60%
- Yellow : 60%-10%
- Red : 10%-0%

#### 6. OPERATIONAL INSTRUCTIONS

##### 1. REMAINING POWER INDICATION

How to check the remaining battery capacity? Click the Heating Button to activate the LED light once when device is off. The LED light will indicate the leftover battery capacity.

LED light color Indication as following:

- Blue : 100%-60%
- Yellow : 60%-10%
- Red : 10%-0%

##### 2. QUICK SHUTDOWN

Press and hold the power button for 1.5 seconds after vibration.

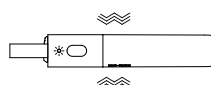

##### 3. RESET

In case of abnormal indicator light or other malfunction, use a pin to insert the top reset hole of the device for reset.

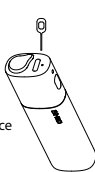

English 05

#### 7. TROUBLESHOOTING

Problem	Troubleshoot	Possible solution
Can't insert the tobacco stick into the heating chamber.	Check if tobacco residue from previous tobacco stick is stuck in the heating chamber.	Clean the heating chamber.
Can't insert the tobacco stick into the heating chamber.	Check if the slot between the tobacco stick holder and the heating chamber is aligned and fastened properly.	Clean the heating chamber.
The Cap can't close and clip properly	Check alignment between the cap and device, make the tobacco stick hole is in the same position.	Adjust the direction of buckling
Can't start the device	Check the leftover power	Charge the device until the charge is complete
	Not used for a long time?	deplete power fully, then recharge fully
	Button damaged?	Send it to the local service center.
	Indicator light damaged?	Send it to the local service center.
Blinking red light for 5 seconds	The leftover battery capacity is low	Charge the device at once.
Solid red light and gap vibration for 3 seconds	Check heating pin	Change heating pin.

#### 8. GENERAL INFORMATION

Manufacturer: Dongguan Mismok Electronic Technology Co., Ltd  
Distributor: ISMOD UK LTD

For all warranty information or to register your device, please visit <https://www.ismodeurope.com> - <https://www.ismod.co.uk>

English 06

#### 9. DISCLAIMERS

- The ISMOD NANO is battery powered. It needs to get recharged when the battery is low. Do not put the ISMOD NANO near the high-temperature environment or heater to avoid battery damage.
- Read all the instructions carefully before you use the ISMOD NANO. Keep the User Guide for future reference. When using the ISMOD NANO, follow the manufacturer's instructions to avoid the possibility of injuries. The warnings and safety instructions in this User Guide cannot include all the possibilities and situations that may occur. Be cautious when you use or maintain any personal electronic product.
- Only use compatible tobacco heat sticks.
- ISMOD NANO contains lithium batteries, for their disposal, please follow the requirement of your local authority.

##### ☆ LITHIUM BATTERY

- If the product is kept at a high temperature for a long time, the degradation of the lithium battery will happen.
- The battery will discharge when it is stored for a long time without operation. Please recharge the device before using it.
- When you do not use the device for a long time, avoid storing the device in fully-charged status or under high temperature / humidity condition in order to avoid accelerated deterioration of the battery.
- Please do not put the battery into a fire to prevent the danger of explosion.

English 07