



User Manual



Before We Get Started,
Let Me Introduce Myself!

Table of Contents

○ 1.0	Important Safeguards	5	○ 10.0	Side Menu Functions	28
1.1	For Your Safety	5	10.1	Managing the Cook History	29
1.2	Safety Alert Symbols and Signal Words	5	10.2	Tutorials	29
1.3	Signal Words	5	○ 11.0	Settings	30
○ 2.0	Intended Use	8	11.1	Logging In/Out of Your MyCooking Account	30
○ 3.0	Appliance Description	9	11.2	Changing the Password of Your MyCooking Account	31
○ 4.0	LED & Button Guidelines	12	11.3	Adjusting the Brightness	31
○ 5.0	Choosing the Setup Location	14	11.4	Adjusting the Volume	31
○ 6.0	Before First Use	16	11.5	Connecting to a Wi-Fi Network	32
6.1	Hub Initial Setup	17	11.6	Managing Appliances	32
○ 7.0	Assembling the Mixing Bowl	20	11.7	Tablet Storage Management	33
○ 8.0	Use of Accessories	22	11.8	Checking for the Most Updated Software	33
8.1	Butterfly Whisk	22	11.9	Viewing Favorite Recipes	34
8.2	Simmering Basket	23	11.10	Checking Notifications	34
8.3	Steamer	25			
○ 9.0	Operation	26			
9.1	Switching the Main Unit On/Off	26			
9.2	Charging the Hub	26			
9.3	Switching the Hub On/Off	27			

○ 12.0	Cooking Modes	35	○ 18.0	FCC – Supplier's Declaration of Conformity	53
12.1	Knead	35	18.1	FCC Compliance Statement	53
12.2	Steam	36	18.2	FCC Interference Statement	54
12.3	Sauté	37	○ 19.0	Trademarks	55
12.4	Scale	37	○ 20.0	Specifications	56
12.5	Keep Warm	38	20.1	Main Unit	56
12.6	Manual	39	20.2	Smart Kitchen Hub	56
○ 13.0	Guided Cooking	40	○ 21.0	Disposal	57
13.1	Turbo Function	42	○ 22.0	Help and Support	58
○ 14.0	Cleaning for the First Time	43			
○ 15.0	Cleaning & Maintenance	44			
15.1	Cleaning the Main Unit, Hub & Cables ..	44			
15.2	Clean Mode	45			
15.3	Cleaning the Accessories	47			
15.4	Cleaning the Blade, Lid & Steamer Seals	47			
15.5	Storage	48			
15.6	Maintenance	48			
○ 16.0	Troubleshooting	49			
○ 17.0	Grounding Instructions	52			

1.0 IMPORTANT SAFEGUARDS

1.1 For Your Safety

Safety is an essential part of every CookingPal® product. However, the product safety of the CookingPal® Multo™ can only be ensured if this chapter and the warning notices in the following chapters are followed.

1.2 Safety Alert Symbols and Signal Words



This is a safety alert symbol. It is used to warn of potential risks of injury.

Comply with all safety instructions following the symbol to avoid potential hazards that can cause injury or death.

1.3 Signal Words

Be aware of the signal words **WARNING** and **NOTICE** as they relate to safety notes. These are the signal words for the respective safety notes:

WARNING

Indicates a hazardous situation which, if not avoided, could result in death or serious injury.

NOTICE

Used to address best practices to avoid damage to your Multo™, its accessories and potential injury.



Read these instructions and the accompanying Safety Guide and Warranty carefully and retain them for future use. If this appliance is passed to a third party, then these instructions and the accompanying Safety Guide and Warranty must be included.

When using electrical appliances, basic safety precautions should always be followed to reduce the risk of fire, electric shock, and/or injury to persons including the following:

- Read all instructions and warnings.
- To protect against risk of electrical shock do not put in water or other liquid.
- The appliance should not be used by children or persons with impaired or reduced physical, sensory or mental capabilities, or any person with a lack of experience or knowledge in using potentially dangerous cooking appliances, unless they are instructed or supervised in the use of the appliance by a person responsible for their safety.
- Children must be closely supervised when the appliance is being used by or near them.
- Turn the appliance OFF, then unplug from the electricity outlet when not in use, before assembling or disassembling parts and before cleaning. To disconnect the appliance from its power source unplug it from the wall outlet. Never pull from the power cord.
- Make sure appliance is disconnected from its electricity source when not in use, before putting on or taking off parts, and before cleaning.
- Avoid contacting moving parts.
- Do not operate any appliance with a damaged cord or plug or after the appliance malfunctions, or is dropped or damaged in any manner. Contact the manufacturer at their customer service telephone number (866)548-3092 for information on examination, repair, or adjustment.
- The use of accessories not recommended or sold by manufacturer may cause a risk of injury to persons.
- Do not use outdoors.
- Do not touch hot surfaces. Use handles or knobs.

- Keep hands and utensils out of container while blending to reduce the risk of severe injury to persons or damage to the blender. A scraper may be used but must be used only when the blender is not running.
- Blades are sharp. Handle carefully.
- Your Multo™ blade can get very hot after prolonged use, even if you have not been using the heating function. Use caution when touching or removing the blade after use and allow it to cool completely before touching or removing it.
- Always operate the appliance with measuring cup and cover securely locked in place.
- Allow to cool before assembling or disassembling parts and before cleaning the appliance.
- Do not let cord hang over edge of table or counter, or touch hot surfaces.
- Do not place on or near a hot gas or electric burner, or in a heated oven.
- To protect against fire, electric shock and injury to persons do not immerse cord, plugs in water or other liquid.

SAVE THESE INSTRUCTIONS

- Read and understand the Multo™ User Manual & Safety Guide and Limited Warranty completely before operating your new Multo™.
- For the latest version of the User Manual and Safety Guide & Limited Warranty, please refer to our website, www.cookingpal.com.
- Do not use appliance for other than intended use.

2.0 Intended Use

- This appliance is intended to:



Cook



Weigh



Boil



Mix



Steam



Knead



Whisk



Grind



Emulsify



Chop



Grate



Sauté

- This appliance is intended for household use only. It is not intended for commercial use.
- This appliance is intended to be used in dry indoor areas only.
- No liability will be accepted for damages resulting from improper use or non-compliance with these instructions and instructions on the Hub.
- Please fully read the Multo™ Safety Guide and Limited Warranty.

3.0 Appliance Description

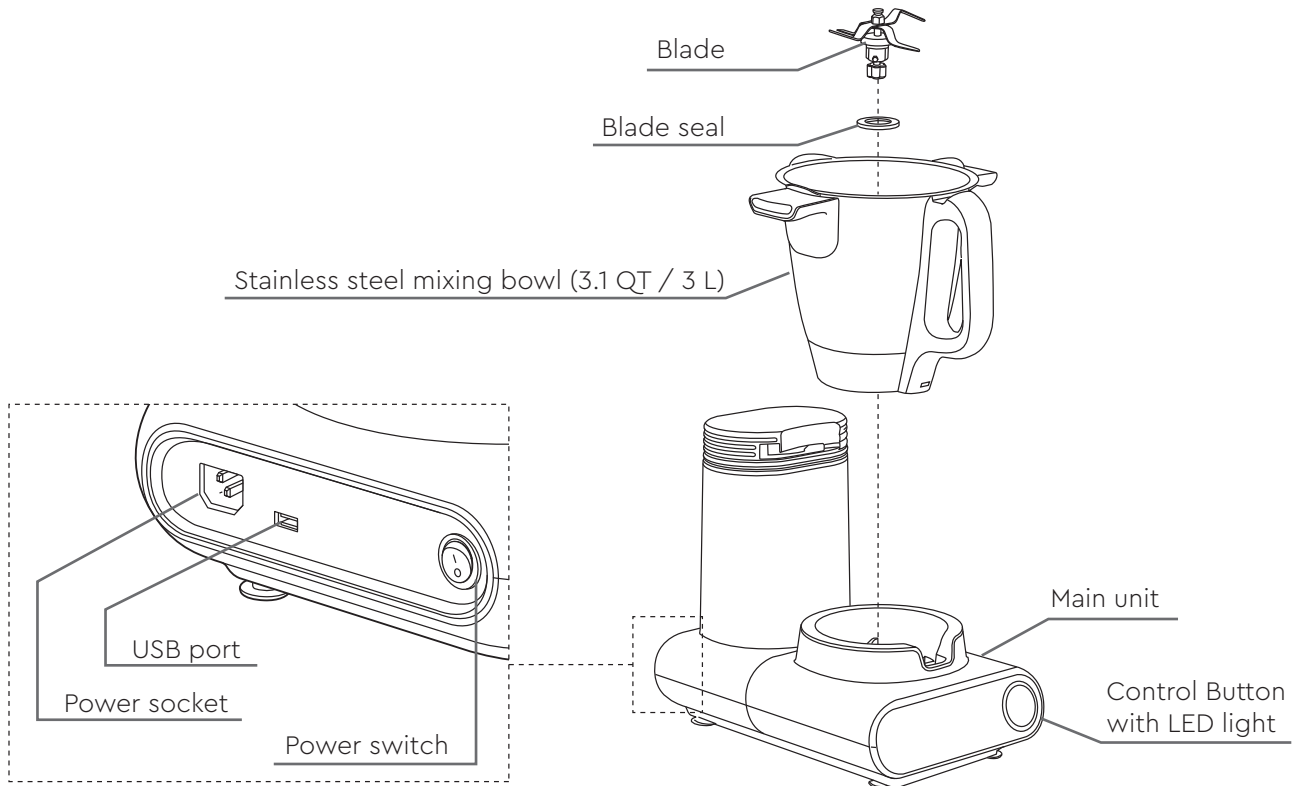

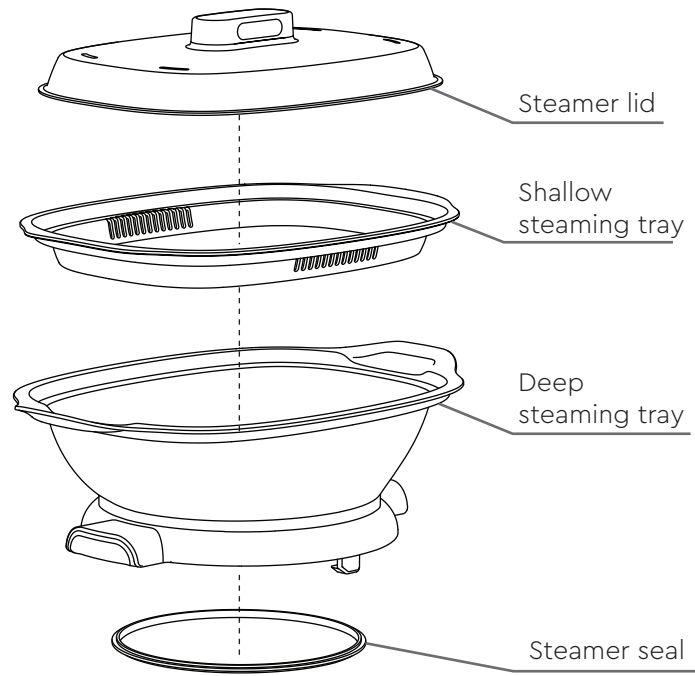
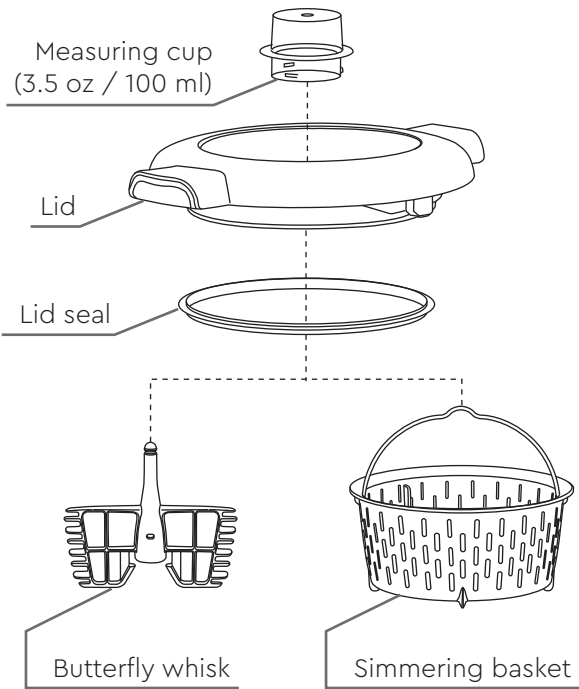

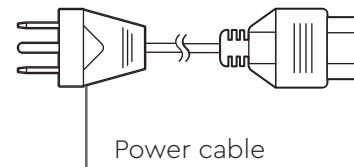
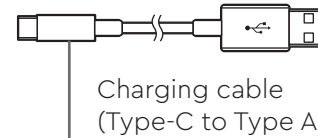
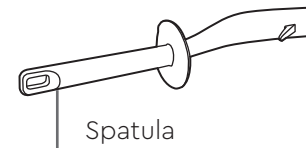
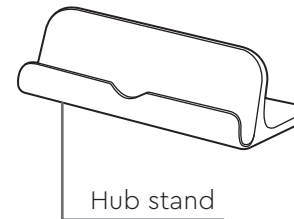
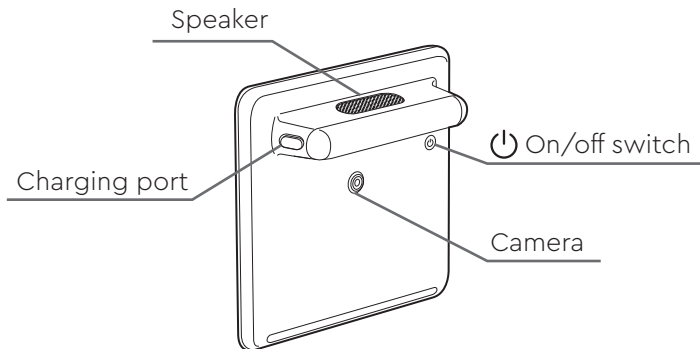
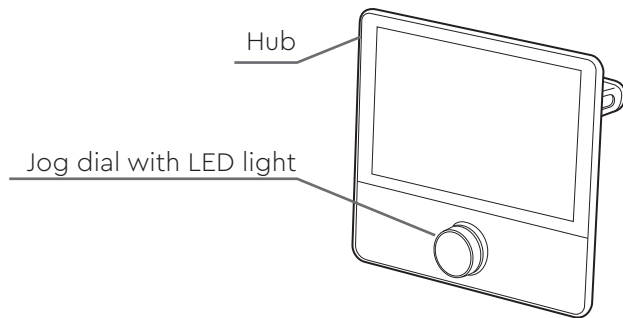

4.0 LED & Control Button Guidelines



Standby

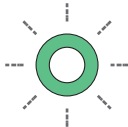

Turbo Unlocked



Bluetooth Pairing



Turbo in Use



Cooking in Progress



Lid Open / Bowl Not Secured

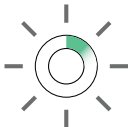

Cooking Paused



Overheat

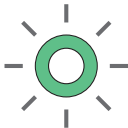

Cooking Done

Push

- Pause cooking
- Resume cooking

Press and hold when turbo unlocks

- Turbo function

Long press for 5 seconds

- Enter Bluetooth pairing function

Remove the mixing bowl. Press and hold for 10 seconds

- Reset to factory settings

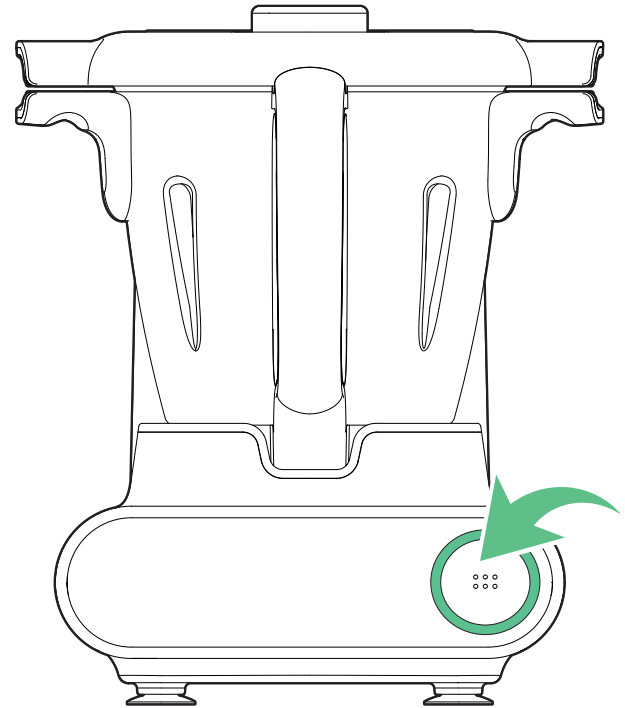

5.0 Choosing the Setup Location

Please refer to our Safety Guide for more details on the safe use of the Multo. When choosing where to place your appliance for use, please keep in mind the following:

⚠️ WARNING Fire Hazard

If the main unit is placed on a hot surface, it may start to catch fire.

- Do not place the main unit on a stovetop (conventional, ceramic glass, induction or other cooktop) or on any other heated surface.
- Keep CookingPal® Multo™ away from hot surfaces.
- Ensure that the power cord does not touch hot surfaces, external heat sources or sharp objects.

⚠️ WARNING Risk of Electric Shock

An incorrectly installed power connection may cause an electric shock.

- Only connect the appliance to an electric outlet installed by a qualified specialist.

⚠️ WARNING Scalding Risk

Serious burns from hot liquids and steam may result from CookingPal® Multo™ being pulled off a countertop. Do not allow the cord to hang over the edge of the counter when it may be grabbed by children or become entangled with the user.

- Do not use the CookingPal® Multo™ with an extension cord.
- Do not drape the power cord over the edge of the counter.
- Do not connect the power cord to outlets below counter height.

⚠️ WARNING Injury Risk

The process of kneading dough or chopping food may cause the CookingPal® Multo™ to move or slide over the counter. The CookingPal® Multo™ could fall over and cause injury.

- Place the main unit on a clean, solid, and flat horizontal surface.
- Ensure that there is sufficient distance between the appliance and the edge of the work surface.

- Never leave the CookingPal® Multo™ unattended while it is running.

-

NOTICE Damage Risk

If the main unit is connected to an unsuitable power supply, it will get damaged.

- Only operate the CookingPal® Multo™ with the alternating current voltage of 114–126 V and main frequency of 50 to 60 Hz, as indicated on the plug label.

NOTICE Damage Risk

Never place CookingPal® Multo™ directly under furniture and fittings (shelving units, wall units or similar), while in use. Doing so may result in property damage.

- Ensure that there is sufficient clearance above and around the CookingPal® Multo™, taking into account the additional height when using the steaming tray and lid.

1. Always place the CookingPal® Multo™ on clean, solid, and flat horizontal surface so that it cannot slip.
2. Ensure that the ventilation opening on the back of the appliance is kept clean (free of grease splashes, etc.).
3. Remove the protective foil from the Smart Kitchen Hub.
4. Do not use the CookingPal® Multo™ with an extension cord.
5. Do not place the main unit on top of the power cord. If you do, it will not rest evenly on the surface.

6.0 Before First Use

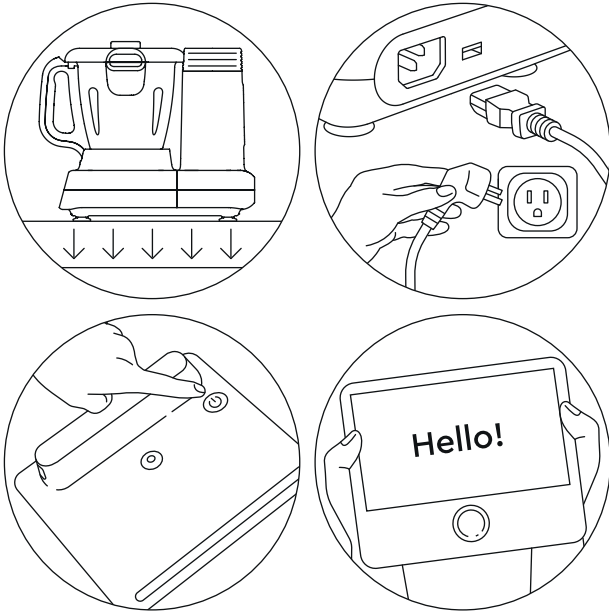

⚠ WARNING Risk of suffocation

Keep any packaging materials away from children – these materials are a potential source of danger, e.g. suffocation.

1. Remove all the packing materials.
2. Check the appliance for transport damages.
3. Clean the appliance and all the accessories following the "Cleaning & Maintenance" section.

NOTICE Before connecting the appliance to the power supply, check that the power supply voltage and current rating corresponds with the power supply details shown on the appliance rating label.

4. Plug in and switch on the main unit following the "Switching the Main Unit On/Off" chapter.
5. Charge the Hub for the first time following the "Charging the Hub" chapter. Charge for at least 3 hours to ensure that the battery is full.

6.1 Hub Initial Setup

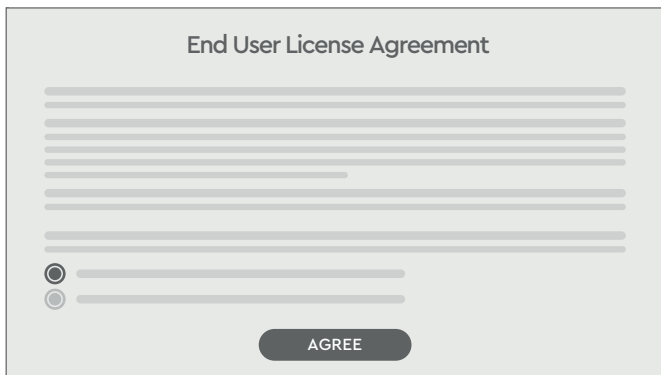

1. Press and hold the  switch to switch on the Hub.
2. Tap "Start".

3. Scroll down to read the "End User License Agreement". When you have read, understood and agreed to the "End User License Agreement", tap "Agree" to continue the setup.

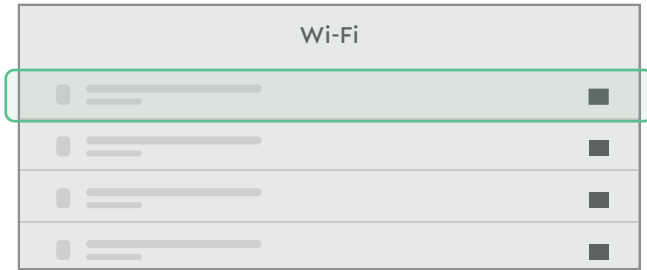

4. Connect the Hub to a Wi-Fi network. Select the desired network.

Input your Wi-Fi network password, then tap "Join".

NOTICE For detailed Wi-Fi setup, follow the "Connecting to a Wi-Fi Network" chapter.

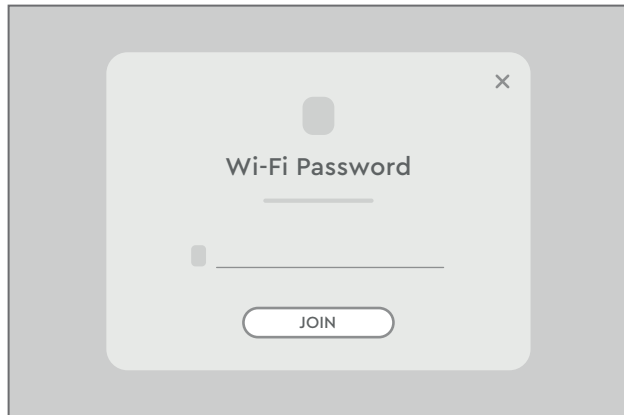

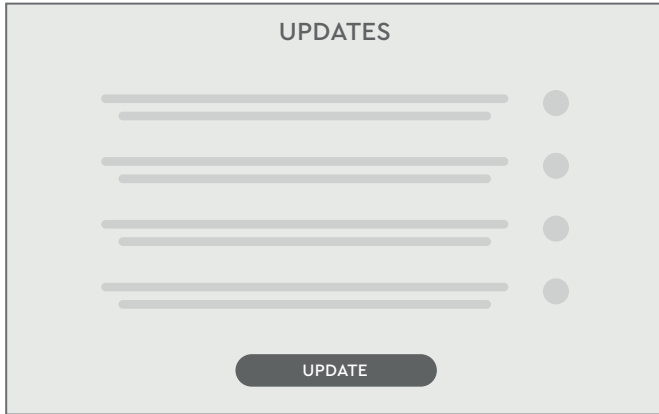

5. If Wi-Fi is connected, the Hub automatically checks if the current software version is updated. If an update is available, tap "Update" to proceed with the update.

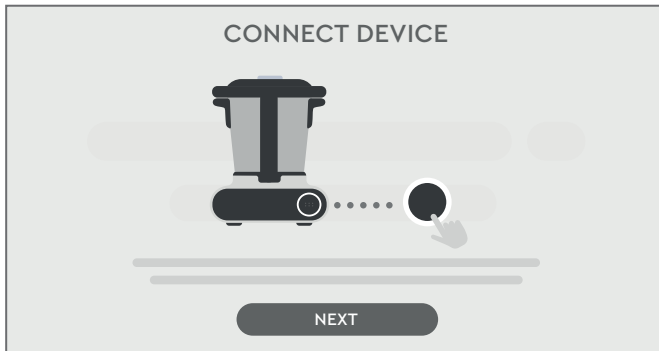

6. Follow the instructions on the display to pair Multo™ to the Hub.

7.0 Assembling the Mixing Bowl

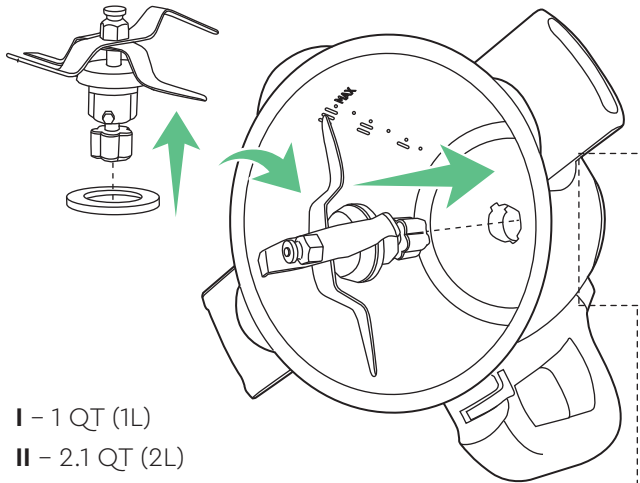

I - 1 QT (1L)

II - 2.1 QT (2L)

III MAX - 3.1 QT (3L) max. capacity

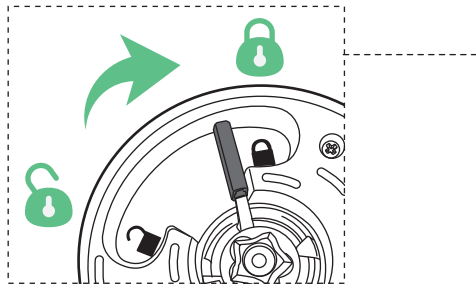

This assembly can be used for the following functions:



Cook



Weigh



Mix



Knead



Grind



Emulsify



Chop



Grate

⚠ WARNING Risk of injury

- The blade is sharp, handle carefully to avoid being cut. Do not turn over the mixing bowl when removing the blade. The blade might fall out abruptly.
- Never hold the blade by the blade edges to avoid injury.

1. Attach the blade seal to the blade of the main unit.
2. Place the blade into the mixing bowl.
3. Lock the parts together using the latch at the bottom of the mixing bowl.

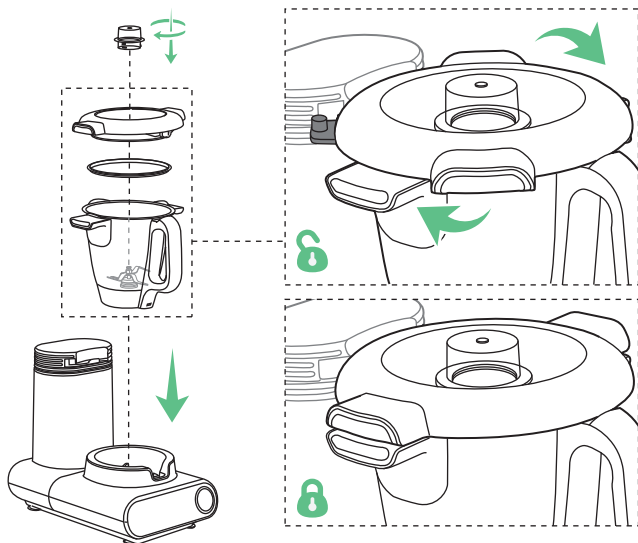

4. Place the assembled mixing bowl on the main unit and ensure the connection points are clean, dry and unobstructed.
5. Place the lid seal inside the lid.
6. Place the lid on, rotate it clockwise until it locks.
7. Place the measuring cup in place, rotate it clockwise until it locks.

⚠ WARNING

- Contents of the mixing bowl can spill out and cause damage and injury if the lid seal is not positioned correctly.
- Do not try to open with force.
- Securely lock the measuring cup when processing hot food to avoid injury.
- Do not operate without the measuring cup locked in place when processing hot contents at a high speed.
- Do not touch or fix the measuring cup when processing hot food to avoid injury.
- Never overload the ingredients or liquids past the **MAX** mark capacity (3.1 QT / 3 L).
- If boiling-over occurs, stop the appliance immediately by carefully removing the plug from the electrical outlet in the wall to avoid the potential of being scalded by any overflowing boil-over.

NOTICE Ensure the blade seal and blade are securely locked.

8.0 Use of Accessories

After assembling the mixing bowl (for boiling, heating, grinding, chopping and grating), different accessories can be added to perform different functions. The possible combinations are:

8.1 Butterfly Whisk

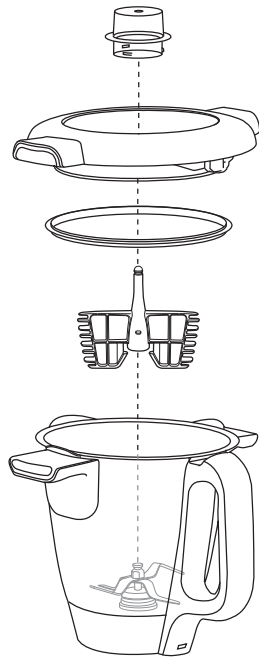

Use the butterfly whisk when you want to:



Whisk

Emulsify

NOTICE The butterfly whisk attachment cannot be used for kneading or at a speed higher than 4.

1. Place the butterfly whisk into the mixing bowl on top of the blade.
2. Place the assembled mixing bowl on the main unit.
3. Close the lid.

8.2 Simmering Basket

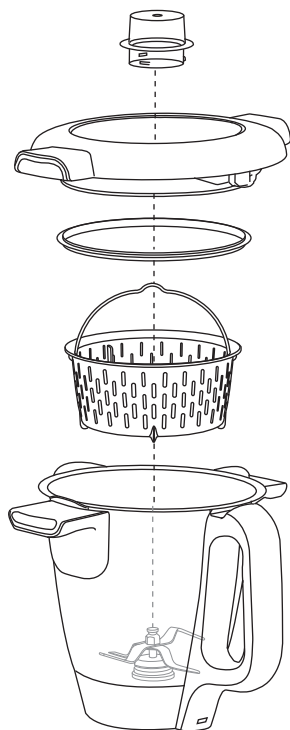

Use the simmering basket when you want to:

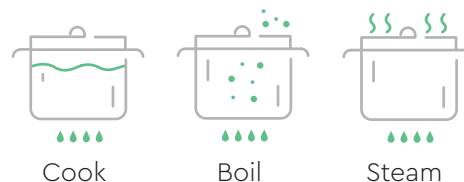

1. After attaching the blade, place the simmering basket into the mixing bowl.
2. Place the assembled mixing bowl on the main unit.
3. Close the lid.

⚠ WARNING After cooking, the handle of the simmering basket will become too hot to pick up with your hands. Use the hook on the side of the spatula to remove the simmering basket (see "Removing the Simmering Basket" chapter).

⚠ WARNING Do not fill the simmering basket past its maximum capacity.

○ Removing the Simmering Basket

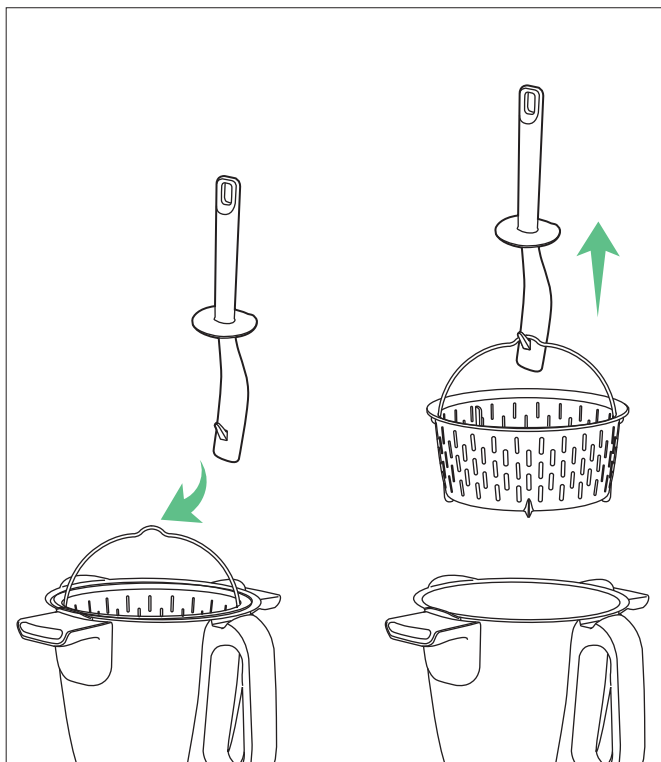

The handle of the simmering basket will become too hot to pick up with your hands.

To remove the simmering basket from the mixing bowl:

1. Use the hook on the side of the spatula to latch onto the handle of the simmering basket.
2. Lift up the simmering basket using the spatula.
3. Let the liquid drain out before placing the simmering basket on a heat-proof mat or surface.

⚠ WARNING

- Other utensils, apart from the supplied spatula, can get caught in the blade and cause injury if they are used to stir food in the mixing bowl when in motion.
- Only use the supplied spatula for stirring.
- Place only the flat end of the spatula in the mixing bowl.

8.3 Steamer

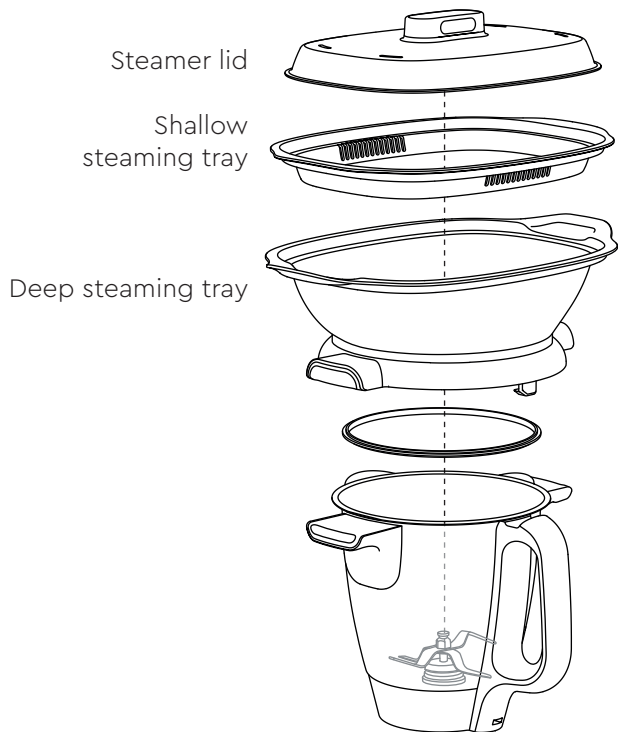

Use the steamer when you want to:



1. After attaching the blade, place the assembled mixing bowl on the main unit.
2. Place the steamer seal on the base of the deep steaming tray.
3. Place the deep steaming tray on, rotate it clockwise to lock.
4. Use the steamer lid to cover the steamer.

⚠ WARNING

- Contents of the mixing bowl can spill out and cause damage and injury if the steamer seal is not positioned correctly.
- To avoid steam burns, do not put any part of your body over or reach over the steam vents in the steamer lid.

9.0 Operation

9.1 Switching the Main Unit On/Off

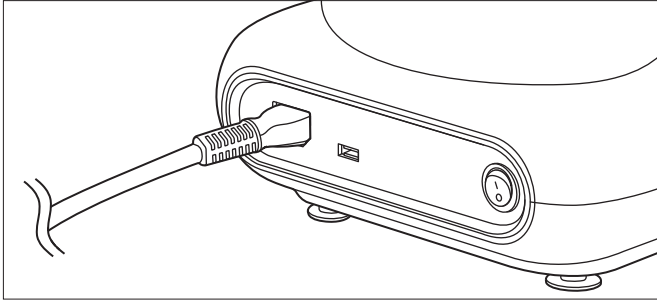

- Connect the power cable to the power socket and then to a suitable electrical wall outlet, ensuring each is dry and clean.
- To switch the main unit on, set the power switch to "I" position.
- To switch off, set the power switch to "O" position.
- After use, switch off, then unplug the appliance from the electrical wall outlet.

9.2 Charging the Hub

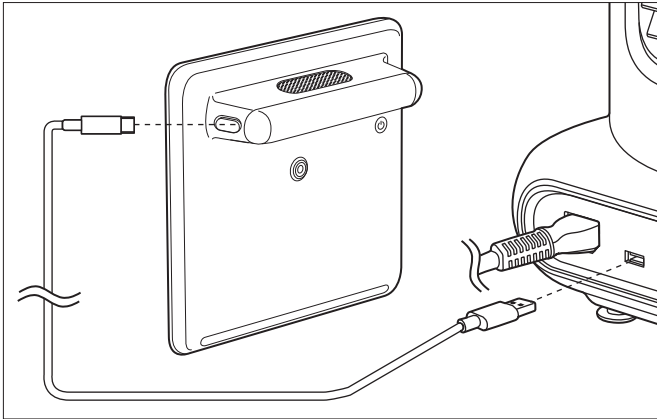

- Open the port cover of the Hub.
- Connect the USB Type-C cable to the charging port and then to the USB port at the back of the Main Unit ensuring each one is dry and clean.
- After charging, unplug the Hub and the charging cable, then close the charging port ensuring it is properly sealed to avoid the entry of food or liquid.

9.3 Switching the Hub On/Off

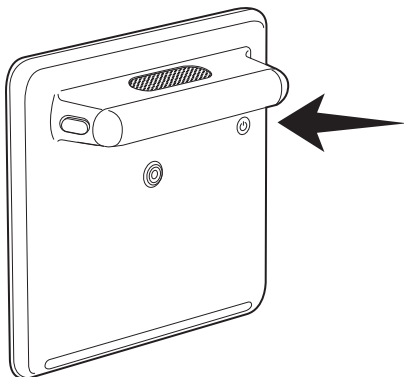

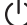
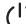
1. Press and hold the  switch to switch on the Hub.
2. To switch off, press and hold the  switch, then press the power off button on the display.

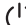
NOTICE After 5 minutes of inactivity, the display enters sleep mode. To wake the display, press the  switch or press the jog dial.

10.0 Side Menu Functions

Tap the ☰ icon on the top right corner of the user interface to access the side menu. Then proceed to tap the function needed.

Cook History – This function keeps track of recently cooked recipes.

Tutorials – This function shows step-by-step videos of how to use the appliance.

Settings – This brings you to the settings menu.

Login/Logout – This allows you to login/logout your account.

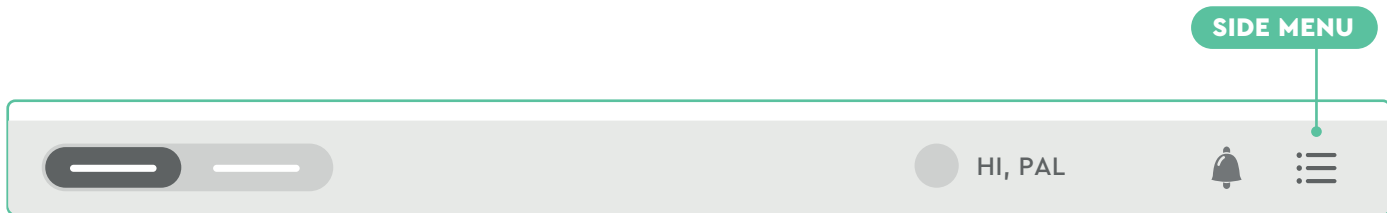

10.1 Managing the Cook History

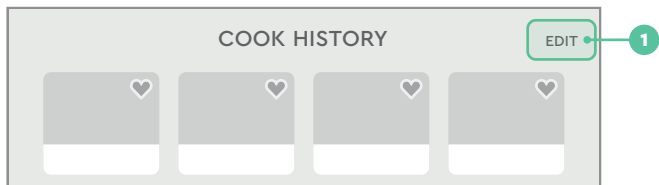

NOTICE If no recipes have been cooked before, the Cook History will be empty.

1. Tap "Cook History".
2. The display shows most recently cooked recipes. Tap "Edit", then select the Cook History you want to delete.

10.2 Tutorials

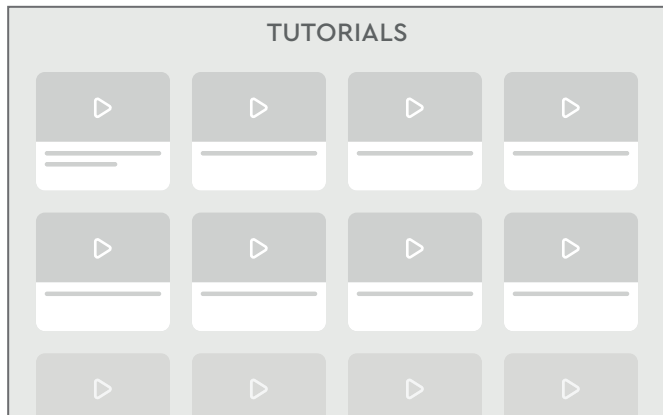

1. Tap "Tutorials".
2. The display shows step-by-step videos of how to use the appliance.

11.0 Settings

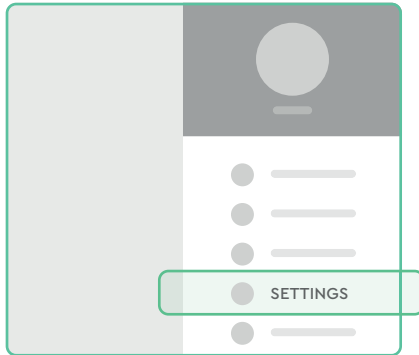

Settings are also kept on the side menu.

1. Tap the ☰ icon on the top right side to access the side menu.
2. Then tap "Settings" to proceed.

11.1 Logging In/Out of Your MyCooking Account



1. Tap "Login".
2. Input your email address and MyCooking Account password or your social media credentials to access your MyCooking Account.
3. To log out, tap the ☰ icon on the top right side to access the side menu, tap "Log out".

11.2 Changing the Password of Your MyCookingPal® Account

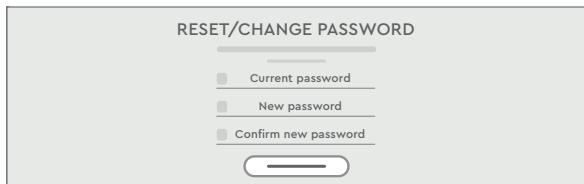

11.3 Adjusting the Brightness

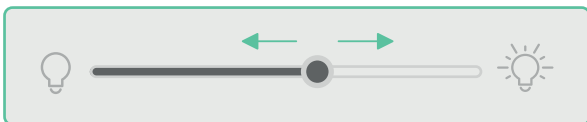

11.4 Adjusting the Volume

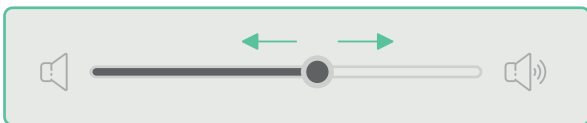

1. To change the password, tap the ☰ icon on the top right side to access the side menu, tap "Settings", then "Account Management".
2. Input your current password, the new password and type in the new password again to confirm the change. Tap "Save" to confirm your changes.

1. Tap "Display & Volume".
2. Slide or rotate the jog dial to adjust the brightness of the display.

NOTICE Please note that you may need to adjust brightness to suit the lighting environment of your premises, however, please note that looking at excessively bright screens can cause eye strain or damage.

1. Tap "Display & Volume".
2. Slide or rotate the jog dial to adjust the brightness of the Hub.

NOTICE Please note that you may need to adjust volume to suit the sound environment of your premises, however, please note that excessive volume can cause hearing damage.

11.5 Connecting to a Wi-Fi Network

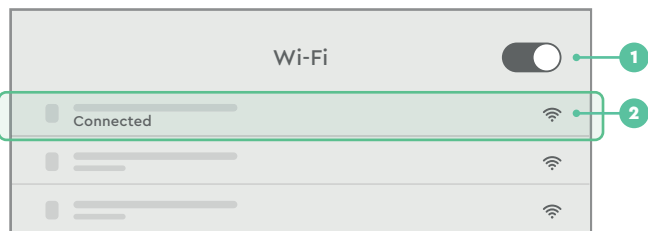

1. Tap "Wi-Fi".
2. Slide the switch of the top right side corner of the user interface from OFF to ON.
3. Select the desired network. Input your Wi-Fi network password, then tap "Join". The Wi-Fi network is connected when the word "Connected" is shown under the network name.

NOTICE To forget a Wi-Fi network, tap and hold the name of the Wi-Fi network, then tap "Confirm".

11.6 Managing Appliances

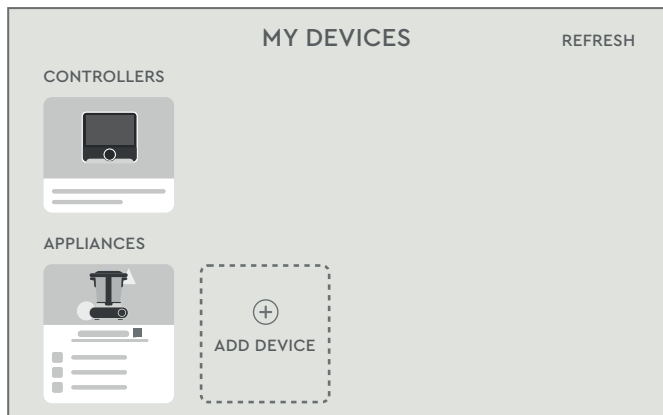

NOTICE This menu shows the connected controllers and appliances to your CookingPal® account. The following actions can be done:

1. Tap "My Devices".
 - Change name of the appliance.
 - Add new appliance.
 - See appliance information and check for updates.
 - Refresh and relink, pair and unlink controllers and the appliance.
 - See the status of the appliance (connected / out of range / offline).

11.7 Tablet Storage Management

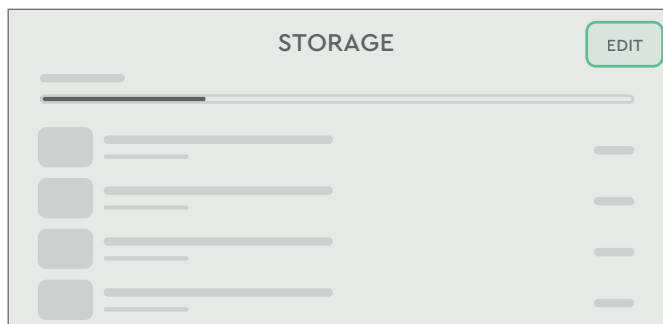

11.8 Checking for the Most Updated Software

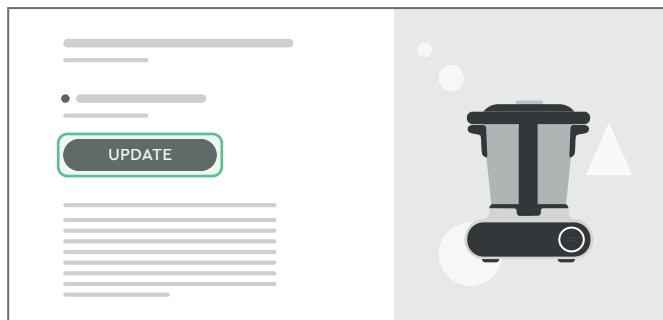

NOTICE When the Hub storage memory is full, an alert pops up. Tap "Manage Storage" to clear space for new downloads.

1. Tap the ☰ icon on the top right side to access the side menu, tap "Settings", then "Storage".
2. The top bar shows how much of the memory capacity has been used. Tap "Edit", then select the recipes you want to delete. Tap "Delete" to remove the downloaded recipe.

1. Tap the ☰ icon on the top right side to access the side menu, tap "Settings", then "About -> Software Update". The version number and appliance number is displayed.
2. If an update is available, tap "Update" to proceed with downloading.

11.9 Viewing Favorite Recipes

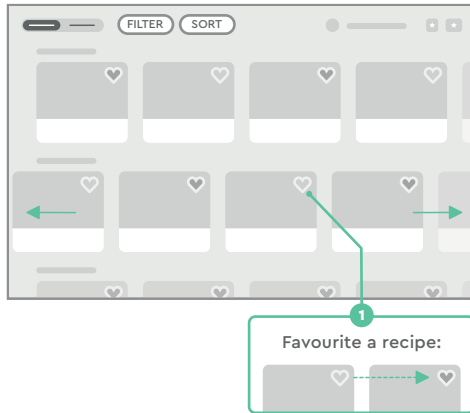

NOTICE If no recipes have been marked with a ♥ icon, the Favorite Recipes list will be empty.

- Tap the ♥ icon on the top right side to enter "Favorite Recipes"
- To mark a recipe as a Favorite, tap on the ♥ icon on the top right of the recipe photo. The ♥ icon changes to red, the recipe is added to the Favorite Recipes list.
- Tap "Favorite Recipes" to view your Favorite Recipes list.

11.10 Checking Notifications

Tap the 🔔 icon on the top right side to view your notifications.

12.0 Cooking Modes

1. Tap "Cooking Modes". Scroll on the display or rotate the jog dial to find the desired cooking mode including Knead, Steam, Sauté, Scale, Keep Warm and Manual.
2. Tap on the mode or press the jog dial to select the mode.

NOTICE To quickly switch to Guided Cooking, tap "Guided" on the top left side of the Hub.

12.1 Knead

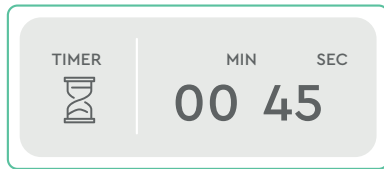

NOTICE

- Do not use the butterfly whisk when using the Knead mode.
- Only a maximum of 1.8 lbs (800 g) of dough can be mixed at a time.

- To prevent the appliance from overheating, do not run Knead mode for more than 2 minutes after each kneading session and allow at least 10 minutes before next use.

The mode is intended for kneading a dough.

1. Place the ingredients for the dough into the mixing bowl and lock the lid.
2. On the Hub, tap the timer on the left side, then scroll or use the jog dial to set the timer (1 second – 2 minutes).
3. Tap "Start" to start kneading. Press "Pause" to stop and "Resume" to continue kneading.
4. Kneading is finished when the countdown is over.

12.2 Steam

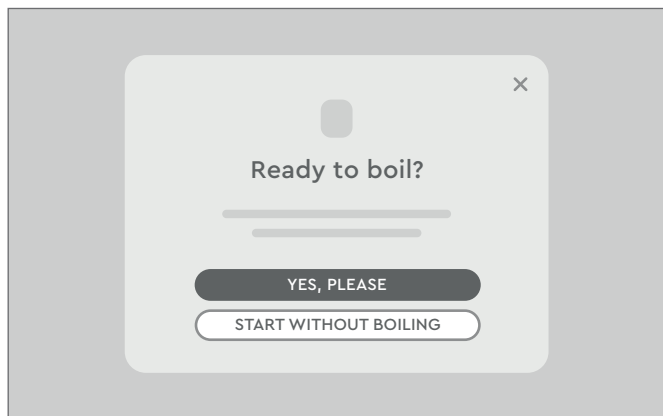
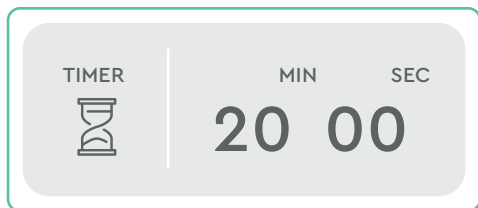

NOTICE Use the steamer for this mode.

This mode is intended for steaming.

1. Fill the mixing bowl with water. Do not fill above the **MAX** mark on the mixing bowl. Place the steamer on top of the mixing bowl and lock the deep steaming tray.
2. On the Hub, tap the timer on the left side, then set the timer (max. 60 minutes) using the display or the jog dial.
3. Tap "Start", a pop-up appears to ask if preheating is needed. If preheating is needed, tap "Yes, please". The timer does not start when preheating is in progress. The mixing bowl starts to heat up the water to 212 °F (100 °C) and will alert you when the preheating is finished. If preheating is not needed, tap "Start without preheat" to start steaming immediately.
4. Place the food into the deep steaming tray and/or shallow steaming tray, then cover with the steamer lid. Press "Pause" to stop and "Resume" to continue steaming.
5. Steaming is finished when the countdown is over.

12.3 Sauté

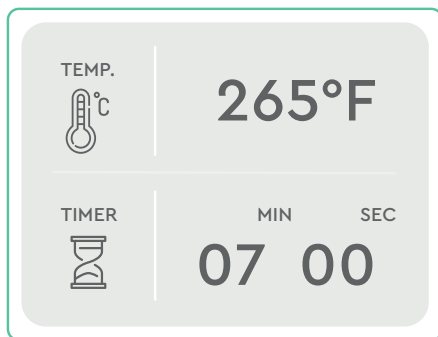

This mode is intended for sautéing.

1. Place the ingredients into the mixing bowl. Lock the lid.
2. On the Hub, tap the temperature setting, tap to set the cooking temperature (125 – 265 °F/50 – 130 °C) or turn the jog dial.
3. Tap the timer, set the timer (max. 99 minutes) using the display or the jog dial.
4. Tap "Start" to start sautéing. Press "Pause" to stop and "Resume" to continue sautéing.
5. Sautéing is finished when the countdown is over.

12.4 Scale

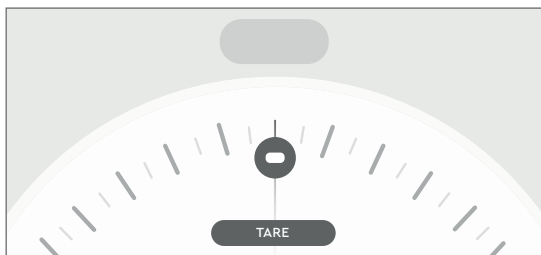

This mode is intended for weighing.

1. Press "Tare" to set the scale to zero.
2. Place the food that needs to be weighed into the mixing bowl. The display shows the weight of the food placed inside.

NOTICE The max. weight capacity is 11 lbs (5 kg) with 0.25 oz (5 g) deviation.

12.5 Keep Warm

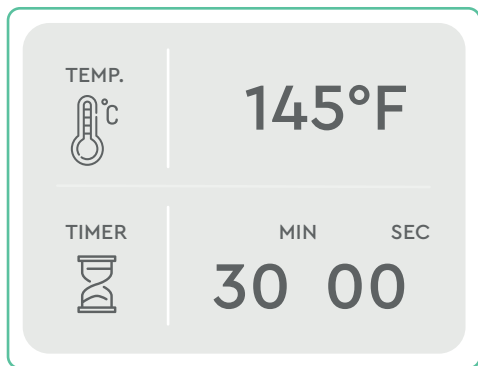

NOTICE Use this mode to keep cooked dishes warm.

1. Place the food that needs to be kept warm in the mixing bowl.
2. On the Hub, tap the temperature setting, set the temperature (100 – 160 °F/37 – 70 °C) using the display or the jog dial.
3. Tap the timer, set the timer (max. 99 minutes) using the display or the jog dial.
4. Tap "Start" to start keeping warm. Press "Pause" to stop and "Resume" to continue keeping warm.
5. Keep Warm mode is finished when the countdown is over.

12.6 Manual

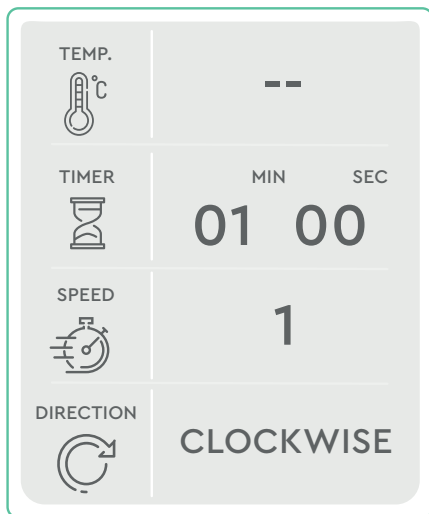

NOTICE This mode can be used with all accessories. Butterfly whisk should not be used for speeds higher than 4.

In this mode, all settings are customizable for different cooking needs.

1. Place the food in the mixing bowl.

2. On the Hub, tap the temperature setting, set the temperature (100 – 265 °F/37 – 130 °C) using the display or the jog dial. Set to -- (no heat).
3. Tap the timer, set the timer (1 second – 99 minutes 59 seconds) using the display or the jog dial.
4. Tap the speed, set the speed (1 – 10) using the display or the jog dial.

NOTICE Under the following circumstances only speed settings 1/2/3 can be used for safety reasons:

- The temperature is set to 100 – 265 °F (37 – 130 °C).
 - The blade is spinning counter-clockwise.
5. Tap the direction, set the blade rotation direction (clockwise/counter-clockwise) using the display or the jog dial.
 6. Tap "Start" to start the function. Press "Pause" to stop and "Resume" to continue the function.
 7. Cooking mode is finished when the countdown is over.

NOTICE Turbo function can be used with this mode when the bowl temperature is lower than 140 °F (60 °C).

13.0 Guided Cooking

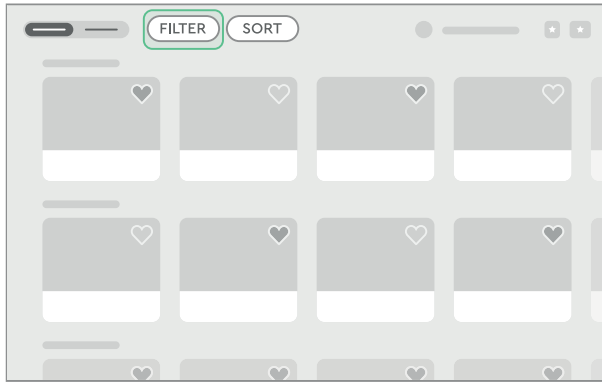

1. To cook with a guided recipe, tap "Guided Cooking".

NOTICE To quickly switch to Cooking modes, tap the words "Modes" on the top left side of the Hub.

2. Scroll on the display or rotate the jog dial to browse the recipe selection. Tap to select your desired recipe.

NOTICE To filter the recipes, tap "Filter", select the desired attributes, then tap "Apply".

To sort the recipes, tap "Sort", then select your desired sorting order.

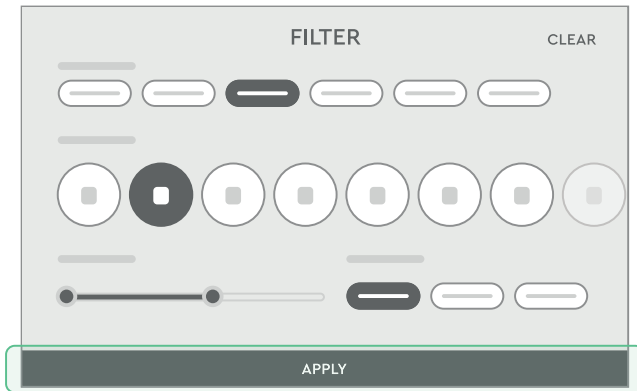

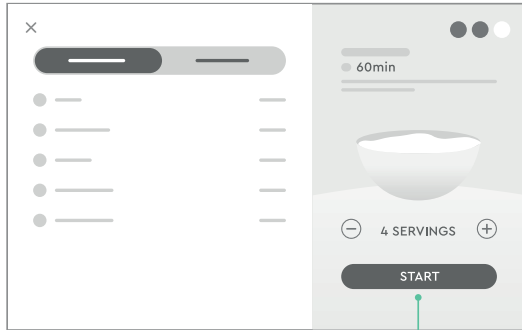

First download the recipe :

DOWNLOAD → START

3. Download the recipe. Set the number of servings needed. Check the ingredients for the recipe.
4. Tap "Start Cooking", then follow the steps to cook the recipe. Swipe left or right or rotate the jog dial to scroll through the steps. To go to a specific step, tap the downwards arrow to expand the recipe timeline, then tap the desired step to go to that step.

NOTICE Cooking settings are still adjustable in Guided Cooking function. Tap the setting that needs to be changed and adjust accordingly.

13.1 Turbo Function

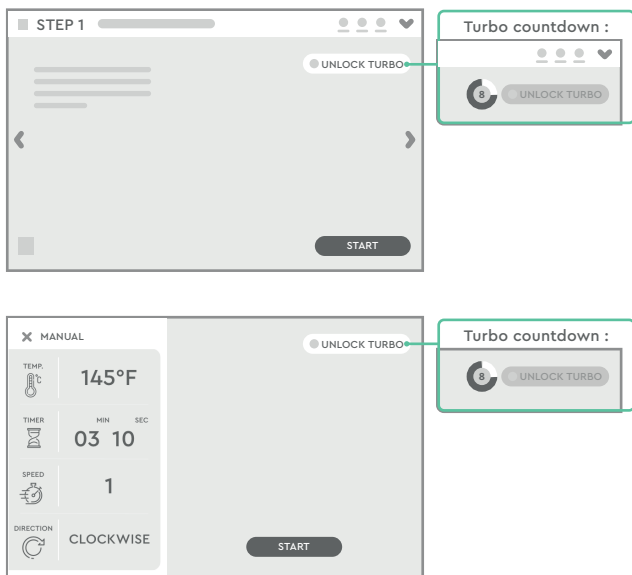

NOTICE Turbo function appears on the top right side of the display when it is available for the step. The Turbo function is suspended when the bowl temperature is higher than 140 °F (60 °C).

NOTICE Turbo function is also supported in Manual mode.

1. Tap "Unlock Turbo". The timer starts counting down from 10 seconds.
2. Press and hold the control button on the main unit or the jog dial on the Hub to start Turbo function. Release to stop.
3. When the control button on the main unit or the jog dial on the Hub is released, the timer starts counting down from 10 seconds again. Push the control button or the jog dial to continue Turbo function or the Turbo function will be disabled when time has finished.

WARNING Hot contents of the mixing bowl can spill out and cause damage and injury if the lid seal is not positioned correctly.

14.0 Cleaning for the First Time

If using CookingPal® Multo™ for the first time, begin by becoming familiar with the appliance.

⚠ WARNING Health Risk

Because of the manufacturing process residues of oil or other contaminants may be on the components of CookingPal® Multo™. Those contaminants are not suitable for consumption and pose a health risk.

- Thoroughly wash all components and accessories, that could come into contact with food, with warm water and dish soap before using CookingPal® Multo™ for the first time.
- Make sure to thoroughly dry all washed components and accessories before use.

When cleaning the appliance for the first time, proceed as follows:

1. Disassemble the mixing bowl;
2. Then wash all parts and accessories by hand or in the dishwasher (except for the main unit and the Hub).

More information on cleaning can be found in the CookingPal® Multo™ online user manual.

15.0 Cleaning & Maintenance

⚠ WARNING Risk of electric shock

To prevent electric shock, unplug the appliance before cleaning.

⚠ WARNING Risk of electric shock

During cleaning, do not immerse the electrical parts of the main unit, the Hub and any cables in water or other liquids. Never hold the appliance under running water.

○ 15.1 Cleaning the Main Unit, Hub & Cables

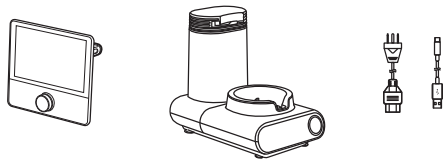

- Do not immerse these parts into water.
- Do not wash in the dishwasher.
- To clean the components, wipe with a soft, slightly moist cloth.
- Never use corrosive detergents, wire brushes, abrasive scourers, metal or sharp utensils to clean the components.
- The Hub has IPX4 ingress protection rating, it can withstand slight water splashes.

⚠ WARNING Risk of Electric Shock

If water penetrates the electrical components, you could receive an electric shock.

- Clean the main unit only with a dry or damp cloth.
 - Do not pour water over the main unit.
 - The main unit, Hub, charging ports or electrical sockets, electrical cables and charging wires as well as their plugs and heads should always be kept dry and clean.
 - Unplug the main unit from the outlet before cleaning the base unit.
 - Do not use the CookingPal® Multo™ outdoors.
 - Do not immerse the main unit in water or other liquids.
 - Do not hold the main unit under running water.
1. Disconnect the appliance from the main power supply before cleaning the main unit.
 2. Wipe off the main unit with a damp cloth and a gentle cleaning agent.

If water has managed to penetrate the main unit, contact CookingPal®'s Customer Service center.

15.2 Clean Mode

Clean mode features two cleaning modes:

Quick Clean – Quick and easy bowl refreshment in between two cooking steps and similar uses.

Deep Clean – Removing tough or dried up food residue.

Quick Clean

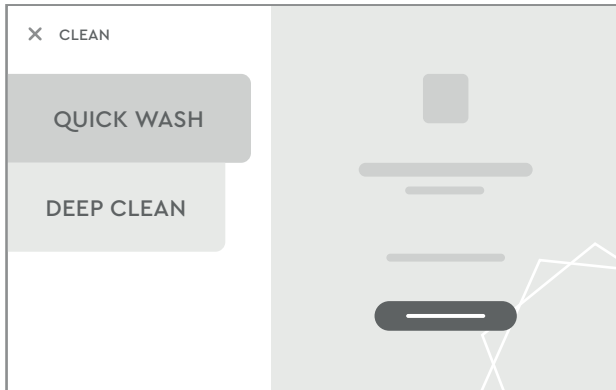

- This mode is only used for cleaning non-sticky foods off of the mixing bowl (with the blade). Do not place any attachments into the mixing bowl.
1. Fill the mixing bowl with water up to **50 oz / 1.5 L** mark.
 2. Attach the seal and close the lid.
 3. Choose Clean mode from Cooking modes menu.
 4. Tap "Quick Wash" and run the function. The function lasts 30 seconds.

Deep Clean

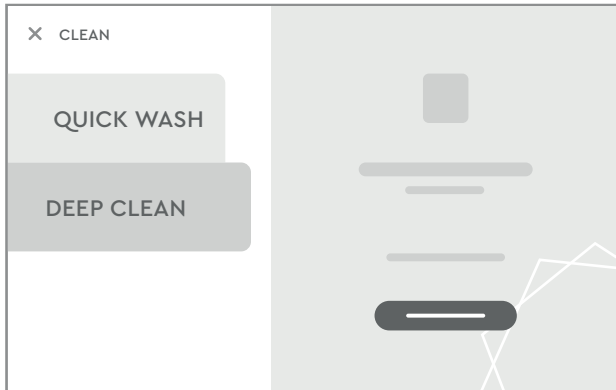

- This mode is only used for cleaning the mixing bowl (with the blade). Do not place any attachments into the mixing bowl.
1. Fill the mixing bowl with water and washing liquid up to **50 oz / 1.5 L** mark.
 2. Attach the seal and close the lid.
 3. Choose Clean mode from Cooking modes menu.
 4. Tap "Deep Clean" and run the function. The water heats up and starts cleaning. The function lasts 3 – 6 minutes, depending on the water temperature.

15.3 Cleaning the Accessories

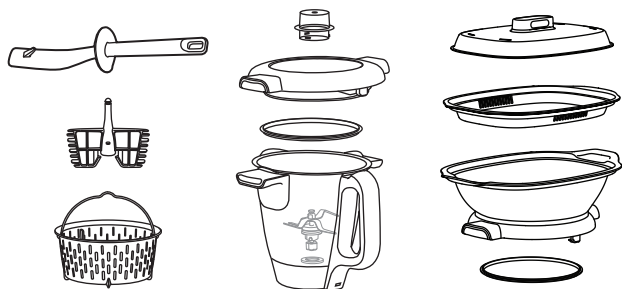

NOTICE All the accessories are dishwasher safe. Place plastic parts, in particular the mixing bowl lid, into the top rack of the dishwasher in order to avoid deformation resulting from exposure to higher temperatures and pressure from stacking items.

15.4 Cleaning the Blade, Lid & Steamer Seals

WARNING Your Multo™ blade can get very hot after prolonged use, even if you have not been using the heating function. Use caution when touching or removing the blade after use and allow it to cool completely before touching or removing it.

- Ensure the seals do not come in contact with any sharp or abrasive objects or surfaces.
- Some of the plastic parts may become slightly discolored but this does not affect your health or how the parts function.
- To clean the accessories, wipe with a soft, slightly moist cloth.
- Never use corrosive detergents, wire brushes, abrasive scourers, metal or sharp utensils to clean the accessories.
- Once the mixing bowl and accessories have cooled down remove the seals from the steamer and the blade and load all parts separately.
- Remove the seal from the blade/lid/steamer, and then wipe with a soft, slightly moist cloth.
- Never use corrosive detergents, wire brushes, abrasive scourers, metal or sharp utensils to clean the blade seal.

WARNING Never touch the blade by the edges in order to avoid injury.

○ 15.5 Storage

- Store the appliance in its original packaging in a dry area. Keep away from children and pets.
- Do not expose to direct sunlight.
- When not in use, the built-in battery of the Hub should be charged monthly.

○ 15.6 Maintenance

Any other servicing than mentioned in this manual should be performed by an authorized repair center.

NOTICE Corrosion inside the appliance

Ensure that the mixing bowl and especially the contact pins underneath are thoroughly dried after cleaning. If you use the mixing bowl when it is still wet, rust could form inside the main unit.

- Allow the mixing bowl to dry completely before inserting it into the main unit.



16.0 Troubleshooting

⚠ WARNING Risk of Electric Shock

If the main unit or power cord is damaged, you could receive an electric shock. Do not use the CookingPal® Multo™ if the power cord is damaged.

- Before every usage inspect the main unit, the Hub, power cord, and accessories for potential damage.
 - Ensure that the power cord does not touch hot surfaces or external heat sources, sharp or abrasive surfaces that can cut or degrade the insulation on the power cord.
 - Do not use the main unit, the Hub if it is dropped or damaged in any manner.
 - In the event of damage to the main unit, the Hub or the power cord, contact CookingPal®'s Customer Service center for examination, repair or electrical or mechanical adjustment.
 - If the power cord on the main unit has been damaged, it must be replaced by the manufacturer or an authorized Repair Center to avoid hazards.
 - Never attempt to repair the main unit or the Hub yourself.
- Never put your fingers into the openings that are intended for the contact pins on the base of the mixing bowl.
 - Do not insert any objects into these openings.

Problem	Cause	Solution
The appliance does not start.	The mixing bowl is not positioned correctly.	Insert the mixing bowl correctly.
	The lid or the deep steaming tray have not been locked correctly onto the mixing bowl.	Place the lid or the deep steaming tray on correctly.
	No power supply.	Check if the power plug is connected to the electrical wall outlet and the switch button is on. Check if the electrical wall outlet works.
Liquid is leaking from under the main unit.	The blade has not been inserted correctly, causing the mixing bowl to leak.	Insert the blade correctly (see "Assembling the Mixing Bowl" section step 1 – 3).
	The blade seal is faulty.	Replace with a new blade seal. Contact an authorized service center to purchase new blade seal).

Problem	Cause	Solution
Cannot set the temperature.	Speed setting 4 – 10 is selected.	At these speed settings, there is a risk of hot food spilling, so the speed range is limited to only 0 – 3.
Cannot set the speed to more than 3.	The temperature setting is set between 100 – 265 °F/37 – 130 °C or the direction of the blade is set to counter-clockwise.	Set the temperature to -- (no heat) or set the direction of the blade to clockwise.
Error messages or notes on the display. The LED and button lights are flashing red.	Warning against incorrect operation.	Follow the instructions on the display.

17.0 Grounding Instructions

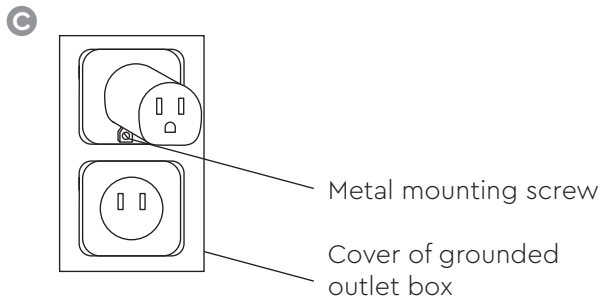
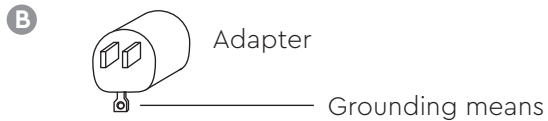
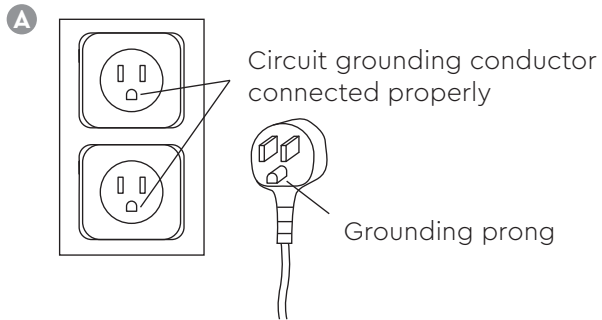

This appliance must be grounded while in use to protect the operator from electrical shock. The appliance is equipped with a 3-conductor cord and a 3-prong grounding-type plug to fit the proper grounding-type receptacle. The appliance has a plug that looks like sketch **A** in the figure on the left side. An adaptor, sketch **B**, should be used for connecting sketch-A plugs to two-prong receptacles. The grounding tab which extends from the adaptor must be connected to a permanent ground such as a properly grounded outlet box as shown in sketch **C** using a metal screw.

18.0 FCC – Supplier's Declaration of Conformity

Unique Identifier	2AX9F-MULTO
Responsible Party	Smart Product Concepts Limited
U.S. Contact Information	6600 Silacci Way Gilroy, CA 95020
Telephone Number	(866) 548-3092

18.1 FCC Compliance Statement



1. This appliance complies with Part 15 of the FCC rules. Operation is subject to the following two conditions:
 - (1) this appliance may not cause harmful interference, and
 - (2) this appliance must accept any interference received, including interference that may cause undesired operation.
2. Changes or modifications not expressly approved by the party responsible for compliance could void the user's authority to operate the equipment.

18.2 FCC Interference Statement



This equipment has been tested and found to comply with the limits for a Class B digital appliance, pursuant to part 15 of the FCC Rules. These limits are designed to provide reasonable protection against harmful interference in a residential installation. This equipment generates, uses and can radiate radio frequency energy and, if not installed and used in accordance with the instructions, may cause harmful interference to radio communications. However, there is no guarantee that interference will not occur in a particular installation. If this equipment does cause harmful interference to radio or television reception, which can be determined by turning the equipment off and on, the user is encouraged to try to correct the interference by one or more of the following measures:

- Reorient or relocate the receiving antenna.
- Increase the separation between the equipment and receiver.
- Connect the equipment into an outlet on a circuit different from that to which the receiver is connected.
- Consult the dealer or an experienced radio / TV technician for help.

19.0 Trademarks



CookingPal® is a registered trademark in the United States and in other countries and owned by Smart Product Concepts Limited.



The Bluetooth® word mark and Logos are registered trademarks owned by Bluetooth SIG, Inc. and any use of such marks is under license. Other trademarks and trade names are those of their respective owners.

20.0 Specifications

20.1 Main Unit

Model number:	SKA-CP-MUL-WHI-528
Rated voltage:	120 V~, 60 Hz
Power output (USB):	5 V, max. 2 A
Power rating:	1200 W
Net weight (excluding the Hub):	approx. 13 lbs (5.9 kg)
Mixing bowl capacity:	3.1 QT (3 L)

20.2 Smart Kitchen Hub

Display:	8.9" 800 × 1200
Operating system:	Android 8.1
RAM:	2 GB
ROM:	32 GB
Wi-Fi:	802.11 b/g/n/ac (2.4G&5G)
Bluetooth:	4.2
Camera:	8 MP
Battery:	5000 mAh
Charging:	DC 5 V, 2 A
Weight:	1.5 lbs (0.7 kg)



21.0 Disposal



This symbol means that electrical and electronic appliances may not be disposed of in the normal household waste. Please check your local guidelines for instructions on how to dispose of electronic devices.

22.0 Help and Support

We're here to help!

Visit us: support.cookingpal.com

Contact us: support@cookingpal.com

Call us: (866) 548-3092





Great!

Now That We Are All Set,

Let's Start Cooking!

www.cookingpal.com
(866) 548-3092
support@cookingpal.com

