

OPERATOR'S MANUAL **HT-400 & HT-600**

Manual Clamshell with Pressure Readout
15"x15" & 16"x20" Heat Transfer Machines

EVO TOUCH



HT400



HT600

S-450 & S-650

Auto Opening Clamshell with Pressure Readout
15"x15" & 16"x20" Heat Transfer Machines

EVO PRO



S450



S650

For Customer Service:
Call 1-800-835-0606 or Visit hixcorp.com

HIX CORPORATION



CONTENTS

| | |
|--|-------|
| <i>Receiving & Setup</i> | 3 |
| <i>Power</i> | 4 |
| <i>User Adjustable Settings</i> | 5 |
| <i>Machine Presets</i> | 6 |
| <i>Platen Pressure</i> | 7 |
| <i>Transfer Application</i> | 8 |
| <i>Troubleshooting</i> | 9-12 |
| <i>Repairs & Maintenance</i> | 13 |
| <i>Parts List</i> | 14-15 |
| <i>Warranty</i> | 16 |

BEFORE warranty repair you MUST get Prior Authorization



RECEIVING & SETUP

SHIPPING OR RETURNS

NOTE Save all of your shipping/packing material. Do not risk costly shipping damage, ship only in original box.

1. Fasten machine to plywood shipping base with bolts provided.
2. Tie or tape handle securely to base.
3. Place in original box, and put side liner and top liner in place. Fold flaps and seal the box. (Additional bottom boards, box and liners may be obtained from your supplier for a normal cost.)

UNPACKING

Remember to save all packing material - including box, liner and board. You may need these for shipping your machine or if a repair is necessary in the future.

INSPECTION

Inspect your machine for hidden shipping damage. Contact the delivery company immediately, should you find damage.

INSTALLATION

1. Remove plywood shipping base bolts (see A and B) and screw on feet or affix self-adhesive rubber feet provided.

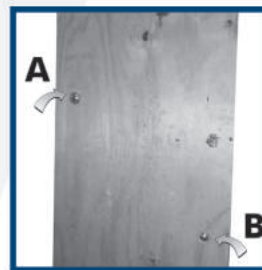
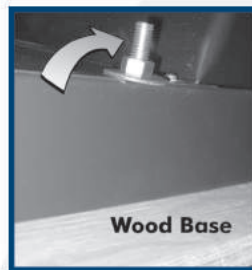

CAUTION: Handle must be tied to base before moving or shipping.

2. Carefully cut tape/wrap holding the machine closed.
3. Plug the machine into the correct grounded electrical outlet.

WARNING: When using an extension cord, use 12 or 14 ga.-3 conductor. Maximum length, 25' (7.762 m).

POWER

TURNING THE POWER “ON”

1. Once the machine is plugged into power, the display will show a “Red Icon” as shown below. To turn the power on to the machine, simply press the Red Icon.



2. The display will then come on and look similar to what is shown below.

To turn the Power “OFF” to the machine, simply press the Green “Power” Icon in the upper right corner of the display and the machine will turn “OFF.”



To adjust the temperature or time settings, simply press the “UP” or “DOWN” arrows to change the values.

As the temperature is warming up from a cold start, the temperature digits will be RED when the heat platen temperature is more than 10 degrees away from desired setpoint temperature.

When the platen temperature is less than 10 degrees, but more than 5 degrees from the desired setpoint the temperature displayed will be YELLOW.

When the platen temperature displayed is within 5 degrees of the desired setpoint, the temperature digits will be GREEN.

When the actual platen temperature reaches the setpoint, the controller will BEEP.

3. A little “Red Dot” shown above in the lower left corner of the temperature display window represents the “Heat Light.” This indicator will be on when the controller is applying power to the heating element. It is normal for this indicator to flash on and off as heat is required.

USER ADJUSTABLE SETTINGS

USER ADJUSTABLE SETTINGS

Pressing the “GEAR” Icon  in the upper left corner of the Home Screen will switch the screen to the user settings menu, shown below.



Pressing the “Back Arrow” Icon in the upper left corner of the display will take you to the previous screen.

Pressing the “Home” Icon in the upper right corner of the display will take you to the “HOME” Screen.

Pressing any of the USER SETTINGS buttons will take you to one of the screens shown below where you can adjust the machine settings to your preferences.

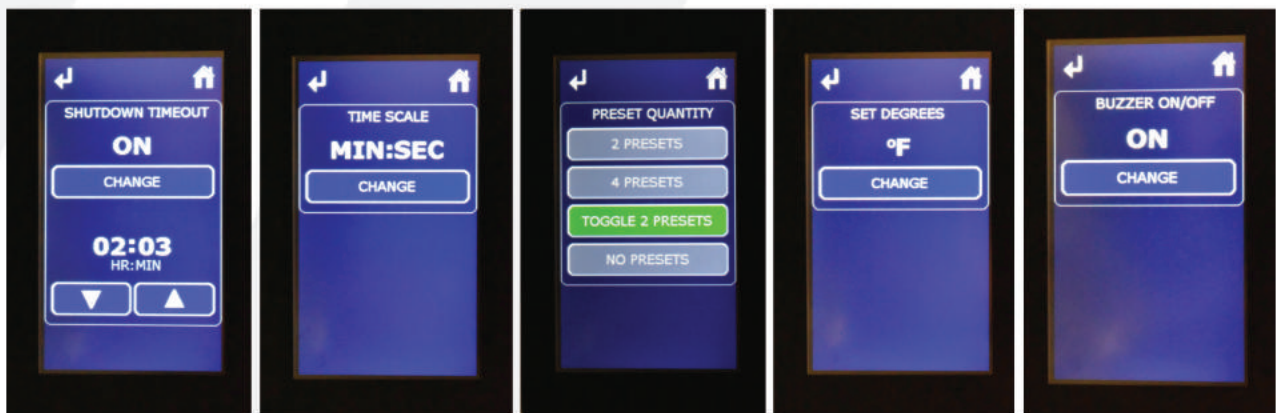

Once you have made the desired adjustments, press the “Back Arrow” or “Home” Icon.

Any changes in any of the settings or values you have made will be automatically stored as you leave that screen.

MACHINE PRESETS

PRESETS FOR TIME & TEMPERATURE SETTINGS

The controller has several Time and Temperature Preset options (No Presets, Two Presets, Four Presets, Toggle Two Presets) which are selectable in the “User Adjustable Settings” as outlined on the previous page.

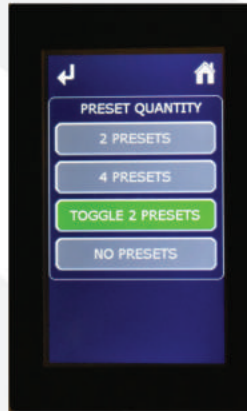

ON THE HOME SCREEN

If one of the buttons is “GREEN” then that button is the ACTIVE time and temperature preset on the controller. See below:

2 presets option



4 presets option



If you wish to make an adjustment to the time or temperature, simply press the UP/DOWN arrows next to the Time or Temperature values to change the number to the new setting desired.

NOTE: You will notice when you change either the Time or the Temperature away from the preset values, all the preset buttons will turn “Gray.”

To store the new Time or Temperature value(s) in a preset button location, simply press and HOLD on the desired preset button for 2 seconds. Once the new values are stored, the button will turn GREEN and the controller will BEEP to acknowledge the new values are stored.

To “recall” a preset, simply touch on the desired preset button and the Time and Temperature setting stored in that location will be recalled and displayed in the Time and Temperature values.

PLATEN PRESSURE

PRESSURE CONTROL KNOB

The pressure control knob, located on the top of the machine, should be set so that the heat will lock down firmly.

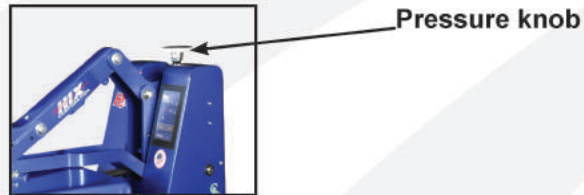

Pressure is reduced by turning knob (with machine open) counter-clockwise and increased by turning is clockwise.

PLATEN PRESSURE READOUT

The amount of platen pressure being exerted on the transfer and substrate can be monitored on the controller. When the machine is closed, the platen pressure is expressed in a numerical value between 0-9 on the controller home screen. Values of 0-3 indicate “light” pressure, 4-6 “medium” pressure and 7-9 “heavy” pressure. If the value exceeds 9, then “Pressure High” will appear on the display indicating that the maximum value can be displayed has been exceeded.

WARNING: Excessive pressure can cause structural damage, voiding the machine warranty!

AUTO-OPEN OVERRIDE (S-450 & S-650 MODELS)

Your semi automatic press features Automatic Opening at the end of each count down timer setting. The press will simply release and open.

DO NOT pry or try to open press, there is an emergency release lever atop the handle if you ever need to interrupt the countdown and get the press open.

CAUTION: Do not lean over press when cycle is complete. Injury could occur.

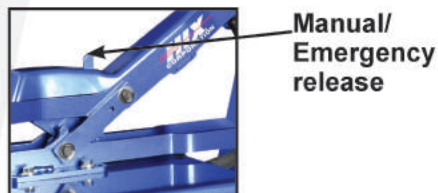

TRANSFER APPLICATION

The **120 volt models** have a slower heat recovery (i.e. 18-20 seconds @ 375°F).

The **220 volt models** are recommended for quicker cycle times (i.e. 10 seconds @ 375°F).

1. Set the temperature, time, & pressure to the desired settings as instructed. **Always** consult your specific transfer recommendations. Typical settings are; **Cold Peel**: 350°F (177°C), 15 seconds and **Hot Split**: 375°F (190°C), 10-12 seconds.

2. Align substrate on lower platen. Smooth wrinkle from garments.

NOTE: Wrinkles may be removed by bringing the heated platen in contact with the garment for a few seconds before the transfer is positioned.

3. Position the transfer in the desired location on the substrate.

NOTE: The transfer image should be “mirrored” before transferring except when transferring to substrates where the image shows through, i.e. glass tiles and cutting boards.

TIP: *When transferring double sided or sublimation transfers to garments, always place a sheet of transfer paper or a PTFE sheet between the layers of the garments to avoid bleed through or reheating of the applied transfer.*

4. Pull the handle down until the handle locks.

NOTE: Do not fold the transfer back on itself. Successful transfer work depends on the correct balance of time, temperature and pressure. The type and thickness of the material and the kind of transfer being used will determine what settings are necessary.

For hot peel/split transfers, immediately peel the paper after the machine has opened.

DO NOT allow the transfer to cool. For cold peel transfers, rub the transfer with an eraser or cloth and allow to cool for 5-10 seconds before removing the release paper.

TROUBLESHOOTING

NOTE: Specific application instructions are enclosed with transfers.

When you fail to make a successful transfer you can wonder, “Is it the machine’s fault, or the transfer, wrong settings or what?”

FIRST, THE BASICS

1. Be sure to set the heat transfer machine to the transfer manufacturer’s recommended Temperature, Time and Pressure settings. If you don’t have these specifications, contact your transfer supplier for this information and any other special application instructions as many of the new “High Tech” transfers require significantly different settings and/or application techniques than those from years past.
2. When you start up your press for the first time each day, preheat the pad for a minute. If the press has sat for 3-5 minutes without use, be sure to “preheat” the pad for 10-15 seconds before loading the shirt or making the first transfer.
3. After the shirt is positioned and centered on the preheated pad, “pre-press” the shirt for 3 seconds to take the wrinkles out and more importantly, release any excess moisture out of the T-shirt fabric which can reduce the chance of a successful transfer.
4. With all of the above recommendations, try making a transfer.
5. If successful, great! You are on your way to making some serious money with your transfer machine!
6. If you have an area that isn’t transferring completely or as you would like it to, follow these steps to determine the problem.
 - Try increasing the pressure on the machine by 10-20%
 - Recheck your temperature required and the press readout. You may want to increase the temperature 10 degrees.
 - Try increasing the application time by 2-4 seconds
 - If after trying these things there is still a “specific” area (say over in one corner of the transfer) that isn’t coming out as you would like it to, then try the same type transfer on a scrap shirt but rotate the transfer 180 degrees (changing the failure location) If after doing this the problem area is in the same physical location on the machine, then you probably have a problem with the pad or possibly a warped platen if the machine has ever overheated severely. On the other hand if the transfer failed in the same area on the transfer (after changing the location of where the problem had previously been occurring), then you most likely have a problem with the transfer or it’s application settings (Temperature, Time or Pressure) and you should contact your transfer supplier to discuss the problem.

Following these basic guidelines can help you be more successful with each and every transfer!

TROUBLESHOOTING

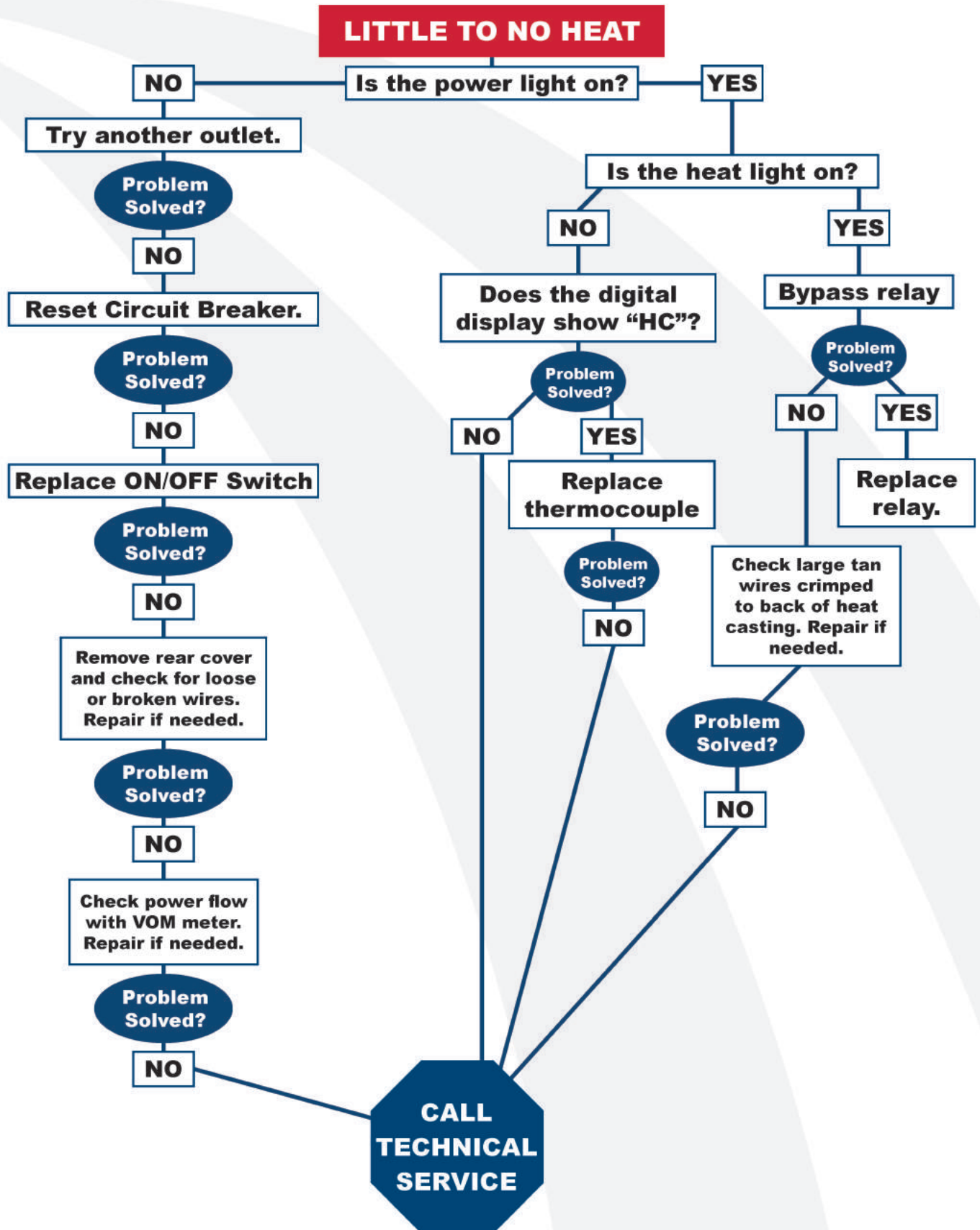

TROUBLESHOOTING

MACHINE OVERHEATS

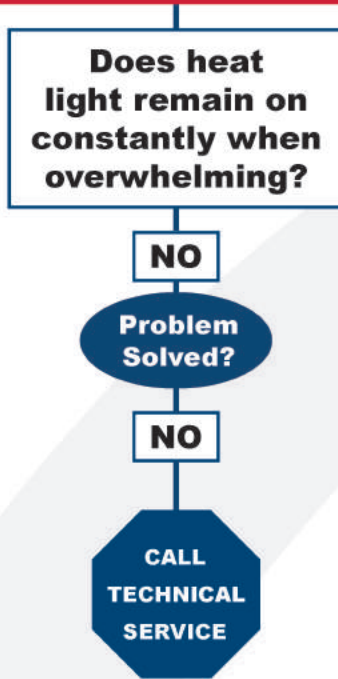

Platen pressure indicator not working properly.

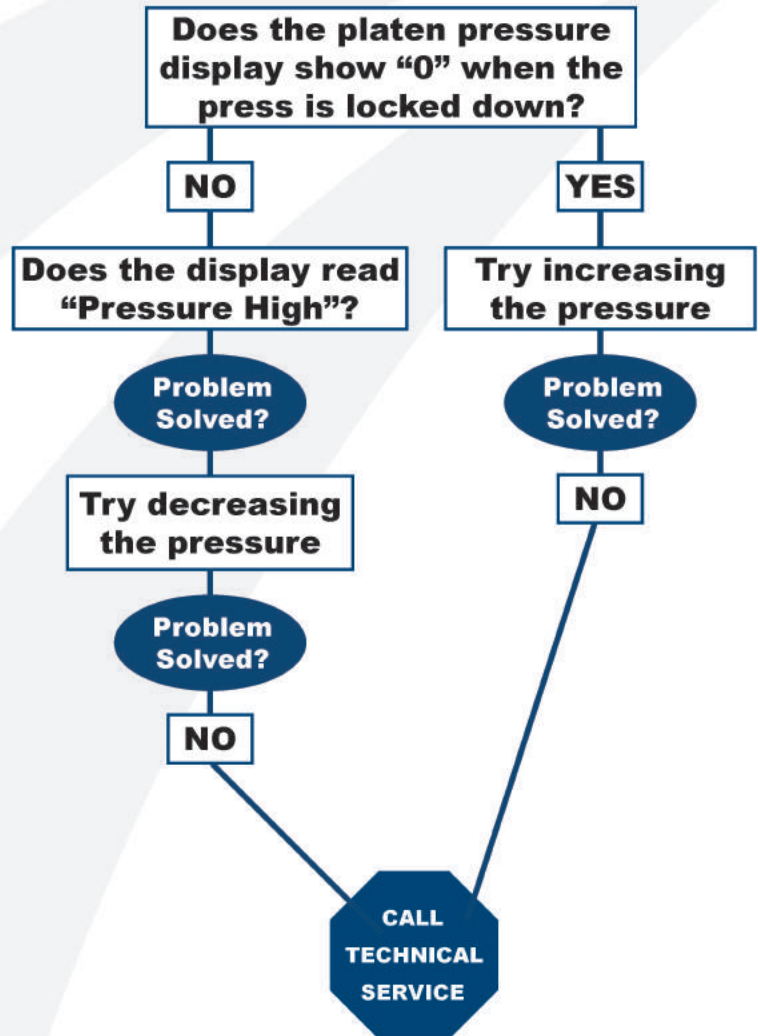

MACHINE WON'T STAY CLOSED

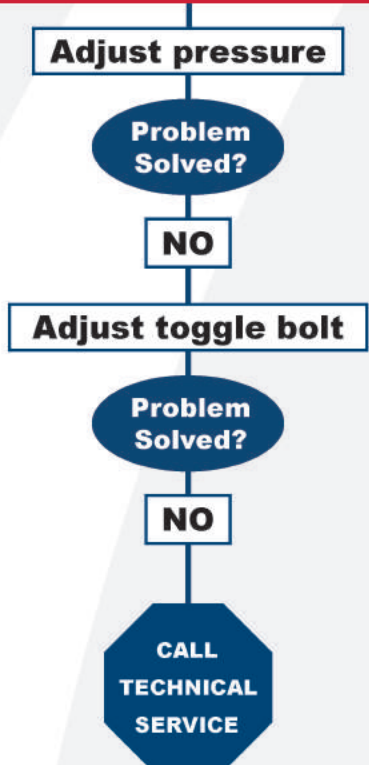

TROUBLESHOOTING

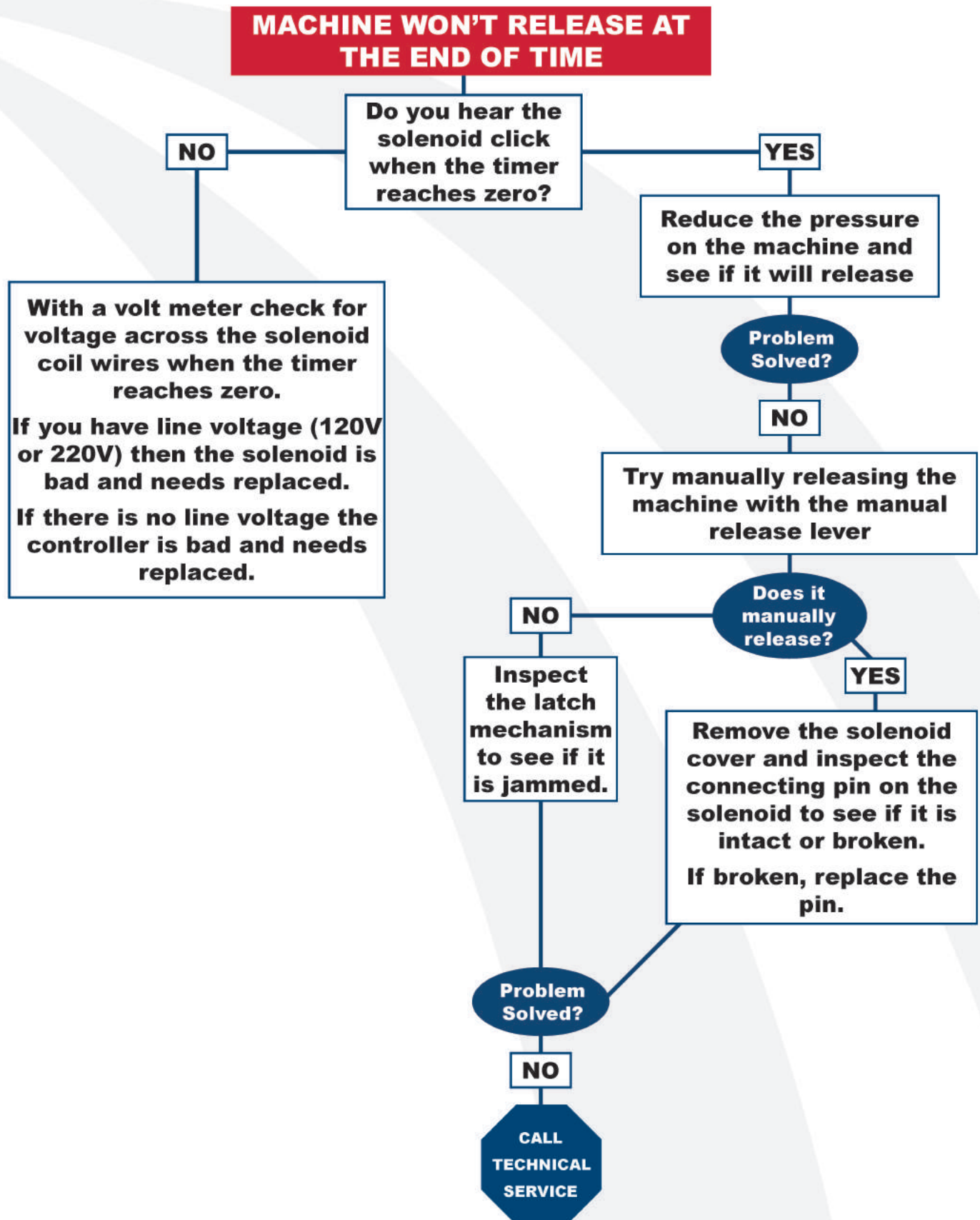

REPAIRS

RELAY BYPASS:

WARNING: Before making repairs, be sure ON/OFF switch is OFF and machine is unplugged!

1. Remove the back cover of the machine.

WARNING: To prevent possible electrical shock, unplug the machine before removing cover to service.

2. Remove wire #26 from terminal #2 on relay.
3. Loosen terminal #1 on relay and replace wire #26 along with wire #12 under terminal #1.
4. Tighten the connection.
5. Plug machine in and turn the power switch on.

NOTE: Replace the relay if the machine starts heating. This is a test only. Do not operate machine with relay bypassed.

MAINTENANCE

LUBRICATION:

Your press requires lubrication every 15,000 cycles or every 6 months.

Lubricate weekly in a heavy use production environment.

Use NSF/NLG12 rated food grade grease (such as Bel-Ray No-Tox #2 or equivalent).

A general purpose food grade machine oil spray is also acceptable such as CRC03055 lubricant (available from retailers such as Amazon).

Lubricate all moving or hinged points.

CLEANING HEAT PLATEN:

Clean the heat platen with steel wool, scrubbing aluminum sponge, or fine wire brush.

REPLACEMENT PARTS LIST (HT-400 MODEL)

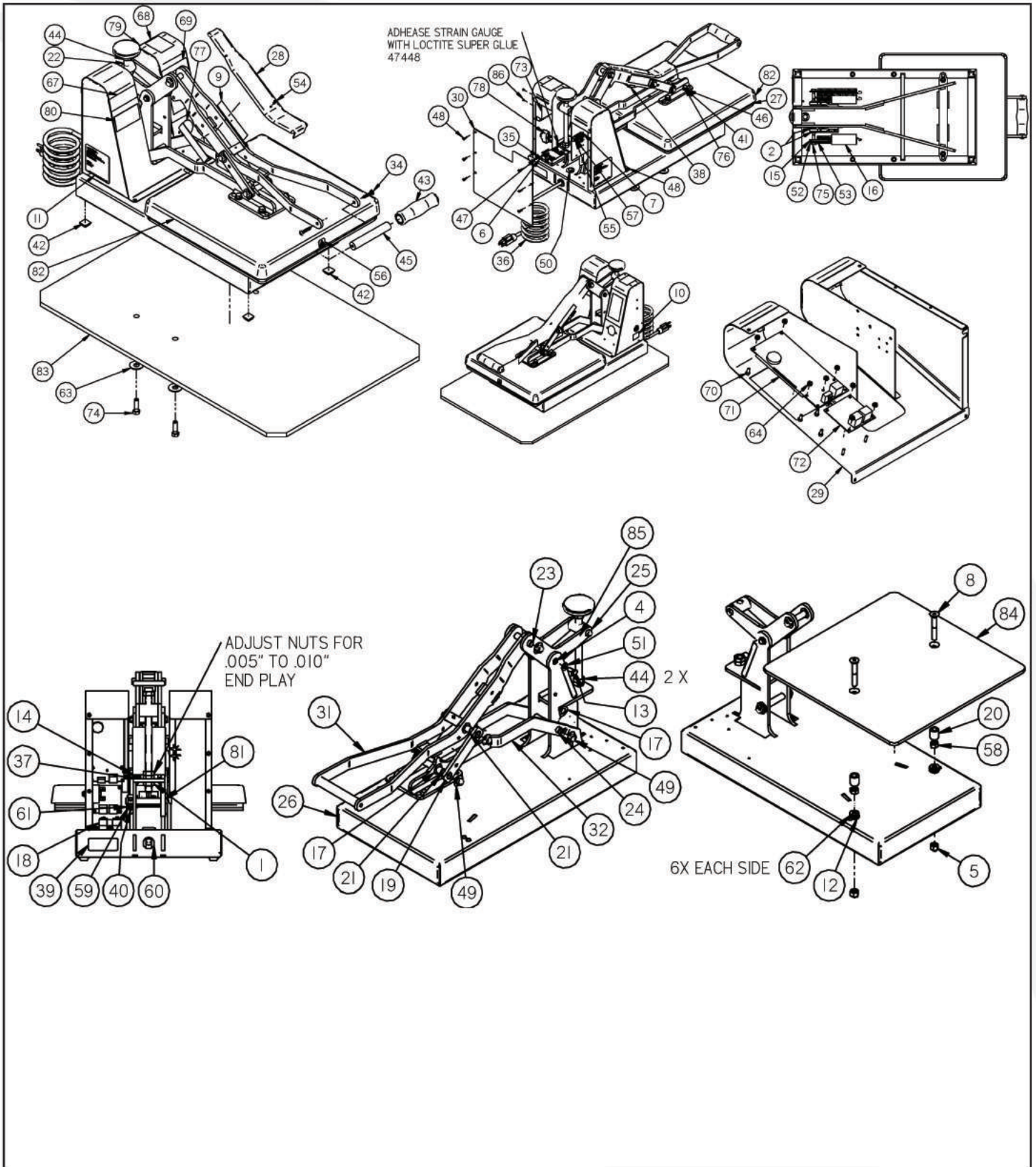

REPLACEMENT PARTS LIST

(HT-400 MODEL)

| ITEM# | PART# | TITLE | ITEM# | PART# | TITLE |
|-------|---------|--------------------------------|-------|---------|--------------------------------|
| 1 | 89078 | NUT 1/2-20 JAM NYLON INSERTZPS | 55 | 15297 | SCREW MCH 6-32x0.500 PHPH |
| 2 | 87619 | NUT 5/16-18 JAM | 56 | 14910 | DECAL HOT SURFACE SYMBOL |
| 3* | 8640502 | P-TXM20/DM18/400/600 PACKAGING | 57 | 14621 | NUT 6-32 ZPS |
| 4 | 8611803 | O-400/600 PIN THREADED .5x2.5 | 58 | 14571 | NUT 3/8-16 ZPS |
| 5 | 81380 | NUT 3/8-16 NYLON INSERT ZPS | 59 | 13919 | WASHER LOCK HEL SPR #4 ZP |
| 6 | 73841 | TERM 18-14 RING 1/4 NON M | 60 | 13250 | CORD GRIP HEYCO 1857 RDD201 |
| 7 | 72223 | TERM BD 601-2-KT37,38,39 | 61 | 13103 | SCREW MCH 4-40x0.750 RHSL |
| 8 | 71103 | SCREW FHSKT 3/8-16X2.500 | 62 | 12378 | WASHER SPG STL .375x.750x.028 |
| 9 | 70732 | DECAL HIX LOGO 4"x1" | 63 | 12229 | WASHER FLT .500x1.250x.078 ZPS |
| 10 | 70362 | DECAL CERTIFIED GREEN | 64 | 11349 | NUT 6-32 EXT TOOTH LOCK ZPS |
| 11 | 70268 | DECAL HIX I.D. 3"x3" SILVER | 65* | 11121 | WIRE KIT 400/600 120V ANT |
| 12 | 70009 | WASHER FLT .406x0.813x.080 ZPS | 66* | 11120 | MANUAL OWNERS HTM ANT |
| 13 | 65986 | BOLT 1/4-20x0.625 | 67 | 11024 | DECAL SILVER/RED EVO TOUCH |
| 14 | 6505020 | M-STRAIN GAUGE COVER | 68 | 10963 | DECAL QR CODE DXP ANT |
| 15 | 6505015 | M-400/600/450/650 SPG EXT LINK | 69 | 10916 | DECAL LCD DISPLAY ANT |
| 16 | 6501144 | P-400/600/450/650 TUBE DAMPEN2 | 70 | 10914 | SPACER .140x.250X.125 NYLON |
| 17 | 64203 | WASHER FLT .515x0.875x.032 SS | 71 | 10911 | CONTROL DISPLAY BD 4.3" COLOR |
| 18 | 62731 | RELAY SS 25A 3-32VDC INPUT | 72 | 10910 | CONTROL TEMP I/O BOARD ANT |
| 19 | 6105036 | M-LINK ASSY 400/600 ANT | 73 | 10903 | POWER SUPPLY 5VDC 15W |
| 20 | 6105030 | O-400/450 PLATEN SPACER | 74 | 10868 | BOLT 3/8-16x1.250 |
| 21 | 6105006 | M-HT400 PIN LOWER LINK | 75 | 10793 | BOLT 5/16-18x1.750 |
| 22 | 6105005 | M-DM18/400/600 PRSURE ADJ ROD | 76 | 10769 | BOLT 5/16-18x1.000 |
| 23 | 6105004 | M-HT400 PIN ROCKER LINK | 77 | 10664 | DECAL MADE IN THE USA ROUND |
| 24 | 6102008 | M-HT400 PIN MAIN ARM | 78 | 10347 | CIRCUIT BKR 1-POLE PTR 15A ST |
| 25 | 6021041 | M-ROCKER LINK 400/600 ANT | 79 | 10151 | KNOB 1/2-20 KNURLED |
| 26 | 6020065 | M-400/600/450/650 BASE WM ANT | 80 | 10131 | DECAL HT-400 SILVER/RED |
| 27 | 6010062 | M-PAD 15x15x3/8 MED BLK MOLDED | 81 | 10012 | TRIM-LOK 150 B2 X 3/16 ALUM |
| 28 | 6003001 | O-CVR HANDLE SHORT 400/600 | 82 | 0101031 | M-ASSY PLATEN 15X15 120V ANT |
| 29 | 6001031 | M-400/600/450/650 ENC WDMT ANT | 83 | 0101010 | M-400/600/DM MOUNTING BOARD |
| 30 | 6001006 | M-ENC BACK SHEET UNIVERSAL | 84 | 0100004 | M-PLATEN 1515 STL |
| 31 | 6000133 | M-HANDLE WELDMNT 400/600 ANT | 85 | 0100001 | M-UNIVERSAL ADJUSTMENT BLOCK |
| 32 | 6000131 | M-MAIN ARM WLDMNT 400/600 ANT | 86 | 10909 | SCREW MCH M3-0.5X3 PHP ZPS |
| 33* | 59886 | SCREW TAP 10-32x0.500 WHHX | | | |
| 34 | 59816 | SCREW TAP 14x1.250 PHPH | | | |
| 35 | 50181 | SCREW TAP 1/4-20x0.500 WHHX | | | |
| 36 | 39768 | CORDSET 120V 14/3 STOW 5-15P | | | |
| 37 | 39179 | GAUGE STRAIN | | | |
| 38 | 35408 | BUMPER 1/8X1/2 SQ BLK RUBBER | | | |
| 39 | 33605 | DECAL UNPLUG MACHINE | | | |
| 40 | 31823 | SWITCH MICRO SMALL SEMI-HOOK | | | |
| 41 | 30910 | WASHER LOCK HEL SPR 5/16 ZP | | | |
| 42 | 28010 | BUMPON BLACK .81"x.30" | | | |
| 43 | 26840 | HANDLE GRIP 3/4" FOAM BLK | | | |
| 44 | 25151 | NUT 1/2-20 JAM | | | |
| 45 | 2507074 | M-GENERIC HTM HANDLE | | | |
| 46 | 24732 | WASHER FLT .344x0.688x.063 ZPS | | | |
| 47 | 21989 | WASHER LOCK INT TH #14 | | | |
| 48 | 21482 | SCREW TAP 8x0.500 PHPH | | | |
| 49 | 20214 | NUT PUSH 1/2 PW500015 EZ | | | |
| 50 | 17301 | GROMMET .563IDx.750 GRVx.063 | | | |
| 51 | 16774 | WASHER FLT .281x0.625x.063 ZPS | | | |
| 52 | 16683 | WASHER FLT .375x0.875x.078 ZPS | | | |
| 53 | 15834 | SPRING HIX #105 | | | |
| 54 | 15446 | SCREW TAP 6x0.375 PHPH | | | |

REPLACEMENT PARTS LIST (HT-600 MODEL)

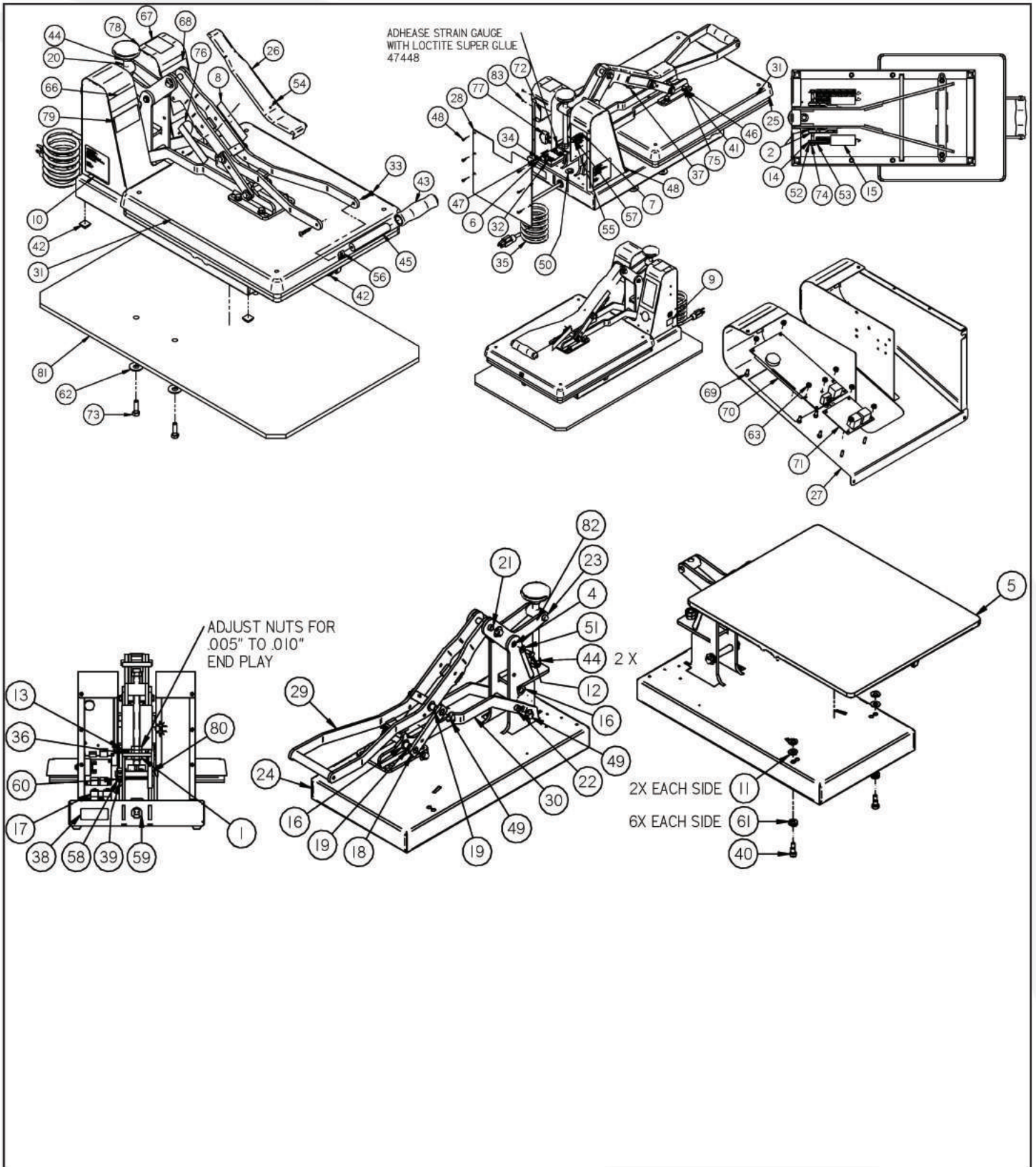

REPLACEMENT PARTS LIST

(HT-600 MODEL)

| ITEM# | PART# | TITLE | ITEM# | PART# | TITLE |
|-------|---------|--------------------------------|-------|---------|--------------------------------|
| 1 | 89078 | NUT 1/2-20 JAM NYLON INSERTZPS | 55 | 15297 | SCREW MCH 6-32x0.500 PHPH |
| 2 | 87619 | NUT 5/16-18 JAM | 56 | 14910 | DECAL HOT SURFACE SYMBOL |
| 3* | 8640502 | P-TXM20/DM18/400/600 PACKAGING | 57 | 14621 | NUT 6-32 ZPS |
| 4 | 8611803 | O-400/600 PIN THREADED .5x2.5 | 58 | 13919 | WASHER LOCK HEL SPR #4 ZP |
| 5 | 82768 | M-CASTING 16x20 LOWER F | 59 | 13250 | CORD GRIP HEYCO 1857 RDD201 |
| 6 | 73841 | TERM 18-14 RING 1/4 NON M | 60 | 13103 | SCREW MCH 4-40x0.750 RHSL |
| 7 | 72223 | TERM BD 601-2-KT37,38,39 | 61 | 12378 | WASHER SPG STL .375x.750x.028 |
| 8 | 70732 | DECAL HIX LOGO 4"x1" | 62 | 12229 | WASHER FLT .500x1.250x.078 ZPS |
| 9 | 70362 | DECAL CERTIFIED GREEN | 63 | 11349 | NUT 6-32 EXT TOOTH LOCK ZPS |
| 10 | 70268 | DECAL HIX I.D. 3"x3" SILVER | 64* | 11121 | WIRE KIT 400/600 120V ANT |
| 11 | 70009 | WASHER FLT .406x0.813x.080 ZPS | 65* | 11120 | MANUAL OWNERS HTM ANT |
| 12 | 65986 | BOLT 1/4-20x0.625 | 66 | 11024 | DECAL SILVER/RED EVO TOUCH |
| 13 | 6505020 | M-STRAIN GAUGE COVER | 67 | 10963 | DECAL QR CODE DXP ANT |
| 14 | 6505015 | M-400/600/450/650 SPG EXT LINK | 68 | 10916 | DECAL LCD DISPLAY ANT |
| 15 | 6501144 | P-400/600/450/650 TUBE DAMPEN2 | 69 | 10914 | SPACER .140x.250X.125 NYLON |
| 16 | 64203 | WASHER FLT .515x0.875x.032 SS | 70 | 10911 | CONTROL DISPLAY BD 4.3" COLOR |
| 17 | 62731 | RELAY SS 25A 3-32VDC INPUT | 71 | 10910 | CONTROL TEMP I/O BOARD ANT |
| 18 | 6105036 | M-LINK ASSY 400/600 ANT | 72 | 10903 | POWER SUPPLY 5VDC 15W |
| 19 | 6105006 | M-HT400 PIN LOWER LINK | 73 | 10868 | BOLT 3/8-16x1.250 |
| 20 | 6105005 | M-DM18/400/600 PRSURE ADJ ROD | 74 | 10793 | BOLT 5/16-18x1.750 |
| 21 | 6105004 | M-HT400 PIN ROCKER LINK | 75 | 10769 | BOLT 5/16-18x1.000 |
| 22 | 6102008 | M-HT400 PIN MAIN ARM | 76 | 10664 | DECAL MADE IN THE USA ROUND |
| 23 | 6021041 | M-ROCKER LINK 400/600 ANT | 77 | 10347 | CIRCUIT BKR 1-POLE PTR 15A ST |
| 24 | 6020065 | M-400/600/450/650 BASE WM ANT | 78 | 10151 | KNOB 1/2-20 KNURLED |
| 25 | 6010063 | M-PAD 16x20x1/2 MED BLK MOLDED | 79 | 10132 | DECAL HT-600 SILVER/RED |
| 26 | 6003001 | O-CVR HANDLE SHORT 400/600 | 80 | 10012 | TRIM-LOK 150 B2 X 3/16 ALUM |
| 27 | 6001031 | M-400/600/450/650 ENC WDMT ANT | 81 | 0101010 | M-400/600/DM MOUNTING BOARD |
| 28 | 6001006 | M-ENC BACK SHEET UNIVERSAL | 82 | 0100001 | M-UNIVERSAL ADJUSTMENT BLOCK |
| 29 | 6000133 | M-HANDLE WELDMENT 400/600 ANT | 83 | 10909 | SCREW MCH M3-0.5X3 PHP ZPS |
| 30 | 6000131 | M-MAIN ARM WLDMNT 400/600 ANT | | | |
| 31 | 6000104 | M-PLATEN ASSY 16X20 120V ANT | | | |
| 32 | 59886 | SCREW TAP 10-32x0.500 WHHX | | | |
| 33 | 59816 | SCREW TAP 14x1.250 PHPH | | | |
| 34 | 50181 | SCREW TAP 1/4-20x0.500 WHHX | | | |
| 35 | 39768 | CORDSET 120V 14/3 STOW 5-15P | | | |
| 36 | 39179 | GAUGE STRAIN | | | |
| 37 | 35408 | BUMPER 1/8X1/2 SQ BLK RUBBER | | | |
| 38 | 33605 | DECAL UNPLUG MACHINE | | | |
| 39 | 31823 | SWITCH MICRO SMALL SEMI-HOOK | | | |
| 40 | 30929 | BOLT SHOULDER 3/8x1/2x5/16-18 | | | |
| 41 | 30910 | WASHER LOCK HEL SPR 5/16 ZP | | | |
| 42 | 28010 | BUMPON BLACK .81"x.30" | | | |
| 43 | 26840 | HANDLE GRIP 3/4" FOAM BLK | | | |
| 44 | 25151 | NUT 1/2-20 JAM | | | |
| 45 | 2507074 | M-GENERIC HTM HANDLE | | | |
| 46 | 24732 | WASHER FLT .344x0.688x.063 ZPS | | | |
| 47 | 21989 | WASHER LOCK INT TH #14 | | | |
| 48 | 21482 | SCREW TAP 8x0.500 PHPH | | | |
| 49 | 20214 | NUT PUSH 1/2 PW500015 EZ | | | |
| 50 | 17301 | GROMMET .563IDx.750 GRVx.063 | | | |
| 51 | 16774 | WASHER FLT .281x0.625x.063 ZPS | | | |
| 52 | 16683 | WASHER FLT .375x0.875x.078 ZPS | | | |
| 53 | 15834 | SPRING HIX #105 | | | |
| 54 | 15446 | SCREW TAP 6x0.375 PHPH | | | |

REPLACEMENT PARTS LIST (S-450 MODEL)

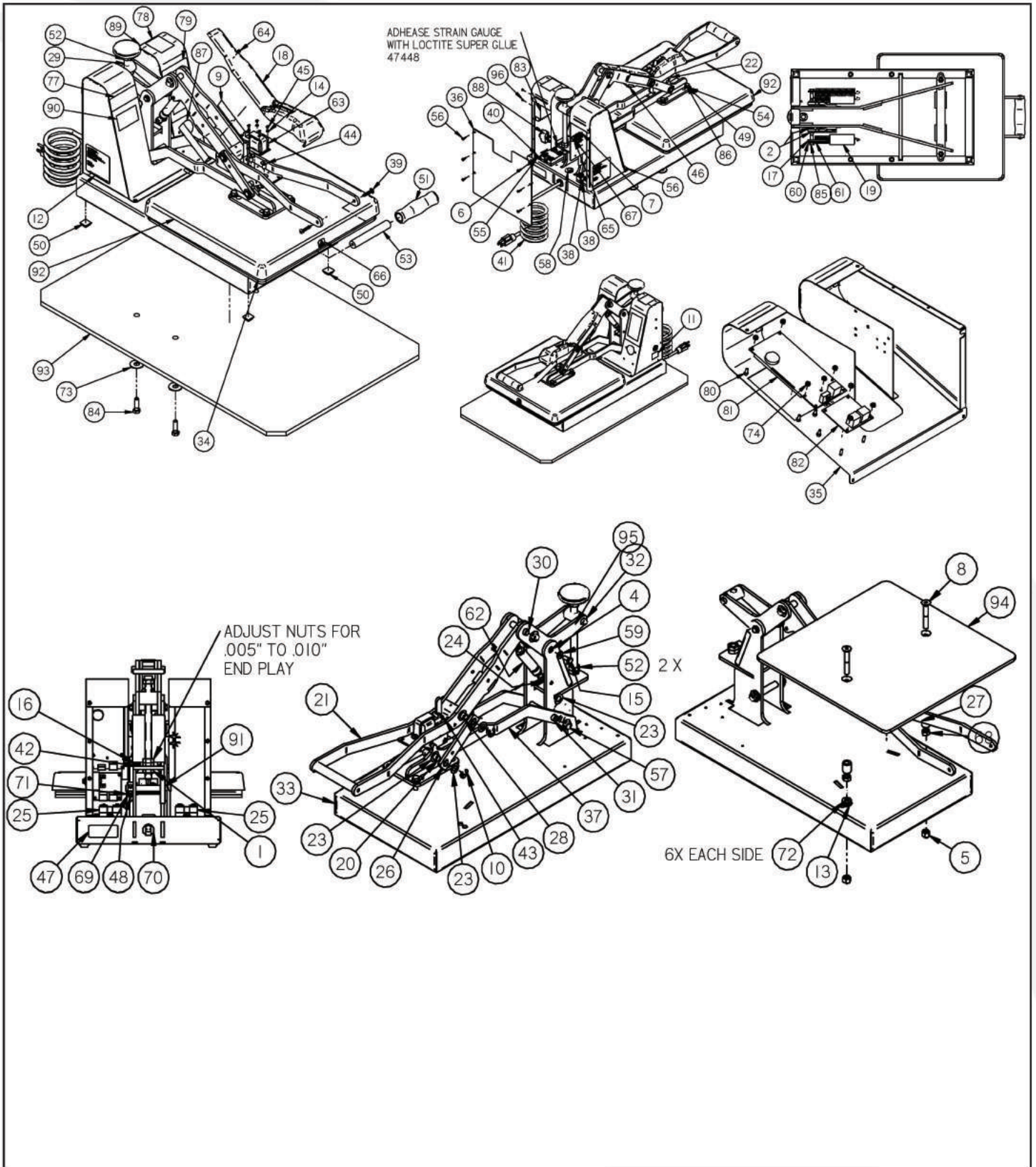

REPLACEMENT PARTS LIST

(S-450 MODEL)

| ITEM# | PART# | TITLE | ITEM# | PART# | TITLE |
|-------|---------|--------------------------------|-------|---------|--------------------------------|
| 1 | 89078 | NUT 1/2-20 JAM NYLON INSERTZPS | 55 | 21989 | WASHER LOCK INT TH #14 |
| 2 | 87619 | NUT 5/16-18 JAM | 56 | 21482 | SCREW TAP 8x0.500 PHPH |
| 3* | 8640502 | P-TXM20/DM18/400/600 PACKAGING | 57 | 20214 | NUT PUSH 1/2 PW500015 EZ |
| 4 | 8611803 | O-400/600 PIN THREADED .5x2.5 | 58 | 17301 | GROMMET .563IDx.750 GRVx.063 |
| 5 | 81380 | NUT 3/8-16 NYLON INSERT ZPS | 59 | 16774 | WASHER FLT .281x0.625x.063 ZPS |
| 6 | 73841 | TERM 18-14 RING 1/4 NON M | 60 | 16683 | WASHER FLT .375x0.875x.078 ZPS |
| 7 | 72223 | TERM BD 601-2-KT37, 38,39 | 61 | 15834 | SPRING HIX #105 |
| 8 | 71103 | SCREW FHSKT 3/8-16X2.500 | 62 | 15753 | SPRING GAS 125# P6909 |
| 9 | 70732 | DECAL HIX LOGO 4"x1" | 63 | 15751 | SOLENOID 120V PULL |
| 10 | 70693 | RETAINING RING EXT 0.500 E | 64 | 15446 | SCREW TAP 6x0.375 PHPH |
| 11 | 70362 | DECAL CERTIFIED GREEN | 65 | 15297 | SCREW MCH 6-32x0.500 PHPH |
| 12 | 70268 | DECAL HIX I.D. 3"x3" SILVER | 66 | 14910 | DECAL HOT SURFACE SYMBOL |
| 13 | 70009 | WASHER FLT .406x0.813x.080 ZPS | 67 | 14621 | NUT 6-32 ZPS |
| 14 | 68330 | WASHER LOCK HEL SPR #6 ZP | 68 | 14571 | NUT 3/8-16 ZPS |
| 15 | 65986 | BOLT 1/4-20x0.625 | 69 | 13919 | WASHER LOCK HEL SPR #4 ZP |
| 16 | 6505020 | M-STRAIN GAUGE COVER | 70 | 13250 | CORD GRIP HEYCO 1857 RDD201 |
| 17 | 6505015 | M-400/600/450/650 SPG EXT LINK | 71 | 13103 | SCREW MCH 4-40x0.750 RHSL |
| 18 | 6503021 | O-CVR HANDLE LONG 450/650 | 72 | 12378 | WASHER SPG STL .375x.750x.028 |
| 19 | 6501144 | P-400/600/450/650 TUBE DAMPEN2 | 73 | 12229 | WASHER FLT .500x1.250x.078 ZPS |
| 20 | 6501141 | M-450/650 LINK PIN MACHINED | 74 | 11349 | NUT 6-32 EXT TOOTH LOCK ZPS |
| 21 | 6500380 | M-450/650 HANDLE WELDMNT NEW | 75* | 11123 | WIRE KIT 450/650 120V ANT |
| 22 | 6500370 | M-450/650 LATCH ASSEMBLY | 76* | 11120 | MANUAL OWNERS HTM ANT |
| 23 | 64203 | WASHER FLT .515x0.875x.032 SS | 77 | 11025 | DECAL SILVER/RED EVO PRO |
| 24 | 63428 | STUD BALL FOR GAS SPRINGS | 78 | 10963 | DECAL QR CODE DXP ANT |
| 25 | 62731 | RELAY SS 25 A 3-32VDC INPUT | 79 | 10916 | DECAL LCD DISPLAY ANT |
| 26 | 6105036 | M-LINK ASSY 400/600 ANT | 80 | 10914 | SPACER .140x.250x.125 NYLON |
| 27 | 6105030 | O-400/450 PLATEN SPACER | 81 | 10911 | CONTROL DISPLAY BD 4.3" COLOR |
| 28 | 6105022 | M-450/650 PIN LOWER LIN | 82 | 10910 | CONTROL TEMP I/O BOARD ANT |
| 29 | 6105005 | M-DM18/400/600 PRSURE ADJ ROD | 83 | 10903 | POWER SUPPLY 5VDC 15W |
| 30 | 6105004 | M-HT400 PIN ROCKER LINK | 84 | 10868 | BOLT 3/8-16x1.250 |
| 31 | 6102008 | M-HT400 PIN MAIN ARM | 85 | 10793 | BOLT 5/16-18x1.750 |
| 32 | 6021041 | M-ROCKER LINK 400/600 ANT | 86 | 10769 | BOLT 5/16-18x1.000 |
| 33 | 6020065 | M-400/600/450/650 BASE WM ANT | 87 | 10664 | DECAL MADE IN THE USA ROUND |
| 34 | 6010062 | M-PAD 15x15x3/8 MED BLK MOLDED | 88 | 10347 | CIRCUIT BKR 1-POLE PTR 15A ST |
| 35 | 6001031 | M-400/600/450/650 ENC WDMT ANT | 89 | 10151 | KNOB 1/2-20 KNURLED |
| 36 | 6001006 | M-ENC BACK SHEET UNIVERSAL | 90 | 10133 | DECAL S-450 |
| 37 | 6000131 | M-MAIN ARM WLDMNT 400/600 ANT | 91 | 10012 | TRIM-LOK 150 B2 X 3/16 ALUM |
| 38 | 59886 | SCREW TAP 10-32x0.500 WHHX | 92 | 0101031 | M-ASSY PLATEN 15X15 120V ANT |
| 39 | 59816 | SCREW TAP 14x1.250 PHPH | 93 | 0101010 | M-400/600/DM MOUNTING BOARD |
| 40 | 50181 | SCREW TAP 1/4-20x0.500 WHHX | 94 | 0100004 | M-PLATEN 1515 STL |
| 41 | 39768 | CORDSET 120V 14/3 STOW 5-15P | 95 | 0100001 | M-UNIVERSAL ADJUSTMENT BLOCK |
| 42 | 39179 | GAUGE STRAIN | 96 | 10909 | SCREW MCH M3-0.5X3 PHP ZPS |
| 43 | 37001 | PIN DOWEL 0.125x1.250 | | | |
| 44 | 36846 | SCREW FHSKT 5/16-18x0.625 | | | |
| 45 | 36587 | SCREW MCH 6-32x0.250 PHPH | | | |
| 46 | 35408 | BUMPER 1/8X1/2 SQ BLK RUBBER | | | |
| 47 | 33605 | DECAL UNPLUG MACHINE | | | |
| 48 | 31823 | SWITCH MICRO SMALL SEMI-HOOK | | | |
| 49 | 30910 | WASHER LOCK HEL SPR 5/16 ZP | | | |
| 50 | 28010 | BUMPON BLACK .81"x.30" | | | |
| 51 | 26840 | HANDLE GRIP 3/4" FOAM BLK | | | |
| 52 | 25151 | NUT 1/2-20 JAM | | | |
| 53 | 2507074 | M-GENERIC HTM HANDLE | | | |
| 54 | 24732 | WASHER FLT .344x0.688x.063 ZPS | | | |

REPLACEMENT PARTS LIST (S-650 MODEL)

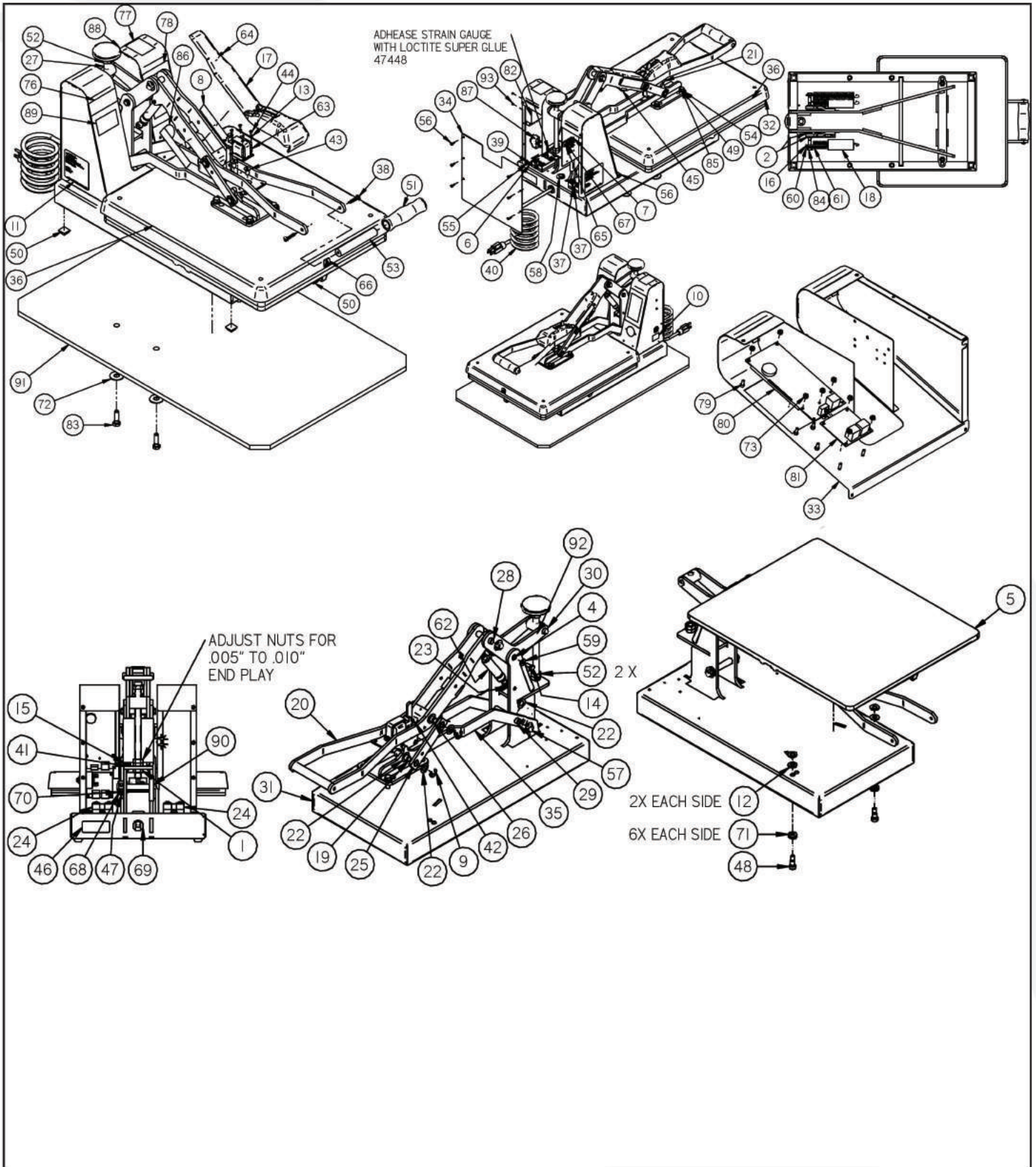

REPLACEMENT PARTS LIST

(S-650 MODEL)

| ITEM# | PART# | TITLE | ITEM# | PART# | TITLE |
|-------|---------|--------------------------------|-------|---------|--------------------------------|
| 1 | 89078 | NUT 1/2-20 JAM NYLON INSERTZPS | 55 | 21989 | WASHER LOCK INT TH #14 |
| 2 | 87619 | NUT 5/16-18 JAM | 56 | 21482 | SCREW TAP 8x0.500 PHPH |
| 3* | 8640502 | P-TXM20/DM18/400/600 PACKAGING | 57 | 20214 | NUT PUSH 1/2 PW500015 EZ |
| 4 | 8611803 | O-400/600 PIN THREADED .5x2.5 | 58 | 17301 | GROMMET .563IDx.750 GRVx.063 |
| 5 | 82768 | M-CASTING 16x20 LOWER F | 59 | 16774 | WASHER FLT .281x0.625x.063 ZPS |
| 6 | 73841 | TERM 18-14 RING 1/4 NON M | 60 | 16683 | WASHER FLT .375x0.875x.078 ZPS |
| 7 | 72223 | TERM BD 601-2-KT37,38,39 | 61 | 15834 | SPRING HIX #105 |
| 8 | 70732 | DECAL HIX LOGO 4"x1" | 62 | 15753 | SPRING GAS 125# P6909 |
| 9 | 70693 | RETAINING RING EXT 0.500 E | 63 | 15751 | SOLENOID 120V PULL |
| 10 | 70362 | DECAL CERTIFIED GREEN | 64 | 15446 | SCREW TAP 6x0.375 PHPH |
| 11 | 70268 | DECAL HIX I.D. 3"x3" SILVER | 65 | 15297 | SCREW MCH 6-32x0.500 PHPH |
| 12 | 70009 | WASHER FLT .406x0.813x.080 ZPS | 66 | 14910 | DECAL HOT SURFACE SYMBOL |
| 13 | 68330 | WASHER LOCK HEL SPR #6 ZP | 67 | 14621 | NUT 6-32 ZPS |
| 14 | 65986 | BOLT 1/4-20x0.625 | 68 | 13919 | WASHER LOCK HEL SPR #4 ZP |
| 15 | 6505020 | M-STRAIN GAUGE COVER | 69 | 13250 | CORD GRIP HEYCO 1857 RDD201 |
| 16 | 6505015 | M-400/600/450/650 SPG EXT LINK | 70 | 13103 | SCREW MCH 4-40x0.750 RHSL |
| 17 | 6503021 | O-CVR HANDLE LONG 450/650 | 71 | 12378 | WASHER SPG STL .375x.750x.028 |
| 18 | 6501144 | P-400/600/450/650 TUBE DAMPEN2 | 72 | 12229 | WASHER FLT .500x1.250x.078 ZPS |
| 19 | 6501141 | M-450/650 LINK PIN MACHINED | 73 | 11349 | NUT 6-32 EXT TOOTH LOCK ZPS |
| 20 | 6500380 | M-450/650 HANDLE WELDMNT NEW | 74* | 11123 | WIRE KIT 450/650 120V ANT |
| 21 | 6500370 | M-450/650 LATCH ASSEMBLY | 75* | 11120 | MANUAL OWNERS HTM ANT |
| 22 | 64203 | WASHER FLT .515x0.875x.032 SS | 76 | 11025 | DECAL SILVER/RED EVO PRO |
| 23 | 63428 | STUD BALL FOR GAS SPRINGS | 77 | 10963 | DECAL QR CODE DXP ANT |
| 24 | 62731 | RELAY SS 25A 3-32VDC INPUT | 78 | 10916 | DECAL LCD DISPLAY ANT |
| 25 | 6105036 | M-LINK ASSY 400/600 ANT | 79 | 10914 | SPACER .140x.250x.125 NYLON |
| 26 | 6105022 | M-450/650 PIN LOWER LIN | 80 | 10911 | CONTROL DISPLAY BD 4.3" COLOR |
| 27 | 6105005 | M-DM18/400/600 PRSURE ADJ ROD | 81 | 10910 | CONTROL TEMP I/O BOARD ANT |
| 28 | 6105004 | M-HT400 PIN ROCKER LINK | 82 | 10903 | POWER SUPPLY 5VDC 15W |
| 29 | 6102008 | M-HT400 PIN MAIN ARM | 83 | 10868 | BOLT 3/8-16x1.250 |
| 30 | 6021041 | M-ROCKER LINK 400/600 ANT | 84 | 10793 | BOLT 5/16-18x1.750 |
| 31 | 6020065 | M-400/600/450/650 BASE WM ANT | 85 | 10769 | BOLT 5/16-18x1.000 |
| 32 | 6010063 | M-PAD 16x20x1/2 MED BLK MOLDED | 86 | 10664 | DECAL MADE IN THE USA ROUND |
| 33 | 6001031 | M-400/600/450/650 ENC WDMT ANT | 87 | 10347 | CIRCUIT BKR 1-POLE PTR 15A ST |
| 34 | 6001006 | M-ENC BACK SHEET UNIVERSAL | 88 | 10151 | KNOB 1/2-20 KNURLED |
| 35 | 6000131 | M-MAIN ARM WLDMNT 400/600 ANT | 89 | 10134 | DECAL S-650 |
| 36 | 6000104 | M-PLATEN ASSY 16X20 120V ANT | 90 | 10012 | TRIM-LOK 150 B2 X 3/16 ALUM |
| 37 | 59886 | SCREW TAP 10-32x0.500 WHHX | 91 | 0101010 | M-400/600/DM MOUNTING BOARD |
| 38 | 59816 | SCREW TAP 14x1.250 PHPH | 92 | 0100001 | M-UNIVERSAL ADJUSTMENT BLOCK |
| 39 | 50181 | SCREW TAP 1/4-20x0.500 WHHX | 93 | 10909 | SCREW MCH M3-0.5X3 PHP ZPS |
| 40 | 39768 | CORDSET 120V 14/3 STOW 5-15P | | | |
| 41 | 39179 | GAUGE STRAIN | | | |
| 42 | 37001 | PIN DOWEL 0.125x1.250 | | | |
| 43 | 36846 | SCREW FHSKT 5/16-18x0.625 | | | |
| 44 | 36587 | SCREW MCH 6-32x0.250 PHPH | | | |
| 45 | 35408 | BUMPER 1/8X1/2 SQ BLK RUBBER | | | |
| 46 | 33605 | DECAL UNPLUG MACHINE | | | |
| 47 | 31823 | SWITCH MICRO SMALL SEMI-HOOK | | | |
| 48 | 30929 | BOLT SHOULDER 3/8x1/2x5/16-18 | | | |
| 49 | 30910 | WASHER LOCK HEL SPR 5/16 ZP | | | |
| 50 | 28010 | BUMPON BLACK .81"x.30" | | | |
| 51 | 26840 | HANDLE GRIP 3/4" FOAM BLK | | | |
| 52 | 25151 | NUT 1/2-20 JAM | | | |
| 53 | 2507074 | M-GENERIC HTM HANDLE | | | |
| 54 | 24732 | WASHER FLT .344x0.688x.063 ZPS | | | |

WARRANTY

BEFORE warranty repair you MUST get Prior Authorization: Call 1-800-835-0606 Warranty will be voided otherwise.

(Effective 9/1/2021)

HIX® Corporation (HIX) will automatically register the equipment on the date it was shipped to you or your distributor. If the equipment was not purchased directly from HIX, but through a distributor, please keep a copy of their sales invoice showing the serial number and date it was sold/shipped to you with this warranty. In this case, we will use the distributor's invoice date as the beginning warranty date. **STAPLE A COPY OF YOUR PROOF OF PURCHASE TO THIS WARRANTY** and keep in a safe place to provide verification of your warranty should a problem occur. Thank you.

Please fill in the following information and attach a copy of your receipt for your records.

Date Purchased: _____ **From:** _____
Model #: _____ **Serial #:** _____

This warranty applies to Graphics equipment manufactured by the HIX® Corporation (HIX), Pittsburg, Kansas, U.S.A. HIX warrants to the original purchaser, its Heat Transfer Machines, Ovens and Dryers, Printers, Spotheters and Exposure Units, against defects in workmanship and material, except for wear and tear for a period of "One Year" from the date of purchase. HIX warrants Accessories for a period of 90 days from the date of purchase. doughXpress® products are covered under separate warranty.

In the event of a defect, HIX, at its option, will repair, replace or substitute the defective item at no cost during this warranty period subject to the limitations of insurance and shipping costs stated below (excludes labor).

In the case of heat transfer presses (except the Hobby Lite® and Large Format presses), HIX warrants the heat casting for the "Life" of the machine for the original purchaser. If a part becomes obsolete at the time for repair, and/or cannot be reasonably substituted for, HIX will credit, at half the then current list price or last recorded price, only that part toward a new machine or any product HIX offers. This credit offer shall be the sole responsibility of the HIX in the event of an obsolete part.

This warranty does not cover belts, rail tape, pads, mug wraps, canvas, rubber blankets, bulbs, glass. Warranty does not cover damages due to accident, misuse/abuse, alterations or damage due to neglect, shipping or lack of proper lubrication or maintenance. HIX shall not be responsible for repairs or alterations made by any person without the prior written authorization by HIX. This warranty is the sole and exclusive warranty of HIX and no person, agent, distributor, or dealer of HIX is authorized to change, amend or modify the terms set forth herein, in whole or in part.

In the case of a problem with the equipment identified herein, HIX should be contacted during regular business hours to discuss the problem and verify an existing warranty. HIX personnel will assist the customer to correct any problems which can be corrected through operation or maintenance instructions, simple mechanical adjustments, or replacement of parts. In the event the problem cannot be corrected by phone, and upon the issuance of a return authorization by HIX, the equipment shall be returned to HIX or an authorized service representative. All insurance, packaging and shipment/freight costs are solely the responsibility of the customer, and not that of HIX, and HIX shall not be responsible for improper packaging, handling or damage in transit. Contact HIX customer service for complete return authorization information. Correct shipping boxes are available from HIX.

This expressed warranty is given in lieu of any and all other warranties, whether expressed or implied, including but not limited to those of merchantability and fitness for a particular purpose, and constitutes the only warranty made by HIX.

In no event shall HIX's liability for breach of warranty extend beyond the obligation to repair or replace the nonconforming goods. HIX shall not be liable for any other damages, either incidental or consequential, or the action as brought in contract, negligence or otherwise.

This warranty gives you specific legal rights and you may also have other rights which vary from state to state.



1201 E. 27th Terrace • Pittsburg, KS 66762 • U.S.A.

Phone: (800) 835-0606 • Fax: (620) 231-1598

Web site: hixcorp.com • E-Mail: support@hixcorp.com