

BEST TARPS, INC.

Roll Master Systems

RETAIL 2020 CATALOG



1-800-765-6127

2020 RETAIL



ROLL MASTER SYSTEMS®

BEST TARPS, INC. INTRODUCES

YOU HAVE HAD A MANUAL ROLL SYSTEM.....IT IS **TIME TO EVOLVE**

The **Roll Master Evolution Electric System** features our powerful Roll Master HD motor attached to our gear reduction system, insuring your tarp is tight and secure at all times with the exact torque needed for load protection and containment. This powerful system is designed to walk over heaped loads with ease.

The Evolution offers heavy duty black anodized arms backed by a lifetime warranty against breaking.

The Evolution can be fitted to most trailers in the industry. This system can be used to convert your manual crank system to one that opens and closes your tarp by the simple push of a button from the comfort of your truck, or by the optional remote control.



Part # EVOLUTION-DA	EVOLUTION DUAL ARM CONVERSION SYSTEM	1600
Part # EVOLUTION-SA	EVOLUTION SINGLE ARM CONVERSION SYSTEM	1325
Part # EVOLUTION-DAH	EVOLUTION DUAL ARM HINGED CONVERSION	1650

EVOLUTION PARTS -2020

PART # EVTMA-R COMPLETE REAR TRAILER MOUNT \$ 185

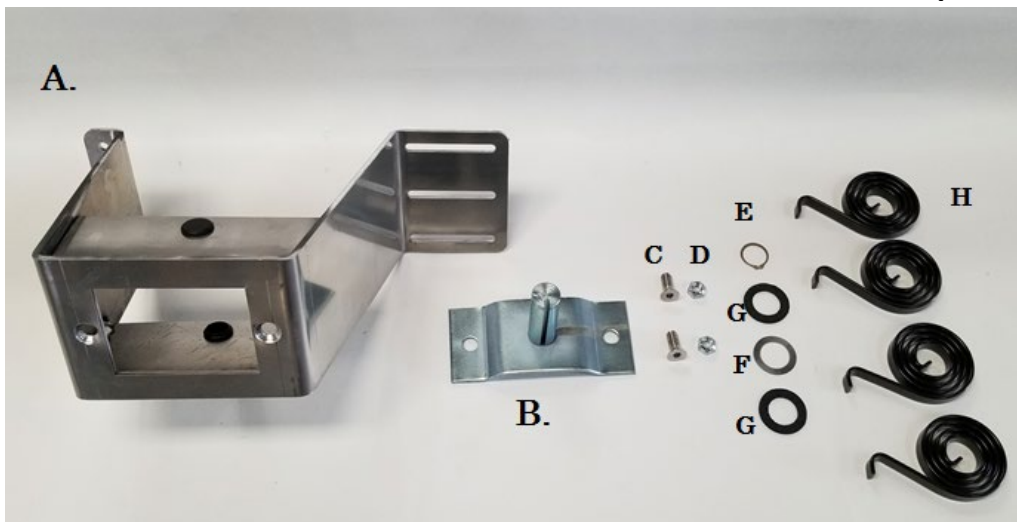

- | | |
|-------------|--|
| A. EV-LATMS | EVOLUTION LOWER ARM TRAILER MOUNT STAND \$ 110 |
| B. FTB-SMB4 | FTB/EVOLUTION STEEL 4 SPRING MOUNTING BRACKET \$ 28.00 |
| C. HDW-5 | HARDWARE- 1/2" X 1-1/4" STAINLESS FLAT HEAD HEX DRIVE SCREW 1.95 |
| D. HDW-12 | HARDWARE- 1/2" STAINLESS NYLON INSERT LOCKNUT .75 |
| E. FTB-SR | FTB/EVOLUTION SNAP RING 1.00 |
| F. FTB-SPW | FTB/EVOLUTION STEEL PIVOT WASHER 2.00 |
| G. EV-LAW1 | EVOLUTION LOWER ARM ABS 1/8" WASHER .85 |
| H. FTB-S | FTB/EVOLUTION SPRING 11.00 |

PART# EVLAA-R LOWER REAR ARM ASSEMBLY \$164

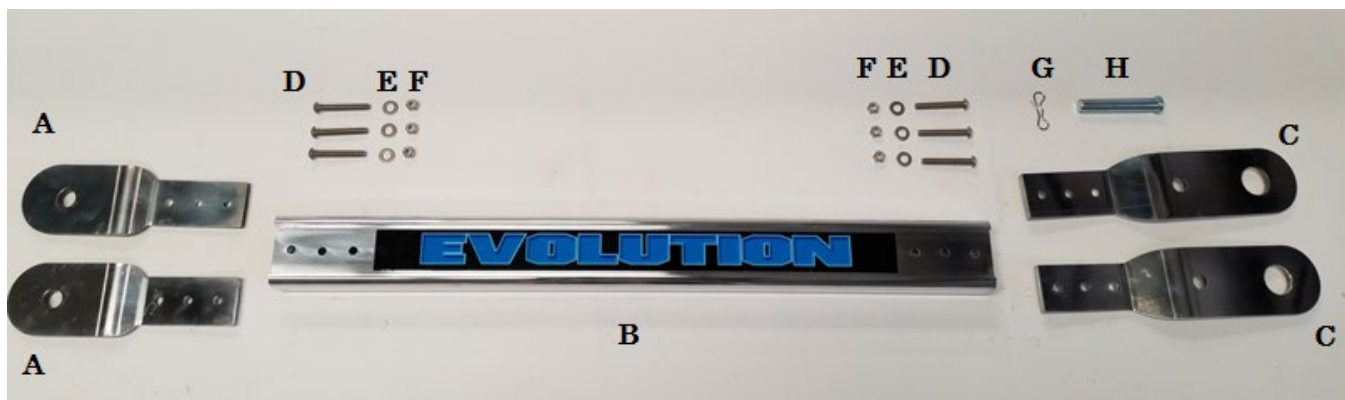

- | | |
|--------------|---|
| A. EV-LAPP | EVOLUTION LOWER ARM PIVOT PLATE \$ 24 |
| B. EV-LA | EVOLUTION LOWER ARM \$ 63 |
| C. EV-LASP24 | EVOLUTION LOWER ARM 4-SPRING PLATE \$ 21 |
| D. HDW-2 | HARDWARE- 5/16 X 2-1/4" STAINLESS BUTTON HEAD HEX DRIVE SCREWS 1.50 |
| E. HDW-14 | HARDWARE- 5/16 STAINLESS WASHER .35 |
| F. HDW-10 | HARDWARE- 5/16 STAINLESS NYLON INSERT LOCKNUT .45 |
| G. PIN-BT | BOW TIE PIN CLIP .20 |
| H. EV-PIN4 | EVOLUTION- 5/8 X 3-1/2 CLEVIS PIN \$ 3.75 |

EVOLUTION PARTS -2020

PART # **EVTMA-F** Complete Front Trailer Mount \$200

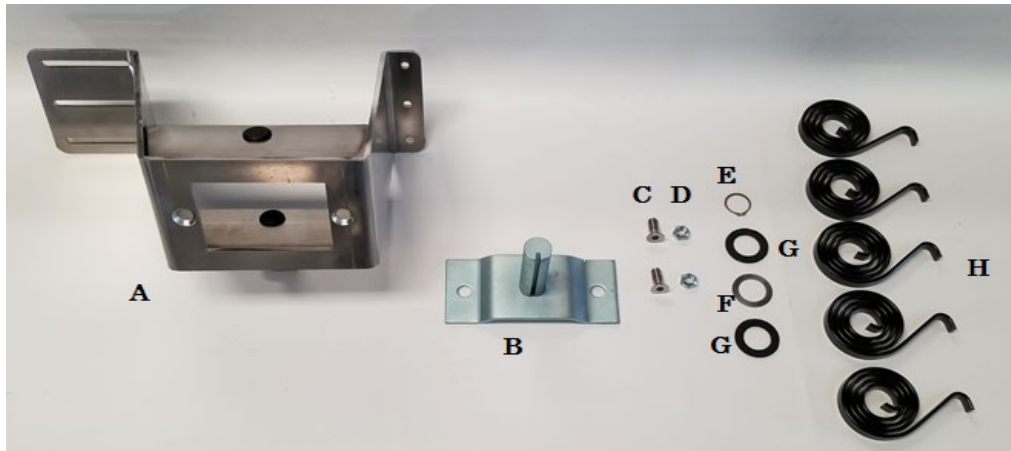

- | | | |
|-------------|---|----------|
| A. EV-LATMS | EVOLUTION LOWER ARM TRAILER MOUNT STAND | \$ 110 |
| B. FTB-SMB5 | FTB/EVOLUTION STEEL 5 SPRING MOUNTING BRACKET | \$ 36.00 |
| C. HDW-5 | HARDWARE- 1/2" X 1-1/4" STAINLESS FLAT HEAD HEX DRIVE SCREW | \$ 1.95 |
| D. HDW-12 | HARDWARE- 1/2" STAINLESS NYLON INSERT LOCKNUT | .75 |
| E. FTB-SR | FTB/EVOLUTION SNAP RING | 1.00 |
| F. FTB-SPW | FTB/EVOLUTION STEEL PIVOT WASHER | \$ 2.00 |
| G. EV-LAW1 | EVOLUTION LOWER ARM ABS 1/8" WASHER | .85 |
| H. FTBS | FTB/EVOLUTION SPRING | \$ 11 |

PART # **EVLAA-F** LOWER FRONT ARM ASSEMBLY \$175

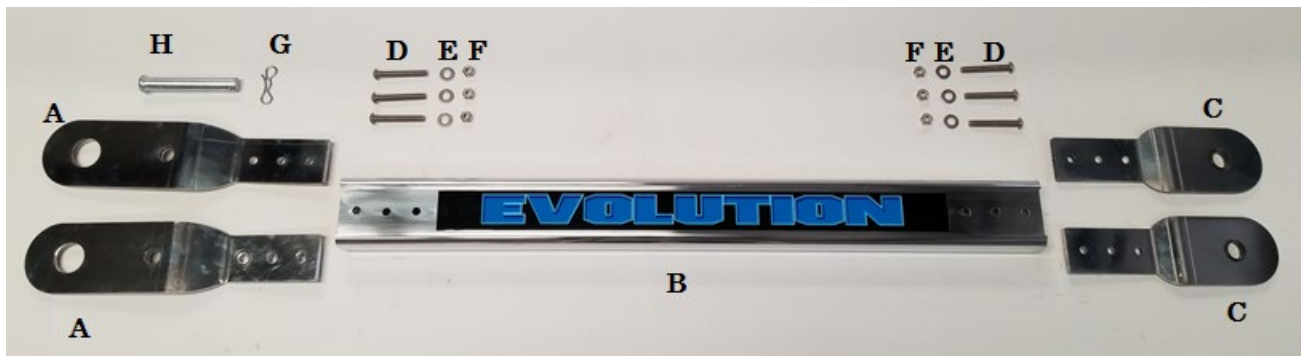

- | | | |
|--------------|--|----------|
| A. EV-LASP25 | EVOLUTION LOWER ARM 5-SPRING PLATE | \$ 15.50 |
| B. EV-LA | EVOLUTION LOWER ARM | \$ 63 |
| C. EV-LAPP | EVOLUTION LOWER ARM PIVOT PLATE | \$ 24 |
| D. HDW-2 | HARDWARE- 5/16 X 2-1/4" STAINLESS BUTTON HEAD HEX DRIVE SCREWS | 1.50 |
| E. HDW-14 | HARDWARE- 5/16 STAINLESS WASHER | .35 |
| F. HDW-10 | HARDWARE- 5/16 STAINLESS NYLON INSERT LOCKNUT | .45 |
| G. PIN-BT | BOW TIE PIN CLIP | .25 |
| H. EV-PIN5 | EVOLUTION- 5/8 X 4 CLEVIS PIN | \$ 5.00 |

PART # EVUAA-R

UPPER REAR ARM ASSEMBLY \$ 199

- A. EV-UAPR UPPER ARM PLATE REAR \$ 32
- B. EV-UAR UPPER ARM REAR \$ 60
- C. EV-UAWP UPPER ARM ABS WEAR PLATE \$ 18
- D. EV-UABP UPPER ARM BACKING PLATE \$ 12
- E. EV-S GAS STRUT \$ 28
- F. EV-SBU STRUT BRACKET UPPER \$ 6.50
- G. EV-SBL STRUT BRACKET LOWER \$ 6.50
- H. EV-SR EVOLUTION SNAP RING 3/4 1.00
- I. EV-UAW2 UPPER ARM STAINLESS WASHER \$ 2.10
- J. EV-PP EVOLUTION PIVOT PIN \$ 18.00
- K. HDW-11 3/8 STAINLESS NYLON INSERT LOCKNT .55
- L. HDW-6 3/8 X 1-1/2" STAINLESS SOCKET HEAD SCREW 1.50
- M. HDW-2 5/16 X 2-1/4" BUTTON HEAD HEX SCREW 1.50
- N. HDW-14 5/16 STAINLESS WASHER .35
- O. HDW-10 5/16 STAINLESS NYLON INSERT LOCKNUT .45
- P. HDW-16 10-24 STAINLESS SELF TAPPING SCREW .35
- Q. HDW-14 5/16 STAINLESS WASHERS .35
- R. EV-EC EVOLUTION 5/16 E-CLIP .35
- S. EV-SBP STRUT BRACKET PIN 5/16 X 1" 2.50
- T. EV-UAB UPPER ARM FLANGE BEARING \$ 24

PART # EVUAA-F

UPPER FRONT ARM ASSEMBLY \$ 230

- A. EV-UAMP UPPER ARM MOTOR PLATE \$ 55
- B. EV-UAF UPPER ARM FRONT \$ 60
- C. EV-WTB WIRE TERMINAL BLOCK \$ 22
- D. EV-UABP UPPER ARM BACKING PLATE \$ 12
- E. EV-S GAS STRUT \$ 28
- F. EV-SBU STRUT BRACKET UPPER \$ 6.50
- G. EV-SBL STRUT BRACKET LOWER \$ 6.50
- H. EV-SR EVOLUTION SNAP RING 3/4 1.00
- I. EV-UAW2 UPPER ARM STAINLESS WASHER 2.10
- J. EV-PP EVOLUTION PIVOT PIN \$ 18.00
- K. HDW-9 10-32 X 1" STAINLESS SOCKET HEAD SCREW .90
- L. HDW-3 5/16 X 2-1/2" BUTTON HEAD HEX SCREW 1.50
- M. HDW-1 5/16 X 2-3/4" MOTOR COVER SCREW 2.75
- N. HDW-14 5/16 STAINLESS WASHER .35
- O. HDW-10 5/16 STAINLESS NYLON INSERT LOCKNUT .45
- P. HDW-16 10-24 STAINLESS SELF TAPPING SCREW .35
- Q. HDW-14 5/16 STAINLESS WASHERS .35
- R. EV-EC EVOLUTION 5/16 E-CLIP .35
- S. EV-SBP STRUT BRACKET PIN 5/16 X 1" 2.50
- T. EV-UAB UPPER ARM FLANGE BEARING 24.00

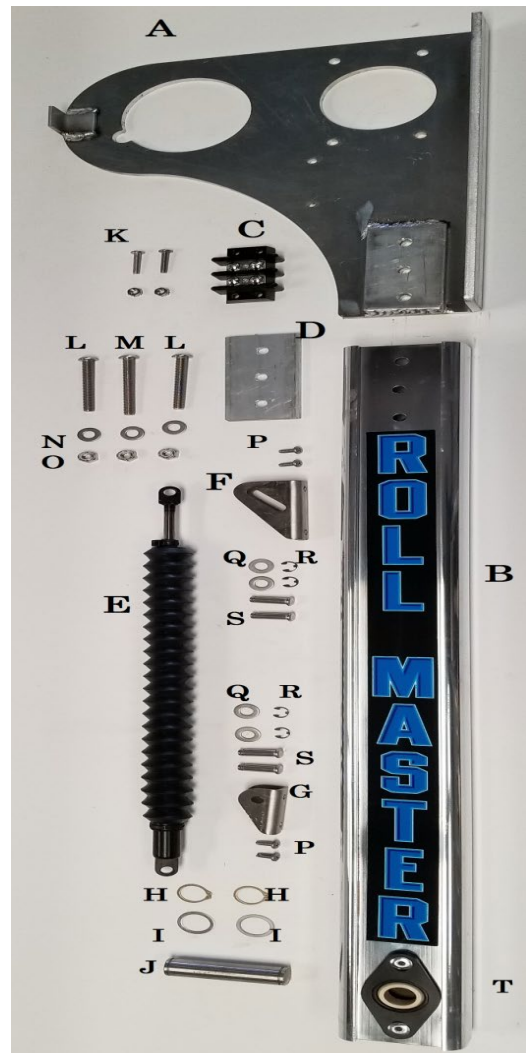
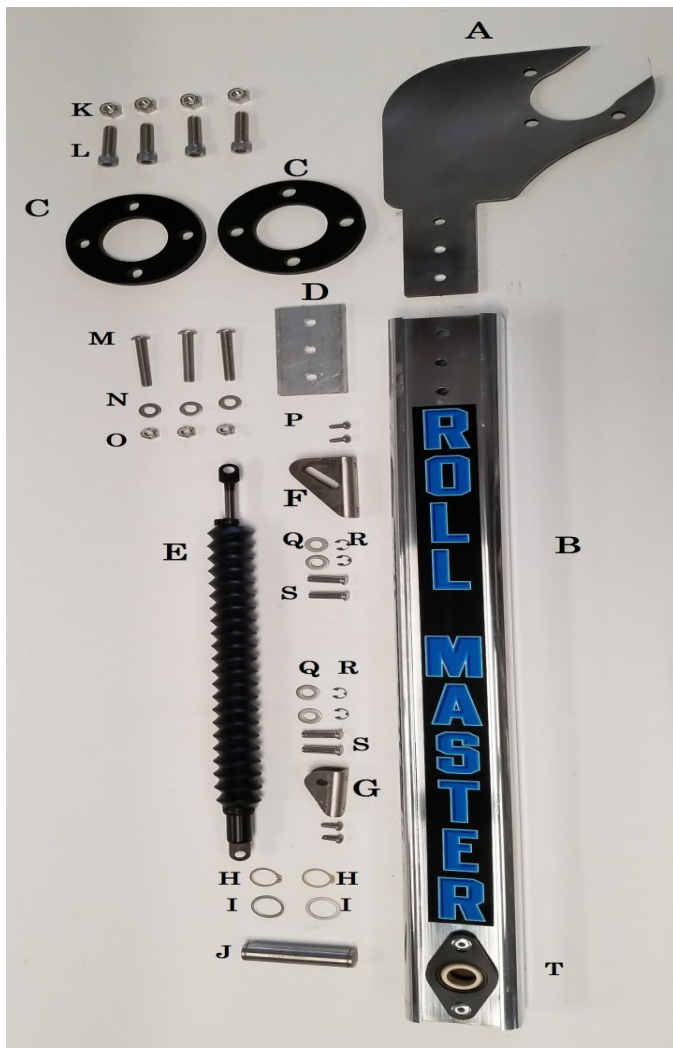

EVOLUTION HINGED REAR ARM ASSEMBLY Part # EV-HAA
COMPLETE ASSEMBLY (TOP AND BOTTOM) 435.00 PIC 1 AND 2 AND 3

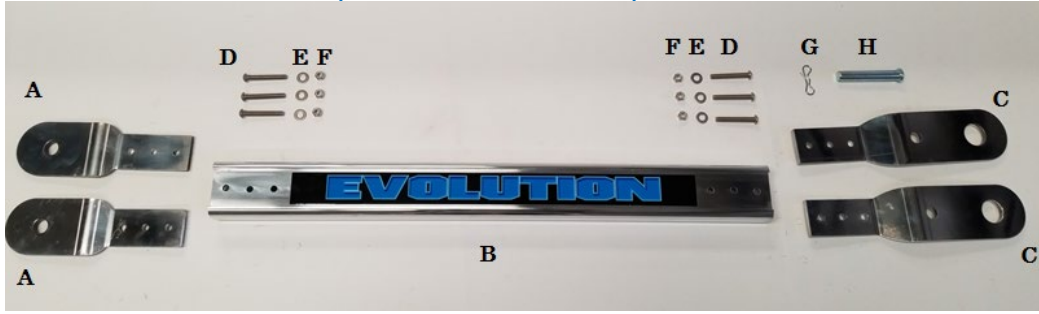

PIC 1

- PIC 1: PART# EVLAA-R LOWER REAR ARM ASSEMBLY \$ 164.00**
- A. EV-LAPP EVOLUTION LOWER ARM PIVOT PLATE \$ 24
 - B. EV-LA EVOLUTION LOWER ARM \$ 63
 - C. EV-LASP24 EVOLUTION LOWER ARM 4-SPRING PLATE \$ 21
 - D. HDW-2 HARDWARE- 5/16 X 2-1/4" STAINLESS BUTTON HEAD HEX DRIVE SCREWS 1.50
 - E. HDW-14 HARDWARE- 5/16 STAINLESS WASHER .35
 - F. HDW-10 HARDWARE- 5/16 STAINLESS NYLON INSERT LOCKNUT .45
 - G. PIN-BT BOW TIE PIN CLIP .25
 - H. EV-PIN4 EVOLUTION- 5/8 X 3-1/2 CLEVIS PIN \$ 3.75

- PIC 2: PART# EVHAU HINGED ARM UPPER \$ 200.00**
- A. EV-HCS HINGED UPPER ARM CONNECTING SHACKLE –PLATE ONLY \$ 45
 - B. EV-HUAR HINGED UPPER ARM REAR \$ 60
 - C. EV-UAWP UPPER ARM ABS WEAR PLATE -EACH \$ 18 (REQUIRES 2)
 - D. EV-HC HINGED ARM CHAIN 9.00
 - E. EV-HAP HINGED ARM PLATE 2"X 8" X 1/4" -EACH 13.50 (REQUIRES 2)
 - F. EV-UAB UPPER ARM FLANGE BEARING \$ 24
 - H. EV-SR EVOLUTION SNAP RING 3/4 1.00 EA (REQUIRES 2)
 - I. EV-UAW2 UPPER ARM STAINLESS WASHER \$ 2.10 EA (REQUIRES 2)
 - J. EV-PP EVOLUTION PIVOT PIN \$ 18.00



PIC 2

- PART # EVTMA-R COMPLETE REAR TRAILER MOUNT \$ 185**
- A. EV-LATMS LOWER ARM TRAILER MOUNT STAND \$ 110
 - B. FTB-SMB4 EVOLUTION STEEL 4 SPRING MOUNTING BRACKET \$ 28
 - C. HDW-5 1/2" X 1-1/4" FLAT HEAD HEX DRIVE SCREW 1.95
 - D. HDW-12 1/2" STAINLESS NYLON INSERT LOCKNUT .75
 - E. FTB-SR EVOLUTION SNAP RING 1.00
 - F. FTB-SPW EVOLUTION STEEL PIVOT WASHER 2.00
 - G. EV-LAW1 EVOLUTION LOWER ARM ABS 1/8" WASHER .85
 - H. FTB-S FTB/EVOLUTION SPRING 11.00

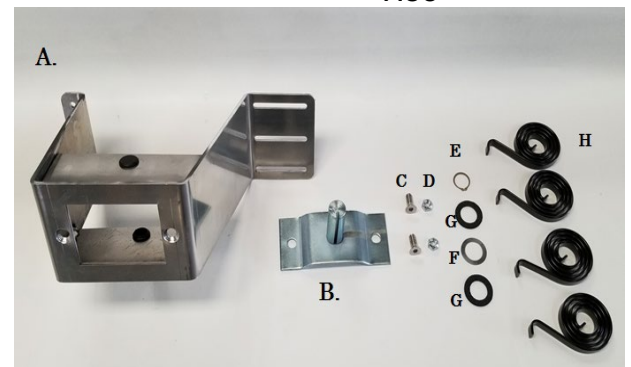

PIC 3

PART # EV-MMA MOTOR MOUNT ASSEMBLY COMPLETE \$ 475

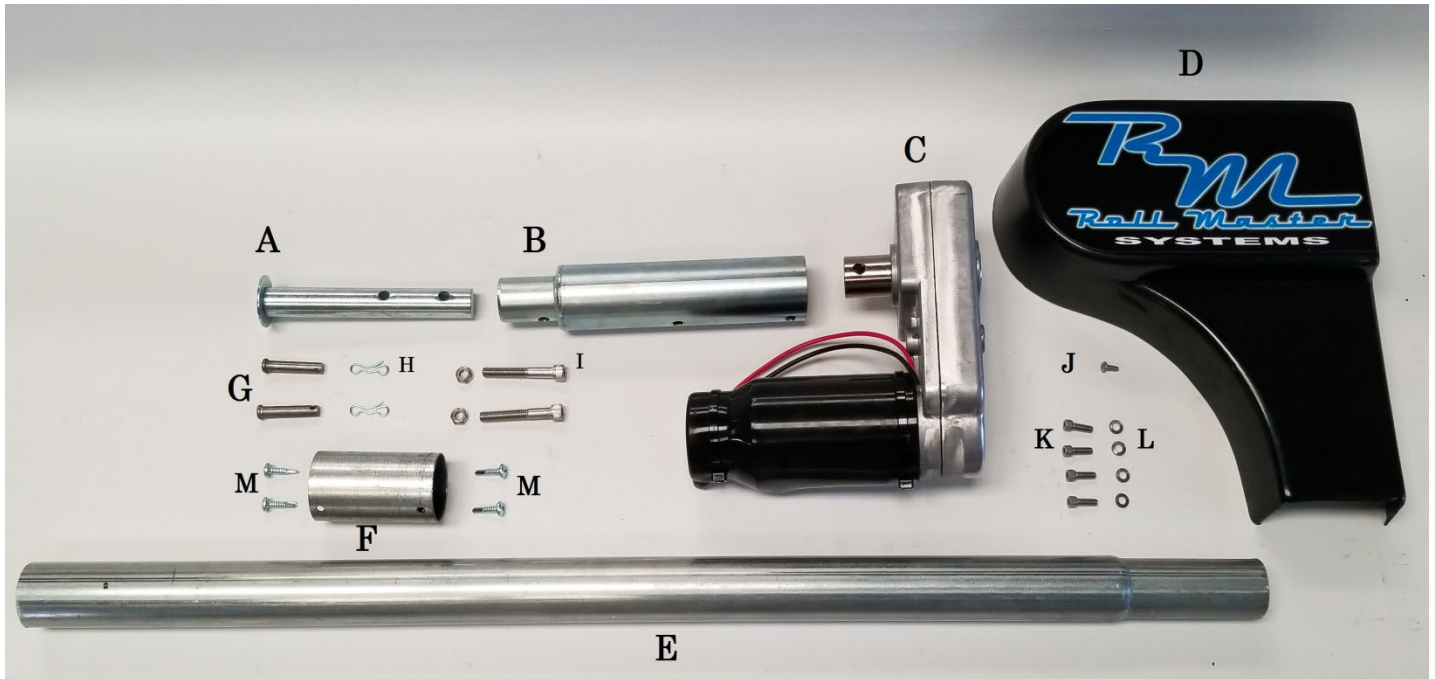

A. EV-MS	MOTOR SHAFT 1" X 7"	\$ 21
B. EV-MSC	MOTOR SHAFT CONNECTOR	\$ 37
C. EV-M	EVOLUTION MOTOR	\$ 325
D. EV-MC	EVOLUTION MOTOR COVER	\$ 50
E. EV-RTE	ROLL TUBE EXTENDER 36"	\$ 21
F. EV-PS	PIPE SLEEVE	\$ 8.00

G. EV-MCP	MOTOR CLEVIS PIN	\$ 3.50
H. PIN-BT	BOW TIE CLIP	.25
I. HDW-7	3/8 X 2-1/2 SOCKET HD SCREW	\$ 2.50
J. HDW-16	10-24 SELF TAP SCREW	.35
K. HDW-8	1/4 X 3/4 SOCKET HEAD SCREW	.80
L. HDW-13	1/4 SPLIT LOCK WASHER	.10
M. UC02	3/4 SELF TAPPING SCREW	.25

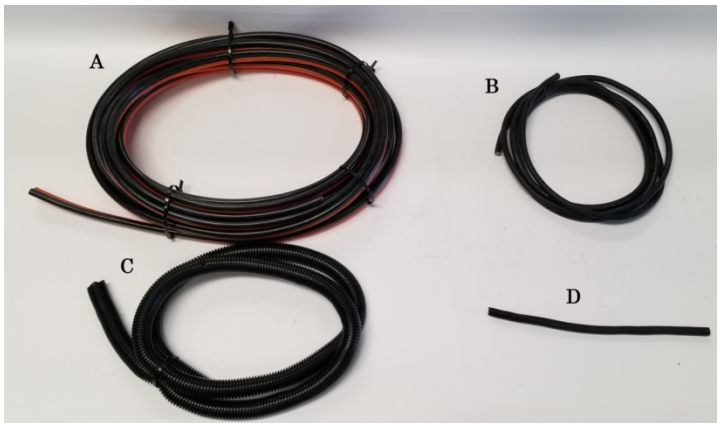

A	FTBW6-40	6 GA WIRE 40' SPOOL	\$ 120
B	FTBW14-12	14 GA WIRE 12' SPOOL	\$15.00
C	EV-WL1	3/4 WIRE LOOM 6'	2.75
D	EV-WL2	SMALL WIRE LOOM 1'	2.25



EV-RR	EVOLUTION REAR RETURN COMPLETE	\$ 70
A	EV-RC	REAR COLLAR \$ 23
B	EV-EG	REAR GUIDE \$ 20
C	RETURN-ER	1/2" X 12' RETURN CORD \$ 12
D	BOLT-ST	3/8 SELF TAP BOLTS .65



**ROLL MASTER EVOLUTION SYSTEMS
ELECTRIC REPLACEMENT PARTS**

EV-MC MOTOR COVER \$ 50



**EV-MO EVOLUTION
MOTOR ONLY
\$ 325**



**EV-M EVOLUTION
MOTOR & COVER
\$ 365**



**FTB-EB \$ 7
50-AMP BREAKER**

**EV-RB REMOTE BOX
WITH KEY FOB
\$ 325**



**FTB-ES
SOLENOID \$65**



**ROCKER SWITCH KIT
\$ 85**

**EV-WTB
WIRE TERMINAL BLOCK**



TARP TUBES AND ACCESSORIES



ITEM	PART #	DESCRIPTION	
9.	CONN01	1 1/8" PIPE CONNECTOR	13.00
10.	CONN02	2" PIPE CONNECTOR	15.00
11.	SPLINE	SPLINE SHAFT	32.00
12.	SPLINE02	SPLINE SHAFT W/CONNECTOR	40.00
13.	UC01	U-CLAMP	1.00
	UC02-L	U-CLAMP SCREWS 1"	.25
15.	SQCOG	SQUARE COG	12.00

10

ROLL TUBE DEFLECTORS

PROTECT THE SIDE OF YOUR TRAILER

- 1. PIPE-D **BLACK PLASTIC ROLL TUBE DEFLECTOR** **10.00**
- 2. PIPE-DM **METAL ROLL TUBE DEFLECTOR** **15.00**



1.	RETURN02	COMPLETE ROLL RETURN ASSEMBLY	29.00
2.	RETURN01	RETURN ROPE 3/8 X 12 FOOT LONG	9.00
3.	RETURN03	RETURN END PLUG-NLYON	9.00
4.	RETURN04	RETURN EYE BOLT	2.50
5.	RETURN05	RETURN ROPE-BULK 300 FT SPOOL @.60 Per ft.	180.00
6.	RETURN06	PVC TUBE – 10 FT LONG-2 5' SECTIONS	9.00
7.	RETURNRD	REAR RETURN DELUX	105.00
8.	RETURNRDC	CABLE ONLY	26.50



TARP STOPS



STOPSWA



STOPRC



stop-oc

STOPOC



STOP01



STOP03

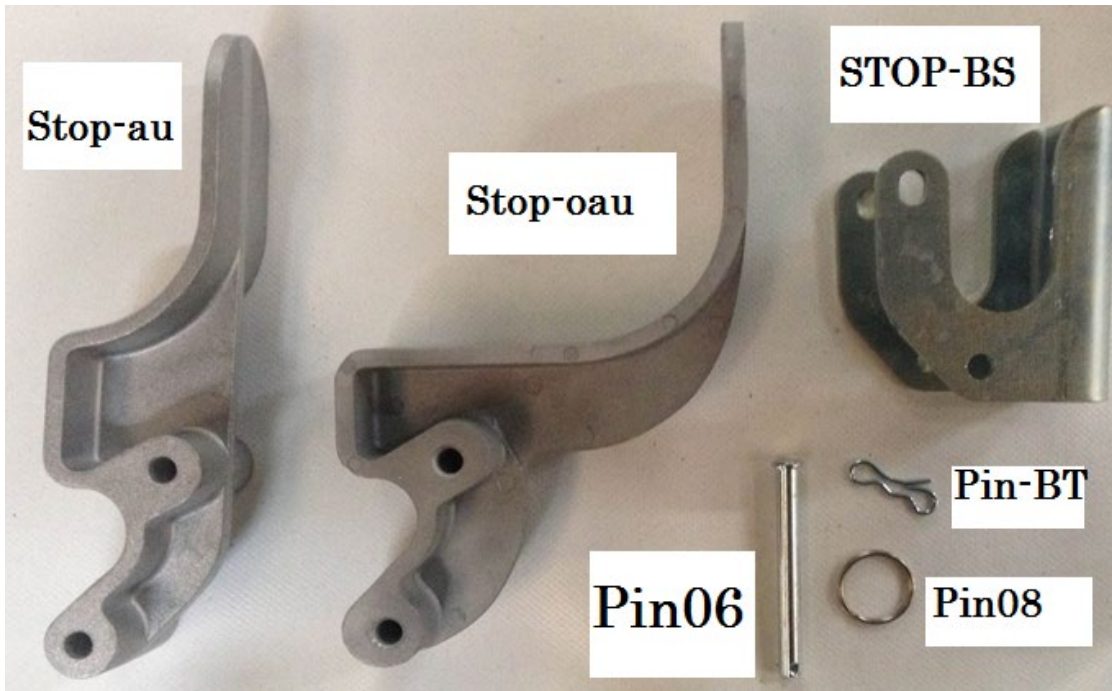

Stop-au

Stop-oau

STOP-BS

Pin-BT

Pin06

Pin08



STOP-R

TARP STOPS

1.	STOP01	STANDARD TARP STOP	6.50
2.	STOP03	TOP MOUNT TARP STOP	8.50
3.	STOPSWA	STANDARD EZ OFF STOP W/ALUM UPRITE	18.50
4.	STOPOC	OFFSET EZ STOP W/6"OFFSET ALUM UPRITE	23.00
INDIVIDUAL STOP PARTS			
7.	STOPAU	STANDARD ALUMINUM UPRITE	9.50
8.	STOPOAU	6" OFFSET ALUMINUM UPRITE	14.00
9.	STOPBS	EZ OFF STEEL MOUNT BRACKET	7.00
10.	PIN03	CLEVIS PIN W/BOW TIE	2.50
11.	BOLT-ST	3/8 SELF TAPPING BOLT	.65
13.	STOP-R	3" STANDARD RUBBER UPRIGHTS :	21.00
14.	STOP-RC	3" RUBBER COMPLETE EZ OFF	28.00

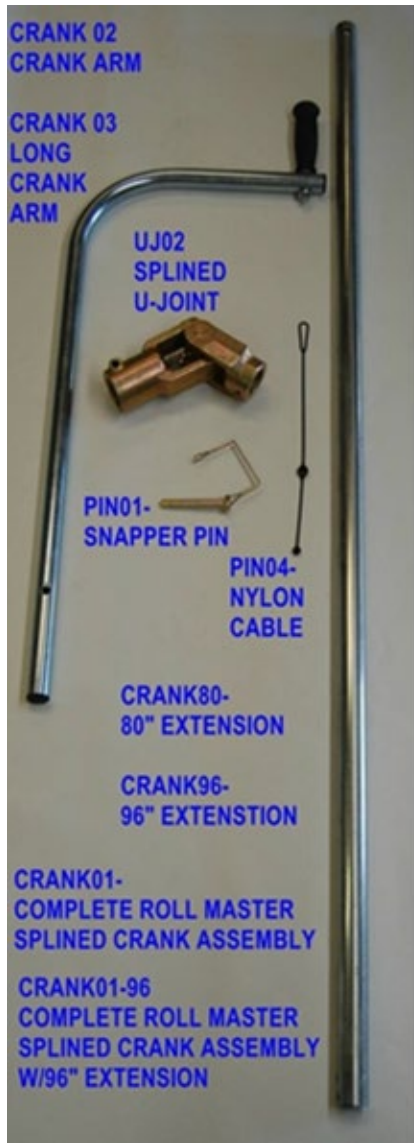

CRANK02- STANDARD CRANK ARM 28"
CRANK03- LONG CRANK ARM 50"



CRANK06 NYLON CRANK GRIP
CRANK21 BOLT NUT AND WASHER
CRANK06-WB CRANK GRIP W/BOLT

14 **2020** CRANK ASSEMBLIES

ITEM	PART #	DESCRIPTION	PRICE
1.	CRANK01	STD. L-SERIES SPLINED CRANK ASSEMBLY	99.00
2.	CRANK01-B	LONG L-SERIES SPLINED CRANK ASSEMBLY	105.00
3.	PIN01	SNAPPER PIN	2.50
4.	PIN05	SPRING PIN	.80
5.	UJ02	SPLINED U-JOINT	46.00
6.	CRANK02	STANDARD CRANK ARM	30.00
7.	CRANK03	LONG CRANK ARM	32.00
8.	CRANK80	80" EXTENSION POLE	35.00
	CRANK96	96" EXTENSION POLE	39.00
9.	CRANK06-WB	PLASTIC CRANK GRIP W/BOLT	8.60
10.	CRANK21	HANDLE BOLT	1.60

ITEM	PART #	DESCRIPTION	PRICE
1.	CRANK18	BREAKING CRANK ASSEMBLY W/40" EXT	145.00
2.	CRANK18-54	BREAKING CRANK ASSEMBLY W/54" EXT	150.00
	CRANK18-80	W/80" EXT	154.00
	CRANK18-96	BREAKING CRANK W/96" EXT	158.00
3.	CRANK40	40" EXTENSION	31.50
4.	CRANK54	54" EXTENSION	36.50
5.	CRANK20	20" EXTENSION	27.00
6.	CRANK15	MALE KNUCKLE	22.50
7.	CRANK16	FEMALE KNUCKLE	22.50
8.	CRANK17	SLIDE LOCKING TUBE	14.50
9.	CRANK02	STANDARD CRANK ARM	30.00
10.	UJ02	SPLINED U-JOINT	46.00

40" CONVERSION 113.00 54" CONVERSION 117.00

ITEM	PART #	DESCRIPTION	PRICE
1.	CRANK04	RTS CRANK ASSEMBLY W/RETAINERS	72.00
2.	CRANK12	RTS CRANK ASSEMBLY ONLY-NO RETAINERS	65.00
3.	UJ03	RTS U-JOINT	32.50
4.	CRANK14	SQUARE KEY	9.00
5.	CRANK05	RTS CRANK ARM	31.50

15

CRANK HANDLE RETAINERS



RETAIN01-SINGLE RETAINER HOOK



**PIN01-SNAPPER
PIN**

PIN04-NYLON PIN CABLE KEEPER



**RETAIN02-COMPLETE
SWIVEL PINLESS RETAINER**



**RETAIN03-SPRING-LOK
RETAINER COMPLETE**



**RETAIN-06
PINLESS HOOK**



**RETAIN-07
7" STAND**



RETAIN04-SPRING LOK CONVERSION KIT



**RETAIN-C
CLEVIS & COTTER**



RETAIN-SL SPRING LOK



**RETAIN-B
BASE PLATE**



**RETAIN-S
RETAINER SPRING**



**RETAIN-W
1/4" FLAT WASHER**



**BOLT-ST
3/8 SELF TAPPING**

16. CRANK RETAINERS

ITEM	PART #	DESCRIPTION	PRICE
1.	RETAIN01	SINGLE RETAINER	8.50
2.	PIN01	SNAPPER PIN	2.50
3.	PIN04	NYLON CABLE FOR SNAPPER PIN	1.00
4.	RETAIN02	SWIVEL PINLESS CRANK RETAINER	22.00
5.	RETAIN07	7" RETAINER STAND ONLY	11.00
6.	RETAIN06	PINLESS RETAINER HOOK ONLY	14.00
7.	RETAIN03	COMPLETE SPRING-LOK RETAINER	22.00
8.	RETAIN04	SPRING-LOK CONVERSION	14.00

TARP BOWS



**STANDARD 1" AND 1-1/4"
GALVANIZED BOWS**

BOWS

Part #	Pic	Description	Price
BOW02	E	1" BOW SHANK ONLY	5.00
BOW08	C	1-1/4" BOW SHANK ONLY	7.00
BOW03	F	1" STEEL BOW BRACKET ONLY	6.00
BOW21	D	1-1/4" STEE4L BOW BRACKET ONLY	6.50



RED
BLUE
GRAY
BLACK
WHITE
GREEN

HEAVY DUTY 18 OZ VINYL TARP REPAIR TAPE

THE ULTIMATE FIRST AID FOR REPAIRING RIPS TEARS OR HOLES IN YOUR TARP. SIMPLY CUT TO SIZE, PEEL OFF THE BACKING AND PLACE OVER THE HOLE.

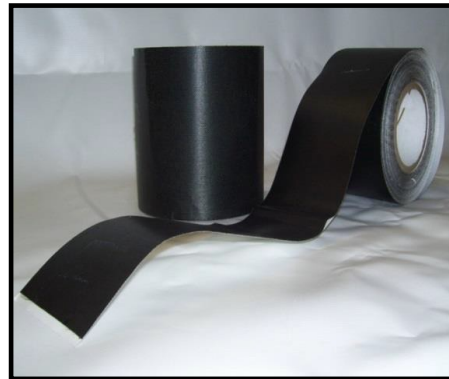
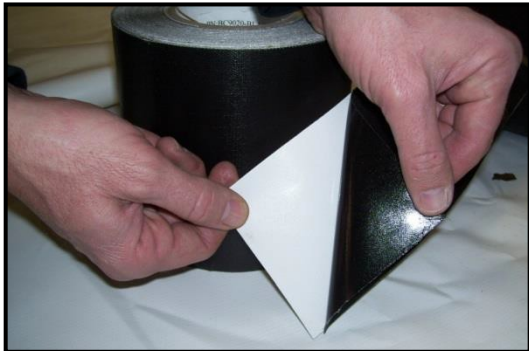

Part # Patch6-roll 6"x50' roll 18 oz repair tape \$ 60
Part # Patch6-10 6" x 10' roll patch tape \$ 17.50

HH-66 VINYL CEMENT KITS

ITEM	PART #	DESCRIPTION	
1.	GLUE-8	HH-66 8 oz GLUE ONLY	12.50
			20.00
2.	GLUE-Q	HH-66 Quart GLUE ONLY	
			41.00
3.	GLUE-G	HH-66 Gallon GLUE ONLY	
4.	GLUE-M	ROLLS OF MATERIAL ONLY -COLOR YOUR CHOICE	3.50



RIDGE STRAP ASSEMBLIES

1" RIDGE STRAPS

ITEM PART #	DESCRIPTION	
1. STRAPA1-46FP	RIDGE STRAP ASSEMBLY 1" X 46' W/FLAT PLATE	25.50
2. STRAPA1-46H	RIDGE STRAP ASSEMBLY 1" X 46' W/HOOK	25.50
3. STRAP1-46FP	RIDGE STRAP ONLY 1" X 46' W/FLAT PLATE	17.50
4. STRAP1-46H	RIDGE STRAP ONLY 1" X 46' W/HOOK	17.50
5. STRAPR1-FP	1" RATCHET W/1" WEB STRAP & FLAT PLATE	13.75
6. STRAPR1-H	1" RATCHET W/1" WEB STRAP & HOOK	13.75

2" RIDGE STRAPS

ITEM PART #	DESCRIPTION	
1. STRAPA2-46FP	RIDGE STRAP ASSEMBLY 2" X 46' W/FLAT PLATE	27.50
2. STRAPA2-46H	RIDGE STRAP ASSEMBLY 2" X 46' W/HOOK	27.50
3. STRAP2-46FP	RIDGE STRAP ONLY 2" X 46' W/FLAT PLATE	19.50
4. STRAP2-46H	RIDGE STRAP ONLY 2" X 46' W/HOOK	19.50
5. STRAPR2-FP	2" RATCHET W/2" WEB STRAP & FLAT PLATE	14.25
6. STRAPR2-H	2" RATCHET W/2" WEB STRAP & HOOK	14.25

FLAT BED TARPS

THE DRIVER'S EDGE TARP SHOP

FLAT BED TARPS **FOR: Tarps in stock -Black**

PART NUMBER: COIL6

6' Coil Bag 22 OZ VINYL 165.00

PART NUMBER: ST16/16

16' x 16' -18 oz blk
each w/2 rows of d's on all 4 side 170.00

PART NUMBER: ST16/27

16' x 27' -18 oz blk
w/2 rows d's all 4 sides 260.00

PART NUMBER: ST16/27WF

16' x 27' w/flap -18oz blk
w/2 rows d's per diagram 270.00

PART NUMBER: LT6D

6' Drop Tarp-
18 oz top/14 oz sides
20'x27'w/flap
3 rows of d-rings 320.00

PART NUMBER: LT8D

8' Drop Tarp
18 oz top/14 oz sides
24'6"x27' w/flap
3 rows of d-rings 370.00

LUMBER TARPS

6 foot Drops and 8 foot Drops



6' DROP LUMBER TARPS 18 OZ TOPS 14 OZ SIDES

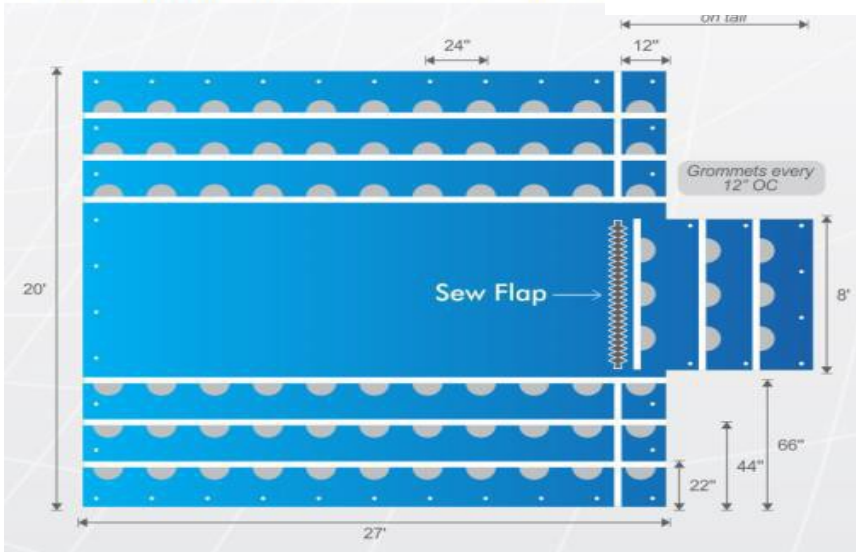

6' DROPS
FINISHED SIZE
20' X 27' PLUS A 6' FLAP
ON ONE END

3 ROWS OF D'S AT
22" 44" 66"
GROMMETTS ON EDGE

18OZ VINYL TOPS

8 foot drop Lumber Tarps 18 oz Top 14 oz sides

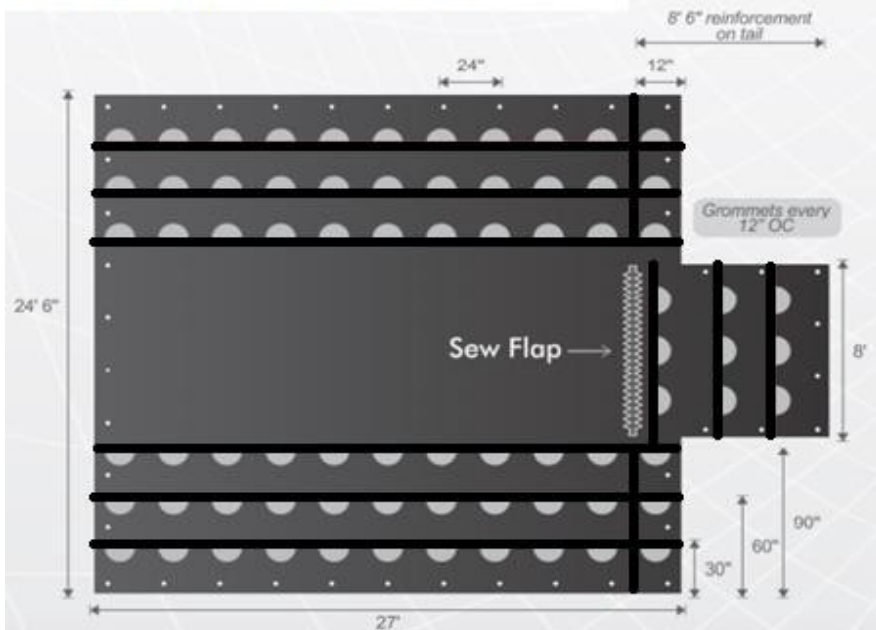

8'DROPS
FINISHED SIZE
24'6" X 27' PLUS A 8'
FLAP
ON ONE END

3 ROWS OF D'S AT
30" 60" 90"
GROMMETTS ON EDGE

18 OZ VINYL TOP

STEEL TARPS

HIGH QUALITY TRUCK TARPS



Steel tarp 18oz.

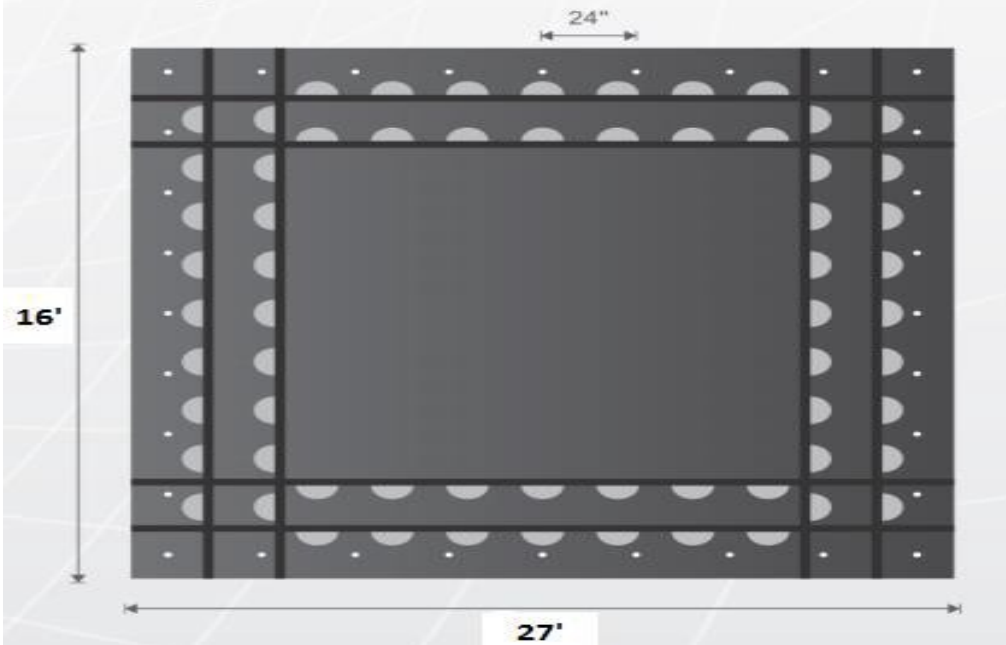

16' X 27'
2 ROWS OF D-RINGS
ALL 4 SIDES
SPACED AT 24" & 48"
GROMETTS ON EDGE
EVERY 24"

4' DROP STEEL/LUMBER TARP WITH FLAP

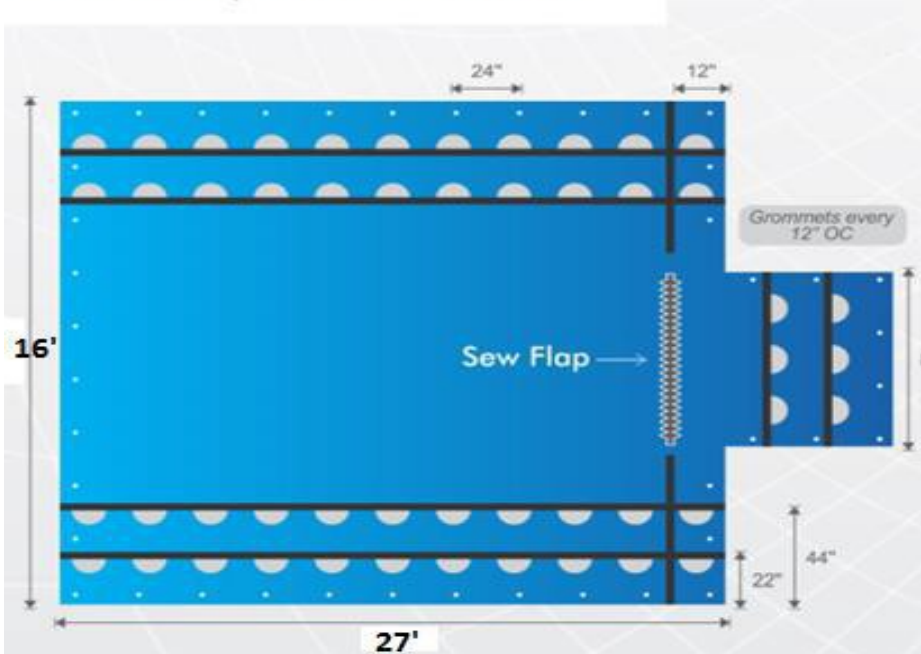

16' X 27' w/4' flap
2 ROWS OF D-RINGS
on 27' sides & flap
SPACED AT 22" & 44"
GROMETTS ON EDGE
EVERY 24"



**COIL BAGS AND
16X16 FLAT STEEL TARP**

6'6" X 6' X 5'6"
22 OZ VINYL
COIL BAGS

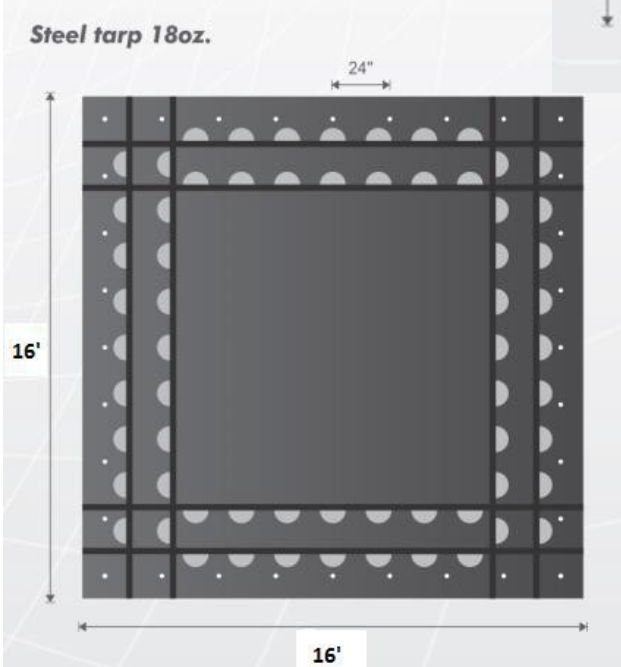
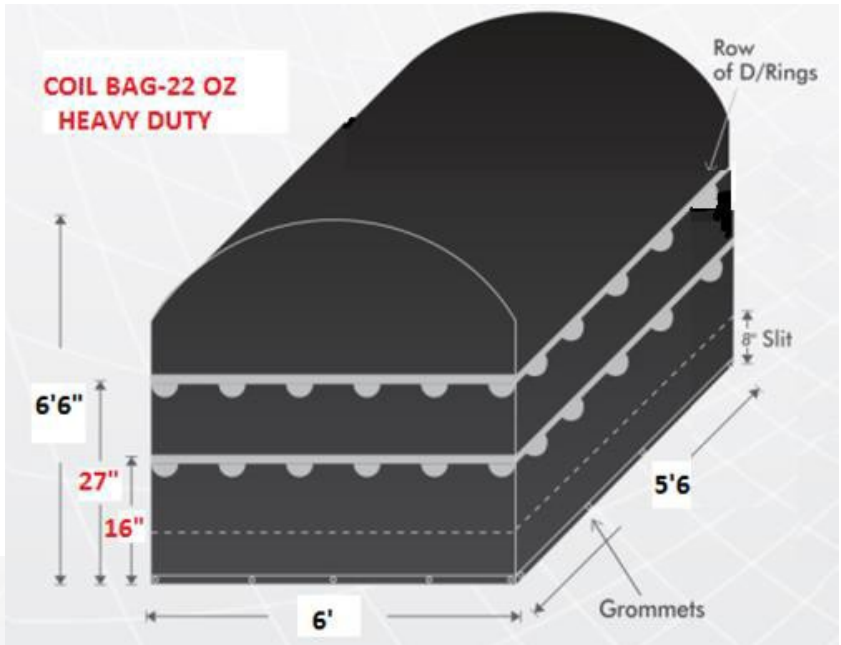

16' X 16'
2 ROWS OF D-RINGS
on all 4 sides

GROMMETTS ON EDGE
EVERY 24"

FTB ROLL MASTER STEEL PARTS

PART NUMBER : FTB-S

FTB SPRING- TORSION SPRING

\$ 11.00



PART NUMBER: FTB-SMB4

FTB STEEL MOUNTING BRACKET-4 SPRING

\$ 28.00



PART NUMBER: FTB-SMB5

FTB STEEL MOUNTING BRACKET-5 SPRING

\$ 36.00

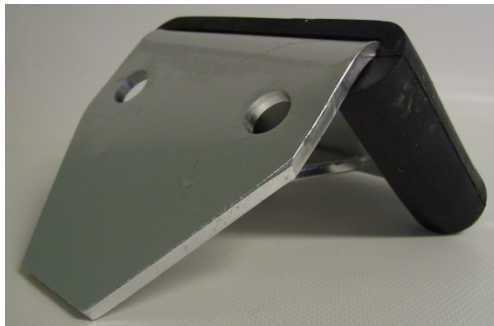

PART NUMBER: FTB-APR

FTB-ALUMINUM PIVOT REST

\$ 25.00



PART NUMBER: FTB-SPW

FTB-PIVOT MOUNT WASHER

\$ 2.00



PART NUMBER: FTB-SR

FTB-SNAP RINGS

\$.75

FTB WIND DEFLECTOR & PARTS

PART # FTB-WDP

WIND DEFLECTOR SIDE PLATE

\$ 22.50

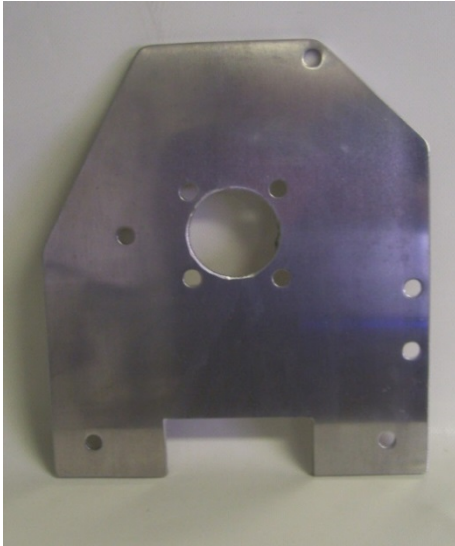

PART # FTB-B

FTB BEARING

\$ 14.00



PART # FTBA90

ALUMINUM 90 DEGREE ELBOW

\$ 28.00



PART # FTB APR

ALUMINUM PIVOT REST \$ 25.00

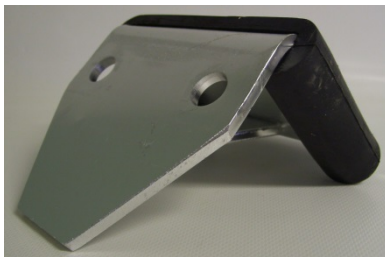

1-800-765-6127
ROLL MASTER
SYSTEMS



PART # FTBM-A
 SMALL BOT MOTOR
 FOR BEDS UP TO 20 FT
 \$ 245.00



PART # FTB ESK1- SWITCH KIT \$85



PART # FTBM-HD
 TARP BOT MOTOR \$ 275.00
 FOR BEDS OVER 20 FT



FTB-ES SILENOID \$ 65



FTBW6 6G WIRE 2.00 per ft



FTB-EB 50 AMP BREAKER
 7.00



FTB-ESO1
 SWITCH ONLY \$ 15



FTBW14 14G WIRE 1.20 FT



FTB-MC
 MOTOR COVER
 \$ 22.00



FTB-ETPS TRAILER PLUG SET \$ 45



FTB-TPF FEMALE END \$ 23

FTB-TPM MALE END \$ 23





BEST TARPS, INC. IS YOUR CARGO CONTROL HEADQUARTERS

BEST

PRE-CRIMPED HOOKS

BOXES OF 50

S21 21" STRAPS \$ 39.50
S31 31" STRAPS \$ 49.50



**PART # CARGO-BANNER
REVERSIBLE BANNER
12.00**

**PART # CARGO-FLAG
18x18 red flags 3.50**



**Part # CARGOTG
Tarp Corner Guard
3.00**



**CARGOP
Tarp Pad/Blanket
72"x80"
\$12**

**CARGOFB
Load Shield-Felt Blanket
12'5" x 20 ft
\$85**



CARGO STRAPS

CARGO1
 2" x 30' Strap w/ratchet
 16.00
 Ratchet only 11.00

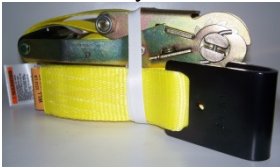

CARGO2
 2" x 30' Strap Only
 8.00

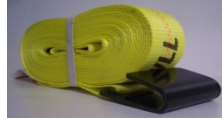

CARGO4C
 4" x 30' Strap w/ratchet
 39.00
 Ratchet only 30.00



CARGO4
 4" x 30' Strap
 12.50 each



STRAP WINDERS



CARGOSWD
 EZ WINDER
 14.00



CARGOSW
 STANDARD
 STRAP WINDER
 12.00

EDGE PROTECTORS



Cargosp
 Steel Edge
 Protector
 5.25



CARGOPP
 Plastic Edge
 Protector
 1.75



CARGOXP 12" protectors 6.50

CHAINS AND BINDERS



CARGORB
 Ratchet Binder
 29.00



CARGOCB
 Chain Binders
 19.50

CARGOCR
Coil Racks
8.00

