

CONTROLLING THE MONSTER TRUCK

STEERING TRIM

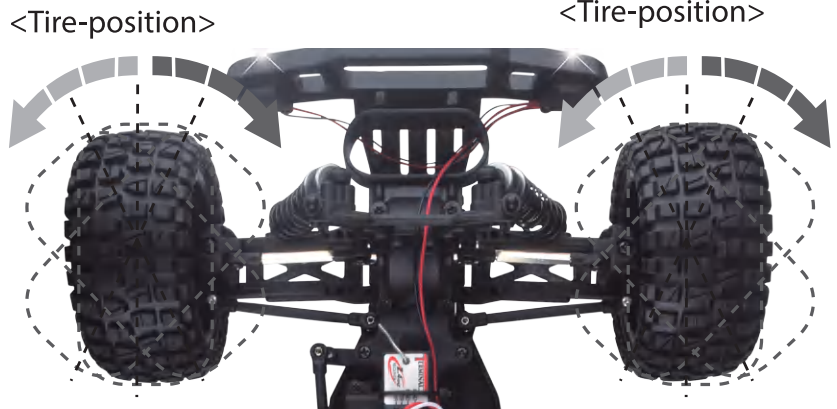

- If the truck tracks right (when viewed from behind), rotate the ST.TRIM knob slightly left.
- If the truck tracks left (when viewed from behind), rotate the ST.TRIM knob slightly right.
- Check that the servo saver screw is fully tightened to ensure that your truck tracks straight.

STEERING DUAL RATE

If you need to limit the angle of steering your truck has, rotate the "ST.RATE" knob counterclockwise. For sharper steering angle, rotate the knob clockwise.

<If the steering angle increases>

<The steering angle will decrease>

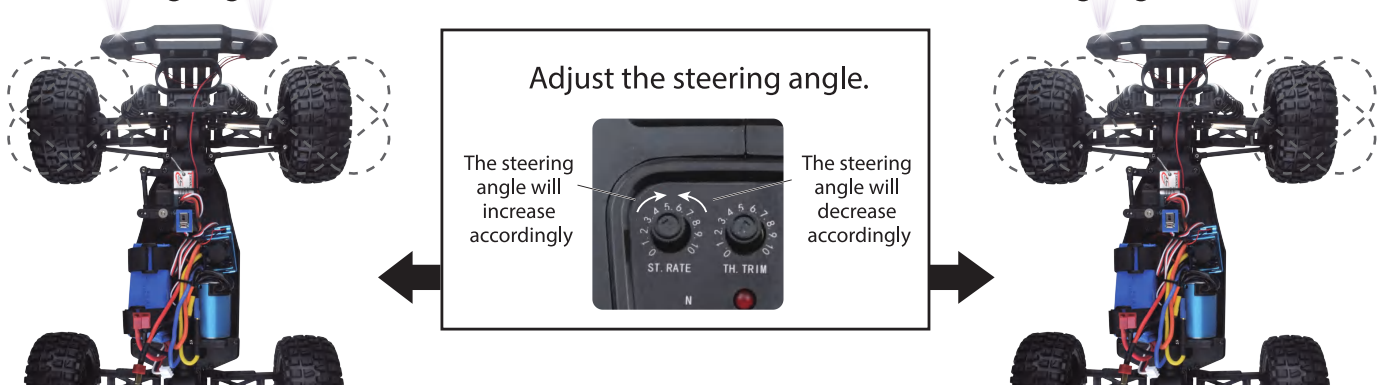

THROTTLE DUAL RATE

In order to limit the maximum speed of your truck, rotate the "TH.TRIM" knob counterclockwise. For higher top speeds, rotate the knob clockwise.



OPERATING YOUR TRUCK

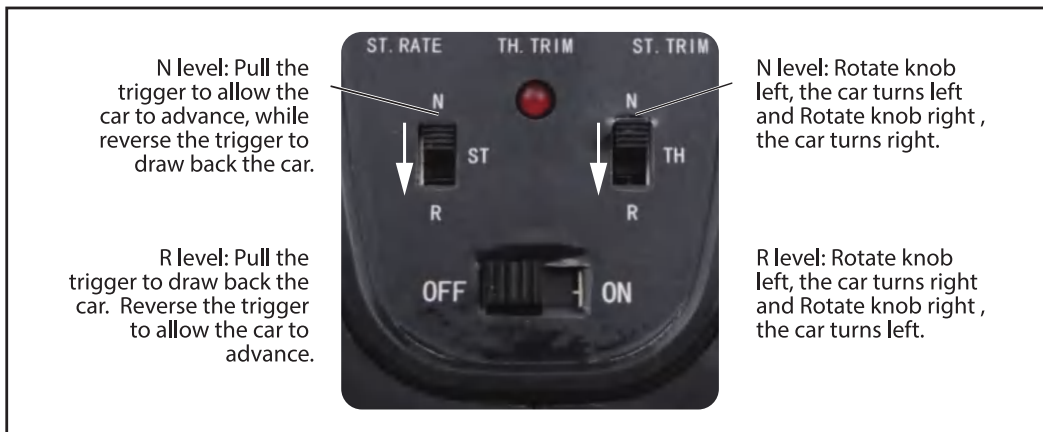

DRIVING YOUR TRUCK

PAIR YOUR TRUCK TO THE REMOTE CONTROL. SEE PAGE 8 FOR PAIRING INSTRUCTIONS.

- Pull the throttle towards your body softly and the truck will start moving forward. The harder you pull the faster the truck will go.
- To brake, push the throttle away from your body. To drive in reverse, push again.
- To stop slowly just let go of the throttle.
- When the battery reach low voltage, the truck will stop. The truck is equipped with LVC to protect the battery.



BEFORE RECHARGING

- Before charging the battery be sure it has cooled off from last use.

TRUCK MAINTENANCE

Your model needs to be repaired in time to ensure its optimal operational state. High attention should be paid to following steps. Check whether the car has obvious damage or wearing. For example:

1. Check whether it has broken, bent or damaged parts;
2. Check whether wheel hub and steering are installed in place;
3. Check whether it has worn wires or connecting rod with loose connection;
4. Check receiver and remote, and installation of electronic speed controller;
5. Check wheels for proper tightness;
6. Check remote system, especially battery capacity;
7. Check car body and suspension for loose screws;
8. Check tightness of all components;

SHREDDER ASSEMBLY GUIDE

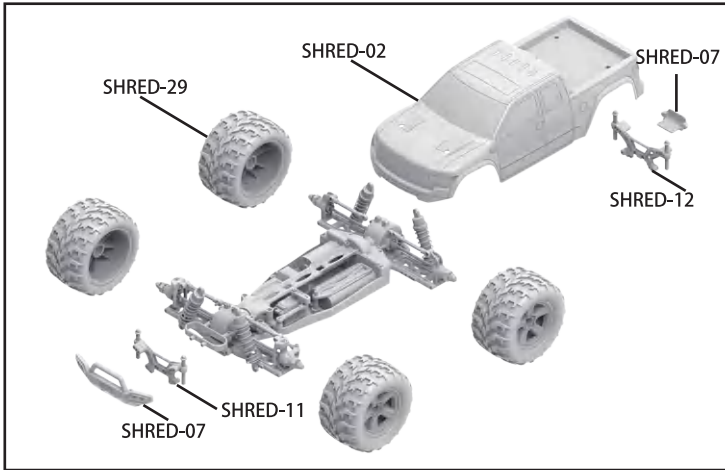

FRONT & REAR DIFFERENTIAL ASSEMBLY GUIDE

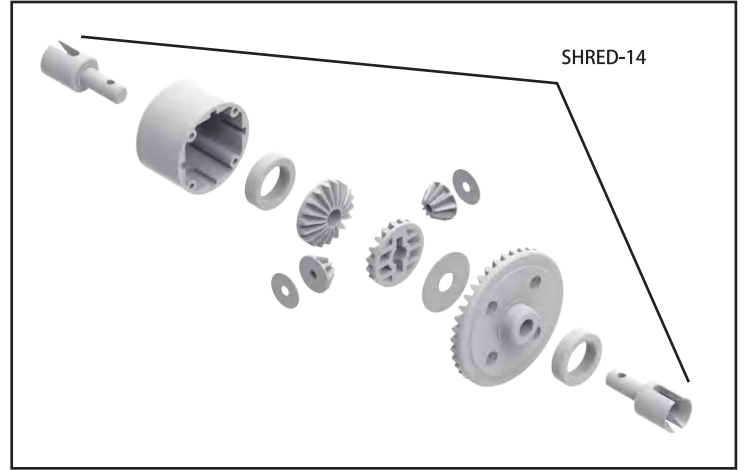

DRIVE AXLE ASSEMBLY GUIDE

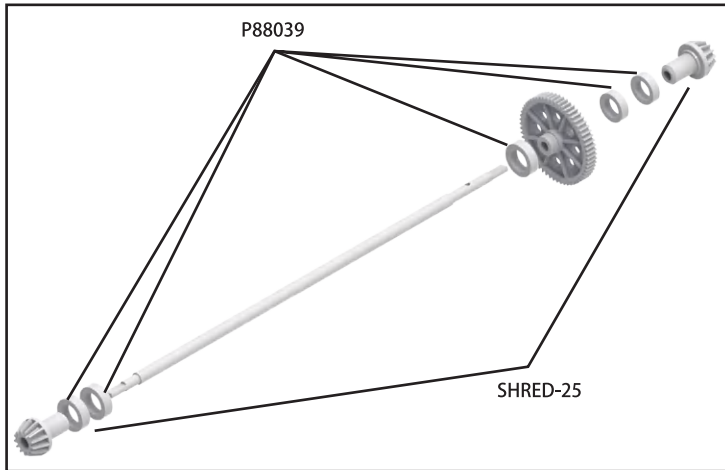

TIRE & WHEEL AXLE ASSEMBLY GUIDE

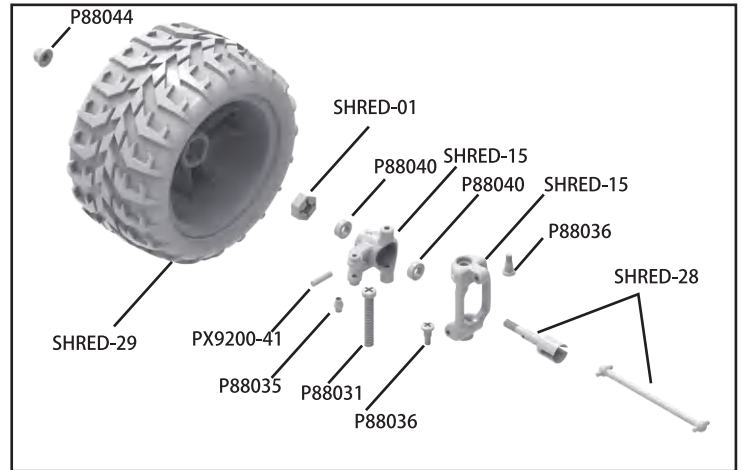

PARTS LIST

P88022



Φ2.6*7PB Round Head Screw

P88023



Φ2.6*10PB Round Head Screw

P88024

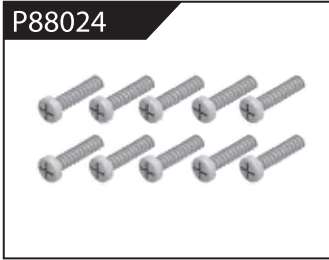

Φ2.6*30PB Round Head Screw

P88025

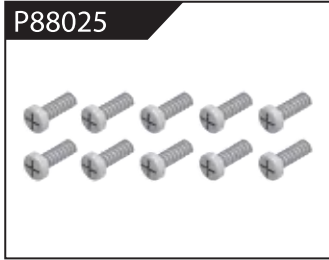

Φ3*12 Round Head Screw

P88026



Φ2.3*10PB Screw

P88027

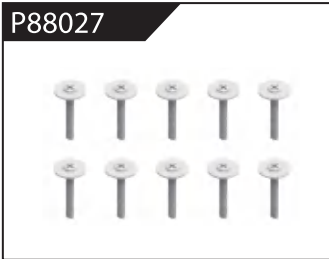

Φ2.6*12PB Screw

P88028

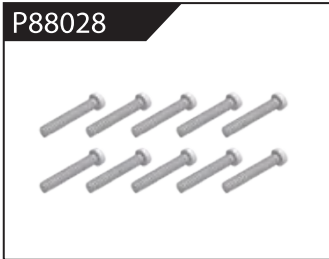

Φ1.7*8PB Screw

P88029



Φ2*8PB Screw

P88030

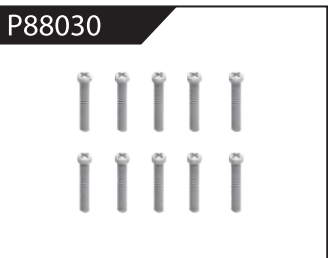

Φ2.3*14PB Screw

P88031



Φ2.6*14PB Screw

P88032



Φ2.6*10 Flattened Head Screw

P88033



Φ3*8 Flattened Head Machine Screw

P88034

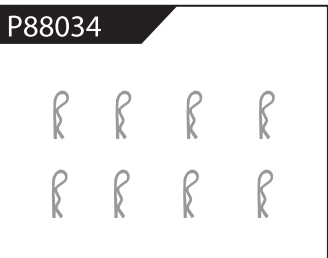

Body Clip

P88035



Hollow Ball Connectors

P88036



Step Screw

P88037

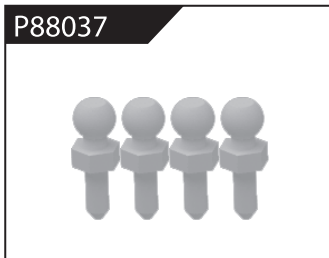

Φ4.8 Ball Head

P88038

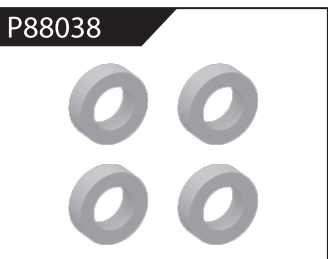

Φ10*15*4 Ball Bearing

P88039

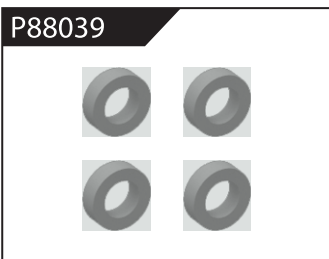

Φ8*10*3 Ball Bearing

P88040

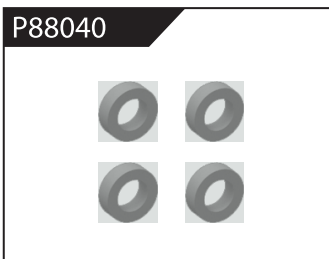

Φ5*9*3 Ball Bearing

P88041

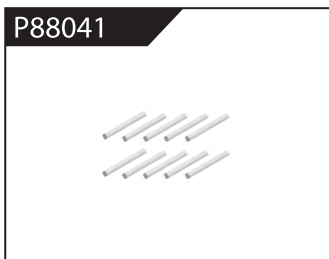

Φ1.5*10 Wheel Hex Pin c

P88042

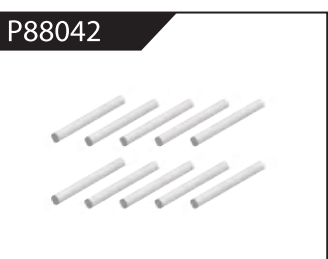

Φ2.5*26.5 Steering Pin B

P88043

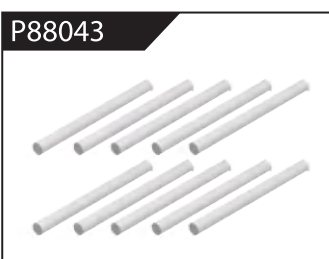

Φ3*48 Front/Rear Lower Suspension Pin A

P88044



Nylor Nut M4

SHRED-01A

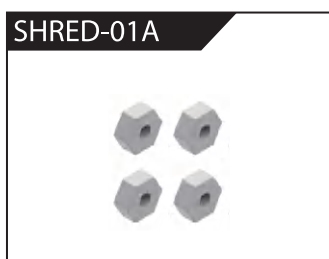

Metal Wheel Hex

PARTS LIST

SHRED-02



Truck over

SHRED-05

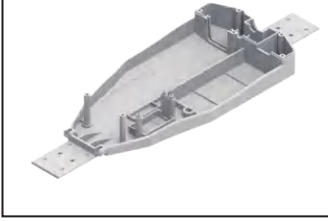

Chassis

SHRED-06



Tube-style bumpers

SHRED-07



Front/Rear Bumper

SHRED-09



Tie Bar

SHRED-10



Lower Suspension Arm

SHRED-11



Front Shock Tower and Body Post

SHRED-12



Rear Shock Tower and Body Post

SHRED-13



Front/Rear Gear Box

SHRED-14



Diff Main Gear Complete

SHRED-15



Front Steering Carrier

SHRED-16



Rear Upright

SHRED-17A



Front/Rear Upper Link

SHRED-18



Front/Rear Shock Absorber

SHRED-19



Steering Link

SHRED-20



Steering Arm Complete

SHRED-51



Servo

SHRED-22



Servo Link

SHRED-25



Drive Shaft Assembly

SHRED-27



Motor Layering

SHRED-28



Universal Drive Joint

SHRED-29



Wheel Complete

SHRED-32



Chassis Sheet Steel

SHRED-34



3MM Crosstip Screwdrivers

PASTS LIST

SHRED-35

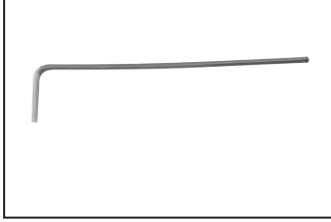

2MM Hexagon Wrench

SHRED-36



2.4G Transmitter

SHRED-37



USB

SHRED-38



Socket Wrench

SHRED-39



Motor Gear (22T)

SHRED-43A



Headlamp

SHRED-50



Motor

SHRED-52



Receiver

SHRED-53

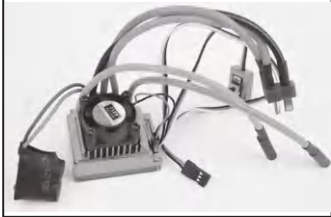

Brushless ESC

SHRED-54



Battery Li-Po (7.4V 4000mAh)

RC-PRO

We believe that you should make the most out of your R/C vehicle. If you are ever in need of advice, service or parts, please visit our website for a list of our retailers and service centers.

WWW.RCPRO.CA