

SHREDDER

MANUAL

1/12 SCALE 4WD BRUSHED MONSTER TRUCK
2.4G RADIO SYSTEM

14+

AGES

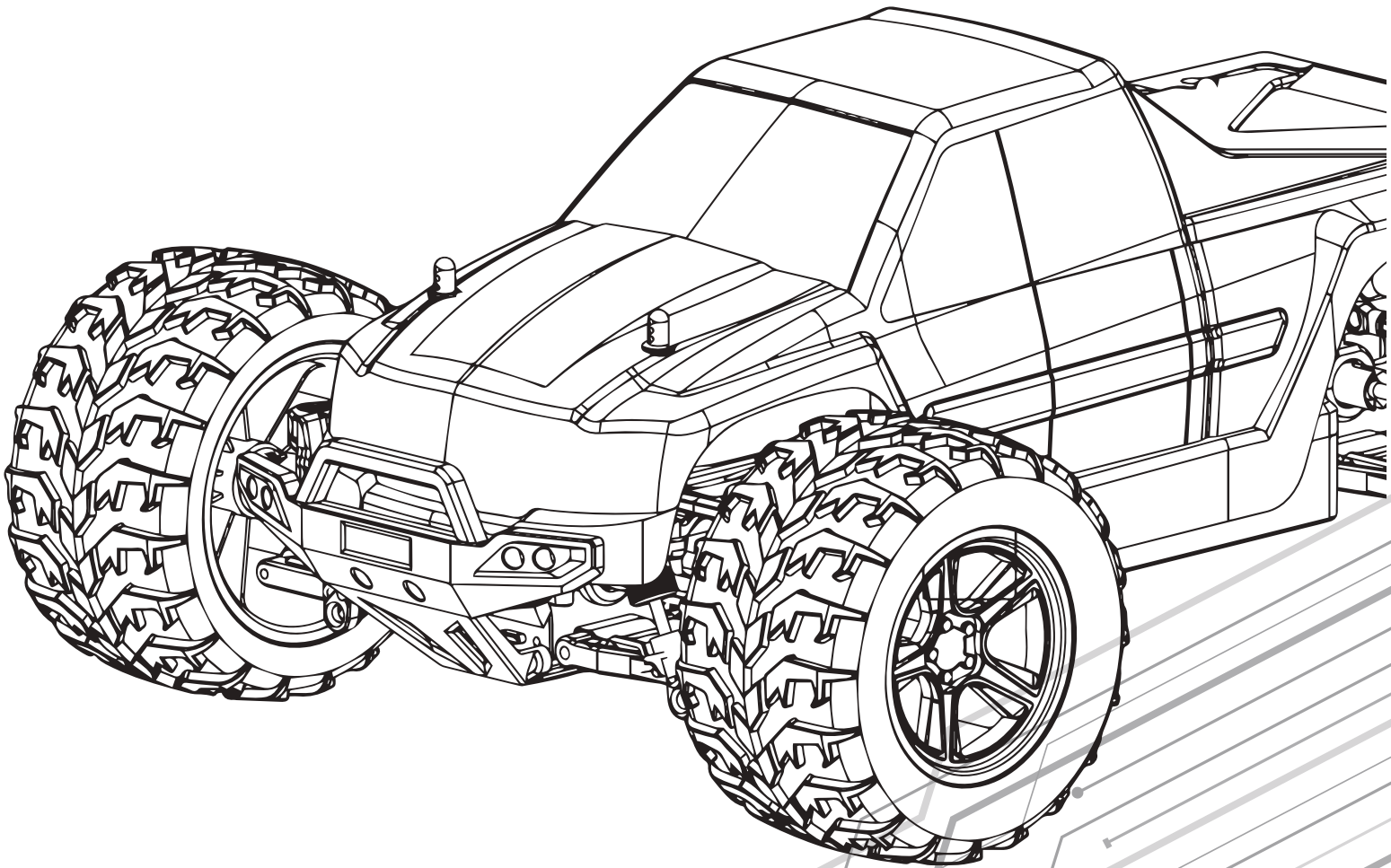

WARNING: PLEASE READ THE INSTRUCTION MANUAL BEFORE OPERATING THE PRODUCT

BEFORE YOU PROCEED

CONTENTS

Contents	1
Safety precautions	2
Instruction	3
Model introduction	5
Pairing	6
2.4G Remote control	9
Operating your model	11
Maintaining your model	12
Diagram parts	13
Assembly guide	14
Parts list	15

INSTRUCTIONS

Thank you for purchasing the SHREDDER monster truck. Please read all instructions and warnings carefully before operating. Please also keep this instruction manual for future reference and maintenance.

IMPORTANT:

1. This monster truck is not a toy. It may cause injury or damage if not used properly under a controlled environment. Always make sure you practice driving in an open airspace area while following the rules and regulations which applies to the area to avoid any potential damage or injury.
2. This product is suitable for experienced drivers no less than 14 years of age.

BEFORE YOU PROCEED

Please read carefully and follow all instructions.

Violation of these instructions shall be deemed as misuse or faulty operation.

Before operating your remote-controlled car, please read all contents of this manual and check carefully the remote car.

Dealer shall not support return & exchange after the remote-controlled car is unpacked or used.

PAY ATTENTION TO SAFETY PRECAUTIONS



Warning: Do not modify or alter this model. Changes or modifications to this model not expressly approved by the party responsible for compliance could void the user's authority to operate the equipment.

- The truck is suitable for ages 14 and above. Parents should supervise children who operate the truck.
- This truck is suitable for indoor or outdoor use.
- Switch off the truck and disconnect the battery when not in use.
- Keep hands, face and loose clothing away from the truck.
- Always follow these instructions when operating this truck.
- Do not operate near people or animals.
- Always unplug battery from charger after charging is complete. Disconnect the charger from the power source and only then disconnect the battery from the charger.
- DO NOT store the truck in a damp environment. The truck's interior is composed of delicate electronic components and mechanical parts, which can be seriously damaged by moisture. Please take serious care, as this type of damage may not be visible on the outside, but can cause the product damage or act unpredictably once in use.
- Always operate with safety in mind. DO NOT use this truck under the influence of drugs or alcohol, or in the case of fatigue, as improper operation can cause serious injury and/or property damage.
- DO NOT store or operate in high heat, as electrical components can be damaged.
- Small parts are included with this product. Please place it beyond the reach of the children to avoid a CHOKING HAZARD or parts being mistakenly swallowed.
- Only the original charger made from our factory can be used.
- Charger is not a toy.
- Engine will heat up. Please DO NOT touch it to avoid being burned or injured.
- Always operate your truck within eye sight.
- RC-PRO's all-weather electronics allow you to operate your truck in various conditions, including rain, snow, mud and more. DO NOT submerge your RC-PRO Truck!

PRODUCT PACKAGING CONTENT

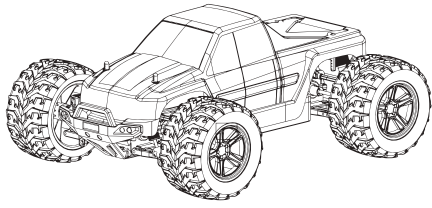

SHREDDER X1



Remote X1



7.4V 1500mAh
Li-ion Battery X1



USB Charger X1



Extra Parts Kit X1



Socket Wrench X1

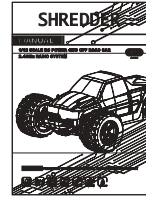

Manual X1

PRODUCT SPECIFICATION

Size of graphic carton (length*width*height)	468X300X165mm
Size of car (length*width*height)	370x280x140mm
Car weight(includes battery)	1.55kg
Wheel base:	245mm
Wheel diameter:	105mm
Drive:	4WD
Motor:	540 brush driver
Steering servo:	2.2KG tense
Battery:	7.4V 1500mAh lithium battery
Remote frequency:	2.4GHz
Remote distance:	100m
Charging mode:	USB balance charging cable

MODEL INTRODUCTION

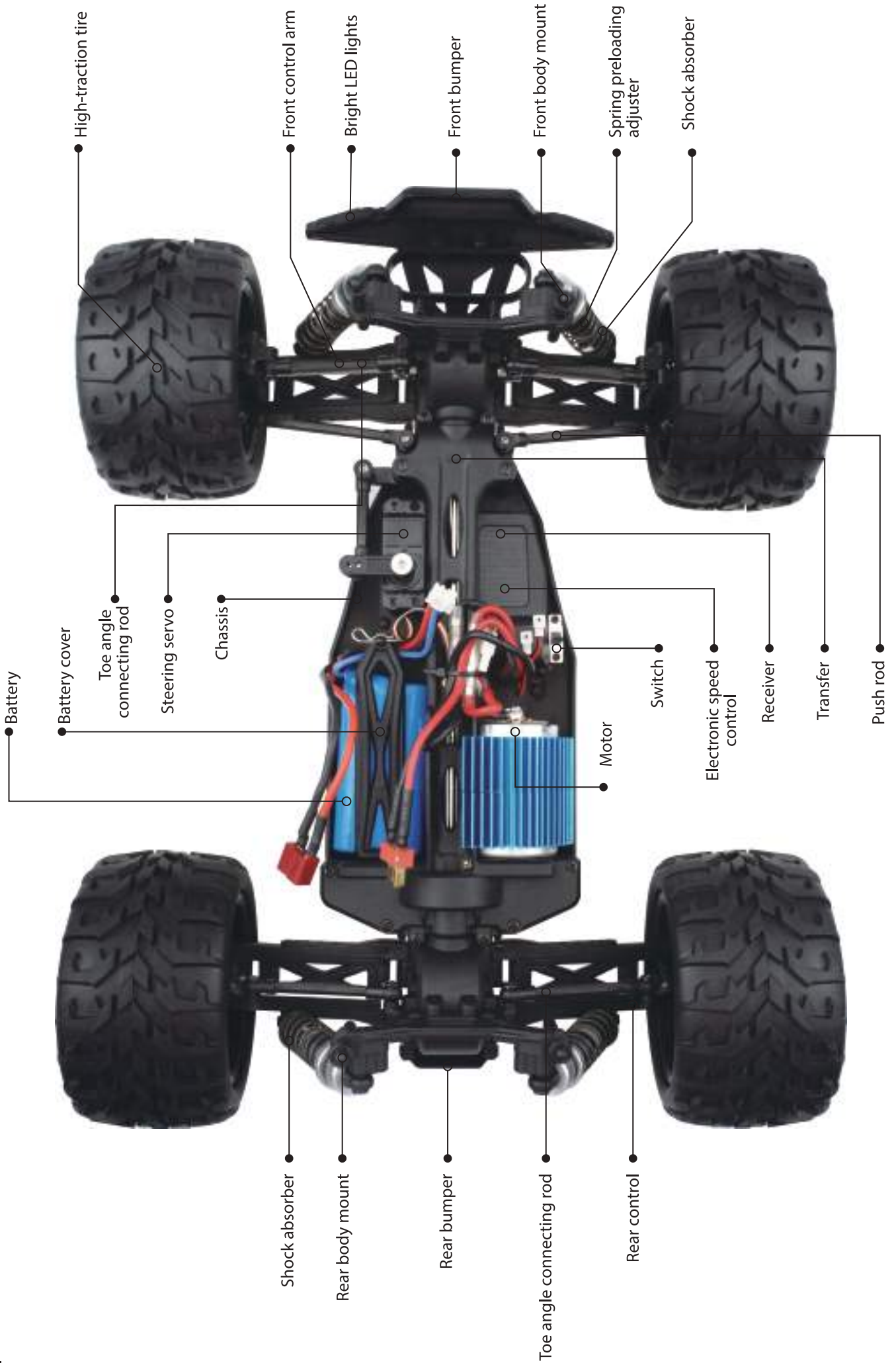

INSTALLATION OF REMOTE BATTERY

Your remote requires three AA batteries (No.5). The battery compartment is at the bottom of the remote.

1. Hold and slide the battery compartment to take off the battery compartment cover.
2. Install the battery according to correct directions of positive and negative anodes, indicating on the battery compartment.
3. Re-install and close the battery compartment.



4. Turn the remote power on to check its state indicator light with red.
5. Once the remote control is paired with the truck, the indicator light will remain solid and the truck is ready to go.

The remote's LED indicator light will flash slowly in case the AA batteries are too weak. In this case, please change to fully charged AA batteries.

If the LED indicator of the remote is off, please check the direction of the positive and negative anodes and check whether the battery is charged fully.

Please refer to diagram of Identification number on page 9 for any other flash signals from LED.



Use normal battery

Your remote control use AA batteries which are not included in this package. You also can use rechargeable battery in your remote. Please make sure that rechargeable batteries are charged fully according to instructions of manufacturers. If you use rechargeable batteries in your remote, you should know that their power is consumed quickly compared with other alkaline batteries.



Note: When your remote-control's batteries voltage reaches low levels (red light flashes slowly), please stop running the truck immediately in order to avoid damage or injury due to signal loss.

READY FOR PLAY

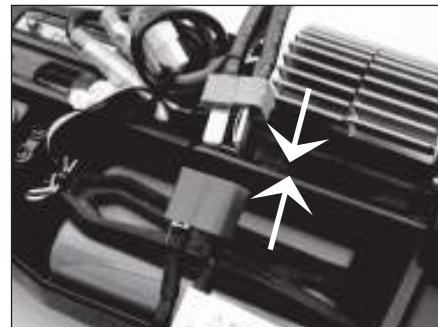

INSTALL THE BATTERY PACK FOR YOUR MODEL

Your SHREDDER comes with an included 7.4V Li-ion Rechargeable Battery pack.

Please install the battery according to the following steps:

1. Remove the truck's cover.
2. Remove the buckle that holds the battery cover.
3. Place the battery in the designated compartment and make sure the wires are positioned towards the front of the car.
4. Replace the battery cover, re-install the buckle and make sure the battery wire is not being pinched.



WARNINGS: LiPo batteries are only suitable for advanced users who have been aware of battery risks. It is not recommended that children below 14 years old operate LiPo batteries with direction of experienced adults. Please strictly obey directions from battery manufacturers and charger manufacturers charge, and it is important for you and users of this product to use and store LiPo batteries. Be sure your safety and understand how to use LiPo battery. Please notice that our company has no obligations to install batteries of the model, therefore, we will assume liability of any special, non-direct, attached or indirect loss caused by using LiPo battery.

NOTE OF REMOTE OPERATION

This 2.4G remote is equipped with directional antenna.

In order to obtain maximum distance, please hold the remote vertically towards the model.

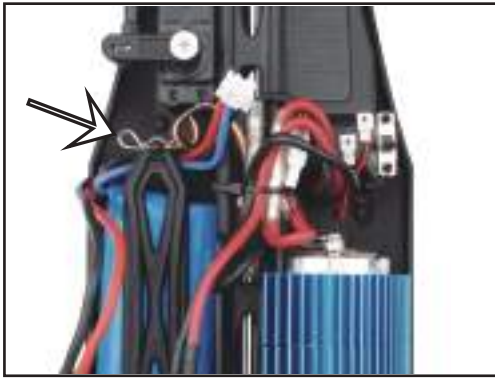

1. Install the battery into the truck and secure battery strap to post using clip.

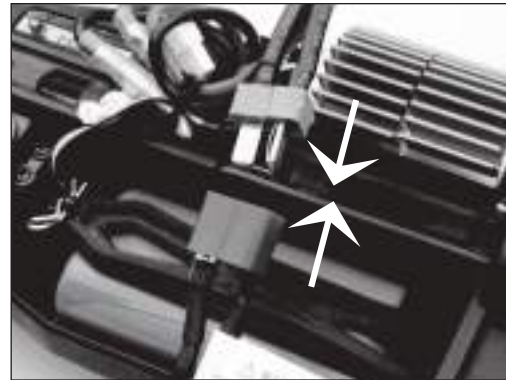

2. Connect the battery.



3. Switch remote control on.



4. Switch Truck on.

5. Make sure you switch the truck on within 20 seconds of switching on the remote-control.

If you are using more than 1 truck then In order to avoid signal interference, always pair 1 truck at a time. Continue to pair a second truck only after pairing is completed.



2.4GHZ REMOTE

REMOTE CONTROLLER



REMOTE LED CODES

LED color/pattern	Name	Solution
Solid red light	Normal driving pattern	Please refer to information about how to use remote control on page 9.
Slow flashing red light (on at 0.5s/off at 0.5s)	Low power	Replace batteries in the remote. See page 6 for more info.
Fast flashing red light (on at 0.125s/off at 0.125s)	Pairing failed/error	Please turn the remote system off and restart in order to reset the receiver. Please check if the battery level is sufficient or whether the antenna has been damaged.

CONTROLLING THE MONSTER TRUCK

STEERING TRIM



<Tire-position>

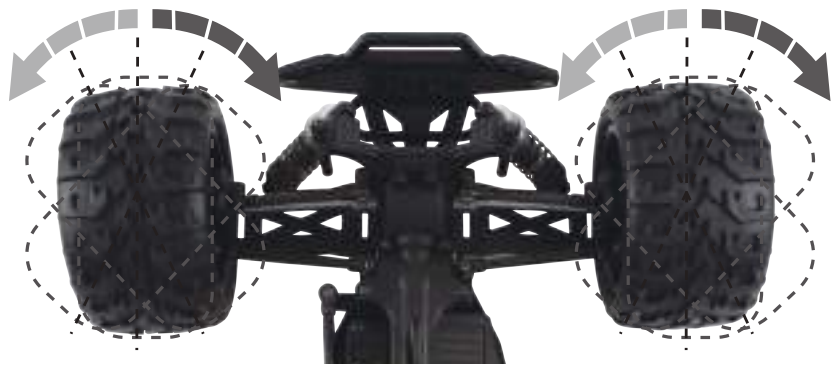

- If the truck tracks right (when viewed from behind), rotate the ST.TRIM knob slightly left.
- If the truck tracks left (when viewed from behind), rotate the ST.TRIM knob slightly right.
- Check that the servo saver screw is fully tightened to ensure that your truck tracks straight.

STEERING DUAL RATE

If you need to limit the angle of steering your truck has, rotate the "ST.RATE" knob counterclockwise. For sharper steering angle, rotate the knob clockwise.

<If the steering angle increases>

<The steering angle will decrease>

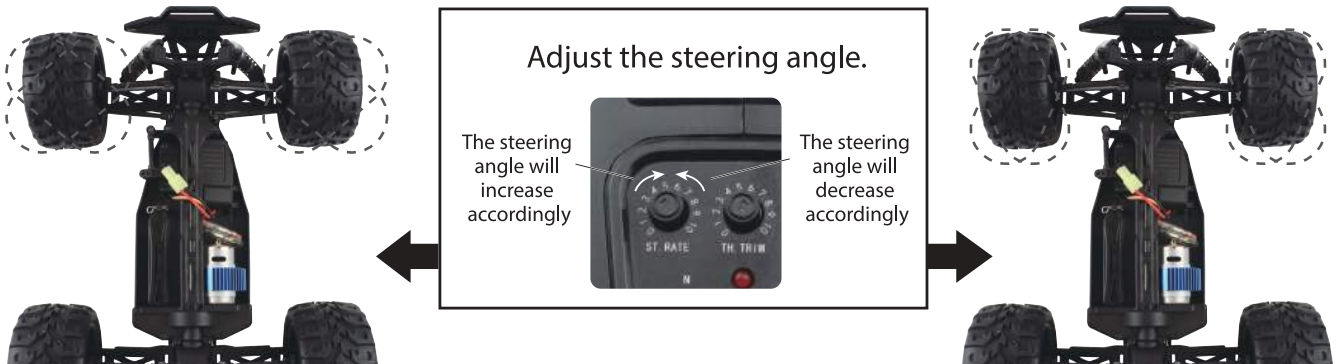

THROTTLE DUAL RATE

In order to limit the maximum speed of your truck, rotate the "TH.TRIM" knob counterclockwise. For higher top speeds, rotate the knob clockwise.



OPERATING YOUR TRUCK

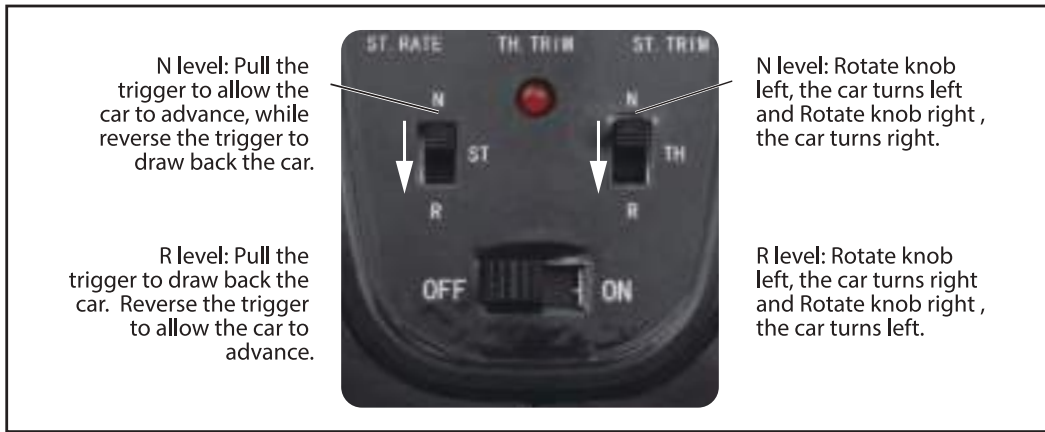

DRIVING YOUR TRUCK

PAIR YOUR TRUCK TO THE REMOTE CONTROL. SEE PAGE 8 FOR PAIRING INSTRUCTIONS.

- Pull the throttle towards your body softly and the truck will start moving forward. The harder you pull the faster the truck will go.
- To brake, push the throttle away from your body. To drive in reverse, push again.
- To stop slowly just let go of the throttle.
- When the battery reach low voltage, the truck will stop. The truck is equipped with LVC to protect the battery.



BEFORE RECHARGING

- Before charging the battery be sure it has cooled off from last use.

TRUCK MAINTENANCE

Your model needs to be repaired in time to ensure its optimal operational state. High attention should be paid to following steps. Check whether the car has obvious damage or wearing. For example:

1. Check whether it has broken, bent or damaged parts;
2. Check whether wheel hub and steering are installed in place;
3. Check whether it has worn wires or connecting rod with loose connection;
4. Check receiver and remote, and installation of electronic speed controller;
5. Check wheels for proper tightness;
6. Check remote system, especially battery capacity;
7. Check car body and suspension for loose screws;
8. Check tightness of all components;

TRUCK PARTS DIAGRAM

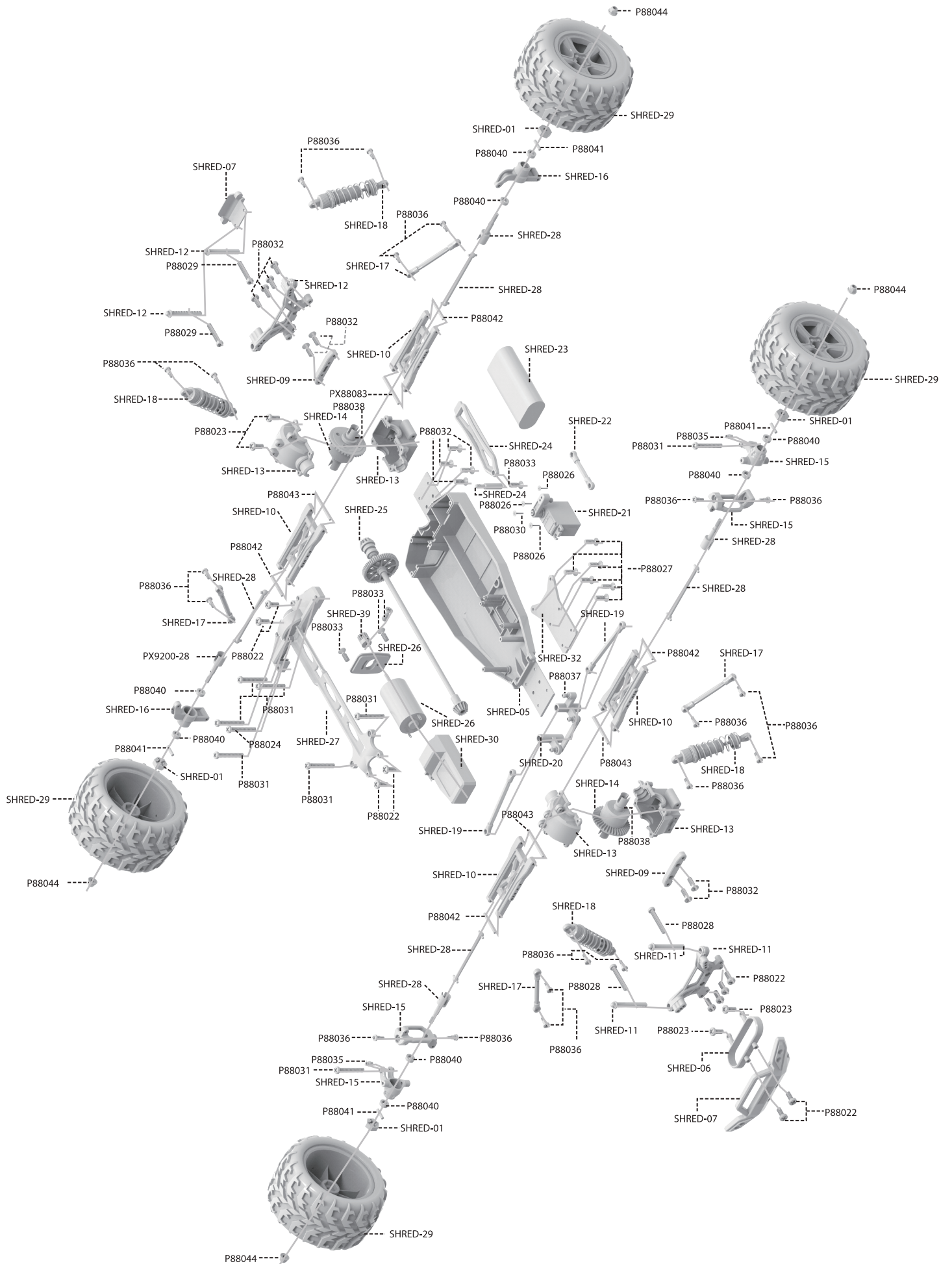

SHREDDER ASSEMBLY GUIDE

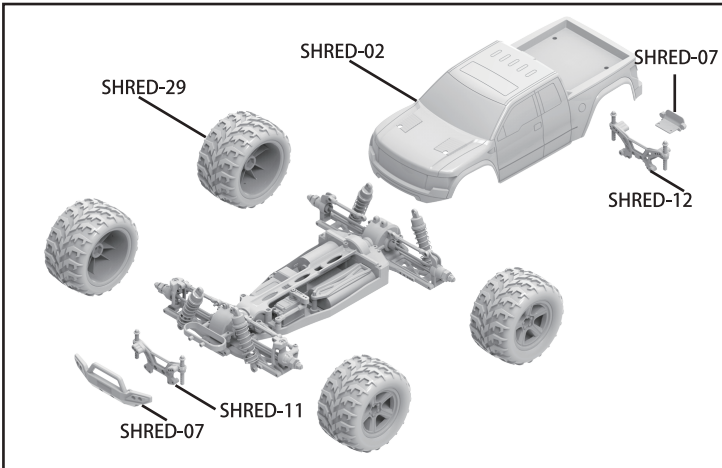

FRONT & REAR DIFFERENTIAL ASSEMBLY GUIDE

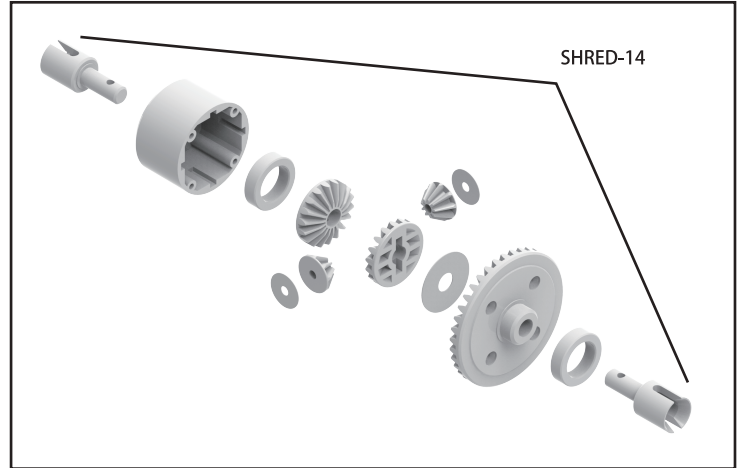

DRIVE AXLE ASSEMBLY GUIDE

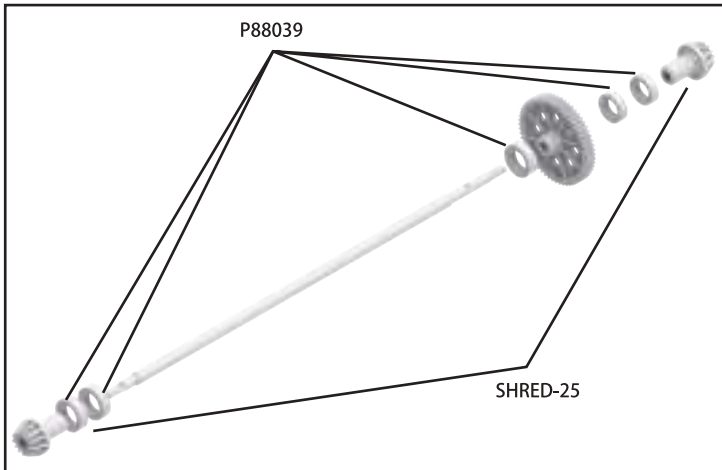

TIRE & WHEEL AXLE ASSEMBLY GUIDE

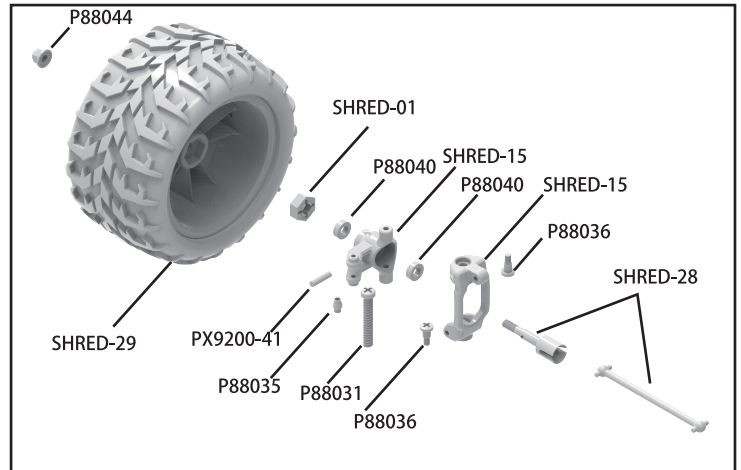

PARTS LIST

P88022

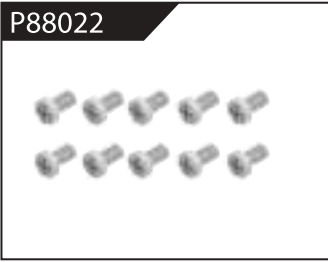

Φ2.6*7PB Round Head Screw

P88023

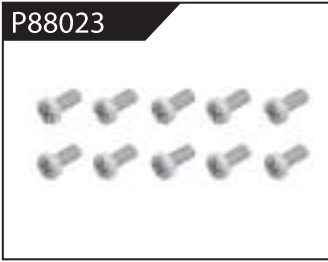

Φ2.6*10PB Round Head Screw

P88024



Φ2.6*30PB Round Head Screw

P88025

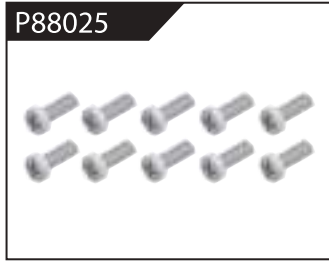

Φ3*12 Round Head Screw

P88026

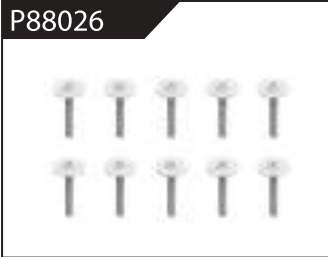

Φ2.3*10PB Screw

P88027



Φ2.6*12PB Screw

P88028

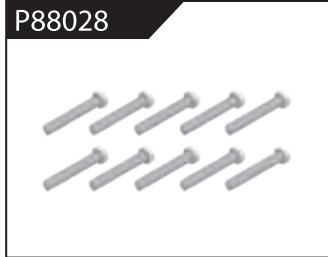

Φ1.7*8PB Screw

P88029



Φ2*8PB Screw

P88030

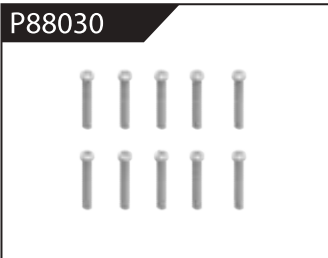

Φ2.3*14PB Screw

P88031

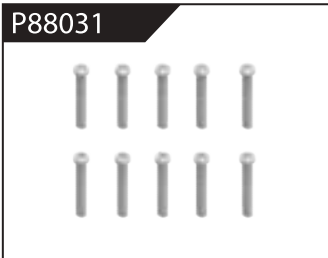

Φ2.6*14PB Screw

P88032



Φ2.6*10 Flattened Head Screw

P88033



Φ3*8 Flattened Head Machine Screw

P88034

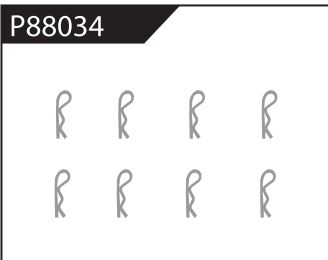

Body Clip

P88035



Hollow Ball Connectors

P88036

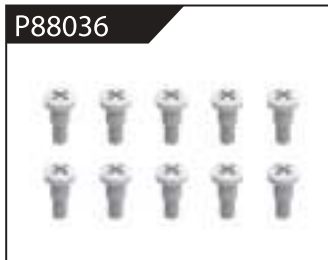

Step Screw

P88037



Φ4.8 Ball Head

P88038

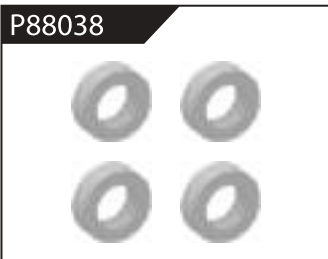

Φ10*15*4 Ball Bearing

P88039



Φ8*10*3 Ball Bearing

P88040

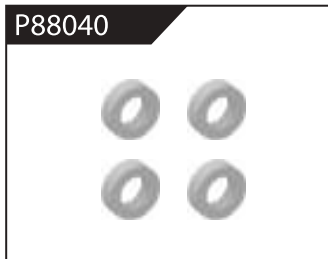

Φ5*9*3 Ball Bearing

P88041

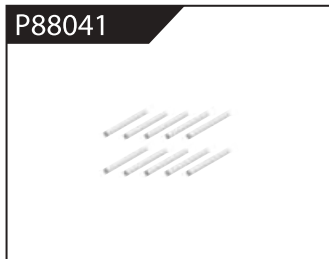

Φ1.5*10 Wheel Hex Pin c

P88042

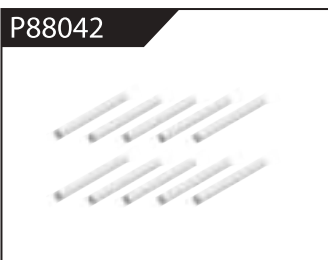

Φ2.5*26.5 Steering Pin B

P88043



Φ3*48 Front/Rear Lower Suspension Pin A

P88044



Nylor Nut M4

SHRED9200-01



Wheel Hex

PARTS LIST

SHRED-02

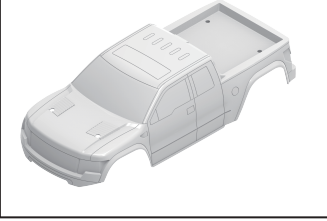

Truck over

SHRED-05

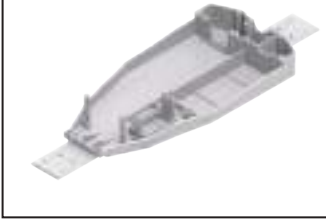

Chassis

SHRED-06



Tube-style bumpers

SHRED-07



Front/Rear Bumper

SHRED-09



Tie Bar

SHRED-10



Lower Suspension Arm

SHRED-11



Front Shock Tower and Body Post

SHRED-12



Rear Shock Tower and Body Post

SHRED-13



Front/Rear Gear Box

SHRED-14



Diff Main Gear Complete

SHRED-15



Front Steering Carrier

SHRED-16



Rear Upright

SHRED-17



Front/Rear Upper Link

SHRED-18



Front/Rear Shock Absorber

SHRED-19

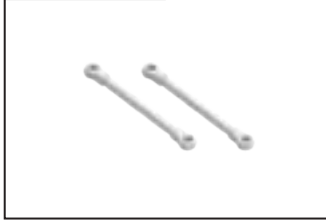

Steering Link

SHRED-20



Steering Arm Complete

SHRED-21



Servo

SHRED-22



Servo Link

SHRED-23



Battery Li-ion (7.4V 1500mAh)

SHRED-24



Battery Cover

SHRED-25



Drive Shaft Assembly

SHRED-26



Motor

SHRED-27



Motor Layering

SHRED-28



Universal Drive Joint

PASTS LIST

SHRED-29



Wheel Complete

SHRED-30



Receiver

SHRED-32

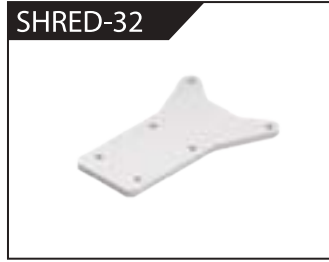

Chassis Sheet Steel

SHRED-34



3MM Crosstip Screwdrivers

SHRED-35



2MM Hexagon Wrench

SHRED-36



2.4G Transmitter

SHRED-37



USB

SHRED-38



Socket Wrench

SHRED-39

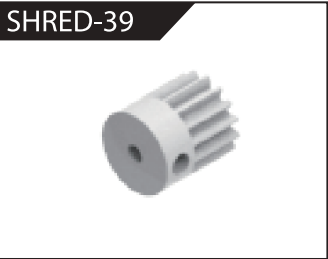

Motor Gear (22T)

SHRED-40



Motor Heat Proof Cover

SHRED-42

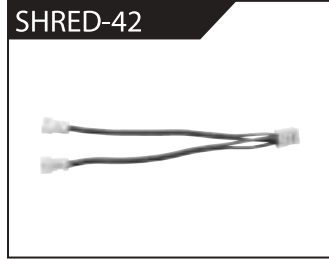

One-to-Two Lamp Cord

SHRED-43



Headlamp

SHRED-44



3X1.5VAA

SHRED-46



Battery LiPo(7.4V 2000mah)



We believe that you should make the most out of your R/C vehicle. If you are ever in need of advice, service or parts, please visit our website for a list of our retailers and service centers.

WWW.RCPRO.CA