

RC-PRO

14+
AGES

ROWDI ETW MANUAL

1/28 SCALE 4WD BRUSHED RACE CAR
2.4G RADIO SYSTEM



PLEASE READ THE INSTRUCTION MANUAL BEFORE
OPRATING THE PRODUCT

Safety and caution	1-2
Troubleshooting • Product introduction	2-3
Instruction of common tools Or installing of the electronic parts ...	4-5
Practice and maintenance.....	5-7
Assemble exploded view	8-18
Parts list	19-21

Safety and Cautions

- *Never run the model on public roads or streets, as it could endanger traffic.
- *Never run the model in crowded areas, near or toward people or animals, to prevent property damage and/or personal injury.
- *Never run the model near rivers, ponds or lakes as to prevent R/C car from dropping into the water.
- *Make sure that no one else is using the same frequency as yours in your running area. Using the same frequency at the same time, whether it is driving, flying or sailing, can cause loss of control with R/C model, resulting in serious accidents.
- *To avoid a runaway R/C model or loss of control, always follow the procedure below:
 1. Fully extend transmitter antenna.
 2. Switch on transmitter.
 3. Switch on R/C model.
- *Follow reverse procedure to shut down.
- *Never touch or hinder rotating tire.
- *Never run R/C model in the rain or let run over puddles, as water may cause trouble with R/C model.
- *Motor and battery get very hot after running. Take care when handle them.
- *Retract transmitter antenna when not in use.
- *Remove the batteries from model and transmitter when they are not in use.

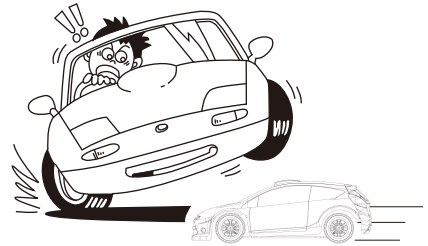

Cautions when handling batteries

- *Do not dismantle the battery or charger and do not cut any battery cables. This may cause short-circuit and/or damage to the product.
- *Change battery with compatible charger following proper procedure that is called out in the instructions. Do not modify charger or charge battery in improper way.
- *Do not recharge battery that is still warm from use as it may damage the battery. Allow the battery to cool off prior to recharging.
- *Make sure to disconnect charger cables from R/C model and electric outlet when not in use.
- *Remove transmitter battery when not using it for a long time as it may leak and damage transmitter when left for a long period.
- *Never incinerate used batteries, as they can explode causing serious accidents.



Safety precautions

Do not operate the model on public roads, in crowded places or near infants, it may cause accidents or injury.

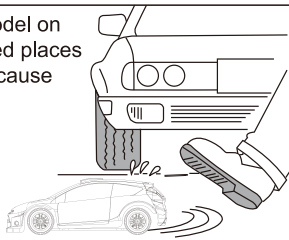

As the product includes small and sharp parts, assemble and store this product only in places out of the reach of children.



As the front end of the antenna may be dangerous, do not aim it toward faces.



During the car running and after, the motor will be hot. Please do not touch it until it has had time to cool down.



Don't use the same frequency with others at the same time. Or the car will lose control or even lead to serious accidents.

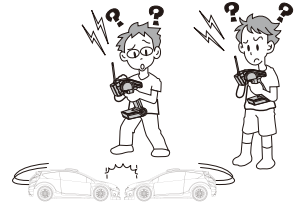

Troubleshooting

Description	Cause	Solution
The car does not operate at all.	Transmitter or receiver is off.	Turn on both transmitter and receiver.
	Batteries are not placed properly in the transmitter.	Place batteries in the transmitter properly.
	The drive battery is not charged enough.	Charge the drive battery.
The car does not follow your operation and control distance not enough long.	Someone else is using the same radio frequency as you are using.	Change your radio frequency to the one no one else is using, wait until the driver using the same radio frequency finishes driving, or drive your car at a different place.
	There is not enough power in the transmitter or receiver batteries.	Replace the transmitter batteries with new ones and charge the drive battery.
	Not tighten antenna on the transmitter/not fully extend antenna.	Make sure insert antenna into the transmitter and fully extend antenna.



CAUTION

- * Please observe the operation manual or packing explanation to install and use, and some parts should be installed by adults.
- * The product contains small parts, it may cause swallow or choke.
- * Never run an R/C model in the seep or rain, moisture areas, or it may cause the parts malfunction.
- * Please throw the wrapper in time to avoid danger for the children.
- * Regularly examine for damage to the charge, wire, plug, bodyshell or other parts. In the event of any damage, it must not be used until the damage has been repaired.
- * The charge, battery box and battery must insert with the appointed power source of product symbol same.
- * This product must only be used with the original collocation charger.
- * The product is contains the functional outshoots are may be dangerous to the children.

- * Apart the charger and toy before clean.
- * As the front end of the antenna may be dangerous, do not aim it toward anyone's body, face or eyes.
- * Batteries are to be inserted with the correct polarity.
- * Use the "AA" non-rechargeable or "AA" rechargeable batteries.
- * Non-rechargeable batteries are not to be recharged.
- * Rechargeable batteries should only be charged under adult supervision.
- * Rechargeable batteries must be removed from model before charger.
- * Different types of batteries or old and new batteries are not to be mixed.
- * Exhausted batteries are to be removed in time.
- * The supply terminals are not to be short-circuited.
- * Never short circuit the batteries. throw it in a fire or attempt to open their outer casings.
- * Please remove the batteries when not in use.
- * Please retain these instructions for future reference.

Product Introduction

Item number: ROWDI ETW 1:28 Scale Brushed Race Car

Vehicle size: length 165mm X width 80mm X height 58mm

Wheelbase: Standard 98mm (variable 102mm)

Front and rear wheel minimum distance: Standard 71mm (75mm)

Ground clearance: Standard 4.6mm (adjustable)

Transmission ratio: Standard 1:5.34 (Motor gear 15T, 17T, 19T, 21T; 27T and 29T gear reduction are free to mix)

Tire diameter : 27mm; wheel width: 8.5mm

2-in-1 Receiver and ESC

Motor: 130 brush motor

Remote controller: 2.4G remote controller

Remote control distance is greater than or equal to 100 meters:

Remote controller battery: 4 AA batteries (sold separately)

Battery: lithium battery 7.4V 400mAh, sufficient energy, explosive strength

Charger: lipo balance

Charging time: about 1 hours and a half

Use of time: 30 minutes

Servo: independent 5 grams of digital servo with the steering gear steering protection, sensitive, quick response

Car shell: antiknock PVC color printing car shell, beautiful Crashworthiness

Four wheel independent suspension system, sealing gearbox. Some parts can be general Kyosho car parts, shape simulation, for the crowd is wide

Speed: the highest about 30KM/H

Proportional R/C Using Instruction

- ① Turn left the steering wheel, the car will turn left. Turing left angle can be adjusted by the degree of wheel twisting.

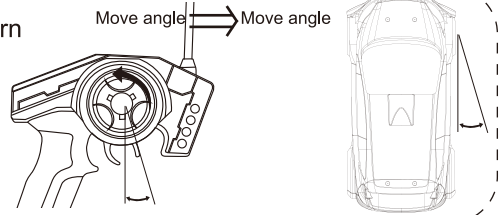

- ② Turn right the steering wheel, the car will turn right. Turing right angle can be adjusted by the degree of wheel twisting.

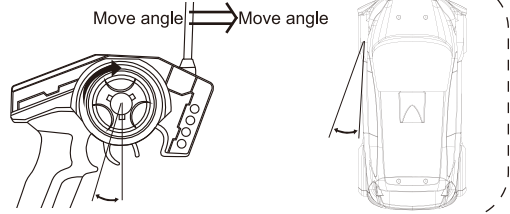

- ③ Pull the throttle trigger backward, the car will forward. Adjusting the angle of throttle trigger can adjust forward speed of the car. During the car forward, quickly push the trigger forward to stop it.

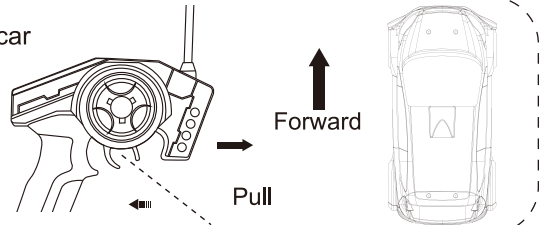

- ④ Loosen the trigger to make it return the neutral position when brake. Push the throttle trigger forward, the car will backward. Adjusting forward angle of throttle trigger adjust backward speed of the car.

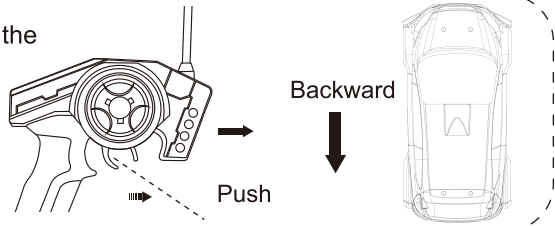

Introduce the common tools and assemble the electron parts

Tools needed for assembly

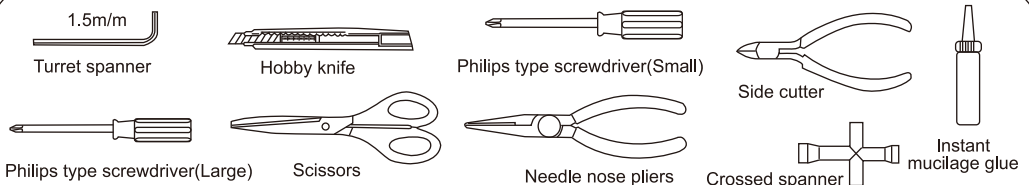

Charge caution

CHARGING BATTERY

- 1) Please firstly check and confirm input voltage of the charge is consistent with local voltage, output voltage of the charge is consistent with battery voltage.
- 2) Battery must be used up before you charge, Charging time is not more than 1.5 hours.
- 3) Be careful to make sure there is adult to control when charging.

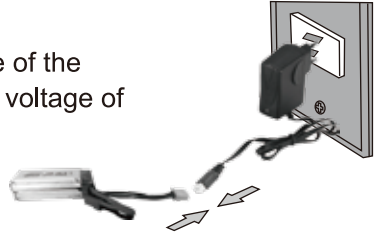

Assemble the electron parts

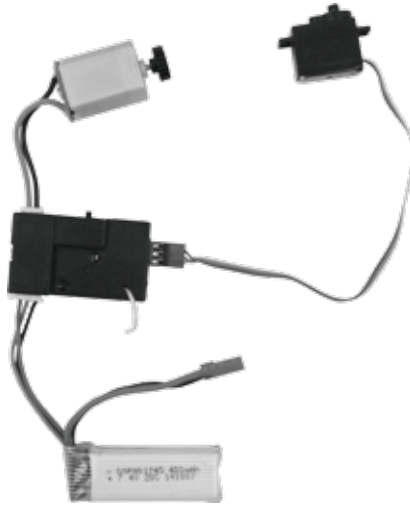

PRACTICE AND MAINTENANCE

Operating program

- 1> Turn on the switch **1** of transmitter and make sure the power indicator is **2** steady light, then turn on the car.
- 2> Put the car on the frame or stand. If wheel is running self-motion, adjust the trim **5** of transmitter until the wheel is still.
- 3> Slip the trigger **3** of transmitter slowly, you can observe the car whether it can go ahead or go back.

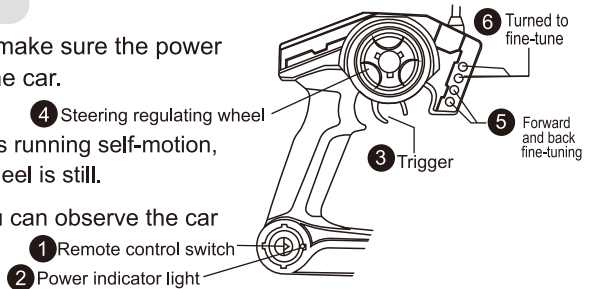

4>Turn steering adjusting wheel ④ of transmitter to left or right,and make sure the steering of front wheels follow the instruction.



5>Put the car on the ground and stand behind the back of the car. Squeeze the throttle trigger ③ of transmitter gently.If the car does not move in a straight line,you can adjust the trim ⑥ of transmitter until the car moves in a straight line.

6>OK,ready to run.

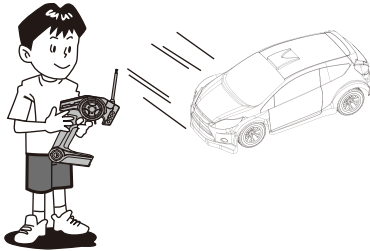

Practice

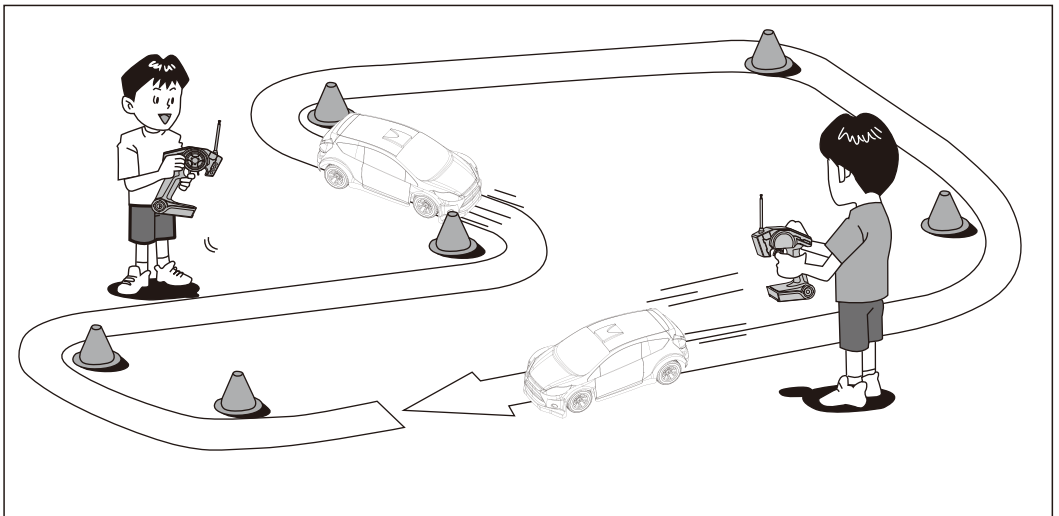

Let's practice!Make R/C car circuit at a wide and safe location using corner pylons(separately available),empty cans or such.Running fast at straight section and slow down at curved section is a basic speed control technique useful when driving R/C car.

Maintain

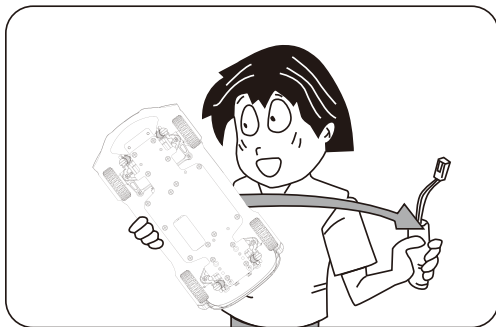

When the car is not in use, you should remove the battery from the car.

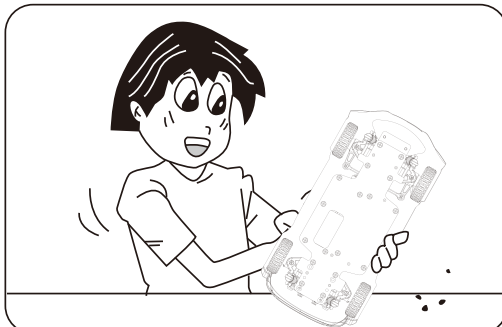

Completely remove sand, mud, dirt etc.

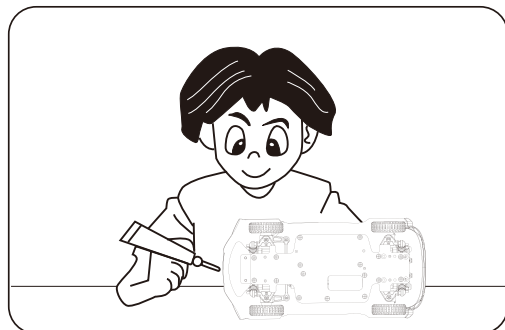

Metal outside should apply the rust prevention oil.

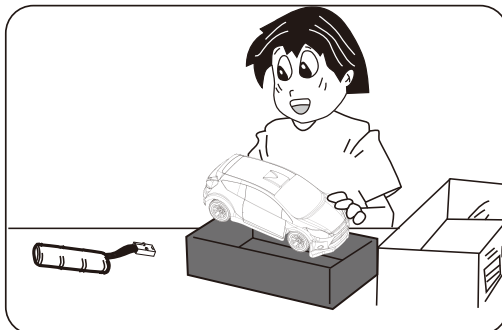

Store the car and batteries separately when not in use.

Assembly Exploded Diagram

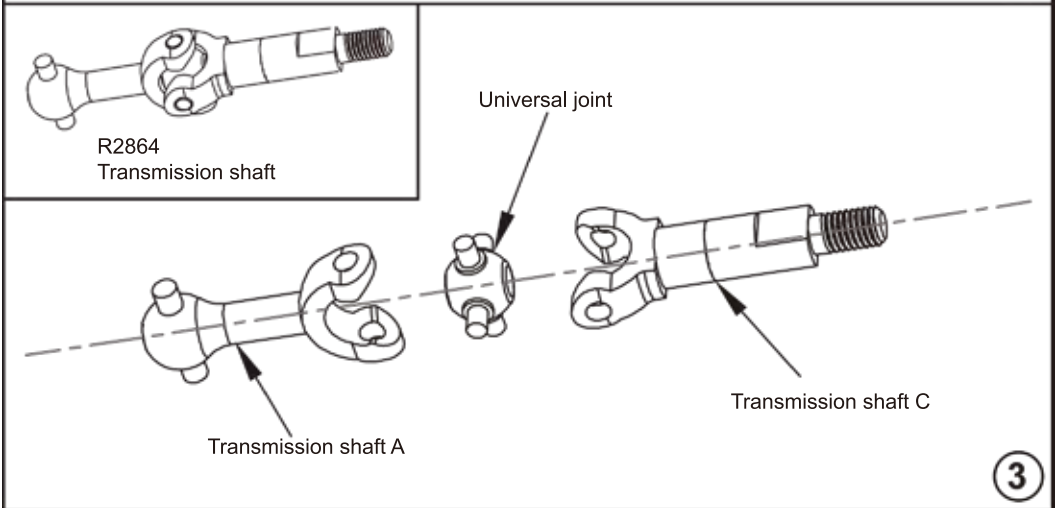
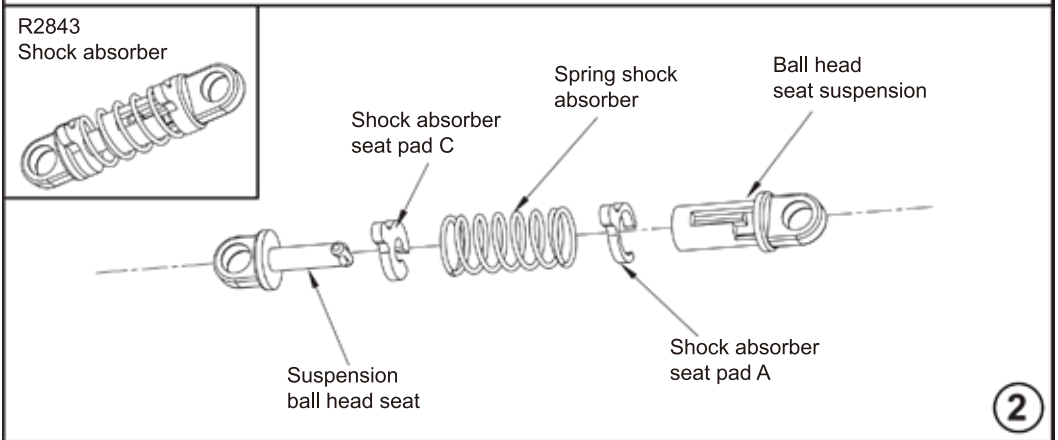
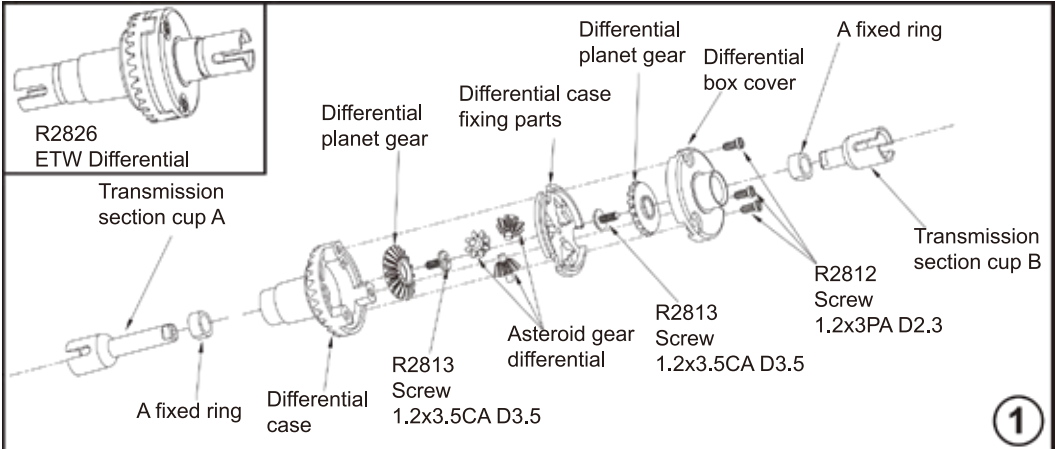

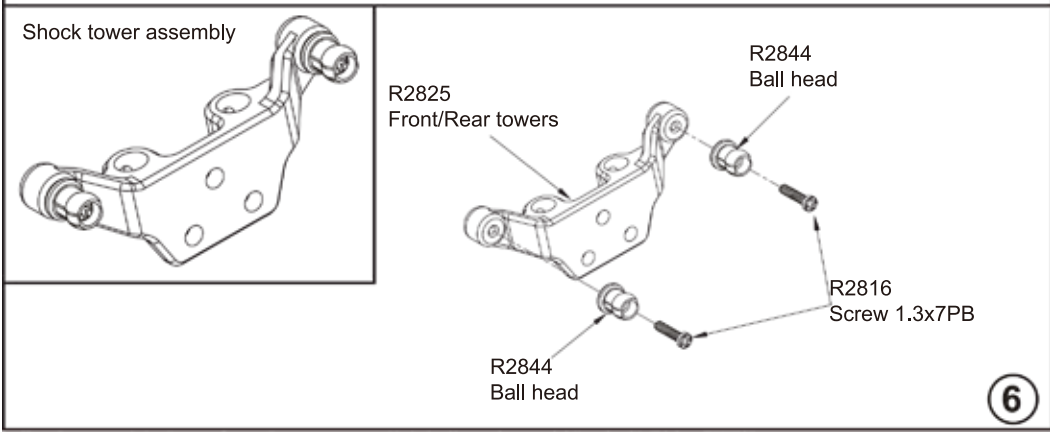
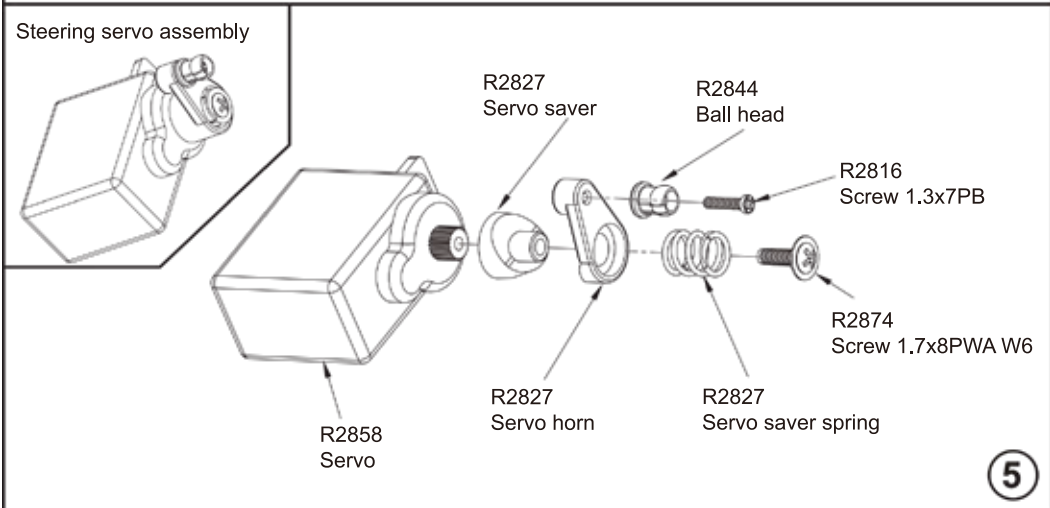
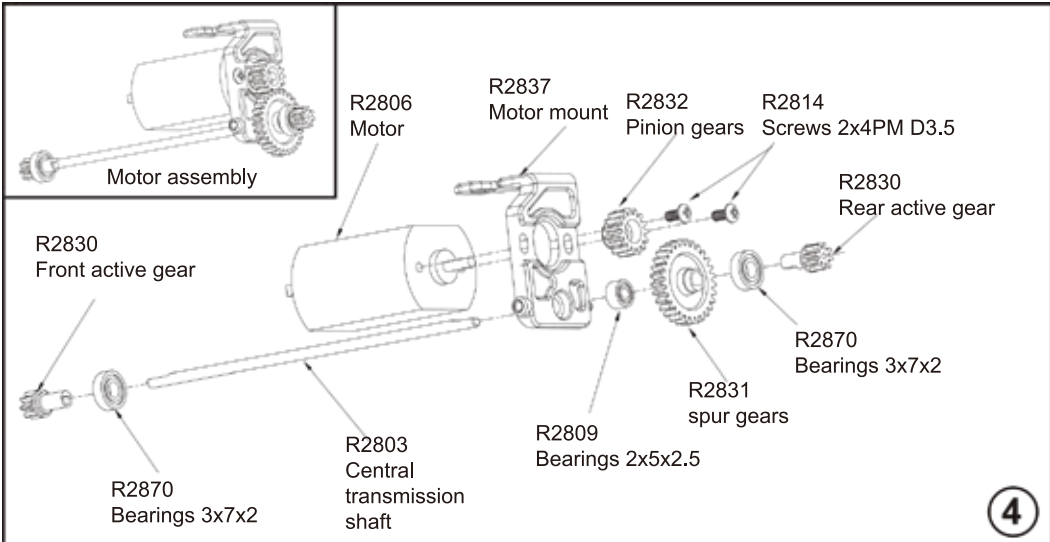

Gear box assembly

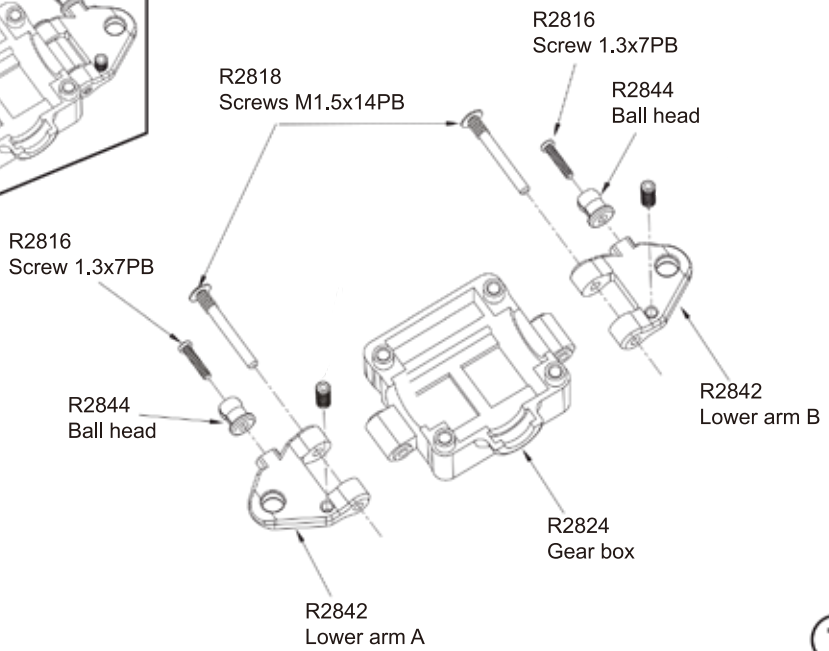
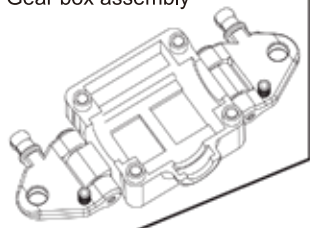

Left tire



R2853 ETW Racing tire

R2749 ETW Racing rim

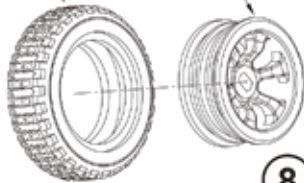

8

Right tire



R2749 ETW Racing rim

R2853 ETW Racing tire

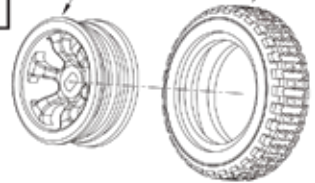

9

Front left steering hub assembly

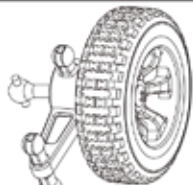

R2864 Transmission shaft

R2870 Bearings 3x7x2

R2867 Nut M2

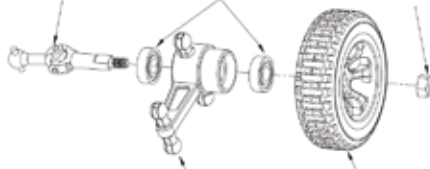

R2834 Steering hub left

R2853 ETW Racing tire left

10

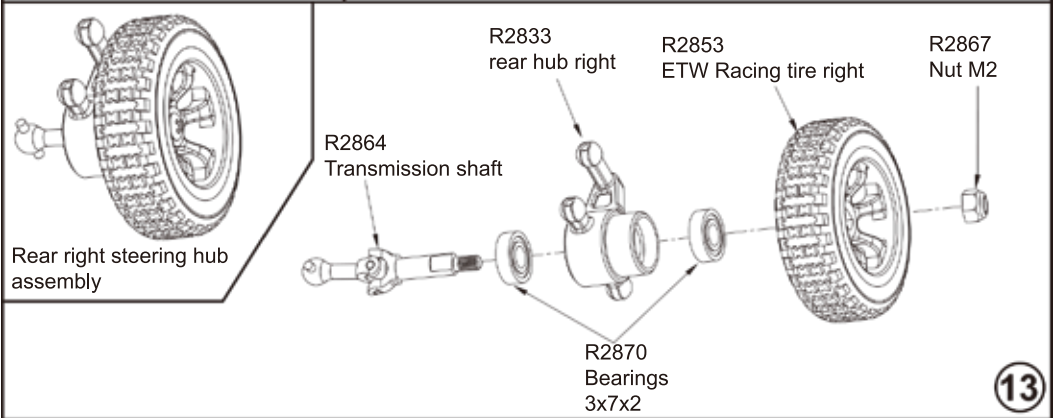
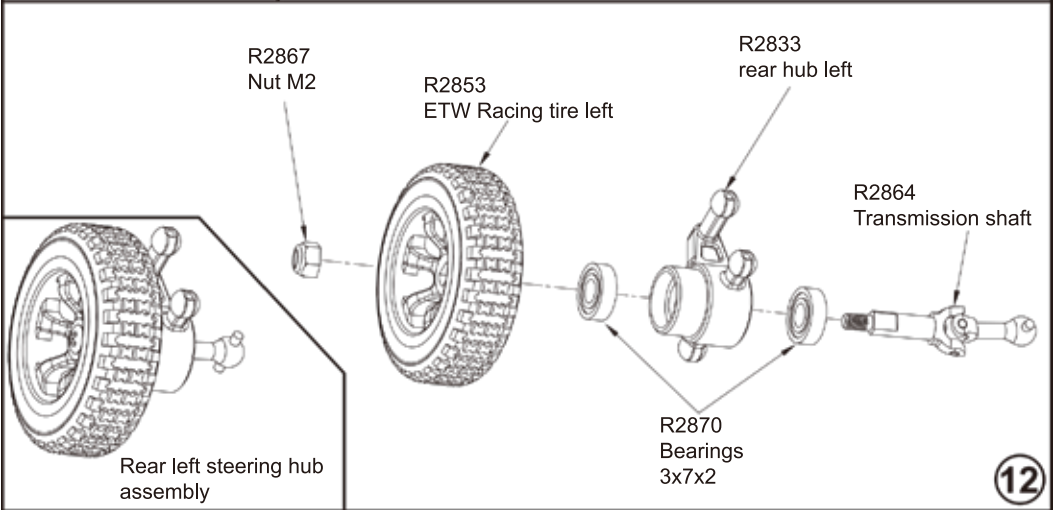
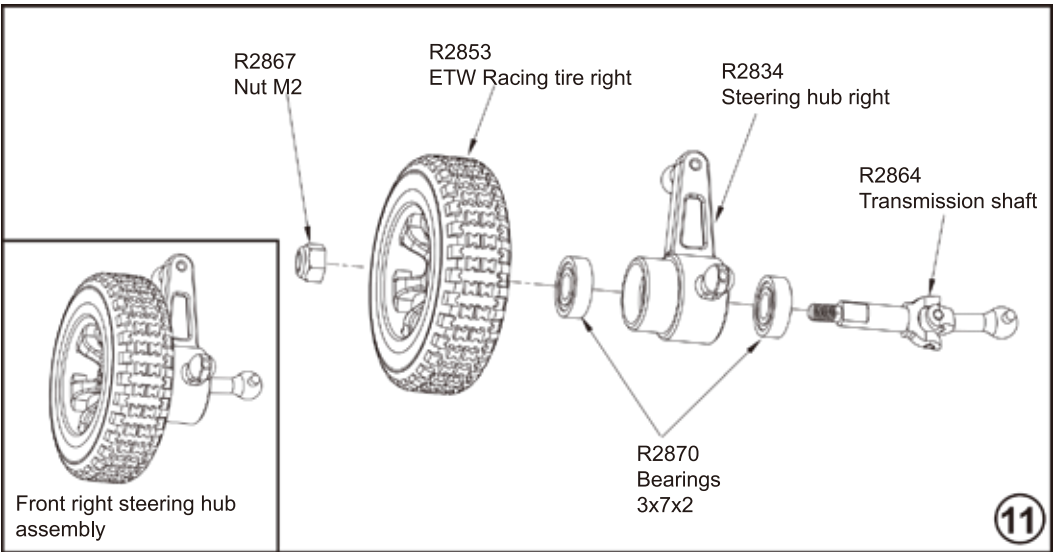

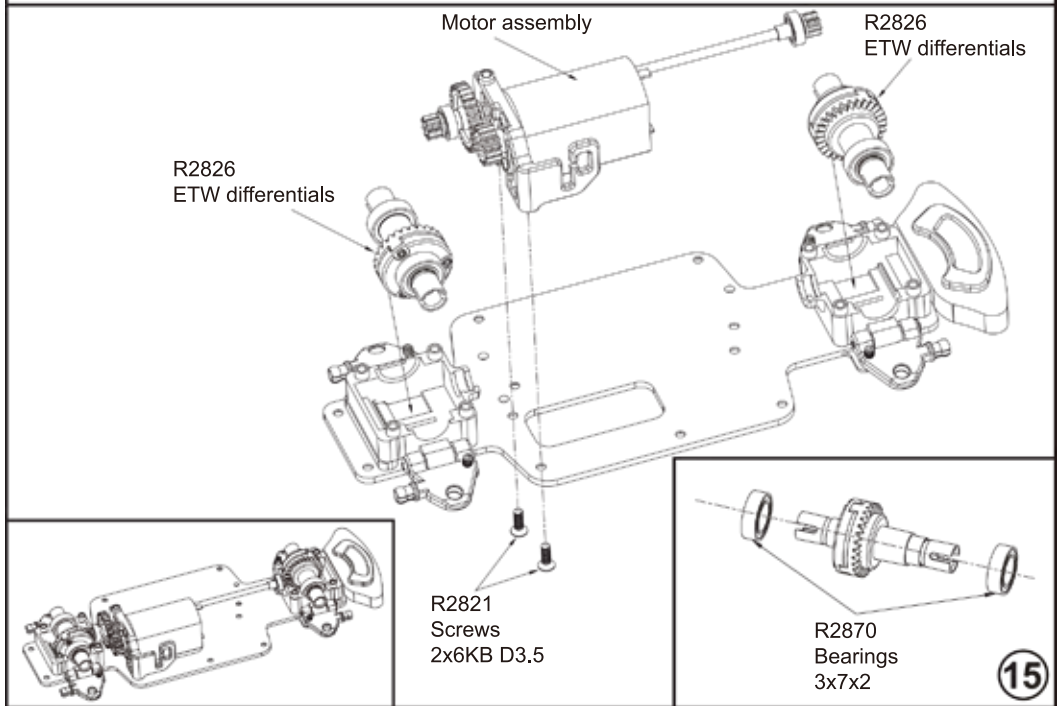
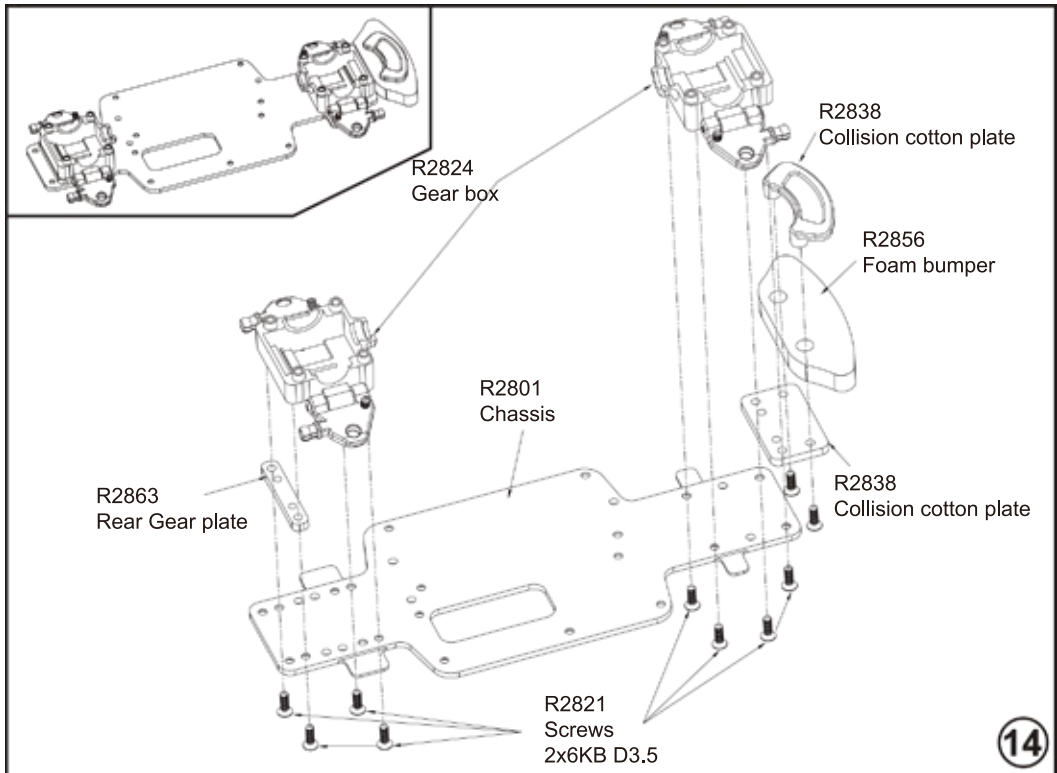

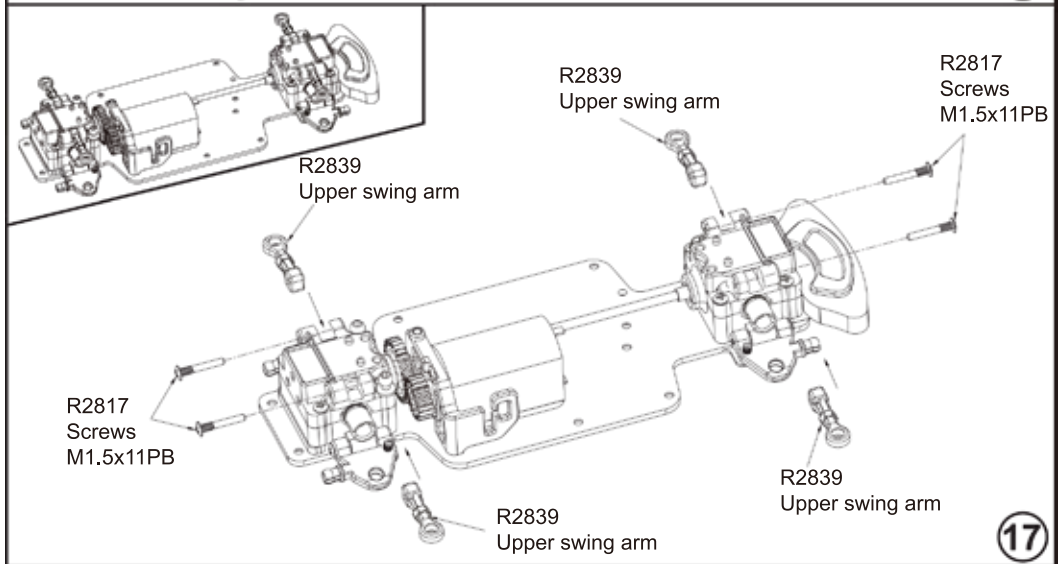
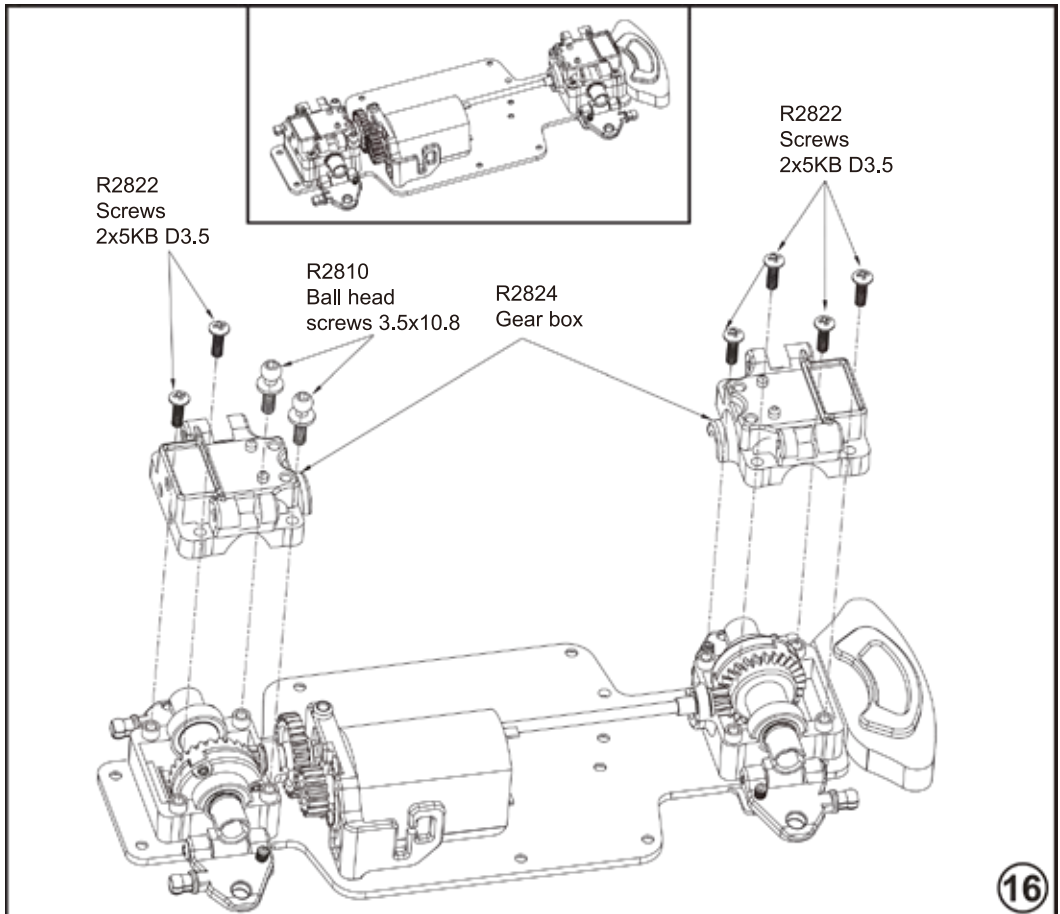

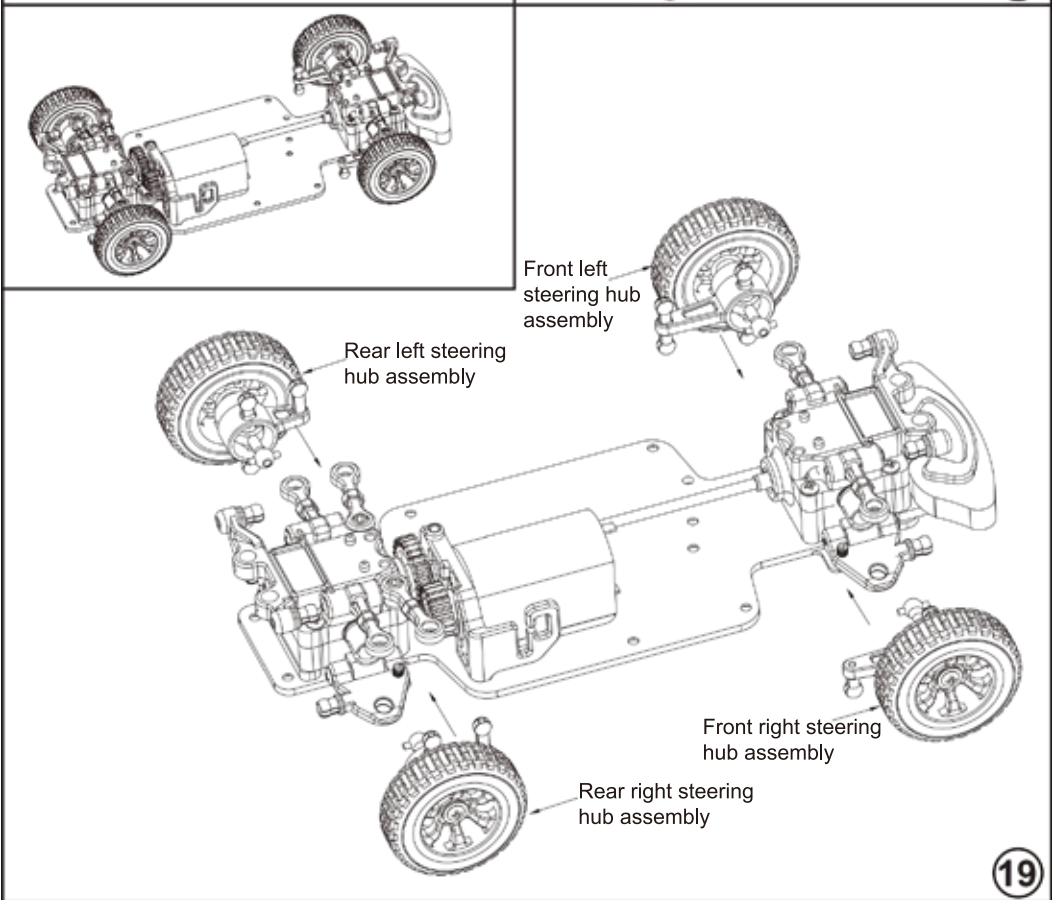
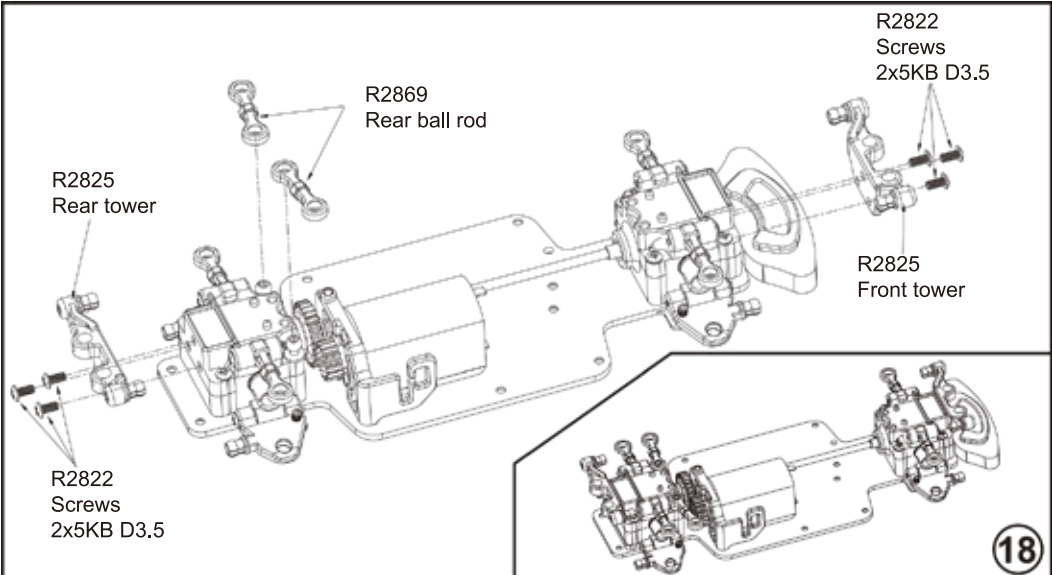

R2835
Battery holder B

R2835
Battery holder A

R2821
Screws 2x6KB D3.5

20

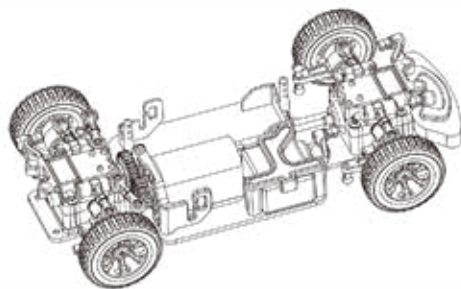
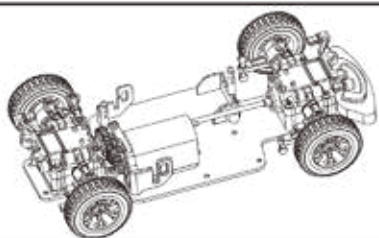

R2836
Servo holder

R2858
Servo

R2821
Screws 2x6KB D3.5

21

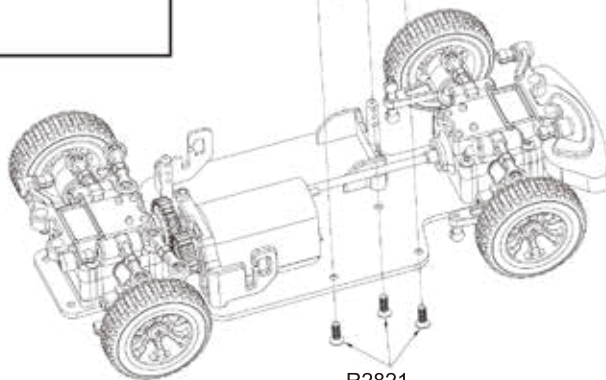

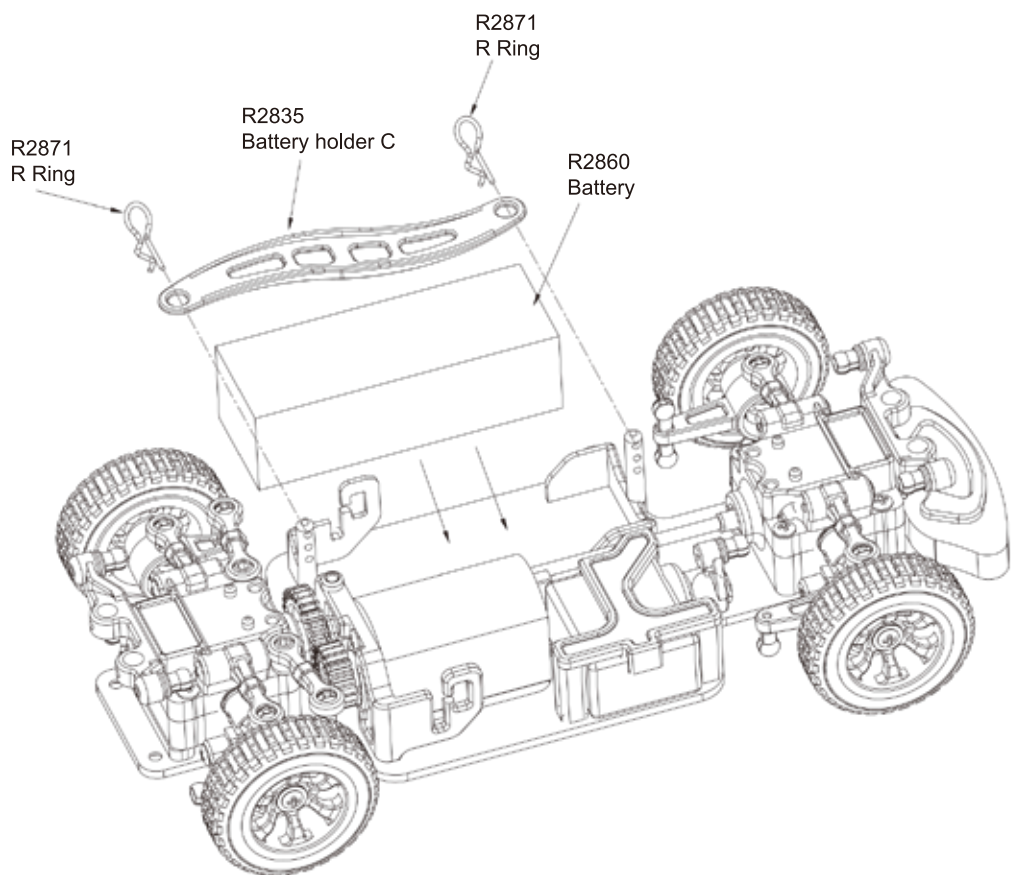
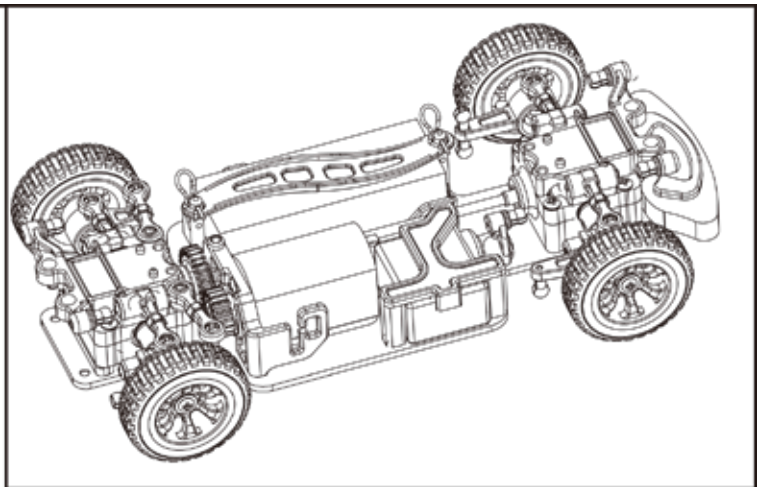

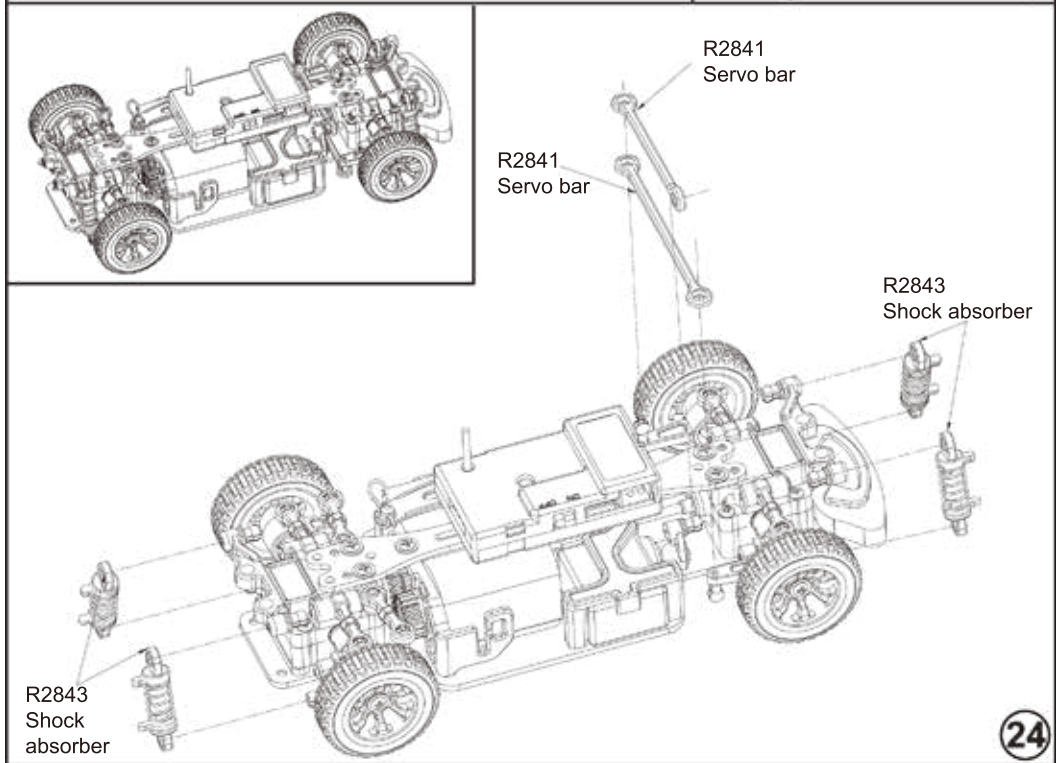
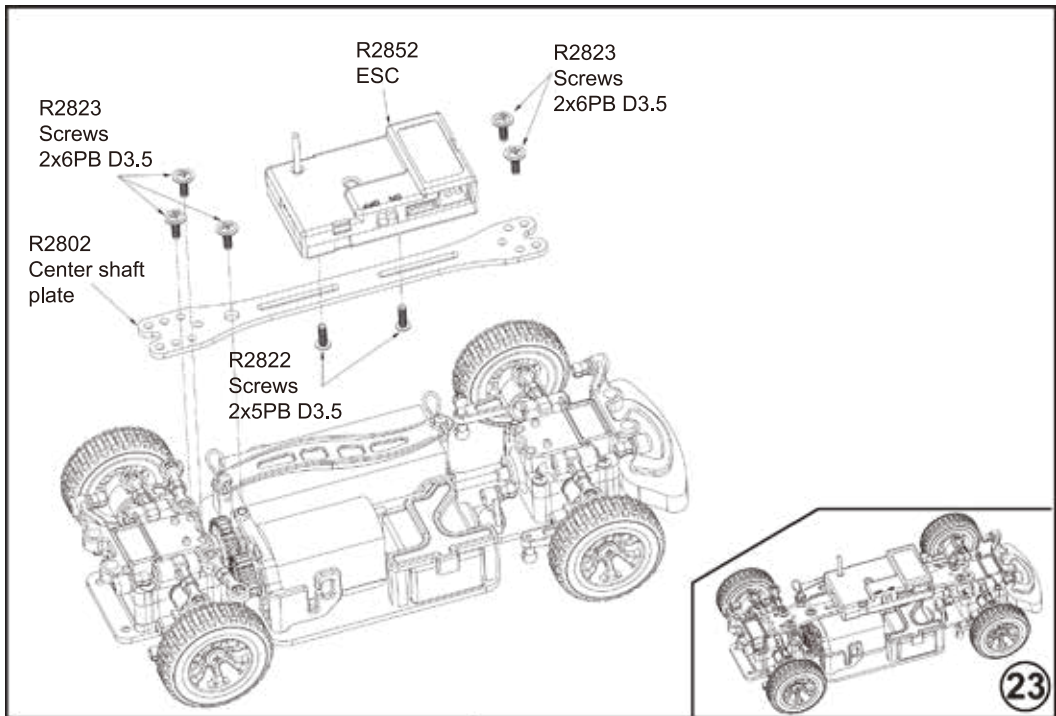

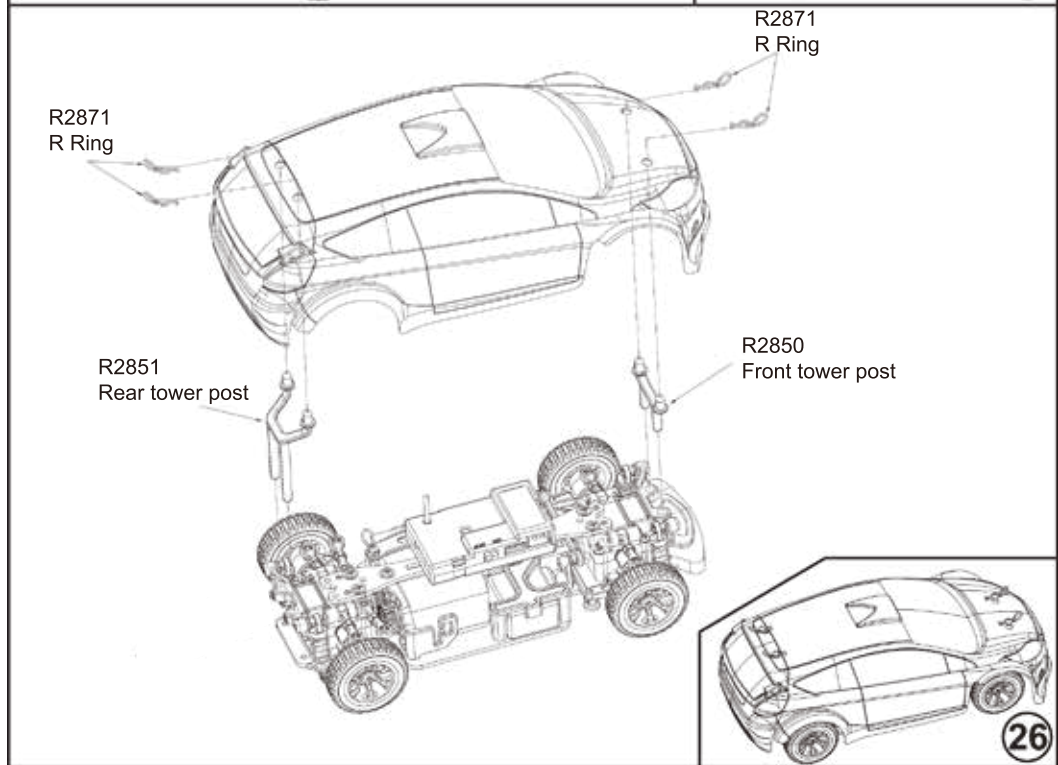
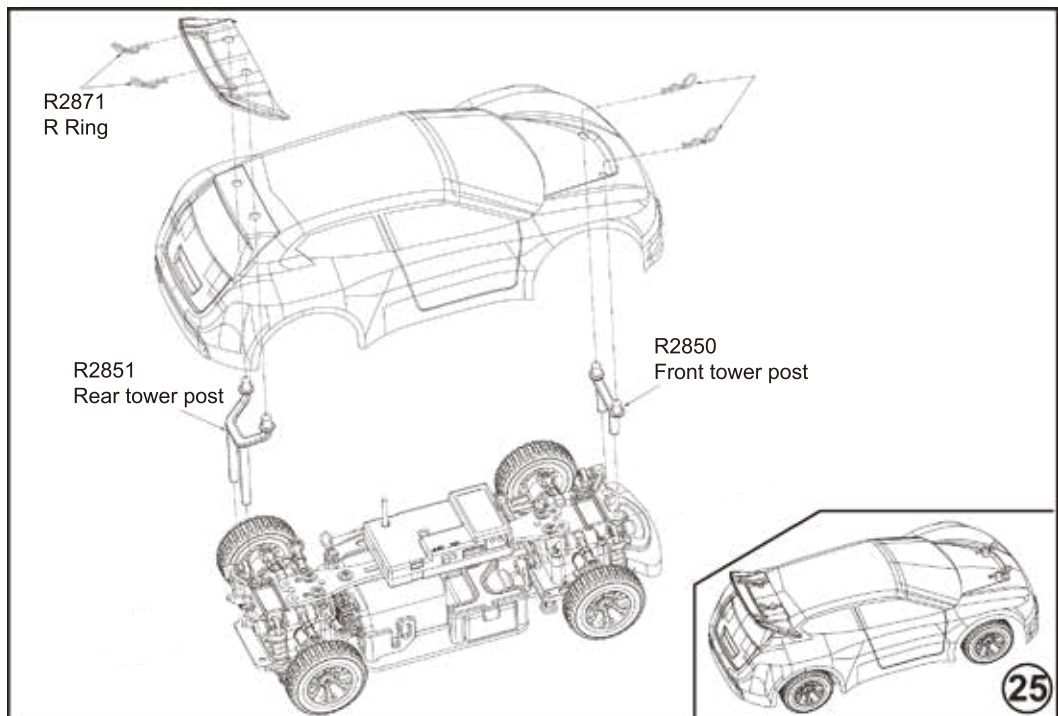

Sale parts view

R2805

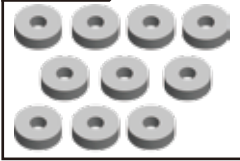

Cover shim set

R2801

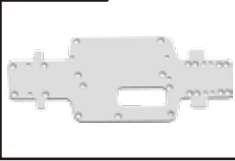

Chassis

R2802



Center shaft plate

R2803



Central transmission shaft 2x78

R2806



Motor

R2807



Bearing 6x10x3

R2870



Bearing 3x7x2

R2809

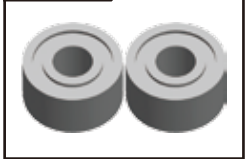

Bearing 2x5x2.5

R2810

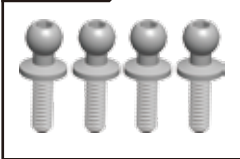

Ball head screw 3.5x10.8

R2871



R Ring

R2812

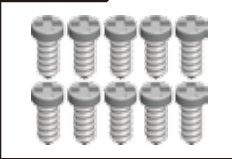

Screws 1.2*3PA D2.3

R2813

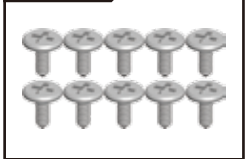

Screws 1.2*3.5PA D3.5

R2814



Screws 2*4PM D3.5

R2874



Screws 1.7*8PWA W6

R2816



Screws 1.3*7PB

R2817



Screws M1.5*11PB

R2818

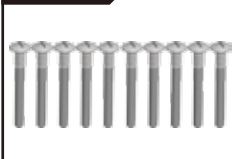

Screws M1.5*14PB

R2819



set screw M2x5

R2858



Servo

R2821

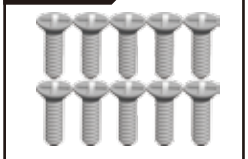

Screws 2*6KB D3.5

Sale parts view

R2822



Screws 2*5PB D3.5

R2823



Screws 2*6PWB W5

R2824

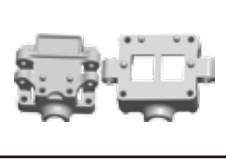

Gear box

R2825

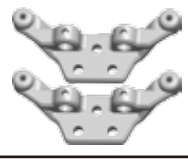

Front/Rear tower

R2826

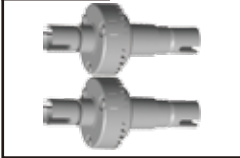

ETW Differentials

R2827

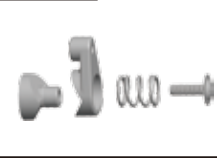

Steering gear buffer accessories

R2830

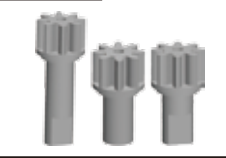

Front & rear active gears

R2831

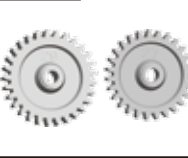

Spur gears 27/29

R2832

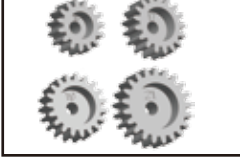

Pinion gears
15/17/19/21

R2833



Rear hubs

R2834



Steering hubs

R2835



Battery holder

R2836



Servo holder

R2837



Motor mount

R2838



Collision cotton plate

R2839

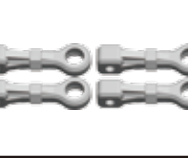

Upper Swing arm

R2869



Rear ball rod

R2841

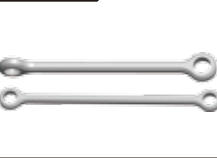

Servo bar

R2842



Lower arm

R2843

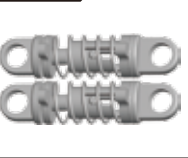

Shock absorber

Sale parts view

R2844

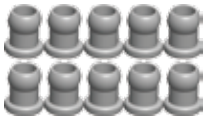

Ball head

R2867



Nut M2

R2864



Transmission shaft

R2849



ETW Racing rims

R2850



Front tower post(short)

R2851

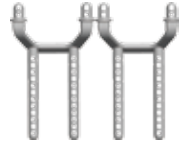

Rear tower post(long)

R2852

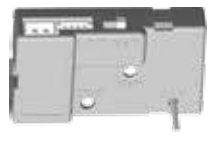

ESC

R2853



ETW Racing tire

R2854



ETW Cover

R2863



Rear gear plate

R2856



Foam bumper

R2866



Remote controller

R2857



Charger

R2860



Battery

LITHIUM BATTERIES WARNINGS AND PROPER USAGE INFORMATION

- **DO NOT LEAVE LITHIUM BATTERIES CHARGING UNATTENDAND.** You should always remain close to the charging battery to monitor the charging process and react to potential problems should they occur.
- Only use the provided charger in order to charge the included battery. Failure to do so may cause fire, which may result in personal injury and/or property damage.
- Do not charge Lithium batteries inside the model/car/boat etc.
- Do not puncture the Lithium battery.
- Only charge in isolated charging area away from flammable materials and on non-conductive and non-flammable surface. Lithium batteries fires cannot be extinguished with water. If a fire occur, wither cover it with sand or better still salt. On no account use water to extinguish a fire as water acts as petrol for Lithium batteries.
- If at any time you see a part of the battery 'puff up' disconnect from the charger immediately and either cover it with sand, or place in a non-conductive container and place it outside away from all flammable objects for at least 30 minutes.
- Manually check the temperature of your Lithium battery pack constantly during charging. Unlike other types of cells, Lithium cells should never get warm and should stay at the ambient temperature when being charged. If any of the individuals cell within a pack becomes warm/hot compared to the other cells, disconnect it immediately and either cover it in sand or place it in a non-conductive container and place it outside away from all flammable objects for at least 30 minutes.
- Store Lithium batteries in a temperature between 5-27°C (40°-80°F) for best results. The lower the temperature the better.
- Always disconnect the battery from your device/car/boat etc. when not in use.
- Always check the batteries for physical or electrical damage before charging or discharging.
- Do not short wires of your Lithium batteries, this is very dangerous and can cause a fire or even explosion. If you accidentally short wires your Lithium battery. Either cover it in sand or place it in a non-conductive container and place it outside away from all flammable objects for at least 30 minutes.
- Do not 'Top up' your Lithium batteries. Even if you charged them a year ago. Lithium loose less than 1% of their capacity per month just use them and recharge as normal.
- Do not charge cells that have been stored in cold conditions below 10°C/50°F, let them warm up for a minimum of 30 minutes.
- You risk an explosion if you attempt to charge batteries which has been used or stored under 0°C/32°F. Warm them first for at least 60 minutes above 10°C before charging.
- Do not store your Lithium batteries for extended periods of time (more than 1 hour) in a hot place as this may cause them to catch fire or even explode.
- Do not ingest contents of Lithium batteries; if you do accidentally swallow any content of Lithium batteries seek medical attention immediately.
- Keep all batteries out of reach of children.

RC-PRO

We believe that you should make the most out of your R/C vehicle. If you are ever in need of advice, service or parts, please visit our website for a list of our retailers and service centers.

WWW.RCPRO.CA