

GOAL ZERO

# YETI<sup>®</sup> APP

---

QUICK START GUIDE

---



NOTICE: this is for the mobile app software which may be updated at anytime. This guide is for Goal Zero Yeti App version 3.0 and may no longer apply to the latest version of the software. For the latest manual please visit <https://www.goalzero.com/user-guides/>.

Congrats on your new Goal Zero Yeti Portable Power Station!  
With its built-in WiFi capability, you can control and monitor your Yeti from just about anywhere through the Goal Zero Yeti App.

**Some helpful hints before you start:**

Make sure to have your home WiFi network name (SSID) and password ready as you'll need it during the setup process.

To get the app, scan the QR code below or search and download the Goal Zero Yeti App in the Apple App Store® or Google Play™ Store.

Once launched, follow the on-screen prompts for setup.

If you have trouble, use the in-app help or give our Solutions Center a call at 888-794-6250.



**Scan the QR Code to download the App**

## PAIRING

### STEP 1 - SELECTING CONNECTION TYPE

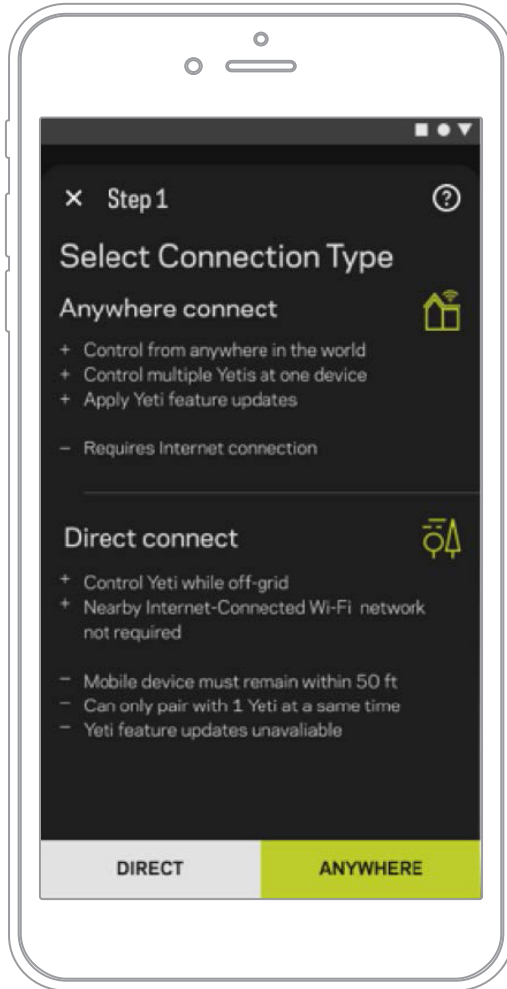

## PAIRING

### STEP 2 - TURNING ON YOUR YETI'S WIFI / BLUETOOTH

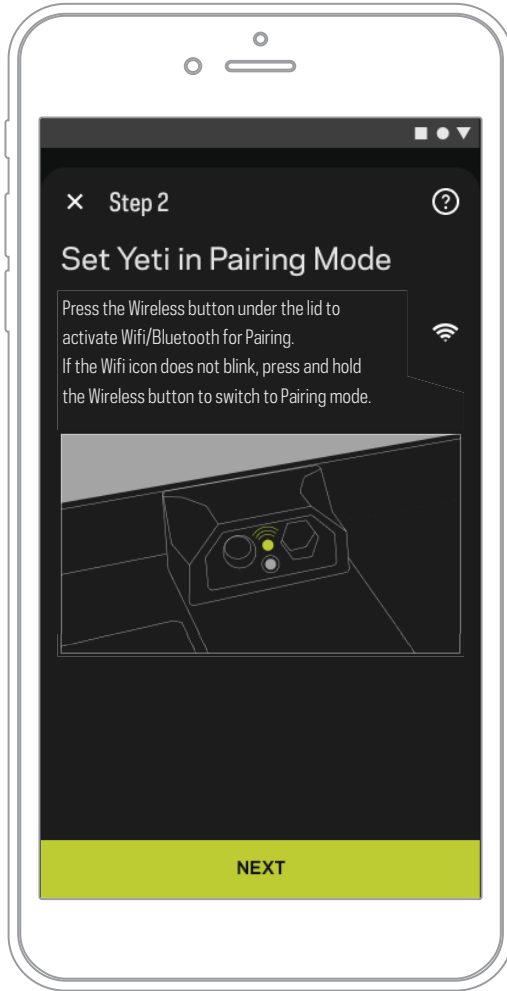

## PAIRING

The Yeti's Wireless button is located under the lid. It's the top of the two buttons.

One press is all it takes to activate the Yeti's WiFi. If the WiFi icon does not begin to blink, press and hold the Wireless button for 3 seconds.

WiFi Icon on Yeti LCD

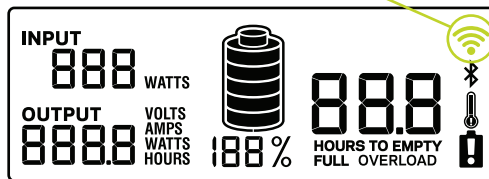

Note: this LCD configuration applies to Yeti 1500X, Yeti 3000X, and Yeti 6000X. If your Yeti is not one of these models, your LCD may look slightly different.

## PAIRING

If your Yeti has firmware v0.8.1 or newer it also supports pairing via Bluetooth.

If your Yeti supports pairing via Bluetooth, the Bluetooth icon will also blink.

To verify your firmware version on the Yeti, press and hold the UNITS + LIGHTS buttons for 3 seconds. In the app, you can find the version under Device Information in the settings.

Bluetooth icon on Yeti LCD

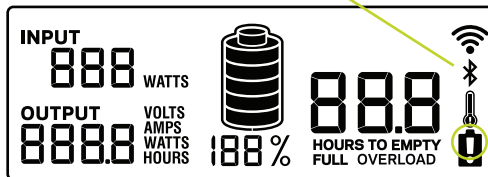

Note: this LCD configuration applies to Yeti 1500X, Yeti 3000X, and Yeti 6000X. If your Yeti is not one of these models, your LCD may look slightly different.

## PAIRING

### STEP 3 - CHOOSING PAIRING METHOD

If the Bluetooth icon is blinking on the Yeti, Bluetooth is supported. Bluetooth pairing is the quickest way to get connected.

If you selected **WiFi**, proceed to **STEP 4a**.

If you selected **Bluetooth**, proceed to **STEP 4b**.





## PAIRING

### STEP 4a - CONNECTING TO YOUR YETI'S WIFI NETWORK

#### **Read the on screen instructions carefully!**

You'll be leaving the Yeti App to connect your mobile device to the Yeti's WiFi. Be sure to come back to the Yeti App once your device is connected to the Yeti's WiFi network.

Connect using the Default Password. If you choose, you can change the default password. Write it below so you don't forget!

Default Password: GOALZERO

My Password: \_\_\_\_\_

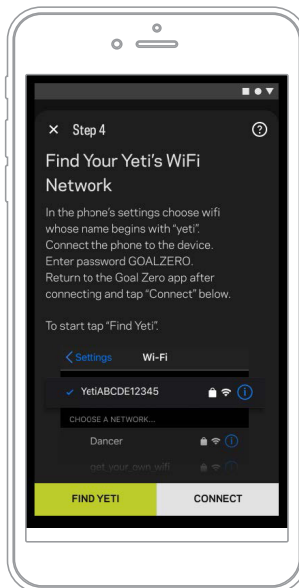

## PAIRING

### STEP 4b - CONNECTING TO YOUR YETI'S BLUETOOTH

Once you select Bluetooth, Yeti App will search for nearby Yetis. If you followed the previous instructions correctly, your Yeti's Device ID should show up in the Yeti App.

Select the Yeti to proceed to the next step.

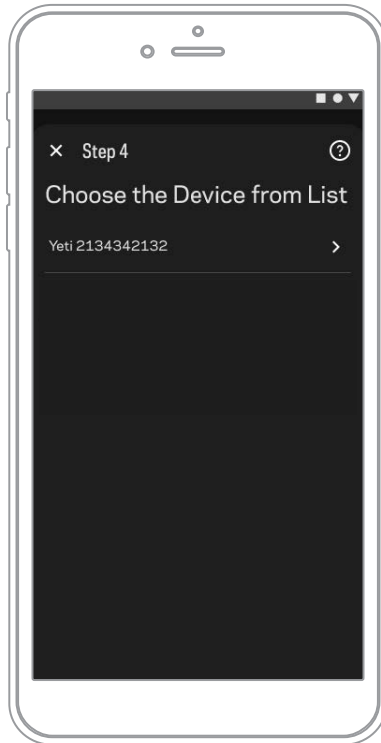

## PAIRING

### STEP 5 - ENTER WIFI NETWORK INFORMATION

The Yeti App is now connected to the Yeti. To get your Yeti online, we need to send it your Internet Connected WiFi network information.

Find your network in the dropdown. If you don't see it, you can enter the network name manually.

Once your information looks correct, tap NEXT to proceed.

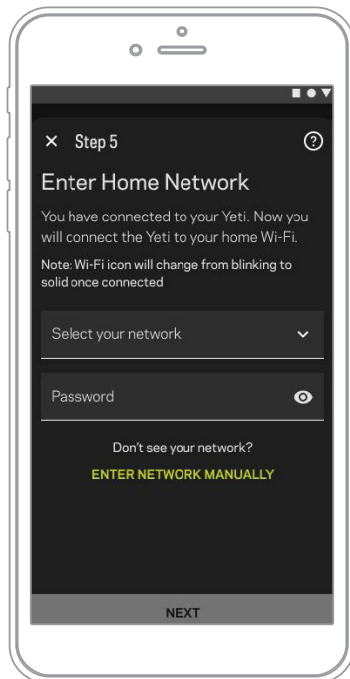

## **PAIRING**

### **WAITING FOR CONNECTION**

After a successful connection is made, the WiFi icon will stop blinking and remain lit on the Yeti's screen.

The connection process can take up to 2 minutes. You'll receive an error message in the app if something goes wrong - press OK to return to **STEP 1** in the setup.

## CONGRATULATIONS - YOUR YETI IS ONLINE!

Your Yeti is online! Proceed to the DASHBOARD to check in on your Yeti's latest status.

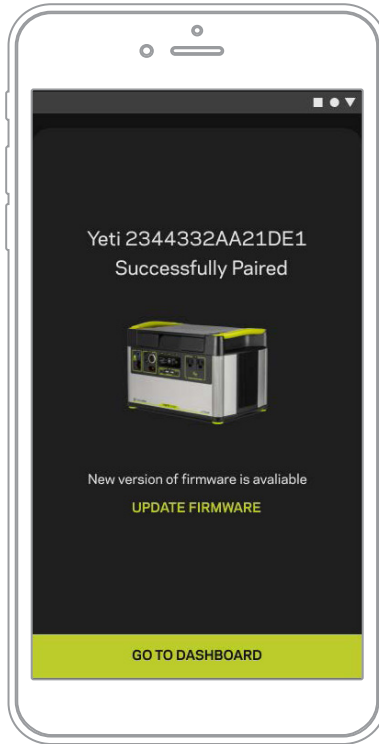

## MANAGING YOUR YETI DASHBOARD

Now that you're connected, here's everything you need to know about managing your dashboard.

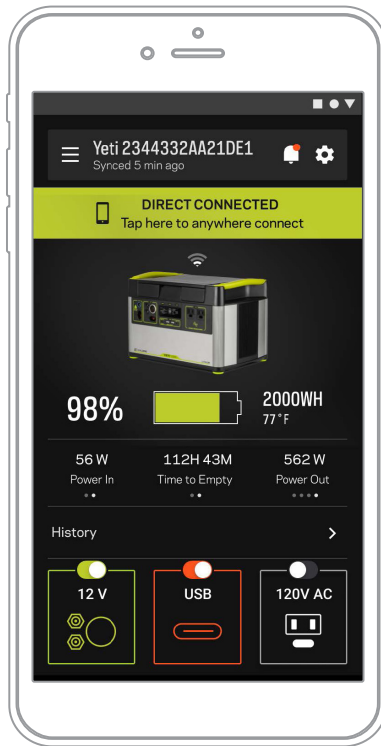

## MANAGING YOUR YETI

View all paired Yetis or Pair another Yeti

Manage all of your Notifications

Manage your Yeti Settings

Yeti's connection status - Tap to switch between Anywhere & Direct Connect

Yeti's WiFi connection strength

Yeti's State of Charge

Energy Remaining & Temperature

Tap each item to toggle info shown

View Energy Usage History

Turn ports on or off

- - The port is on and functional
- - The port was disabled due to error or protection
- - The port is off

# SETTINGS

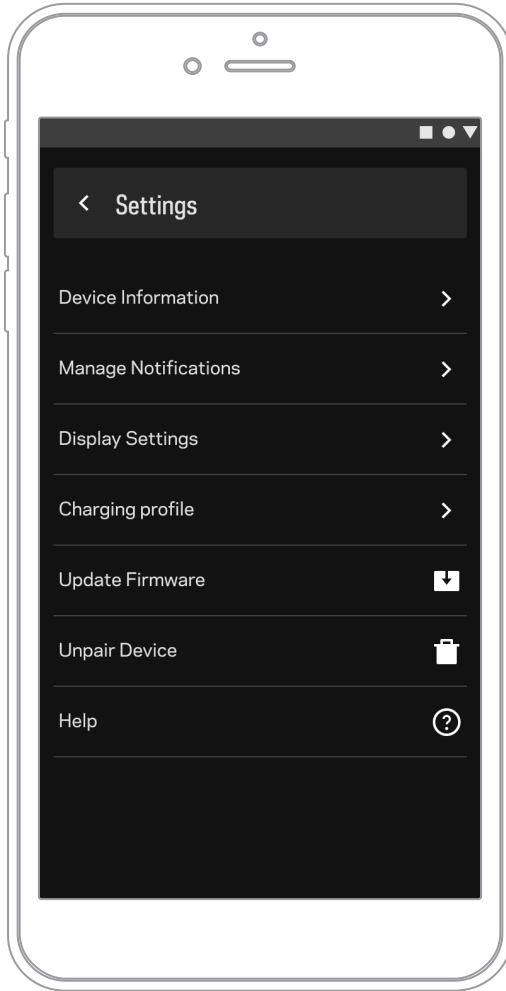



## SETTINGS DEVICE INFORMATION

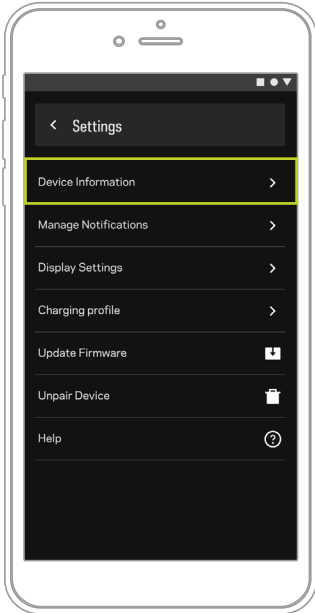

Tap Device Information for your Yeti's device identification information.

Change Your Yeti's Name. This is helpful if you're managing multiple power stations.

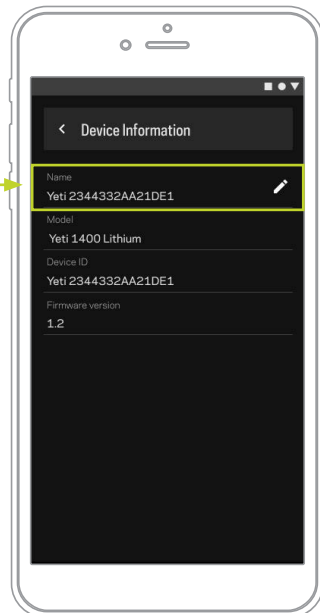

## SETTINGS MANAGE NOTIFICATIONS

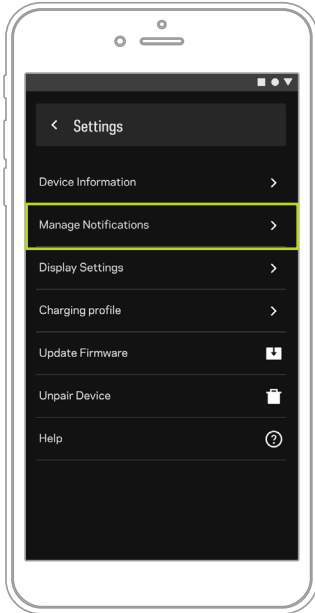

Tap "Manage Notifications" to choose which notifications you'd like to receive.

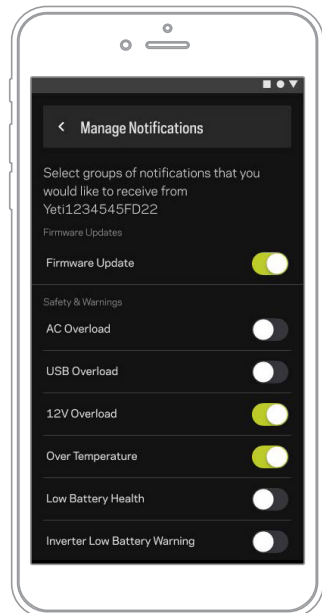

## SETTINGS DISPLAY SETTINGS

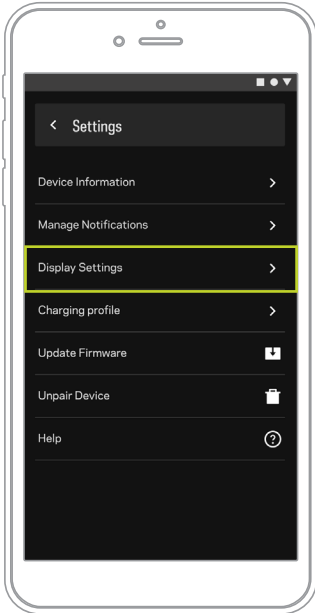

← Tap “Display Settings” to change how some data appears in the app.

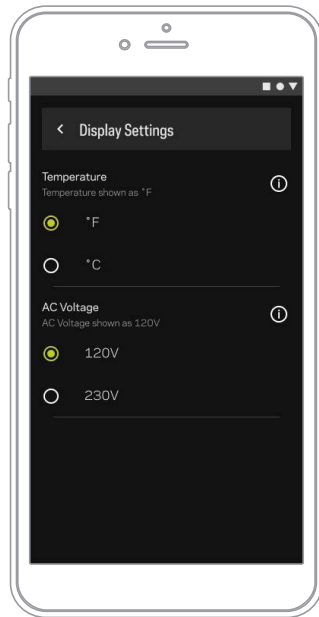

Note: AC Voltage is automatically determined in Yeti X models.

## SETTINGS CHARGING PROFILE

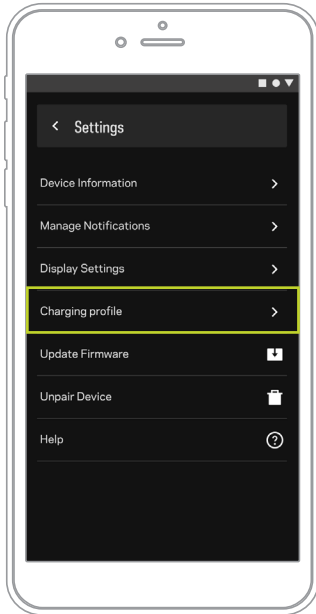

Tap "Charging Profile" to manage when your Yeti stops charging, stops discharging, and starts recharging.

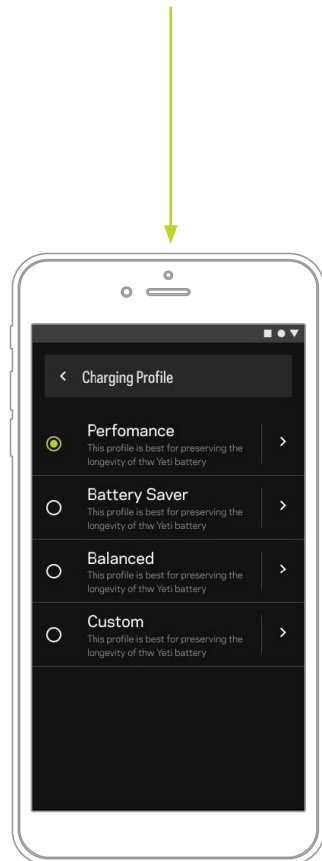

## SETTINGS UPDATE FIRMWARE

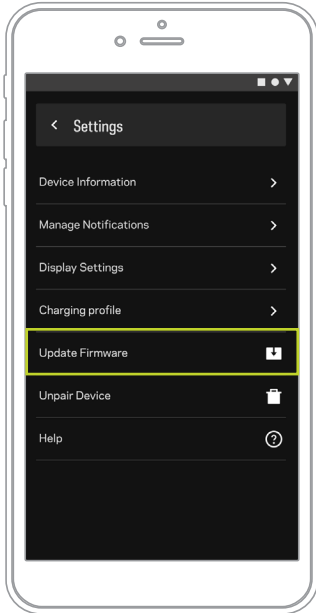

Tap "Update Firmware" to install firmware updates

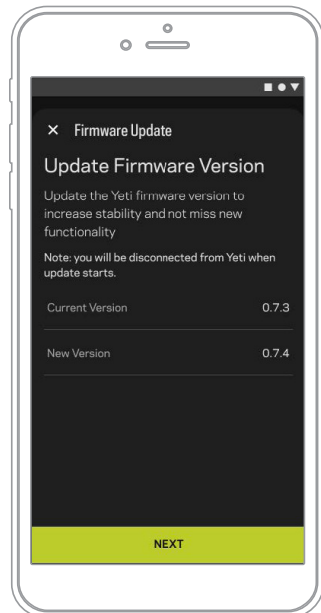

Installing firmware updates will ensure your Yeti has the latest features, enhancements, and security.

## SETTINGS UNPAIR DEVICE

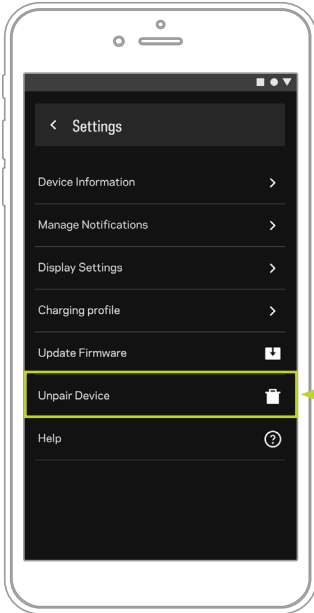

Tap “Unpair Device” to remove your mobile device pairing.

Your mobile device will no longer be able to manage the unpaired Yeti. You can always pair with the Yeti again later.

## HELP

If, at any time, you're feeling stuck, help is just a couple taps away. Look for the  icon throughout the app's screens or in settings.

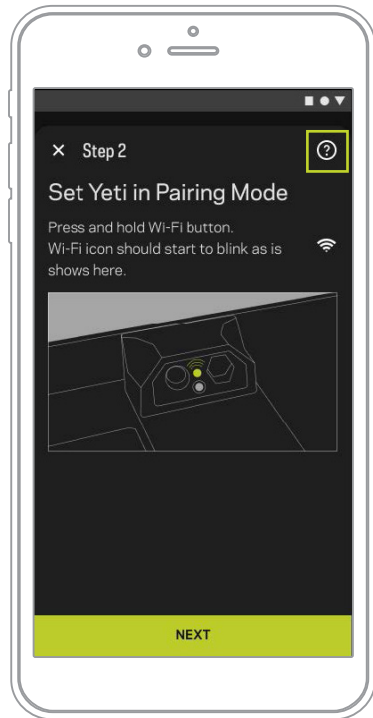
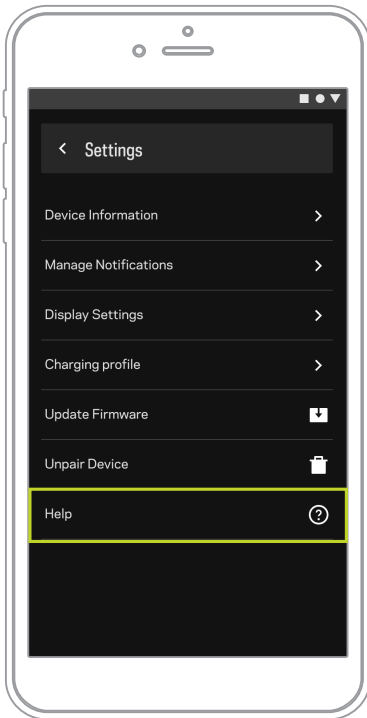

GOAL ZERO HEADQUARTERS

675 West 14600 South  
Bluffdale, UT 84065  
1-888-794-6250  
Designed in the U.S.A.  
Made in China

Goal Zero Yeti is a trademark  
of Goal Zero.

Apple App Store® is a registered trademark of Apple Inc, in the U. S. and other countries. Apple is not responsible for the operation of this device or its compliance with safety and regulatory standards.

Google Play™ store is a trademark of Google LLC, in the U. S. and other countries. Google is not responsible for the operation of this device or its compliance with safety and regulatory standards.

**GOALZERO.COM**