

Passage Latch Set

Exploded View

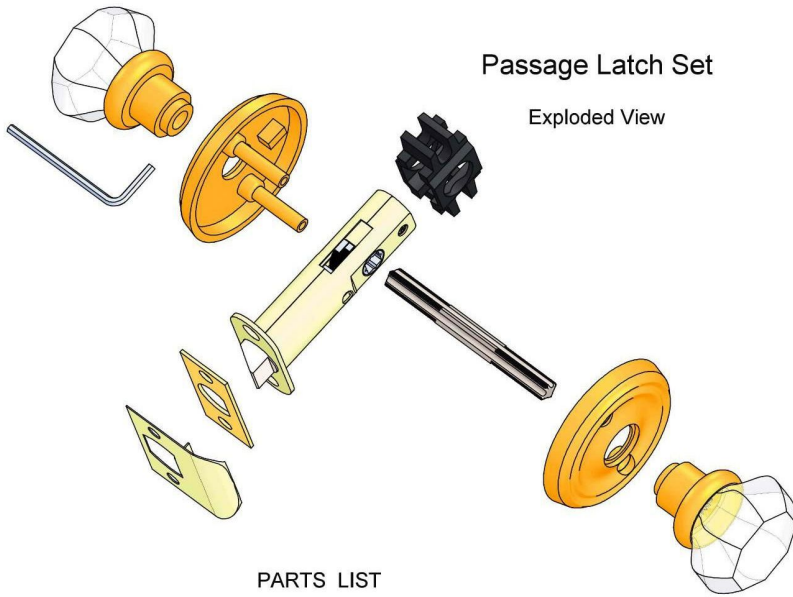

PARTS LIST

- | | |
|----------------------------------|-------------------------------------|
| 1 passage latch | 1 plastic alignment block for latch |
| 2 doorknobs | 1 face plate |
| 1 spindle - 3.5" | 1 strike plate (full lip) |
| 1 spindle - 3.25" | 4 wood screws for plates |
| 1 door rose with screw-holes | 2 machine screws (bolts) for roses |
| 1 door rose with threaded shanks | 1 Allen (hex) key |

1-3/8" standard door thickness

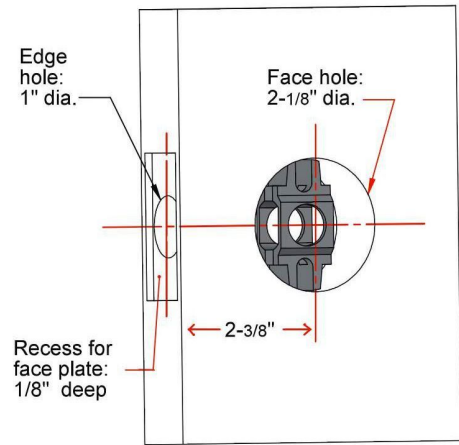

(a) Door prep for latch installation
[Standard sizes of pre-drilled holes shown with alignment block in place]

Installation instructions - tubular latch set - 2 3/8" backset - passage function

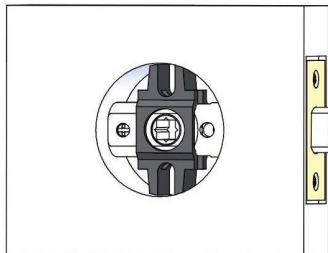

(b) Latch installed with alignment block and face plate

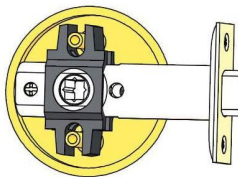

(c) Latch shown with alignment block, face plate and one rose

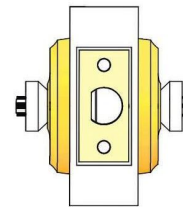

(d-1) Shown with ALIGNMENT TOOL [Alignment tool - sold separately - is used to align the roses and mark the location of holes for screws]

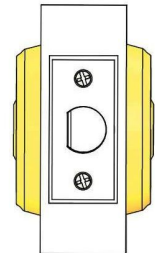

(d) Latch installed with roses

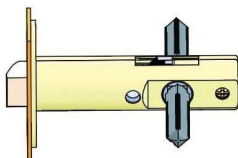

(e) Latch shown with spindle installed "ON THE DIAMOND"

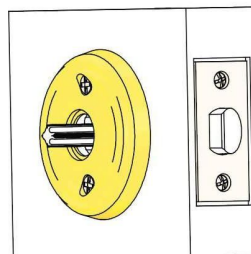

(f) Latch installed with roses and spindle

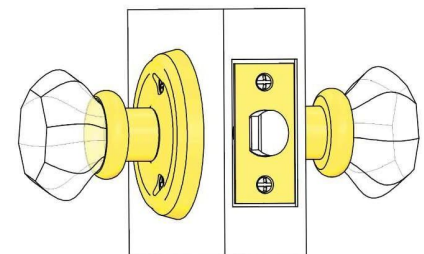

(g) Fully assembled latch set

Glass doorknobs with

Roses #8873

Passage function - backset: 2 3/8"

Installation Instructions - Tubular Latch Set - 2 3/8" Backset - Passage Function

General: Think safety. Use gloves and goggles as needed. Do not lock yourself inside a room while installing latch set.

Keep a spindle and a doorknob inside the room in case door closes inadvertently.

1. A) Doors with pre-drilled holes:

There are two holes: face hole and edge hole. Standard diameter of face hole is 2-1/8". Standard diameter of edge hole is 1". You are good to go.

B) Prep for doors without pre-drilled holes:

- 1) You'll need to drill 2 holes: a face hole and an edge hole. Standard height of the centers of the two holes is 38" to 40" from the floor. The center of the face hole is 2-3/8" from the edge of the door (equivalent to the backset of the latch). [See picture (a)].
- 2) Drill the face hole first. Make a pilot hole for it at the center. Drill a 2-1/8" diameter hole from both sides of the door to prevent splitting of the wood. [Picture (a)]
- 3) Drill a 1" diameter hole in the center of the door's edge to go through the face hole. [Picture (a)]
- 4) Mark the outline of the latch's face plate on the door's edge. Use a chisel or router to make a 1/8" deep recess for it.
2. Hold the plastic alignment block inside the larger (door face) hole. Insert the latch's tube through the smaller (door edge) hole and through the alignment piece until the latch's hub is inside the circle in the side of the alignment block. [Picture (b)].
3. The latch serves for both right-hand and left-hand doors. Turn the latch's bolt so the beveled (curved) side faces the door jamb. Put the face plate over the bolt, and install it with 2 wood screws. Once the face plate sits in place it determines and secures the orientation of the latch. [Picture (b)].
4. Place the rose with the threaded shanks on the "out" side of the door, and the rose with countersunk holes on the "in" side of the door. Insert the shanks of the rose through the guide holes in the alignment block [picture (c)] and attach the other rose to them with machine screws (don't tighten the screws yet). Position both roses so their holes align with the latch's hub. [We recommend using our alignment tool (sold separately) for this purpose.] Now tighten the machine screws to lock the roses in place. [Picture (d)].
5. The hub of the latch is star-shaped. It enables the latch to accept two widths of spindle: 9/32" [7mm] on the diamond, or 5/16" [8mm] on the square of the hub. Our spindles are 9/32" wide. Select the appropriate spindle for the door's thickness, and insert into the hub ON THE DIAMOND of the hub for a snug fit. [Pictures (e) and (f)].
6. Install the two doorknobs onto the spindle on both sides of the door. Screw both doorknobs in equally on the spindle from both sides so the middle of the spindle more or less corresponds to the middle of the latch's hub. The doorknobs should fit nicely but not tightly into the hubs of the roses. Adjust doorknobs and roses for smooth operation, and tighten the set-screws on the sides of the doorknobs' bases against the spindle with the Allen key. [Picture (g)].
7. Mark the outline of the latch's strike plate on the doorjamb. Use a chisel or a router to make a 3/64" deep recess for it. Install the strike plate on the door jamb with 2 wood screws.

