



### Description

bathtub, built-in, without brassware, rectangular 170x70, built-in version, side bath waste, enamelled steel.

### Finish



white  
100050760

### Technical drawing

Dimensions in mm

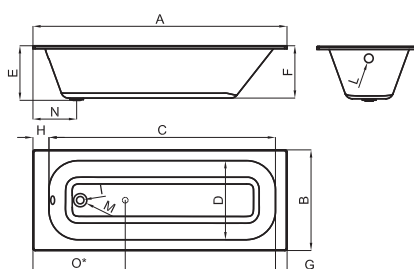

mm	A	B	C	D	E	F	G	H	I	L	M	N	O
1600 x 700	1600	700	1350	550	400	380	50	100	52	52	88	300	450
1400 x 700	1400	700	1250	550	400	380	50	100	52	52	88	300	450
1500 x 700	1500	700	1350	550	400	380	50	100	52	52	88	300	450
1600 x 700	1600	700	1450	550	400	380	50	100	52	52	88	300	450
1700 x 700	1700	700	1550	550	400	380	50	100	52	52	88	300	450