

## PRODUCT SIZING

Ref No. 7630-XXX

Measure circumference of leg 6" above mid-patella with leg fully extended

Size	Ref No.	Max	Max
Universal Knee Wrap	7630-XXX	25"	63cm
Extender Strap	152-00-01	32"	81cm
Bundle Options	Pack Size	Packs	XXX
Wrap Only	-	0	000
First Ice® System (Wrap, Packs, & Tote-Bag)	6" x 12"	4	102
First Gel® System (Wrap, Packs, & Tote-Bag)	6" x 12"	4	202

**Note:** All options are available in single and 6-pack case quantities, wraps only in 24 packs

## FIRST ICE® & FIRST GEL® (PACK ONLY)

Intergrated Hot or Cold Therapy

Product Name	Pack Size	Storage	Packs	Ref No.
First Ice® Direct Stick™ Cold Therapy Packs	6" x 12"	Zip-Lock	2	130-0612
		Direct Freeze Package (DFP)	4	144-0612
First Gel® Direct Stick™ Hot / Cold Therapy Packs	6" x 12"	Zip-Lock	4	230-0612

**Note:** DFP decreases pack freeze time and facilitates freezer storage

© 2023 Professional Products, Inc.  
www.ezywrap.com  
Made in the USA

254 Hugh Adams Rd., Defuniak Springs, FL 32435  
National: (800) 234-9004  
International: (850) 892-5731  
Fax: (800) 274-9006

R&ID# \*286724\*



REV A 5/23



# UNIVERSAL KNEE WRAP

## INDICATIONS:

### Patient Population: Adults and Children with identified indications

- Post-Operative pain and inflammation
- Post-Injury pain and inflammation
- Rehabilitation pain and inflammation
- Acute knee injuries (muscle sprains, strains, contusions, ligament tear, meniscus tear)
- Chronic knee conditions (arthritis, tendonitis, bursitis, instability, ligament tightness)

**WARNING:** This product is intended for single-patient use at the direction of a medical professional and does not prevent or reduce the risk of injury. Do Not Over Tighten. If you experience a sudden increase in pain, numbness, or unusual activity with this device, discontinue use immediately and consult your healthcare provider.

**CAUTION:** Review all instructions included with Hot or Cold Therapy, First Ice® or First Gel® before use. Hot or Cold Therapy is intended for external use only.

**CARE:** Hand-wash using a mild detergent. Rinse thoroughly. Air Dry only. Do not tumble dry.



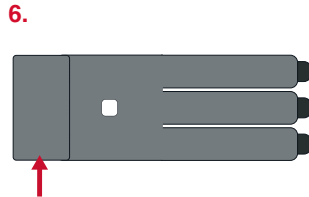
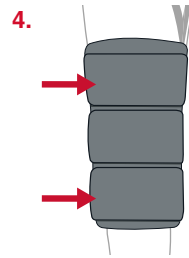
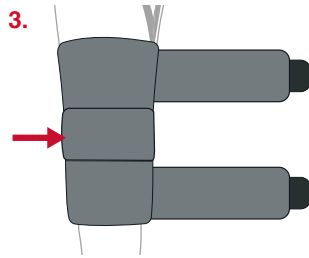
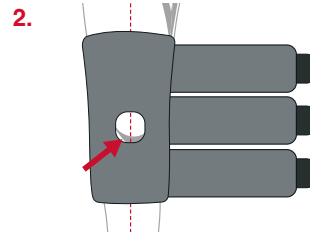
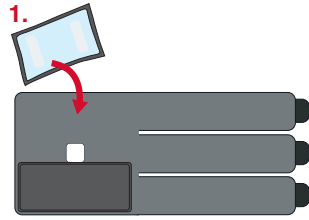

1. Place Direct Stick™ pack(s) on desired wrap area with a black barrier facing the skin

2. Place wrap with hole centered on kneecap

3. Wrap middle strap around leg and secure

4. Wrap calf and thigh straps

5. Adjust the straps to desired compression

### Optional Adjustments

6. Place extender strap for additional size

**Note:** This system is intended to be applied over any post-operative dressing when present.