

Chain Applicator Size Guide

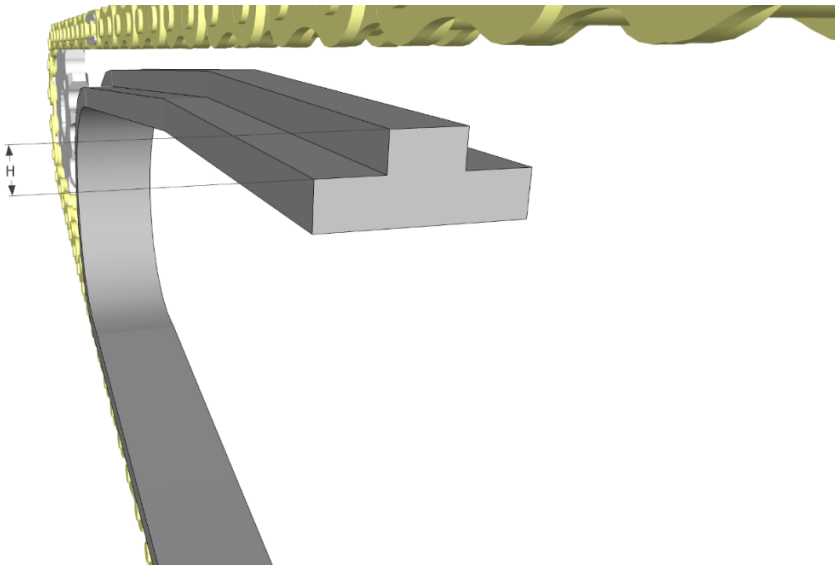

1. Measure the height (H) of the raised area on your chain slider at the desired location.
2. The thickness of the chain applicator should be at least the measured height (H) and up to 3mm (1/8") thicker

Measured Height (H)	Recommended Chain Applicator Thickness
6 mm (1/4")	6-10mm (1/4" - 3/8")
10 mm (3/8")	10-13mm (3/8" - 1/2")
13 mm (1/2")	13-16mm (1/2" - 5/8")