



VERRATEK

LumaVision



User Manual



 verratek.com

 support@verratek.com

Thank you for choosing to purchase Verratek's LumaVision Projector.

Please note: There may be some software differences between what's shown in the manual and what's shown on the projector due to software updates. Please check our website for the latest updates and information.

If you experience any issues, difficulties, or have any questions, please check our FAQ, or contact our support team: support@verratek.com and we will be happy to assist you.

 **WARNING**

Please do not open the case in order to prevent any electric shocks. Opening the case will void the projector's warranty.

Knowing Your Projector

PACKING LIST

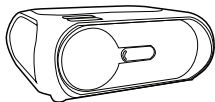

Mini Projector

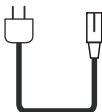

Electric Cable



Remote Controller
(Not Standard Accessory)



AV Cable



User's Guide



Lens Cleaning Fabric
(Not Standard Accessory)

The data is only for reference

Projection distance and size

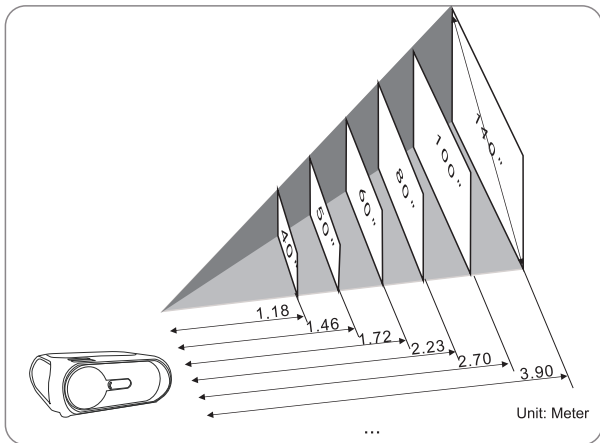

Alleged screen size (inch)	Screen size width x height (m)	Projector distance (m)
40"	0.50(H)x0.89(W)	1.18
50"	0.62(H)x1.10(W)	1.46
60"	0.75(H)x1.33(W)	1.72
70"	0.87(H)x1.55(W)	1.97
80"	1.00(H)x1.77(W)	2.23
100"	1.25(H)x2.21(W)	2.70
120"	1.55(H)x2.66(W)	3.30
140"	1.74(H)x3.10(W)	3.90

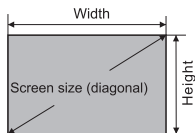

Design allowable error +/-8%

This table measures the front end and the center of the lens and assumes that the projector is horizontally placed.

Introduction

Lamp	LED	Image system	LCD
Native Resolution	1280*720	Resolution	1920*1080 Max
Aspect Ratio	16:9/4:3	Input voltage	100-240V 50/60Hz
Lens	F= 130	Projection distance	≈1.2-4m
Image size	≈ 40-200inch	Throw Ratio	1.3:1
Power consumption	70W Max	Loudspeaker	4 Ω 3W
Weight	1.36kg	Product Size	246*188*92mm
Interface	USBx2/HDMI/AV/Aux(3.5 mm)		

Working temperature : -10~36°C

Support Formats

File type	Support format
Audio	MP3/WMA/OGG/AAC/FLAC/APE/WAV
Pic	JPEG/BMP/PNG
Video	MP4/AVI/WMV/RMVB
Text	TXT

Knowing Your Projector

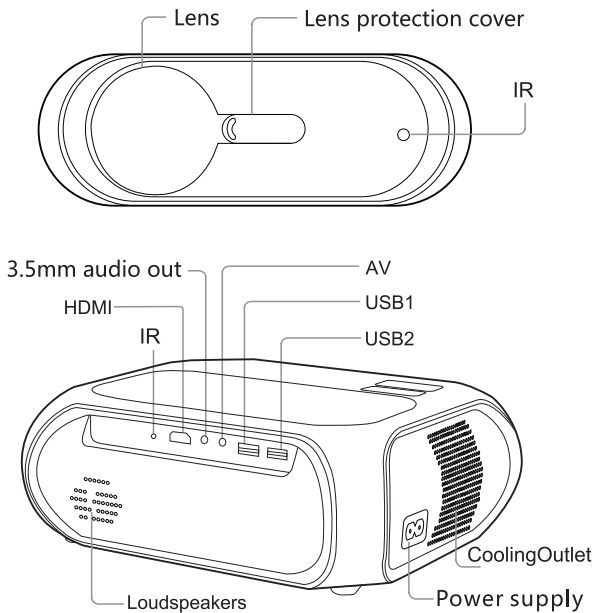
PARTS AND FUNCTIONS OF PROJECTOR

Knowing Your Projector

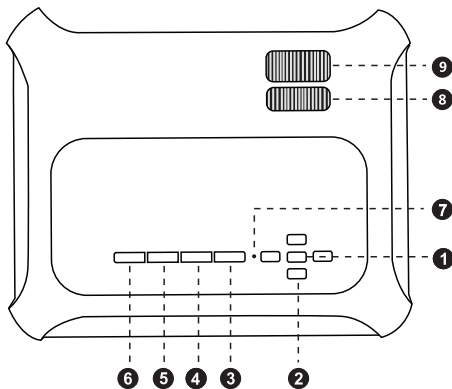
PARTS AND FUNCTIONS OF PROJECTOR

- | | | |
|---------------------|---------------------|-----------------|
| 1 OK | 2 Arrow keys | 3 BACK |
| 4 INPUT | 5 MENU | 6 ON/OFF |
| 7 Pilot lamp | 8 Keystone | 9 Focus |

Knowing Your Projector

PARTS AND FUNCTIONS OF PROJECTOR

Introduction of remote control

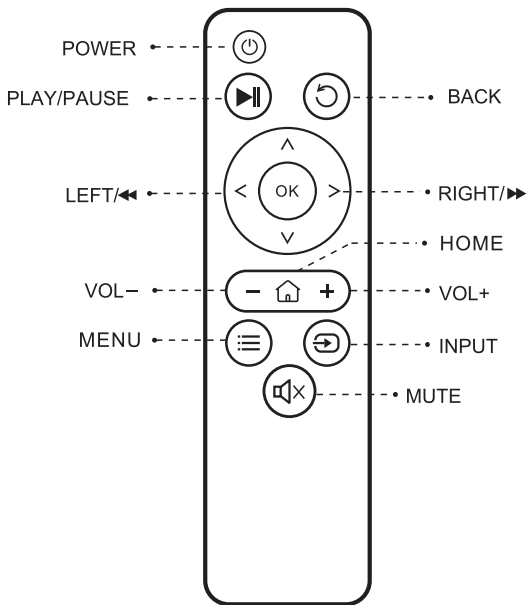

Power on/off

1. Connect the projector with power cord, then plug the power cord into AC connector. When the indicator light stops flashing, projector is under standby status.

2. Press the  button on remote o projector.

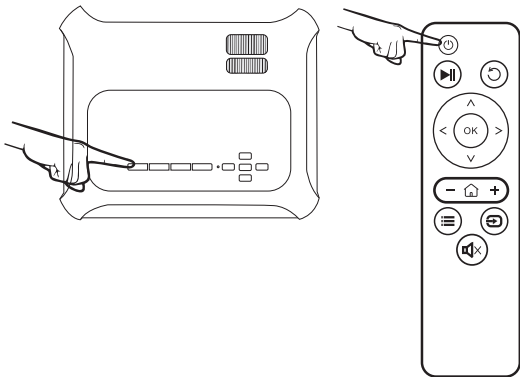

Let's Begin

First USE

1. Adjust the image (Keystone distortion)

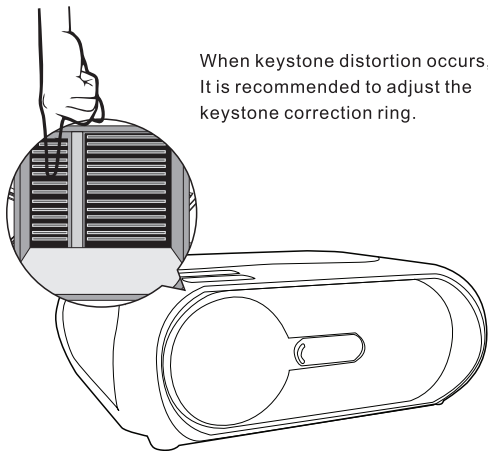

When keystone distortion occurs, It is recommended to adjust the keystone correction ring.



Bad



Good!



Bad



Let's Begin

First USE

2.Adjust the image (Blurred image)

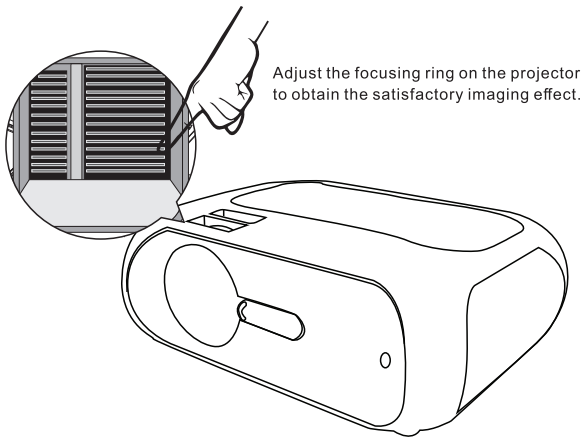

Bad



Good!



Let's Begin-HOME Input source switch

1. Enter the "Home " interface, select the "Source" icon through the remote control or the keyboard button, and press "OK" to enter"Source menu".

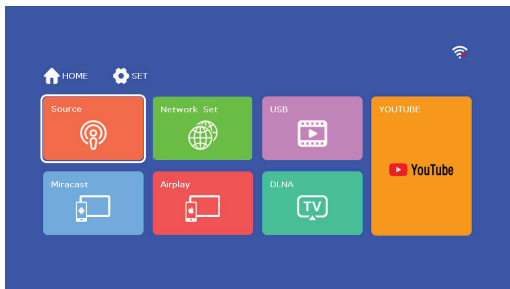

2. In the pop-up "Source" menu, select the type of signal source channel (video, HDMI, multimedia) that you want to play.

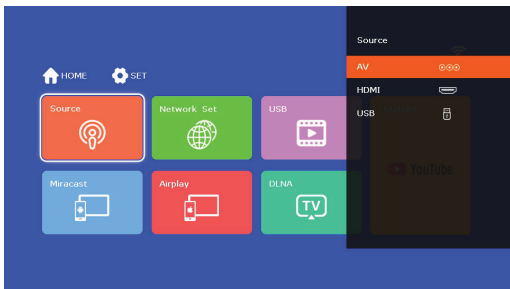

Let's Begin-HOME Network Set

1. Enter the "Home" interface, select the "Network Set" icon through the remote control or the keyboard button, and press "OK" to enter"WLAN Set menu".

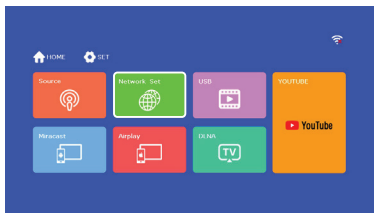

2. In the pop-up "WLAN Set" menu , select the network you want to connect to.



3. Enter the WIFI password to connect to the network.

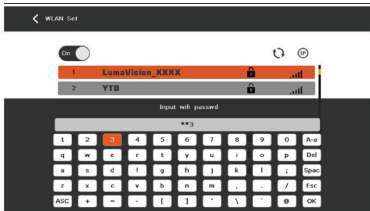

Let's Begin-HOME Multimedia function

1. Insert the USB device containing the video/picture/music/e-book file into the projector USB port (a recognized USB device icon will appear on the home page). Enter the interface of "Home", select the "USB" menu through the remote control or the keyboard button, press "OK" to enter the "USB menu".

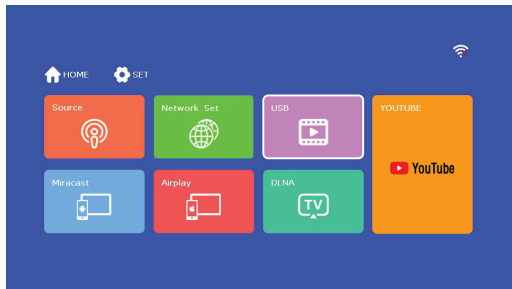

2. In the pop-up "USB" menu, select the type of multimedia file (video/picture/music/ebook) to be played through the remote control or the button on the keyboard button, press "OK" to enter the file menu in the USB device and select the multimedia file to be played.

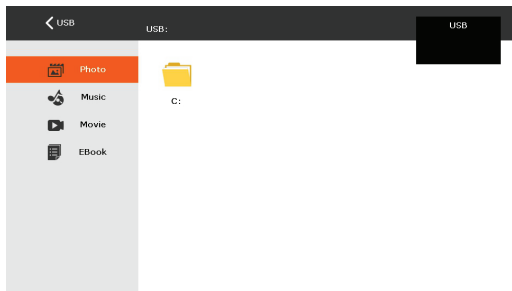

Let's Begin-HOME Miracast

1. Enter the "Home" interface, select the "Miracast" icon through the remote control or the keyboard button, and press "OK" to enter "Miracast menu".

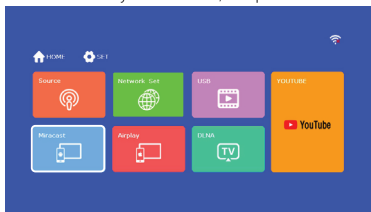

2. Open the Android device, go to "Device connectivity" under settings, click "Wireless Projection", and search the network name of the projector "LumaVision_XXXX" (as shown below), then select the projector name to connect wirelessly.

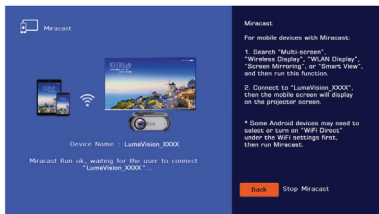

Let's Begin-HOME Airplay

1. Enter the "Home" interface, select the "Airplay" icon through the remote control or the keyboard button, and press "OK" to enter "Airplay menu".

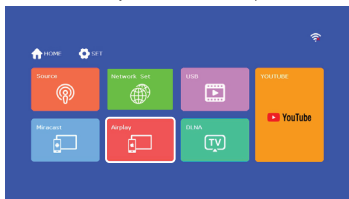

2. Airplay

Method 1: Connect your phone and projector to the same WIFI. Open the "Screen mirroring" function of iOS device, at this time, the iOS device will pop up the name of projection device, click the name to realize the wireless co-screen of iOS device and projection device.

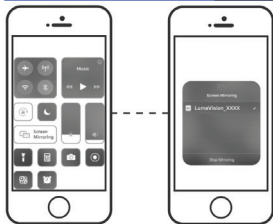

Let's Begin-HOME Airplay

Method 2: Open the iOS device, go to "WLAN" of setting to search for the name of the projector device to be connected, then open the "mirror" function of the iOS device. Then it will pop up the name of the projector device. Then select the projector name to put password to be connected successfully (As below pic shows) to realize the wireless connection function.

AP mode

This mode can syncs the iphone screen to the projector without Wi-Fi.

1. Open the phone Wi-Fi interface, search "wifi_ap_XXXX", password "12345678".
2. On the main interface, slide open up "control center", click on the "screen image", in the equipment list click choose "LumaVision_XXXX", after the connection is successful will be displayed to the projection screen.
3. Watch the video, the landscape, the phone screen can obtain larger projection screen.

On AP mode

Back Stop Airplay

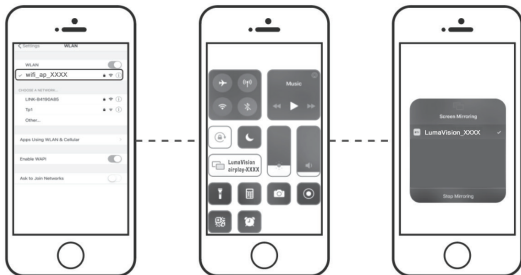

Let's Begin-HOME DLNA

1. Enter the "Home" interface, select the "DLNA" icon through the remote control or the keyboard button, and press "OK" to enter "DLNA menu".

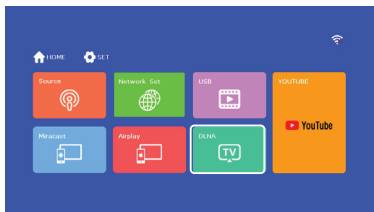

2. DLNA

Step 1: Connect your phone and projector to the same WIFI connection.

Step 2: Find "DLNA" in the APP content that needs the same screen.

Step 3: Click "DLNA" to select "LumaVision_XXXX" to complete the same screen.

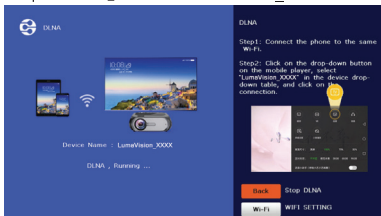

! Attention

If screen projection is not possible, please check whether the APP supports screen projection.

Let's Begin-SET Projection Set

1. Enter the "Set" interface, select the "Projection Set" icon through the remote control or the keyboard button, and press "OK" to enter "Projection Set menu".

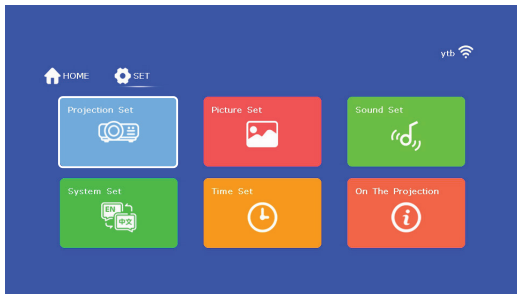

2. In the pop-up menu of "Projection Set", you can choose forward/back/formal/ceiling projection.



Let's Begin-SET Picture Set

1. Enter the "Set" interface, select the "Picture Set" icon through the remote control or the keyboard button, and press "OK" to enter "Picture Set menu".

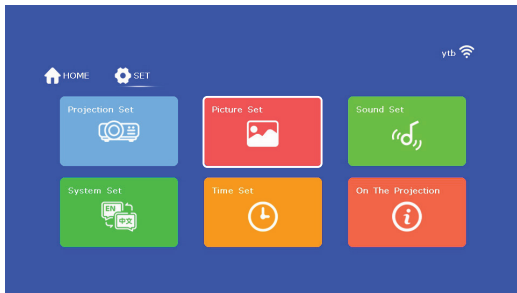

2. In the pop-up menu of "Picture Set ", you can set "image" related options.

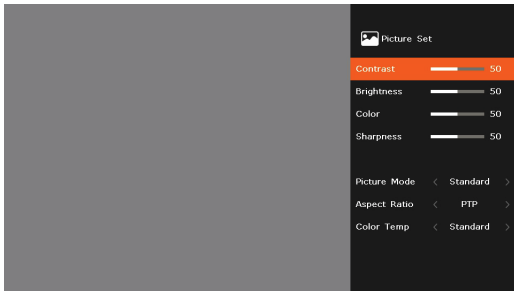

Let's Begin-SET Sound Set

1. Enter the "Set" interface, select the "Sound Set" icon through the remote control or the keyboard button, and press "OK" to enter "Sound Set menu".

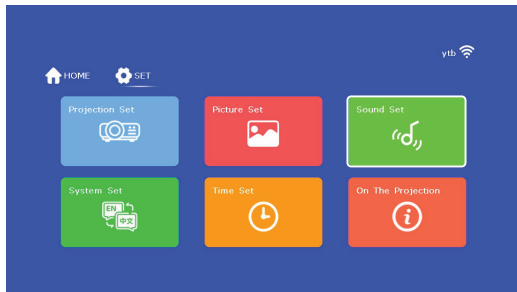

2. In the pop-up menu of "Sound Set", you can set "Sound" related options.

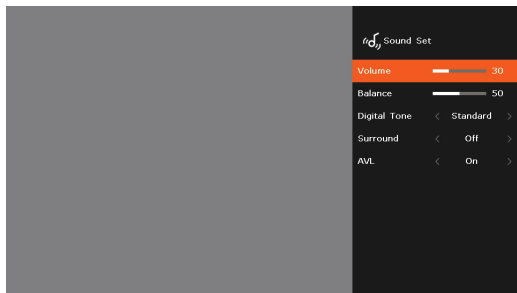

Let's Begin-SET System Set

1. Enter the "Set" interface, select the "System Set" icon through the remote control or the keyboard button, and press "OK" to enter "System Set menu".

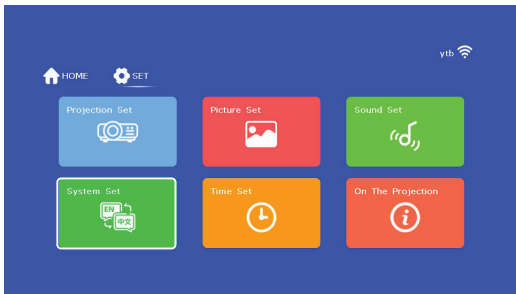

2. In the pop-up menu of "System Set", you can set "System" related options.

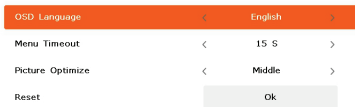

Let's Begin-SET Time Set

1. Enter the "Set" interface, select the "Time Set" icon through the remote control or the keyboard button, and press "OK" to enter "Time Set menu".

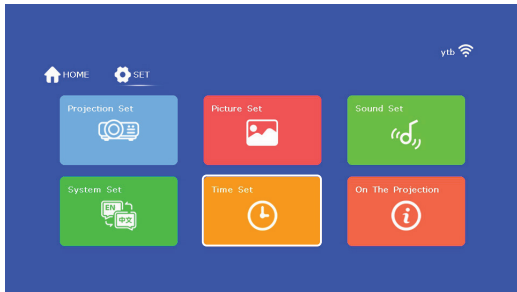

2. In the pop-up menu of "Time Set", you can set "Time" related options.

