



KV30PT

WET & DRY VACUUM CLEANER

WITH POWER TAKE-OFF SOCKET FOR USE WITH POWER TOOLS

Instructions Manual

Read instructions manual before use!



Equipmart Ltd
Kiam House
Birchill Road
Knowsley Ind. Park North
Merseyside
L33 7TD
United Kingdom



T: 0044 151 548 5500
F: 0044 151 548 5599

© Equipmart Ltd
www.kiamproducts.co.uk

1. Product Features

- 1) Vacuum cleaner for wet and dry applications.
- 2) Push and clean semi-automatic filter cleaning system ensuring continued high suction.
- 3) Storage points on the base for easy access to accessories.
- 4) Twin cable hook design for easy cable storage.
- 5) Power take-off point to connect with power tools, the socket is for synchronization function.

2. Part Names

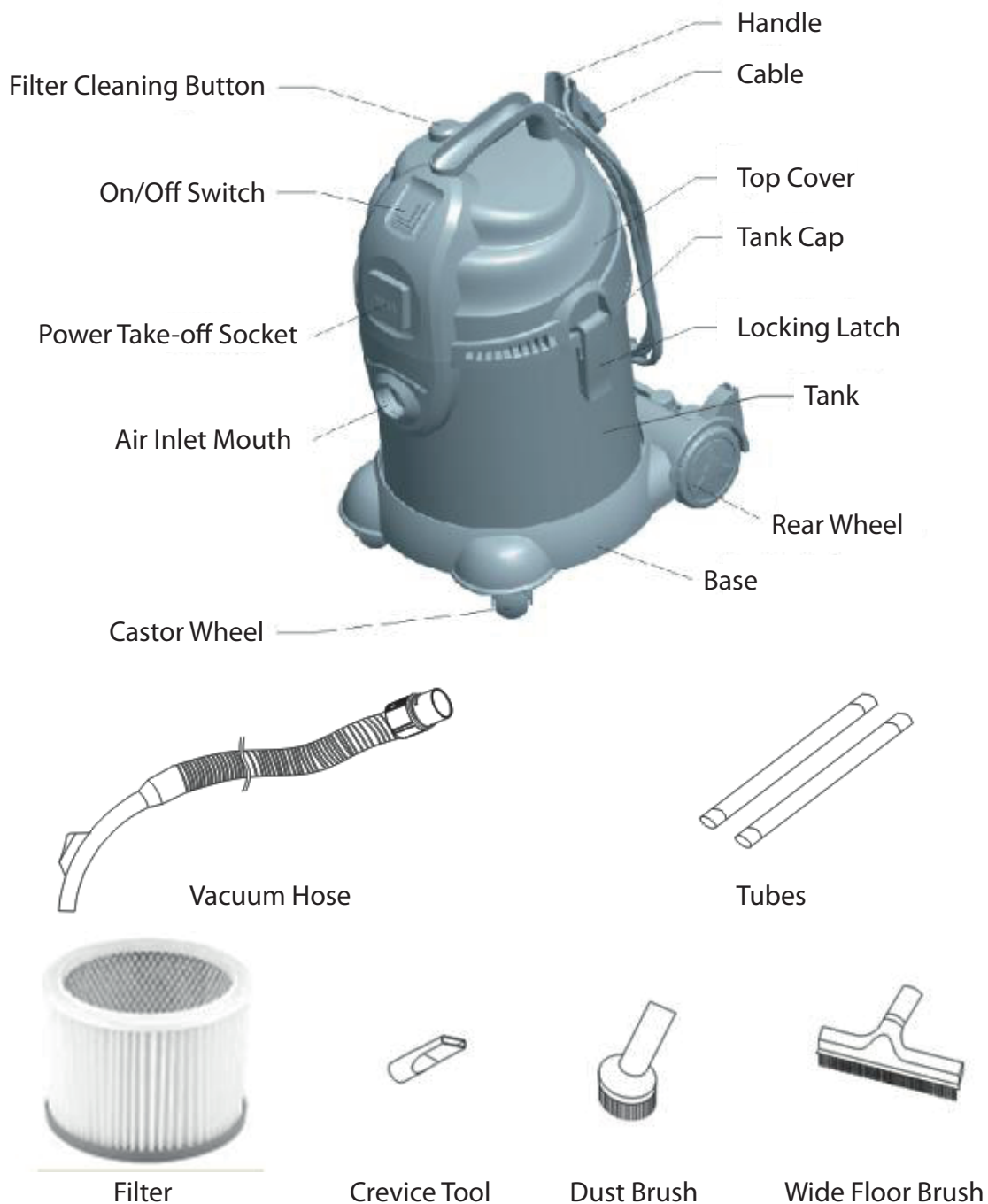

3. For Safe Operation

- 1) Check before operation that the local power supply is the same as the specification on the rating label (240v).
- 2) Do not use the machine in a combustible and explosive area in case the motor spark creates ignition of fire and/or explosion.



- 3) Do not block the air inlet mouth as this will cause the motor temperatures to increase and cause damage to the motor.

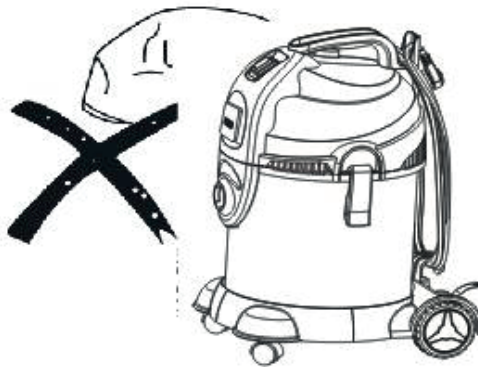

- 4) Do not pick up any of the following objects:
 - Combustible and/or explosive objects such as cigarettes, petrol, etc.
 - Sharp objects such as nails, screws, etc.
 - Objects which easily attach onto the filter such as calcourous powder, fine graphite powder, etc. that will block ventilation causing damage to the motor.



- 5) Do not overturn the machine in case water goes into and damages the motor.

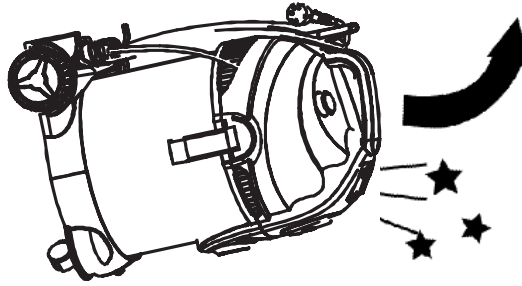

- 6) If the power supply cable is damaged, it must be replaced by the manufacturer, its service agent or a similarly qualified person in order to avoid any potential hazard.
- 7) This machine is not intended for use by children, persons with reduced physical, sensory or mental capabilities, or lack of experience and knowledge unless they are under supervision. Children must always be supervised and kept away from the machine to ensure they do not play with it.
- 8) Turn off the machine and remove the plug each time after use or when carrying out any maintenance.
- 9) Keep the machine away from strong sunlight and high temperature areas in case of plastic distorting.

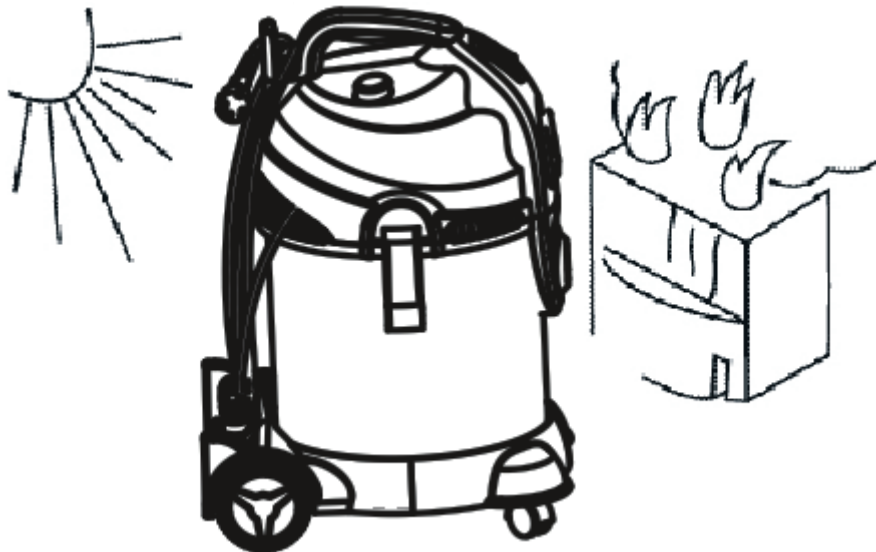

- 10) Do not flatten, trample or drag the hose as this may damage it.
- 11) Do not submerge the vacuum head in water or wash with water in case any water gets into the electrical parts and cause any injury. The correct way to clean is to wipe over with a damp cloth and allow to dry.

4. How To Operate

Connection

To connect the vacuum hose into the machine, insert the hose connector into the air inlet mouth as pictured below and make sure it is securely fastened.

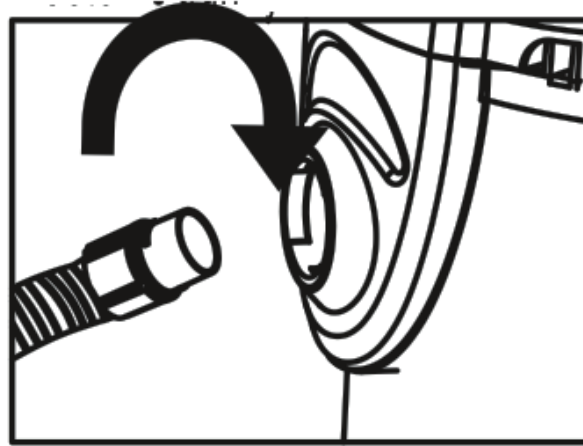

To remove the vacuum hose from the machine, press the release button on the vacuum hose connector and pull the connector out.

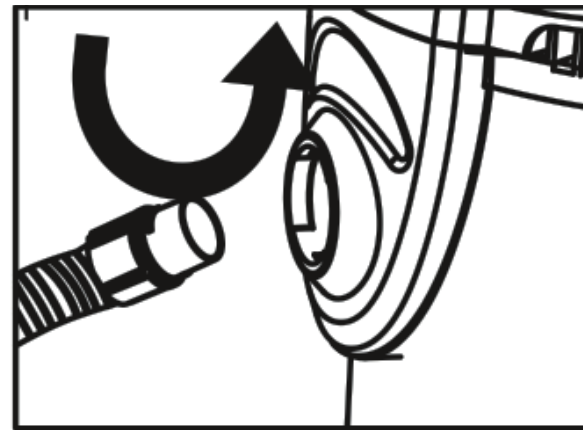

Connect all the accessories as pictured below.

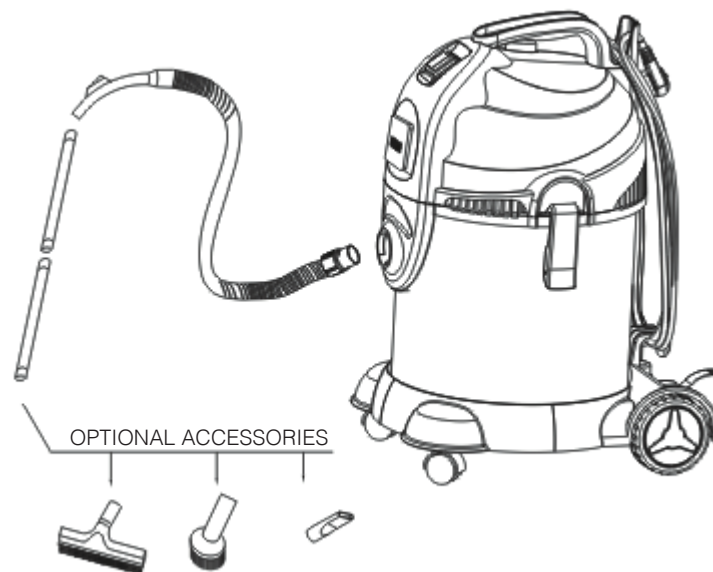

Filter Cleaning System

When the suction is feeling weak during use please close-over the connector by hand, then press the filter cleaning button 10 times. The filter will be cleaned ensuring the high volume of suction.

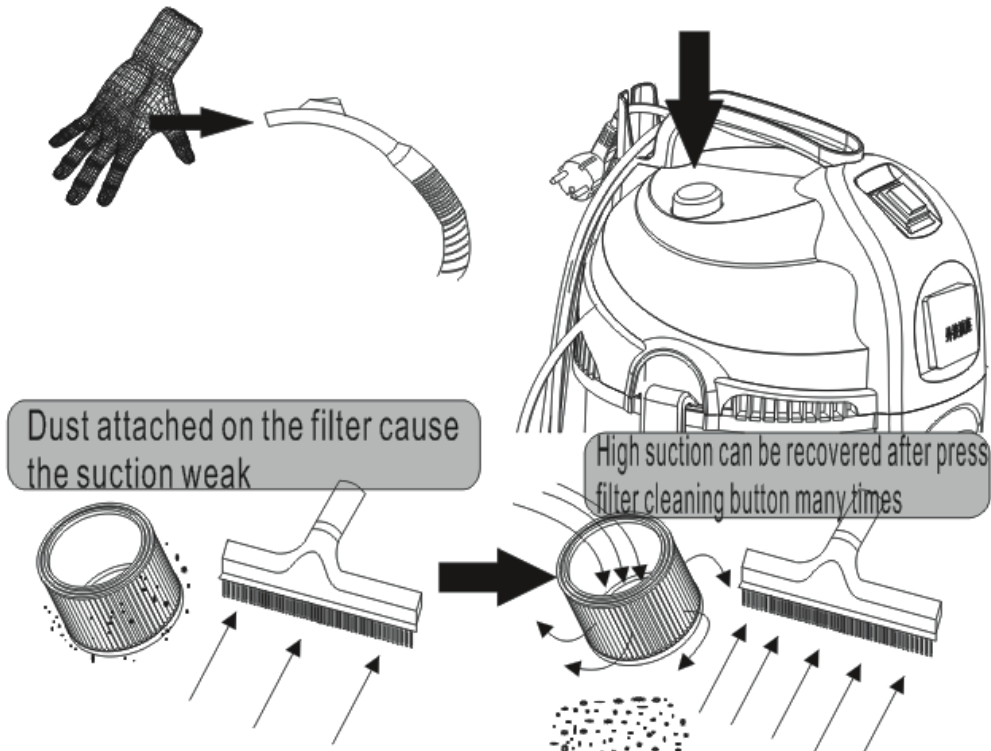

Adjust the airflow by pushing the sliding block up and down.

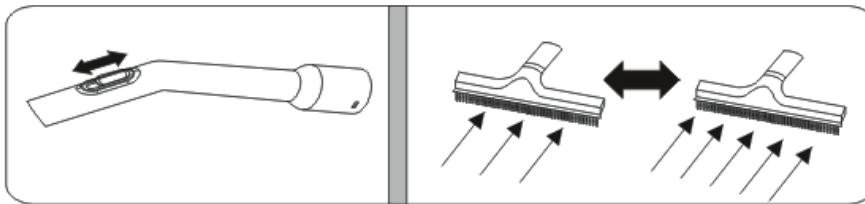

Power Take-off Function

When you want to use the power take-off function, lift the socket cover and insert the plug.

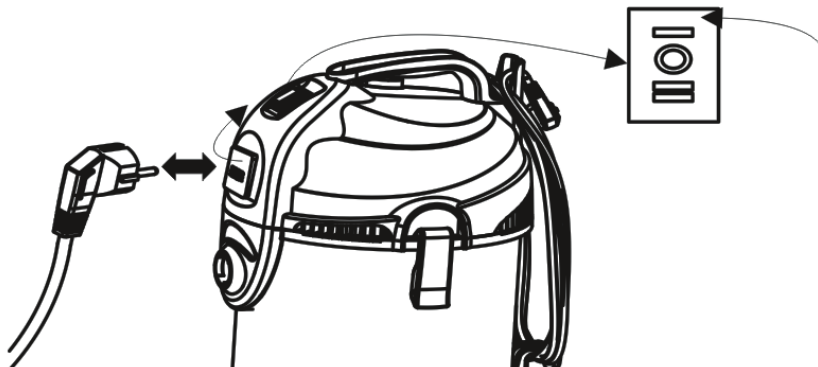

Press the switch and the machine will begin to work.

- 1) "I" stands for turn on, the socket is not powered.
- 2) "O" stands for turn off, the socket is not powered.
- 3) "II" stands for machine is switched off until the power take-off tool is operated for 5-8 seconds, then the cleaner begins to work. The cleaner stops working when the power tool is turned off 5-8 seconds later

Cable Hook Design & Accessories Holder

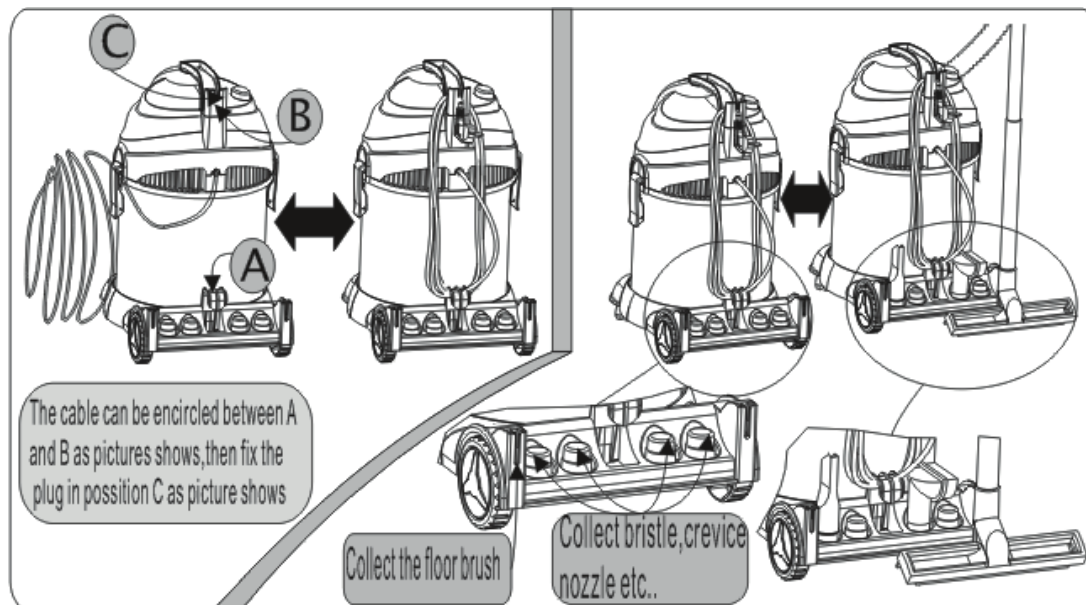

5. Maintenance

- 1) Clean the tank, filter and accessories, check for any damage or leaks in the vacuum hose. Every time after using the machine, please wash and dry filter if necessary. Never use the filter when it is wet.
- 2) Check the power cable and plug for any damage.
- 3) Check for any objects blocking the air inlet mouth after sucking up water, remove any blockages.
- 4) Use the machine gently, do not damage.
- 5) Keep the machine in a dry environment.
- 6) If the filter is covered in dust, wash with clean warm water.
- 7) Do not use the machine for more than 2 hours at a time or the lifetime will be affected.
- 8) Suction will be weak if the filter is dirty, in order to avoid low suction please wash and clean the filter frequently.
- 9) Stop using the machine if the motor noise changes or if you get a burning smell.

Cleaning the Tank

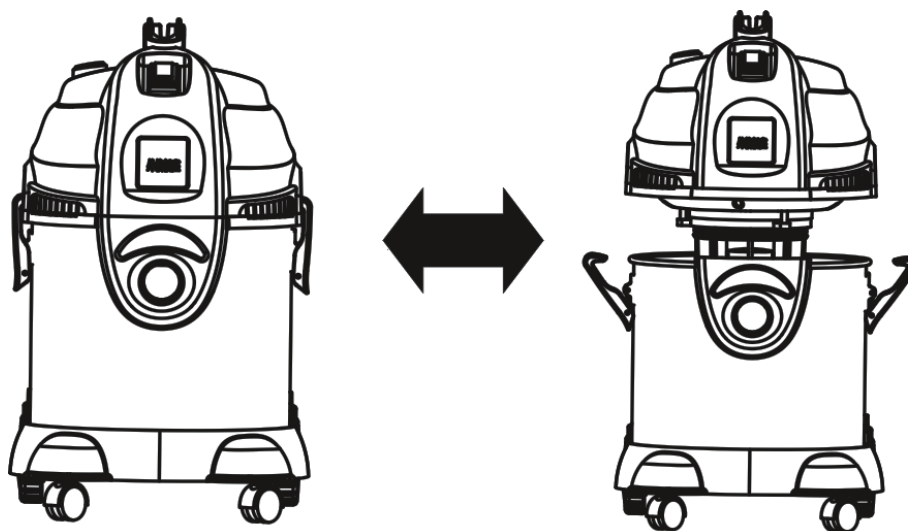

- 1) Unfasten the locking latches, lift up the vacuum head.
- 2) Take off the filter, clean any dust from the tank.
- 3) Reinstall the filter, replace the vacuum head and fasten the locking latches.

Filter Cleaning

If the filter is covered in dust it should be washed in clean warm water. Make sure the filter is dry before refitting.

6. Technical Data

Model	Power	Voltage	Frequency
KV30PT	1400W	220V - 240V	50 / 60Hz

7. Help

Call Kiam Power Products on 0151 548 5500 for any technical assistance or visit our website at www.kiamproducts.co.uk