



Kiam Sherwood KA500

Petrol Earth Auger

Instructions Manual

Read instructions manual before use!

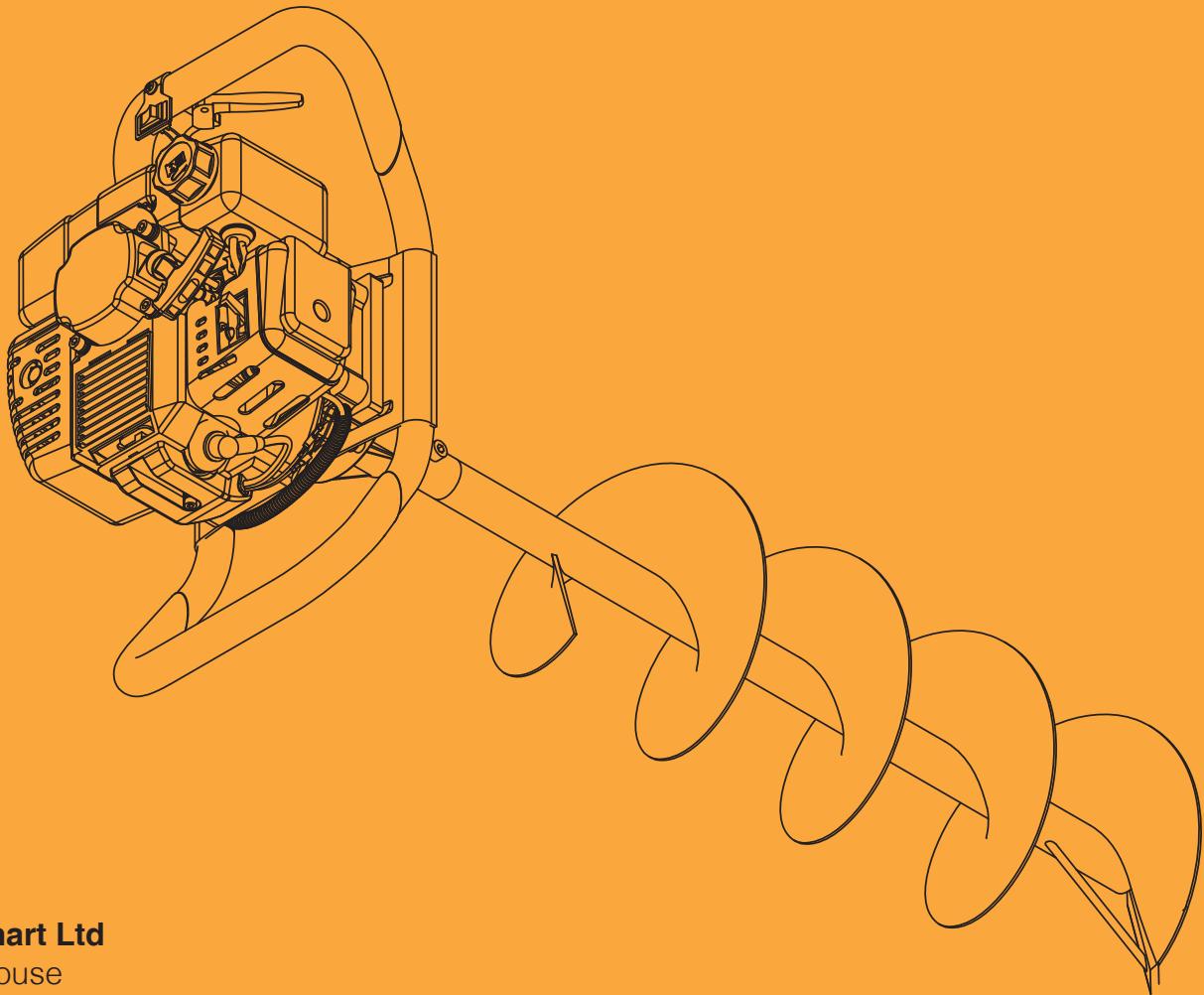

Equipmart Ltd

Kiam House
Birchill Road
Knowsley Ind. Park North
Merseyside
L33 7TD
United Kingdom



T: 0044 151 548 5500
F: 0044 151 548 5599

© Equipmart Ltd
www.kiamproducts.co.uk

Contents

1. Parts location	2
2. Specifications	2
3. Warning labels on the machine	3
4. Symbols on the machine	3
5. For safe operation	4
6. Setup	7
7. Fuel	8
8. Operation	9
9. Maintenance	10
10. Storage	11
11. Troubleshooting guide	12
12. Disposal	12
13. Spare parts	12
14. Warranty	13

SAFETY FIRST

Instructions will contain warnings within this manual, they will be marked with a  symbol concerning critical points which must be taken into consideration to prevent any possible serious bodily injury. You are requested to read all such instructions carefully and follow them without fail.

WARNINGS IN THE MANUAL

WARNING

This mark indicates instructions which must be followed in order to prevent accidents that could lead to serious bodily injury or death.

IMPORTANT

This mark indicates instructions which must be followed to prevent any mechanical failures, breakdowns and/or damage.

NOTE

This mark indicates hints or directions that are useful in the use of this machine.

1. Parts location

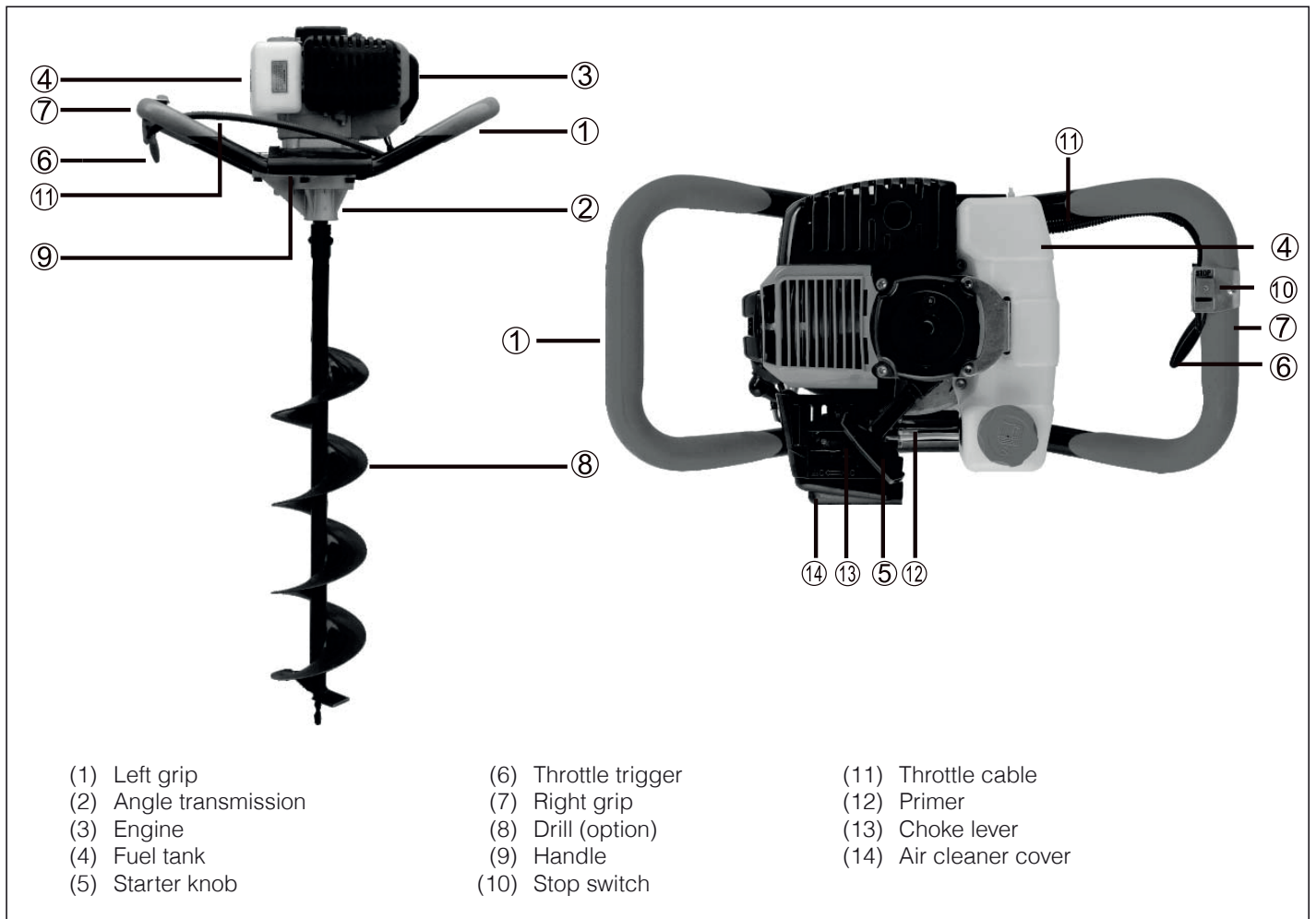

2. Specification

Model Name	KA500
Engine Displacement	52 cm ³
Maximum power	2.2 kW at 7500rpm
Carburetor	Diaphragm
Ignition system	CDI
Spark plug	LD BM6A
Starter	Recoil starter
Fuel	Mixture (Petrol 25: 2-Stroke Oil 1)
Fuel tank capacity	1.2 L
Transmission	Centrifugal clutch, worm gear reduction
Gear box lubricant	Gear oil SAE#80-90
Reduction ratio	40:1
Overall dimensions Length	660 mm
Width	374 mm
Height w/o drill	309 mm
Dry weight w/o drill	10.4 kg
Adaptable drill size Diameter	100 mm to 200 mm
Length	80 cm
Extension pole size Length	30 cm

Specifications are subject to change without notice.

3. Warning labels on the machine



(1) **Warning / Attention**

(2) **Read owner's manual before operating this machine.**

(3) **Wear head, eye and ear protection.**

 If warning label peels off or becomes soiled and impossible to read, you should contact the dealer from which you purchased the product to order new labels and affix them in the required location(s).

 **Never modify your machine. We won't warrant the machine if you use the remodeled hedge trimmer or if you don't observe the proper usage written in the manual.**

4. Symbols on the machine

For safe operation and maintenance, symbols are carved in relief on the machine. According to these indications, please be careful not to make a mistake.



The opening to refuel the "PETROL MIX"
Position: FUEL TANK CAP



The position to close the choke
Position: AIR FILTER COVER



The position to open the choke
Position: AIR FILTER COVER

▲ 5. For safe operation



1. THIS MACHINE CAN CAUSE SERIOUS INJURIES. Read this manual carefully until you completely understand and follow all safety and operating instructions. Also, know how to stop the machine quickly in an emergency.
2. Keep this manual handy so that you may refer to it later whenever any questions arise. Also note, if you have any questions which cannot be answered herein, contact the dealer from whom you purchased the product.
3. Always be sure to include this manual when selling, lending, or otherwise transferring the ownership of this product.
4. Never allow children or anyone unable to fully understand the directions given in the manual to use the machine.



WORKING CONDITION

1. When using the product, you should wear proper clothing and protective equipment.

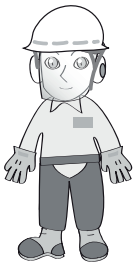

- (1) Helmet
- (2) Ear protectors
- (3) Protection goggles or face protector
- (4) Thick work gloves
- (5) Non-slip-sole work boots

2. And you should carry with you.
 - (1) Attached tools
 - (2) Properly reserved fuel
 - (3) Spare blade
 - (4) Things to notify your working area (rope, warning signs)
 - (5) Whistle (for collaboration or emergency)
 - (6) Hatchet or saw (for removal of obstacles)
 - (7) First-aid kit



3. Do not wear loose clothing, jewelry, short trousers, sandals, or go barefoot. Do not wear anything which might be caught by a moving part of the unit. Secure hair so it is above shoulder length.



WORKING CIRCUMSTANCE

1. Never start the engine inside a closed room or building. Exhaust

gases contain dangerous carbon monoxide.

2. Never use the product,
 - a. when the ground is slippery or when you can't maintain a steady posture.
 - b. At night, at times of heavy fog, or at any other times when your field of vision might be limited and it would be difficult to gain a clear view of the working area.
 - c. During rain, during storms at times of strong or gale-force winds, or at any other times when weather conditions might make it unsafe to use the product.



WORKING PLAN

1. You should never use the product when under the influence of alcohol, when suffering from exhaustion or lack of sleep, when suffering from drowsiness as a result of having taken cold medicine or at any other time when a possibility exists that your judgment might be impaired or that you might not be able to operate the product properly and in a safe manner.
2. When planning your work schedule, allow plenty of time to rest. Limit the amount of time over which the product is to be used continuously to somewhere around 30 ~ 40 minutes per session, and take 10 ~ 20 minutes of rest between work sessions. Also try to keep the total amount of work performed in a single day under 2 hours or less.



▲ WARNING

1. If you don't observe the working time, or working manner (See "USING THE PRODUCT"), Repetitive Stress Injury (RSI) could occur.

If you feel discomfort, redness and swelling of your fingers or any other part of your body, see a doctor before getting worse.

2. To avoid noise complaints, in general, operate product between 8 a.m. and 5 p.m. on weekdays and 9 a.m. to 5 p.m. on weekends.



⚠ 5. For safe operation

❗ IMPORTANT

Check and follow the local regulations as to sound level and hours of operations for the product.

BEFORE STARTING THE ENGINE

1. The area within a perimeter of 15m of the person using the machine should be considered a hazardous area in which no one should enter. If necessary, warning signs should be placed around the perimeter of the area. When work is to be performed simultaneously by two or more people, care should also be taken to regularly look around and check for the presence and locations of other people working to help maintain a safe distance between each person.
2. Check the condition of working area to avoid any accident by hitting hidden obstacles such as stumps, stones, cans, or broken glass.



❗ IMPORTANT

Remove any obstacle before beginning work.

3. Inspect the entire unit for loose fasteners and fuel leakage. Make sure that the cutting attachment is properly installed and securely fastened.

STARTING THE ENGINE

1. Keep bystanders, especially children, and animals at least 15 m away from the operating point. If you are approached, immediately stop the engine.
2. The product is equipped with a centrifugal clutch mechanism, so the cutting attachment begins to move as soon as the engine is started by putting the throttle into the start position. When starting the engine, place the product onto the ground in a flat clear area and hold it firmly in place so as to ensure that neither the cutting part nor the throttle come into contact with any obstacle when the engine starts.

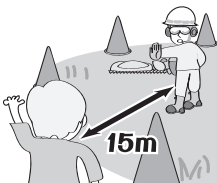

⚠ WARNING

- **Never place the throttle into the high-speed position when starting the engine.**

3. After starting the engine, check to make sure that the drill stops moving when the throttle is moved fully back to its original position. If it continues to move even after the throttle has been moved fully back, turn off the engine and contact your authorized Kiam dealer.

USING THE PRODUCT

❗ IMPORTANT

Drill only materials recommended by the manufacturer. And use only for tasks explained in the manual.

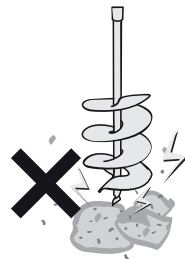

1. Grip the handles firmly with both hands using your whole hand. Place your feet slightly apart (slightly further apart than the width of your shoulders) so that your weight is distributed evenly across both legs, and always be sure to maintain a steady, even posture while working.
2. Maintain the speed of the engine at the level required to perform drilling work, and never raise the speed of the engine above the necessary level.
3. If the unit starts to shake or vibrate, turn off the engine and check the whole unit. Do not use it until the trouble has been properly corrected.
4. Keep all parts of your body away from moving drilling attachment and hot surfaces.
5. Never touch the exhaust, spark plug or other metallic parts of the engine while the engine is in use or immediately after turning the engine off. Doing so may cause burns or electrical shocks.
6. While operating the machine be always sure of a safe and secure operating position especially when using steps or a ladder.



▲ 5. For safe operation

• IF SOMEONE COMES

1. Guard against hazardous situations at all times. Warn adults to keep pets and children away from the area. Be careful if you are approached. Injury may result from flying debris.
2. If someone calls out or otherwise interrupts you while working, always be sure to turn off the engine before turning around.

MAINTENANCE

1. In order to maintain your product in proper working order, perform the maintenance and checking operations described in the manual at regular intervals.
2. Always be sure to turn off the engine before performing any maintenance or checking procedures.



▲ WARNING

The metallic parts reach high temperatures immediately after stopping the engine.



3. In the event that any part must be replaced or any maintenance or repair work not described in this manual must be performed, please contact your authorized Kiam dealer for assistance.
4. Do not use any accessory or attachment other than those bearing the Kiam mark and recommended for the unit.
5. Under no circumstances should you ever take apart the product or alter it in any way. Doing so might result in the product becoming damaged during operation or the product becoming unable to operate properly.



HANDLING FUEL

1. The engine of the product is designed to run on mixed fuel which contains highly flammable petrol. Never store cans of fuel or refill the tank of the unit in any place where there is a boiler, stove, wood fire, welding sparks, electrical sparks or any other source of heat or fire which might ignite the fuel.
2. Never smoke while operating the unit or refilling its fuel tank.
3. When refilling the tank, always turn off the engine and allow it to cool down. Take a careful look around to make sure that there are no sparks or open flames anywhere nearby before refueling.
4. Wipe spilled fuel completely using a dry rag if any fuel spillage occurs during refueling.
5. After refueling, screw the fuel cap back tightly onto the fuel tank and then carry the unit to a spot 3 m or more away from where it was refueled before turning on the engine.

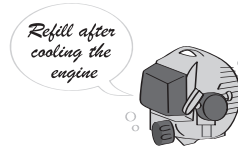

TRANSPORTATION

1. When hand-carrying the product, cover over the drill if necessary, lift up the product and carry it paying attention to the drill.
2. Never transport the product over rough roads over long distances by vehicle without removing all fuel from the fuel tank. If doing so, fuel might leak from the tank during transport.

6. Setup

A Package contains the items as illustrated.

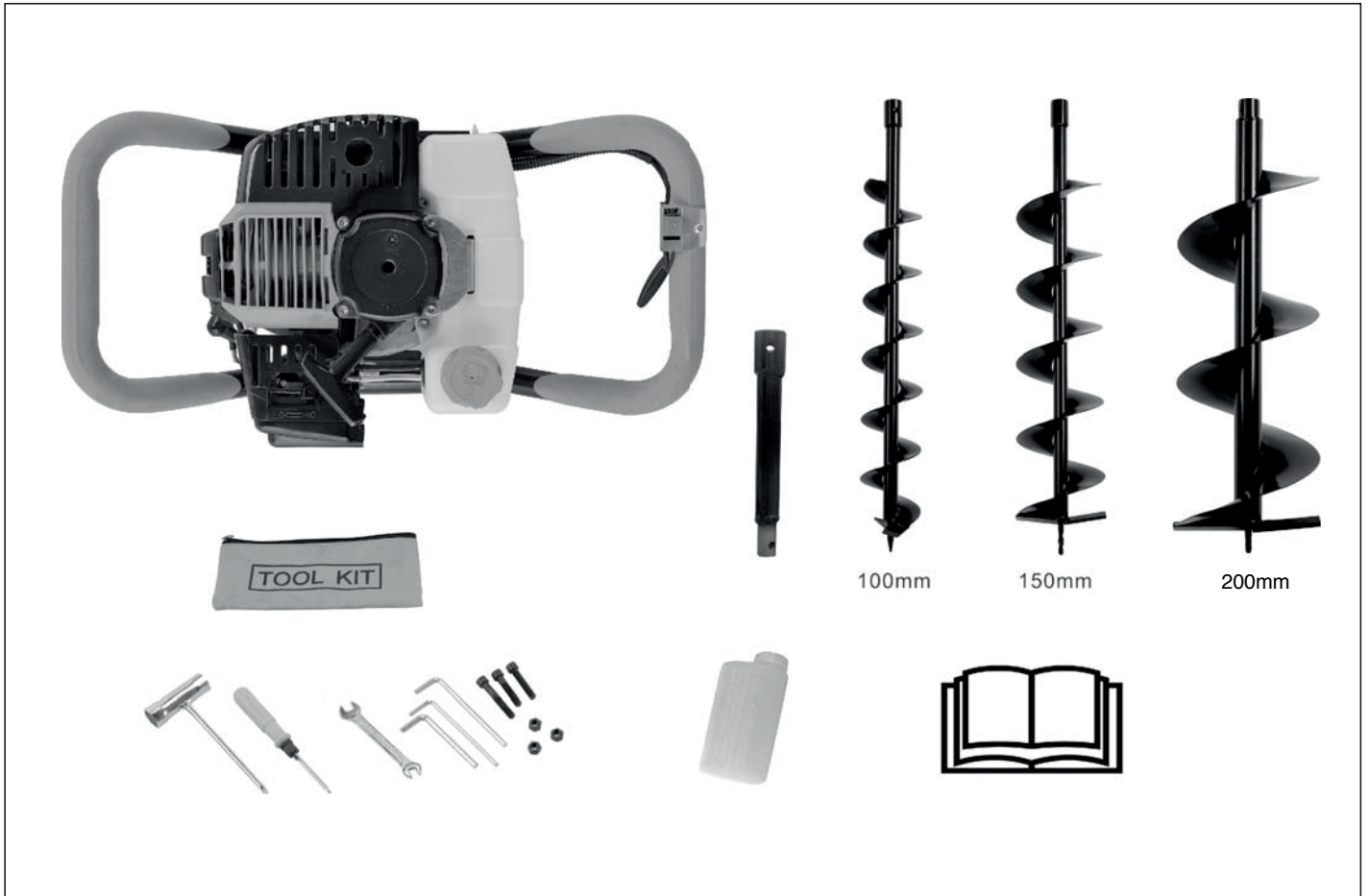

INSTALLING THE DRILL

1. Put the drill onto the auger output shaft.
2. Insert the screw into the hole on the head of drill and lock it with a nut.

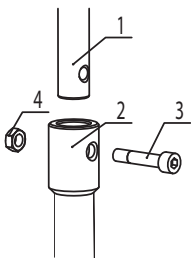

(1) PTO shaft
(2) Drill

(3) Screw
(4) Nut

6. Fuel

■ FUEL

⚠ WARNING

- **Petrol is very flammable. Avoid smoking or bringing any flame or sparks near fuel. Make sure to stop the engine and allow it cool before refueling the unit. Use outdoor grounds for refueling and move at least 3m (10 ft) away from the fueling point before starting the engine.**



- The engines are lubricated by oil specially formulated for air-cooled 2-stroke petrol engine use. If Kiam 2-stroke oil is not available, use a red semi-synthetic 2-stroke oil.
- Do not use BIA or TCW (2-stroke water-cooling type) mixed oil.



■ RECOMMENDED MIXING RATIO PETROL 25 : OIL 1

- **Exhaust emission are controlled by the fundamental engine parameters and components (eq., carburation, ignition timing and port timing) without addition of any major hardware or the introduction of an inert material during combustion.**
- These engines are certified to operate on unleaded petrol.
- If you use petrol of a lower octane value than described there is danger that the engine temperature may rise which may cause an engine pistone to seize.
- Unleaded petrol is recommended to reduce the contamination of the air for the sake of your health and the environment.
- Poor quality petrol or oils may damage sealing rings, fuel lines or fuel tank of the engine.

■ HOW TO MIX FUEL

⚠ WARNING

- Pay attention to agitation.
1. Measure out the quantities of petrol and oil to be mixed.
 2. Put some of the petrol into a clean, approved fuel container.
 3. Pour in all of the oil and mix thoroughly.

4. Pour in the rest of the petrol and mix thoroughly again. As some oils may be more difficult to mix depending on the oil ingredients, sufficient mixing is necessary to help improve the engines life. Be careful that if mixing is insufficient there is increased danger of early piston seizing due to lack of lubrication.
5. Indicate the contents inside the container by placing a clear indication on the outside of the container for easy identification and to avoid mixing up with petrol or any other containers.

■ FUELING THE UNIT

1. Untwist and remove the fuel cap. Rest the cap on a dustless place.
2. Put fuel into the fuel tank to 80% of the full capacity.
3. Fasten the fuel cap securely and wipe up any fuel spillage around the unit.

⚠ WARNING

1. Select clear flat ground for fueling.
2. Move at least 10 feet (3 meters) away from the fueling point before starting the engine.
3. Stop the engine before refueling the unit. At that time, be sure to sufficiently agitate the mixed gasoline in the container.

■ FOR YOUR ENGINE LIFE, AVOID:

1. **FUEL WITH NO OIL (PURE PETROL)** - It WILL cause severe damage to the internal engine parts immediately.
2. **GASOHOL** - It can cause deterioration of rubber and/or plastic parts and disrupt engine lubrication.
3. **OIL FOR 4-STROKE ENGINES** - It can cause spark plug fouling, exhaust blockages or piston ring sticking.
4. Mixed fuels which have been left unused for a period of one month or more may clog the carburetor and result in the engine failing to operate properly.
5. In the case of storing the product for a long period of time, clean the fuel tank after completely emptying it. Start the engine to empty the carburetor of any remaining fuel.
6. In the case of disposing of used mixing containers, only scrap it at authorized sites.

📖 NOTE

- As for details of quality assurance, read the description section Limited Warranty carefully. Normal wear and change in product with no fuctional influence are not covered by the warranty. Also, be careful that if the usage in the instruction manual is not followed (mixed petrol, etc.) as described, it may not be covered by the warranty.

8. Operation

STARTING ENGINE

⚠ WARNING

The drill will start moving when the engine starts.

1. Pour fuel into the fuel tank and tighten the cap securely.
2. Rest the unit on a flat, firm place. Keep the drill off the ground and clear of surrounding objects as it will start moving when starting of the engine.
3. Push the primer several times until overflow fuel flows out in the clear tube.

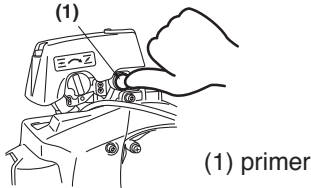

4. Move the choke lever to the closed position.

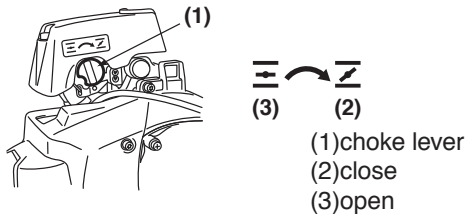

5. Set the stop switch to the "RUN" position. Place the unit on a flat, firm place.

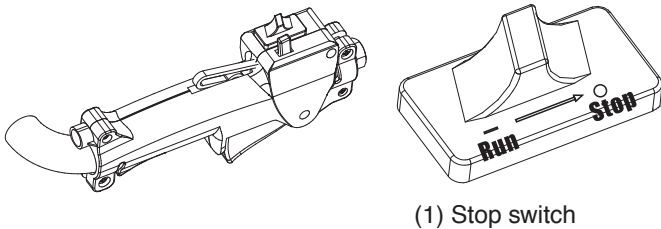

6. While holding the unit firmly, pull out the starter rope quickly until engine fires.

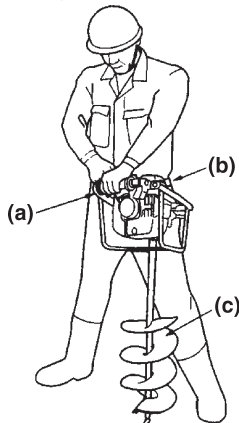

- (a) Hold the right grip with your left hand.
- (b) Support the left grip with your waist.
- (c) Do not press the drill on the ground.

⚠ IMPORTANT

Avoid pulling the rope to its end or returning it by releasing the knob. Such actions can cause starter failures.

7. Move the choke lever downward to open the choke. And restart the engine.
8. Allow the engine to warm up for a several minutes before starting operation.

📖 NOTE

1. When restarting the engine immediately after stopping it, leave the choke open.
2. Overchoking can make the engine hard to start due to excess fuel. When the engine failed to start after several attempts, open the choke and repeat pulling the rope, or remove the spark plug and dry it.

STOPPING ENGINE

1. Release the throttle lever and run the engine for a half minute.
2. Shift the stopswitch to the "Stop" position.

⚠ IMPORTANT

Except for an emergency, avoid stopping the engine while pulling the throttle lever.

ADJUSTING THROTTLE CABLE

The normal play is 1 or 2 mm when measured at the carburetor side end. Readjust with the cable adjuster as required and tighten the screw up.

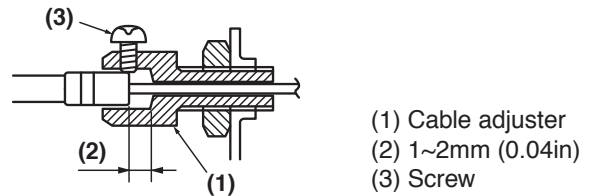

ADJUSTING IDLING SPEED

1. When the engine tends to stop frequently at idling mode, turn Idle speed adjuster clockwise.
2. When the cutting head keeps rotating after releasing the trigger, turn Idle speed adjuster counter-clockwise.

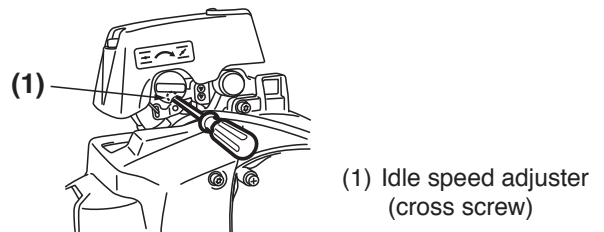

📖 NOTE

Warm up the engine before adjusting the idling speed.

8. Operation

DRILLING

- Keep a firm grip of the auger at all times on a wide stance and by holding the handle with both hands.
- A sudden jolt may occur on the auger when the drill has hit stones, tree roots or debris under the ground. Always hold the auger securely and firmly to keep the auger under control.
- Start drilling with half-throttle and gradually increase the engines speed to ensure smooth drilling into the ground.
- If the drill is caught in the ground and cannot be pulled out, stop the engine and rotate the auger counter-clockwise.

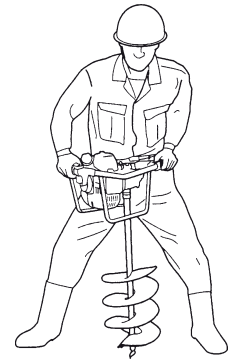

9. Maintenance

MAINTENANCE CHART

	System/components	Procedure	Before use	Every 25 hours after	Every 50 hours after	Every 100 hours after	Note
ENGINE	fuel leaks, fuel spillage	wipe out	✓				
	fuel tank, air filter, fuel filter	inspect/clean	✓	✓			replace, if necessary
	idle adjusting screw	see adjusting idling speed	✓				replace carburetor if necessary
	spark plug	clean and readjust plug gap			✓		GAP: .026 in (0.65 mm) replace, if necessary
	intake air cooling vent	clean		✓			
MAIN UNIT	throttle lever, ignition switch	check operation	✓				
	drill	replace if something's wrong	✓				
	gear box	oil			✓		
	screws/nuts/bolts	tighten/replace	✓			✓	not adjusting screws

- **Before cleaning, inspecting or repairing the unit, make sure that the engine has stopped and is cool.**
- **Use protective gloves whenever inspecting, removing and installing the drill.**

⚠ WARNING

- **Make sure that the engine has stopped and is cool before performing any service to the machine. Contact with hot exhaust may cause injury.**
- **Do not modify the drill or dismantle the engine.**
- **When replacing parts use Kiam original parts.**

AIR FILTER

- If air filter blocked, will reduce engine performance.
- Check filter element (1). Clean in warm soapy water when required. Dry completely before installing. If filter is damaged or shrunk, replace with new one.

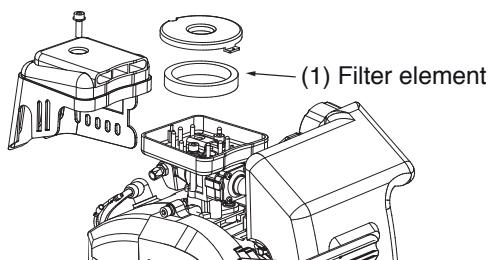

🔧 IMPORTANT

- If the air filter is blocked, the efficiency of the engine will be reduced. In addition, internal engine components will suffer abnormal wear if operated with the filter or if continually operated with damaged filter.

FUEL FILTER

After every 25 hours of operation, empty the fuel tank, detach the fuel filter from the tank, and remove all dirt. If the filter is too clogged, replace with a new one.

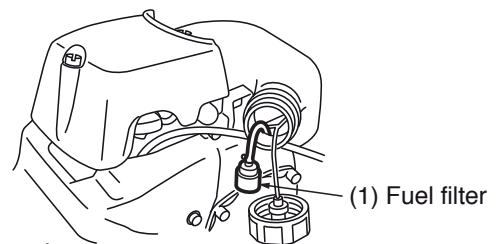

9. Maintenance

⚠ IMPORTANT

- If the fuel filter is clogged, the engine speed may be limited or speed fluctuations may occur.
- If the engine is operated without a fuel filter, dirt will accumulate in the carburetor and cause it to malfunction.

SPARK PLUG

⚠ WARNING

- Do not touch the spark plug with your bare hands immediately after operation, as there is the risk of burns due to high temperature.



- After every 50 hours of operation, detach the spark plug and remove dirt from the electrodes with a wire brush or similar.
- The correct electrode gap is 0.6 to 0.7mm.

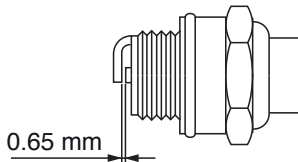

⚠ IMPORTANT

- If too much fuel is absorbed or poor quality oil is used, the spark plug electrodes become dirty, making the engine harder to start.
- Note that using incorrect spark plugs may result in engine failing to operate correctly or engine overheating causing damage to the engine.
- To install the spark plug, first turn the plug until it is finger tight, then tighten a quarter turn with socket wrench.

10. Storage

1. Drain the fuel tank and push the primer bulb until it is empty of fuel.
2. Remove the spark plug and pour a spoonful of 2-stroke oil into the cylinder. Crank the engine several times and replace the plug.
3. Brush off dirt from the drill surface and apply rust protective oil.
4. Store the machine in a dry, dust-free place.

EXHAUST

⚠ WARNING

- **Inspect the exhaust regularly for loose fasteners, damage or corrosion. If any sign of exhaust leakage is found, stop using the machine and have it repaired immediately. Note that failing to do so may result in the engine catching on fire.**

INTAKE AIR COOLING VENT

⚠ WARNING

- **Check the intake air cooling vent after every 25 hours of use for blockage, and remove any waste which has attached itself to the machine.**

⚠ IMPORTANT

- If waste gets stuck and causes blockage around the intake air cooling vent, it may cause the engine to overheat, and that in turn may cause mechanical failure on the part of the machine.

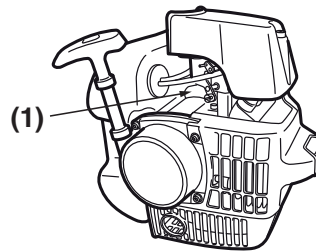

(1) Intake air cooling vent

■ PERIODICAL SERVICE POINTS

Periodically check and clean the cylinder fins
Make sure drill bit is sharp, if it is worn the drill may not work smoothly.

11. Troubleshooting Guide

Case 1. Starting failure

CHECK	PROBABLE CAUSES	ACTION
fuel tank	→ incorrect fuel	→ drain it and use correct fuel
fuel filter	→ fuel filter is clogged	→ clean
carburetor adjustment screw	→ out of normal range	→ adjust to normal range
sparkign (no spark)	→ spark plug is fouled/wet	→ clean/dry
	→ plug gap is incorrect	→ correct (GAP: 0.65 mm)
spark plug	→ disconnected	→ retighten

Case 2. Engine starts but does not keep running/hard re-starting

CHECK	PROBABLE CAUSES	ACTION
fuel tank	→ incorrect fuel or staled fuel	→ drain it and use correct fuel
carburetor adjustment screw	→ out of normal range	→ adjust to normal range
muffler, cylinder (exhaust port)	→ carbon is built-up	→ consult with the repair specialty store
air cleaner	→ clogged with dust	→ air blow or wash
cylinder fin, fan cover	→ clogged with dust	→ consult with the repair specialty store

12. Disposal

- When you dispose of the machine, do not disassemble the machine.
- When you dispose of the machine, fuel, and/or oil be sure to follow your local regulations.

13. Spare parts

Visit www.kiamproducts.co.uk 2-stroke oil, protective safety equipment, spare parts and accessories.



14. Warranty



We warrant this product against any manufacturing defects in the material and workmanship for a period of 12 months from the date of purchase. This warranty is only for domestic / home use.

This warranty does not cover any defects and/or damages caused by the following:

- Misuse of the product
- Negligence or lack of maintenance
- Normal wear and tear on parts
- Use of non original manufacturer parts
- Modification or removal of parts

The purchaser is responsible for all related expenses (parts, labour and return costs) if the product is not covered under warranty.

Original receipt must be included when returning to:

Kiam Power Products
Kiam House
Birchill Road
Knowsley Ind. Park North
Merseyside
L33 7TD
United Kingdom

Return Sheet

Name: _____

Address: _____

Purchased from: _____

Invoice number: _____

Date of purchase: _____

Model: _____

Note: Please remember to attach a copy of your receipt