

STEP 1

NEW INSTALLATION

Go to Step 2

RETROFIT INSTRUCTIONS

Remove existing bolts and spread plates (See Figure A)

REPAIR INSTRUCTIONS

Remove damaged bolts by securing the bolt with a pair of vice grips and backing the nut off the bolt. (See Figure B)

STEP 2

Install the bolts with approved nuts and washers to the lower base plates. Tighten the nuts (See Figure C)

NOTE: DO NOT HOLD THE TOP OF THE BOLT WHILE TIGHTENING THE BOTTOM NUT. HOLD BELOW THE BREAKPOINT, OR CRACKING COULD OCCUR

STEP 3

Lower the sign structure plate onto the top portion of the bolts and install upper washer and nuts. (See Figure D)

If the keeper plate is damaged, it is not necessary to replace it. The bolts should be wrenched tightened to prevent the nuts from working loose. There are no torque requirements.

FAX: (413) 383-0681
Cell: (505) 486-0476

(All bolts must be in place before final tightening)

SPECIAL NOTES:

- Approved nuts and washers are required
- Be sure to tighten nuts evenly in a diagonal pattern, on sides of the flange so that the two plates remain horizontal to each other.
- In the case of any discrepancies or defects, the engineer and manufacturer must be notified immediately
- Both plates must be clean and flat to prevent stretching of the bolt from the uneven section causing cracking

INFORMATION

DENT BREAKAWAY IND, INC.
CLIFFORD DENT, INVENTOR
PO BOX 6007
FARMINGTON, NM 87499

FAX: (413) 383-0681
Cell: (505) 486-0476

FIGURE 1

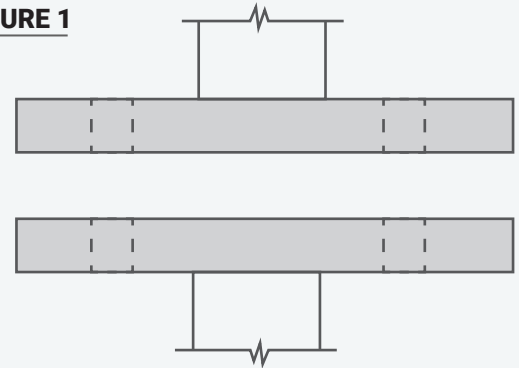

FIGURE 2

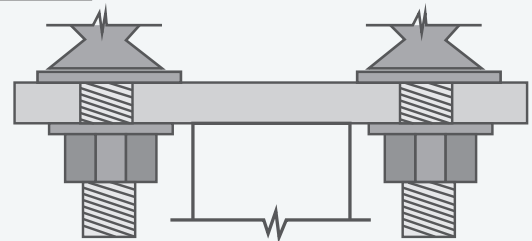

FIGURE 3

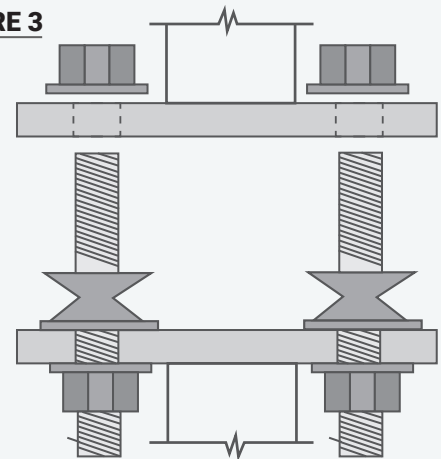

FIGURE 4

