

(FOR SER-II. STD. RANGE)

SHELL SIZE	'T1' THD.	'T2' THD. UNEF-2B	∅ D MAX.	L MAX.
08	M12 X 1.5P	1/2-20UNF	17.20	25.0
10		5/8-24	20.30	
12	M16 X 1.5P	3/4-20	24.10	
14		7/8-20	27.30	
16	M20 X 1.5P	1"-20	30.60	
18		1 1/16 -18	32.00	
20	M25 X 1.5P	1 3/16 -18	34.70	40.0
22		1 5/16 -18	38.50	
24	M32 X 1.5P	1 7/16 -18	42.00	

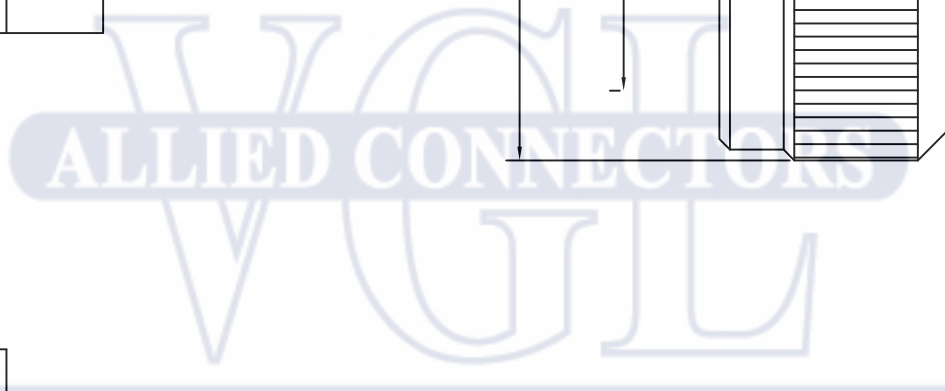
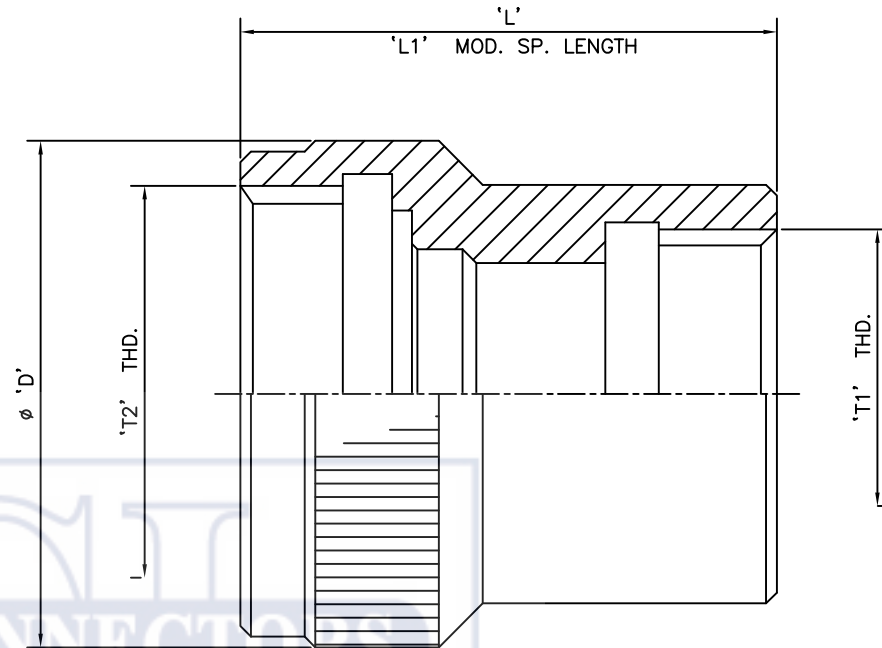

(FOR SER-II. NON STD. RANGE)

SHELL SIZE	'T1' THD.	'T2' THD. UNEF-2B	L1
08	M12 X 1.5P	1/2-20UNF	45.0
10	M16 X 1.5P	5/8-24	
12	M16 X 1.5P	3/4-20	
	M20 X 1.5P	3/4-20	
14	M16 X 1.5P	7/8-20	
	M20 X 1.5P	7/8-20	
16	M20 X 1.5P	1"-20	

ORDERING INFORMATION

IMB1-XX MXX-LOO-ZZZ

SERIES

SHELL SIZE (08/24)

METRIC THREAD (T1)

MODIFIED SPECIAL LENGTH.
(Example- L45)

FINISH.

- Omit for cadmium plate finish.
- 416- Electroless nickel.
- 622- Cad. free zinc cobalt-olive green.
- 624- Cad. free zinc cobalt-black.
- 626- Zinc nickel black.

1	27/03/21
Issue No.	Rev. Date.

(ALL DIM'S ARE IN MM)

SER-II. METRIC ADAPTOR. (08 TO 24 SIZE)

Scale	Dwg. No.	Drawn by.	Date
2:1	C-80110/13	Kulkarni	27/03/21

Amphenol
Amphenol Interconnect India Pvt. Ltd.
PUNE-411026