

Series A
3 P +

10 A / 230/400 V

UL/CSA: 600 V



Description

Part no.

Screw terminal inserts

Female insert

Screw terminal

 without wire protection
 0,5-1,5 mm² (20-16 AWG)

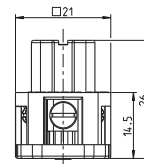



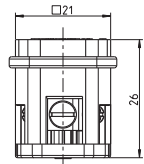

700 103
ex stock

 10
 14



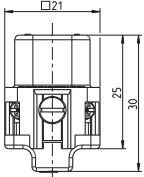
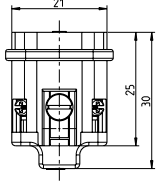

Male insert

Screw terminal

 without wire protection
 0,5-1,5 mm² (20-16 AWG)

700 203
ex stock

 10
 14

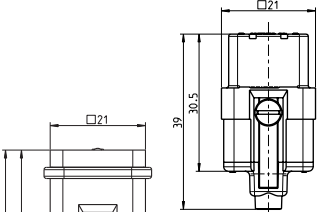
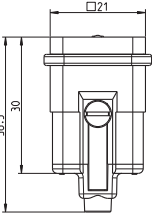
Description	Part no.		Series A 4 P +  10 A / 230/400 V UL/CSA: 600 V	 
Screw terminal inserts			   	10 17
Female insert Screw terminal without wire protection 0,5-1,5 mm ² (20-16 AWG)	700 104			10 18
Male insert Screw terminal without wire protection 0,5-1,5 mm ² (20-16 AWG)	700 204			

Description	Part no.		Series A	5 P +  16 A / 400 V UL/CSA: 600 V	 	
Crimp contact carriers						
Contact carrier for sleeve contacts	700 105	<div data-bbox="1166 629 1467 830" style="background-color: red; color: white; padding: 5px; border-radius: 10px; display: inline-block;">Please order crimp contacts separately</div>	  		10 18	
Contact carrier for pin contacts	700 205			10 14		