



## M8 / M12 SENSOR LEADS & CONNECTORS



## Technical Characteristics

|                                      |                                  |
|--------------------------------------|----------------------------------|
| <b>Insulating Body</b>               | TPU GF, HB according to UL94     |
| <b>Contact</b>                       | CuZn, pre-nickel and gold plated |
| <b>Body</b>                          | TPU                              |
| <b>Coupling nut / Knurling screw</b> | CuZn, nickel plated              |
| <b>Seal</b>                          | FKM                              |
| <b>Mating cycles</b>                 | ≥ 100                            |
| <b>Temperature range</b>             | -25°C to +80°C                   |

## Lead - Female



| # of poles | Part Number    | Current | Voltage       | Cable end 2 | L       | IP Rating | Layout  | Sheath |
|------------|----------------|---------|---------------|-------------|---------|-----------|---------|--------|
| 3          | 0800.03.300_5m | 4A      | 50V AC/60V DC | Blunt cut   | 5.0 Mtr | IP67      | A-coded | PUR    |
| 4          | 0800.04.301_2m | 4A      | 50V AC/60V DC | Blunt cut   | 2.0 Mtr | IP67      | A-coded | PUR    |
| 4          | 0800.04.301_5m | 4A      | 50V AC/60V DC | Blunt cut   | 5.0 Mtr | IP67      | A-coded | PUR    |

## Lead - Male



| # of poles | Part Number    | Current | Voltage       | Cable end 2 | L       | IP Rating | Layout  | Sheath |
|------------|----------------|---------|---------------|-------------|---------|-----------|---------|--------|
| 3          | 0810.03.300_5m | 4A      | 50V AC/60V DC | Blunt cut   | 5.0 Mtr | IP67      | A-coded | PUR    |
| 4          | 0810.04.301_2m | 4A      | 50V AC/60V DC | Blunt cut   | 2.0 Mtr | IP67      | A-coded | PUR    |

## Cordset- Male / Female

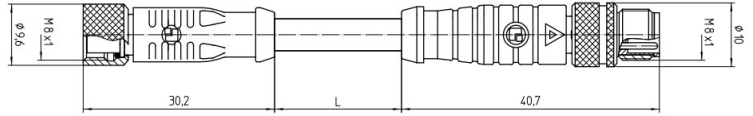
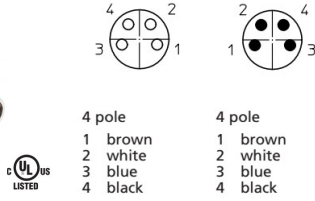

| # of poles | Part Number           | Current | Voltage       | Cable end 1 | Cable end 2 | L       | IP Rating | Layout  | Sheath |
|------------|-----------------------|---------|---------------|-------------|-------------|---------|-----------|---------|--------|
| 4          | 0810.0800.04.301_1.5m | 4A      | 50V AC/60V DC | Male        | Female      | 1.5 Mtr | IP67      | A-coded | PUR    |
| 4          | 0810.0800.04.301_2m   | 4A      | 50V AC/60V DC | Male        | Female      | 2.0 Mtr | IP67      | A-coded | PUR    |

## Cordset- Male / Female (90 Deg)

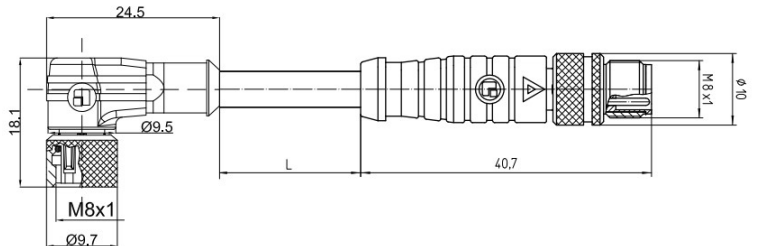
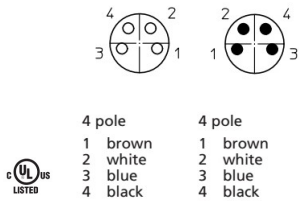

| # of poles | Part Number           | Current | Voltage       | Cable end 1 | Cable end 2    | L       | IP Rating | Layout  | Sheath |
|------------|-----------------------|---------|---------------|-------------|----------------|---------|-----------|---------|--------|
| 4          | 0810.0805.04.301_1.5m | 4A      | 50V AC/60V DC | Male        | Female, 90 deg | 1.5 Mtr | IP67      | A-coded | PUR    |
| 4          | 0810.0805.04.301_2m   | 4A      | 50V AC/60V DC | Male        | Female, 90 deg | 2.0 Mtr | IP67      | A-coded | PUR    |

## Accessories - caps



| Part Number | Suit   |
|-------------|--------|
| 9908.CPM0   | Male   |
| 9908.CPF0   | Female |

## Technical Characteristics

|                                      |                                  |
|--------------------------------------|----------------------------------|
| <b>Insulating Body</b>               | TPU GF, HB according to UL94     |
| <b>Contact</b>                       | CuZn, pre-nickel and gold plated |
| <b>Body</b>                          | TPU                              |
| <b>Coupling nut / Knurling screw</b> | CuZn, nickel plated              |
| <b>Seal</b>                          | FKM                              |
| <b>Mating cycles</b>                 | ≥ 100                            |
| <b>Temperature range</b>             | -25°C to +80°C                   |

## Lead - Female

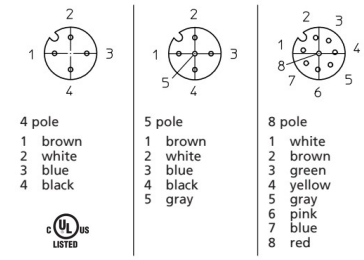

| # of poles | Part Number     | Style    | Current | Voltage    | Cable end 2 | L        | IP Rating | Layout  | Sheath |
|------------|-----------------|----------|---------|------------|-------------|----------|-----------|---------|--------|
| 4          | 1200.04.002_2m  | Straight | 4A      | 250V AC/DC | Blunt cut   | 2.0 Mtr  | IP67      | A-coded | PVC    |
| 4          | 1200.04.002_5m  | Straight | 4A      | 250V AC/DC | Blunt cut   | 5.0 Mtr  | IP67      | A-coded | PVC    |
| 4          | 1200.04.301_5m  | Straight | 4A      | 250V AC/DC | Blunt cut   | 5.0 Mtr  | IP67      | A-coded | PUR    |
| 4          | 1200.04.002_10m | Straight | 4A      | 250V AC/DC | Blunt cut   | 10.0 Mtr | IP67      | A-coded | PVC    |
| 4          | 1205.04.002_5m  | 90 deg   | 4A      | 250V AC/DC | Blunt cut   | 5.0 Mtr  | IP67      | A-coded | PVC    |
| 5          | 1205.05.302_2m  | 90 deg   | 4A      | 60V AC/DC  | Blunt cut   | 2.0 Mtr  | IP67      | A-coded | PUR    |
| 5          | 1205.05.302_5m  | 90 deg   | 4A      | 60V AC/DC  | Blunt cut   | 5.0 Mtr  | IP67      | A-coded | PUR    |
| 8          | 1205.08.303_2m  | 90 deg   | 2A      | 30V AC/DC  | Blunt cut   | 2.0 Mtr  | IP67      | A-coded | PUR    |
| 8          | 1205.08.303_5m  | 90 deg   | 2A      | 30V AC/C   | Blunt cut   | 5.0 Mtr  | IP67      | A-coded | PUR    |

## Lead - Male

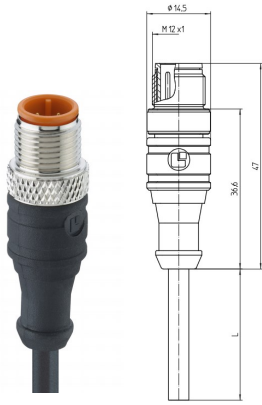
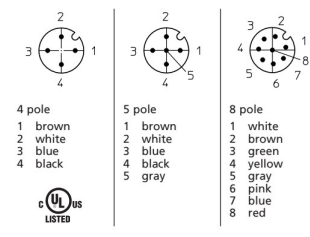

| # of poles | Part Number     | Style    | Current | Voltage    | Cable end 2 | L        | IP Rating | Layout  | Sheath |
|------------|-----------------|----------|---------|------------|-------------|----------|-----------|---------|--------|
| 4          | 1210.04.002_5m  | Straight | 4A      | 250V AC/DC | Blunt cut   | 5.0 Mtr  | IP67      | A-coded | PVC    |
| 4          | 1210.04.301_5m  | Straight | 4A      | 250V AC/DC | Blunt cut   | 5.0 Mtr  | IP67      | A-coded | PUR    |
| 4          | 1210.04.002_10m | Straight | 4A      | 250V AC/DC | Blunt cut   | 10.0 Mtr | IP67      | A-coded | PVC    |
| 5          | 1210.05.302_2m  | Straight | 4A      | 250V AC/DC | Blunt cut   | 2.0 Mtr  | IP67      | A-coded | PUR    |
| 5          | 1210.05.302_5m  | Straight | 4A      | 250V AC/DC | Blunt cut   | 5.0 Mtr  | IP67      | A-coded | PUR    |

## Cordset- Male / Female

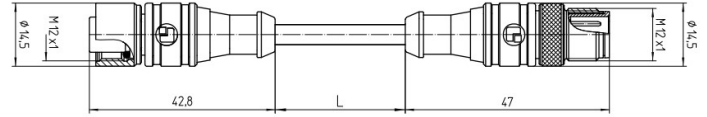
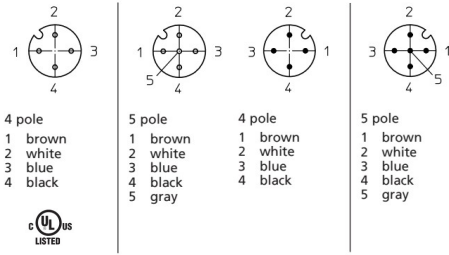

| # of poles | Part Number           | Current | Voltage    | Cable end 1 | Cable end 2 | L       | IP Rating | Layout  | Sheath |
|------------|-----------------------|---------|------------|-------------|-------------|---------|-----------|---------|--------|
| 4          | 1210.1200.04.002_0.6m | 4A      | 250V AC/DC | Male        | Female      | 0.6 Mtr | IP67      | A-coded | PVC    |
| 4          | 1210.1200.04.301_1.5m | 4A      | 250V AC/DC | Male        | Female      | 1.5 Mtr | IP67      | A-coded | PUR    |
| 4          | 1210.1200.04.301_2m   | 4A      | 250V AC/DC | Male        | Female      | 2.0 Mtr | IP67      | A-coded | PUR    |
| 5          | 1210.1200.05.003_0.6m | 4A      | 250V AC/DC | Male        | Female      | 0.6 Mtr | IP67      | A-coded | PVC    |
| 5          | 1210.1200.05.302_1.5m | 4A      | 250V AC/DC | Male        | Female      | 1.5 Mtr | IP67      | A-coded | PUR    |
| 5          | 1210.1200.05.302_5m   | 4A      | 250V AC/DC | Male        | Female      | 5.0 Mtr | IP67      | A-coded | PUR    |

## Cordset- Male / Female (90 Deg)

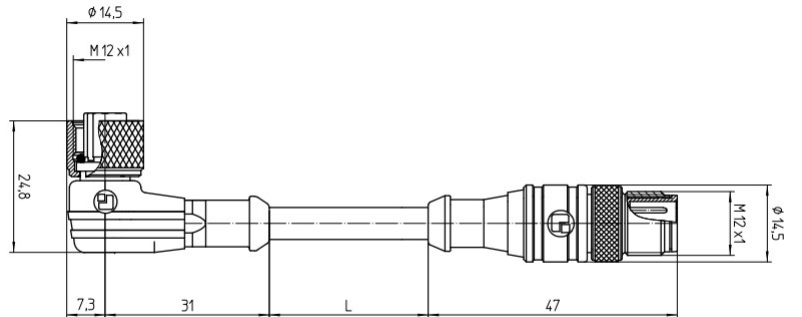
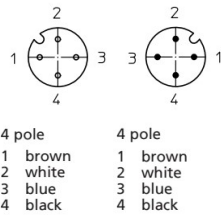

| # of poles | Part Number         | Current | Voltage | Cable end 1 | Cable end 2    | L       | IP Rating | Layout  | Sheath |
|------------|---------------------|---------|---------|-------------|----------------|---------|-----------|---------|--------|
| 4          | 1210.1205.04.301_2m | 4A      | 250V AC | Male        | Female, 90 deg | 2.0 Mtr | IP67      | A-coded | PUR    |

## Accessories - caps



Part Number      Suit

9912.CPM0      Male



9912.CPF0      Female

|                        |                                  |
|------------------------|----------------------------------|
| <b>Insulating Body</b> | PA GF, V-0 according to UL94     |
| <b>Contact</b>         | CuZn, pre-nickel and gold plated |
| <b>Housing</b>         | PBT, V-0 according to UL94       |
| <b>Knurled nut</b>     | CuZn, nickel plated              |

|                          |                |
|--------------------------|----------------|
| <b>O-Ring gasket</b>     | FKM            |
| <b>Hose Gasket</b>       | CR/NBR         |
| <b>Temperature Range</b> | +12°C to +90°C |

### Connector - Female

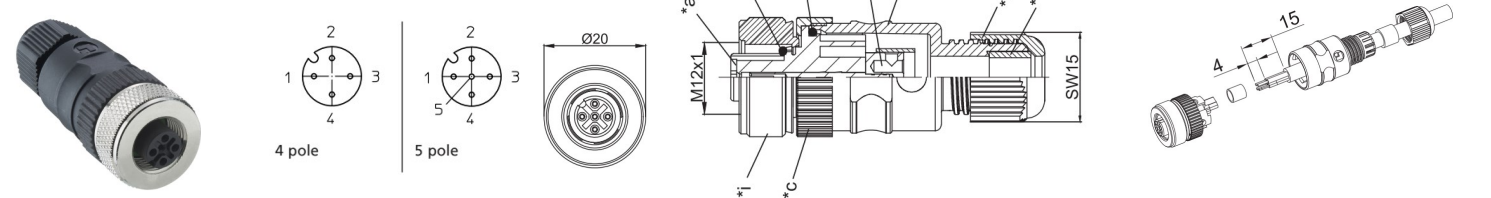

| # of poles | Part Number  | Style    | Current | Voltage       | Cable Range | IP Rating | Layout  |
|------------|--------------|----------|---------|---------------|-------------|-----------|---------|
| 4          | 1240.04.T9CR | Straight | 4A      | 150V AC/DC    | 4.0-8.0mm   | IP67      | A-coded |
| 5          | 1240.05.T9CR | Straight | 4A      | 30V AC/36V DC | 4.0-8.0mm   | IP67      | A-coded |

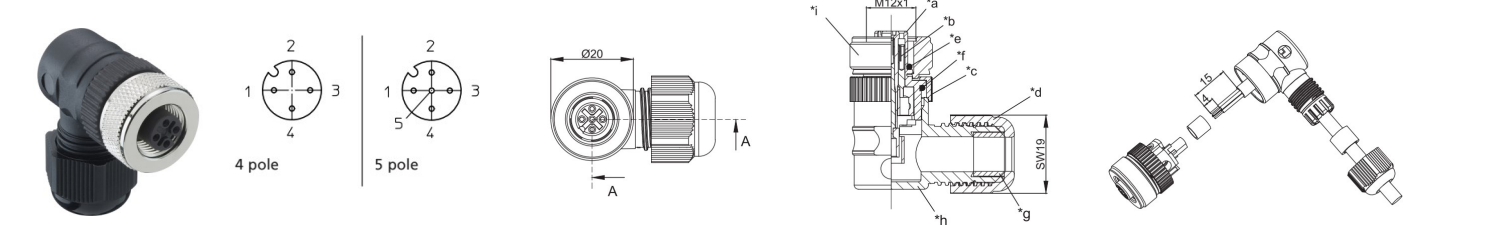

| # of poles | Part Number  | Style  | Current | Voltage       | Cable Range | IP Rating | Layout  |
|------------|--------------|--------|---------|---------------|-------------|-----------|---------|
| 4          | 1245.04.T9CR | 90 deg | 4A      | 150V AC/DC    | 4.0-8.0mm   | IP67      | A-coded |
| 5          | 1245.05.T9CR | 90 deg | 4A      | 30V AC/36V DC | 4.0-8.0mm   | IP67      | A-coded |

### Connector - Male

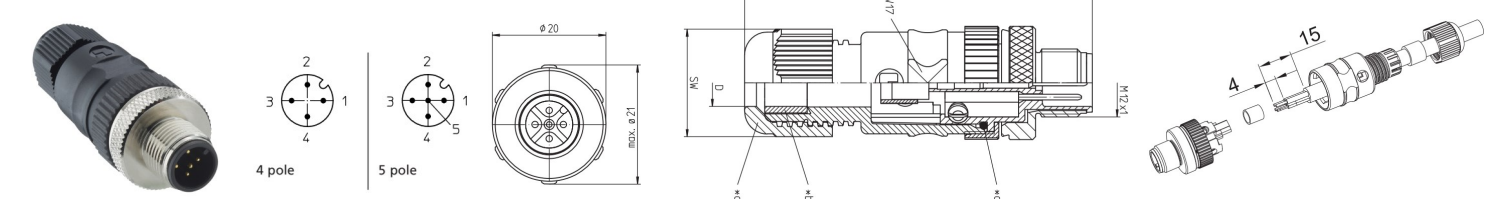

| # of poles | Part Number  | Style    | Current | Voltage       | Cable Range | IP Rating | Layout  |
|------------|--------------|----------|---------|---------------|-------------|-----------|---------|
| 4          | 1250.04.T9CR | Straight | 4A      | 150V AC/DC    | 4.0-8.0mm   | IP67      | A-coded |
| 5          | 1250.05.T9CR | Straight | 4A      | 30V AC/36V DC | 4.0-8.0mm   | IP67      | A-coded |

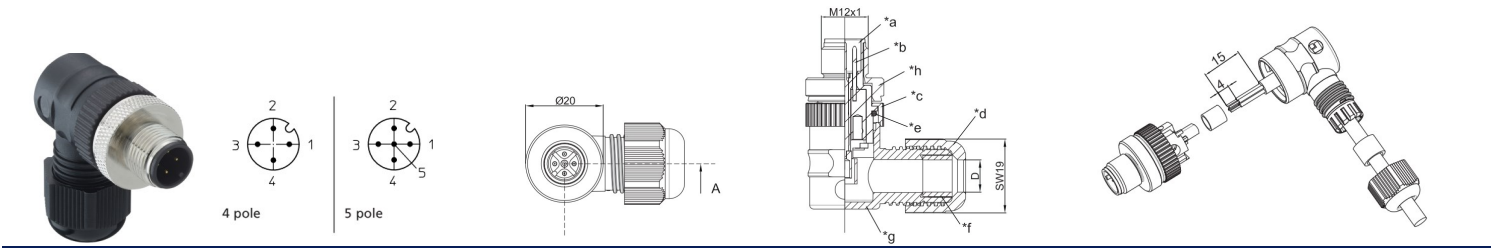

| # of poles | Part Number  | Style  | Current | Voltage       | Cable Range | IP Rating | Layout  |
|------------|--------------|--------|---------|---------------|-------------|-----------|---------|
| 4          | 1255.04.T9CR | 90 deg | 4A      | 150V AC/DC    | 4.0-8.0mm   | IP67      | A-coded |
| 5          | 1255.05.T9CR | 90 deg | 4A      | 30V AC/36V DC | 4.0-8.0mm   | IP67      | A-coded |

## Technical Characteristics

|                          |                                  |
|--------------------------|----------------------------------|
| <b>Insulating Body</b>   | PA                               |
| <b>Contact</b>           | CuZn, pre-nickel and gold plated |
| <b>Housing</b>           | CuZn, nickel plated              |
| <b>Hexagonal nut</b>     | CuZn, nickel plated              |
| <b>Seal</b>              | FKM                              |
| <b>Mating cycles</b>     | ≥ 100                            |
| <b>Temperature range</b> | -25°C to +80°C                   |

## Panel mount - Female

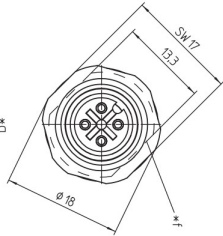
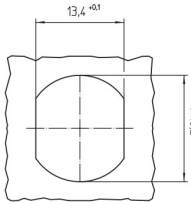
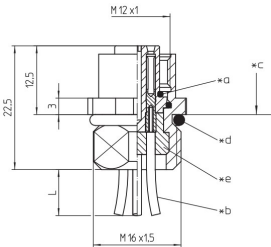
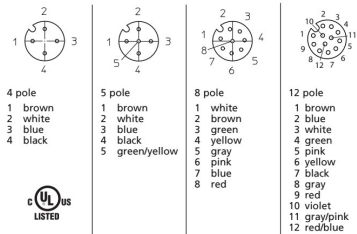

| # of poles | Part Number        | Style       | Current | Voltage    | L       | IP Rating | Layout  | Sheath |
|------------|--------------------|-------------|---------|------------|---------|-----------|---------|--------|
| 4          | 1220.04.T16CW_0.5m | Front-mount | 4A      | 250V AC/DC | 0.5 Mtr | IP67      | A-coded | PVC    |
| 5          | 1220.05.T16CW_0.5m | Front-mount | 4A      | 60V AC/DC  | 0.5 Mtr | IP67      | A-coded | PVC    |
| 8          | 1220.08.T16CW_0.5m | Front-mount | 2A      | 30V AC/DC  | 0.5 Mtr | IP67      | A-coded | PVC    |
| 12         | 1220.12.T16CW_0.5m | Front-mount | 1.5A    | 30V AC/DC  | 0.5 Mtr | IP67      | A-coded | PVC    |

## Panel mount - Male

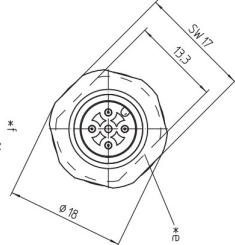
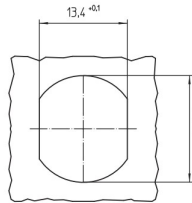
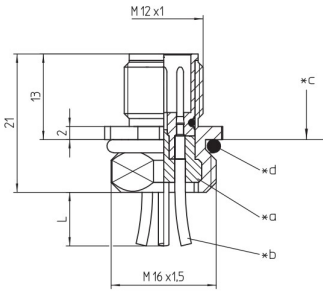
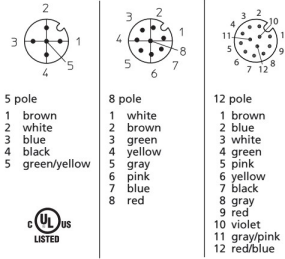

| # of poles | Part Number        | Style       | Current | Voltage    | L       | IP Rating | Layout  | Sheath |
|------------|--------------------|-------------|---------|------------|---------|-----------|---------|--------|
| 5          | 1230.05.T16CW_0.5m | Front-mount | 4A      | 250V AC/DC | 0.5 Mtr | IP67      | A-coded | PVC    |
| 8          | 1230.08.T16CW_0.5m | Front-mount | 2A      | 60V AC/DC  | 0.5 Mtr | IP67      | A-coded | PVC    |
| 12         | 1230.12.T16CW_0.5m | Front-mount | 1.5A    | 30V AC/DC  | 0.5 Mtr | IP67      | A-coded | PVC    |