



© Copyright 2020  
Living Earth Crafts®

All rights reserved. This document or any portion thereof may not be reproduced in any way, including photocopying or translation to another language without the prior written permission from Living Earth Crafts.

Living Earth Crafts® is a registered trademark of Earthlite, LLC.

#### Legal Notice

The information provided in this document is intended for informational purposes only and is subject to change without notice. The information provided in this document should not be construed as a commitment by Living Earth Crafts®.

Living Earth Crafts® assumes no responsibility for the accuracy or suitability of the information contained in this document. This document may contain technical inaccuracies or errors. Living Earth Crafts® makes no expressed or implied warranties of any kind concerning the information contained in this document, including, but not limited to, the implied warranties of merchantability and fitness for purpose.

Living Earth Crafts® shall not be liable for incidental or consequential damages in connection with or arising out of the product, performance, or use of this document and the information and material it describes.

# Introduction

Congratulations on your purchase of the ZG Dream™ Lounger. The ZG Dream™ Lounger fuses the scientifically proven relaxation benefits of zero gravity positioning with LEC's world renowned custom built craftsmanship.

The ZG Dream™ Lounger is designed for licensed therapists and technicians and is intended to be used in a professional spa, salon, or similar commercial environment. While no special training is needed to operate the product, for safety reasons it is important that the instructions contained in this manual are reviewed in detail before the first use. This manual should be read in its entirety by each professional who will be operating the product to ensure the safety of both operator and client. This manual should be saved for future reference.

The ZG Dream™ Lounger should not be used in any other manner than described in this manual. Please read, understand, and follow all safety warnings, labels, and instructions. Misuse, use of unnecessary force, or using the chair for unintended or unauthorized procedures can result in injury to operator, client, and/or equipment.

Detailed instructions for use and maintenance can be found in this user manual. If you have further questions, please contact us at (800) 872-0560 for US customers, or (760) 597-2155 for international customers. We can also be reached via e-mail at [info@livingearthcrafts.com](mailto:info@livingearthcrafts.com)

## Table of Contents

### Section 1: Safety Information

Safety Symbols/Warnings .....	2-3
-------------------------------	-----

### Section 2: Product Overview

Product Diagram .....	4
Product Specifications .....	5

### Section 3: Operating Instructions

Electrical Specifications .....	6
Controls Operation .....	6
Manicure Side Trays .....	7
Relaxor .....	8

### Section 4: Care & Maintenance

Cleaning & Ongoing Maintenance .....	9
Troubleshooting .....	10
Warranty Information .....	10
Contact Us .....	back cover

# SECTION 1: SAFETY INFORMATION

## Safety Symbols

Familiarize yourself with the following Safety & Warning symbols. They are designed to prevent damage and injury to you, your clients, and your new Earthlite product.

**IMPORTANT:** The important safety instructions and warnings in this manual cannot cover all possible problems and conditions that can occur. Use common sense and caution when installing, operating, or maintaining this appliance.



Indicates an imminently hazardous situation which could result in serious or fatal injury.



Indicates a potentially hazardous situation which could result in serious injury.



Indicates a potentially hazardous situation which could result in equipment damage and/or injury.

## IMPORTANT SAFETY INSTRUCTIONS - FOR COMMERCIAL USE ONLY

Read all instructions before using this product.



### MOVABLE PARTS, RISK OF INJURY:

- Keep children away from all moving parts of the chair.

To reduce the risk of burns, fire, electric shock, or injury to persons:

- Unplug from outlet before putting on or taking off parts.
- Close supervision is necessary when this furnishing is used by, or near children, invalids, or disabled persons. DO NOT leave children alone or allow them to operate the controls. Keep controls out of reach of children. DO NOT allow children to crawl behind the chair.
- Never use this furnishing if it has a damaged cord or plug, if it is not working properly, if it has been dropped or damaged, or dropped into water. Return the furnishing to a service center for examination and repair.
- Chair must be placed on a level surface.
- Keep the cord away from heated surfaces.
- Never operate the furnishing with the air openings blocked. Keep the air openings free of lint, hair, etc.
- Never drop or insert any object into any opening.
- Keep the electrical cord away from heated surfaces.
- Connect this appliance only to a properly grounded outlet.
- To avoid injury, exercise care when entering or exiting the chair.
- Use caution when making positioning adjustments to your chair. Keep all equipment and body parts away from moving parts while making any adjustments.
- Make certain that the cord and plug are maintained in good condition and are not allowed to become damaged while in use. Avoid positioning the cord in the traffic lane and it is always kept out of the way. Take this furnishing out of service immediately if the cord or plug becomes damaged in any way.
- Do not attempt to repair. All repairs must be performed by an authorized service representative.

# SECTION 1: SAFETY INFORMATION



## INSTALLATION INSTRUCTIONS / GROUNDING INSTRUCTIONS

When using electrical products, basic precautions should always be followed, including the following:

- 1. RISK OF ELECTRIC SHOCK.** Connect only to a circuit protected by a ground-fault circuit-interrupter.
- 2. Grounding is required.** The unit should be installed by a qualified service representative and grounded.

This product must be grounded. If it should malfunction or break down, grounding provides a path of least resistance for electric current to reduce the risk of electric shock. This product is equipped with a cord having an equipment-grounding conductor and grounding plug. The plug must be plugged into an appropriate outlet that is properly installed and grounded in accordance with all local codes and ordinances.

Improper connection of the equipment-grounding connector can result in a risk of electric shock. Check with a qualified electrician or serviceman if you are in doubt as to whether the product is properly grounded. Do not modify the plug provided with the product - if it will not fit the outlet, have a proper outlet installed by a qualified electrician.

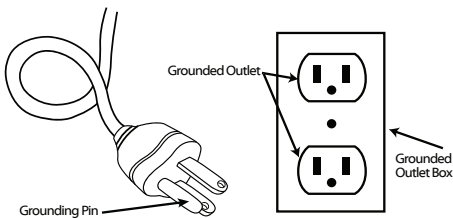

## SECTION 2: PRODUCT OVERVIEW

---

### Upright Position



### Fully Reclined Position



## SECTION 2: PRODUCT OVERVIEW

### Product Specifications

<b>Width</b>	33" (84 cm)
<b>Height (upright)</b>	48" (122 cm)
<b>Length (fully reclined)</b>	63" (160 cm)
<b>Length (upright)</b>	54" (137 cm)
<b>Armrest Height</b>	26" (66 cm)
<b>Seat Height</b>	22.5" (57 cm)
<b>Seat Depth</b>	20.5" (52 cm)
<b>Backrest pad size</b>	30.5" x 22.5" (78 cm x 57 cm)

*\*Measurements may vary due to natural material variations.*

### Included Features

<b>Feature</b>	<b>Standard</b>	<b>Optional</b>
<b>Commercial-grade frame</b>	X	
<b>Fully motorized operation with soft start/stop</b>	X	
<b>Retractable footrest</b>	X	
<b>Embedded controls</b>	X	
<b>USB Charging Port</b>	X	
<b>Cloudfill™ Headpillow</b>	X	
<b>Upholstery</b>	Natursoft™	Promessa® or bespoke fabrics
<b>Relaxor® Heat &amp; Massage</b>		X
<b>Manicure Side Trays</b>		X
<b>Pedicure Bowl</b>		X
<b>Replacement Cushions</b>		X

# SECTION 3: OPERATING INSTRUCTIONS

## Electrical Specifications

Maximum Output	30V DC, 6.0 amps max
Duty Cycle	10%, max. 2 min on/18 min off

## Controls Operation

Your ZG Dream™ Lounger is equipped with controls embedded in the armrest. See below for instructions on how to adjust your chair.



Always use extreme caution when making any position adjustments to your chair. Ensure all body parts and objects are clear from all moving parts.



## Variable Zero Gravity Positioning





## SECTION 3: OPERATING INSTRUCTIONS

### Manicure Side Trays (Optional)

The Manicure Side Trays are a convenient way to offer manicure services in your chair. Each tray has 2 posts on the side that can be pushed into the receivers attached to the armrests. There is a set of receivers to use when the chair is in the upright position, and another set to use when the chair is reclined.

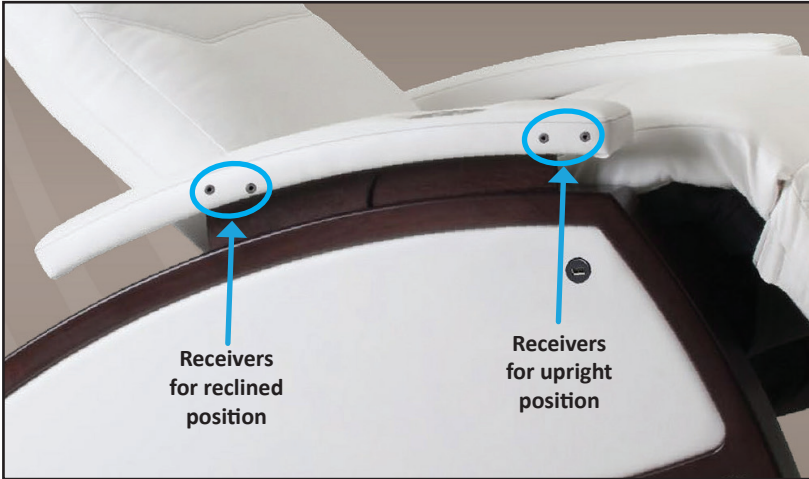

1. Locate the side tray receivers on the side of your chair

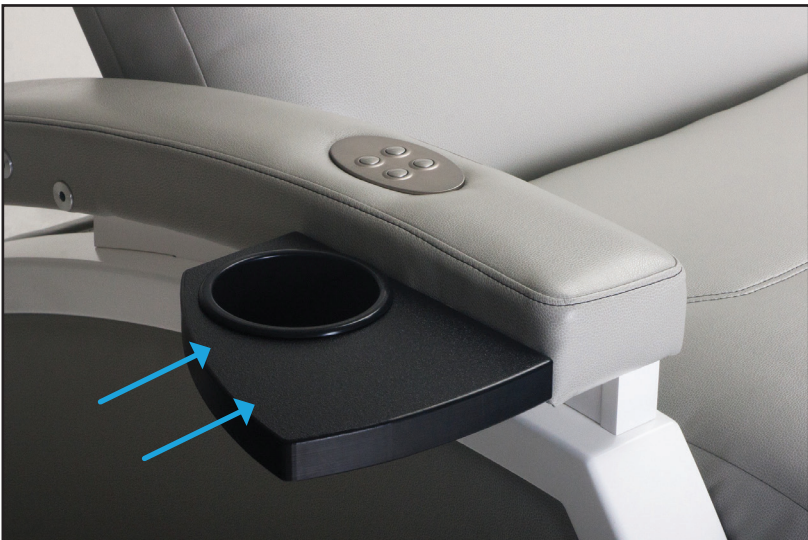

2. Push side tray posts evenly into the receivers

# SECTION 3: OPERATING INSTRUCTIONS

## Relaxor® Heat & Massage (Optional)

The following diagrams illustrate the ease-of-use and functionality that the Relaxor® system provides to you and your clients.



### RISK OF ELECTRIC SHOCK

Keep hand control and all electrical components away from water.

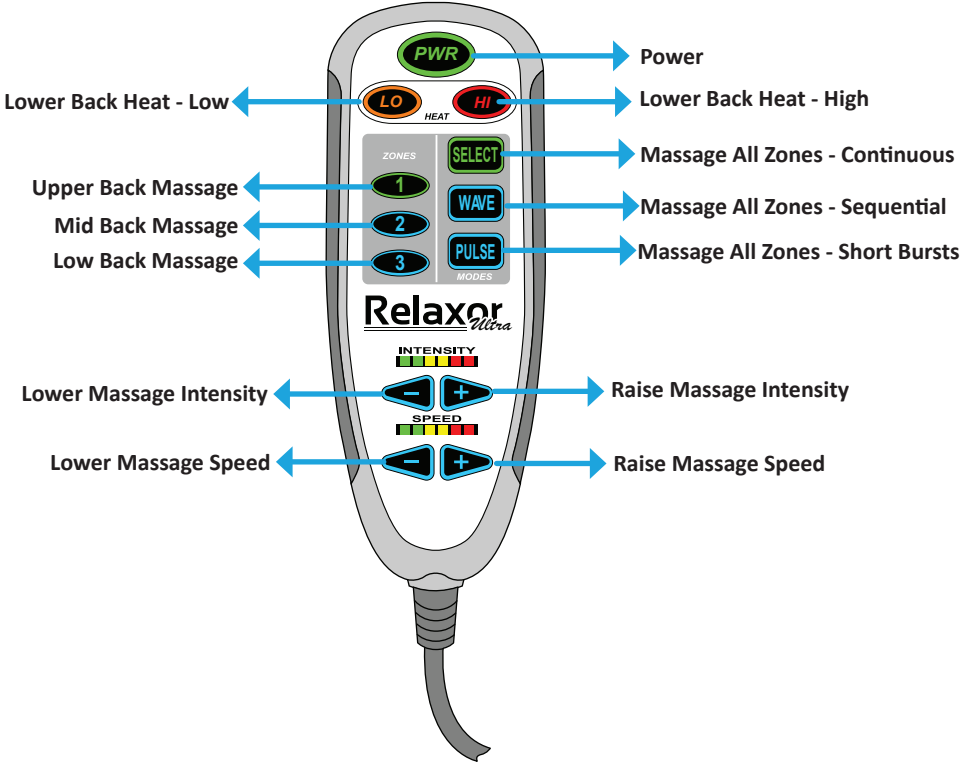

Symbol	Description
	• Massage 15 Minute Timer (Standard)
	• Massage 30 Minute Timer (Hold Down Button)
<b>Green Light</b>	• Indicates Active Button
<b>Blue Light</b>	• Indicates Normal Standby
<b>Red Light</b>	• Indicates High Mode
<b>Orange Light</b>	• Indicates Low Mode

# SECTION 4: CARE & MAINTENANCE

## Cleaning & Ongoing Maintenance



### RISK OF ELECTRIC SHOCK

Always unplug this furnishing from the electrical outlet before cleaning.



DO NOT USE acetone, "Armor All" type cleaners, citrus-based cleaners, or industrial cleaners. These can seriously damage the upholstery. Such damage would not be covered under warranty.

Your ZG Dream Lounger is relatively maintenance free. However, to ensure your chair will continue to function properly and keep its appearance, we recommend the following.

Category	Care Recommendation
Upholstery	Remove day-to-day dirt and smudges with a mild soap and water solution. For tough stains and to disinfect, use a (100 to 1) water to bleach solution. Spray a damp cloth with the solution to clean. After each cleaning, gently wipe the upholstery with a damp cloth and clean water, then allow upholstery to air dry before using or storing. For more difficult stains, please contact your dealer or please call us directly for guidance. For best results, use only the products suggested above.
Laminate	Never use abrasive cleaners. A mild liquid detergent and warm water will clean soiled surfaces. To avoid discoloration, cleaners containing petroleum distillates must not remain on surfaces.
Wood	To maintain the wood finish and retouch scratches, use a high quality furniture wax.
Electronics	Anti-static electronic aerosol dusters can be used to keep the surfaces of electronic components, power cables, and plugs free of dust.
Lubrication & Mechanical	If necessary, lubricate wheel joints, casters, and other mechanical parts with a light machine oil. Periodically check and ensure all visible bolts remain tightened.

# SECTION 4: CARE & MAINTENANCE

## Troubleshooting

This helpful troubleshooting guide will provide you with information about how to recognize a problem with your product, determine possible causes, and find a solution.

In the event your specific situation is not covered in this guide, please contact Living Earth Crafts so our technical support department can assist you. Beyond the troubleshooting guide below, do not attempt to repair the issue yourself. This can void your warranty.

Unauthorized service will not be covered. Please be sure to contact Living Earth Crafts Customer Service first at (800) 358-8292, (760) 597-2155 Int'l.

<b>Issue</b>	<b>Solution</b>
No Power/Not Operating	<ol style="list-style-type: none"><li>1. Ensure the power cord is properly plugged into an operational power supply/outlet.</li><li>2. Check GFCI reset (if applicable) and circuit breakers or fuses.</li><li>3. Ensure the outlet in your room is receiving power. This can be done by plugging in a small appliance and turning it on.</li></ol>

## Warranty Information

Living Earth Crafts (LEC) offers an industry best warranty against defects in materials, design, and workmanship, to the original owner, as follows:

- Frame - lifetime warranty\*
- Foam and upholstery covering - warranted for three (3) years
- Motors, controls, electronics - warranted for two (2) years, including parts and labor
- Accessories and options - warranted for one (1) year, unless otherwise noted

LEC may repair or replace defective components at our discretion. LEC will return the warranted product, standard shipping pre-paid, to customers in the continental US. International customers are responsible for any applicable duties and taxes, as well as all shipping charges inbound and outbound. Normal wear and tear, and costs associated with maintenance procedures, and damage caused by accident, misuse, improper maintenance, harsh operating environments or neglect (which includes tears in the upholstery and damage caused by harsh chemical-based cleaners) are not covered under this warranty. All warranties are limited to repair or replacement, at LEC's discretion, unless otherwise stated.

\*Lifetime warranty applies to the original owner or for 5 years after the model is discontinued, or 5 years for private label chairs.

## Notes







## Contact Us

Living Earth Crafts  
990 Joshua Way  
Vista, CA. 92081  
(800) 358-8292  
(760) 597-2155 Int'l  
(866) 449-8872 fax  
[info@livingearthcrafts.com](mailto:info@livingearthcrafts.com)

Hours of operation:

Monday - Friday  
8:00 a.m. to 5 p.m. PST

Saturday - Sunday  
Closed

Visit us online at: [livingearthcrafts.com](http://livingearthcrafts.com)



Join us on  
Facebook



Follow us on  
Twitter



Follow us on  
Instagram



Connect with us  
on Linked In

